

SPARES LIST

for

500 cc. O.H.V.

"SUPER CLUBMAN"

VERTICAL TWIN

(MODEL G9)



MATCHLESS MOTOR CYCLES

PROPRIETORS : ASSOCIATED MOTOR CYCLES LIMITED

PLUMSTEAD - LONDON - S.E.18



Price :

TWO SHILLINGS and SIXPENCE

EDITION CL-12

ILLUSTRATIONS

	Page
CARBURETTER	13
CLUTCH AND KICK-STARTER	22
CONTROL LEVERS	32
CRANKCASE, CRANKSHAFT AND CONNECTING RODS ...	4
CYLINDERS, HEADS, PISTONS, VALVES AND TIMING GEAR	8
EXHAUST PIPES, ENGINE SHOCK-ABSORBER AND CHAINS	16
FRAME AND <i>TELEDRAULIC</i> REAR LEG	25
FRONT <i>TELEDRAULIC</i> FORKS AND STEERING DAMPER ...	27
GEAR OPERATING PARTS	21
GEAR BOX SHELLS, GEARS AND SHAFTS	18
OIL PUMPS, DYNAMO AND MAGNETO	11
STANDS, GUARDS, CHAINCASES AND TOOL BOXES ...	29
TANKS AND PIPES	36
WHEELS AND BRAKES	38

SPARES LIST

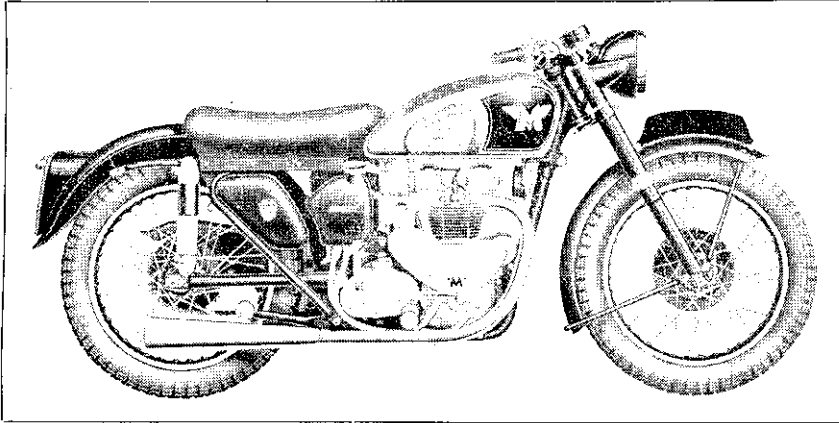

MATCHLESS "SUPER CLUBMAN"

VERTICAL TWIN

Bore 66 m.m.

Stroke 72.8 m.m.

Capacity 498 c.c.

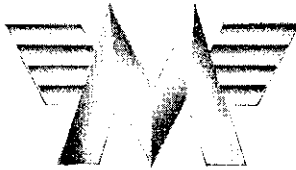

Compiled and Issued by the Manufacturers :

MATCHLESS MOTOR CYCLES

(Proprietors : ASSOCIATED MOTOR CYCLES LIMITED)

Registered Offices :

**PLUMSTEAD ROAD, PLUMSTEAD
LONDON, S.E.18 .. ENGLAND**

Nearest Station :
WOOLWICH ARSENAL
(Southern Region Railway)

Factories :
**BURRAGE GROVE and MAXEY ROAD
PLUMSTEAD, S.E.18**

Telegrams and Cables : "MATCHLESS, WOL-LONDON"
Telephone: WOOLWICH 1223 (5 Lines)
Codes : A.B.C. 5th and 6th Edition ; Bentley's ; and Private Codes

All correspondence to :—
MATCHLESS MOTOR CYCLES, PLUMSTEAD ROAD, LONDON, S.E.18

Price: TWO SHILLINGS and SIXPENCE

EDITION CL-12

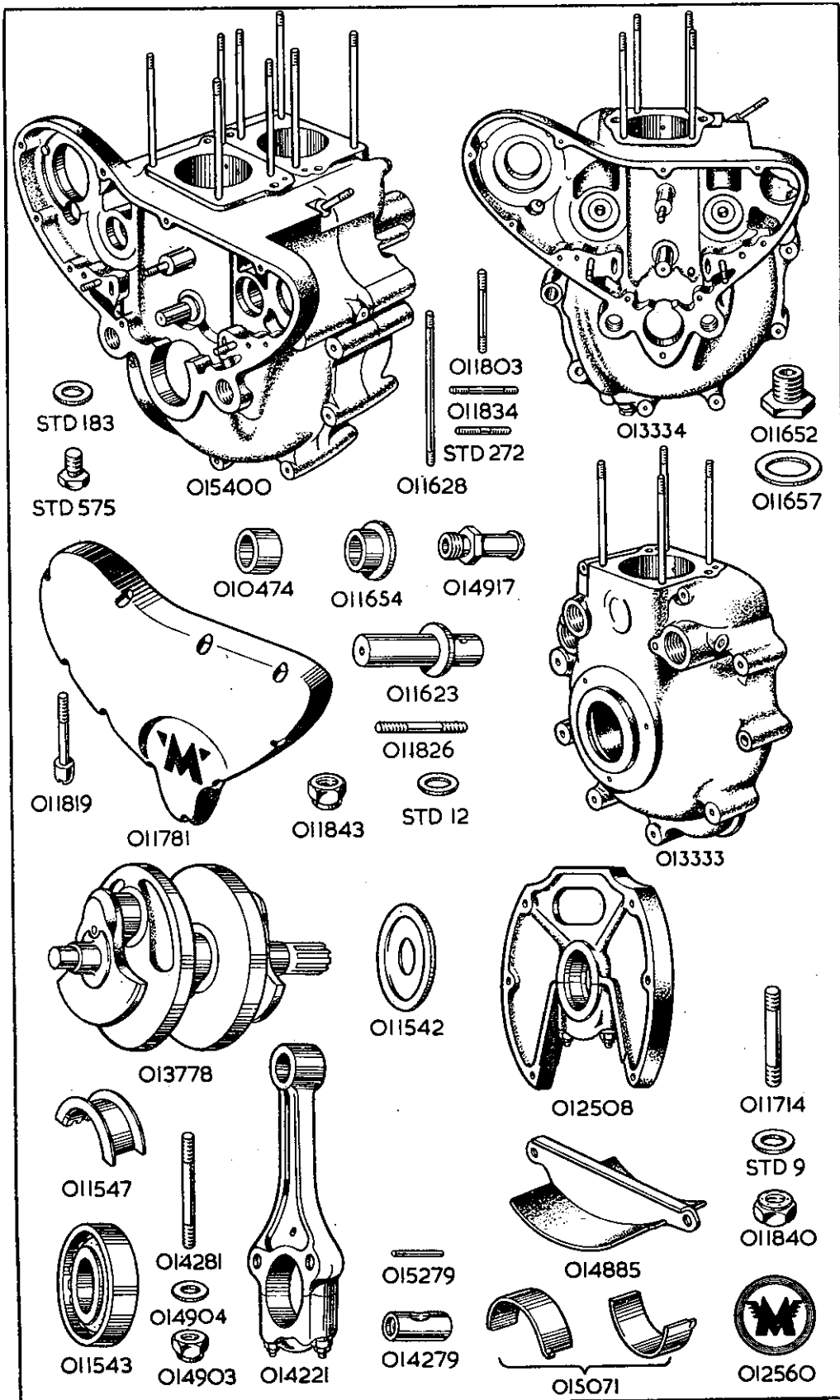

PART NUMBER.	DESCRIPTION.	QTY.	PRICE EACH £ s. d.
CRANKCASE			
015400 Crankcase, complete (1)	1	...
013333 Crankcase, driving side only (2)	1	...
013334 Crankcase, timing side only (3)	1	...
012508 Web, centre, with cap, studs, washers and nuts. (No bearing)	1	...
014885 Deflector, oil, for crankcase	1	...
011781 Cover, for timing gear	1	...
012560 Badge, monogram, for driving side crankcase	1	...
011826 Stud, fixing centre web. 1 $\frac{1}{2}$ in. by $\frac{1}{4}$ in. by 26 and 20	6	...
STD-12 Washer, plain, for centre web top fixing studs	2	...
STD-12 Washer, plain, for centre web centre fixing studs	2	...
011843 Nut, for centre web fixing studs	6	...
011714 Stud, for centre web bearing cap, 2 $\frac{1}{16}$ in. by $\frac{7}{16}$ in. by 18 and 18	2	...
STD-9 Washer, plain, for centre web bearing cap stud	2	...
011840 Nut, for centre web bearing cap stud	2	...
011628 Stud, in driving side crankcase, for cylinder and head, 5 $\frac{7}{16}$ in. by $\frac{5}{16}$ in. by 22 and 22	4	...
011628 Stud, in timing side crankcase, for cylinder and head, 5 $\frac{7}{16}$ in. by $\frac{5}{16}$ in. by 22 and 22	4	...
011834 Stud, in timing side crankcase, for pump carrying plate 1 $\frac{5}{8}$ in. by $\frac{5}{16}$ in. by 26 and 22	3	...
STD-272 Stud, in timing side crankcase, for fixing magneto, 1 $\frac{1}{2}$ in. by $\frac{5}{16}$ in. by 26 and 22	2	...
011803 Stud, in timing side crankcase, for dynamo strap, 1 $\frac{3}{8}$ in. by $\frac{1}{2}$ in. by 26 and 20	1	...
011623 Shaft, in timing side crankcase, for intermediate gear	1	...
STD-575 Plug, drain, for timing side crankcase	1	...
STD-183 Washer, fibre, for crankcase drain plug	1	...
011819 Screw, retaining timing gear cover	10	...
011652 Adaptor, to accommodate oil feed and return pipe retaining banjo pins. (Screws into timing side crankcase)	2	...
011657 Washer, fibre, for banjo pin adaptors	2	...
014917 Union, to accommodate crankcase release valve pipe. (Screws into driving side crankcase)	1	...
STD-183 Washer, fibre, for crankcase release valve pipe union	1	...
010474 Bush, plain, for camshafts. (In driving side crankcase)	2	...
011654 Bush, flanged, for camshafts. (In timing side crankcase)	4	...

NOTE 1.—Includes :—

Driving side crankcase. Timing side crankcase, centre web with studs (no bearing, washers and oil deflector). All bushes for camshafts. All cylinder studs. Shaft for intermediate gear. Studs for pump carrying plate. Two magneto fixing studs. Dynamo strap stud. Timing gear cover and fixing screws. Monogram badge fitted to driving side crankcase. Three bolts. One stud. Two nuts. Five washers.

NOTE 2.—Includes :—

Two camshaft bushes. Four cylinder studs. Six studs for centre web. (No monogram badge).

NOTE 3.—Includes :—

Four camshaft bushes. Four cylinder studs. Shaft for intermediate gear. Three studs for pump carrying plate. Two studs for magneto fixing. One stud for dynamo strap. (No timing gear cover and fixing screws).

PART NUMBER	DESCRIPTION.	QTY.	PRICE EACH £ s. d.
----------------	--------------	------	--------------------------

CRANKSHAFT, BEARINGS, CONNECTING RODS AND BIG-END BEARINGS.

013778	Crankshaft, plugged, but bare	1	...
011542	Washer, for crankshaft.....	2	...
011547	Bearing, plain, for centre bearing (in halves) per pair	1	...
011543	Bearing, roller, for crankshaft. (Parts of this bearing not sold separately) (4)	2	...
014221	Rod, connecting, assembly. (No Big-end bearing)	2	...
014281	Stud, for connecting rod, 2 $\frac{3}{32}$ in. by $\frac{5}{16}$ in. by 26	4	...
014279	Trunnion, for connecting rod stud	4	...
015279	Rivet, locating connecting rod stud	4	...
014904	Washer, plain, for connecting rod stud	4	...
014903	Nut, for connecting rod stud.....	4	...
015071	Bearing, plain, for connecting rod. (Big-end) in halves, per pair	2	...

The following undersize bearings can be supplied. It is necessary to have the journals ground to suit. All are sold in pairs.

1st Undersize is .010 inch below normal.

2nd Undersize is .020 inch below normal.

3rd Undersize is .030 inch below normal.

015072	Bearing, plain, for centre bearing. 1st Undersize.....	1	...
015073	Bearing, plain, for centre bearing. 2nd Undersize	1	...
015406	Bearing, plain, for centre bearing. 3rd Undersize	1	...
015402	Bearing, plain, for connecting rod. 1st Undersize	2	...
015403	Bearing, plain, for connecting rod. 2nd Undersize	2	...
015405	Bearing, plain, for connecting rod. 3rd Undersize	2	...

NOTE 4.—Dimensions :—

Internal diameter, 1 $\frac{3}{8}$ in.

External diameter, 3 in.

Width, $\frac{1}{16}$ in.

Manufacturer's Part Number, RLS 12 $\frac{1}{2}$.

CYLINDERS, PISTONS, HEADS AND VALVES.

011713	Cylinder.....	2	...
011716	Washer, paper, for cylinder base	2	...
015518	Piston, bare, normal size.....	2	...
015803	Piston, bare, .020 in. oversize (5)	2	...
015804	Piston, complete, normal size (6)	2	...
015805	Piston, complete, .020 in. oversize (5) (6)	2	...
010631	Ring, compression, normal size	4	...
015522	Ring, compression, .020 in. oversize (5)	4	...
010632	Ring, scraper, normal size	2	...
015523	Ring, scraper, .020 in. oversize (5)	2	...
011731	Pin, gudgeon	2	...
014283	Circlip, for gudgeon pin	4	...
015121	Head, for cylinder, left bare	1	...
015122	Head, for cylinder, right, bare	1	...
015526	Head, for cylinder, left, with valve guides fitted (7)	1	...
015527	Head, for cylinder, right, with valve guides fitted (7)	1	...
011715	Gasket, for cylinder head	2	...
014163	Valve, inlet.....	2	...
014165	Valve, exhaust	2	...
011770	Spring, inner, for valve	4	...
011769	Spring, outer, for valve	4	...
014169	Seat, for valve springs	4	...
014168	Collar, for valve springs	4	...
014167	Collet, for valve stems.....	4	...
014170	Guide, for inlet valves.....	2	...
014171	Guide, for exhaust valves	2	...
011111	Circlip, locating valve guides	4	...
011635	Nut, retaining cylinders and heads	8	...
011634	Spacer, under head retaining nuts, $\frac{3}{32}$ in. long	8	...
010625	Stud, retaining inlet manifold, 1 $\frac{1}{16}$ in. by $\frac{1}{4}$ in. by 26 and 20... ..	4	...

PART NUMBER.	DESCRIPTION.	QTY.	PRICE EACH £ s. d.
-----------------	--------------	------	--------------------------

NOTE 5.—Cylinders to be ground .020 in. "oversize" to suit.

NOTE 6.—Includes :—

Piston. Two compression rings. One scraper ring. Gudgeon pin. Two circlips for gudgeon pin.

NOTE 7.—Includes :—

One inlet valve guide. One exhaust valve guide. Two circlips locating valve guides. Two studs for inlet manifold.

RE-BORING.

Cylinders may be re-bored to .020 in. oversize and pistons (with rings) supplied to suit. The charge is with an additional if new gudgeon pins and circlips are also supplied.

Cylinders sent for re-boring should be packed in stout cases which will be used by us for their return. Carriage is additional. If a complete machine, or engine, is sent to us for cylinder re-boring, there will be an additional charge, according to the time taken, for dismantling and assembly.

TIMING GEAR.

011784	Camshaft, inlet	1	...
011785	Camshaft, exhaust	1	...
011620	Gear, on camshaft, 60 teeth	2	...
STD-573	Key, locating camshaft gears	2	...
011653	Nut, retaining camshaft gears	2	...
011544	Pinion, on crankshaft, 30 teeth	1	...
STD-573	Key, locating crankshaft pinion	1	...
011776	Bolt, retaining crankshaft pinion, threaded $\frac{1}{2}$ in. by 20	1	...
010589	Washer, plain, for crankshaft pinion bolt	1	...
011621	Gear, intermediate, with bush, 60 teeth	1	...
015278	Bush, for intermediate gear	1	...
014154	Follower, for camshaft	4	...
011626	Spindle, for camshaft followers	2	...
011627	Spacer, between camshaft followers, $1\frac{1}{8}$ in. long	2	...

ROCKERS AND PUSH RODS.

014284	Rocker, with bushes (left inlet and right exhaust)	2	...
014285	Rocker, with bushes (right inlet and left exhaust)	2	...
014222	Spindle, for rockers	4	...
014226	Washer, spring, double coil, for rocker spindle	4	...
014275	Washer, plain, for either side of rocker spindle spring washer	8	...
014275	Washer, plain, for clamping end of rocker spindle	4	...
011760	Bolt, clamping rocker spindle. (Thread No. 2 B.A.)	4	...
015021	Washer, plain, for rocker spindle clamping bolt	4	...
011846	Nut, for rocker spindle clamping bolt	4	...
014245	Bush, for rockers. (Two in each rocker)	8	...
014381	Cover, for rockers	4	...
014411	Gasket, for rocker covers	4	...
014412	Bolt, short head, retaining rocker covers, 2 B.A. by $1\frac{1}{8}$ in. under head	8	...
014413	Bolt, long head, retaining rocker covers, 2 B.A. by $1\frac{1}{8}$ in. under head	8	...
014120	Rod, push, assembled with ends	4	...
014116	Rod, push, bare	4	...
014115	End, upper, for push rod	4	...
014114	End, lower, for push rod	4	...

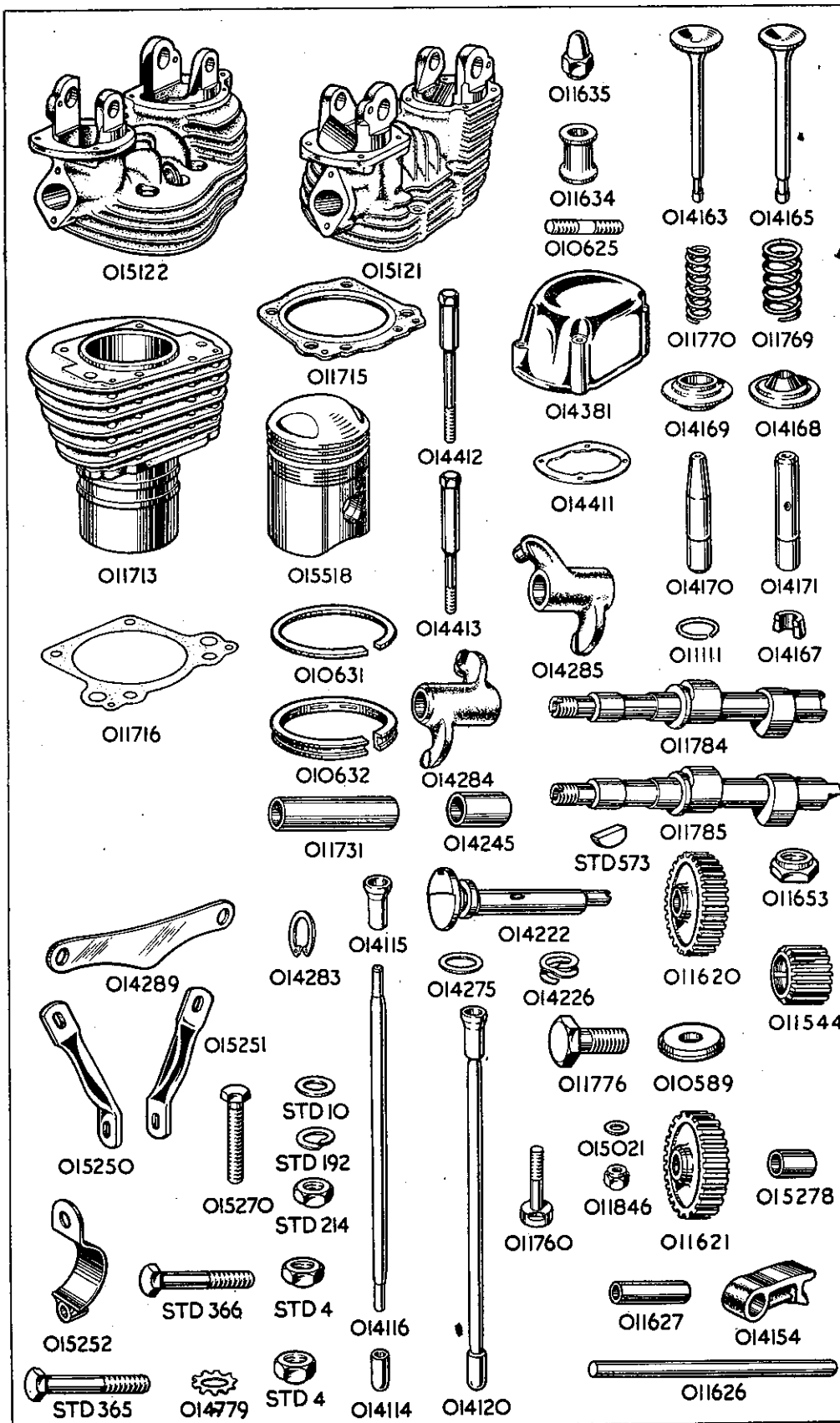

PART NUMBER.	DESCRIPTION.	QTY.	PRICE EACH £ s. d.
ENGINE STEADY STAY.			
015250	Stay, engine steady, right side	1	...
015251	Stay, engine steady, left side	1	...
015252	Clip, half only, on frame tube, for steady stay	2	...
STD-365	Bolt, securing fronts of steady stay frame clips $1\frac{1}{8}$ in. by $\frac{5}{16}$ in. by 26	1	...
014779	Washer, lock, for steady stay frame clip front bolt	1	...
STD-4	Nut, for steady stay frame clip front bolt	1	...
STD-366	Bolt, securing steady stays and frame clips, $1\frac{1}{2}$ in. by $\frac{5}{8}$ in. by 26	1	...
STD-4	Nut, for steady stays and frame clip securing bolt.....	1	...
014289	Plate, tie, for cylinder heads and steady stays.....	1	...
015270	Bolt, retaining steady stays and tie plate to head, $1\frac{1}{8}$ in. by $\frac{5}{16}$ in. by 22	2	...
STD-10	Washer, plain, under heads of tie plate bolts.....	2	...
STD-192	Washer, spring, for tie plate bolts	2	...
STD-214	Nut, for tie plate bolts	2	...

OIL PUMPS.

013345	Oil pumps, complete, assembled on carrying plate (8).....	1	...
015017	Plate, carrying oil pumps, bare (9)	1	...
011842	Nut, securing pump carrying plate to timing side crankcase.....	3	...
STD-11	Washer, plain, for pump carrying plate fixing nuts	3	...
STD-21	Ball, $\frac{3}{16}$ in. steel, for return pump bleed valve	1	...
STD-701	Spring, for return pump bleed valve ball	1	...
015001	Screw, securing return pump bleed valve spring. (Grub screw, $\frac{1}{4}$ in. long by $\frac{5}{16}$ in. by 22)	1	...
012333	Body, oil feed pump, for $\frac{1}{4}$ in. gears	1	...
012336	Gear, driving, for oil feed pump, $\frac{1}{4}$ in. wide	1	...
012337	Gear, driven, for oil feed pump, $\frac{1}{4}$ in. wide.....	1	...
011554	Plate, end, for oil feed pump	1	...
011556	Pin, dowel, locating oil feed pump end plate	1	...
011617	Washer, paper, between oil feed pump and carrying plate	1	...
STD-453	Screw, retaining oil feed pump to carrying plate, 1 in. by 2 B.A.	3	...
011553	Body, oil return pump, for $\frac{3}{8}$ in. gears	1	...
011559	Gear, driving, for oil return pump, $\frac{3}{8}$ in. wide	1	...
011560	Gear, driven, for oil return pump, $\frac{3}{8}$ in. wide.....	1	...
011554	Plate, end, for oil return pump	1	...
011556	Pin, dowel, locating oil return pump end plate	1	...
011617	Washer, paper, between oil return pump and carrying plate ...	1	...
STD-453	Screw, retaining oil return pump to carrying plate, 1 in. by 2 B.A.	3	...

NOTE 8.—Includes all the items listed above except the three 011842 and STD-11 fixing nuts and washers.

NOTE 9.—Includes the STD-21, STD-701 and 015001 bleed valve ball, spring and retaining grub screw.

OIL FELT FILTER (IN ENGINE).

014235	Filter, felt, for engine crankcase	1	...
014239	Seat, for oil felt filter	1	...
014248	Valve, relief, for oil felt filter.....	1	...
014241	Spring, for oil felt filter relief valve	1	...
014238	Cap, for felt filter housing. (Also accommodates oil non-return valve)	1	...
011642	Washer, fibre, for filter housing cap.....	1	...
011645	Ball, $\frac{3}{8}$ in. steel, for non-return valve	1	...
014243	Seat, for non-return valve ball	1	...
014817	Circlip, retaining non-return valve seat	1	...
013564	Spring, for non-return valve ball	1	...
015034	Gasket, paper, for oil filter chamber. (Fits between the two crankcase halves)	1	...

OIL DISTRIBUTOR. (Driven by left hand end of exhaust camshaft.)

014246	Distributor, oil	1	...
014247	Cap, housing, for oil distributor	1	...
011642	Washer, fibre, for oil distributor housing cap.....	1	...

PART NUMBER.	DESCRIPTION.	QTY.	PRICE EACH £ s. d.
--------------	--------------	------	-----------------------

OIL RELIEF VALVE. (Located in Timing side crankcase, close to oil feed pump.)

011645	Ball, $\frac{3}{8}$ in. steel, for oil relief valve.....	1	...
011644	Spring, for oil relief valve ball	1	...
011646	Plug, retaining oil relief valve ball spring.....	1	...
STD-183	Washer, fibre, for oil relief valve plug	1	...

CRANKCASE RELEASE VALVE.

014248	Valve, crankcase release	1	...
011648	Cap, housing, for crankcase release valve	1	...
011642	Washer, fibre, for crankcase release valve housing cap.....	1	...

MAGNETO.

014573	Magneto, complete, Type K2F. (Lucas number, 42180-A)	1	...
458367	Pick-up, with brush and spring, right	1	...
458368	Pick-up, with brush and spring, left	1	...
470534	Contact breaker, complete.....	1	...
470609	Contact set	1	...
458619	Cover, for contact breaker.....	1	...
010339	Gasket, for magneto flange.....	1	...
STD-365	Bolt, retaining magneto, $1\frac{1}{16}$ in. by $\frac{5}{16}$ in. by 26.....	1	...
<i>For the two magneto retaining studs, see " CRANKCASE GROUP."</i>			
014779	Washer, lock, for magneto retaining bolt and studs	3	...
014734	Nut, for magneto retaining bolt and studs	3	...
014464	Gear, on magneto shaft	1	...
140074	Washer, plain, on magneto shaft	1	...
171284	Nut, on magneto shaft, retaining magneto driving gear	1	...

DYNAMO.

011833	Dynamo, Type E3-L-L1-0. (Lucas Number 20009)	1	...
200737	Brush, for dynamo, set of two, per set.....	1	...
014141	Gasket, between dynamo and crankcase	1	...
011801	Strap, retaining dynamo to crankcase	1	...
014796	Screw, retaining lower end of dynamo strap to crankcase, $\frac{7}{16}$ in. by $\frac{1}{2}$ in. by 20.....	1	...
STD-12	Washer, plain, for dynamo strap retaining screw	1	...
010604	Crosshead, in eye of dynamo retaining strap	1	...
011802	Nut, tensioning dynamo strap. (The stud, on which this nut screws, is listed with the crankcase parts)	1	...
STD-12	Washer, plain, for dynamo strap tensioning nut.....	1	...
011800	Gear, on dynamo shaft.....	1	...
STD-572	Key, locating dynamo shaft gear	1	...
111700	Bolt, retaining gear on dynamo shaft	1	...
188378	Washer, lock, for dynamo gear retaining bolt	1	...

CARBURETTER.

014288	Carburetter, complete (less wires and levers). Type 76AG/IAU	1	...
011633	Manifold, inlet, bare, (no studs). (The studs are listed with cylinder heads)	1	...
STD-12	Washer, plain, for inlet manifold retaining studs	4	...
STD-5	Nut, for inlet manifold retaining studs.....	4	...
011771	Gasket, between inlet manifold and cylinder heads	2	...
010624	Stud, retaining carburetter to inlet manifold, $1\frac{1}{2}$ in. by $\frac{5}{16}$ in. by 26 and 22	2	...
STD-11	Washer, plain, for carburetter retaining studs	2	...
STD-74	Nut, retaining carburetter	2	...
STD-581	Gasket, between carburetter and inlet manifold	1	...

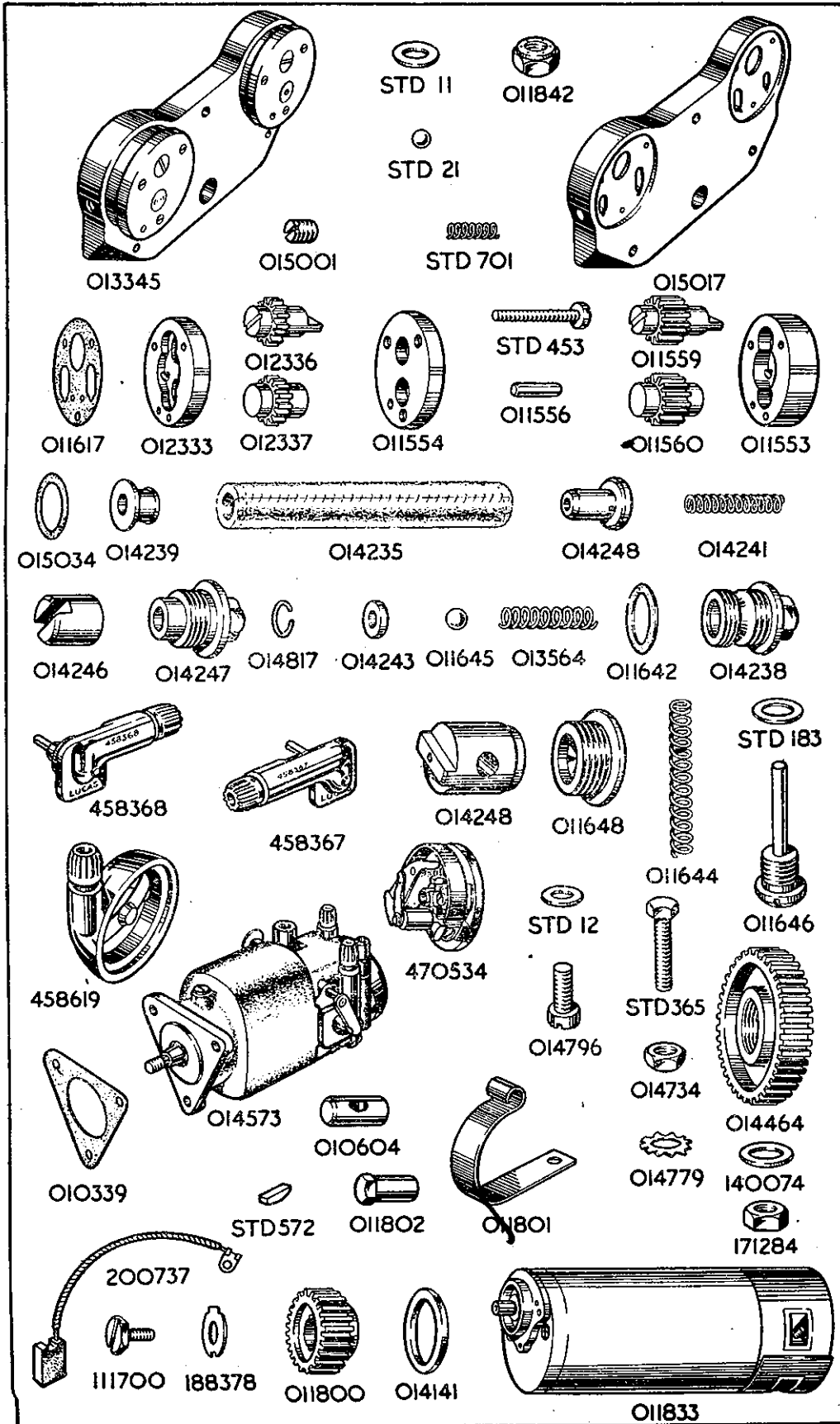

PART NUMBER	DESCRIPTION.	QTY.	PRICE EACH £ s. d.
----------------	--------------	------	--------------------------

FLOAT CHAMBER.

64-192-B ...	Chamber, float, bare	1	...
13-153 ...	Screw, plug, blocking passage in float chamber	1	...
14-039 ...	Washer, fibre, for float chamber passage plug screw.....	1	...
14-208-B ...	Top, or cover, for float chamber	1	...
14-021 ...	Screw, locking float chamber top	1	...
14-015 ...	Float, bare	1	...
14-024 ...	Needle, for float	1	...
14-209 ...	Tickler, bare	1	...
14-210 ...	Stop, for tickler	1	...
14-032 ...	Spring, for tickler	1	...
14-289 ...	Cotter, split pin, for tickler	1	...
14-035 ...	Banjo, connection, for petrol pipe.....	1	...
14-175 ...	Washer, fibre, upper, for petrol banjo connection	1	...
14-037 ...	Washer, fibre, lower, for petrol banjo connection.....	1	...
14-036 ...	Nut, retaining banjo connection to float chamber.....	1	...

MIXING BODY.

76-014 ...	Body, mixing, bare	1	...
6-033 ...	Nut, union, for base of mixing body.....	1	...
6-040 ...	Washer, fibre, for mixing body union nut	1	...
4-043 ...	Bolt, holding float chamber to mixing body	1	...
4-053 ...	Washer, fibre, for float chamber holding bolt.....	2	...
206-038-R ...	Intake, air	1	...
6-032-B ...	Top, for mixing chamber	1	...
6-031 ...	Ring, fixing top to mixing chamber	1	...
4-235 ...	Clip, locking mixing chamber top fixing ring	1	...
4-241 ...	Screw, securing locking clip to mixing body top	1	...
4-035 ...	Adjuster, for control cable, throttle or air	2	...

CHOKE AND JETS.

6-058 ...	Choke, or jet barrel.....	1	...
4-061 ...	Needle jet	1	...
4-042-180...	Jet, main, size 180.....	1	...
6-065 ...	Needle, taper, for needle jet	1	...
4-230 ...	Clip, for jet taper needle.....	1	...
4-060 ...	Pin, split, locating taper needle clip	1	...
13-129 ...	Screw, for pilot jet air adjustment	1	...
16-010 ...	Nut, lock, for pilot jet air screw	1	...

The following alternative main jets can be supplied.

4-042-170...	Jet, main, size 170.....	1	...
4-042-190...	Jet, main, size 190.....	1	...

VALVES (CARBURETTER).

6-052 ...	Valve, throttle, size 6/3	1	...
29-047 ...	Spring, for throttle valve.....	1	...
4-063 ...	Screw, stop, for throttle valve	1	...
16-010 ...	Nut, lock, for throttle valve stop screw	1	...
6-045 ...	Valve, air	1	...
6-047 ...	Guide, tubular, for air valve spring	1	...
4-046 ...	Spring, for air valve	1	...

WHEN IN DOUBT REGARDING THE NAMES AND PART
NUMBERS OF THE PARTS YOU REQUIRE, PLEASE SEND
THE OLD PARTS TO SERVE AS PATTERNS.

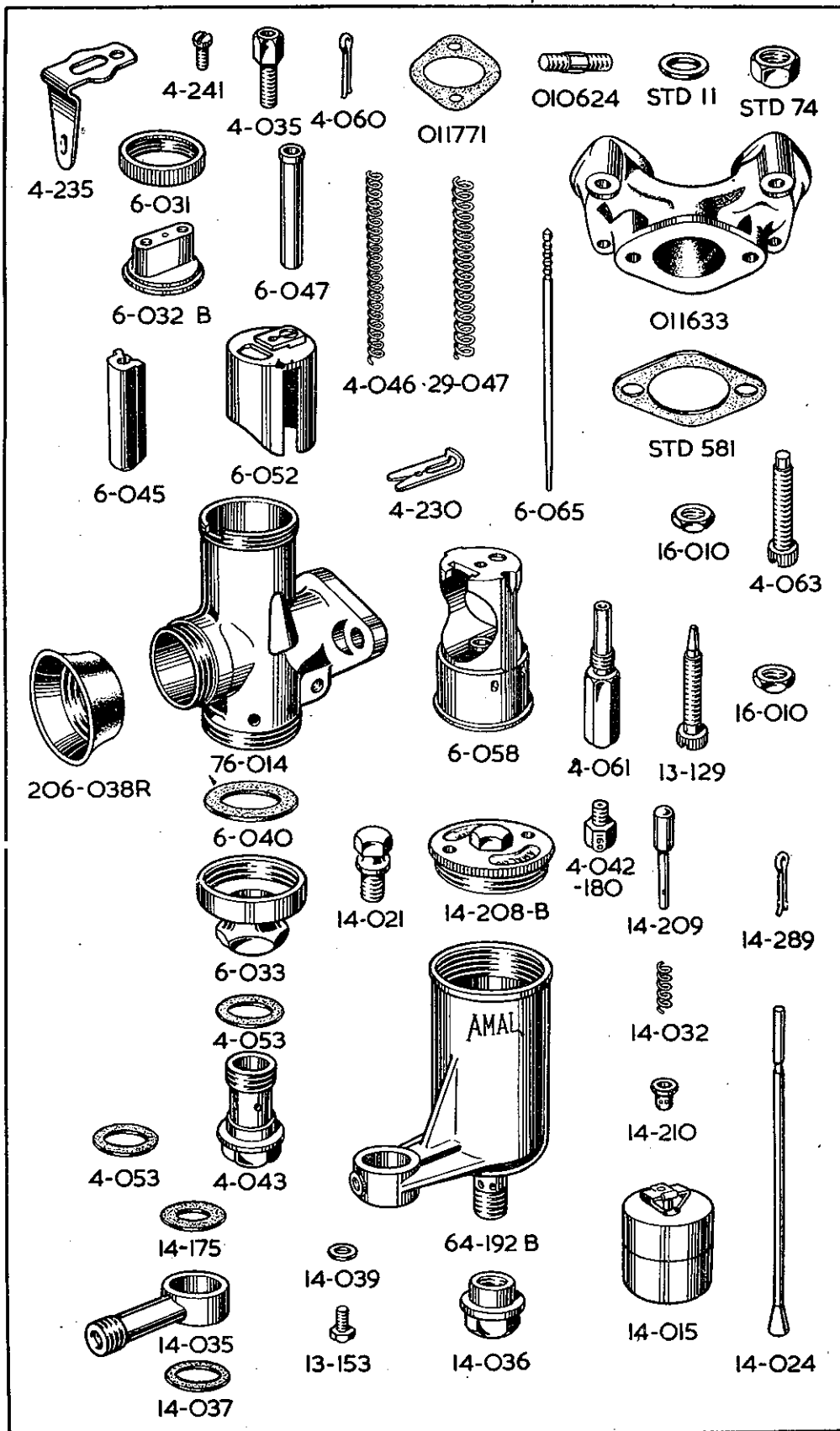

PART NUMBER.	DESCRIPTION.	QTY.	PRICE EACH £ s. d.
CRANKCASE BOLTS, WITH ENGINE PLATES AND ALL BOLTS PASSING THROUGH SAME.			
014292	Bolt, clamping crankcase throat, $3\frac{1}{16}$ in. by $\frac{5}{16}$ in. by 22. (These bolts pass through the driving side crankcase and thread into the timing side crankcase)	3 ...	
STD-11	Washer, plain, for 014292 crankcase bolts	3 ...	
013944	Plate, engine, front, right side	1 ...	
013943	Plate, engine, front, left side	1 ...	
014736	Stud, passing through crankcase and upper holes in engine front plates, 5 in. by $\frac{5}{16}$ in. by 26	1 ...	
	(This stud also supports the stays for the exhaust pipes)		
STD-174	Washer, plain, for 014736 engine plate stud	2 ...	
STD-192	Washer, spring, for 014736 engine plate stud	2 ...	
STD-4	Nut, for 014736 engine plate stud	2 ...	
STD-278	Stud, passing through crankcase and lower holes in engine front plates, $4\frac{9}{16}$ in. by $\frac{5}{16}$ in. by 26	1 ...	
STD-11	Washer, plain, for STD-278 engine plate stud	2 ...	
STD-4	Nut, for STD-278 engine plate stud	2 ...	
STD-277	Stud, passing through crankcase at bottom, $4\frac{3}{8}$ in. by $\frac{5}{16}$ in. by 26	1 ...	
STD-11	Washer, plain, for STD-277 crankcase stud	2 ...	
STD-4	Nut, for STD-277 crankcase stud	2 ...	
STD-303	Stud, passing through front of main frame and top of engine front plates, $4\frac{1}{2}$ in. by $\frac{3}{8}$ in. by 26	1 ...	
STD-10	Washer, plain, for STD-303 frame stud	2 ...	
STD-3	Nut, for STD-303 frame stud	2 ...	
014911	Stud, passing through main frame front tube bottom lug, the crankcase, and the front ends of the rear frame rails, $5\frac{1}{8}$ in. by $\frac{5}{16}$ in. by 26	1 ...	
STD-11	Washer, plain, for 014911 frame stud	2 ...	
STD-4	Nut, for 014911 frame stud	2 ...	
013942	Plate, engine, rear	2 ...	
STD-278	Stud, passing through top of engine rear plates and the crankcase, $4\frac{9}{16}$ in. by $\frac{5}{16}$ in. by 26	1 ...	
STD-278	Stud, passing through bottom of engine rear plates and the crankcase, $4\frac{9}{16}$ in. by $\frac{5}{16}$ in. by 26	1 ...	
STD-11	Washer, plain, for STD-278 studs (two per stud)	4 ...	
STD-4	Nut, for STD-278 studs (two per stud)	4 ...	
STD-316	Stud, passing through engine rear plates, rear of crank case, and centre of front chaincase, $7\frac{7}{16}$ in. by $\frac{7}{16}$ in. by 26. (Stud should be fitted so that the longer thread is on left hand side of machine)	1 ...	
014084	Spacer, $1\frac{1}{2}$ in. long, on STD-316 stud, between back of front chaincase and crankcase	1 ...	
35-2-C29	Spacer, $\frac{7}{8}$ in. long, on STD-316 stud, inside front chaincase ...	1 ...	
STD-220	Nut, thin, on STD-316 stud, inside front chaincase	1 ...	
STD-9	Washer, plain, for STD-316 stud	2 ...	
STD-2	Nut, for STD-316 stud	2 ...	
STD-303	Stud, passing through top of engine rear plates, lower end of main frame seat tube and rear fork bridge, $4\frac{1}{2}$ in. by $\frac{3}{8}$ in. by 26	1 ...	
STD-3	Nut, for STD-303 stud	2 ...	
STD-278	Stud, passing through rear fork bridge and back ends of engine rear plates, $4\frac{9}{16}$ in. by $\frac{5}{16}$ in. by 26	1 ...	
	(The front chain adjusting eye bolt block screws on the right hand end of this stud)		
STD-11	Washer, plain, for STD-278 stud	1 ...	
STD-4	Nut, for STD-278 stud	1 ...	

For the bolt and stud passing through the top and bottom of the gear box and the engine rear plates, see "Gear Box Fixing Bolts."

For the footrest rod, which passes through the bottoms of the engine rear plates and the frame rails, see "Footrests."

PART NUMBER.	DESCRIPTION.	QTY.	PRICE EACH £ s. d.
--------------	--------------	------	-----------------------

GASKETS.

We supply engine gaskets, either as separate spares, or in complete sets.

Single gaskets are listed in the groups to which they belong.

Gaskets in complete sets are listed below.

015870	...	Complete gasket set for vertical twin engine.....	1	...
015869	...	Decarbonising gasket set for vertical twin engine.....	1	...

Each complete gasket set contains :—

1	STD-183	Washer, fibre, for crankcase drain plug.
1	STD-183	Washer, fibre, for crankcase release valve pipe union.
1	STD-183	Washer, fibre, for oil relief valve plug.
1	011642	Washer, fibre, for engine filter housing cap.
1	011642	Washer, fibre, for oil distributor housing cap.
1	011642	Washer, fibre, for crankcase release valve housing cap.
2	011657	Washer, fibre, for banjo pin adaptors in crankcase.
1	STD-581	Gasket, between carburetter and inlet manifold.
2	011617	Washer, paper, for oil pump bodies.
2	011716	Washer, paper, for cylinder bases.
1	015034	Washer, paper, for oil filter chamber.
1	010339	Gasket, between magneto and crankcase.
2	011715	Gasket, for cylinder head.
2	011771	Gasket, between inlet manifold and cylinder head.
1	014141	Gasket, between dynamo and crankcase.
4	014411	Gasket, for rocker covers.

Each decarbonising gasket set includes :

2	011715	Gasket, for cylinder heads.
4	014411	Gasket, for rocker covers.
2	011771	Gasket, between inlet manifold and cylinder heads.
1	STD-581	Gasket, between carburetter and inlet manifold.
2	011716	Washer, paper, for cylinder bases.

EXHAUST PIPES AND SILENCERS.

014756	...	Pipe, exhaust, bare, left side	1	...
014758	...	Pipe, exhaust, bare, right side	1	...
014760	...	Baffle, for exhaust pipe	2	...
014754	...	Stay, for exhaust pipe, left side	1	...
014755	...	Stay, for exhaust pipe, right side	1	...
STD-4	...	Nut, fixing exhaust pipe to stay	2	...
STD-174	...	Washer, plain, for exhaust pipe fixing nut	2	...
014773	...	Silencer, bare, left side	1	...
014774	...	Silencer, bare, right side.....	1	...
20470	...	Clip, clamping silencer to pipe	2	...
STD-363	...	Bolt, for silencer clip, $\frac{3}{8}$ in. by $\frac{5}{16}$ in. by 26	2	...
STD-174	...	Washer, plain, for silencer clip bolt	2	...
STD-4	...	Nut, for silencer clip bolt	2	...
014747	...	Stay, for Silencer	2	...
STD-4	...	Nut, fixing silencer to stay.....	2	...
STD-174	...	Washer, plain, for silencer to stay fixing nut	2	...
STD-192	...	Washer, spring, for silencer to stay fixing nut	2	...
STD-4	...	Nut, fixing silencer stay to frame rail	2	...
STD-174	...	Washer, plain, for silencer stay to frame rail nut	2	...

ENGINE SPROCKETS.

015203	...	Sprocket, engine, bare, 19 teeth	1	...
015204	...	Sprocket, engine, bare, 20 teeth. (This is the standard sprocket)	1	...
014294	...	Sprocket, engine, bare, 21 teeth	1	...
014295	...	Spacer (collar), $\frac{3}{8}$ in. wide, for engine sprocket	1	...
010622	...	Cam, engine shock absorber	1	...
STD-702	...	Spring, engine shock absorber	1	...
010590	...	Cap, for engine shock absorber spring.....	1	...
011775	...	Bolt, locking engine shock absorber assembly, threaded $\frac{1}{2}$ in. by 20	1	...
010589	...	Washer, plain, for engine shock absorber locking bolt.....	1	...

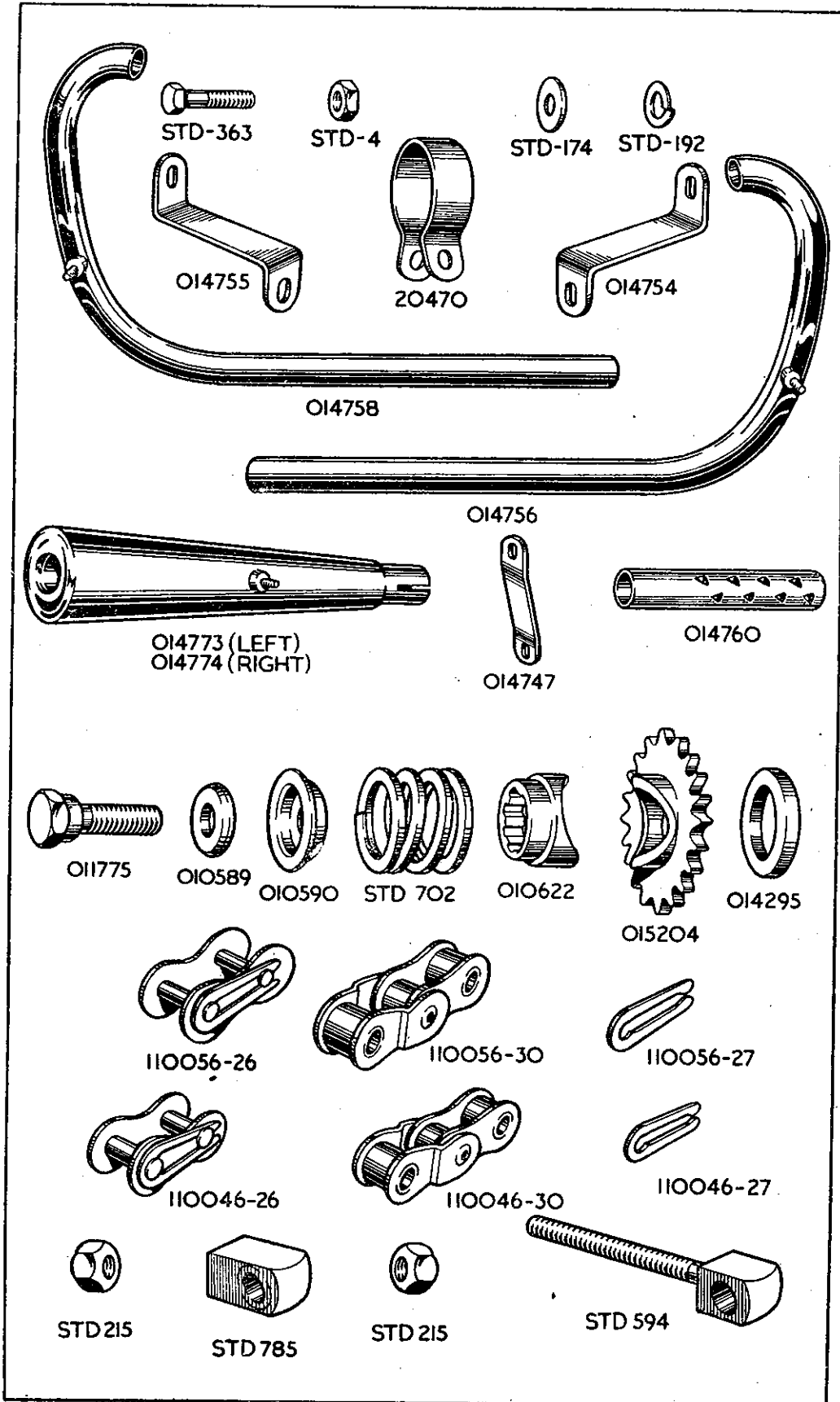

PART NUMBER	DESCRIPTION.	QTY.	PRICE EACH £ s. d.
-------------	--------------	------	-----------------------

CHAINS.

110046-67	... Chain, front, 67 links, $\frac{1}{2}$ in. by .305 in.....	1	...
110056-96	... Chain, rear, 96 links, $\frac{5}{8}$ in. by .380 in.	1	...
110046-26	... Link, connecting, for $\frac{1}{2}$ in. chains	R	...
110056-26	... Link, connecting, for $\frac{5}{8}$ in. chains	R	...
110046-30	... Link, cranked, double, for $\frac{1}{2}$ in. chains.....	R	...
110056-30	... Link, cranked, double, for $\frac{5}{8}$ in. chains.....	R	...
110046-27	... Clip, spring, for 110046-26 connecting links, ($\frac{1}{2}$ in.)	R	...
110056-27	... Clip, spring, for 110056-26 connecting links, ($\frac{5}{8}$ in.)	R	...

The prices of front and rear chains include spring connecting links and these are also included in the number of links per chain.

We do not sell odd lengths of chains.

GEAR BOX.

014556	... Gear box, complete, with clutch and with kick-starter and gear control levers	1	...
--------	---	---	-----

GEAR BOX FIXING BOLTS.

010957	... Stud, fixing gear box at top, $5\frac{3}{8}$ in. by $\frac{7}{16}$ in. by 26. (This is same stud as 39-G9-G59).....	1	...
STD-313	... Stud, fixing gear box at bottom, $4\frac{1}{8}$ in. by $\frac{7}{16}$ in. by 26.....	1	...
012999	... Spacer, $\frac{5}{16}$ in. long, on 010957 top stud, outside right position ...	1	...
011086	... Spacer, $\frac{1}{2}$ in. long, on 010957 top stud, inside left and right positions. (This is same as 39-G9-G61)	2	...
011086	... Spacer, $\frac{1}{2}$ in. long, on STD-313 bottom stud, inside left and right positions. (This is same as 39-G9-G61)	2	...
STD-2	... Nut, on 010957 top fixing stud	2	...
STD-2	... Nut, on STD-313 bottom fixing stud	2	...
STD-9	... Washer, plain, on left side of 010957 top fixing stud.....	1	...
STD-594	... Eye-bolt, for front chain adjustment.....	1	...
STD-215	... Nut, front chain adjustment eye-bolt	2	...
STD-785	... Block, crosshead, for front chain adjustment eye-bolt. (This threads on the right hand end of STD-278 stud that passes through the rear of the engine rear plates and the top of the rear fork bridge)	1	...

GEAR BOX SHELL.

1-CP-16	... Shell gear box, bare.....	1	...
60-X-6	... Stud, gear box shell, $1\frac{1}{8}$ in. by $\frac{5}{16}$ in.	2	...
60-X-9	... Stud, gear box shell, $3\frac{3}{8}$ in. by $\frac{5}{16}$ in.	2	...
60-X-1	... Stud, gear box shell, 1 in. by $\frac{1}{2}$ in.	2	...
152-X-1	... Nut, for $\frac{5}{16}$ in. gear box shell stud	4	...
63-X-1	... Nut, for $\frac{1}{4}$ in. gear box shell stud	2	...
348-X-1	... Plug, drain, for gear box shell	1	...
356-X-1	... Washer, drain plug	1	...
3-C-8	... Case, kick-starter.....	1	...
2-1C-2	... Washer, paper, for kick-starter case	1	...
286-X-1	... Stud, kick-starter case, $2\frac{1}{4}$ in. by $\frac{1}{4}$ in.	3	...
63-X-1	... Nut, for $\frac{1}{2}$ in. kick-starter case stud	3	...
4-C-15	... Cover for kick-starter case.....	1	...
4-1C-2	... Washer, paper, for kick-starter case cover	1	...
326-X-1	... Cap, filler, for kick-starter case cover	1	...
12-5-2	... Cap, in K/S case, for sector spindle bore	1	...
291-X	... Cap, in shell, covering bore of camshaft	1	...

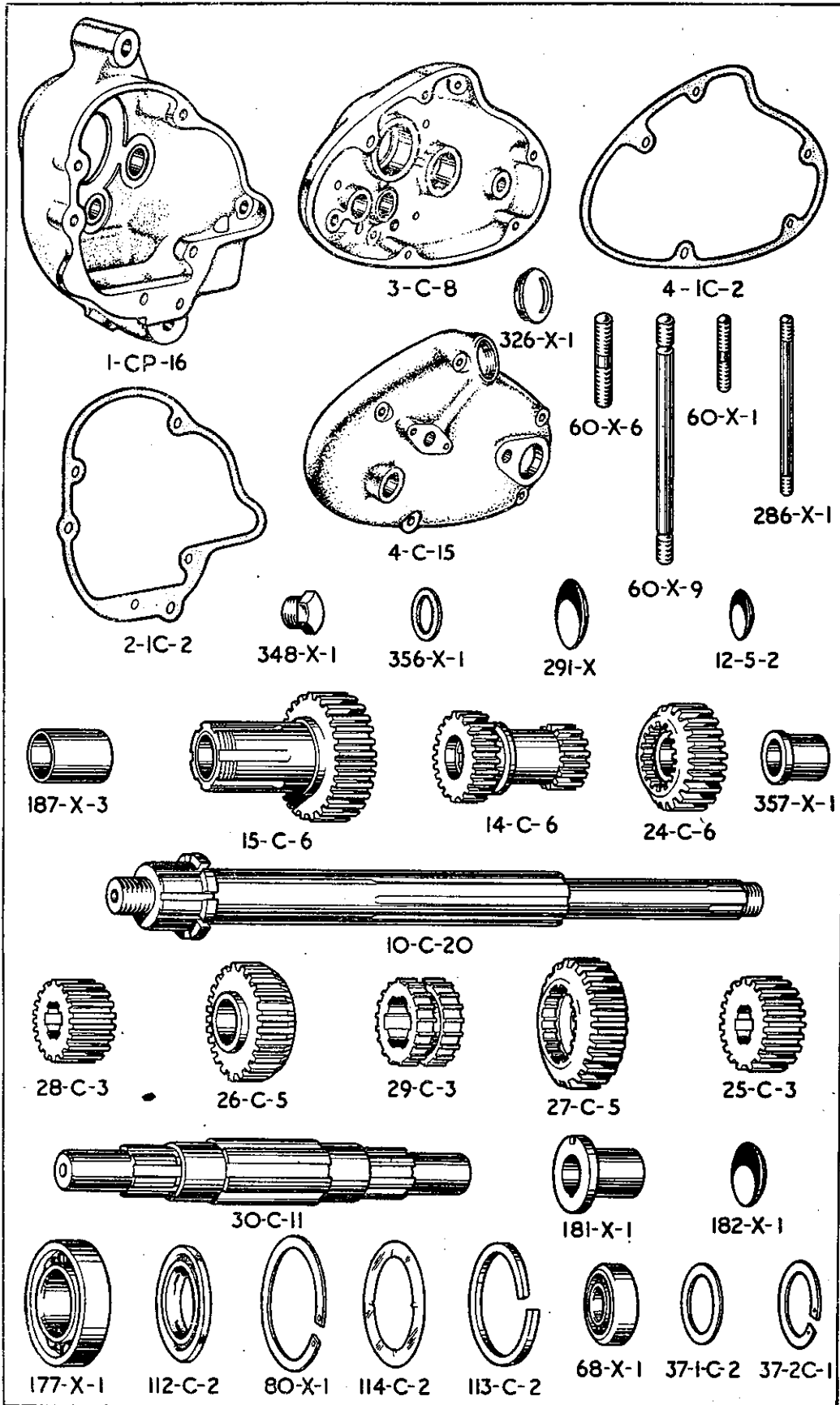

PART NUMBER	DESCRIPTION.	QTY.	PRICE EACH £ s. d.
-------------	--------------	------	-----------------------

SHAFTS AND GEARS.

10-C-20	Mainshaft, gear box, 10 $\frac{1}{4}$ in. overall length	1	...
15-C-6	Gear, driving, mainshaft, with bushes, 30 teeth	1	...
187-X-3	Bush, only, mainshaft driving gear	2	...
14-C-6	Gear, sliding, mainshaft, 18/23 teeth	1	...
24-C-6	Gear, third, on mainshaft, 27 teeth, with bush	1	...
357-X-1	Bush, for mainshaft third gear	1	...
30-C-11	Layshaft, gear box, with bushes	1	...
28-C-3	Gear, small, on layshaft, 20 teeth	1	...
27-C-5	Gear, first, on layshaft, 32 teeth	1	...
26-C-5	Gear, second, on layshaft, 27 teeth	1	...
25-C-3	Gear, third, on layshaft, 23 teeth	1	...
29-C-3	Clutch, sliding on layshaft	1	...

GEAR BOX BEARINGS.

177-X-1	Ball bearing, driving gear (10)	1	...
112-C-2	Oil seal, main driving gear bearing, rubber	1	...
80-X-1	Ring, split, retaining bearing in shell	1	...
114-C-2	Washer, outer, driving gear bearing (11)	2	...
113-C-2	Ring, split, retaining bearing outer washer	1	...
68-X-1	Ball bearing, mainshaft, K-S end (12)	1	...
37-1-C-2	Washer, mainshaft ball bearing K-S end (13)	1	...
37-2-C-1	Ring, split, retaining mainshaft ball bearing K-S end	1	...
181-X-1	Bush for layshaft	2	...
182-X-1	Cap, covering layshaft bush in gear box shell	1	...
87-X	Pin dowel, for layshaft bush	2	...

NOTE 10.—Dimensions 1 $\frac{2}{32}$ in. by 62 mm. by 16 mm. (177-X-1).

NOTE 11.—Dimensions 1 $\frac{5}{16}$ in. by 2 $\frac{7}{16}$ in. (114-C-2).

NOTE 12.—Dimensions 12 mm. by 40 mm. by 17 mm. (68-X-1).

NOTE 13.—Dimensions 1 $\frac{1}{4}$ in. by 1 $\frac{7}{16}$ in. (37-1-C-2).

GEAR OPERATING PARTS.

42-C-1	Fork operating mainshaft sliding gear	1	...
43-C-1	Fork, operating layshaft sliding clutch	1	...
157-X-1	Peg, operating layshaft sliding clutch	2	...
158-X-1	Pin, split, operating fork peg	2	...
45-C-2	Camshaft, bare, for gear box	1	...
192-X-1	Rollers for camshaft	per set of 12	...
159-X-1	Bush, for camshaft, in gear box shell	1	...
163-X-2	Pawl, engages in gear box camshaft	1	...
164-X-1	Pin, bearing, for camshaft pawl	1	...
95-X-1	Nut, for camshaft pawl bearing pin	1	...
193-X-1	Spring, for camshaft pawl	1	...
98-X-1	Plug, screwed, retaining camshaft pawl spring	1	...
162-X-3	Quadrant, gear selection	1	...
161-X-2	Sector, gear selection, engages camshaft	1	...
CO-51-6	Ratchet, gear selection	1	...
CO-51-6-A	Quadrant, sector and ratchet, assembled	1	...
CO-96-1	Rivet, fixing camshaft sector to quadrant	2	...
CO-96-2	Rivet, fixing camshaft ratchet to quadrant	1	...
CO-90-3	Spindle, for gear selection quadrant	1	...
287-X-1	Nut (inside), gear selection quadrant spindle	1	...
CO-91-1	Bush, in kick-starter case, for control spindle	1	...
160-X-2	Bush, in kick-starter case, for camshaft	1	...
CO-53-4	Quadrant, for foot gear control	1	...
CO-94-2	Sleeve, for foot gear control quadrant	1	...
CO-62-1	Peg, for gear indexing pawl	2	...
CO-53-4-A	Quadrant, assembled with sleeve and peg	1	...
CC-54-14	Bush, for foot control quadrant sleeve	1	...
CO-95-1	Bolt, fixing quadrant sleeve bush in K-S cover	1	...
CO-52-5	Pawl, indexing, for foot gear control	1	...

PART NUMBER	DESCRIPTION.	QTY.	PRICE EACH £ s. d.
----------------	--------------	------	--------------------------

GEAR OPERATING PARTS—Continued.

CO-49-5	Box, spring, for foot gear control.....	1	...
CO-56-4	Plate, cover, for foot gear control spring box.....	1	...
CO-66-1	Spring, main, for control box (large spring)	2	...
CO-67-1	Spring, pawl, for control box (small spring)	2	...
CO-59-1	Plate, for control box main spring.....	2	...
CO-58-1	Plate, for control box pawl spring.....	2	...

GEAR CONTROL PARTS.

CO-97-1	Indicator, gear, fixed.....	1	...
CO-97-2	Indicator, gear, moving.....	1	...
CO-105-1	Bolt, retaining moving gear indicator.....	1	...
CO-92-1	Lever, foot, gear control.....	1	...
CO-63-3	Bolt, clamping gear foot lever to sleeve.....	1	...
10-X-1	Nut, for gear foot lever clamping bolt.....	1	...
OS-52-1	Washer, foot lever clamping bolt.....	1	...
CO-82-2	Pad, rubber, foot control lever.....	1	...
CO-38-2	Pin fixing control lever rubber pad.....	1	...
27-7-2	Washer, felt, inserted in control spindle bush (14).....	1	...
27-8-3	Washer, felt, fits in recess in foot change lever (15).....	1	...

NOTE 14.— $\frac{17}{32}$ in. inside diameter.
 $\frac{5}{8}$ in. outside diameter.
 $\frac{1}{8}$ in. thick.

NOTE 15.— $\frac{13}{16}$ in. inside diameter.
1 in. outside diameter.
 $\frac{1}{8}$ in. thick.

GEAR BOX SMALL SPROCKET.

179-X-7	Sprocket, gear box, 16 teeth.....	1	...
180-X-8	Collar, spacing, gear box sprocket, $\frac{7}{16}$ in. thick.....	1	...
176-X-1	Nut, fixing gear box sprocket to main gear.....	1	...
206-X-1	Collar, spacing, under gear box sprocket, $\frac{3}{16}$ in. thick.....	1	...
210-X-1	Washer, lock, gear box sprocket nut.....	1	...

CLUTCH.

1-X-10	Case, for clutch (for five plates).....	1	...
OF-33-3	Rivet, for clutch case and chainwheel.....	8	...
7-X-A-5	Chainwheel and clutch case, assembled.....	1	...
7-X-28	Chainwheel, bare, 40 teeth.....	1	...
34-X-2	Race, roller, clutch sprocket bearing.....	1	...
35-X	Rollers, clutch sprocket bearing, per set.....	24	...
36-X-2	Washer, thin, clutch sprocket bearing.....	1	...
36-X-3	Washer, thick, clutch sprocket bearing.....	1	...
2-X-17	Centre for five plate clutch.....	1	...
69-X-2	Nut, retaining centre to mainshaft.....	1	...
349-X-3	Washer, lock, for centre retaining nut.....	1	...
71-X	Washer, plain, for centre retaining nut.....	1	...
6-X-5	Plate, clutch, plain, steel, thick.....	6	...
3-X-2	Plate, clutch, friction, with inserts.....	5	...
4-X-2	Inserts, fabric, for friction plate, per dozen.....	120	...
18-X-11	Plate, spring pressure, for clutch.....	1	...
303-X	Thrust cap, for spring plate.....	1	...
21-X-3	Spring, for clutch.....	5	...
22-X-2	Cup, for clutch spring.....	5	...
24-X-12	Stud, for clutch spring, five plate clutch.....	4	...
23-X-3	Nut, adjusting, for clutch spring.....	5	...

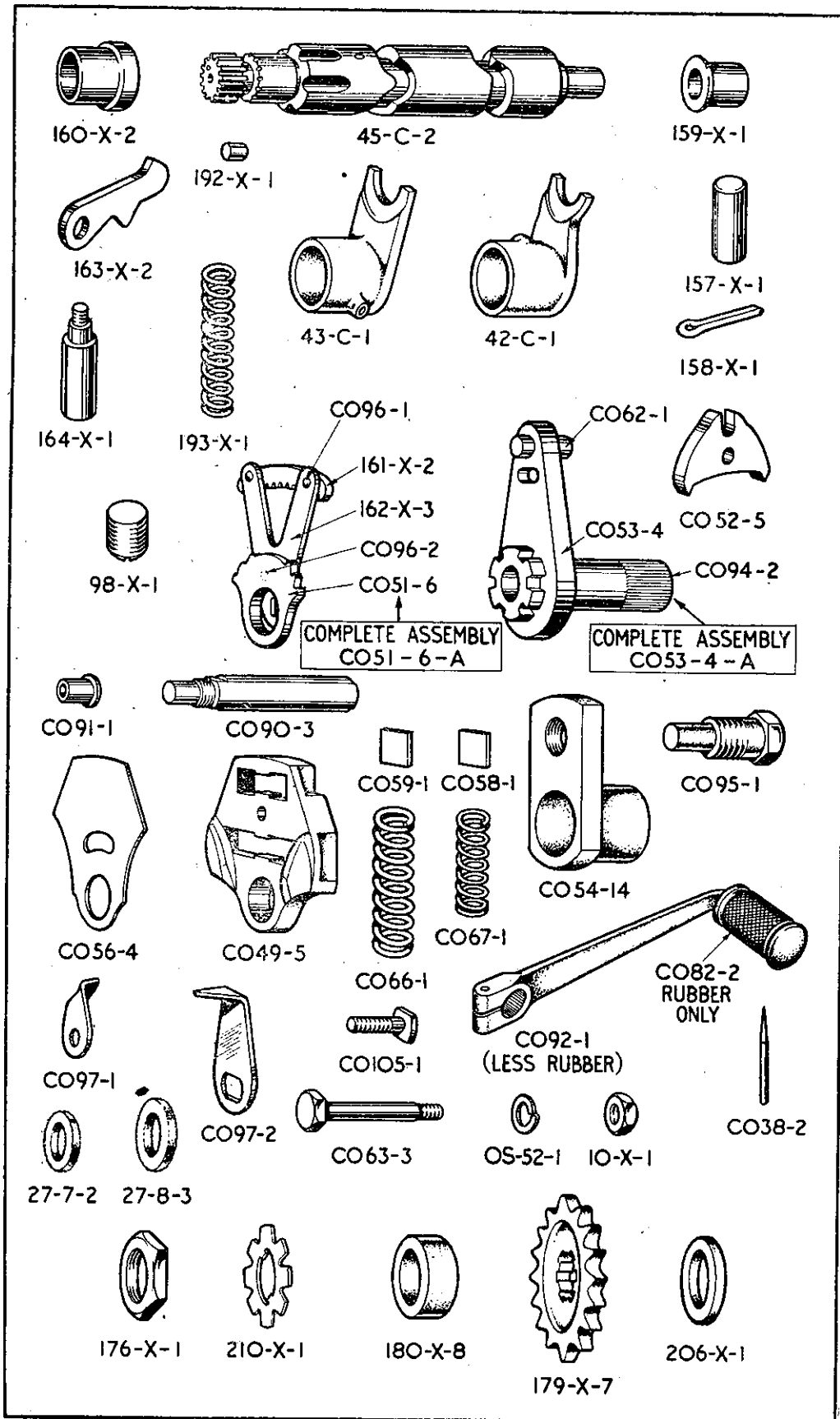

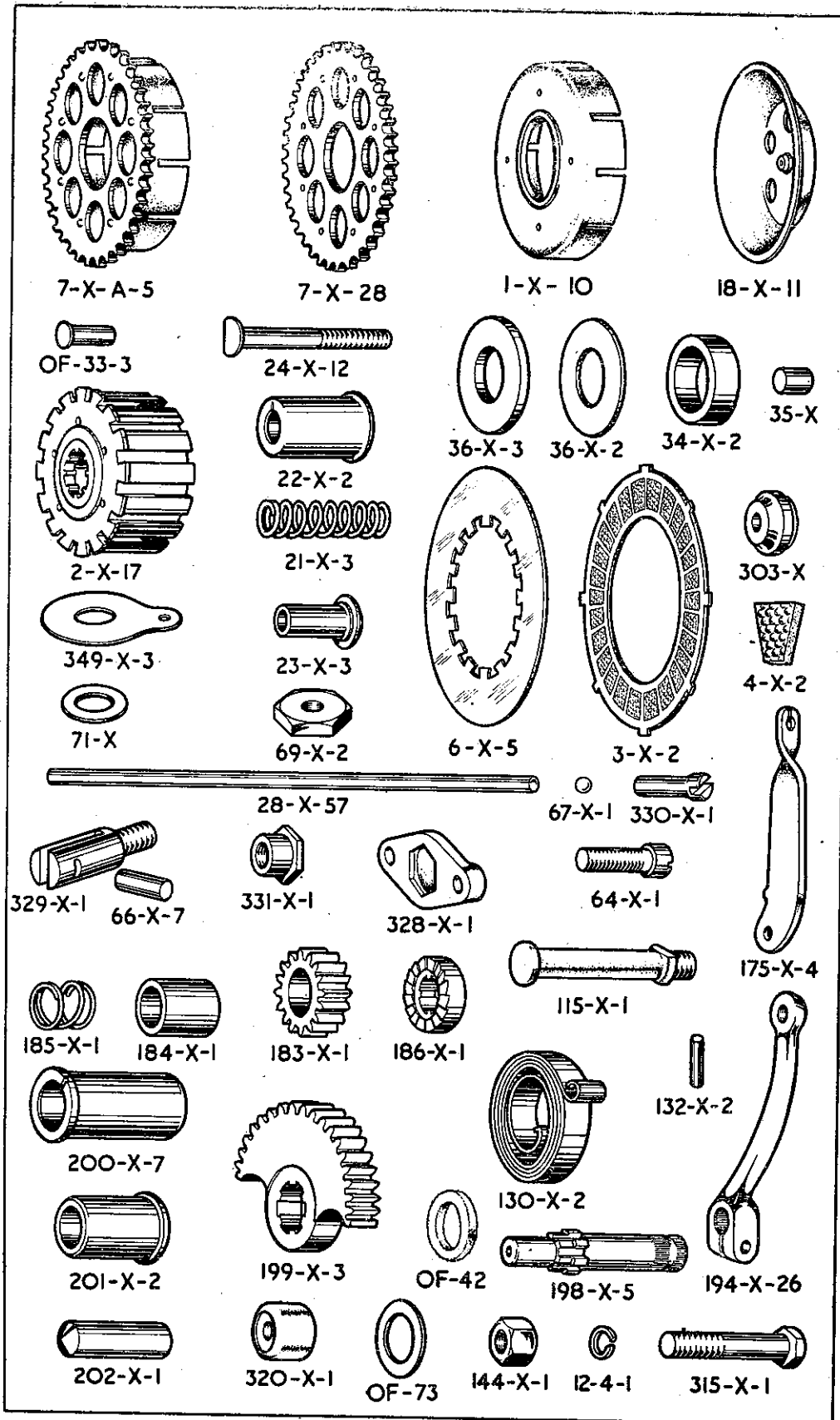

PART NUMBER	DESCRIPTION.	QTY.	PRICE EACH £ s. d.
-------------	--------------	------	-----------------------

CLUTCH OPERATING PARTS.

28-X-57	Rod, thrust, for five plate clutch, 10 $\frac{1}{8}$ in.	1	...
330-X-1	Plunger, clutch operating	1	...
67-X-1	Ball, steel, for clutch operating plunger	1	...
175-X-4	Lever, clutch operating	1	...
66-X-7	Pin, for clutch operating lever	1	...
329-X-1	Fork, for clutch operating lever	1	...
331-X-1	Sleeve, for clutch operating lever fork	1	...
328-X-1	Cap, covering clutch operating lever fork sleeve	1	...
64-X-1	Screw, fixing sleeve cap to kick-starter case cover	2	...

KICK-STARTER.

186-X-1	Ratchet, driving, kick-starter	1	...
183-X-1	Pinion, ratchet, kick-starter	1	...
184-X-1	Bush, kick-starter ratchet pinion	1	...
185-X-1	Spring, kick-starter ratchet pinion	1	...
70-X-1	Nut, retaining driving ratchet to mainshaft	1	...
198-X-5	Spindle, for kick-starter quadrant and foot lever	1	...
201-X-2	Bush, in K-S case, for K-S quadrant spindle	1	...
200-X-7	Bush, in K-S case cover, for K-S quadrant spindle	1	...
199-X-3	Quadrant, for kick-starter spindle	1	...
199-X-3-A-49	Kick-starter quadrant and spindle, assembled	1	...
130-X-2	Spring, return, for kick-starter foot lever	1	...
132-X-2	Pin, anchor, for kick-starter return spring	1	...
320-X-1	Stop, rubber, and sleeve, for K-S quadrant	1	...
202-X-1	Peg, for K-S stop rubber and sleeve	1	...
194-X-26	Lever, foot, kick-starter, bare	1	...
115-X-1	Pin, pedal, for kick-starter foot lever	1	...
315-X-1	Bolt, clamping K-S foot lever to spindle	1	...
144-X-1	Nut, for K-S foot lever clamping bolt	1	...
12-4-1	Washer, spring, on K-S lever bolt	1	...
OF-42	Washer, felt, on K-S spindle	1	...
OF-73	Washer, plain, retains felt washer on K-S spindle	1	...

FRONT FRAME.

013772	Frame, front portion only, bare	1	...
STD-806	Race, ball, for frame head lug	2	...
STD-72	Balls, $\frac{3}{8}$ in. diameter, for steering head, per set of	56	...
STD-51	Nipple, grease, for frame head lug	1	...
014478	Stud, for seat lug (below saddle), 4 $\frac{7}{8}$ in. by $\frac{1}{2}$ in. by 26	1	...
STD-8	Washer, plain, for seat lug stud	2	...
STD-1	Nut, for seat lug stud	2	...
STD-15	Screw, securing earth wires (screws into end of stud 014478) $\frac{3}{8}$ in. by 3 B.A.	1	...
STD-185	Washer, plain, for STD-15 earth wire screw	1	...

REAR FRAME.

014359	Rail, frame, right side	1	...
014360	Rail, frame, left side	1	...
014420	Loop, rear frame	1	...
014512	Stud, for rear loop at bottom, 12 in. by $\frac{7}{8}$ in. by 26 (Also passes through rear fork bridge and both frame rails)	1	...
STD-2	Nut, for rear loop bottom stud	2	...
STD-9	Washer, plain, for rear loop bottom stud	2	...
014879	Tube, supporting rear of rear mudguard, right side	1	...
014880	Tube, supporting rear of rear mudguard, left side	1	...
STD-343	Bolt, fixing mudguard support tube to frame loop, $\frac{1}{8}$ in. by $\frac{1}{4}$ in. by 26	4	...
STD-12	Washer, plain, for mudguard support tube bolt	4	...
STD-191	Washer, spring, for mudguard support tube bolt	4	...
STD-5	Nut, for mudguard support tube bolt	4	...
015329	Bridge, for rear fork (includes bushes and studs for centre stand spring clip)	1	...
014672	Bush, for rear fork bridge	2	...
STD-250	Stud, for rear fork bridge $\frac{3}{8}$ in. by 2 B.A.	2	...

PART NUMBER.	DESCRIPTION.	QTY.	PRICE EACH £ s. d.
REAR FORK.			
014307	Fork, rear	1	...
011372	Pin, chain adjusting, for right fork end	1	...
011373	Nut, lock, for chain adjusting pin	1	...
014746	Sleeve, assembly (bushed)	2	...
010116	Tube	1	...
010095	Cap, for rear fork bearing, right side	1	...
010096	Cap, for rear fork bearing, left side	1	...
010093	Washer, felt, for rear fork bearing	2	...
010098	Gasket, for rear fork bearing caps	2	...
010094	Spoke, for rear fork bearing (central tie bolt)	1	...
012472	Nipple, for rear fork bearing spoke	1	...
015189	Screw, plug, for oil, in end cap	1	...
STD-203	Washer, fibre, for oil plug screw	1	...

TELEDRAULIC REAR LEG.

014477	Leg, TELEDRAULIC, rear, complete assembly (This assembly includes all the remaining items, except the final six, listed in this group)	2	...
015408	Pivot, top assembled (This assembly includes the next five items)	2	...
013872	Pivot, top, bare	2	...
012341	Bush, rubber, for top pivot	4	...
014912	Spacer, for top pivot rubber bush, $\frac{1}{2}$ in. long	4	...
013332	Plug, filling, for top pivot	2	...
012116	Washer, fibre, for top pivot filling plug	2	...
015409	Pivot, bottom, assembled (This assembly includes the next three items)	2	...
014821	Pivot, bottom, bare	2	...
012341	Bush, rubber, for bottom pivot	4	...
014912	Spacer, for bottom pivot rubber bush, $\frac{1}{2}$ in. long	4	...
011945	Spring, suspension, for rear leg	2	...
014358	Spacer, under rear leg spring	2	...
012119	Tube, cover, top, for rear leg spring	2	...
012120	Tube, cover, bottom, for rear leg spring	2	...
014609	Tube, top, for rear leg damper	2	...
014297	Washer, composition, for rear leg damper tube	2	...
014820	Piston, for rear leg damper	2	...
015306	Washer, "Fan Disc," for underside of damper piston	2	...
014669	Shuttle, for rear leg damper	2	...
015701	Bush, plastic, upper, for rear leg damper tube	2	...
015702	Bush, plastic, lower, for rear leg damper tube	2	...
015703	Ring, sealing, between damper tube plastic bushes	2	...
014313	Pin, locating damper tube shuttle	2	...
012132	Oil-seal, for rear leg damper tube	2	...
012131	Cap, screwed, securing rear leg damper oil-seal	2	...
012123	Tube, bottom, for rear leg damper	2	...
012124	Ring, carrier, located on bottom tube by 012125 dowel pin	2	...
012125	Pin, dowel, locating ring 012124	2	...
012126	Washer, fibre, under rear leg bottom damper tube	2	...
014521	Bolt, fixing top pivot, $3\frac{1}{2}$ in. by $\frac{3}{8}$ in. by 26	2	...
STD-10	Washer, plain, for top pivot bolt	4	...
STD-3	Nut, for top pivot bolt	2	...
STD-407	Bolt, fixing bottom pivot, $1\frac{1}{8}$ in. by $\frac{3}{8}$ in. by 26	2	...
STD-10	Washer, plain, for bottom pivot bolt	4	...
STD-73	Nut, for bottom pivot bolt	2	...

FRONT FORKS. (Assemblies).

015865	Fork, assembly (TELEDRAULIC Front Fork)	1	...
--------	---	---	-----

A "front fork assembly" comprises all the parts listed in the "FRONT FORK" group. For ease of servicing, the inner tube unit is listed, and supplied, as a separate assembly. This enables a complete assembly to be exchanged in minimum time. The unit is listed below.

015867	Front fork inner tube assembly	2	...
--------	--------------------------------	---	-----

The above assembly comprises all those parts in the "FRONT FORK" group that are marked "A."

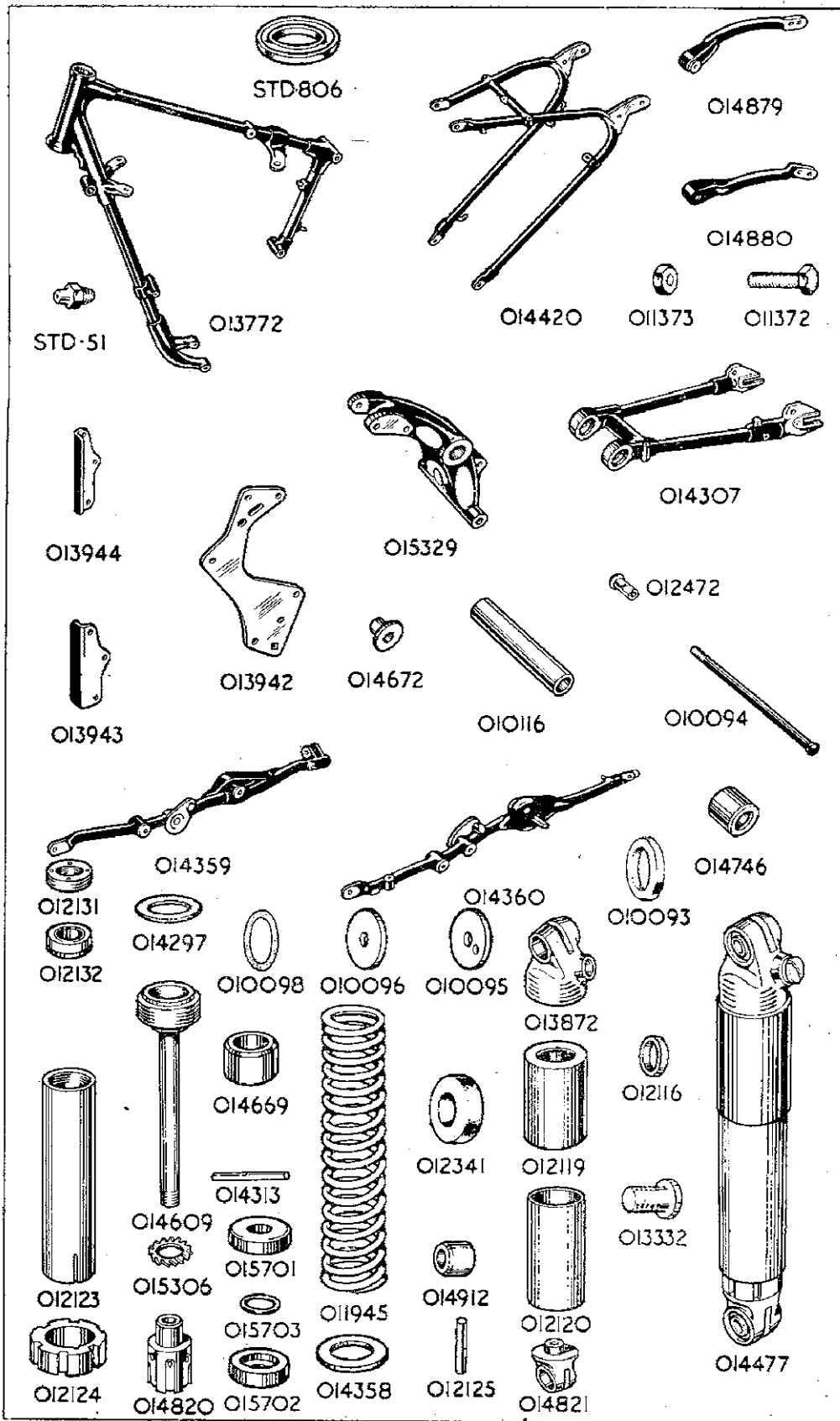

PART NUMBER.	DESCRIPTION.	QTY.	PRICE EACH £ s. d.
FRONT FORK.			
013861	Crown, assembly, comprising crown, stem, circlip and two 014816 studs. (Components not sold as separate spares).....	1	...
STD-805	Race, ball, for fork crown.....	1	...
014816	Stud, pinch, for fork crown, $2\frac{9}{32}$ in. by $\frac{5}{16}$ in. by 26.....	2	...
STD-11	Washer, plain, for fork crown pinch stud.....	2	...
011635	Nut, for fork crown pinch stud.....	2	...
013631	Lug, for handlebar and steering head.....	1	...
012620	Race, ball, for handlebar lug.....	1	...
STD-51	Nipple, grease, for handlebar lug.....	1	...
STD-236	Nut, adjusting, for fork crown stem.....	1	...
L4-FF46	Nut, lock (domed), for fork crown stem.....	1	...
013348	Tube, fork, inner.....	A	2
38-G4-E368	Buffer, rubber, for fork inner tube.....	A	6
40-G12M-FF191	Bush, bottom, for fork inner tube.....	A	2
40-G12M-FF192	Circlip, for fork inner tube bush.....	A	2
014354	Bolt, top, for fork inner tube.....	A	2
014355	Ring, sealing, for fork inner tube top bolt.....	A	2
40-G12M-FF190	Washer, plain, for fork inner tube top bolt.....	A	2
013632	Slider, fork, with cap, studs and nuts, left and right.....	2	...
013509	Cap, for fork slider.....	2	...
014341	Extension, for fork slider.....	A	2
40-G12M-FF41	Bush, plastic, for fork inner tube.....	A	2
40-G12M-FF91	Oil-seal, for fork inner tube.....	A	2
015002	Spring, main, for front fork.....	A	2
011126	Spring, buffer, for front fork.....	A	2
40-G12M-FF126	Washer, leather, fork spring seating.....	A	4
013695	Tube, fork cover, top, left, with lamp lug.....	1	...
013694	Tube, fork cover, top, right, with lamp lug.....	1	...
40-G12M-FF186	Cap, for top of fork top cover tube.....	2	...
012569	Cap, for bottom of fork top cover tube.....	2	...
40-G12M-FF128	Plate, threaded, locating top cover tube.....	2	...
41-G3L-FF184-B	Tube, fork cover, bottom.....	2	...
40-G12M-FF127	Plate, plain, locating bottom cover tube.....	2	...
40-G12M-FF129	Screw, retaining both locating plates, $1\frac{9}{16}$ in. by 3 B.A.....	6	...
STD-485	Screw, plug, oil drain, for fork slider, $\frac{1}{4}$ in. by $\frac{1}{4}$ in. by 26.....	2	...
STD-203	Washer, fibre, for fork slider screw oil plug.....	2	...
013347	Shuttle, for fork damper.....	A	2
012954	Cone, for fork damper.....	2	...
40-G12M-FF94	Bolt, fixing fork damper cone to slider.....	2	...
40-G12M-FF80	Washer, fibre, for damper cone bolt.....	2	...
40-G12M-FF195	Stud, securing fork slider cap, $1\frac{3}{8}$ in. by $\frac{5}{8}$ in. by 26 and 22 ...	4	...
STD-11	Washer, plain, for fork slider cap stud.....	4	...
STD-4	Nut, for fork slider cap stud.....	4	...

STEERING DAMPER

(This is an optional extra).

013457	Damper, steering, complete set of parts.....	1	...
TFF-101-S	Knob, control, for steering damper.....	1	...
STD-162	Washer, ratchet, for steering damper knob.....	1	...
STD-195	Washer, spring, for steering damper knob.....	1	...
010808	Cap, for top of steering stem.....	1	...
010807	Drawbolt for steering damper.....	1	...
015137	Sleeve, assembly, lower end of drawbolt.....	1	...
STD-73	Nut, locking sleeve to drawbolt.....	1	...
STD-344	Bolt, fixing sleeve assembly, $\frac{3}{8}$ in. by $\frac{1}{4}$ in. by 26.....	1	...
015131	Spacer, $\frac{1}{2}$ in. long, for bolt STD-344.....	1	...
STD-191	Washer, spring, for bolt STD-344.....	1	...
STD-12	Washer, plain, for bolt STD-344.....	1	...
STD-5	Nut, for bolt STD-344.....	1	...
40-G12M-FF97	Plate, anchor, top position.....	1	...
STD-70	Bolt, fixing top anchor plate, $\frac{9}{16}$ in. by $\frac{1}{4}$ in. by 26.....	1	...
STD-191	Washer, spring, for top anchor plate bolt.....	1	...
STD-812	Washer, fibre, friction, for steering damper.....	2	...
STD-236	Nut, lock, for fork crown stem. (This replaces the domed lock nut, L4-FF46, when a steering damper is fitted).....	1	...

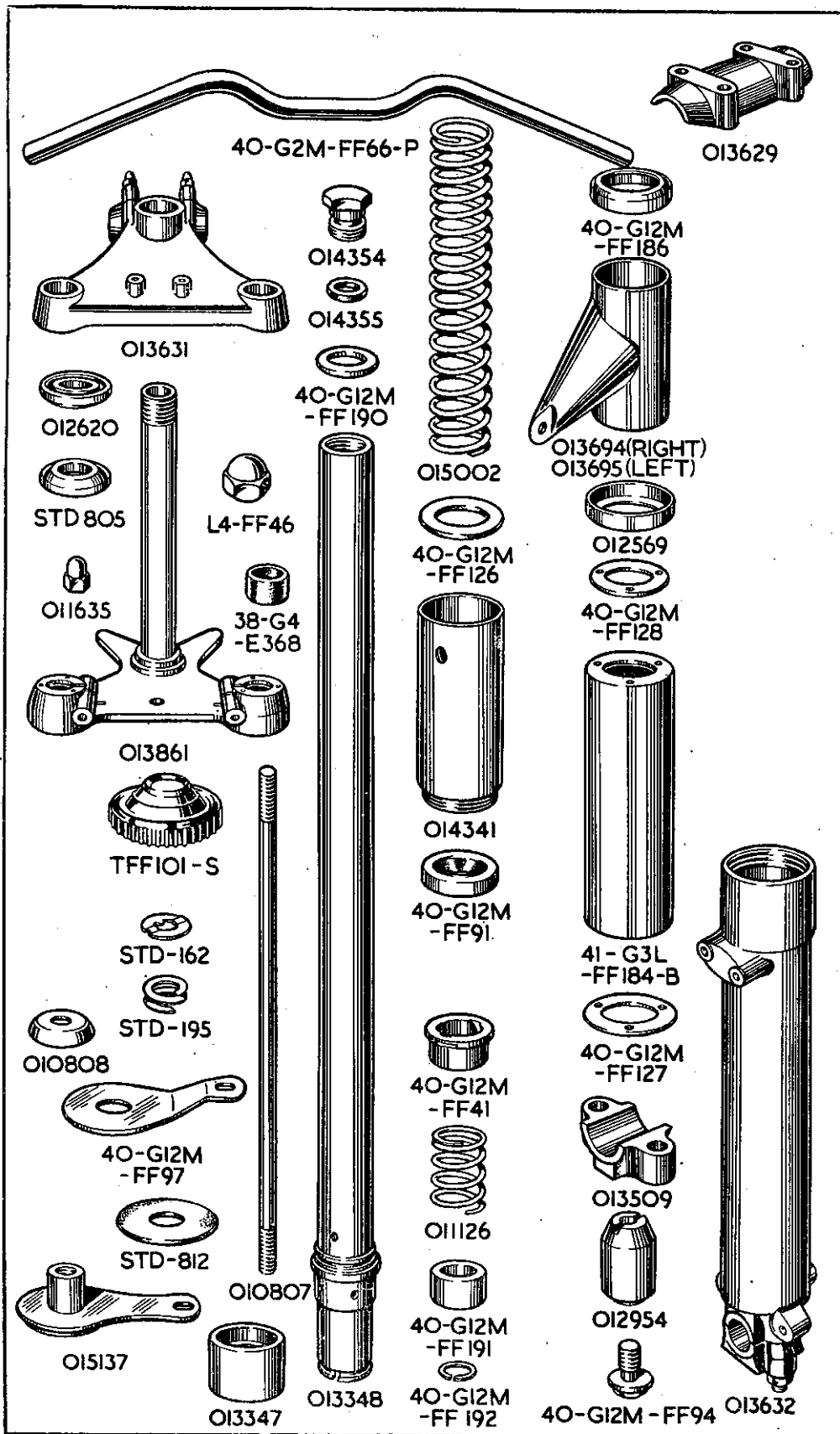

PART NUMBER.	DESCRIPTION.	QTY.	PRICE EACH £ s. d.
--------------	--------------	------	-----------------------

HANDLEBAR.

40-G2M-FF66-P ...	Handlebar, bare.....	1	...
013629 ...	Clip (half only), for handlebar lug.....	1	...
012870 ...	Stud, for handlebar clip, $1\frac{1}{2}$ in. by $\frac{1}{4}$ in. by 26 and 20	4	...
STD-12 ...	Washer, plain, for handlebar clip stud	4	...
014278 ...	Nut, for handlebar clip stud.....	4	...

FRONT STAND.

011286 ...	Stand, front, bare.....	1	...
41-G3L-FF422 ...	Bolt, fixing front stand to slider, $1\frac{3}{8}$ in. by $\frac{5}{16}$ in. by 22.....	2	...
HBD-52 ...	Washer, spring, for stand to slider bolt.....	2	...
STD-14 ...	Pin, split, for stand to slider bolt.....	2	...
STD-342 ...	Bolt, fixing front stand to front mudguard, $\frac{1}{16}$ in. by $\frac{1}{2}$ in. by 26	1	...
STD-12 ...	Washer, plain, for stand to mudguard bolt.....	2	...
STD-5 ...	Nut, front stand to mudguard bolt.....	1	...
014278 ...	Nut, (domed), front stand to mudguard bolt	1	...

PROP STAND.

014719 ...	Stand, prop, bare.....	1	...
014713 ...	Bolt, hinge, for prop stand.....	1	...
STD-49 ...	Pin, split, for prop stand hinge bolt	1	...
014139 ...	Nut, for prop stand hinge bolt	1	...
014991 ...	Spring, return, for prop stand.....	1	...

CENTRE STAND.

014450 ...	Stand, centre, bare.....	1	...
014626 ...	Bush, for centre stand.....	2	...
014629 ...	Stud, hinge, for centre stand, $8\frac{1}{8}$ in. by $\frac{7}{16}$ in. by 26.....	1	...
014630 ...	Spacer, central, 4.2 in. long, for centre stand hinge stud.....	1	...
013837 ...	Spacer, outer, right side, .993 in. long for centre stand hinge stud	1	...
010911 ...	Spacer, outer, left side, .8 in. long for centre stand hinge stud ..	1	...
010912 ...	Washer, spigot, for centre stand hinge stud.....	2	...
STD-2 ...	Nut, for centre stand hinge stud.....	2	...
014627 ...	Spring, return, for centre stand.....	1	...
014628 ...	Spring, stop, for centre stand.....	1	...
STD-80 ...	Nut, for centre stand stop spring (The studs on which these nuts fit, are listed with the Rear Fork bridge).....	2	...
STD-39 ...	Washer, plain, for centre stand stop spring fixing nuts.....	2	...

FRONT MUDGUARD.

014957 ...	Mudguard, front, bare.....	1	...
41-G3L-M38 ...	Bolt, fixing mudguard bridge to right fork slider, $\frac{1}{2}$ in. by $\frac{5}{16}$ in. by 22	2	...
STD-192 ...	Washer, spring, for bridge right fixing bolt.....	2	...
015000 ...	Stud, fixing mudguard bridge to left fork slider, also retains brake anchor stay and bracket for brake cable adjuster, 1 in. by $\frac{5}{16}$ in. by 26 and 22.....	2	...
014117 ...	Washer, plain, for bridge left fixing stud.....	2	...
STD-4 ...	Nut, for bridge left fixing stud.....	2	...
015015 ...	Stay, for front mudguard.....	1	...
41-G3L-M38 ...	Bolt, fixing front mudguard stay to fork slider, $\frac{1}{2}$ in. by $\frac{5}{16}$ in. by 22	2	...
STD-192 ...	Washer, spring, for stay to fork slider bolt.....	2	...
STD-70 ...	Bolt, fixing stay to front mudguard, $\frac{9}{16}$ in. by $\frac{1}{4}$ in. by 26.....	2	...
STD-191 ...	Washer, spring, for stay to front mudguard bolt.....	2	...
STD-12 ...	Washer, plain, for stay to front mudguard bolt.....	2	...
STD-5 ...	Nut, for stay to front mudguard bolt.....	2	...

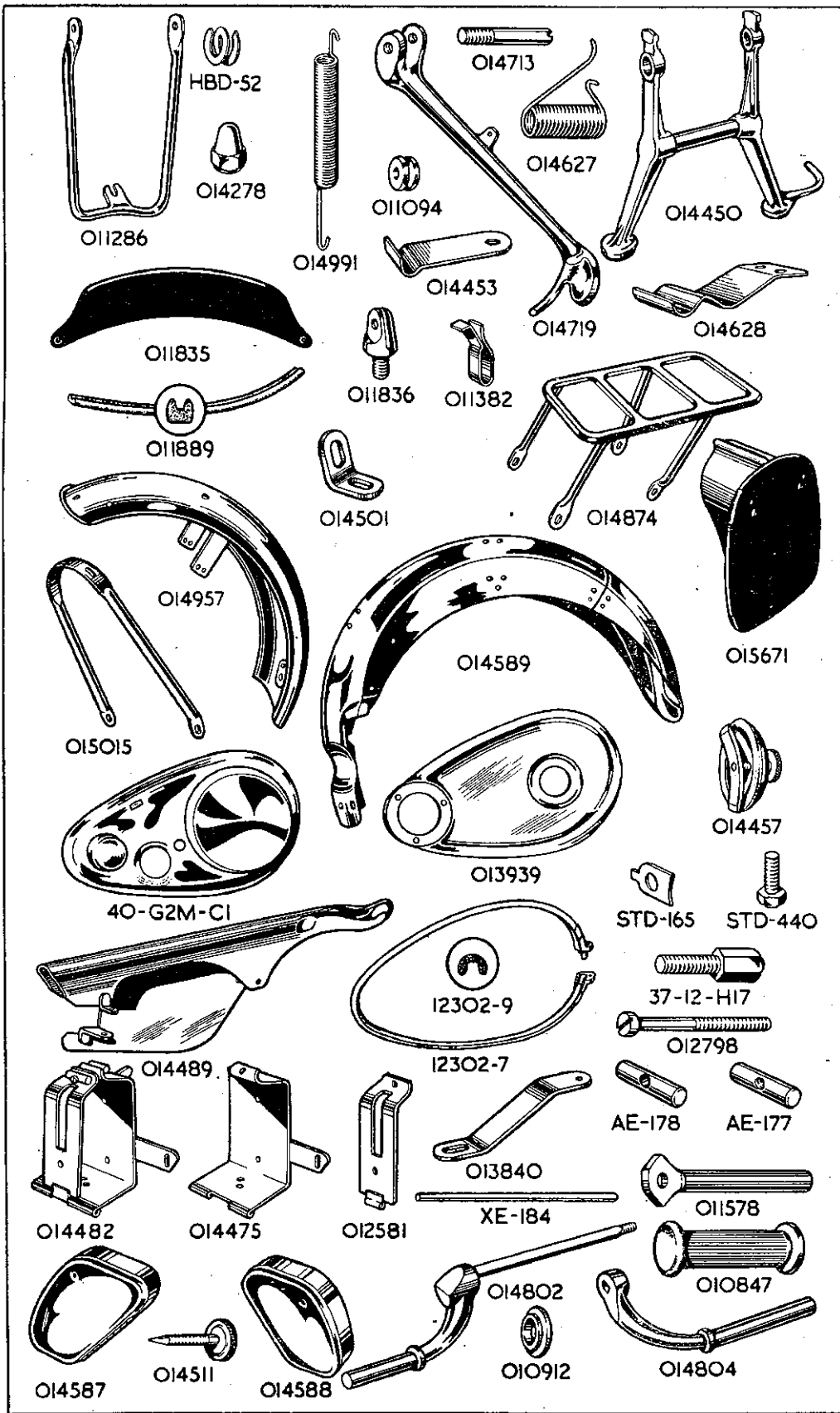

PART NUMBER	DESCRIPTION.	QTY.	PRICE EACH £ s. d.
REAR MUDGUARD.			
014589	Mudguard, rear, bare. (Although this is in two parts, the parts are not sold as separate spares).....	1 ...	
014501	Bracket, for bottom of rear mudguard.....	2 ...	
STD-342	Bolt, fixing bracket to rear mudguard, $\frac{1}{16}$ in. by $\frac{1}{4}$ in. by 26.....	2 ...	
STD-12	Washer, plain, for bracket fixing bolt.....	4 ...	
STD-5	Nut, for bracket fixing bolt.....	2 ...	
STD-271	Stud, fixing rear mudguard brackets to frame, $1\frac{7}{8}$ in. by $\frac{7}{16}$ in. by 26 and 22.....	1 ...	
STD-11	Washer, plain, for bracket fixing stud.....	2 ...	
STD-4	Nut, for bracket fixing stud.....	2 ...	
STD-346	Bolt, fixing rear mudguard to frame loop bridge, $1\frac{7}{8}$ in. by $\frac{1}{4}$ in. by 26.....	1 ...	
STD-191	Washer, spring, for bridge fixing bolt.....	1 ...	
STD-5	Nut, for bridge fixing bolt.....	1 ...	
STD-366	Bolt, fixing rear mudguard to oil tank, $1\frac{1}{4}$ in. by $\frac{5}{16}$ in. by 26.....	1 ...	
014515	Spacer, $\frac{5}{8}$ in. long, for mudguard to oil tank bolt.....	1 ...	
STD-192	Washer, spring, for mudguard to oil tank bolt.....	1 ...	
STD-174	Washer, plain, for mudguard to oil tank bolt.....	1 ...	
STD-4	Nut, for mudguard to oil tank bolt.....	1 ...	

REAR CARRIER

(This is an optional extra).

014874	Carrier, rear, bare.....	1 ...	
STD-342	Bolt, fixing carrier in front, $\frac{1}{8}$ in. by $\frac{1}{4}$ in. by 26.....	2 ...	
STD-12	Washer, plain, for carrier front fixing bolts.....	2 ...	
STD-191	Washer, spring, for carrier front fixing bolts.....	2 ...	
STD-5	Nut, for carrier front fixing bolts.....	2 ...	
STD-344	Bolt, fixing carrier at rear, $\frac{3}{16}$ in. by $\frac{1}{4}$ in. by 26. (These bolts displace two STD-343 bolts in the rear mudguard support tubes, the washers, nuts, etc., of which are transferred).....	2 ...	

FRONT NUMBER PLATE.

011835	Plate, number, front.....	1 ...	
011836	Stud, retaining front number plate.....	2 ...	
STD-12	Washer, plain, for number plate stud.....	2 ...	
STD-5	Nut, for number plate stud.....	2 ...	
011889	Fillet, rubber, for front number plate.....	1 ...	
STD-861	Screw, $\frac{5}{16}$ in. by 2 B.A. fixing number plate to stud.....	2 ...	

REAR NUMBER PLATE.

015671	Plate, number, rear.....	1 ...	
STD-363	Bolt, fixing rear number plate, $\frac{3}{8}$ in. by $\frac{5}{16}$ in. by 26.....	2 ...	
STD-192	Washer, spring, for rear number plate bolt.....	2 ...	

FRONT CHAINCASE.

015722	Chaincase, front, complete. (Includes the next seven items)...	1 ...	
013939	Chaincase, back half only, bare.....	1 ...	
40-G2M-CI	Chaincase, front half only, bare.....	1 ...	
12302-7	Band, metal, for front chaincase.....	1 ...	
STD-453	Screw, clamping chaincase metal band, 1 in. by 2 B.A.....	1 ...	
12302-9	Band, rubber, for front chaincase.....	1 ...	
014457	Cap, assembled, inspection, for front chaincase. (Includes cap, cork washer, central screw and back plate, parts not sold as separate spares).....	1 ...	
STD-580	Washer, cork, for chaincase inspection cap.....	1 ...	
STD-440	Bolt, fixing front chaincase to engine, $\frac{1}{2}$ in. by 0. B.A.	3 ...	
STD-165	Washer, lock, for front chaincase to engine bolt.....	3 ...	

For the bolt, with washers, spacers and nuts fixing the centre of front chaincase, see "Crankcase bolts and engine plates."

PART NUMBER.	DESCRIPTION.	QTY.	PRICE EACH £ s. d.
--------------	--------------	------	-----------------------

REAR CHAINGUARD.

014489	Chainguard, rear, bare.....	1	...
STD-350	Bolt, fixing chainguard at front, $2\frac{1}{8}$ in. by $\frac{1}{4}$ in. by 26.....	1	...
STD-12	Washer, plain, for chainguard front fixing bolt.....	2	...
STD-5	Nut, for chainguard front fixing bolt.....	1	...
014559	Bolt, fixing chainguard at rear, $2\frac{7}{8}$ in. by $\frac{5}{16}$ in. by 26.....	1	...
014560	Spacer, $1\frac{3}{16}$ in. long (located inside chainguard) on chainguard bolt 014559.....	1	...
014561	Spacer, $\frac{3}{8}$ in. long (located between chainguard and frame) on chainguard bolt 014559.....	1	...
STD-11	Washer, plain, for chainguard rear fixing bolt.....	1	...
STD-192	Washer, spring, for chainguard rear fixing bolt.....	1	...
STD-4	Nut, for chainguard rear fixing bolt.....	1	...

BATTERY CARRIER.

014482	Carrier, battery, complete. (Includes the next six items).....	1	...
014475	Carrier, battery, back portion only.....	1	...
012581	Carrier, battery, front portion only.....	1	...
XE-184	Pin, hinge, for battery carrier front.....	1	...
012798	Bolt, clamping battery in carrier, $1\frac{3}{4}$ in. by $\frac{1}{4}$ in. by 26.....	1	...
AE-178	Seat, for battery clamping bolt.....	1	...
AE-177	Nut, for battery clamping bolt.....	1	...
013840	Bracket, for battery carrier.....	1	...
37-12-H17	Bolt, fixing battery carrier bracket to chaincase, $\frac{3}{8}$ in. by $\frac{7}{16}$ in. by 26.....	1	...
STD-11	Washer, plain, for battery carrier bracket to chaincase bolt.....	1	...
STD-4	Nut, for battery carrier bracket to chaincase bolt.....	1	...
STD-40	Screw, fixing battery carrier bracket to carrier, $\frac{1}{2}$ in. by 1 B.A.....	1	...
STD-12	Washer, plain, for STD-40 bracket screw.....	1	...
STD-4	Nut, fixing battery carrier to main frame (also secures oil tank).....	2	...
STD-174	Washer, plain, for battery carrier fixing nuts.....	2	...

TOOL BOXES.

014587	Box, tool, bare, left side. (Does not include any of the following items).....	1	...
014588	Box, tool, bare, right side (Does not include any of the following items).....	1	...
014511	Screw, knurled, for tool box lid.....	2	...
STD-189	Washer, spring, for tool box lid screw.....	2	...
STD-5	Nut, for tool box lid screw.....	4	...
STD-342	Bolt, long, fixing right tool box in top and bottom back locations, $\frac{1}{8}$ in. by $\frac{1}{4}$ in. by 26.....	2	...
STD-342	Bolt, long, fixing left tool box in top back location, $\frac{1}{8}$ in. by $\frac{1}{4}$ in. by 26.....	1	...
014577	Bolt, short, fixing both tool boxes at the sides, $\frac{7}{8}$ in. by $\frac{1}{4}$ in. by 26.....	2	...
014577	Bolt, short, fixing left tool box at bottom back location, $\frac{7}{8}$ in. by $\frac{1}{4}$ in. by 26.....	1	...
STD-639	Spacer, $\frac{1}{8}$ in. long, on 014577 tool box fixing bolts.....	3	...
STD-12	Washer, plain, for tool box fixing bolts.....	12	...
STD-5	Nut, for tool box fixing bolts.....	6	...

FOOTRESTS.

014802	Arm, left side, for footrest (integral with rod).....	1	...
014804	Arm, right side, for footrest.....	1	...
010847	Pad, rubber, for footrest arm. (Same as 16315).....	2	...
010924	Spacer, $3\frac{1}{2}$ in. long, for footrest rod, between rear engine plates. (Same as CFR-6).....	1	...
010912	Washer, spigot, for footrest rod.....	1	...
STD-2	Nut, for footrest rod.....	1	...

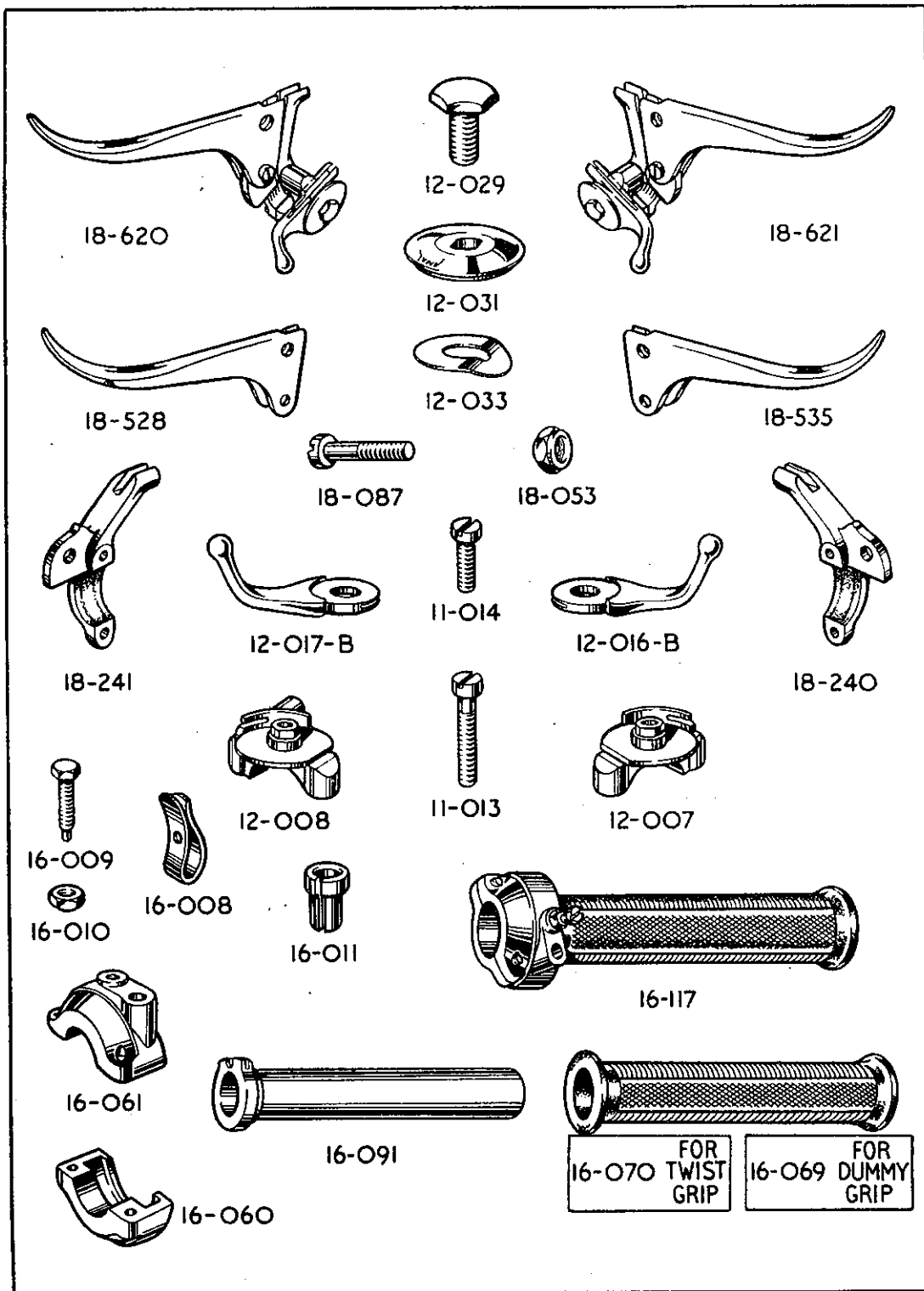

PART NUMBER	DESCRIPTION.	QTY.	PRICE EACH £ s. d.
-------------	--------------	------	-----------------------

PILLION FOOTRESTS.

011267	... Pair of pillion footrests, complete. (Includes all the following items).....	1	...
011518	... Spindle, bare, for pillion footrest.....	2	...
011599	... Bolt, hinge, for pillion footrest spindle, 1 $\frac{3}{8}$ in. by $\frac{3}{8}$ in. by 26.....	2	...
STD-73	... Nut, for pillion footrest hinge bolt.....	2	...
010847	... Pad, rubber, for pillion footrest spindle. (Same as 16315).....	2	...

DUAL SEAT.

014293	... Seat, dual	1	...
014919	... Screw, fixing seat at rear to loop, $\frac{3}{4}$ in. by 2 B.A.....	2	...
STD-39	... Washer, plain, for seat fixing screw.....	2	...
STD-80	... Nut, for seat fixing screw.....	2	...
STD-11	... Washer, plain, for nut fixing seat in centre.....	2	...
STD-4	... Nut, fixing seat in centre.....	2	...

TRANSFERS.

STD-9184	... Transfer, for top of oil tank (service instruction). Same as 38-G3-F391.....	1	...
STD-9183	... Transfer, for side of oil tank (oil level indicator). Same as 38-G3-F392.....	1	...
STD-9186	... Transfer, for front chaincase (oil level indicator). Same as 38-G3-F393.....	1	...
STD-9187	... Transfer, for front chaincase. ("PATENT").....	1	...
STD-9189	... Transfer, for rear mudguard. ("MATCHLESS.") Same as 38-G3-F383.....	1	...
STD-9188	... Transfer, for tool boxes (Monogram). Same as 38-G3-F385.....	2	...
STD-9192	... Transfer, for front forks. ("PATENT")	1	...
012973	... Transfer, for petrol tank. ("RESERVE").....	1	...
011399	... Transfer, for rear fork hinge ("PATENT")	1	...
015282	... Transfer, "Made in England"	1	...
015898	... Set of transfers, comprising all above.....	1	...

TWIST GRIP.

16-117	... Twist grip, complete assembly.....	1	...
16-070	... Grip, rubber, for twist grip.....	1	...
16-091	... Rotor and sleeve, for twist grip (does not include rubber grip).....	1	...
16-060	... Body, twist grip, top (plain clip).....	1	...
16-061	... Body, twist grip, bottom (for friction spring).....	1	...
11-013	... Screw, long, clamping twist grip body.....	1	...
11-014	... Screw, short, clamping twist grip body.....	1	...
16-008	... Spring, friction, for twist grip.....	1	...
16-009	... Screw, for twist grip friction spring.....	1	...
16-010	... Nut, for twist grip friction spring screw.....	1	...
16-011	... Stop, for twist grip (throttle) cable.....	1	...

DUMMY GRIP.

16-069	... Grip, rubber, dummy.....	1	...
--------	------------------------------	---	-----

GENUINE MATCHLESS SPARES

PURCHASED FROM
AN AUTHORISED "MATCHLESS" DEALER
OR FROM THE FACTORY, ARE IDENTICAL
WITH THE PARTS ORIGINALLY BUILT
INTO YOUR MOTOR CYCLE

BY USING GENUINE SPARES YOU ARE ASSURED THEY
WILL FIT ACCURATELY AND GIVE SATISFACTORY SERVICE

PART NUMBER	DESCRIPTION.	QTY.	PRICE EACH £ s. d.
-------------	--------------	------	-----------------------

CLUTCH AND IGNITION CONTROL LEVERS.

18-620	Lever assembly, clutch and ignition.....	1	...
18-528	Lever, only, clutch.....	1	...
12-017-B	Lever, only, ignition.....	1	...
18-241	Bracket, for clutch lever.....	1	...
12-008	Bracket, for ignition lever.....	1	...
11-013	Screw, long, clamping clutch and ignition brackets.....	1	...
11-014	Screw, short, clamping clutch and ignition brackets.....	1	...
18-087	Pin, fulcrum, for clutch lever.....	1	...
18-053	Nut, clutch lever fulcrum pin.....	1	...
12-029	Bolt, central, for ignition lever.....	1	...
12-031	Cap, for ignition lever.....	1	...
12-033	Washer, spring, for ignition lever.....	1	...

BRAKE AND AIR CONTROL LEVERS.

18-621	Lever, assembly, brake and air.....	1	...
18-535	Lever, only, brake.....	1	...
12-016-B	Lever, only, air.....	1	...
18-240	Bracket, for brake lever.....	1	...
12-007	Bracket, for air lever.....	1	...
11-013	Screw, long, clamping brake and air brackets.....	1	...
11-014	Screw, short, clamping brake and air brackets.....	1	...
18-087	Pin, fulcrum, for brake lever.....	1	...
18-053	Nut, brake lever fulcrum pin.....	1	...
12-029	Bolt, central, for air lever.....	1	...
12-031	Cap, for air lever.....	1	...
12-033	Washer, spring, for air lever.....	1	...

FRONT BRAKE CABLE.

013178	Cable, complete, assembled, front brake.....	1	...
12-44	Wire, inner, front brake.....	1	...
40-058	Nipple, brake end, for brake inner wire.....	1	...
18-088	Nipple, handlebar end, for brake inner wire.....	1	...
12C-26	Casing, outer, front brake.....	1	...
STD-531	Ferrule, front brake outer casing.....	2	...
011348	Adjuster, front brake cable.....	1	...
16363	Nut, lock, front brake cable adjuster.....	1	...
16482	End, yoke, front brake cable.....	1	...
STD-736	Pin, for yoke end, front brake cable.....	1	...
STD-14	Pin, split, for front brake cable yoke end pin.....	1	...
012478	Sleeve, rubber, for front brake cable inner wire.....	1	...

CLUTCH CABLE.

41-C-2	Cable, complete, assembled, clutch.....	1	...
12-52	Wire, inner, clutch.....	1	...
4	Nipple, gear box end, clutch inner wire.....	1	...
18-088	Nipple, handlebar end, clutch inner wire.....	1	...
12C-47	Casing, outer, clutch.....	1	...
STD-531	Ferrule, clutch outer casing.....	2	...
014225	Adjuster, clutch cable.....	1	...
STD-290	Nut, lock, clutch cable adjuster.....	1	...

THROTTLE CONTROL CABLE.

41-T-2	Cable, complete, assembled, throttle.....	1	...
SW2-41	Wire, inner, throttle.....	1	...
1482	Nipple, carburettor end, throttle inner wire.....	1	...
12-034	Nipple, handlebar end, throttle inner wire.....	1	...
11C-39	Casing, outer, throttle.....	1	...
STD-528	Ferrule, throttle outer casing.....	2	...

PART NUMBER.	DESCRIPTION.	QTY.	PRICE EACH £ s. d.
--------------	--------------	------	-----------------------

AIR CONTROL CABLE.

41-A-1	... Cable, complete, assembled, air.....	1	...
11-38	... Wire, inner, air.....	1	...
1482	... Nipple, carburetter end, air inner wire.....	1	...
12-034	... Nipple, handlebar end, air inner wire.....	1	...
11C-32	... Casing, outer, air.....	1	...
STD-528	... Ferrule, air outer casing.....	2	...

IGNITION CONTROL CABLE.

015190	... Cable, complete, assembled, ignition.....	1	...
11-37½	... Wire, inner, ignition.....	1	...
MC-4	... Nipple, magneto end, ignition inner wire.....	1	...
12-034	... Nipple, handlebar end, ignition inner wire.....	1	...
11C-25¼	... Casing, outer, ignition, long.....	1	...
11C-6	... Casing, outer, ignition, short.....	1	...
014828	... Stop, adjustable, for ignition cable.....	1	...
STD-528	... Ferrule, ignition outer casing.....	4	...
458731	... Cap, rubber, cable entry to magneto.....	1	...
458727	... Cap, metal, cable entry to magneto.....	1	...
163343	... Washer, fibre, for cable entry metal cap.....	1	...
454969	... Plunger, for ignition cable.....	1	...
458732	... Spring, return, for ignition cable.....	1	...

PETROL TANK.

014614	... Tank, petrol, bare.....	1	...
011928	... Letter M and wing emblem.....	2	...
STD-150	... Screw, fixing wing emblem, $\frac{5}{16}$ in. by 3 B.A.....	4	...

PETROL TANK FITTINGS.

013325	... Cap, filler, for petrol tank.....	1	...
41-G3L-T93	... Tap, with filter, for petrol feed.....	2	...
STD-200	... Washer, fibre, for petrol feed tap.....	2	...
010906	... Grip, knee, left hand side (same as 38-G3-T4-L).....	1	...
010907	... Grip, knee, right hand side (same as 38-G3-T4-R).....	1	...
010908	... Plate, for left hand knee grip (same as 38-G3-T34-L).....	1	...
010909	... Plate, for right hand knee grip (same as 38-G3-T34-R).....	1	...
STD-70	... Bolt, fixing knee grip plate, $\frac{9}{16}$ in. by $\frac{1}{4}$ in. by 26.....	4	...
STD-639	... Spacer, $\frac{1}{8}$ in. long, for knee grip plate bolts.....	4	...

PETROL TANK FIXING BOLTS (1949).

38-G3-T15-A	... Bolt, fixing tank (front right and both rear positions), $1\frac{5}{16}$ in. by $\frac{5}{16}$ in. by 26.....	3	...
015248	... Bolt, fixing tank (front left position), $1\frac{15}{16}$ in. by $\frac{5}{16}$ in. by 26.....	1	...
015246	... Sleeve, fixing horn bracket.....	1	...
015247	... Nut, for horn bracket fixing sleeve.....	1	...
16413	... Pad, rubber, thick ($\frac{7}{16}$ in.) for tank fixing bolt.....	3	...
16414	... Pad, rubber, thin ($\frac{1}{2}$ in.), for tank fixing bolt.....	5	...
STD-173	... Washer, metal, $1\frac{1}{8}$ in. diameter, plain, for tank fixing bolts.....	14	...
41-G3L-T97	... Wire, copper, 5 feet by 20 S.W.G.....	1	...

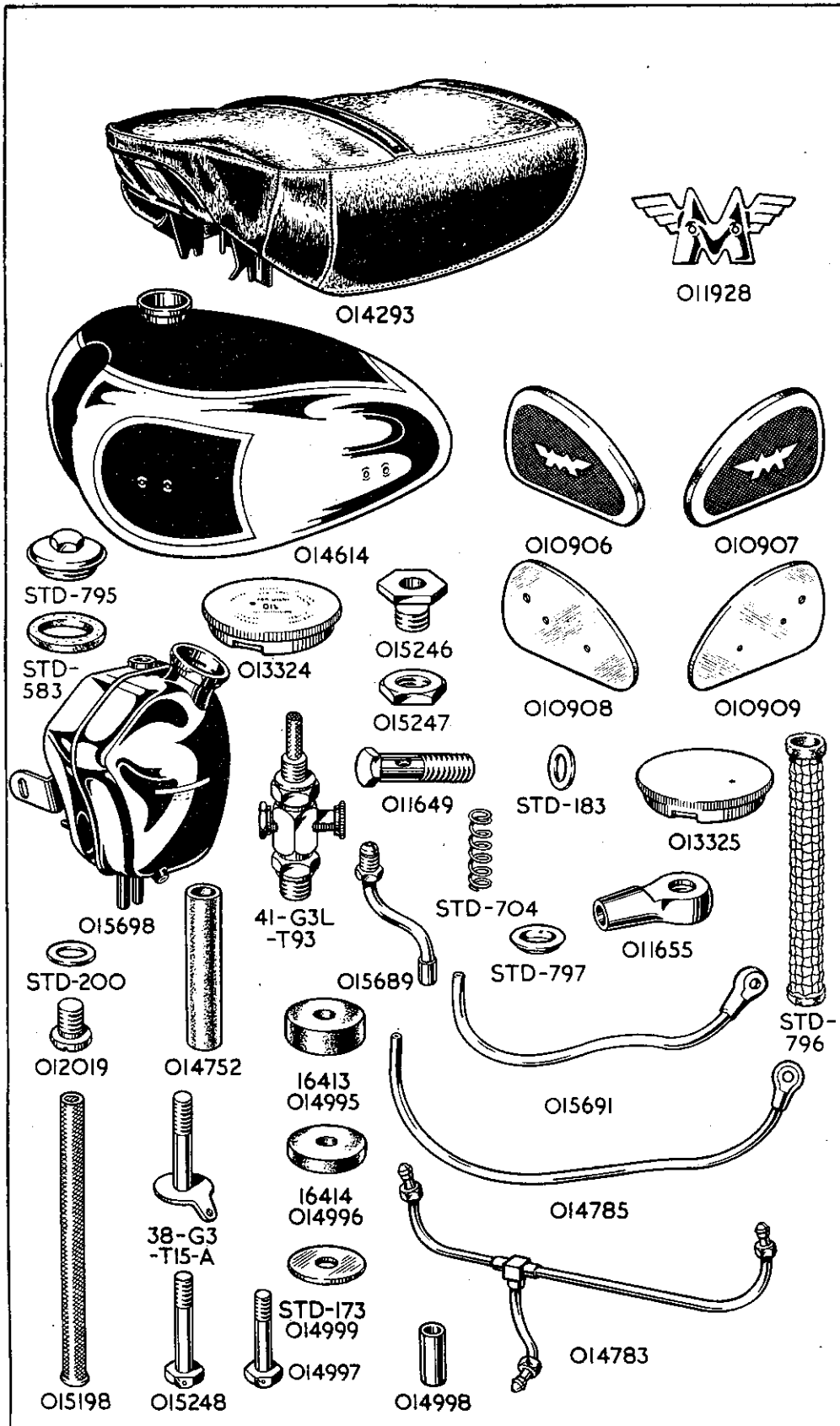

PART NUMBER.	DESCRIPTION.	QTY.	PRICE
			EACH £ s. d.
PETROL TANK FIXING BOLTS (1950).			
014997	Bolt, fixing tank, all positions, 1¼ in. by 5/16 in. by 26.....	4 ...	
014998	Sleeve, 13/8 in. long, for tank fixing bolts.....	4 ...	
014995	Pad, rubber, thick (5/8 in.), for tank fixing bolts in front right and both rear positions.....	3 ...	
014996	Pad, rubber, thin (3/16 in.), for all tank fixing bolts (three used on front left bolt).....	6 ...	
014999	Washer, metal, 1¼ in. diameter, plain, for tank fixing bolts.....	4 ...	
41-G3L-T97	Wire, copper, 5 feet by 20 S.W.G.....	1 ...	

OIL TANK.

015698	Tank, oil, bare.....	1 ...	
013324	Cap, filler, for oil tank.....	1 ...	
012019	Plug, drain, for oil tank.....	1 ...	
STD-200	Washer, fibre, for oil tank drain plug.....	1 ...	
STD-796	Filter, felt, for oil tank.....	1 ...	
STD-797	Cap, metal, dished, for oil tank felt filter.....	1 ...	
STD-704	Spring, on top of oil tank filter metal cap.....	1 ...	
STD-795	Cap, screwed, for oil tank filter compartment.....	1 ...	
STD-583	Washer, cork, for filter compartment cap.....	1 ...	

For the two nuts and washers that retain the oil tank (and the Battery Carrier) to the main frame, see "Battery Carrier" Group.

For the bolt, washer, and nut fixing the oil tank bracket to the rear mudguard, see "Rear Mudguard" Group.

PETROL PIPE.

014783	Pipe, assembled, for petrol feed.....	1 ...	
---------------	---------------------------------------	-------	--

The "nipples" on these pipes are formed integrally with the piping. Therefore union nuts cannot be removed or re-fitted, and they are not sold as separate spares.

OIL PIPES.

014785	Pipe, oil feed, assembly.....	1 ...	
015691	Pipe, oil return, engine end.....	1 ...	
015689	Pipe, oil return, tank end.....	1 ...	
011655	Union, banjo, for feed and engine end return oil pipes.....	2 ...	
011649	Pin, banjo, retaining feed and engine end return oil pipes.....	2 ...	
STD-183	Washer, fibre, for oil pipe banjo pins.....	2 ...	
014752	Connection, rubber, for feed and return oil pipes.....	2 ...	
015198	Filter, metal gauze, for oil feed pipe.....	1 ...	
014789	Hose, vent, from oil tank.....	1 ...	
014951	Clip, for oil tank vent pipe.....	1 ...	
014789	Hose, from crankcase release valve to oil tank.....	1 ...	

FRONT WHEEL.

015553	Wheel, front, with all fittings (comprises rim, spokes, nipples, hub, all bearings, all brake parts, including cover plate and expander lever, but does not include the tyre).....	1 ...	
013612	Wheel, front, less all fittings (comprises rim, spokes, nipples and hub shell assembled).....	1 ...	
012875	Rim, front, 19 in. by 2½ in.....	1 ...	
011018	Spoke, front, left, 5-3/8 in. by 8G by 10G (same as 37-X-H51).....	20 ...	
011014	Spoke, front, right, 8-3/8 in. by 9G by 11G (same as 12399).....	20 ...	
011017	Nipple, front, left, .225 in. by 10G (same as 20680).....	20 ...	
011016	Nipple, front, right, .225 in. by 11G (same as 20678).....	20 ...	
012575	Hub, with brake drum, bare, for front wheel.....	1 ...	
STD-51	Nipple, grease, for front wheel hub.....	1 ...	

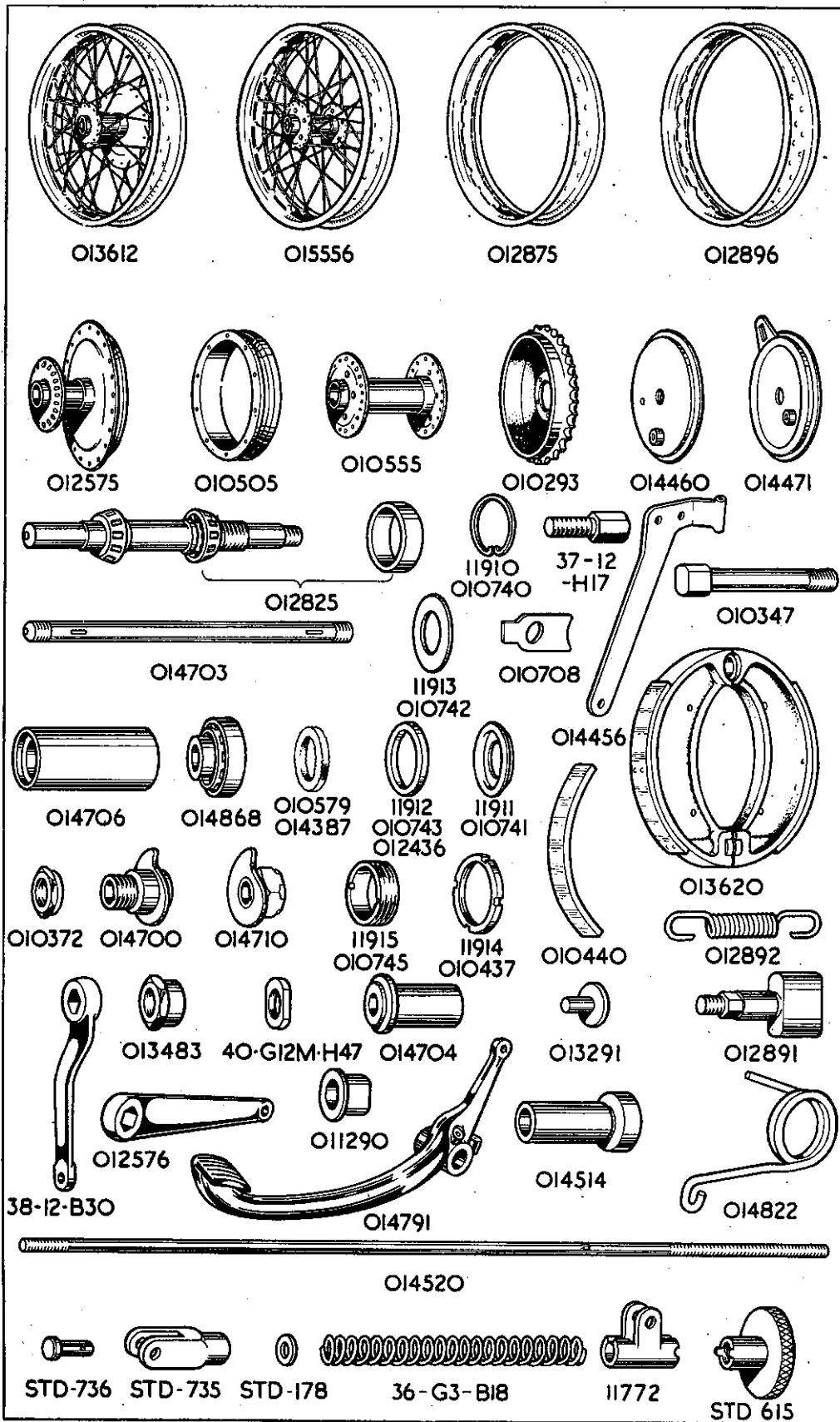

PART NUMBER	DESCRIPTION.	QTY.	PRICE EACH £ s. d.
-------------	--------------	------	-----------------------

FRONT WHEEL BEARINGS.

012825	Spindle, with roller bearings, for front wheel (same as 40-G12M-H10)	1	...
010579	Oil-seal, for front hub bearings	2	...
11910	Ring, spring, locating front hub bearings	1	...
11911	Cup, for front hub bearing oil-seal	1	...
11912	Ring, spacing, for front hub bearing oil-seal	1	...
11913	Ring, retaining front hub bearing oil-seals	3	...
11914	Nut, lock, for front hub bearing adjusting ring	1	...
11915	Ring, adjusting, for front hub bearing	1	...
40-G12M-H47	Nut, locating front brake cover plate	1	...
11913	Washer, locating front brake cover plate	1	...
013483	Nut, outside, securing front brake cover plate	1	...
STD-1	Nut, front wheel spindle, left side	1	...
STD-8	Washer, plain, front wheel spindle, left side	1	...

REAR WHEEL.

015565	Wheel, rear, with all fittings (comprises rim, spokes, nipples, hub, all bearings, but <i>does not include</i> the centre solid spindles, washers, spacers, cams, nuts, brake parts, sprocket, speedometer drive and tyre)	1	...
015556	Wheel, rear, less all fittings (comprises rim, spokes, nipples and hub shell assembled)	1	...
012876	Rim, rear, 19 in. by 2½ in.	1	...
011012	Spoke, rear wheel, left and right, 8 $\frac{3}{8}$ in. by 6G by 9G (same as 39-8-H54)	40	...
011013	Nipple, left and right, .250 in. by 9G (same as 12344)	40	...
010555	Hub, rear wheel, shell only	1	...
STD-51	Nipple, grease, for rear wheel hub	1	...

REAR WHEEL BEARINGS.

014868	Bearing, roller, for rear hub (only sold as a complete bearing)	2	...
014387	Oil-seal, for rear hub bearings	2	...
010740	Ring, spring, locating rear hub bearings	1	...
010741	Cup, for rear hub bearing oil-seal	1	...
010743	Ring, spacing, for rear hub bearing oil-seal	1	...
010742	Ring, retaining rear hub bearing oil-seals	3	...
012436	Collar, spacing, between taper bearing and rear hub bearing oil-seal	2	...
014706	Spacer, 2 $\frac{9}{16}$ in. long, between the two bearings of rear hub	1	...
010745	Ring, adjusting, for rear hub bearing	1	...
010437	Nut, lock, for rear hub bearing adjusting ring	1	...
014703	Spindle, centre, solid, for rear wheel	1	...
014705	Spacer, 1 $\frac{1}{16}$ in. long, on rear wheel solid spindle, for speedometer gear box	1	...
010372	Nut, locking, speedometer gear box	1	...
014704	Sleeve, on rear wheel solid spindle, locating cover plate	1	...
014700	Cam, on rear wheel solid spindle, right side	1	...
014710	Cam, on rear wheel solid spindle, left side	1	...
STD-573	Key, on rear wheel solid spindle locating cams	2	...
011290	Collar, on rear wheel solid spindle (abuts against fork end)	2	...
014869	Nut, on rear wheel solid spindle	2	...

FRONT BRAKE.

010505	Drum, front brake	1	...
STD-140	Screw, fixing front brake drum to hub shell, $\frac{3}{8}$ in. by 1 B.A.	10	...
014460	Plate, cover, front brake	1	...
014456	Stay, front brake cover plate anchor	1	...
014807	Bolt, fixing anchor stay to front cover plate, $\frac{5}{8}$ in. by $\frac{3}{8}$ in. by 26	1	...
014119	Washer, plain, for anchor stay bolt	1	...
013620	Shoes, pair of, for front brake, with brake linings and thrust pins. Only supplied in pairs (same as 39-8-B71-A) per pair	1	...

PART NUMBER	DESCRIPTION.	QTY.	PRICE EACH £ s. d.
-------------	--------------	------	-----------------------

FRONT BRAKE—Continued,

013291	Pin, thrust, brake expander adjusting.....	2	...
STD-174	Washer, plain, for thrust pin.....	R	...
000440	Linings, brake, per pair of, less rivets (same as 3836-2).....	1	...
STD-113	Rivets, for brake linings, per set of.....	12	...
012892	Spring, for brake shoes (same as 16485).....	2	...
012891	Expander, for brake shoes (same as 36-8-B51).....	1	...
012576	Lever, for front brake shoe expander.....	1	...
STD-51	Nipple, grease, for brake shoe expander.....	1	...
STD-174	Washer, plain, for brake shoe expander.....	1	...
STD-4	Nut, for brake shoe expander.....	1	...

REAR BRAKE.

010293	Sprocket and brake drum, for rear wheel, 42 teeth.....	1	...
37-12-H17	Bolt, retaining sprocket to rear hub, $\frac{3}{8}$ in. by $\frac{5}{16}$ in. by 26.....	5	...
010708	Washer, lock, for rear sprocket retaining bolt.....	5	...
STD-11	Washer, plain, for rear sprocket retaining bolt.....	5	...
STD-74	Nut, for rear sprocket retaining bolt.....	5	...
014471	Plate, cover, rear brake.....	1	...
010347	Bolt, anchor, rear brake cover plate, $2\frac{1}{4}$ in. by $\frac{3}{8}$ in. by 26, with square head.....	1	...
STD-3	Nut, for rear brake cover plate anchor bolt.....	1	...
STD-6	Pin, split, for rear brake anchor bolt.....	1	...
013620	Shoes, pair of, for rear brake, with brake linings and thrust pins. Only supplied in pairs (same as 39-8-B71-A) per pair.....	1	...
013291	Pin, thrust, brake expander adjusting.....	2	...
STD-174	Washer, plain, for thrust pin.....	R	...
010440	Linings, brake, per pair of, less rivets (same as 3836-2).....	1	...
STD-113	Rivets, for brake linings, per set of.....	12	...
012892	Spring, for brake shoes (same as 16485).....	2	...
012891	Expander, for brake shoes (same as 36-8-B51).....	1	...
38-12-B30	Lever, for rear brake shoe expander.....	1	...
STD-51	Nipple, grease, for brake shoe expander.....	1	...
STD-174	Washer, plain, for brake shoe expander.....	1	...
STD-4	Nut, for brake shoe expander.....	1	...

REAR BRAKE OPERATING PARTS.

014791	Pedal, foot, for rear brake.....	1	...
014514	Bush, for rear brake foot pedal.....	1	...
STD-51	Nipple, grease, for rear brake foot pedal.....	1	...
STD-344	Bolt, adjusting rear brake foot pedal, $\frac{3}{8}$ in. by $\frac{1}{4}$ in. by 26.....	1	...
STD-5	Nut, for rear brake foot pedal adjusting bolt.....	1	...
014822	Spring, return, rear brake foot pedal.....	1	...
014520	Rod, bare, rear brake.....	1	...
STD-735	End, yoke, for front end of brake rod.....	1	...
STD-736	Pin, for brake rod yoke end.....	1	...
STD-14	Pin, split, for brake rod yoke end pin.....	1	...
36-G3-B18	Spring, for brake rod.....	1	...
STD-178	Collar, for brake rod spring.....	1	...
11772	Clip, adjusting, for rear end of brake rod.....	1	...
STD-736	Pin, for brake rod adjusting clip.....	1	...
STD-14	Pin, split, for brake rod adjusting clip pin.....	1	...
STD-615	Nut, adjusting, for rear brake rod.....	1	...

VOLTAGE REGULATOR.

015087	Regulator, with cut-out, complete unit, type MCR-2. Lucas replacement number 37097.....	1	...
014929	Strip, fixing regulator to battery carrier.....	1	...
STD-70	Bolt, fixing regulator to fixing strip, $\frac{3}{8}$ in. by $\frac{1}{4}$ in. by 26.....	2	...
STD-347	Bolt, securing fixing strip to battery carrier, $1\frac{5}{8}$ in. by $\frac{1}{4}$ in. by 26.....	1	...
STD-12	Washer, plain, for regulator fixing bolts.....	5	...
STD-5	Nut, for regulator fixing bolts.....	3	...

PART NUMBER	DESCRIPTION.	QTY.	PRICE EACH £ s. d.
BATTERY.			
PUW-7E-4	... Battery, with lid, dry and uncharged. This is a battery that has NOT been filled with electrolyte (acid) and is, of course, not charged. It requires no special packing and can safely be packed with other goods.....	1	...
PUW-7E-4-C	... Battery, with lid, filled and charged. This is a battery filled with electrolyte and charged, ready for use. It is only supplied to callers who have previously arranged for it to be prepared. IN NO CIRCUMSTANCES do we pack and despatch this battery	1	...
S-2171	... Lid, only, with rubber pads, for battery.....	1	...
HEAD LAMP.			
50788-B	... Lamp, head, Type SSU-700-P, with bulbs, ammeter and switch (no cable harness).....	1	...
553248	... Rim, bare, for head lamp.....	1	...
516364	... Reflector with front glass (parts not sold separately).....	1	...
516368	... Holder, for bulbs.....	1	...
106779	... Screw, fixing panel to head lamp.....	3	...
185026	... Washer, spring, for panel fixing screw.....	3	...
516183	... Fillet, rubber, for head lamp panel.....	1	...
112201	... Bolt, fixing head lamp to bracket.....	2	...
137141	... Washer, plain, for head lamp fixing bolts.....	2	...
REAR LAMP.			
53139-A	... Lamp, rear, complete with bulb. Lucas replacement number for early models "467-1," for later models "467-2" (see items seven and eight below).....	1	...
572611	... Glass, red, for rear lamp.....	1	...
572595	... Gasket, rubber, for base of rear lamp.....	1	...
572039	... Grummet, rubber, for rear lamp wire.....	1	...
572040	... Plug, rubber, for base of rear lamp.....	1	...
572609	... Frame, over rear lamp red glass.....	1	...
572055	... Screw, fixing glass frame on rear lamps marked "467-1," (see item one above).....	1	...
572614	... Nut, sleeve, fixing glass frame on rear lamps marked "467-2" (see item one above).....	1	...
161385	... Washer, rubber, for screw, or sleeve nut, fixing glass frame on rear lamps.....	1	...
188818	... Terminal sleeve, for rear lamp wire.....	2	...
165310	... Nut, rear lamp fixing screw.....	2	...
185036	... Washer, spring, for rear lamp fixing screw.....	2	...
HORN.			
015257	... Horn, type HF 1234, with bracket. Lucas replacement number is 069225, but hole in bracket must be opened out to $\frac{1}{4}$ in. diameter.....	1	...
015245	... Bracket, only, for horn (see note above re opening out hole).....	1	...

For the convenience of Owners, **SPARES STOCKISTS** are appointed for most districts. To save delay, and the delivery surcharge customers are recommended to always first apply to their nearest Agent or spares stockist.

PART NUMBER.	DESCRIPTION.	QTY.	PRICE EACH £ s. d.
--------------	--------------	------	-----------------------

ELECTRICAL SUNDRIES.

36084 Ammeter, for head lamp panel.....	1	...
351551 Switch, main lighting, for head lamp panel.....	1	...
380521 Switch, dipping, for handlebar.....	1	...
762664 Switch, horn, for handlebar.....	1	...
762664 Switch, magneto cut-out, for handlebar.....	1	...
351567 Handle, with screw, for main lighting switch.....	1	...
994001 Cable harness, main lighting and horn, but does not include the triple wire from head lamp to handlebar dipping switch and the wires from regulator.....	1	...
858795 Cable harness, triple, for dipping switch.....	1	...
989981 Cable harness, for regulator.....	1	...
STD-543 Cable, high tension, for sparking plugs (28½ ins. required for left cylinder and 28½ ins. for right cylinder) price per foot.....	R	...
STD-541 Terminal, for high tension cable.....	2	...
STD-540 Terminal, for earth cables.....	2	...
900269 Connector, snap, for rear lamp cable.....	1	...
900269 Connector, snap, for regulator to ammeter cable.....	1	...
571395 Connector, screwed, for battery positive cable.....	1	...
168 Bulb, head lamp, main, 6 volt, 24 by 24 watts.....	1	...
	Plus Purchase Tax.....	-	...
988 Bulb, head lamp, pilot, 6 volt, 3 watts.....	1	...
	Plus Purchase Tax.....	-	...
988 Bulb, rear lamp, 6 volt, 3 watts.....	1	...
	Plus Purchase Tax.....	-	...
014296 Plug, sparking, LODGE, Type HL-14-S (used as standard on 1949 machines).....	2	...
015547 Plug, sparking, K-L-G, Type FE-80 (used as standard on 1950 machines)	2	...

CABLE CLIPS.

011907 Clip, rubber, 1½ in.....	6	...
011908 Clip, rubber, 3 in.....	5	...
011909 Clip, rubber, 4½ in.....	4	...
014453 Clip, metal, holding cable behind rear lamp.....	1	...
011382 Clip, metal, holding rear lamp cable to mudguard edge.....	3	...
011094 Bush, rubber, fits in rear mudguard, for rear lamp cable (same as 39-G3-EQ-13)	1	...

SPEEDOMETER.

015561 Speedometer, trip, 120 M-P-H, complete.....	1	...
015562 Speedometer, trip, 180 K-P-H, complete.....	1	...
S-480-3-L... Head, only, speedometer, trip, 120 M-P-H.....	1	...
S-480-7-L... Head, only, speedometer, trip, 180 K-P-H.....	1	...
53279-1 Set of bulb holding parts for speedometer head.....	1	...
53205 Bulb, for speedometer head, M-B-C, 6 volts, 1.8 watts.....	1	...
	Plus Purchase Tax.....	-	...
40-G12M-FF78 Bracket for speedometer head.....	1	...
STD-341 Bolt, fixing speedometer bracket to forks, ⅝ in. by ¼ in. by 20...	2	...
STD-12 Washer, plain, for speedometer bracket bolts.....	2	...
STD-12 Washer, plain, spacing, for speedometer head.....	2	...
W-7216 Washer, spring, for speedometer head fixing nut.....	2	...
N-1253 Nut, fixing speedometer head to bracket.....	2	...
53395-1-65 Cable, speedometer drive, complete.....	1	...
52108-1-65 Cable, speedometer drive, inner only.....	1	...
53398-1-65 Cable, speedometer drive, outer only.....	1	...
41-G3L-F311 Clip, for speedometer drive cable.....	1	...
STD-450 Screw, fixing speedometer cable clip, ⅜ in. by 2 B.A.....	1	...
STD-190 Washer, spring, for cable clip screw.....	1	...
52283-5 Gearbox, speedometer, complete.....	1	...

COMPLETE TOOL KITS.

015899 Tool kit, complete, with tyre inflator.....	1	...
015900 Tool kit, complete, less tyre inflator.....	1	...

PART NUMBER	DESCRIPTION.	QTY.	PRICE EACH £ s. d.
-------------	--------------	------	-----------------------

TOOLS.

The following comprise "TOOL KIT, COMPLETE, WITH TYRE INFLATOR," and is included as part of every motor cycle.

17520	Bag, for tools.....	1	...
L-TK13	Screwdriver	1	...
L-TK15	Pliers, side cutting.....	1	...
11024	Pliers, for gudgeon pin circlips.....	1	...
L-TK20	Gun, grease	1	...
38-G3-EQ2	Inflator, tyre.....	1	...
40-G3-TK29	Lever, tyre.....	2	...
015264	Spanner, single end, for rocker clamping bolts.....	1	...
41-G3L-TK1	Spanner, double end, $\frac{3}{16}$ in. by $\frac{1}{4}$ in.....	2	...
41-G3L-TK2	Spanner, double end, $\frac{5}{16}$ in. by $\frac{3}{8}$ in.....	1	...
3263	Spanner, double end, $\frac{3}{16}$ in. by .375 in., clutch cable adjustment	1	...
015023	Spanner, double end, with gauge, for contacts (Lucas number, 415116)	1	...
R-TK3	Spanner, triple end, .80 in. by 1.011 in. by 1.2 in.....	1	...
17634	Spanner, box, with tommy, for sparking plug.....	1	...
015213	Spanner, box, for cylinder head nuts.....	1	...
014540	Spanner, box, with tommy, for rocker box, cover bolts.....	1	...
11914-S	Spanner, hook, for front hub bearing lock nut.....	1	...
010438	Spanner, hook, for rear hub bearing lock nut.....	1	...
L-TK12	Wrench, adjustable.....	1	...

SPECIAL TOOLS.

36-G8-E384	Holder, valve, for valve grinding.....	1	...
015273	Extractor, for timing pinion and magneto gear.....	1	...
015374	Extractor, for camshaft gears.....	1	...
014598	Disc, timing (see Instruction Manual).....	1	...

The above tools are NOT INCLUDED in the equipment of a new motor cycle.

VARIOUS.

011957	"Tekall," rust preventative, $\frac{1}{2}$ pint tin.....	R	...
011958	"Tekall," rust preventative, 1 pint tin.....	R	...
CM-10	Instruction Manual	R	...
BMH	Badge, Monogram, Matchless, for button hole.....	R	...
BMT	Badge, Monogram, Matchless, for tie.....	R	...
BMB	Badge, Monogram, Matchless, for brooch fixing.....	R	...

SERVICE

The Service and repair department is situated in **Burrage Grove, Plumstead, London, S.E.18**, **Burrage Grove** is the first turning on the left from Burrage Road when entering Burrage Road from the Plumstead Road. (See final paragraph below.)

The nearest Railway Station is **WOOLWICH ARSENAL, SOUTHERN REGION RAILWAY**. This Station is five minutes walk from our Service Depot in Burrage Grove. There is an excellent service of electric trains from Charing Cross, Waterloo, Cannon Street and London Bridge Stations, Southern Region Railway.

Bus routes 53, 53a, 54, 99 and 122. Trolleybus routes, 696 and 698, and Tram routes 36, 38 and 40, pass the end of Burrage Road (one minute from the Service Depot).

Bus routes 21a, 75 and 161 and Tram routes 44, 46 and 72 serve **Beresford Square** which is three minutes walk from the **Service and Repair Department**.

Visitors from the North can pass into Woolwich via the Free Ferry between North Woolwich and Woolwich. North Woolwich is a British Railways terminus and is also served by Bus and Trolleybus routes 101, 569, 669 and 685. There is also a tunnel under the River Thames at this point for foot passengers. The Free Ferry accommodates all types of motor vehicles and there is a very frequent service. The Southern landing stage is less than a mile from the Service Depot.

Visitors arriving by road, if they are strangers to the locality, should enquire for **Beresford Square, Woolwich**. Upon arrival there, the road skirting the Royal Arsenal should be followed in an Easterly direction for about four hundred yards, and Burrage Road is the second turning on the right after leaving the square. Burrage Grove is then the first turning on the left.

DETAILED INDEX

	Page		Page
BRAKES		ENGINE PLATES	
Front	39	Plates	14
Rear	40	Crankcase bolts	14
Rear, operating parts	40		
CARBURETTER		FOOTRESTS	
Choke	12	Pillion	33
Complete	10	Rider's	31
Float Chamber	12		
Jets	12	FRAME	
Mixing body	12	Front Frame	23
Valves	12	Rear Frame	23
		Rear Fork	24
		Rear Carrier	30
		Teledraulic rear leg	24
CABLES		FRONT FORKS	
Air	35	Assembly	24
Brake	34	Handlebar	28
Clutch	34	Parts	26
Ignition	35	Steering damper	26
Throttle... ..	34		
ELECTRICAL		GRIPS	
Battery	41	Dummy	33
Battery carrier	31	Twist	33
Cable clips	42		
Dynamo	10	GUARDS	
Horn	41	Chaincase (front)	30
Lamp, Head	41	Chainguard (rear)	31
Lamp, Rear	41	Mudguard, front	28
Magneto	10	Mudguard, rear	30
Sundries	42	Number plate, front	30
Voltage Regulator	40	Number plate, rear	30
ENGINE		LEVERS	
Big-end bearings	6	Air	34
Connecting rods	6	Brake	34
Crankcase	5	Clutch	34
Crankshaft	6	Ignition	34
Cylinders	6		
Cylinder heads	6	LUBRICATION	
Gaskets	15	Distributor—oil	9
Pistons	6	Filter—oil	9
Push rods	7	Pumps—oil	9
Re-boring	7	Valve—oil relief	10
Rockers	7	Valve—oil release	10
Steady stay	9		
Timing	7		
Valves	6		