

SPARES LIST

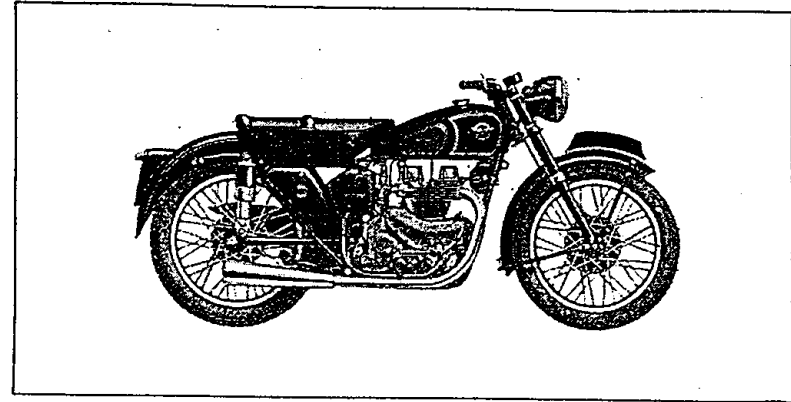

MATCHLESS "SUPER CLUBMAN"

VERTICAL TWIN

Bore 66 m.m.

Stroke 72.8 m.m.

Capacity 498 c.c.

1953



Compiled and Issued by the Manufacturers

MATCHLESS MOTOR CYCLES

(Proprietors : ASSOCIATED MOTOR CYCLES LIMITED)

This scan is intended for personal use and not for resale

(1) TERMS OF BUSINESS.

Our terms are :— CASH WITH ORDER,
CASH AGAINST PRO-FORMA INVOICE, OR
APPROVED LEDGER ACCOUNT.

Customers who wish to avoid delay can open deposit accounts and the usual deposit is £5.

Orders from abroad should be accompanied by a remittance to cover the costs of goods and postal charges.

We do not send goods by "CASH ON DELIVERY" (C.O.D.).

(2) PRICES AND SPECIFICATIONS.

All prices, specifications and conditions are subject to alteration without notice. The prices of spares do not include the costs of packing and carriage.

(3) CARRIAGE AND PACKING.

All invoices for spare parts will be SURCHARGED by 2½ PER CENT. to cover the cost of packing and postage, or carriage, and the minimum surcharge is sixpence. (Home orders only.)

A special packing case, or crate, is required for some spares to ensure freedom from damage in transit. In such circumstances a special charge for the value of the case, or crate, will be made in addition to the 2½ per cent. surcharge but the special charge will be credited in full if the container is promptly returned to our factory carriage paid and in good condition.

(4) HOW TO ORDER SPARES.

STATE :— (a) The Model of the machine.
(b) The complete engine number. (See paragraph 5.)
(c) The frame number. (See paragraph 5.)
(d) The part numbers of the spares required.
(e) A description of each spare.
(f) The quantity required of each item.
(g) How the spares are to be sent. (Post, Parcels Post, Passenger train or Goods train.)
(h) Your full name and address. These particulars are best written in BLOCK LETTERS.
(i) Mention if, or not, you have an account with us.

ALSO :— Unless you have a deposit or ordinary account, enclose a remittance to cover the cost of the spares plus the 2½ per cent. surcharge. (See paragraph 3.)

When cash is sent any excess will be refunded without prior application.

NOTE :— When sending orders by telegram or cable do not omit your name and address from the message.

(5) IDENTITY.

To ensure the supply of correct spares it is essential we can identify the machine for which they are required. The ONLY WAY to do that is for us to know the COMPLETE ENGINE and frame numbers.

The engine number is stamped on the crankcase, IN FRONT OF THE LEFT CYLINDER, and may have one or more letters incorporated in it. THE COMPLETE NUMBER MUST BE QUOTED.

The frame number is stamped on the right-hand side of the frame lug that is below the saddle.

(6) SERVICE.

The SERVICE AND REPAIR DEPARTMENT is situated in BURRAGE GROVE, PLUMSTEAD, LONDON, S.E.18, and is open on Mondays to Fridays from 8.30 a.m. to 12.55 p.m.—2 p.m. to 5.30 p.m. It is closed on Saturdays, Sundays and National Holidays.

It exists for the purpose of :—

- (a) Giving technical assistance verbally or through the Post.
- (b) Supplying spare parts over the counter or through the Post.
- (c) Repairing and re-conditioning machines, or parts of machines, of our make.

If it is considered necessary to bring a machine, or parts, to the factory for an urgent repair IT IS ESSENTIAL you make an appointment beforehand to avoid disappointment. This can be done by letter or telephone.

(7) REPAIRS.

The instructions regarding repairs should be clear and definite, otherwise the cost may be greater than that expected. We shall be pleased to give estimates for repairs if parts are sent to us for that purpose. If the estimate is accepted, no charge is made for the preliminary examination, but, should it be decided not to have the work carried out, it may be necessary to make a charge to cover the cost of whatever dismantling and re-assembly may have been done to prepare the estimate.

(8) REPAIRS TO PROPRIETARY FITTINGS.

We do not repair carburettors, chains, electrical equipment, saddles, sparking plugs, speedometers and tyres. On page 80 of the "MAINTENANCE MANUAL AND INSTRUCTION BOOK" will be found the names and addresses of the manufacturers of the proprietary equipment we fit, all of whom service and repair equipment they make.

(9) PATTERNS.

Parts sent to us as patterns, or for repair, should have attached to them a label bearing the sender's full name and address. The instructions regarding such parts should be sent under separate cover.

(10) GUARANTEE.

All parts made by us, and sold as spares, are subject to the same Limited Guarantee as that issued with each new motor cycle and that guarantee is printed in full on Page 85 of the "MAINTENANCE MANUAL AND INSTRUCTION BOOK."

(11) INSTRUCTION BOOK.

A "MAINTENANCE MANUAL AND INSTRUCTION BOOK" (Edition CM-24) has been compiled and published by us.

One copy is supplied free, upon application, with each new motor cycle. Replacement copies are two shillings and sixpence each.

(12) CORRESPONDENCE.

Our routine is organised into different departments. Therefore delay cannot be avoided if matters relating to more than one department are contained in one letter.

Consequently when communicating with more than one department it is desirable to do so on SEPARATE SHEETS. Each sheet should bear the sender's name and address. IN PARTICULAR, requests for TECHNICAL ADVICE should not be on the same sheets as ORDERS FOR SPARE PARTS.

MATCHLESS MOTOR CYCLES,
PLUMSTEAD, LONDON, S.E.18.

NOTE

The numbers, in brackets, that appear in the "Description" columns relate to the numbered foot notes regarding items so specially indicated.

The quantities per machine of each item are entered in the "Qty." columns. "R" indicates as may be required.

The illustrations are not to scale and are not necessarily accurate in detail.

Some items are not illustrated.

ALL PRICES, EXCEPT THOSE MARKED *,
ARE SUBJECT TO 20% INCREASE.

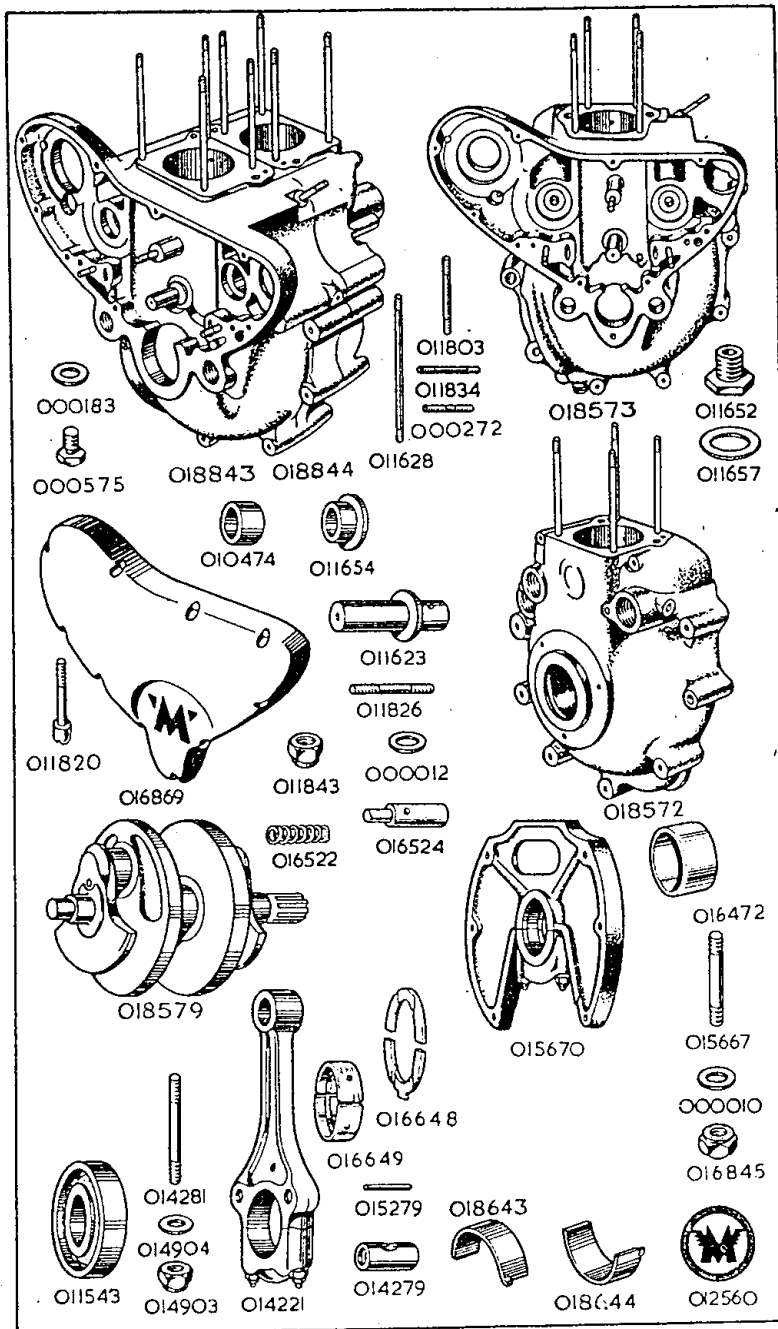

PART NUMBER	DESCRIPTION	QTY. OFF	PRICE EACH £ s. d.
-------------	-------------	----------	--------------------

CRANKCASE

018843	... Crankcase, complete (1)	1	18 3 5
018572	... Crankcase, driving side only (2)	1	5 3 6
018573	... Crankcase, timing side only (3)	1	8 14 0
015670	... Web, centre, with cap. studs, washers and nuts (no bearing and thrust washers)	1	14 6
016869	... Cover, for timing gear	1	15 10
012560	... Badge, monogram, for driving side crankcase	1	4 3
011826	... Stud, fixing centre web, 1 1/2 in. by 1/2 in. by 26 and 20	6	3
000012	... Washer, plain, for centre web top fixing studs	2	1
000012	... Washer, plain, for centre web centre fixing studs	2	1
000012	... Washer, plain, for centre web bottom fixing studs	2	1
011843	... Nut, for centre web fixing studs	6	5
015667	... Stud, for centre web bearing cap, 2 1/4 ins. by 3/8 in. by 20 and 20	2	11
000010	... Washer, plain, for centre web bearing cap stud	2	1
016845	... Nut, for centre web bearing cap stud	2	3
011628	... Stud, in driving side crankcase, for cylinder and head, 5 7/8 ins. by 7/8 in. by 26 and 22	4	2 9
011628	... Stud, in timing side crankcase, for cylinder and head, 5 7/8 ins. by 7/8 in. by 26 and 22	4	2 9
011834	... Stud, in timing side crankcase, for pump carrying plate, 1 1/2 in. by 1/4 in. by 26 and 22	3	3
000272	... Stud, in timing side crankcase, for fixing magneto, 1 1/2 in. by 7/8 in. by 26 and 22	2	4
011803	... Stud, in timing side crankcase, for dynamo strap, 1 1/2 in. by 1/2 in. by 26 and 20	1	3
011623	... Shaft, in timing side crankcase, for intermediate gear	1	5 9
000575	... Plug, drain, for timing side crankcase	1	6
000183	... Washer, fibre, for crankcase drain plug	1	3
011820	... Screw, retaining timing gear cover	10	6
011652	... Adaptor, to accommodate oil feed and return pipe retaining banjo pins. (Screws into timing side crankcase)	2	1 10
011657	... Washer, fibre, for banjo pin adaptors	2	1
010474	... Bush, plain, for camshafts. (In driving side crankcase)	2	2 3
011654	... Bush, flanged, for camshafts. (In timing side crankcase)	4	3 3
016472	... Tunnel, for camshaft chamber (fits between crankcase halves)	2	8
011648	... Cap, in crankcase housing for inlet camshaft	1	2 2
011642	... Washer, fibre, for crankcase housing cap	1	2

1.—Includes:—Driving crankcase. Timing crankcase, centre web with studs (no bearing and washers). Bushes for camshafts. Cylinder studs. Shaft for intermediate gear. Cam follower spindles. Studs for pump plate. Two magneto studs. Dynamo strap stud. Timing gear cover and screws. Monogram badge. Three bolts. One stud. Two nuts. Five washers.

2.—Includes:—Two camshaft bushes. Four cylinder studs. Cam follower spindles. Six studs for centre web. (No badge.)

3.—Includes:—Four camshaft bushes. Four cylinder studs. Shaft for intermediate gear. Three studs for pump plate. Two studs for magneto. One stud for dynamo strap. (No timing gear cover and screws.)

WHEN IN DOUBT REGARDING THE NAMES AND PART NUMBERS OF THE PARTS YOU REQUIRE, PLEASE SEND THE OLD PARTS TO SERVE AS PATTERNS.

PART NUMBER	DESCRIPTION	QTY. OFF	PRICE EACH £ s. d.
CRANKSHAFT, CONNECTING RODS AND BEARINGS			
018579	... Crankshaft, plugged, but bare	1	9 8 6
016649	... Bearing, plain, for centre bearing (in halves)	1	5 8
016648	... Washer, thrust, for centre bearing	2	10
011543	... Bearing, roller, for crankshaft. (Parts of this bearing not sold separately), $1\frac{3}{8}$ in. internal, 3 ins. external, $\frac{1}{16}$ in. wide. Manufacturers part number RLS-12 $\frac{1}{2}$	2	1 4 6
014221	... Rod, connecting, assembly. (No big end bearing)	2	3 1 0
014281	... Stud, for connecting rod, $2\frac{3}{4}$ ins. by $\frac{3}{8}$ in. by 26	4	9
014279	... Trunnion, for connecting rod	4	2 6
015279	... Rivet, locating connecting rod stud	4	2
014904	... Washer, plain, for connecting rod stud	4	1
014903	... Nut, for connecting rod stud	4	6
018643	... Bearing, plain, for connecting rod. (Big-end) top half	2	2 3
018644	... Bearing, plain, for connecting rod. (Big-end) bottom half	2	5 9

The following undersize bearings (in pairs) can be supplied. It is necessary to have the journals ground to suit.

016670	... Bearing, plain, for centre bearing, .010 in. Undersize (2 halves)	1	5 8
018671	... Bearing, plain, for connecting rod, .010 in. Undersize top half	2	3 4
018564	... Bearing, plain, for connecting rod .010 in. Undersize bottom half	2	8 7

CYLINDERS, PISTONS, HEADS AND VALVES

011713	... Cylinder	2	2 10 0
011716	... Washer, paper, for cylinder base	2	1
015518	... Piston, bare, normal size	2	17 6
015803	... Piston, bare, .020 in. oversize	2	17 6
018024	... Piston, bare, .040 in. oversize	2	17 6
015804	... Piston, complete, normal size	2	1 8 9
015805	... Piston, complete, .020 in. oversize	2	1 8 9
018025	... Piston, complete, .040 in. oversize	2	1 8 9

The above complete pistons include:—

Piston, two compression rings (1 chrome plated), one scraper ring.
Gudgeon pin, two circlips for gudgeon pin.

018297	... Ring, compression, chrome plated, normal size	2	3 9
018298	... Ring, compression, chrome plated, .020 in. oversize	2	3 9
018299	... Ring, compression, chrome plated, .040 in. oversize	2	3 9
010631	... Ring, compression, normal size	2	1 3
015522	... Ring, compression, .020 in. oversize	2	1 3
016441	... Ring, compression, .040 in. oversize	2	1 3
010632	... Ring, scraper, normal size	2	1 7
015523	... Ring, scraper, .020 in. oversize	2	1 7
016442	... Ring, scraper, .040 in. oversize	2	1 7
011731	... Pin, gudgeon	2	4 2
014283	... Circlip, for gudgeon pin	4	3
018738	... Head, for cylinder, bare, left	1	4 12 6
018740	... Head, for cylinder, bare, right	1	4 12 6
018755	... Head, for cylinder, with valve guides, guide circlips and manifold studs, left	1	4 18 2
018756	... Head, for cylinder, with valve guides, guide circlips and manifold studs, right	1	4 18 2

BY USING GENUINE SPARES YOU ARE ASSURED THEY
WILL FIT ACCURATELY AND GIVE SATISFACTORY SERVICE

PART NUMBER	DESCRIPTION	QTY. OFF	PRICE EACH £ s. d.
CYLINDERS, PISTONS, HEADS AND VALVES—continued.			
011715	... Gasket, for cylinder head	2	3 6
014163	... Valve, inlet	2	7 6
014165	... Valve, exhaust	2	13 1
011770	... Spring, inner, for valve	4	8
011769	... Spring, outer for valve	4	1 3
014169	... Seat, for valve springs	4	8
014168	... Collar, for valve springs	4	1 9
014167	... Collet, for valve stems (in pairs)	4	11
014170	... Guide, for inlet valves	2	2 6
014171	... Guide, for exhaust valves	2	2 6
011111	... Circlip, locating valve guides	4	1
000004	... Nut, retaining cylinders and heads	8	3
011634	... Spacer, $\frac{3}{4}$ in. long for head retaining nuts	8	3
000011	... Washer, plain, for head retaining nuts	8	1
010625	... Stud, retaining inlet manifold, $1\frac{1}{16}$ in. by $\frac{1}{4}$ in. by 26 and 20	4	3
014352	... Bush, for rocker spindle	4	9

RE-BORING

Cylinders may be re-bored to .020 in. or .040 in. oversize and pistons (with rings) supplied to suit. The charge is £4 19s. 9d.* for the pair, with an additional 11s. 2d.* if new gudgeon pins and circlips are also supplied. Cylinders sent for re-boring should be packed in stout cases which will be used by us for their return. Carriage is additional.
If a complete machine, or engine, is sent to us for cylinder re-boring, there will be an additional charge, according to the time taken, for dismantling and assembly.

TIMING GEAR

011784	... Camshaft, inlet	1	1 11 0
011785	... Camshaft, exhaust	1	1 11 0
011620	... Gear, on camshaft, 60 teeth	2	17 6
000573	... Key, locating camshaft gears	2	4
011653	... Nut, retaining camshaft gears	2	9 9
016209	... Pinion, on camshaft, 30 teeth	1	8 9
016210	... Spacer, $\frac{1}{2}$ in. long, for crankshaft pinion	1	11
000573	... Key, locating crankshaft pinion	1	4
011776	... Bolt, retaining crankshaft pinion, threaded $\frac{1}{2}$ in. by 20	1	9
010589	... Washer, plain, for crankshaft pinion bolt	1	5
011621	... Gear, intermediate, with bush, 60 teeth	1	18 6
015278	... Bush, for intermediate gear	1	10
018576	... Follower, for camshaft	4	12 9
011626	... Spindle, for camshaft followers	2	2 6
011627	... Spacer, $1\frac{1}{2}$ in. long between camshaft followers	2	8
018680	... Spacer, washer	4	5

ROCKERS AND PUSH RODS

014284	... Rocker, with bushes (left inlet and right exhaust)	2	1 2 9
014285	... Rocker with bushes (right inlet and left exhaust)	2	1 2 9
014222	... Spindle for rockers	4	11 3
014226	... Washer, spring, double coil, for rocker spindle	4	1
014275	... Washer, plain, for either side of rocker spindle spring washer	8	2
014275	... Washer, plain, for clamping end of rocker spindle	4	2
011760	... Bolt, clamping rocker spindle. (Thread No. 2 B.A.)	4	1 2
015021	... Washer, plain, for rocker spindle clamping bolt	4	1
011846	... Nut, for rocker spindle clamping bolt	4	3
014245	... Bush, for rockers. (Two in each rocker)	8	7
018623	... Cover, for rockers	4	9 10
018493	... Gasket, for rocker covers	4	4
018492	... Screw, retaining rocker covers	8	11
018517	... Rod, push, assembled with ends	4	6 0
018508	... Rod, push, bare	4	1 8
018518	... End, upper, for push rod	4	2 6
018519	... End, lower, for push rod	4	2 0

PART NUMBER	DESCRIPTION	QTY. OFF	PRICE EACH £ s. d.
OIL FELT FILTER (IN ENGINE)			
014235	... Filter, felt, for engine crankcase	1	6 0
018120	... Seat, for oil felt filter	1	4
014240	... Valve, relief, for oil felt filter	3	9
014241	... Spring, for oil felt filter relief valve	1	2
016179	... Cap, for felt filter housing (also accommodates oil non-return valve)	1	6 9
012116	... Washer, fibre, for filter housing cap	1	1
011645	... Ball, $\frac{3}{8}$ in. steel, for non-return valve	1	2
013564	... Spring, for non-return valve ball	1	2
013332	... Plug, screwed, retaining non-return valve spring	1	8
011642	... Washer, fibre, for non-return valve spring plug	1	1
015034	... Gasket, paper, for oil filter chamber (fits between the two crankcase halves)	1	1

OIL DISTRIBUTOR. (Driven by the left hand end of exhaust camshaft)

014246	... Distributor, oil	1	2 8
014247	... Cap, housing, for oil distributor	1	5 3
011642	... Washer, fibre, for oil distributor housing cap	1	2

OIL RELIEF VALVE. (Located in Timing side crankcase, close to oil feed pump).

016524	... Piston, for oil relief valve	1	10
016522	... Spring, for oil relief valve piston	1	1

GENUINE MATCHLESS SPARES

PURCHASED FROM

AN AUTHORISED "MATCHLESS" DEALER
OR FROM THE FACTORY, ARE IDENTICAL
WITH THE PARTS ORIGINALLY BUILT
INTO YOUR MOTOR CYCLE

MAINTENANCE MANUAL EDITION CM-24 PRICE 2/6
IS THE APPROPRIATE MANUAL FOR THIS SPARES LIST

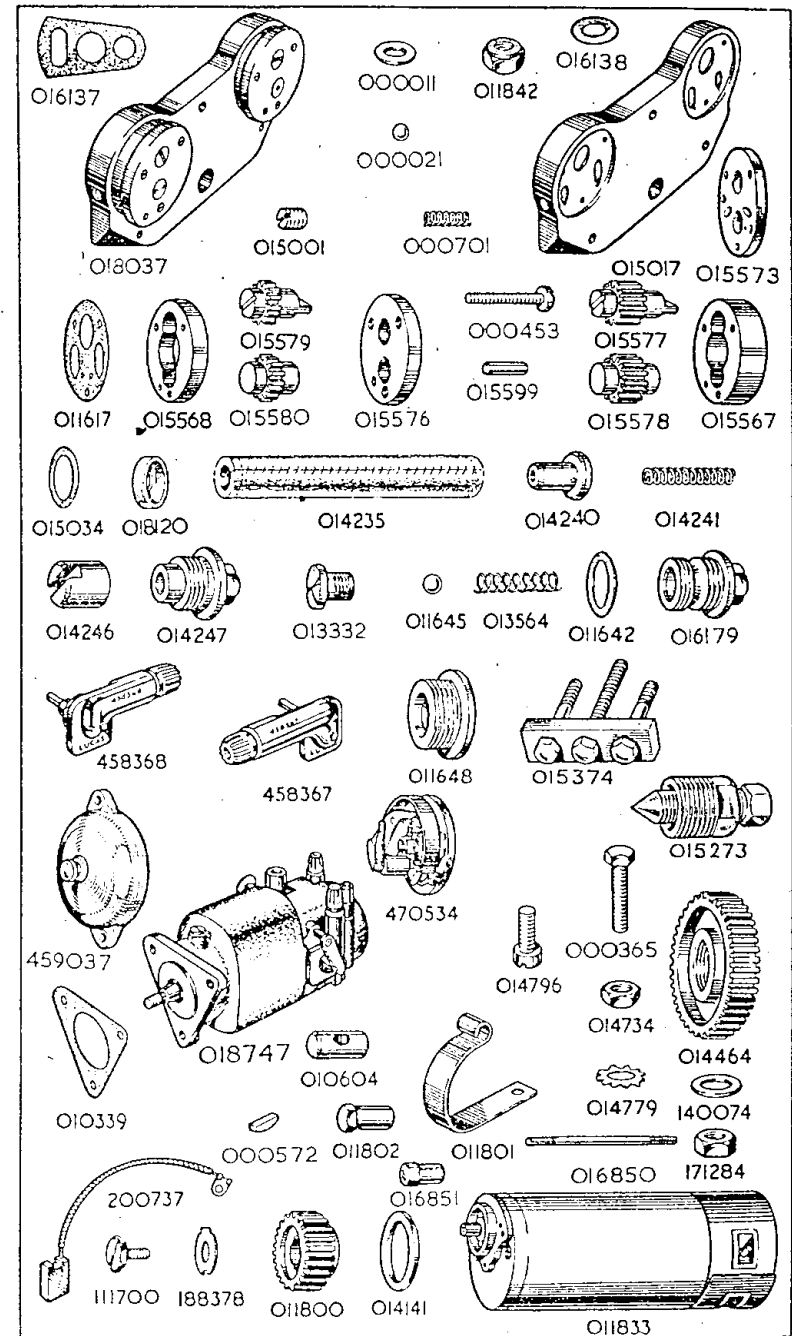

PART NUMBER	DESCRIPTION	QTY. OFF	PRICE EACH £ s. d.
CARBURETTER			
014288	Carburetter, complete (less wires and levers) Type 76AG/1AU	1	2 19 3*
018654	Manifold, inlet, bare (no studs). (The studs are listed with cylinder heads)	1	13 7
000012	Washer, plain, for inlet manifold retaining studs	4	1
000005	Nut, for inlet manifold retaining studs	4	3
011771	Gasket, between inlet manifold and cylinder heads	2	1
016724	Bolt, retaining carburetter to inlet manifold, 4 7/8 ins. by 3/8 in. by 22	2	5
000011	Washer, plain, for carburetter retaining bolts	2	1
018503	Ring, between carburetter and manifold	1	1 0
FLOAT CHAMBER			
64-192-B	Chamber, float, bare	1	14 0*
13-153	Screw, plug, blocking passage in float chamber	1	3*
14-039	Washer, fibre, for float chamber passage plug screw	1	1*
14-208	Top, or cover, for float chamber	3	9*
14-021	Screw, locking float chamber top	1	4*
14-015	Float, bare	3	9*
14-024	Needle, for float	1	6*
14-209	Tickler, bare	1	10*
14-210	Stop, for tickler	1	3*
14-032	Spring, for tickler	1	2*
14-289	Cotter (split pin), for tickler	1	1*
14-035	Banjo, connection, for petrol pipe	3	0*
14-175	Washer, fibre, upper, for petrol banjo connection	1	2*
14-037	Washer, fibre, lower, for petrol banjo connection	1	2*
14-036	Nut, retaining banjo connection to float chamber	1	9*
MIXING BODY			
76-014	Body, mixing, bare	1	14 0*
6-033	Nut, union, for base of mixing body	2	3*
6-040	Washer, fibre, for mixing body union nut	1	2*
4-043	Bolt holding float chamber to mixing body	1	3 0*
4-053	Washer, fibre, for float chamber holding bolt	2	2*
6-038	Intake, air	1	3 0*
6-032	Top, for mixing chamber	1	2 6*
6-031	Ring, fixing top to mixing chamber	1	2 6*
4-235	Clip, locking mixing chamber top fixing ring	1	9*
4-241	Screw, securing locking clip to mixing body top	1	2*
4-035	Adjuster, for control cable, throttle or air	2	6*
CHOKE AND JETS			
6-058	Choke, or jet barrel	1	7 6*
4-061	Needle jet	2	6*
4-042-180	Jet, main, size 180	1	8*
6-065	Needle, taper, for needle jet	2	0*
4-230	Clip, for jet taper needle	1	6*
4-060	Pin, split, locating taper needle clip	1	1*
13-129	Screw, for pilot jet air adjustment	1	9*
4-206	Nut, lock, for pilot jet air screw	1	2*
<i>The following alternative main jets can be supplied.</i>			
4-042-160	Jet, main, size 160	1	8*
4-042-170	Jet, main, size 170	1	8*
4-042-190	Jet, main, size 190	1	8*

BY USING GENUINE SPARES YOU ARE ASSURED THEY
WILL FIT ACCURATELY AND GIVE SATISFACTORY SERVICE

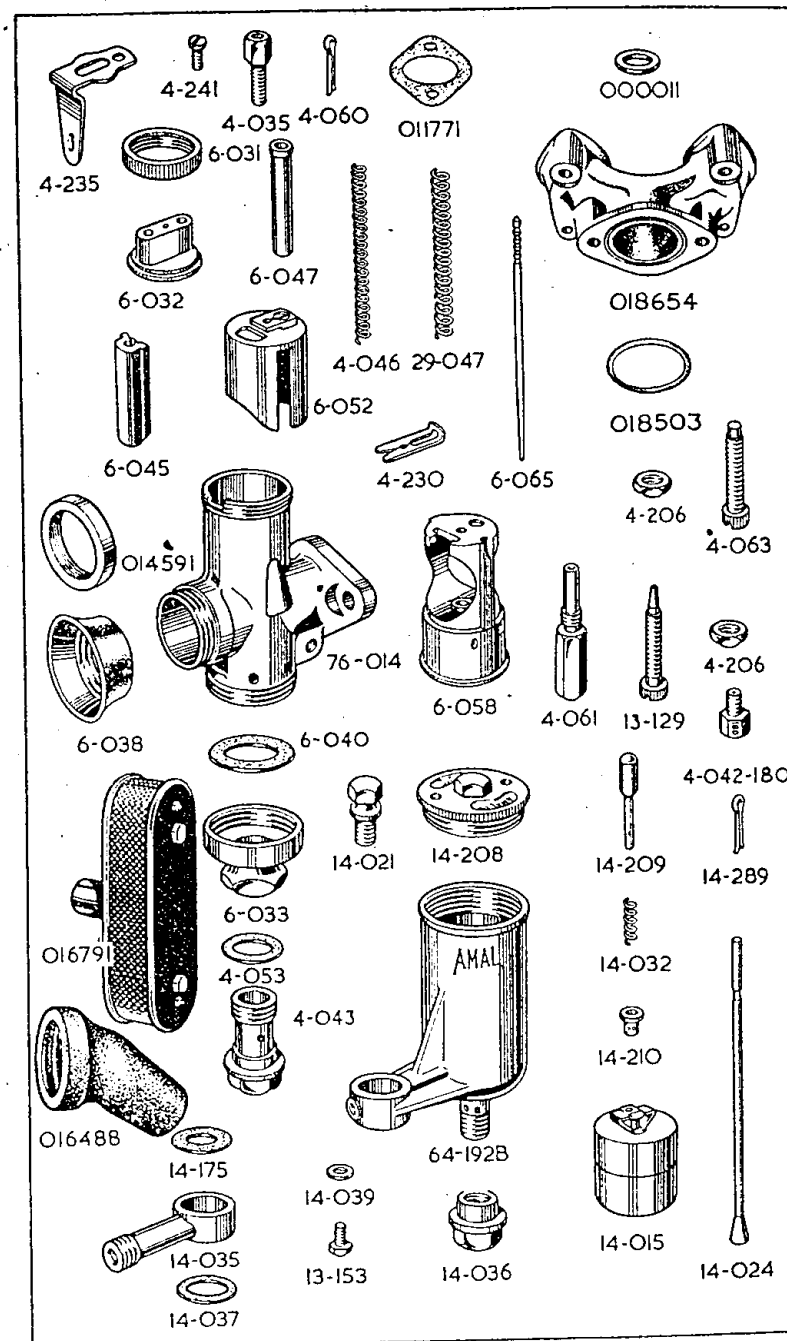

PART NUMBER	DESCRIPTION	QTY. OFF	PRICE EACH £ s. d.
VALVES (CARBURETTER)			
6-052	Valve, throttle, size 6/4	1	6 0*
29-047	Spring, for throttle valve	1	4*
4-063	Screw, stop, for throttle valve	1	9*
4-206	Nut, lock, for throttle valve stop screw	1	2*
6-045	Valve, air	3	9*
6-047	Guide, tubular, for air valve spring	1	0*
4-046	Spring, for air valve	1	4*

AIR CLEANER. (This is optional extra equipment)

016791	Cleaner, air	1	11 6*
014591	Adaptor, for air cleaner (screws on carburetter)	1	1 6*
016488	Sleeve, rubber, connecting air cleaner to carburetter adaptor	1	3 6*
016983	Set of air cleaner elements comprising filter element and two fabric end gaskets	1	8 0*

When an air cleaner is fitted it is essential to:—

(a) Use an adaptor and connector in order to fit the cleaner to carburetter intake. (016791 does not include these.)

(b) Fit a smaller jet, viz., use jet 4-042-160 (size 160), price 8d.

MAGNETO

018747	Magneto, complete, Type K2F (Lucas number 42230-A)	1	10 0 0*
458367	Pick-up, with brush and spring, right	1	5 3*
458368	Pick-up, with brush and spring, left	1	5 3*
470534	Contact breaker, complete	1	4 6*
470609	Contact set	1	8 9*
459037	Cover, for contact breaker with switch	1	6 0*
010339	Gasket, for magneto flange	1	1
000365	Bolt, retaining magneto, 1 1/8 in. by 7/8 in. by 26. For the two magneto retaining studs, see "Crankcase Group."	1	6
014779	Washer, lock, for magneto retaining bolt and studs	3	1
000004	Nut, for magneto retaining bolt and studs	3	3
014464	Gear, on magneto shaft	1	7 0
140074	Washer, plain, on magneto shaft	1	1*
171284	Nut, on magneto shaft, retaining magneto driving gear	1	3*

DYNAMO

011833	Dynamo, Type E3-L-R-0 (Lucas Number 20009-B)	1	6 10 0*
200737	Brush, for dynamo, set of two, per set	1	3 6*
014141	Gasket, between dynamo and crankcase	1	1
011801	Strap, retaining dynamo to crankcase	1	9
014796	Screw, retaining lower end of dynamo strap to crankcase, 7/8 in. by 1/2 in. by 20	1	2
000012	Washer, plain, for dynamo strap retaining screw	1	1
010604	Crosshead, in eye of dynamo retaining strap	1	6
011802	Nut, tensioning dynamo strap. (The stud on which this nut screws, is listed with the crankcase parts)	1	4
000012	Washer, plain, for dynamo strap tensioning nut	1	1
011800	Gear on Dynamo shaft	1	8 6
000572	Key, locating dynamo shaft gear	1	3
111700	Bolt, retaining gear on dynamo shaft	1	10*
188378	Washer, lock, for dynamo gear retaining bolt	1	2*
016850	Stud, drawing dynamo to crankcase, and passing through timing cover, 2 1/2 ins. long by 2 B.A.	1	4
016851	Nut, for dynamo draw stud	1	9

PART NUMBER	DESCRIPTION	QTY. OFF	PRICE EACH £ s. d.
CRANKCASE BOLTS, with engine plates and all bolts passing through same.			
014292	Bolt, clamping crankcase throat, 3 1/4 ins. by 7/8 in. by 22. (These bolts pass through the driving side crankcase and thread into the timing side crankcase)	3	9
000011	Washer, plain, for 014292 crankcase bolts	3	1
013944	Plate, engine front, right side	1	2 0
013943	Plate, engine front, left side	1	2 0
014736	Stud, passing through crankcase and upper holes in engine, front plates, 5 ins. by 7/8 in. by 26. (This stud also supports the stays for the exhaust pipes)	1	5
000174	Washer, plain, for 014736 engine plate stud	2	1
000192	Washer, spring, for 014736 engine plate stud	2	1
000004	Nut, for 014736 engine plate stud	2	3
000278	Stud, passing through crankcase and lower holes in engine front plates, 4 1/2 ins. by 7/8 in. by 26	1	6
000011	Washer, plain, for 000278 engine plate stud	2	1
000004	Nut, for 000278 engine plate stud	2	3
000277	Stud, passing through crankcase at bottom, 4 3/4 ins. by 7/8 in. by 26	1	6
000011	Washer, plain, for 000277 crankcase stud	2	1
000004	Nut for 000277 crankcase stud	2	3
000303	Stud, passing through front of main frame and top of engine front plate, 4 1/2 ins. by 7/8 in. by 26	1	6
000010	Washer, plain, for 000303 frame stud	2	1
000003	Nut, for 000303 frame stud	2	3
014911	Stud, passing through main frame front tube bottom lug, the crankcase, and the front ends of the rear frame rails, 5 1/4 ins. by 7/8 in. by 26	1	1 0
000011	Washer, plain, for 014911 frame stud	2	1
000004	Nut, for 014911 frame stud	2	3
018014	Plate, engine, rear	2	4 3
000278	Stud, passing through top of engine rear plates and the crankcase, 4 1/2 ins. by 7/8 in. by 26	1	6
000278	Stud, passing through bottom of engine rear plates and the crankcase, 4 1/2 ins. by 7/8 in. by 26	1	6
000011	Washer, plain, for 000278 studs	3	1
000004	Nut, for 000278 studs	3	3
000316	Stud, passing through engine rear plates, rear of crankcase, and centre of front chaincase, 7 7/8 ins. by 7/8 in. by 26. (Stud should be fitted so that the longer thread is on left-hand side of machine)	1	1 2
014084	Spacer, 1 1/2 in. long, on 000316 stud, between back of front chaincase and crankcase	1	7
017142	Spacer, 1/2 in. long, on 000316 stud, inside front chaincase	1	4
000220	Nut, thin, on 000316 stud, inside front chaincase	1	6
000009	Washer, plain, for 000316 stud	2	1
000002	Nut, for 000316 stud	2	4
000303	Stud, passing through top of engine, rear plates, lower end of main frame seat tube and rear fork bridge, 4 1/2 ins. by 7/8 in. by 26	1	6
000003	Nut, for 000303 stud	2	3
000278	Stud, passing through rear fork bridge and back ends of engine rear plates, 4 1/2 ins. by 7/8 in. by 26 (The front chain adjusting eye bolt block screws on the right-hand end of this stud.)	1	6
000011	Washer, plain, for 000278 stud	1	1
000004	Nut, for 000278 stud	1	3

For the bolt stud passing through the top and bottom of the gear box and the engine rear plates, see "Gear Box Fixing Bolts".

For the footrest rod, which passes through the bottoms of the engine rear plates and the frame rails, see "Footrests".

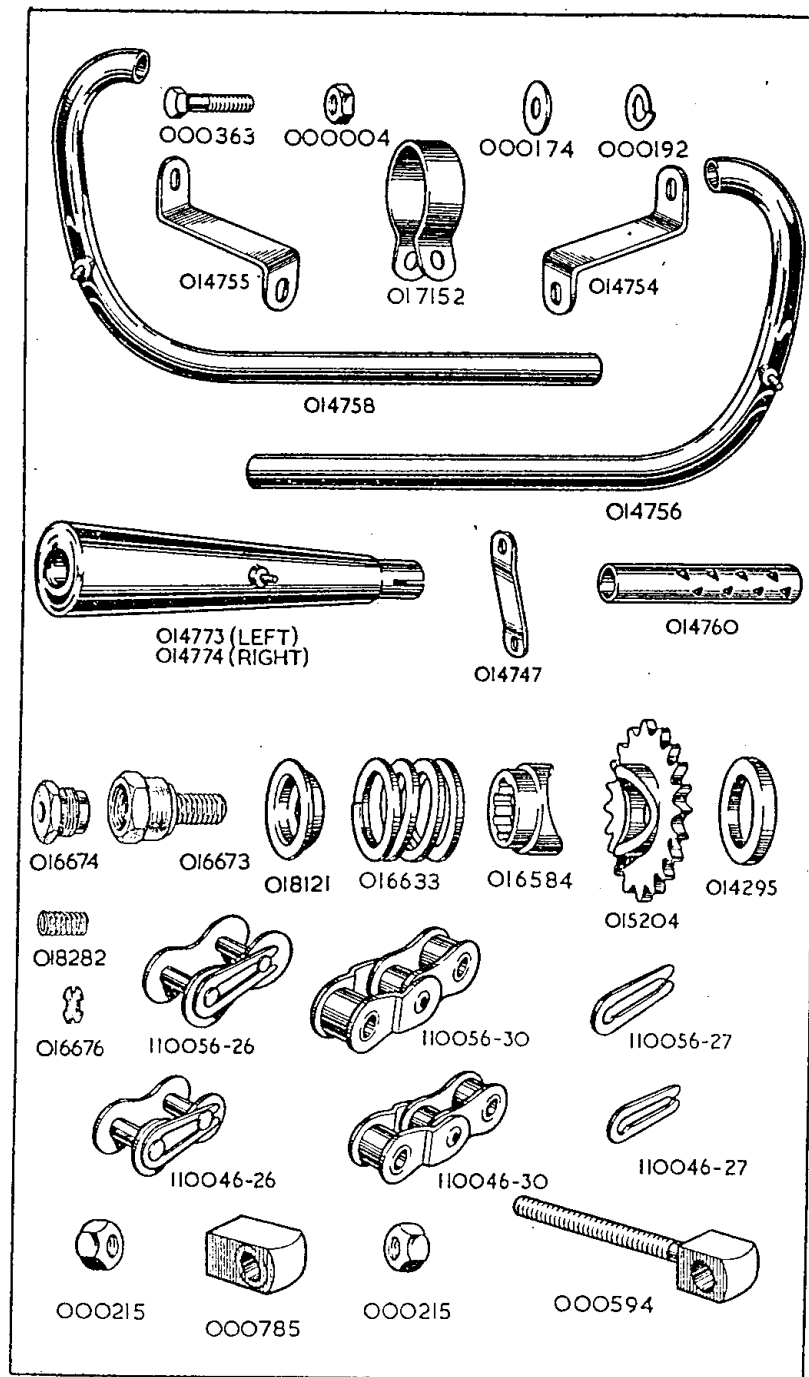

PART NUMBER	DESCRIPTION	QTY. OFF	PRICE EACH £ s. d.
-------------	-------------	----------	--------------------

GASKETS

We supply engine gaskets, either as separate spares, or in complete sets. Single gaskets, are listed in the groups to which they belong. Gaskets in complete sets are listed below

018783	... Complete gasket set for vertical twin engine	1	10 7
018784	... Decarbonising gasket set for vertical twin engine	1	8 8

Each complete gasket set contains:—

- 1—000183 Washer, fibre, for crankcase, drain plug.
- 1—011642 Washer, fibre, for engine filter housing cap.
- 1—011642 Washer, fibre, for oil distributor housing cap.
- 1—011642 Washer, fibre, for crankcase release valve housing cap.
- 2—000183 Washer, fibre, for banjo end of oil pipes.
- 2—011617 Washer, paper, for oil pump bodies.
- 2—011716 Washer, paper, for cylinder bases.
- 1—015034 Washer, paper, for oil filter chamber.
- 1—010339 Gasket, between magneto and crankcase.
- 2—011715 Gasket, for cylinder head.
- 2—011771 Gasket, between inlet manifold and cylinder head.
- 1—014141 Gasket, between dynamo and crankcase.
- 4—018493 Gasket, for rocker covers.
- 2—016137 Gasket, oval, behind pump carrying plate.
- 1—016138 Gasket, round, behind pump carrying plate.

Each decarbonising gasket set includes:—

- 2—011715 Gasket, for cylinder heads.
- 4—018493 Gasket, for rocker covers.
- 2—011771 Gasket, between inlet manifold and cylinder heads.
- 2—011716 Washer, paper, for cylinder bases.

EXHAUST PIPES AND SILENCERS

014756	... Pipe, exhaust, bare, left side	1	3 1
014758	... Pipe, exhaust, bare, right side	1	3 1
014760	... Baffle, for exhaust pipe	2	3 3
014754	... Stay, for exhaust pipe, left side	1	8
014755	... Stay, for exhaust pipe, right side	1	8
000004	... Nut, fixing exhaust pipe to stay	2	3
000174	... Washer, plain, for exhaust pipe fixing nut	2	1
014773	... Silencer, bare, left side	1	10 9
014774	... Silencer, bare, right side	1	10 9
017152	... Clip, clamping silencer to pipe	2	7
000363	... Bolt, for silencer clip, 3/8 in. by 1/4 in. by 26	2	4
000174	... Washer, plain, for silencer clip bolt	2	1
000004	... Nut, for silencer, clip bolt	2	3
014747	... Stay, for silencer	2	7
000004	... Nut, fixing silencer to stay	2	3
000174	... Washer, plain, for silencer to stay fixing nut	2	1
000192	... Washer, spring, for silencer to stay fixing nut	2	1
000004	... Nut, fixing silencer stay to frame rail	2	3
000174	... Washer, plain, for silencer stay to frame rail nut	2	1
000192	... Washer, spring, for silencer stay to frame rail nut	2	1

ALWAYS INCLUDE ALL THE LETTERS WHEN QUOTING THE ENGINE NUMBER

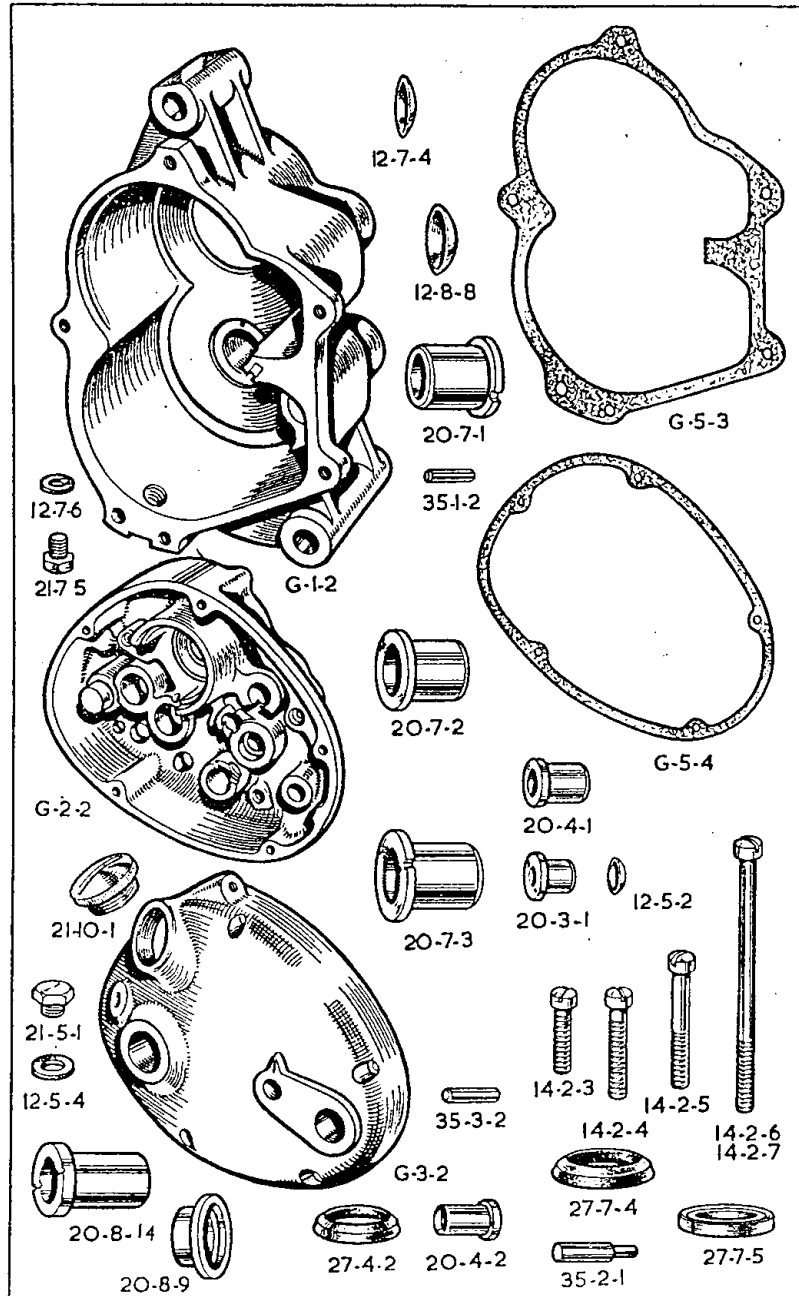

PART NUMBER	DESCRIPTION	QTY. OFF	PRICE EACH £ s. d.
-------------	-------------	----------	-----------------------

ENGINE SPROCKETS (and Crankcase Release Valve)

016665	... Sprocket, engine, bare, 18 teeth (for sidecar use only)	1	0 2
015203	... Sprocket, engine, bare, 19 teeth	1	2 8
015204	... Sprocket, engine, bare, 20 teeth. (This is the standard sprocket)	1	2 8
014294	... Sprocket, engine, bare, 21 teeth	1	2 8
014295	... Spacer (collar), $\frac{3}{8}$ in. wide, for engine sprocket	1	3 9
016584	... Cam, engine shock absorber	1	12 0
016633	... Spring, engine shock absorber	1	3 1
018121	... Cap, for engine shock absorber spring	1	1 9
016673	... Bolt, locking shock absorber assembly, threaded $\frac{1}{2}$ in. by 20. (Also houses crankcase release valve)	1	2 2
016676	... Diaphragm, for crankcase release valve	1	1
018282	... Spring, for crankcase release valve diaphragm	1	2
016674	... Plug, retaining crankcase release valve. (Screws into bolt 016673)	1	10

CHAINS

017298	... Chain, front, 66 links, $\frac{1}{2}$ in. by .305 in.	1	1 1 1
017375	... Chain, rear, 96 links, $\frac{5}{8}$ in. by .380 in.	1	2 5 0*
110046-26	... Link, connecting, for $\frac{5}{8}$ in. chains	R	8*
110056-26	... Link, connecting, for $\frac{3}{4}$ in. chains	R	11*
110046-30	... Link, cranked, double, for $\frac{1}{2}$ in. chains	R	1 2*
110056-30	... Link, cranked, double, for $\frac{3}{8}$ in. chains	R	1 7*
110046-27	... Clip, spring, for 110046-26 connecting links ($\frac{5}{8}$ in.)	R	1 $\frac{1}{2}$ *
110056-27	... Clip, spring, for 110056-26 connecting links ($\frac{3}{4}$ in.)	R	2*

The prices of front and rear chains include spring connecting links and these are also included in the number of links per chain.

We do not sell odd lengths of chains.

GEAR BOX

016709	... Gear, box complete, with clutch and with kick-starter and gear control levers	1	★
--------	---	---	---

★ Price on application.

GEAR BOX FIXING PARTS

010957	... Bolt, gearbox top fixing, $5\frac{1}{4}$ ins. by $\frac{7}{8}$ in. by 26	1	2 0
000318	... Stud, gearbox bottom fixing, $4\frac{3}{4}$ ins. by $\frac{7}{8}$ in. by 26	1	10
012999	... Spacer, $\frac{7}{8}$ in. wide, on top bolt, outside right	1	4
000002	... Nut, for gearbox top fixing bolt	1	4
000002	... Nut, for gearbox bottom fixing stud	2	4
000009	... Washer, plain, for top fixing bolt, left side	1	1
000594	... Eye-bolt, for front chain adjustment	1	1 3
000215	... Nut, for front chain adjustment eye-bolt	2	4
000785	... Block, crosshead, for front chain adjustment eye-bolt. (This threads on the right hand end of 000278 stud that passes through the rear of the engine rear plates and the top of the rear fork bridge)	1	1 0

GEAR BOX SHELL

G-1-2	... Shell, gearbox, bare	1	2 5 0*
21-7-5	... Plug, drain, for gearbox shell	1	9*
12-7-6	... Washer, fibre, for gearbox shell drain plug	1	1*
12-7-4	... Cap, in shell, covering bore for selector spindles	2	3*
35-3-2	... Pin, dowel, locating, kick-starter case on gearbox shell	1	4*
G-2-2	... Case, kick-starter	1	1 5 0*
G-5-3	... Washer, paper, between shell and kick-starter case	1	1*

PART NUMBER	DESCRIPTION	QTY. OFF	PRICE EACH £ s. d.
-------------	-------------	----------	-----------------------

GEAR BOX SHELL—continued.

G-3-2	... Cover, for kick-starter case.....	1	5 0*
G-5-4	... Washer, paper, between kick-starter case and cover.....	1	1*
28-12-19	... Piece, locating, between kick-starter case and cover.....	1	6*
35-1-1	... Pin, dowel, locating fixed cam-plate in kick-starter case.....	2	3*
21-10-1	... Cap, filler, for kick-starter case cover.....	1	3 0*
21-5-1	... Plug, oil level, in kick-starter case cover.....	1	9*
12-5-4	... Washer, fibre, for oil level plug.....	1	1*
35-2-1	... Pin, anchor, in cover, for kick-starter spring.....	1	6*
14-2-3	... Screw, 7/8 in. under head.....	1	6*
14-2-4	... Screw, 1 1/2 in. under head.....	3	9*
14-2-5	... Screw, 1 1/2 in. under head.....	2	9*
14-2-6	... Screw, 2 1/2 ins. under head.....	1	1 0*
14-2-7	... Screw, 3 1/2 ins. under head.....	1	1 0*

Above screws have cheese heads and are threaded 1/4 in. Whit.

SHAFTS AND GEARS

G-18-2	... Mainshaft, for gearbox.....	1	7 6*
G-19-2	... Layshaft, for gearbox.....	1	10 0*
G-6-2	... Gear, driving, mainshaft, with bushes, 28 teeth.....	1	2 8 0*
G-12-2	... Gear, first, mainshaft, 17 teeth.....	1	15 0*
G-10-2	... Gear, second, mainshaft, 22 teeth.....	1	18 6*
G-8-1	... Gear, third, mainshaft, 25 teeth.....	1	1 0*
G-7-2	... Pinion, on layshaft, 18 teeth.....	1	15 0*
G-13-2	... Gear, first, layshaft, with bush, 29 teeth.....	1	1 0*
G-11-2	... Gear, second, layshaft, with bush, 24 teeth.....	1	1 0*
G-9-1	... Gear, third, layshaft, 21 teeth.....	1	18 6*
19-8-13	... Bush, for mainshaft driving gear.....	2	3 0*
19-8-15	... Bush, for mainshaft third gear.....	1	5 0*
19-8-15	... Bush, for layshaft second gear.....	1	5 0*
19-8-14	... Bush, for layshaft first gear.....	1	5 0*

GEARBOX BEARINGS, CAPS AND OIL-SEALS

38-11-1	... Bearing, ball, 1 1/2 in. by 62 mm. by 16 mm. for driving gear on mainshaft.....	1	2 6*
27-12-2	... Oil-seal, for driving gear bearing.....	1	4 6*
39-12-1	... Housing, for driving gear bearing oil-seal.....	2	6*
31-12-2	... Ring, split, retaining driving gear bearing.....	1	6*
38-7-1	... Bearing, ball 17 mm. by 40 mm. by 12 mm. for mainshaft (kick-starter end).....	1	18 9*
12-11-3	... Spacer, 1/4 in. wide, for mainshaft ball bearing.....	2	3*
31-11-1	... Ring, split, retaining mainshaft ball bearing.....	1	6*
20-7-1	... Bush, for layshaft (clutch end) (-843 in. long).....	1	6 0*
35-1-2	... Pin, dowel, locating layshaft bush.....	1	2*
12-8-8	... Cap, in shell, covering bore, for layshaft.....	1	4*
20-7-3	... Bush, for layshaft (kick-starter end) (-779 in. long).....	1	6 0*
35-1-2	... Pin, dowel, locating layshaft bush.....	1	2*
20-7-2	... Bush, in kick-starter case, for kick-starter spindle.....	3	0*
20-8-14	... Bush, in cover, for kick-starter spindle.....	3	0*
27-7-5	... Oil-seal, in cover bush, for kick-starter spindle.....	3	6*
20-4-1	... Bush, in kick-starter case, for cam spindle.....	2	6*
20-4-2	... Bush, kick-starter case cover.....	2	0*
27-4-2	... Oil-seal, in cover bush, for cam spindle.....	1	3*
20-3-1	... Bush, in kick-starter case, for control quadrant spindle.....	1	6*
12-5-2	... Cap, in kick-starter case, covering bore for control quadrant spindle.....	1	1*
20-8-9	... Bush, in cover, for control quadrant spindle.....	2	6*
27-7-4	... Oil-seal, in cover bush, for control quadrant spindle.....	1	4*

GEARBOX SMALL SPROCKET

G-31-1	... Sprocket, gearbox, 16 teeth by 1/2 in. by 380 in.....	1	2 6*
28-12-16	... Collar, spacing, gearbox sprocket, -435 in. wide.....	1	6*
12-11-1	... Washer, lock, for gearbox sprocket nut.....	1	9*
11-11-1	... Nut, fixing gearbox sprocket to driving gear.....	1	2 7*

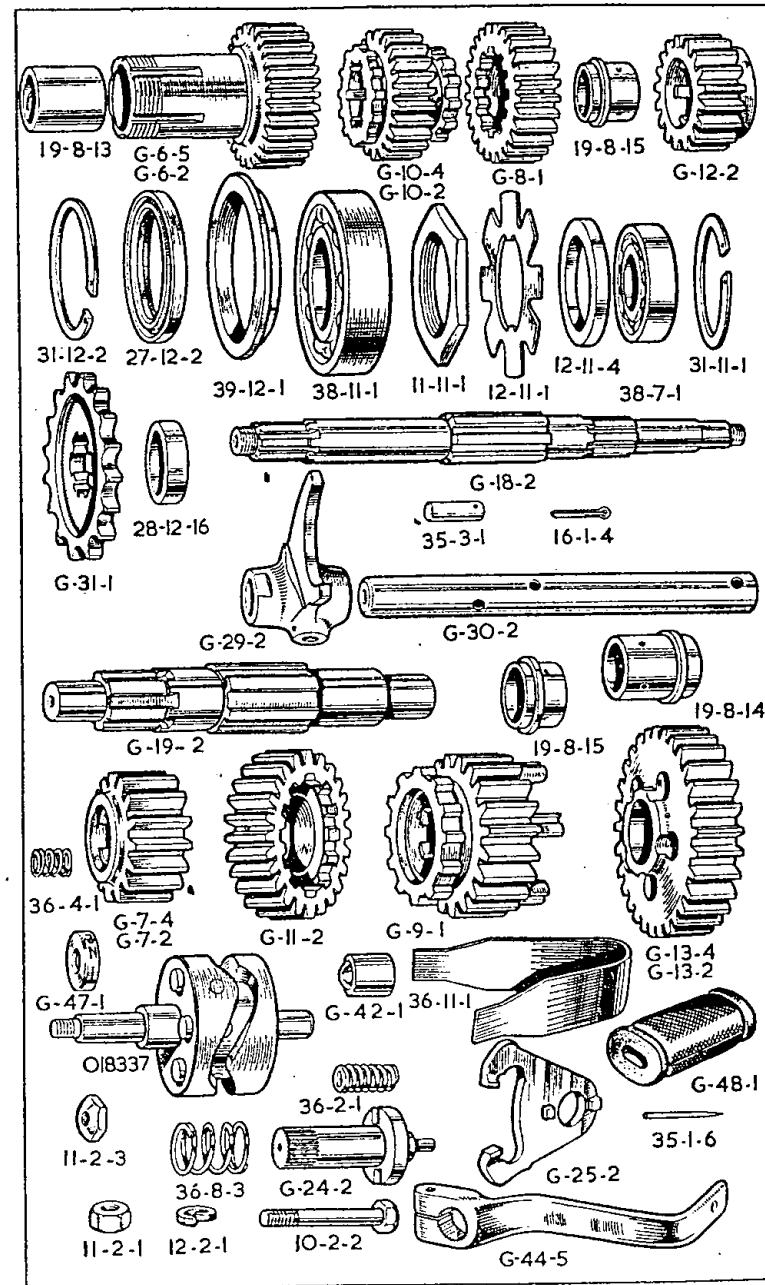

PART NUMBER	DESCRIPTION	QTY. OFF	PRICE EACH £ s. d.
-------------	-------------	----------	--------------------

GEAR OPERATING PARTS

G-30-2	Spindle, for selector forks.....	2	7 6*
G-29-2	Fork, for gear selection.....	2	10 0*
35-3-1	Peg, for selector spindles.....	4	6*
16-1-4	Pin, cotter, for selector spindle pegs.....	4	1*
018337	Cam, assembly.....	1	10 0*

The cam assembly comprises:—

- 1—G-27-2 Spindle.
- 1—G-28-1 Cam.
- 3—35-2-4 Pegs.
- 1—35-2-2 Locating pegs.
- 2—35-1-4 Cam stop pegs.

(Above parts not sold as separate spares)

G-42-1	Plunger, locating cam assembly.....	1	2 0*
36-2-1	Spring, for cam assembly locating plunger.....	1	6*
G-25-2	Quadrant, for control spindle.....	1	7 6*
35-2-6	Peg, quadrant drive.....	1	3*
G-24-2	Spindle, for gear control quadrant.....	12	6*
36-1-1	Spring, primary, for control quadrant.....	2	0*
36-8-3	Spring, secondary, for control quadrant.....	1	6*
G-47-1	Indicator.....	1	9*
36-4-1	Spring under indicator.....	1	3*
11-2-3	Nut, retaining indicator.....	1	3*
G-44-5	Lever, foot, for gear control.....	11	3*
G-48-1	Pad, rubber, for gear foot lever.....	1	1*
35-1-6	Pin, fixing gear foot lever rubber pad.....	1	1*
10-2-2	Bolt, clamping gear foot lever.....	1	10*
12-2-1	Washer, spring, for gear foot lever bolt.....	1	1*
11-2-1	Nut, for gear foot lever bolt.....	1	3*

CLUTCH

G-36-3	Case, for five plate clutch.....	1	18 0*
29-2-4	Rivet, for clutch case and chainwheel.....	8	2*
G-34-2	Chainwheel, 40 teeth by $\frac{1}{2}$ in. by .305 in.....	1	10 0*
018339	Case and chainwheel, assembled (five plate).....	2	11 0*
G-35-2	Sleeve, for mainshaft.....	1	17 0*
12-10-2	Race, roller, for clutch bearing chainwheel.....	1	3 0*
18-2-1	Rollers, for chainwheel bearing.....	price per set of 24	5 3*
12-10-3	Washer, thin, chainwheel bearing.....	1	1 1*
12-10-4	Washer, thick, chainwheel bearing.....	1	1 1*
G-37-3	Centre, for five plate clutch.....	1	10 0*
12-7-7	Washer, plain, for centre retaining nut.....	1	4*
12-7-5	Washer, lock, for centre retaining nut.....	1	9*
11-7-11	Nut, retaining clutch centre.....	1	9*
G-39-4	Plate, clutch, plain, steel.....	6	3 0*
G-40-6	Plate, clutch, friction, with Inserts.....	5	12 6*
G-41-1	Inserts, fabric, for friction plate.....	price per dozen/20	2 6*
G-38-2	Plate, clutch, spring pressure.....	1	13 6*
25-7-3	Cup thrust, for spring pressure plate.....	1	1 0*
11-7-8	Nut, lock, for pressure plate thrust cup.....	1	6*
14-2-8	Stud, for clutch spring, 2 ins. long (five plate clutch).....	5	6*
36-6-1	Spring, for clutch.....	5	9*
G-42-2	Cup, for clutch spring.....	5	9*
11-2-2	Nut, adjusting, for clutch spring.....	5	6*

CLUTCH OPERATING PARTS

37-3-1	Rod, thrust, 10 $\frac{1}{8}$ ins. long (five plate clutch).....	1	1 6*
17-3-2	Ball, $\frac{1}{8}$ in., steel, for clutch thrust rod.....	1	1*
G-32-2	Cam-plate, fixed, actuating clutch.....	1	2 0*
G-33-3	Cam-plate, moving, actuating clutch.....	1	2 6*
35-3-4	Dowel, thrust (passes through both cam-plates).....	1	6*
12-2-4	Washer, plain, for cam-plate dowel.....	1	1*
36-2-3	Spring, for cam-plate dowel.....	1	3*
16-1-5	Pin, split, for cam-plate dowel.....	1	1*
17-3-2	Ball, $\frac{1}{8}$ in., steel, for cam-plates.....	3	1*

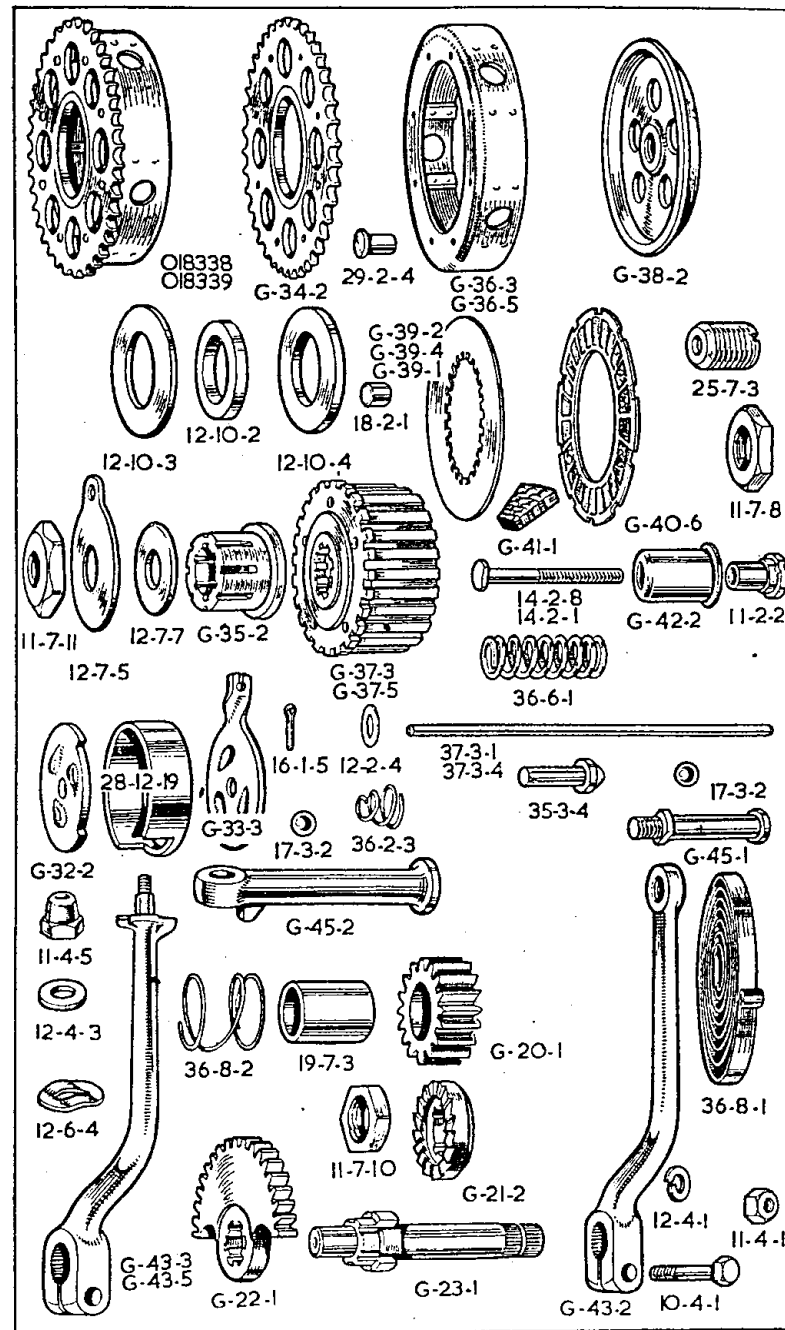

PART NUMBER	DESCRIPTION	QTY. OFF	PRICE EACH	
			£	s. d.

KICK-STARTER

G-21-2	... Ratchet, driving, kick-starter.....	1	8	8*
G-20-1	... Pinion, ratchet, kick-starter.....	1	12	0*
19-7-3	... Bush, kick-starter ratchet pinion.....	1	3	9*
36-8-2	... Spring, kick-starter ratchet pinion.....	1	1	1*
11-7-10	... Nut, retaining ratchet driver to mainshaft.....	1	6	6*
G-23-1	... Spindle, for kick-starter quadrant.....	1	11	3*
G-22-1	... Quadrant, for kick-starter.....	1	15	9*
018340	... Kick-starter quadrant and spindle assembled.....	1	7	0*
36-8-1	... Spring, return, for kick-starter foot lever.....	1	4	0*
G-43-2	... Lever, foot, kick-starter, bare.....	1	15	9*
G-45-1	... Pin, pedal, rigid, for kick-starter lever.....	1	4	6*
10-4-1	... Bolt, clamping, kick-starter foot lever to spindle.....	1	1	1*
12-4-1	... Washer, spring, for foot lever clamping bolt.....	1	9	9*
11-4-1	... Nut, for foot lever clamping bolt.....	1	2	2*

FRONT FRAME

018703	... Frame, front portion only, bare	1	6	5	3
000806	... Race, ball, for frame head lug.....	2	3	10	
000072	... Balls, $\frac{7}{8}$ in. diameter, for steering head, per set of.....	56	1	7	
000051	... Nipple, grease, for frame head lug.....	1	5		
014478	... Stud, for seat lug (below saddle), $4\frac{1}{2}$ ins. by $\frac{1}{2}$ in. by 26.....	1	11		
000008	... Washer, plain, for seat lug stud.....	2	1		
000001	... Nut, for seat lug stud.....	2	4		
000015	... Screw, securing earth wires (screws into end of stud 014478) $\frac{3}{8}$ in. by 3 B.A.....	1	1		
000185	... Washer, plain, for STD.15 earth wire screw.....	1	1		

REAR FRAME

014359	... Rail, frame, right side.....	1	2	0	0
014360	... Rail, frame, left side	1	2	3	4
018051	... Loop, rear frame	1	4	1	0
014512	... Stud, for rear loop at bottom, 12 ins. by $\frac{7}{8}$ in. by 26. (Also passes through rear fork bridge and both frame rails).....	1	4	4	
000002	... Nut, for rear loop bottom stud.....	2	4		
000009	... Washer, plain, for rear loop bottom stud.....	2	1		
018617	... Tube, supporting rear of rear mudguard, right side.....	1	6	3	
018616	... Tube, supporting rear of rear mudguard, left side.....	1	6	3	
000343	... Bolt, fixing mudguard support tube to mudguard, $1\frac{1}{2}$ in. by $\frac{1}{2}$ in. by 26.....	4	3		
018648	... Bolt, fixing mudguard support tube to frameloop (also fixes top end of rear leg).....	2	1	4	
<i>If a carrier is fitted the above 018648 bolts are discarded and bolt 014521 used. See Carrier page 31.</i>					
000012	... Washer, plain, for mudguard support tube bolt.....	4	1		
000191	... Washer, spring, for mudguard support tube bolt.....	4	1		
000005	... Nut, for mudguard support tube bolt.....	4	3		
015329	... Bridge, for rear fork (includes bushes and studs for centre stand spring clip).....	1	2	3	8
014672	... Bush, for rear fork bridge.....	2	7		
000250	... Stud, for rear fork bridge $\frac{3}{4}$ in. by 2 B.A.....	2	3		
016768	... Stud, $1\frac{1}{2}$ in. by $\frac{7}{8}$ in. by 26 by 26, for oil tank, battery carrier and air cleaner retention.....	2	4		
018641	... Stud, $1\frac{1}{2}$ in. by $\frac{7}{8}$ in. by 26 by 26, for oil tank, battery carrier and air cleaner retention, drilled for split pin.....	1	6		
000174	... Washer, plain, for 016768 stud.....	3	1		
000004	... Nut, for 016768 stud.....	3	3		
000014	... Pin, split, for 018641 stud.....	1	1		

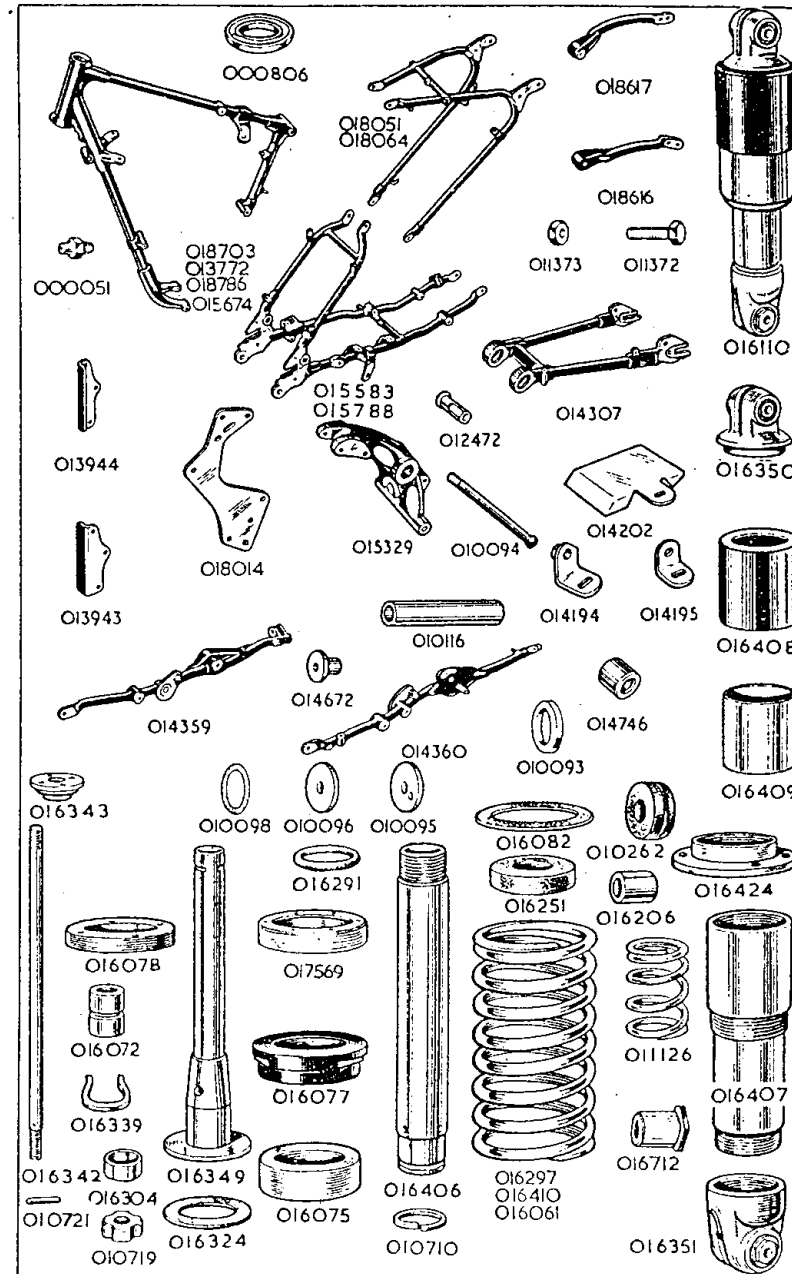

PART NUMBER	DESCRIPTION	QTY. OFF	PRICE EACH		
			£	s.	d.
REAR FORK					
014307	... Fork, rear	1	4	1	7
011372	... Pin, chain, adjusting, for right fork end	1	7
011373	... Nut, lock, for chain adjusting pin	1	2
014746	... Sleeve, assembly (bushed)	2	...	5	6
010116	... Tube	1	...	5	0
010095	... Cap, for rear fork bearing, right side	1	...	1	0
010096	... Cap, for rear fork bearing, left side	1	6
010093	... Washer, felt, for rear fork bearing	2	10
010098	... Gasket, for rear fork bearing caps	2	1
010094	... Spoke, for rear fork bearing (central tie bolt)	1	4
012472	... Nipple, for rear fork bearing spoke	1	4
000485	... Screw, plug, for oil, in end cap, $\frac{1}{4}$ in. by $\frac{1}{4}$ in. by 26	1	1
000203	... Washer, fibre, for oil plug screw	1	1

TELEDRAULIC REAR LEG

016110	... Leg, TELEDRAULIC, rear complete assembly (no fixing bolts, washers and nuts)	2	...	5	7	8
016350	... Pivot, top, assembled (this assembly includes the next three items)	2	...	15	9	
016059	... Pivot, top, bare	2	...	14	9	
010262	... Bush, rubber, for top pivot	4	3	
016206	... Spacer, for top pivot rubber bush	4	3	
016351	... Pivot, bottom, assembled (this assembly includes the next five items)	2	...	11	10	
016060	... Pivot, bottom, bare	2	...	10	6	
010262	... Bush, rubber, for bottom pivot	4	3	
016206	... Spacer, for bottom pivot rubber bush	2	3	
016712	... Nut, with sleeve, for bottom pivot bolt	2	6	
016873	... Washer, plain, for 016712 sleeve nut	2	1	
016406	... Tube, inner (fits in top pivot recess)	2	...	10	2	
016291	... Ring, sealing inner tube at top	2	...	1	0	
016075	... Bush, lower end of inner tube	2	...	2	9	
010710	... Circlip, retaining inner tube bush	2	1	
016407	... Tube, outer (screws into bottom pivot)	2	...	19	4	
016324	... Washer, sealing lower end of outer tube	4	1	
016077	... Bush, for outer tube	2	...	1	8	
017569	... Oil-seal, between inner and outer tubes	2	...	5	3	
016078	... Collar, retaining oil-seal	2	...	1	9	
016349	... Tube, for damper	2	...	6	6	
016072	... Sleeve, plunger, for damper rod	2	6	
016339	... Clip, locating plunger sleeve	2	1	
016342	... Rod, for damper	2	...	1	0	
016343	... Collar, for top end of damper rod	2	0	
000074	... Nut, locking collar top-end of damper rod	2	3	
016304	... Valve, for damper	2	...	1	0	
010721	... Pin, stop, for damper valve	2	1	
010719	... Seat, for damper valve	2	3	
000005	... Nut, retaining damper seat to damper rod	2	3	
011126	... Spring buffer	2	10	
016297	... Spring, main	2	...	5	0	
016061	... Spring, main (sidecar)	2	...	9	8	
016082	... Washer, leather, at both ends of main spring	4	3	
016408	... Tube, outer, covering top end of main spring	2	...	7	3	
016409	... Tube, outer, covering bottom end of main spring	2	...	5	10	
016424	... Nut, retaining bottom outer cover tube	2	...	6	3	
016251	... Buffer, for TELEDRAULIC Leg	2	11	
018648	... Bolt, fixing top pivot, $3\frac{1}{8}$ ins. by $\frac{3}{8}$ in. by 26	2	...	1	4	
014521	... Bolt, fixing top pivot (replaces 018648 when carrier is fitted)	2	...	1	4	
000010	... Washer, plain, for top pivot bolt	4	1	
016712	... Nut for top pivot bolt	2	6	
016359	... Bolt, fixing bottom pivot, $2\frac{1}{8}$ ins. by $\frac{3}{8}$ in. by 26	2	7	
000010	... Washer, plain, for bottom pivot bolt	2	1	

BEFORE ORDERING
 PLEASE NOTE THE INFORMATION GIVEN ON PAGES
 TWO AND THREE

PART NUMBER	DESCRIPTION	QTY. OFF	PRICE EACH		
			£	s.	d.

FORK ASSEMBLIES

The following fork assemblies are complete and include ball races for the fork crown and top head lug (but not the two frame ball races).

018766	... Fork, assembly (TELEDRAULIC Front Fork, Solo)	1	...	15	17	6
018769	... Fork, assembly (TELEDRAULIC Front Fork, Sidecar)	1	...	16	3	9

For ease of servicing, the inner tube unit and damper unit are listed and supplied as separate assemblies. This enables a complete assembly to be exchanged in minimum time. The units are listed below.

018582	... Front fork inner tube assembly, Solo	2	...	2	12	6
018770	... Front fork inner tube assembly, Sidecar	2	...	2	13	9

The above assemblies comprise:—

Inner tubes with rubber buffers, bushes and circlips, top bolts with washers and sealing rings, slider extensions with oil seals, fork springs and washers.

018328	... Front fork damper assembly	2	...	10	1	
--------	--------------------------------	---	-----	----	---	--

The above assembly comprises:—

Rod and two nuts, damper tube with valve, seat and pin, sleeve and clip and bottom fixing bolt with washer.

FRONT FORK

018540	... Crown, assembly, comprising crown, stem and circlip (these parts not sold separately)	1	...	1	17	0
000805	... Race, ball, for fork crown	1	3	9
018649	... Screw, pinch, for fork crown	2	1	4
018309	... Lug, for handlebar and steering head	1	...	1	16	6
012620	... Race, ball, for handlebar lug	1	3	8
000051	... Nipple, grease, for handlebar lug	1	5	
000236	... Nut, adjusting, for fork crown stem	1	8	
010712	... Nut, lock (domed), for fork crown stem	1	2	10
016322	... Tube, fork, inner	2	...	1	3	8
016148	... Buffer, rubber, for fork inner tube	6	5	
010692	... Bush, bottom, for fork inner tube	2	4	1
010710	... Circlip, for fork inner tube bush	2	1	
016718	... Bolt, top, for fork inner tube	2	2	0
014355	... Ring, sealing, for fork inner tube top bolt	2	3	
010709	... Washer, plain, for fork inner tube top bolt	2	4	
018310	... Slider, fork, with cap, studs and nuts, left and right	2	...	1	17	4
013589	... Cap, for fork slider	2	4	1
010713	... Stud, securing fork slider cap, $1\frac{1}{8}$ in. by $\frac{7}{16}$ in. by 26 and 22	4	4	
000011	... Washer, plain, for fork slider cap stud	4	1	
000004	... Nut, for fork slider cap stud	4	3	
018214	... Extension, for fork slider	2	6	9
015286	... Bush, plastic, for fork inner tube	2	2	6
017569	... Oil-seal, for fork inner tube (rubber)	2	5	3
010718	... Oil-seal, for fork inner tube (alternative to 017569 and made of leather)	2	5	3
014297	... Washer, under oil-seal (must only be used under leather oil-seal 010718)	2	2	
016526	... Spring, main, for front fork, solo	2	5	0
016782	... Spring, main, for front fork, sidecar	2	6	3
010360	... Spring, buffer, for front fork	2	1	1
010698	... Washer, leather, fork spring seating	4	3	
018538	... Tube, fork cover, top, right, with lamp lug	1	8	6
018537	... Tube, fork cover, top, left, with lamp lug	1	8	6
010703	... Cap, for top of fork top cover tubes	2	1	2
018216	... Seat (rubber), for cover tube	2	7	
018215	... Cap, for bottom of fork top cover tube	2	1	2
018539	... Tube fork cover, bottom	2	4	10
000485	... Screw, plug, oil drain, for fork slider, $\frac{1}{4}$ in. by $\frac{1}{4}$ in. by 26	2	1	
000203	... Washer, fibre, for fork slider screw oil plug	2	1	
015932	... Tube, fork damper	2	5	2
010697	... Bolt, fixing fork damper to slider $\frac{7}{16}$ in. by $\frac{7}{16}$ in. by 26	2	10	
010706	... Washer, fibre, for damper tube bolt	2	1	

PART NUMBER	DESCRIPTION	QTY. OFF	PRICE EACH		
			£	s.	d.
REAR FORK					
014307	... Fork, rear	1	4	1	7
011372	... Pin, chain, adjusting, for right fork end	1			7
011373	... Nut, lock, for chain adjusting pin	1			2
014746	... Sleeve, assembly (bushed)	2	5		6
010116	... Tube	1	5		0
010095	... Cap, for rear fork bearing, right side	1	1		0
010096	... Cap, for rear fork bearing, left side	1			6
010093	... Washer, felt, for rear fork bearing	2			10
010098	... Gasket, for rear fork bearing caps	2			1
010094	... Spoke, for rear fork bearing (central tie bolt)	1			4
012472	... Nipple, for rear fork bearing spoke	1			4
030485	... Screw, plug, for oil, in end cap, $\frac{1}{4}$ in. by $\frac{1}{2}$ in.	1			1
000203	... Washer, fibre, for oil plug screw	1			1

TELEDAULIC REAR LEG

016110	... Leg, TELEDAULIC, rear complete assembly (no fixing bolts, washers and nuts)	2	5	7	8
016350	... Pivot, top, assembled (this assembly includes the next three items)	2	15		9
016059	... Pivot, top, bare	2	14		9
010262	... Bush, rubber, for top pivot	4			3
016206	... Spacer, for top pivot rubber bush	4			3
016351	... Pivot, bottom, assembled (this assembly includes the next five items)	2	11		10
016060	... Pivot, bottom, bare	2	10		6
010262	... Bush, rubber, for bottom pivot	4			3
016206	... Spacer, for bottom pivot rubber bush	2			3
016712	... Nut, with sleeve, for bottom pivot bolt	2			6
016873	... Washer, plain, for 016712 sleeve nut	2			1
016406	... Tube, inner (fits in top pivot recess)	2	10		2
016291	... Ring, sealing inner tube at top	2	1		0
016075	... Bush, lower end of inner tube	2	2		9
010710	... Circlip, retaining inner tube bush	2			1
016407	... Tube, outer (screws into bottom pivot)	2	19		4
016324	... Washer, sealing lower end of outer tube	4			1
016077	... Bush, for outer tube	2	1		8
017569	... Oil-seal, between inner and outer tubes	2	5		3
016078	... Collar, retaining oil-seal	2	1		9
016349	... Tube, for damper	2	6		6
016072	... Sleeve, plunger, for damper rod	2			6
016339	... Clip, locating plunger sleeve	2			1
016342	... Rod, for damper	2	1		0
016343	... Collar, for top end of damper rod	2	1		0
000074	... Nut, locking collar top end of damper rod	2			3
016304	... Valve, for damper	2	1		0
010721	... Pin, stop, for damper valve	2			1
010719	... Seat, for damper valve	2			3
000005	... Nut, retaining damper seat to damper rod	2			3
011126	... Spring, buffer	2			10
016297	... Spring, main	2	5		0
016061	... Spring, main (sidecar)	2	9		8
016062	... Washer, leather, at both ends of main spring	4			3
016403	... Tube, outer, covering top end of main spring	2	7		3
016409	... Tube, outer, covering bottom end of main spring	2	5		10
016424	... Nut, retaining bottom outer cover tube	2	6		3
016251	... Buffer, for TELEDAULIC Leg	2			11
018648	... Bolt, fixing top pivot, $3\frac{1}{4}$ ins. by $\frac{3}{8}$ in. by 26	2	1		4
014521	... Bolt, fixing top pivot (replaces 018648 when carrier is fitted)	2	1		4
000010	... Washer, plain, for top pivot bolt	4			1
016712	... Nut for top pivot bolt	2			6
016359	... Bolt, fixing bottom pivot, $2\frac{1}{2}$ ins. by $\frac{3}{8}$ in. by 26	2			7
000010	... Washer, plain, for bottom pivot bolt	2			1

BEFORE ORDERING
PLEASE NOTE THE INFORMATION GIVEN ON PAGES
TWO AND THREE

PART NUMBER	DESCRIPTION	QTY. OFF	PRICE EACH		
			£	s.	d.
FORK ASSEMBLIES					
<i>The following fork assemblies are complete and include ball races for the fork crown and top head lug (but not the two frame ball races).</i>					
018766	... Fork, assembly (TELEDAULIC Front Fork, Solo)	1	15	17	6
018769	... Fork, assembly (TELEDAULIC Front Fork, Sidecar)	1	16	3	9
<i>For ease of servicing, the inner tube unit and damper unit are listed and supplied as separate assemblies. This enables a complete assembly to be exchanged in minimum time. The units are listed below.</i>					
018582	... Front fork inner tube assembly, Solo	2	2	12	6
018770	... Front fork inner tube assembly, Sidecar	2	2	13	9
<i>The above assemblies comprise:—</i>					
<i>Inner tubes with rubber buffers, bushes and circlips, top bolts with washers and sealing rings, slider extensions with oil seals, fork springs and washers.</i>					
018328	... Front fork damper assembly	2	10		1
<i>The above assembly comprises:—</i>					
<i>Rod and two nuts, damper tube with valve, seat and pin, sleeve and clip and bottom fixing bolt with washer.</i>					
FRONT FORK					
018540	... Crown, assembly, comprising crown, stem and circlip (these parts not sold separately)	1	1	17	0
000805	... Race, ball, for fork crown	1			3
018649	... Screw, pinch, for fork crown	2			4
018309	... Lug, for handlebar and steering head	1	1	16	6
012620	... Race, ball, for handlebar lug	1			3
000051	... Nipple, grease, for handlebar lug	1			5
000236	... Nut, adjusting, for fork crown stem	1			8
010712	... Nut, lock (domed), for fork crown stem	1			2
016322	... Tube, fork, inner	2	1	3	8
016148	... Buffer, rubber, for fork inner tube	6			5
010692	... Bush, bottom, for fork inner tube	2	4		1
010710	... Circlip, for fork inner tube bush	2			1
016718	... Bolt, top, for fork inner tube	2	2		0
014355	... Ring, sealing, for fork inner tube top bolt	2			3
010709	... Washer, plain, for fork inner tube top bolt	2			4
018310	... Slider, fork, with cap, studs and nuts, left and right	2	1	17	4
013589	... Cap, for fork slider	2			1
010713	... Stud, securing fork slider cap, $1\frac{1}{4}$ in. by $\frac{7}{16}$ in. by 26 and 22	4			1
000011	... Washer, plain, for fork slider cap stud	4			1
000004	... Nut, for fork slider cap stud	4			3
018214	... Extension, for fork slider	2			6
015286	... Bush, plastic, for fork inner tube	2	2		6
017569	... Oil-seal, for fork inner tube (rubber)	2			5
010718	... Oil-seal, for fork inner tube (alternative to 017569 and made of leather)	2			5
014297	... Washer, under oil-seal (must only be used under leather oil-seal 010718)	2			2
016526	... Spring, main, for front fork, solo	2			5
016782	... Spring, main, for front fork, sidecar	2			6
010360	... Spring, buffer, for front fork	2			1
010698	... Washer, leather, fork spring seating	4			3
018538	... Tube, fork cover, top, right, with lamp lug	1	8		6
018537	... Tube, fork cover, top, left, with lamp lug	1	8		6
010703	... Cap, for top of fork top cover tubes	2			1
018216	... Seat (rubber), for cover tube	2			7
018215	... Cap, for bottom of fork top cover tube	2			1
018539	... Tube fork cover, bottom	2	4		10
000485	... Screw, plug, oil drain, for fork slider, $\frac{1}{2}$ in. by $\frac{1}{2}$ in. by 26	2			1
000203	... Washer, fibre, for fork slider screw oil plug	2			1
015932	... Tube, fork damper	2	5		2
010697	... Bolt, fixing fork damper to slider $\frac{7}{16}$ in. by $\frac{7}{16}$ in. by 26	2			10
010706	... Washer, fibre, for damper tube bolt	2			1

PART NUMBER	DESCRIPTION	QTY. OFF	PRICE EACH £ s. d.
REAR FORK			
014307	... Fork, rear	1	4 1 7
011372	... Pin, chain, adjusting, for right fork end	1	7
011373	... Nut, lock, for chain adjusting pin	1	2
014746	... Sleeve, assembly (bushed)	2	5 6
010116	... Tube	1	5 0
010095	... Cap, for rear fork bearing, right side	1	1 0
010096	... Cap, for rear fork bearing, left side	1	6
010093	... Washer, felt, for rear fork bearing	2	10
010098	... Gasket, for rear fork bearing caps	2	1
010094	... Spoke, for rear fork bearing (central tie bolt)	1	4
012472	... Nipple, for rear fork bearing spoke	1	4
000485	... Screw, plug, for oil, in end cap, ¼ in. by ¼ in. by 26	1	1
000203	... Washer, fibre, for oil plug screw	1	1
TELEDRAULIC REAR LEG			
016110	... Leg, TELEDRAULIC, rear complete assembly (no fixing bolts, washers and nuts)	2	5 7 8
016350	... Pivot, top, assembled (this assembly includes the next three items)	2	15 9
016059	... Pivot, top, bare	2	14 9
010262	... Bush, rubber, for top pivot	4	3
016206	... Spacer, for top pivot rubber bush	4	3
016351	... Pivot, bottom, assembled (this assembly includes the next five items)	2	11 10
016050	... Pivot, bottom, bare	2	10 6
010262	... Bush, rubber, for bottom pivot	4	3
016206	... Spacer, for bottom pivot rubber bush	2	3
016712	... Nut, with sleeve, for bottom pivot bolt	2	6
016873	... Washer, plain, for 016712 sleeve nut	2	1
016406	... Tube, inner (fits in top pivot recess)	2	10 2
016291	... Ring, sealing inner tube at top	2	1 0
016075	... Bush, lower end of inner tube	2	2 9
010710	... Circlip, retaining inner tube bush	2	1
016407	... Tube, outer (screws into bottom pivot)	2	19 4
016324	... Washer, sealing lower end of outer tube	4	1
016077	... Bush, for outer tube	2	1 8
017569	... Oil-seal, between inner and outer tubes	2	5 3
016078	... Collar, retaining oil-seal	2	1 9
016349	... Tube, for damper	2	6 6
016072	... Sleeve, plunger, for damper rod	2	6
016339	... Clip, locating plunger sleeve	2	1
016342	... Rod, for damper	2	1 0
016343	... Collar, for top end of damper rod	2	1 0
000074	... Nut, locking collar top-end of damper rod	2	3
016304	... Valve, for damper	2	1 0
010721	... Pin, stop, for damper valve	2	1
010719	... Seat, for damper valve	2	3
000005	... Nut, retaining damper seat to damper rod	2	3
011126	... Spring buffer	2	10
016297	... Spring, main	2	5 0
016061	... Spring, main (sidecar)	2	9 8
016082	... Washer, leather, at both ends of main spring	4	3
016408	... Tube, outer, covering top end of main spring	2	7 3
016409	... Tube, outer, covering bottom end of main spring	2	5 10
016424	... Nut, retaining bottom outer cover tube	2	6 3
016251	... Buffer, for TELEDRAULIC Leg	2	11
018648	... Bolt, fixing top pivot, 3½ ins. by ¾ in. by 26	2	1 4
014521	... Bolt, fixing top pivot (replaces 018648 when carrier is fitted)	2	1 4
000010	... Washer, plain, for top pivot bolt	4	1
016712	... Nut for top pivot bolt	2	6
016359	... Bolt, fixing bottom pivot, 2½ ins. by ¾ in. by 26	2	7
000010	... Washer, plain, for bottom pivot bolt	2	1

BEFORE ORDERING
PLEASE NOTE THE INFORMATION GIVEN ON PAGES
TWO AND THREE

PART NUMBER	DESCRIPTION	QTY. OFF	PRICE EACH £ s. d.
FORK ASSEMBLIES			
<i>The following fork assemblies are complete and include ball races for the fork crown and top head lug (but not the two frame ball races).</i>			
018766	... Fork, assembly (TELEDRAULIC Front Fork, Solo)	1	15 17 6
018769	... Fork, assembly (TELEDRAULIC Front Fork, Sidecar)	1	16 3 9
<i>For ease of servicing, the inner tube unit and damper unit are listed and supplied as separate assemblies. This enables a complete assembly to be exchanged in minimum time. The units are listed below.</i>			
018582	... Front fork inner tube assembly, Solo	2	2 12 6
018770	... Front fork inner tube assembly, Sidecar	2	2 13 9
<i>The above assemblies comprise:—</i>			
<i>Inner tubes with rubber buffers, bushes and circlips, top bolts with washers and sealing rings, slider extensions with oil seals, fork springs and washers.</i>			
018328	... Front fork damper assembly	2	10 1
<i>The above assembly comprises:—</i>			
<i>Rod and two nuts, damper tube with valve, seat and pin, sleeve and clip and bottom fixing bolt with washer.</i>			
FRONT FORK			
018540	... Crown, assembly, comprising crown, stem and circlip (these parts not sold separately)	1	1 17 0
000805	... Race, ball, for fork crown	1	3 9
018649	... Screw, pinch, for fork crown	2	1 4
018309	... Lug, for handlebar and steering head	1	1 16 6
012620	... Race, ball, for handlebar lug	1	3 8
000051	... Nipple, grease, for handlebar lug	1	5
000236	... Nut, adjusting, for fork crown stem	1	8
010712	... Nut, lock (domed), for fork crown stem	1	2 10
016322	... Tube, fork, inner	2	1 3 8
016148	... Buffer, rubber, for fork inner tube	6	5
010692	... Bush, bottom, for fork inner tube	2	4 1
010710	... Circlip, for fork inner tube bush	2	1
016718	... Bolt, top, for fork inner tube	2	2 0
014355	... Ring, sealing, for fork inner tube top bolt	2	3
010709	... Washer, plain, for fork inner tube top bolt	2	4
018310	... Slider, fork, with cap, studs and nuts, left and right	2	1 17 4
013589	... Cap, for fork slider	2	4 1
010713	... Stud, securing fork slider cap, 1½ in. by 7/8 in. by 26 and 22	4	4
000011	... Washer, plain, for fork slider cap stud	4	1
000004	... Nut, for fork slider cap stud	4	3
018214	... Extension, for fork slider	2	6 9
015286	... Bush, plastic, for fork inner tube	2	2 6
017569	... Oil-seal, for fork inner tube (rubber)	2	5 3
010718	... Oil-seal, for fork inner tube (alternative to 017569 and made of leather)	2	5 3
014297	... Washer, under oil-seal (must only be used under leather oil-seal 010718)	2	2
016526	... Spring, main, for front fork, solo	2	5 0
016782	... Spring, main, for front fork, sidecar	2	6 3
010360	... Spring, buffer, for front fork	2	1 1
010698	... Washer, leather, fork spring seating	4	3
018538	... Tube, fork cover, top, right, with lamp lug	1	8 6
018537	... Tube, fork cover, top, left, with lamp lug	1	8 6
010703	... Cap, for top of fork top cover tubes	2	1 2
018216	... Seat (rubber), for cover tube	2	7
018215	... Cap, for bottom of fork top cover tube	2	1 2
018539	... Tube fork cover, bottom	2	4 10
000485	... Screw, plug, oil drain, for fork slider, ½ in. by ¼ in. by 26	2	1
000203	... Washer, fibre, for fork slider screw oil plug	2	1
015932	... Tube, fork damper	2	5 2
010697	... Bolt, fixing fork damper to slider 7/8 in. by 7/8 in. by 26	2	10
010706	... Washer, fibre, for damper tube bolt	2	1

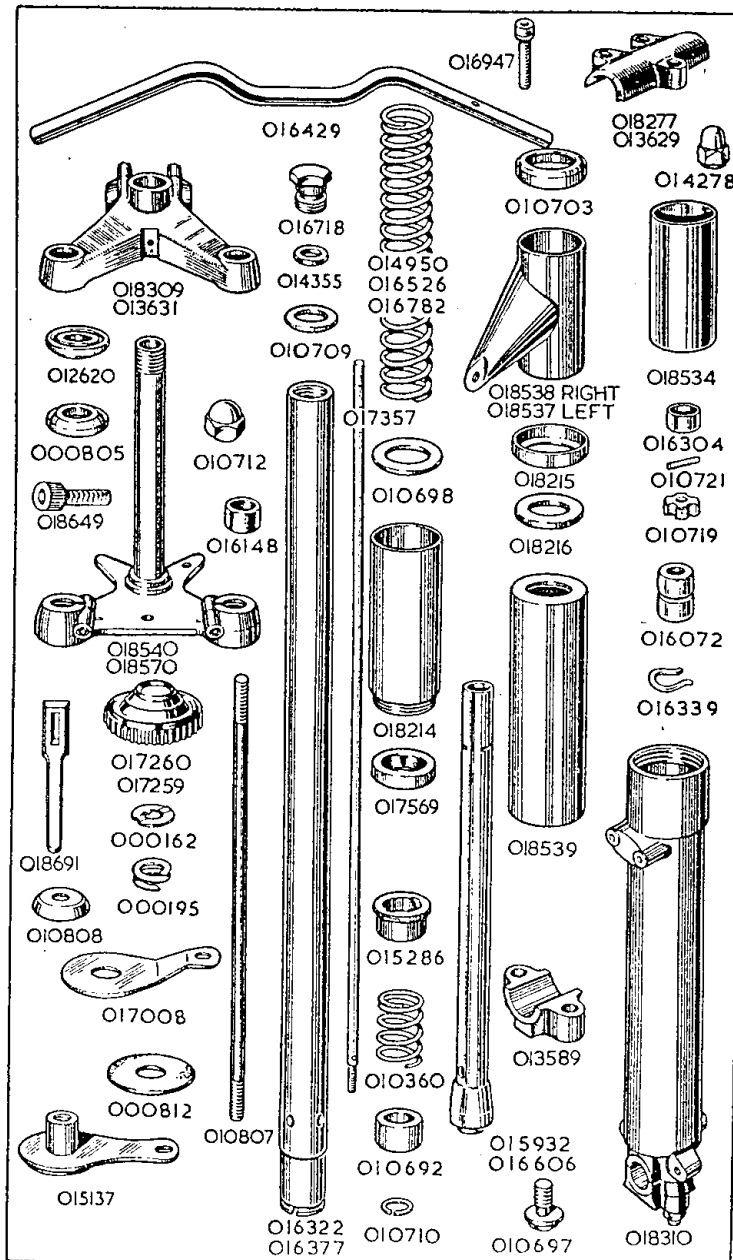

PART NUMBER	DESCRIPTION	QTY. OFF	PRICE EACH £ s. d.
FRONT FORK—continued.			
017357	... Rod, for fork damper.....	2	1 7
000004	... Nut, lock, top end of damper rod.....	2	3
016072	... Sleeve, plunger, for fork damper rod.....	2	6
016339	... Clip, retaining damper rod sleeve.....	2	1
016304	... Valve, for fork damper.....	2	1 0
010721	... Pin, stop, for fork damper valve.....	2	1
010719	... Seat, for fork damper valve.....	2	3
000005	... Nut, lock, for fork damper valve seat.....	2	3
018691	... Steering locking bar (own padlock to be used).....	1	1 3
STEERING DAMPER. (This is an optional extra)			
016404	... Damper, steering, complete set of parts.....	1	15 0
017259	... Knob, control, for steering damper.....	1	3 6
000162	... Washer, ratchet, for steering damper knob.....	1	3
000195	... Washer, spring, for steering damper knob.....	1	4
010808	... Cap, for top of steering stem.....	1	6
010807	... Drawbolt, for steering damper.....	1	1 2
015137	... Sleeve, assembly, lower end of drawbolt.....	1	5 8
000073	... Nut, locking sleeve to drawbolt.....	1	3
000342	... Bolt, fixing sleeve assembly, $1\frac{1}{4}$ in. by $\frac{1}{2}$ in. by 26.....	1	3
000191	... Washer, spring, for bolt 000342.....	1	1
000012	... Washer, plain, for bolt 000342.....	1	1
017008	... Plate, anchor, top position.....	1	9
000070	... Bolt, fixing top anchor plate, $\frac{3}{8}$ in. by $\frac{1}{2}$ in. by 26.....	1	3
000191	... Washer, spring, for bolt 000070.....	1	1
000812	... Washer, friction, for steering damper.....	2	10
000236	... Nut, lock, for fork crown stem (this replaces the domed lock-nut 010712 when a steering damper is fitted).....	1	8
HANDLEBAR			
016429	... Handlebar, bare.....	1	1 6 3
018277	... Clip (half only), for handlebar lug.....	1	2 0
016947	... Screw, for handlebar clip, $\frac{3}{8}$ in. by $\frac{1}{2}$ in. by 26 (socket head).....	3	9
FRONT STAND			
011286	... Stand, front, bare.....	1	8 3
010694	... Bolt, fixing front stand to slider, $1\frac{1}{8}$ in. by $\frac{1}{4}$ in. by 22.....	2	10
010724	... Washer, spring, for stand to slider bolt.....	2	2
000014	... Pin, split, for stand to slider bolt.....	2	1
000342	... Bolt, fixing front stand to front mudguard, $1\frac{1}{4}$ in. by $\frac{1}{2}$ in. by 26.....	1	3
000012	... Washer, plain, for stand to mudguard bolt.....	2	1
000005	... Nut, front stand to mudguard bolt.....	1	3
014278	... Nut (domed), front stand to mudguard bolt.....	1	6
PROP STAND			
014719	... Stand, prop, bare.....	1	1 0 3
014713	... Bolt, hinge, for prop stand, $2\frac{1}{8}$ ins. by $\frac{7}{16}$ in. by 26.....	1	7
014139	... Nut, for prop stand hinge bolt.....	1	4
000049	... Pin, split, for prop stand hinge bolt.....	1	1
010843	... Spring, return, for prop stand.....	1	7
CENTRE STAND			
016438	... Stand, centre, bare.....	1	1 7 3
014626	... Bush, for centre stand, .7 in. long.....	2	8
014629	... Stud, hinge, for centre stand, $8\frac{1}{4}$ ins. by $\frac{7}{16}$ in. by 26.....	1	2 1
014630	... Spacer, central, for centre stand hinge stud, 4.2 ins. long.....	1	11
010912	... Washer, spigot, for centre stand hinge stud.....	2	4
000002	... Nut, for centre stand hinge stud.....	2	4
014627	... Spring, return, for centre stand.....	1	2 6
016399	... Spring, stop, for centre stand.....	1	10
000080	... Nut, for centre stand stop spring (the studs, on which these nuts fit, are listed with the " REAR FORK BRIDGE ").....	2	1
000039	... Washer, plain, for centre stand stop spring fixing nuts.....	2	1

PART NUMBER	DESCRIPTION	QTY. OFF	PRICE EACH	
			£	s. d.

FRONT CHAINCASE

018772	Chaincase, complete (comprises both halves, metal and rubber bands, clamping screw and inspection caps—NO FIXING BOLTS, SPACERS, WASHERS AND NUTS ARE INCLUDED)	1	19	6
018718	Chaincase, back half, bare	1	10	5
018111	Chaincase, front half, bare	1	14	10
018650	Band, metal, for chaincase	1	6	6
000453	Screw, clamping, chaincase metal band, 1 in. by 2 B.A.	1	3	3
018652	Band, rubber, for chaincase	1	5	3
014457	Cap, assembly, chaincase inspection (components not sold as separate spares)	1	2	2
000580	Washer, cork, chaincase inspection cap	1	3	3
018112	Cap, over clutch	1	6	6
018116	Washer, cork, for clutch cap	1	2	2
000450	Screw, $\frac{3}{8}$ in. by 2 B.A., round head, for clutch cap screw	3	2	2
000440	Bolt, fixing chaincase to engine, $\frac{1}{2}$ in. by 0 B.A.	3	3	3
000165	Washer, lock, chaincase engine bolt	3	1	1

REAR CHAINGUARD

014489	Chainguard, rear, bare	1	17	3
000350	Bolt, fixing chainguard in front, $2\frac{1}{4}$ ins. by $\frac{1}{4}$ in. by 26	1	4	4
000012	Washer, plain, chainguard, front fixing bolt	2	1	1
000005	Nut, for chainguard front fixing bolt	1	3	3
014559	Bolt, fixing rear of chainguard, $2\frac{1}{2}$ ins. by $\frac{3}{8}$ in. by 26	1	7	7
000011	Washer, plain, for chainguard rear fixing bolt	1	1	1
000192	Washer, spring, for chainguard rear fixing bolt	1	1	1
014560	Spacer, $1\frac{1}{2}$ in. long (located inside chainguard), on bolt 014559	1	5	5
014561	Spacer, $\frac{3}{4}$ in. long (located between chainguard and frame on bolt 014559)	1	4	4
000004	Nut, for chainguard bolt 014559	1	3	3

BATTERY CARRIER

018043	Carrier, battery, complete with bolt, seat and nut	1	12	11
018029	Carrier, battery, back portion only	1	10	0
012581	Carrier, battery, front portion only	1	2	0
010854	Pin, hinge, battery carrier front	1	3	3
012798	Bolt, clamping battery carrier, $1\frac{3}{4}$ in. by $\frac{1}{4}$ in. by 26	1	6	6
012291	Seat, battery carrier clamping bolt	1	4	4
010851	Nut, battery carrier clamping bolt	1	7	7
000004	Nut, fixing battery carrier and oil tank to front frame	3	3	3
000174	Washer, plain, for battery carrier and oil tank fixing nut	3	1	1
013840	Stay, battery carrier to chaincase	1	10	10
000040	Screw, fixing stay to battery carrier, $\frac{1}{2}$ in. by 1 B.A.	1	1	1
000012	Washer, plain, for 000040 bracket screw	1	1	1
010734	Bolt, fixing battery carrier bracket to chaincase, $3\frac{1}{2}$ in. by $\frac{1}{4}$ in. by 26	1	4	4
000011	Washer, plain, for 010734 carrier bracket bolt	1	1	1
000004	Nut, for 010734 carrier bracket bolt	1	3	3

TOOL BOXES

014587	Box, tool, bare (with lid but no other fittings), left side	1	2	0
014588	Box, tool, bare (with lid but no other fittings), right side	1	17	6
014511	Screw, knurled, for tool box lid	2	11	11
000189	Washer, spring, for tool box lid screw	2	1	1
000005	Nut, for tool box lid screw	4	3	3
000342	Bolt, long, fixing tool box, $1\frac{1}{4}$ in. by $\frac{1}{4}$ in. by 26	4	3	3
014577	Bolt, short, fixing tool box, $\frac{1}{4}$ in. by $\frac{1}{4}$ in. by 26	2	2	2
000639	Spacer, $\frac{1}{2}$ in. long for tool box long fixing bolts	4	3	3
000012	Washer, plain, for tool box fixing bolt	12	1	1
000005	Nut, for tool box fixing bolts	6	3	3

PART NUMBER	DESCRIPTION	QTY. OFF	PRICE EACH	
			£	s. d.

FOOTRESTS

018601	Arm, for footrest	2	8	4
010847	Pad, rubber, for footrest arm	2	1	6
018604	Rod, for footrests, overall length $10\frac{1}{2}$ ins.	1	2	3
010924	Spacer, $3\frac{1}{2}$ ins. long, for footrest rod, between engine rear plates	1	1	1
013837	Spacer, 1 in. long, for footrest rod, outside right plate	1	8	8
010911	Spacer, $\frac{1}{2}$ in. long, for footrest rod, outside left plate	1	6	6
010912	Washer, spigot, for footrest rod	2	3	3
000002	Nut, for footrest rod	2	4	4

PILLION FOOTRESTS

011267	Pair of pillion footrests, complete (includes all the following items)	1	10	6
011518	Spindle, bare for pillion footrest	2	3	0
011599	Bolt, hinge, for pillion footrest spindle, $1\frac{1}{8}$ in. by $\frac{3}{8}$ in. by 26	2	6	6
000073	Nut, for pillion footrest hinge bolt	2	3	3
010847	Pad, rubber, for pillion footrest spindle	2	1	6

TWIN SEAT

014293	Seat, Twin	1	7	0 0
014919	Screw, fixing seat at rear to loop, $\frac{3}{8}$ in. by 2 B.A.	2	1	0
000039	Washer, plain, for seat fixing screw	2	1	1
000080	Nut, for seat fixing screw	2	1	1
000011	Washer, plain, for nut fixing seat in centre	2	1	1
000004	Nut, fixing seat in centre	2	3	3

TRANSFERS

009183	Transfer, for side of oil tank (oil level indicator)	1	3	3
009184	Transfer, for top of oil tank (service instruction)	1	3	3
009186	Transfer, for front chaincase (oil level indicator)	1	3	3
009187	Transfer, for front chaincase (patent)	1	1	1
009188	Transfer, for tool box (monogram)	2	4	4
009189	Transfer, for rear mudguard ("MATCHLESS")	1	6	6
009192	Transfer, for front forks (patent)	1	6	6
009195	Transfer, for petrol tank (reserve)	1	3	3
009198	Transfer, for side of oil tank (oil top level indicator)	1	2	2
009196	Transfer, for forks ("Made In England")	1	1	1
009197	Transfer, for rear fork hinge (patent)	1	1	1
018090	Complete set of transfers	1	3	1

DUMMY GRIP

16-069	Grip, rubber, dummy	1	1	6*
--------	---------------------	---	---	----

WHEN ORDERING SPARES, IF IN DOUBT REGARDING THE NAMES AND PART NUMBERS OF THE PARTS YOU REQUIRE, PLEASE SEND THE OLD PARTS TO SERVE AS PATTERNS.

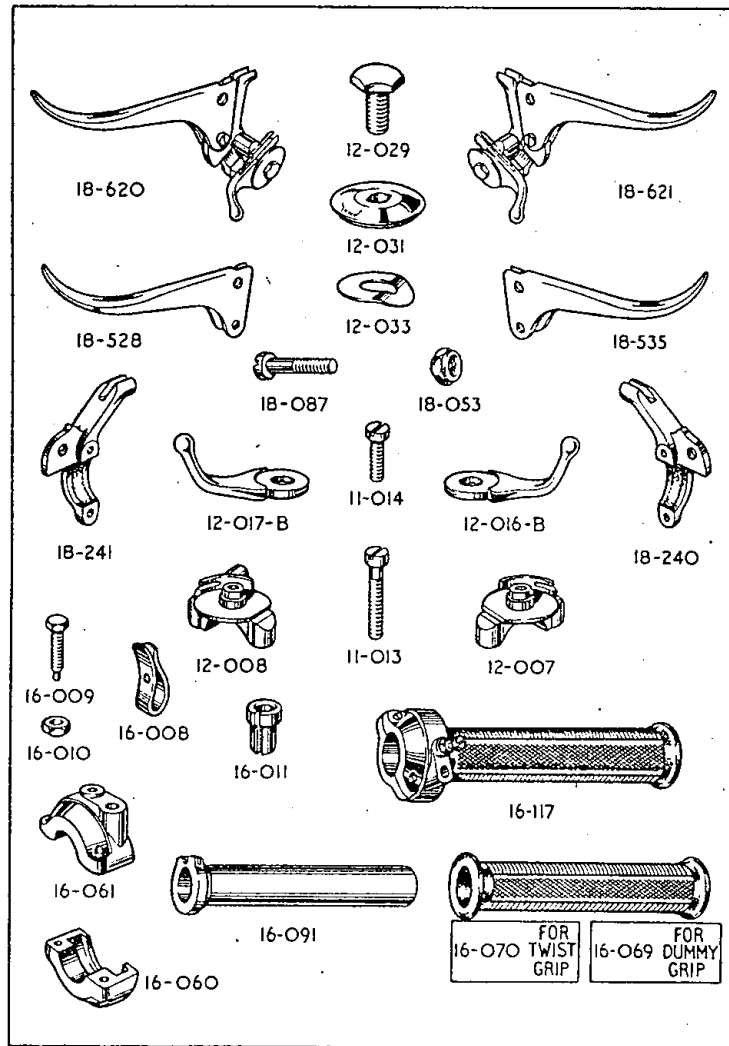

PART NUMBER	DESCRIPTION	QTY. OFF	PRICE EACH
			£ s. d.

TWIST GRIP

16-117	... Twist grip, complete assembly	1	10 6*
16-070	... Grip, rubber, for twist grip	1	1 0*
16-091	... Rotor, and sleeve, for twist grip (does not include rubber grip)	1	3 6*
16-060	... Body, twist grip, top (plain clip)	1	3 0*
16-061	... Body, twist grip, bottom (for friction spring)	1	3 0*
11-013	... Screw, long, clamping twist grip body	1	3*
11-014	... Screw, short, clamping twist grip body	1	3*
16-008	... Spring, friction, for twist grip	1	9*
16-009	... Screw, for twist grip friction spring	1	6*
16-010	... Nut, for twist grip friction spring screw	1	2*
16-011	... Stop, for twist grip (throttle) cable	1	6*

CLUTCH AND IGNITION CONTROL LEVERS

18-620	... Lever, assembly, clutch and ignition	1	18 9*
18-528	... Lever only, clutch	1	5 3*
12-017-B	... Lever only, ignition	1	3 9*
18-241	... Bracket, for clutch lever	1	5 3*
12-008	... Bracket, for ignition lever	1	2 9*
11-013	... Screw, long, clamping clutch and ignition brackets	1	3*
11-014	... Screw, short, clamping clutch and ignition brackets	1	3*
18-087	... Pin, fulcrum, for clutch lever	1	3*
18-053	... Nut, clutch lever fulcrum pin	1	3*
12-029	... Bolt, central, for ignition lever	1	3*
12-031	... Cap, for ignition lever	1	8*
12-033	... Washer, spring, for ignition lever	1	2*

BRAKE AND AIR CONTROL LEVERS

18-621	... Lever, assembly, brake and air	1	18 9*
18-535	... Lever, only, brake	1	5 3*
12-016-B	... Lever, only, air	1	3 9*
18-240	... Bracket, for brake lever	1	5 3*
12-007	... Bracket, for air lever	1	2 9*
11-013	... Screw, long, clamping brake and air brackets	1	3*
11-014	... Screw, short, clamping brake and air brackets	1	3*
18-087	... Pin, fulcrum, for brake lever	1	3*
18-053	... Nut, brake lever fulcrum pin	1	3*
12-029	... Bolt, central, for air lever	1	3*
12-031	... Cap, for air lever	1	8*
12-033	... Washer, spring, for air lever	1	2*

FRONT BRAKE CABLE

013178	... Cable, complete, assembled, front brake	1	6 3
000530-40½	... Wire, inner, front brake, 40½ ins. finished length	1	1 2
017240	... Nipple, brake end, for brake inner wire	1	3
017238	... Nipple, handlebar end, for brake inner wire	1	3
000529-26	... Casing, outer, front brake, 26 ins. long	1	1 2
000531	... Ferrule, front brake outer casing	2	1
011348	... Adjuster, front brake cable	1	2 0
017217	... Nut, lock, front brake cable adjuster	1	6
017049	... End, yoke, front brake cable	1	1 4
000736	... Pin, for yoke end, front brake cable	1	4
000014	... Pin, split, for front brake cable yoke and pin	1	1
012478	... Sleeve, rubber, for front brake cable inner wire	1	5

CLUTCH CABLE

018141	... Cable, complete, assembled, clutch	1	6 4
000530-43½	... Wire, inner, clutch, 43½ ins. finished length	1	1 2
017241	... Nipple, gearbox end, clutch inner wire	1	1
017238	... Nipple, handlebar end, clutch inner wire	1	3
000529-39½	... Casing, outer, clutch, 39½ ins. long	1	2 5
000531	... Ferrule, clutch outer casing	2	1
014225	... Adjuster, clutch cable	1	7
011373	... Nut, lock, clutch cable adjuster	1	3

PART NUMBER	DESCRIPTION	QTY. OFF	PRICE EACH £ s. d.
-------------	-------------	----------	--------------------

REAR WHEEL

The complete wheel listed below comprises:—
Rim, spokes, nipples, hub, grease nipple and all bearings assembled, but does NOT include the centre solid spindle, washers, spacers, nuts, brake parts, sprocket and brake drum, speedometer drive and tyre.

015566	Wheel, rear, complete, with all fittings, Home Models.....	1	5 14 5
The bare wheel listed below comprises:— Rim, spokes, nipples and hub.			
015558	Wheel, rear, bare, less all fittings, Home Models.....	1	3 18 11
018245	Rim, rear, 19 ins. by 2½ ins., Home Models.....	1	19 9
015565	Wheel, rear, with all fittings, chrome rim, red centre, Export Models.....	1	6 4 5
015556	Wheel, rear, bare, Export Models.....	1	4 8 11
012876	Rim, rear, chrome, red centre, Export Models.....	1	1 8 1
011012	Spoke, rear, left or right, 8½ ins. by 7 G by 9 G.....	40	3
011013	Nipple, rear, left or right, .250 in. by 9 G.....	40	1
016964	Hub, rear wheel, shell only.....	1	2 5 7
000051	Nipple, grease, for rear wheel hub.....	1	5
011090	Tape, for 19 ins. rear rim.....	1	1 9*

REAR WHEEL BEARINGS

014868	Bearings, roller, for rear hub (only sold as a complete bearing) ...	2	12 4
014387	Oil-seal, for rear hub bearings.....	2	4
010740	Ring, spring, locating rear hub bearings.....	1	3
018094	Cup, for rear hub bearing oil-seal.....	1	4
010743	Ring, spacing, for rear hub bearing oil-seal.....	1	11
018095	Ring, retaining rear hub bearing oil-seals.....	3	1
012436	Collar, spacing, between bearing and rear hub bearing oil-seal.....	2	9
014706	Spacer, 2⅞ ins. long between the two bearings of rear hub.....	1	2 6
010745	Ring, adjusting, for rear hub bearing.....	1	2 5
010437	Nut, lock, for rear hub bearing adjusting ring.....	1	2 0
014703	Spindle, centre, solid, for rear wheel.....	1	8 6
014705	Spacer, 1⅞ in. long, on rear wheel solid spindle, for speedometer gearbox.....	1	2 7
010372	Nut, locking, speedometer gearbox.....	1	7
014704	Sleeve, on rear wheel solid spindle, locating brake cover plate.....	1	3 3
014700	Cam, on rear wheel solid spindle, right side.....	1	5 10
014710	Cam, on rear wheel solid spindle, left side.....	1	4 11
000573	Key, on rear wheel solid spindle, locating cams.....	2	4
011290	Collar, on rear wheel solid spindle (abuts against fork end).....	2	1 4
014869	Nut, for rear wheel solid spindle.....	2	6

FRONT BRAKE

010505	Drum, front brake.....	1	17 11
000140	Screw, fixing front brake drum to hub shell, ¾ in. by 1 B.A.....	10	3
018662	Plate, cover, front brake.....	1	13 4
018655	Stay, front brake cover plate anchor.....	1	6 6
014807	Bolt, fixing anchor stay to front cover plate, ⅝ in. by ⅝ in. by 26.....	1	3
014119	Washer, special, for anchor stay bolt.....	1	1
018070	Pin, fulcrum, for brake shoes.....	1	7
000010	Washer, plain (inner for pin).....	1	1
000011	Washer, plain (outer for pin).....	1	1
000004	Nut, for brake fulcrum pin.....	1	3
013620	Shoes, pair of, for front brake, with brake linings and thrust pins (only supplied in pairs).....per pair.....	1	1 0 6
013291	Pin, thrust, brake expander adjusting.....	2	9
000174	Washer, plain, for thrust pin.....	R	1
010440	Linings, brake, per pair of, less rivets.....	1	4 0
000113	Rivets, for brake linings, per set of.....	12	2
012892	Spring, for brake shoes.....	2	4
012891	Expander, for brake shoes.....	1	4 1
012576	Lever, for front brake shoe expander.....	1	2 6
000051	Nipple, grease, for brake shoe expander.....	1	5
000174	Washer, plain, for brake shoe expander.....	1	1
000004	Nut, for brake shoe expander.....	1	3

PART NUMBER	DESCRIPTION	QTY. OFF	PRICE EACH £ s. d.
-------------	-------------	----------	--------------------

REAR BRAKE

010293	Sprocket and brake drum, for rear wheel, 42 teeth, five hole fixing.....	1	15 0
010734	Bolt, retaining sprocket to rear hub, ⅜ in. by ⅜ in. by 26.....	5	4
010708	Washer, lock, for rear sprocket retaining bolt.....	5	1
000011	Washer, plain, for rear sprocket retaining bolt.....	5	1
000074	Nut, for rear sprocket retaining bolt.....	5	3
014471	Plate, cover, rear brake.....	1	15 0
010347	Bolt, anchor, rear brake cover plate, 2⅞ ins. by ⅝ in. by 26, with square head.....	1	2 0
000003	Nut, for rear brake cover plate anchor bolt.....	1	3
000006	Pin, split, for rear brake anchor bolt.....	1	1
013620	Shoes, pair of, for rear brake, with brake linings and thrust pins (only supplied in pairs).....per pair.....	1	1 0 6
013291	Pin, thrust, brake expander adjusting.....	2	9
000174	Washer, plain, for thrust pin.....	R	1
010440	Linings, brake, per pair of, less rivets.....	1	4 0
000113	Rivets, for brake linings.....per set of.....	12	2
012892	Spring, for brake shoes.....	2	4
012891	Expander, for brake shoes.....	1	4 1
017113	Lever, for rear brake shoe expander.....	1	2 6
000051	Nipple, grease, for brake shoe expander.....	1	5
000174	Washer, plain, for brake shoe expander.....	1	1
000004	Nut, for brake shoe expander.....	1	3

REAR BRAKE OPERATING PARTS

014791	Pedal, foot, for rear brake.....	1	17 3
014514	Bush, for rear brake foot pedal.....	1	1 0
000051	Nipple, grease, for rear brake foot pedal.....	1	5
014822	Spring, return, rear brake foot pedal.....	1	7
000344	Bolt, adjusting, rear brake foot pedal, ⅜ in. by ½ in. by 26.....	1	3
000005	Nut, for rear brake, foot pedal adjusting bolt.....	1	3
014520	Rod, bare, rear brake.....	1	1 9
000735	End, yoke, for front end of brake rod.....	1	1 4
000736	Pin, for brake rod yoke end.....	1	4
000014	Pin, split, for brake rod yoke end pin.....	1	1
017095	Spring, for brake rod.....	1	4
000178	Collar, for brake rod, spring.....	1	1
017227	Clip, adjusting, for rear end of brake rod.....	1	2 5
000736	Pin, for brake rod adjusting clip.....	1	4
000014	Pin, split, for brake rod adjusting clip pin.....	1	1
000615	Nut, adjusting, for rear brake rod.....	1	2 10

VOLTAGE REGULATOR

015087	Regulator, complete unit, type MCR2 (Lucas No. 37097-B).....	1	2 0 0*
000342	Bolt, fixing regulator unit ⅜ in. by ½ in. by 26.....	2	3
011094	Grummet, or bush, rubber, for regulator fixing bolt.....	2	4
000012	Washer, plain, for regulator fixing bolt.....	4	1
018160	Nut, for regulator fixing bolt.....	2	1

THE PRICES OF SPARES DO NOT
INCLUDE THE COST OF CARRIAGE

PART NUMBER	DESCRIPTION	QTY. OFF	PRICE EACH	
			£	s. d.

BATTERY

011255	Battery, with lid, dry and uncharged. This is a battery that has NOT been filled with electrolyte (acid) and is, of course, not charged. It requires no special packing and can safely be packed with other goods. (Lucas No. PUW-7E-4). (We do not supply charged batteries—for such apply to nearest Lucas Service Station)	1	2	2	6*
S-2171	Lid, only, with rubber pads, for battery	1	2	0	0*

HEAD LAMP

018151	Lamp, head, type SSU-700-P-I, with bulbs, ammeter and switch (no cable harness) (Lucas No. 51103A)	1	5	2	6*
553248	Rim, bare, for head lamp	1	12	6*	
553925	Light unit (glass and reflector)	1	14	6*	
555005	Adaptor (bulb holder)	1	8	0*	
516386	Glass, for pilot light	1	1	6*	
130251	Screw, fixing panel to head lamp	3	3	1*	
185026	Washer, spring, for panel fixing screw	3	1	1*	
516183	Fillet, rubber, for head lamp panel	1	3	1*	
112201	Bolt, fixing head lamp to bracket	2	1	3*	
137141	Washer, plain, for head lamp fixing bolts	2	4	9*	

See ELECTRICAL SUNDRIES for Ammeter, Switch, Cable Harness and Bulbs.

REAR LAMP

018760	Lamp, rear, with bulb, Lucas type 525 (53269-A)	1	1	5	0*
573819	Window cover, red, for rear lamp	1	7	0*	
573814	Rubber gasket, for window cover	1	6	6*	
572072	Screw, retaining lamp window cover	2	4	4*	
166014	Nut, retaining body to rear number plate	2	1	1*	
188330	Spring washer, under nut rear number plate	2	1	2*	
860428	Rear lamp wires, with contact disc, spring and paxolin washer	1	3	0*	
573825	Rubber cap, covering wire entry	1	6	2*	

STOP LIGHT PARTS (Optional Extra)

018720	Stop light switch	1	7	0*	
016727	Pull off, spring for switch	1	9	9*	
018763	Bracket, for switch	1	8	8*	
018764	Clip, for pull off spring	1	5	5*	
000738	Screw, securing switch and spring clip	3	3	3*	
000739	Nut, for screw switch and spring clip	3	3	3*	
000039	Washer, for spring clip screw	2	1	1*	
000073	Nut, securing switch bracket	1	3	3*	
000010	Washer, for nut switch bracket	1	1	1*	
011907	Extra rubber cable clips	3	2	2*	
011908	Extra rubber cable clips	2	2	2*	
014453	Metal cable clip	1	3	3*	
011382	Metal cable clip, to side of mudguard	3	2	2*	
018866	Cable, 6ft (switch to lamp and battery)	1	1	6*	
900269	Snap connector	1	2	2*	
018855	Complete kit of parts for stop light conversion	1	10	0	

HORN

015257	Horn, type HF 1234, with bracket. Lucas replacement number is 069225, but hole in bracket must be opened out to $\frac{1}{8}$ in. diameter	1	1	19	0*
015245	Bracket, only, for horn (see note above re opening out hole)	1	3	3*	

PART NUMBER	DESCRIPTION	QTY. OFF	PRICE EACH	
			£	s. d.

ELECTRICAL SUNDRIES

36084	Ammeter, for head lamp panel	1	8	9*	
351551	Switch, main lighting, for head lamp panel	1	10	6*	
351567	Handle, with screw, for main lighting switch	1	3	0*	
380521	Switch, dipping, for handlebar	1	6	6*	
016427	Switch, horn, for handlebar (Lucas No. 76209)	1	3	9*	
997831	Cable harness, main lighting (no dip switch wire, no horn wire, no regulator wires)	1	15	0*	
858795	Cable harness, triple, for dipping switch	1	4	0*	
860596	Cable harness, for regulator	1	6	0*	
359218	Cable, for horn	1	1	0*	
016681	Sheath, for horn cable	1	5	5*	
016682	Sheath, for dynamo cable	1	3	3*	
000543	Cable, high tension, for sparking plug, price per foot	R	10	10*	
000541	Terminal, for high tension cable	2	3	3*	
000540	Terminal, for earth cables	2	2	2*	
900269	Connector, snap, for rear lamp cable	1	2	2*	
900260	Connector, snap, for regulator to ammeter cable	1	2	2*	
571395	Connector, screwed, for battery positive cable	1	9	9*	
011094	Bush, rubber, fits in rear mudguard, for rear lamp cable	1	4	4*	
312	Bulb, head lamp, main, 6 volt, 30 by 24 watts	1	5	6*	
	Plus Purchase Tax	—	1	3*	
988	Bulb, head lamp, pilot, 6 volt, 3 watts	1	1	6*	
	Plus Purchase Tax	—	1	4*	
352	Bulb, rear lamp, 6 volt, 18 and 3 watt double contact	1	3	9*	
	Plus Purchase Tax	—	10	10*	
015538	Plug, sparking, K.L.G. type FE-80	2	5	0*	

CABLE CLIPS

011907	Clip, rubber, $\frac{1}{2}$ in.	4	2	2*	
011908	Clip, rubber, 3 ins.	3	2	2*	
018220	Clip, rubber, $\frac{3}{4}$ ins.	5	2	2*	
014453	Clip, metal, holding rear lamp wire inside mudguard	1	3	3*	
011382	Clip, metal, holding rear lamp cable to mudguard edge	3	2	2*	

SPEEDOMETER

S-480-3-L	Head, only, speedometer, trip, 120 M.P.H.	1	3	10	0*
S-480-7-L	Head, only, speedometer, trip, 180 K.P.H.	1	3	10	0*
54279-1	Set of bulb holding parts for head	1	5	0*	
53205	Bulb, 6 volts, 1.8 watts, M.B.C. for head	1	1	6*	
	Plus Purchase Tax	—	4	4*	
N-1253	Nut, fixing speedometer head to bracket	2	2	2*	
000012	Washer, plain, spacing, for head	2	1	1*	
W-7216	Washer, spring, speedometer bracket nut	2	1	1*	
53395-1-65	Cable, speedometer drive, complete	1	1	2	6*
52108-1-65	Cable, speedometer drive, inner only	1	11	3*	
53398-1-65	Cable, speedometer drive, outer only	1	11	3*	
011392	Clip, for speedometer drive, cable	1	3	3*	
000450	Screw, fixing speedometer cable clip, $\frac{3}{8}$ in. by 2 B.A.	1	1	1*	
000190	Washer, spring, for cable clip screw	1	1	1*	
52283-5	Gearbox, speedometer, complete	1	2	2	6*
016945	Bracket, for speedometer head	1	7	7*	
000362	Bolt, fixing speedometer head to forks, $\frac{5}{8}$ in. by $\frac{1}{4}$ in. by 26	1	3	3*	
000011	Washer, plain, speedometer bracket bolt	1	1	1*	
000192	Washer, spring, speedometer bracket bolt	1	1	1*	

VARIOUS EQUIPMENT

018691	Bar, locking, for fork crown	1	1	3	
016344	Set of Pannier bags, with frames and fixing bolts, washers and nuts	1	6	6	0*
	Plus Purchase Tax	—	2	9	4*
011957	"TEKALL" Rust preventative $\frac{1}{2}$ pint	R	2	0*	
011958	"TEKALL" Rust preventative 1 pint	R	3	0*	
CM-20	Instruction Manual	R	2	6*	
B-M-H	Badge, monogram, MATCHLESS, for button hole	R	1	6*	
B-M-T	Badge, monogram, MATCHLESS, for tie	R	1	6*	
B-M-B	Badge, monogram, MATCHLESS, for brooch fixing	R	1	6*	

PART NUMBER	DESCRIPTION	QTY. OFF	PRICE EACH		
			£	s.	d.

COMPLETE TOOL KITS

018780	... Tool kit, complete, with tyre inflator	1	...	2	13	8
018781	... Tool kit, complete, less tyre inflator	1	...	2	6	2

The following comprise "TOOL KIT, COMPLETE, WITH TYRE INFLATOR," and is included as part of every motor cycle.

TOOLS

017253	... Bag for tools	1	...	4	1	
017256	... Screwdriver	1	...	2	9	
017248	... Pliers, side cutting	1	...	3	10	
011188	... Pliers, for gudgeon pin circlips	1	...	1	7	
017246	... Gun, grease	1	...	6	1	
017114	... Inflator, tyre	1	...	7	6	
017007	... Lever, tyre	1	...	1	7	
017052	... Spanner, double end, $\frac{1}{2}$ in. by $\frac{1}{2}$ in.	1	...	2	5	
017053	... Spanner, double end, $\frac{1}{2}$ in. by $\frac{3}{8}$ in.	1	...	3	8	
018178	... Spanner, double end, 1-011 in. by 1-2 in.	1	...	1	6	
017257	... Spanner, double end, $\frac{1}{2}$ in. by .375 in.	1	...	1	4	
017252	... Spanner, box, with tommy, for sparking plug	1	...	1	7	
017249	... Wrench, adjustable	1	...	9	0	
015023	... Spanner, double end, with gauge, for contacts (Lucas No. 415116)	1	...	7	*	
015264	... Spanner, single end, for rocker clamping bolts	1	...	4		
015213	... Spanner, box, for cylinder head nuts	1	...	1	8	
017254	... Spanner, clutch spring adjustment	1	...	10		
018153	... Spanner, for petrol tap	1	...	7		
018055	... Key, for handlebar clip screws and rocker cap screws	1	...	7		
018667	... Key, for fork tube pinch screw	1	...	1	6	

SPECIAL TOOLS

011381	... Holder, valve, for valve grinding	1	...	10		
015273	... Extractor, for timing pinion and magneto gear	1	...	4	6	
015374	... Extractor, for camshaft gears	1	...	4	6	
015955	... Disc, timing (see Instruction Manual)	1	...	3	6	

The above tools are NOT INCLUDED in the equipment of a new motor cycle.

SERVICE

The Service and Repair Department is situated in Burrage Grove, Plumstead, London, S.E.18. Burrage Grove is the first turning on the left from Burrage Road when entering Burrage Road from the Plumstead Road. (See final paragraph below.)

The nearest Railway Station is WOOLWICH ARSENAL, SOUTHERN REGION RAILWAY. This Station is five minutes' walk from our Service Depot in Burrage Grove. There is an excellent service of electric trains from Charing Cross, Waterloo, Cannon Street and London Bridge Stations, Southern Region Railway.

Bus routes 53, 54, 163, 99, 122, 122a, 177 and Trolleybus routes, 696 and 698, pass the end of Burrage Road (one minute from the Service Depot).

Bus routes 21a, 75 and 161 serve Beresford Square which is three minutes' walk from the Service and Repair Department.

Visitors from the North can pass into Woolwich via the Free Ferry between North Woolwich and Woolwich. North Woolwich is a British Railways terminus and is also served by Bus and Trolleybus routes 101, 569, 669 and 685. There is also a tunnel under the River Thames at this point for foot passengers. The Free Ferry accommodates all types of motor vehicles and there is a very frequent service. The Southern landing stage is less than a mile from the Service Depot.

Visitors arriving by road, if they are strangers to the locality, should enquire for Beresford Square, Woolwich. Upon arrival there, the road skirting the Royal Arsenal should be followed in an Easterly direction for about four hundred yards, and Burrage Road is the second turning on the right after leaving the square. Burrage Grove is then the first turning on the left.