

# SPARES LIST

+ 25%

for

**1954**

500 c.c. O·H·V

**A·J·S**

**"SPRINGTWIN"**

VERTICAL TWIN  
(MODEL 20)

+ 25%



**A·J·S**

**MOTOR CYCLES**

PROPRIETORS: ASSOCIATED MOTOR CYCLES LIMITED

PLUMSTEAD - LONDON - S.E.18



Price:

**TWO SHILLINGS and SIXPENCE**

EDITION CL-32

**MAKERS PRICE INCREASE**

AS FROM JAN 1st 1954, Carburettors,  
Control Levers and all parts thereof are  
increased by 10%

# SPARES LIST

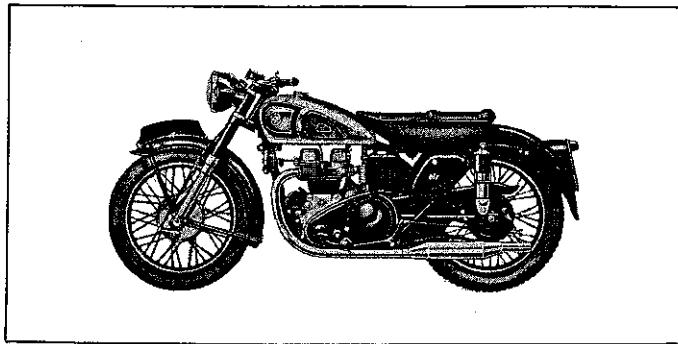

**A·J·S "SPRINGTWIN"**

**VERTICAL TWIN**

**Bore 66 m.m.**

**Stroke 72·8 m.m.**

**Capacity 498 c.c.**



Compiled and Issued by the Manufacturers

## **A·J·S MOTOR CYCLES**

(Proprietors : ASSOCIATED MOTOR CYCLES LIMITED)

Registered Offices :

**PLUMSTEAD ROAD, PLUMSTEAD  
LONDON, S.E.18 . ENGLAND**

Nearest Station :  
**WOOLWICH ARSENAL**  
(Southern Region Railway)

Factories :  
**BURRAGE GROVE and MAXEY ROAD  
PLUMSTEAD S.E.18**

Telegrams and Cables : "ICANHOPIT, WOL-LONDON"  
Telephone : WOOLWICH 1223 (5 Lines)  
Codes : A.B.C. 5th and 6th Edition ; Bentley's ; and Private Codes

All correspondence to :—  
**A·J·S MOTOR CYCLES, PLUMSTEAD ROAD, LONDON, S.E.18**

**Price : TWO SHILLINGS and SIXPENCE**

EDITION CL-32

**(1) TERMS OF BUSINESS.**

Our terms are :— CASH WITH ORDER,  
CASH AGAINST PRO-FORMA INVOICE, OR  
APPROVED LEDGER ACCOUNT.

Customers who wish to avoid delay can open deposit accounts and the usual deposit is £5.

Orders from abroad should be accompanied by a remittance to cover the costs of goods and postal charges.

We do not send goods by "CASH ON DELIVERY" (C.O.D.).

**(2) PRICES AND SPECIFICATIONS.**

All prices, specifications and conditions are subject to alteration without notice. The prices of spares do not include the costs of packing and carriage.

**(3) CARRIAGE AND PACKING.**

All invoices for spare parts will be SURCHARGED by 5 PER CENT. to cover the cost of packing and postage, or carriage, and the minimum surcharge is sixpence. (Home orders only)

A special packing case, or crate, is required for some spares to ensure freedom from damage in transit. In such circumstances a special charge for the value of the case, or crate, will be made in addition to the 5 per cent. surcharge but the special charge will be credited in full if the container is promptly returned to our factory carriage paid and in good condition.

**(4) HOW TO ORDER SPARES.**

- STATE :— (a) The Model of the machine.  
(b) The complete engine number. (See paragraph 5.)  
(c) The frame number. (See paragraph 5.)  
(d) The part numbers of the spares required.  
(e) A description of each spare.  
(f) The quantity required of each item.  
(g) How the spares are to be sent. (Post, Parcels Post, Passenger train or Goods train.  
(h) Your full name and address. These particulars are best written in BLOCK LETTERS.  
(i) Mention if, or not, you have an account with us.

ALSO :— Unless you have a deposit or ordinary account, enclose a remittance to cover the cost of the spares plus the 5 per cent. surcharge. (See paragraph 3.)

When cash is sent any excess will be refunded without prior application.

NOTE :— When sending orders by telegram or cable do not omit your name and address from the message.

**(5) IDENTITY.**

To ensure the supply of correct spares it is essential we can identify the machine for which they are required. The ONLY WAY to do that is for us to know the COMPLETE ENGINE and frame numbers.

The engine number is stamped on the crankcase, IN FRONT OF THE LEFT CYLINDER, and may have one or more letters incorporated in it. THE COMPLETE NUMBER MUST BE QUOTED.

The frame number is stamped on the right-hand side of the frame lug that is below the saddle.

**(6) SERVICE.**

The SERVICE AND REPAIR DEPARTMENT is situated in BURRAGE GROVE, PLUMSTEAD, LONDON, S.E.18, and is open on Mondays to Fridays from 8.30 a.m. to 12.55 p.m.—2 p.m. to 5.30 p.m. it is closed on Saturdays, Sundays and National Holidays.

It exists for the purpose of :—

- (a) Giving technical assistance verbally or through the Post.
- (b) Supplying spare parts over the counter or through the Post.
- (c) Repairing and re-conditioning machines, or parts of machines, of our make.

If it is considered necessary to bring a machine, or parts, to the factory for an urgent repair IT IS ESSENTIAL you make an appointment beforehand to avoid disappointment. This can be done by letter or telephone.

**(7) REPAIRS.**

The instructions regarding repairs should be clear and definite, otherwise the cost may be greater than that expected. We shall be pleased to give estimates for repairs if parts are sent to us for that purpose. If the estimate is accepted, no charge is made for the preliminary examination, but, should it be decided not to have the work carried out, it may be necessary to make a charge to cover the cost of whatever dismantling and re-assembly may have been done to prepare the estimate.

**(8) REPAIRS TO PROPRIETARY FITTINGS.**

We do not repair carburettors, chains, electrical equipment, saddles, sparking plugs, speedometers and tyres. On page 80 of the "MAINTENANCE MANUAL AND INSTRUCTION BOOK" will be found the names and addresses of the manufacturers of the proprietary equipment we fit, all of whom service and repair equipment they make.

**(9) PATTERNS.**

Parts sent to us as patterns, or for repair, should have attached to them a label bearing the sender's full name and address. The instructions regarding such parts should be sent under separate cover.

**(10) GUARANTEE.**

All parts made by us, and sold as spares, are subject to the same Limited Guarantee as that issued with each new motor cycle and that guarantee is printed in full on Page 88 of the "MAINTENANCE MANUAL AND INSTRUCTION BOOK."

**(11) INSTRUCTION BOOK.**

A "MAINTENANCE MANUAL AND INSTRUCTION BOOK" (Edition CM-29) has been compiled and published by us.

One copy is supplied free, upon application, with each new motor cycle. Replacements copies are two shillings and sixpence each.

**(12) CORRESPONDENCE.**

Our routine is organised into different departments. Therefore delay cannot be avoided if matters relating to more than one department are contained in one letter.

Consequently when communicating with more than one department it is desirable to do so on SEPARATE SHEETS. Each sheet should bear the sender's name and address. IN PARTICULAR, requests for TECHNICAL ADVICE should not be on the same sheets as ORDERS FOR SPARE PARTS.

A·J·S MOTOR CYCLES,  
PLUMSTEAD, LONDON, S.E.18.

**NOTE**

The numbers, in brackets, that appear in the "Description" columns relate to the numbered foot notes regarding items so specially indicated.

The quantities per machine of each item are entered in the "Qty." columns. "R" indicates as may be required.

The illustrations are not to scale and are not necessarily accurate in detail.

Some items are not illustrated.

PART NUMBER	DESCRIPTION	QTY. OFF.	PRICE EACH £ s. d.
-------------	-------------	-----------	--------------------

**CRANKCASE**

021396	Crankcase, complete (1)	1	19 16
021397	Crankcase, driving side only (2)	1	6 4 2
021398	Crankcase, timing side only (3)	1	10 8 10
015670	Web, centre, with cap, studs, washers and nuts (no bearing and thrust washers)	1	2 1 5
016867	Cover, for timing gear	1	2 3 0
012561	Badge, monogram, for driving side crankcase	1	2 5 1
011826	Stud, fixing centre web, 1 1/2 in. by 1/2 in. by 26 and 20	6	1 1/2 1/2
000012	Washer, plain, for centre web top fixing studs	2	1 1/2 1/2
000012	Washer, plain, for centre web centre fixing studs	2	1 1/2 1/2
000012	Washer, plain, for centre web bottom fixing studs	2	1 1/2 1/2
011843	Nut, for centre web fixing studs	6	6
015667	Nut, for centre web bearing cap, 2 1/4 in. by 3/8 in. by 20 and 20	2	1 1/2 1/2
000010	Washer, plain, for centre web bearing cap stud	2	4
016845	Nut, for centre web bearing cap stud	2	4
011628	Stud, in driving side crankcase, for cylinder and head, 5 1/2 in. by 1/2 in. by 26 and 22	4	3 4
011628	Stud, in timing side crankcase, for cylinder and head, 5 1/2 in. by 1/2 in. by 26 and 22	4	3 4
011834	Stud, in timing side crankcase, for pump carrying plate, 1 1/2 in. by 1/2 in. by 26 and 22	4	4
000272	Stud, in timing side crankcase, for fixing magneto, 1 1/2 in. by 1/2 in. by 26 and 22	3	4
011803	Stud, in timing side crankcase, for dynamo strap, 1 1/2 in. by 1/2 in. by 26 and 20	2	5
011623	Shaft, in timing side crankcase, for intermediate gear	1	4
000575	Plug, drain, for timing side crankcase	1	6 11
011820	Screw, retaining timing gear cover	10	7 1/2 7 1/2
011652	Adaptor, to accommodate oil feed and return pipe retaining banjo pins. (Screws into timing side crankcase)	2	2 2 1/2
011657	Washer, fibre, for banjo pin adaptors	2	1 1/2
010474	Bush, plain, for camshafts. (In driving side crankcase)	2	2 8 1/2
011654	Bush, flanged, for camshafts. (In timing side crankcase)	4	3 11
016472	Tunnel, for camshaft chamber (fits between crankcase halves)	2	3 10
011648	Cap, in crankcase housing for inlet camshaft	1	2 7 1/2
011642	Washer, fibre, for crankcase housing cap	1	2 1/2

1.—Includes:—Driving crankcase, Timing crankcase, centre web with studs (no bearing and washers). Bushes for camshafts. Cylinder studs. Shaft for intermediate gear. Cam follower spindles. Studs for pump plate. Two magneto studs. Dynamo strap stud. Timing gear cover and screws. Monogram badge. Three bolts. One stud. Two nuts. Five washers.

2.—Includes:—Two camshaft bushes. Four cylinder studs. Cam follower spindles. Six studs for centre web. (No badge.)

3.—Includes:—Four camshaft bushes. Four cylinder studs. Shaft for intermediate gear. Three studs for pump plate. Two studs for magneto. One stud for dynamo strap. (No timing gear cover and screws.)

WHEN IN DOUBT REGARDING THE NAMES AND PART NUMBERS OF THE PARTS YOU REQUIRE, PLEASE SEND THE OLD PARTS TO SERVE AS PATTERNS.

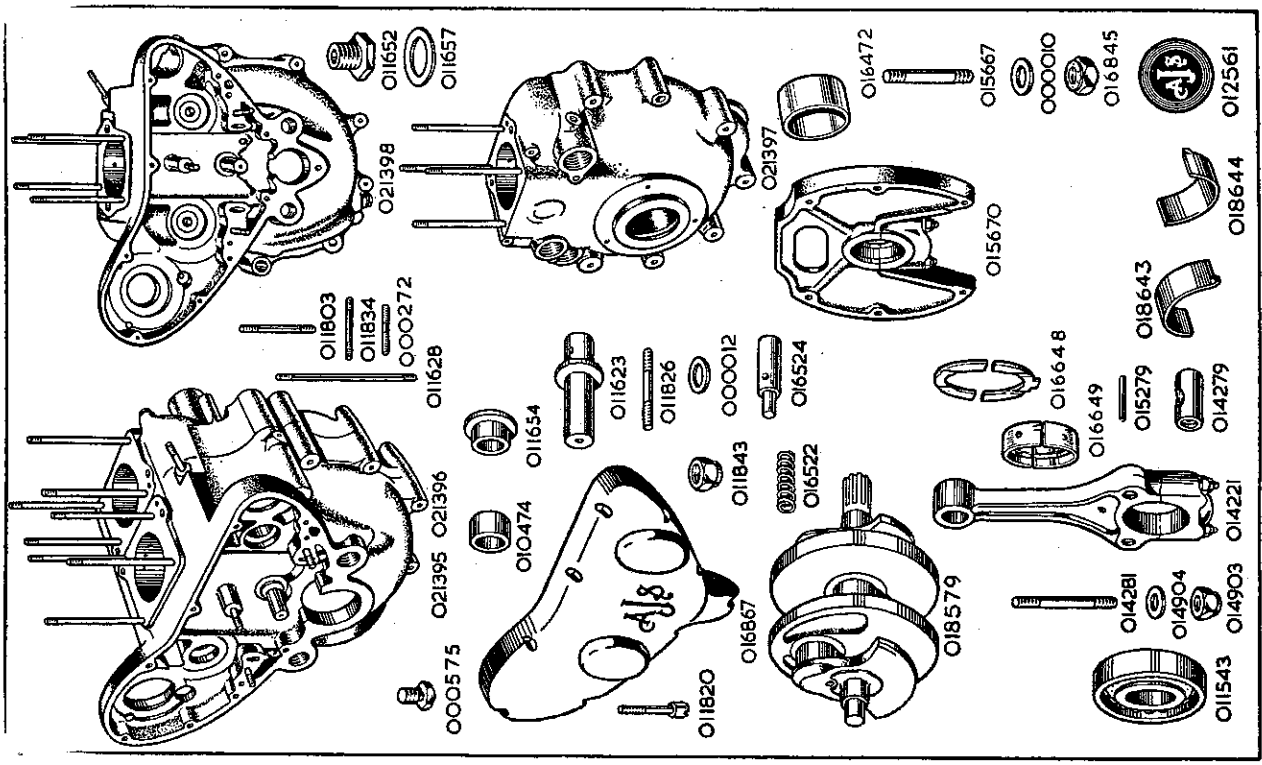

PART NUMBER	DESCRIPTION	QTY. OFF	PRICE EACH £ s. d.
018579	Crankshaft, plugged, but bare	1	11 6 2
016649	Bearing, plain, for centre bearing (in halves).....per pair	1	6 10
016648	Washer, thrust, for centre bearing	2	1 9
011543	Bearing, roller, for crankshaft. (Parts of this bearing not sold separately). $\frac{1}{8}$ in. internal, 3 ins. external, $\frac{1}{4}$ in. wide. Manufacturers part number RLS-12 $\frac{1}{2}$	2	1 9 5
014231	Rod, connecting, assembly. (No big end bearing)	2	3 13 2
014281	Stud, for connecting rod, 2 $\frac{1}{2}$ ins. by $\frac{1}{8}$ in. by 36	2	11
014379	Trunion, for connecting rod	4	3
015279	Rivet, locating connecting rod stud	4	2 $\frac{1}{2}$
014904	Washer, plain, for connecting rod stud	4	7 $\frac{1}{2}$
014903	Nut, for connecting rod stud	4	2 8 $\frac{1}{2}$
018643	Bearing, plain, for connecting rod. (Big-end) top half	2	6 11
018644	Bearing, plain, for connecting rod. (Big-end) bottom half	2	6 11
The following undersize bearings (in pairs) can be supplied. It is necessary to have the journals ground to suit.			
016670	Bearing, plain, for centre bearing, .010 in. Undersize (2 halves)	1	6 10
018671	Bearing, plain, for connecting rod, .010 in. Undersize top half	2	4 0
018564	Bearing, plain, for connecting rod, .010 in. Undersize bottom half	2	10 4

### CRANKSHAFT, CONNECTING RODS AND BEARINGS

### CYLINDERS, PISTONS, HEADS AND VALVES

011713	Cylinder	2	3 0 0
011716	Washer, paper, for cylinder base	2	1 1 $\frac{1}{2}$
015518	Piston, bare, normal size	2	1 0
015803	Piston, bare, .020 in. oversize	2	1 0
018024	Piston, bare, .040 in. oversize	2	1 0
015804	Piston, complete, normal size	2	14 6
015805	Piston, complete, .020 in. oversize	2	14 6
018025	Piston, complete, .040 in. oversize	2	14 6
018109	Piston, bare, normal size	2	1 0
018269	Piston, bare, .020 in. oversize	2	1 0
021241	Piston, bare, .040 in. oversize	2	1 0
018939	Piston, complete, normal size	2	14 6
018979	Piston, complete, .020 in. oversize	2	14 6
021242	Piston, complete, .040 in. oversize	2	14 6
The above complete pistons include— Piston, two compression rings (1 chrome plated), one scraper ring. Gudgeon pin, two circlips for gudgeon pin.			
018297	Ring, compression, chrome plated, normal size	2	4 6
018298	Ring, compression, chrome plated, .020 in. oversize	2	4 6
018299	Ring, compression, chrome plated, .040 in. oversize	2	4 6
010631	Ring, compression, normal size	2	1 6
015522	Ring, compression, .020 in. oversize	2	1 6
016441	Ring, compression, .040 in. oversize	2	1 6
010632	Ring, scraper, normal size	2	1 1
015523	Ring, scraper, .020 in. oversize	2	1 1
016442	Ring, scraper, .040 in. oversize	2	1 1
011731	Pin, gudgeon	2	5 0
014283	Circlip, for gudgeon pin	4	4
018738	Head, for cylinder, bare, left	1	5 11 0
018740	Head, for cylinder, bare, right	1	5 11 0
018755	Head, for cylinder, with valve guides, guide circlips and manifold studs, left	1	5 17 9
018756	Head, for cylinder, with valve guides, guide circlips and manifold studs, right	1	5 17 9

NOTE—Pistons 7 to 1 C.R. are Standard Fitted

BY USING GENUINE SPARES YOU ARE ASSURED THEY WILL FIT ACCURATELY AND GIVE SATISFACTORY SERVICE.

PART NUMBER	DESCRIPTION	QTY. OFF	PRICE EACH £ s. d.
011715	Gasket, for cylinder head	2	4 2
014163	Valve, inlet	2	10 6
014165	Valve, exhaust	2	19 3
011770	Spring, inner, for valve	4	10
011769	Spring, outer, for valve	4	1 6
014169	Seat, for valve springs	4	10
014168	Collar, for valve springs	4	2 1 $\frac{1}{2}$
014167	Collar, for valve stems (in pairs)	4	1 1 $\frac{1}{2}$
014170	Guide, for inlet valves	2	3 0
014171	Guide, for exhaust valves	2	3 0
011111	Circlip, locating valve guides	2	1 $\frac{1}{2}$
000004	Nut, retaining cylinders and heads	4	4
011634	Spacer, $\frac{3}{16}$ in. long for head retaining nuts	8	4
000111	Washer, plain, for head retaining nuts	8	4
010625	Stud, retaining inlet manifold, $1\frac{1}{8}$ in. by $\frac{3}{8}$ in. by 26 and 20	4	1 $\frac{1}{2}$
014352	Bush, for rocker spindle	4	11

### CYLINDERS, PISTONS, HEADS AND VALVES—continued.

### RE-BORING

Cylinders may be re-bored to .020 in. or .040 in. oversize and pistons (with rings) supplied to suit. The charge is £4 19s. 9d. for the pair, with an additional 11s. 2d. if new gudgeon pins and circlips are also supplied. Cylinders sent for re-boring should be packed in stout cases which will be used by us for their return. Carriage is additional. If a complete machine, or engine, is sent to us for cylinder re-boring, there will be an additional charge, according to the time taken, for dismantling and assembly.

### TIMING GEAR

011784	Camshaft, inlet	1	1 17 2
011785	Camshaft, exhaust	1	1 17 2
011620	Gear, on camshaft, 60 teeth	2	1 0
000573	Key, locating camshaft gears	2	1 5
011653	Nut, retaining camshaft gears	2	11
016209	Pinion, on crankshaft, 30 teeth	1	10 6
016210	Spacer, $\frac{3}{8}$ in. long, for crankshaft pinion	1	1 1 $\frac{1}{2}$
000573	Key, locating crankshaft pinion	1	11
010589	Bolt, retaining crankshaft pinion, threaded $\frac{1}{2}$ in. by 20	1	6
011621	Washer, plain, for crankshaft pinion bolt	1	2 2
015278	Gear, intermediate, with bush, 60 teeth	1	1 0
018576	Follower, for camshaft	1	15 4
011626	Spindle, for camshaft followers	2	3 0
011627	Spacer, $1\frac{1}{2}$ in. long between camshaft followers	2	10
018680	Spacer, washer	4	6

### ROCKERS AND PUSH RODS

014284	Rocker, with bushes (left inlet and right exhaust)	2	1 7 4
014285	Rocker with bushes (right inlet and left exhaust)	2	1 7 4
014222	Spindle for rockers	4	13 6
014226	Washer, spring, double coil, for rocker spindle	4	1 $\frac{1}{2}$
014275	Washer, plain, for either side of rocker spindle	8	2 $\frac{1}{2}$
014275	Washer, plain, for clamping end of rocker spindle	4	2 $\frac{1}{2}$
011760	Bolt, clamping rocker spindle. (Thread No. 2 B.A.)	4	1 5
015021	Nut, for rocker spindle clamping bolt	4	4
011846	Bush, for rocker spindle clamping bolt	4	4
014245	Cover, for rockers. (Two in each rocker)	4	11 10
018625	Gasket, for rocker covers	4	1 5
018493	Screw, retaining rocker covers	8	1 2
018517	Rod, push, assembled with ends	4	7 2 0
018508	Rod, push, bare	4	2 0
018518	End, upper, for push rod	4	3 0
018519	End, lower, for push rod	4	2 5



PART NUMBER	DESCRIPTION	QTY. OFF	PRICE EACH		
			£	s.	d.

**OIL FELT FILTER (IN ENGINE)**

014235	Filter, felt, for engine crankcase	1	7	2	
018120	Seat, for oil felt filter	1	4	6	
014240	Valve, relief, for oil felt filter	1	21		
014241	Spring, for oil felt filter relief valve	1	8		
016179	Cap, for felt filter housing (also accommodates oil non-return valve)	1	2		
012116	Washer, fibre, for filter housing cap	1	2		
011645	Ball, 3/8 in. steel, for non-return valve	1	10		
013564	Spring, for non-return valve ball	1	1		
013332	Plug, screwed, retaining non-return valve spring	1	1		
011642	Washer, fibre, for non-return valve spring plug	1	1		
015034	Gasket, paper, for oil filter chamber (fits between the two crankcase halves)	1	1		

**OIL DISTRIBUTOR. (Driven by the left hand end of exhaust camshaft)**

014246	Distributor, oil	1	3	2 1/2	
014247	Cap, housing, for oil distributor	1	6	4	
011642	Washer, fibre, for oil distributor housing cap	1	6	2 1/2	

**OIL RELIEF VALVE. (Located in Timing side crankcase, close to oil feed pump).**

016524	Piston, for oil relief valve	1	1	0	
016522	Spring, for oil relief valve piston	1	1	1 1/2	

**GENUINE A.J.S SPARES**

PURCHASED FROM  
 AN AUTHORISED "A.J.S" DEALER  
 OR FROM THE FACTORY, ARE IDENTICAL  
 WITH THE PARTS ORIGINALLY BUILT  
 INTO YOUR MOTOR CYCLE

**MAINTENANCE MANUAL** EDITION CM-29 **PRICE 2/6**  
 IS THE APPROPRIATE MANUAL FOR THIS SPARES LIST

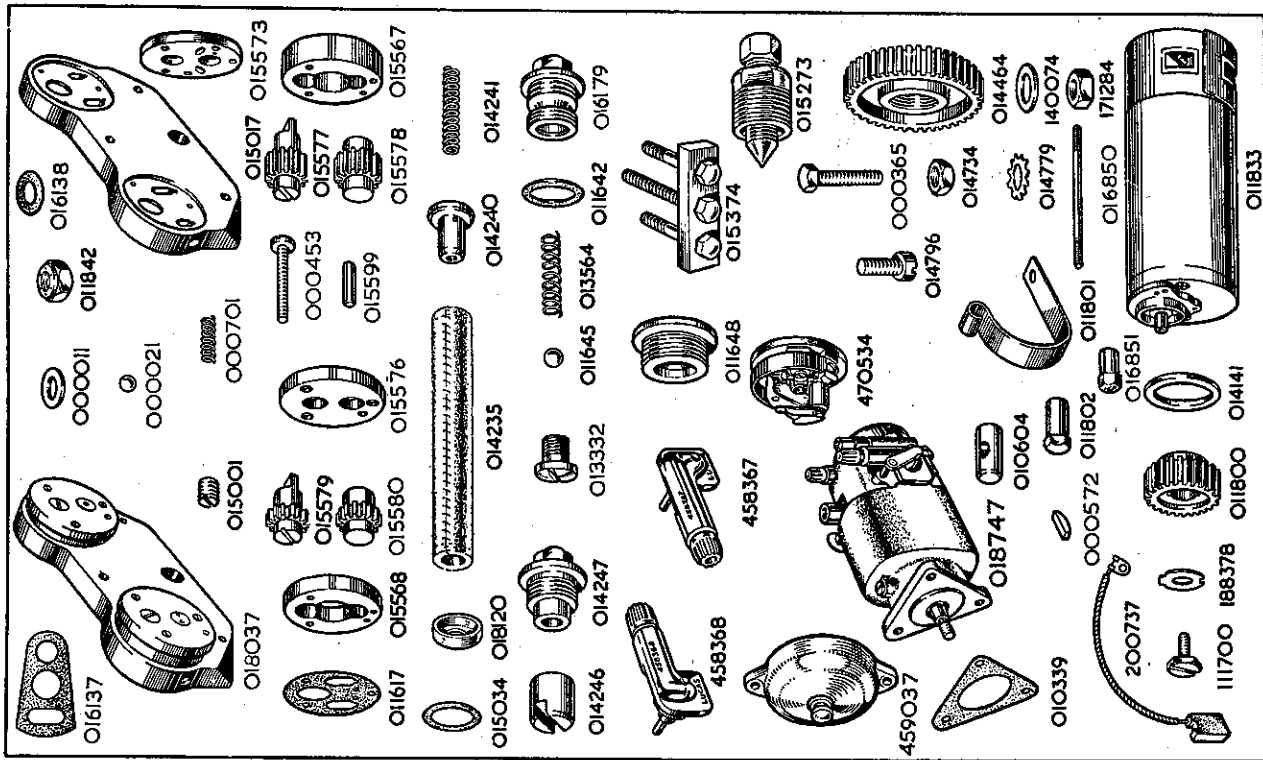

PART NUMBER	DESCRIPTION	QTY.	PRICE EACH
		OFF	£ s. d.
<b>CARBURETTER</b>			
021182	Carburetter, complete (less wires and levers) Type 76AT/I.E.F. ...	1	2 19 3
018654	Manifold, inlet, bare (no studs). (The studs are listed with cylinder heads).....	1	16
000012	Washer, plain, for inlet manifold retaining studs.....	4	1 1/2
000005	Nut, for inlet manifold retaining studs.....	4	4
011771	Gasket, between inlet manifold and cylinder heads.....	2	1 1/2
016724	Bolt, retaining carburetter to inlet manifold, 3/8 in. by 2 1/2	2	6
000011	Washer, plain, for carburetter retaining bolts.....	2	1 1/2
018503	Ring, between carburetter and manifold.....	1	2 1/2

<b>FLOAT CHAMBER</b>			
64-192-B	Chamber, float, bare.....	14	0
13-153	Screw, plug, blocking passage in float chamber.....	3	1
14-039	Washer, fibre, for float chamber passage plug screw.....	3	9
14-208	Top, or cover, for float chamber.....	3	4
14-021	Screw, locking float chamber top.....	3	9
14-015	Float, bare.....	1	10
14-024	Needle, for float.....	3	2
14-209	Tickler, bare.....	3	2
14-210	Stop, for tickler.....	3	2
14-032	Spring, for tickler.....	1	9
14-289	Cutter (split pin), for petrol pipes.....	6	9
14-352	Banjo, connection, for petrol pipes.....	2	2
14-175	Washer, fibre, upper, for petrol banjo connection.....	2	2
14-037	Washer, fibre, lower, for petrol banjo connection.....	2	2
14-036	Nut, retaining banjo connection to float chamber.....	9	9

<b>MIXING BODY</b>			
76-014	Body, mixing, bare.....	14	0
6-033	Nut, union, for base of mixing body.....	2	3
6-040	Washer, fibre, for mixing body union nut.....	3	0
4-043	Bolt holding float chamber to mixing body.....	2	2
4-053	Washer, fibre, for float chamber holding bolt.....	3	0
6-038	Intake, air.....	2	6
6-032	Top, for mixing chamber.....	2	6
6-031	Rings, fixing top to mixing chamber.....	9	9
4-235	Clip, locking mixing chamber top fixing ring.....	2	2
4-241	Screw, securing locking clip to mixing body top.....	2	6
4-035	Adjuster, for control cable, throttle or air.....	2	6

<b>CHOKE AND JETS</b>			
6-058	Choke, or jet barrel.....	7	6
4-061	Needle jet.....	2	6
4-042-180	Jet, main, size 180.....	8	8
6-065	Needle, taper, for needle jet.....	2	0
4-230	Clip, for jet taper needle.....	6	6
4-060	Pin, split, locating taper needle clip.....	1	9
13-129	Screw, for pilot jet air adjustment.....	1	9
4-206	Nut, lock, for pilot jet air screw.....	2	2
The following alternative main jets can be supplied.			
4-042-160	Jet, main, size 160.....	8	8
4-042-170	Jet, main, size 170.....	8	8
4-042-190	Jet, main, size 190.....	8	8

BY USING GENUINE SPARES YOU ARE ASSURED THEY WILL FIT ACCURATELY AND GIVE SATISFACTORY SERVICE

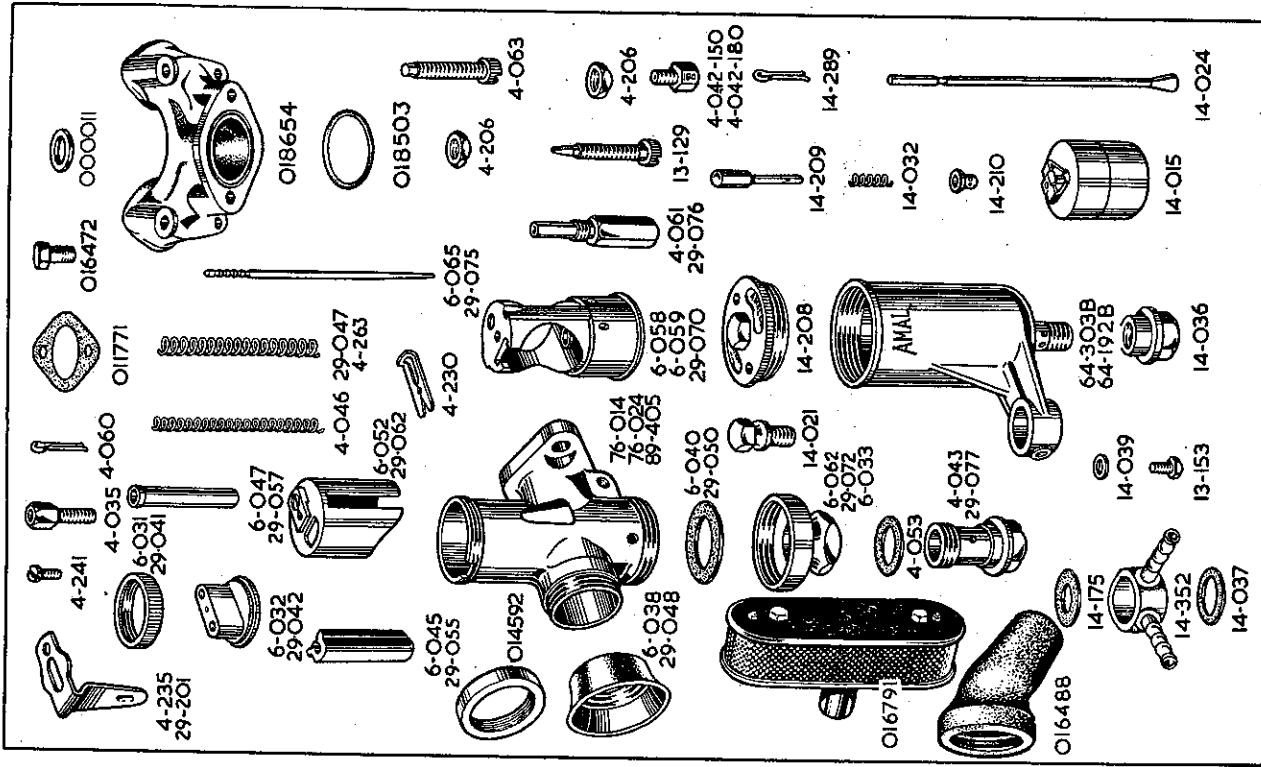

PART NUMBER	DESCRIPTION	QTY. OFF	PRICE EACH £ s. d.
-------------	-------------	----------	--------------------

**VALVES (CARBURETTER)**

6-052	Valve, throttle, size 6/4	...	6 0
4-263	Spring, for throttle valve	...	4
4-063	Screw, stop, for throttle valve	...	2
4-206	Nut, lock, for throttle valve stop screw	...	9
6-045	Valve, air	...	3 9
6-047	Guide, tubular, for air valve spring	...	1 0
4-046	Spring, for air valve	...	4

**AIR CLEANER. (This is optional extra equipment)**

016791	Cleaner, air	...	1 11 6
014591	Adaptor, for air cleaner (screws on carburetter)	...	1 6
016488	Sleeve, rubber, connecting air cleaner to carburetter adaptor	...	3 6
016983	Set of air cleaner elements comprising filter element and two fabric end gaskets	...	8 0

When an air cleaner is fitted it is essential to—  
 (a) Use an adaptor and connector in order to fit the cleaner to carburetter intake. (016791 does not include these.)  
 (b) Fit a smaller jet, viz., use jet 4-042-160 (size 160), price 6d.

**MAGNETO**

018747	Magneto, complete, Type K2F (Lucas number 42230-A)	10	0 0
458367	Pick-up, with brush and spring, right	...	5 3
458368	Pick-up, with brush and spring, left	...	5 3
470534	Contact breaker, complete	...	1 0 0
470609	Contact set	...	8 9
459037	Cover, for contact breaker with switch	...	6
010339	Gasket, for magneto flange	...	1 1 7 1/2
000365	Bolt, retaining magneto, 1 1/2 in. by 7/8 in. by 26	...	7 1/2
014779	For the two magneto retaining studs, see "Crankcase Group."	...	...
000004	Washer, lock, for magneto retaining bolt and studs	3	1 4
014464	Nut, for magneto retaining bolt and studs	3	1 4
140074	Gear, on magneto shaft	...	1 12 5
171284	Washer, plain, on magneto shaft	...	1
	Nut, on magneto shaft, retaining magneto driving gear	...	4

**DYNAMO**

011833	Dynamo, Type E3-L-R-0 (Lucas Number 20009-B)	7	10 0
200737	Brush, for dynamo, set of two, per set	...	3 9
014141	Gasket, between dynamo and crankcase	...	1 1 1/2
011801	Strap, retaining dynamo to crankcase	...	1 1
014796	Screw, retaining lower end of dynamo strap to crankcase, 7/8 in. by 3/4 in. by 20	...	2 1/2
000012	Washer, plain, for dynamo strap retaining screw	...	1 1 1/2
010604	Crosshead, in eye of dynamo retaining strap	...	7 1/2
011802	Nut, tensioning dynamo strap. (The stud on which this nut screws, is listed with the crankcase parts)	...	5
000012	Washer, plain, for dynamo strap tensioning nut	...	1 1/2
011800	Gear on Dynamo shaft	...	10 2
000572	Key, locating dynamo shaft gear	...	4
111700	Bolt, retaining gear on dynamo shaft	...	6
188378	Washer, lock, for dynamo gear retaining bolt	...	2
016850	Stud, drawing dynamo to crankcase, and passing through timing cover, 2 1/2 ins. long by 2 B.A.	...	5
016851	Nut, for dynamo draw stud	...	1 1

PART NUMBER	DESCRIPTION	QTY. OFF	PRICE EACH £ s. d.
-------------	-------------	----------	--------------------

**CRANKCASE BOLTS, with engine plates and all bolts passing through same.**

014292	Bolt, clamping crankcase throat, 3 1/8 ins. by 7/8 in. by 22. (These bolts pass through the driving side crankcase and thread into the timing side crankcase)	3	11
000011	Washer, plain, for 014292 crankcase bolts	3	1 1/2
013944	Plate, engine front, right side	1	2 5
013943	Plate, engine front, left side	1	2 5
014736	Stud, passing through crankcase and upper holes in engine, front plates, 5 ins. by 3/8 in. by 26. (This stud also supports the stays for the exhaust pipes)	1	6
000174	Washer, plain, for 014736 engine plate stud	2	1 1/2
000192	Washer, spring, for 014736 engine plate stud	2	1 1/2
000004	Nut, for 014736 engine plate stud	2	4
000278	Stud, passing through crankcase and lower holes in engine front plates, 4 1/2 ins. by 7/8 in. by 26	1	7 1/2
000011	Washer, plain, for 000278 engine plate stud	2	1 1/2
000004	Nut, for 000278 engine plate stud	2	4
000277	Stud, passing through crankcase at bottom, 4 3/8 ins. by 7/8 in. by 26	1	7 1/2
000011	Washer, plain, for 000277 crankcase stud	2	1 1/2
000004	Nut for 000277 crankcase stud	2	4
000303	Stud, passing through front of main frame and top of engine front plate, 4 1/2 ins. by 7/8 in. by 26	1	7 1/2
000010	Washer, plain, for 000303 frame stud	2	1 1/2
000003	Nut, for 000303 frame stud	2	4
021086	Stud, passing through main frame front tube bottom lug, the crankcase, and the front ends of the rear frame rails, 6 ins. by 1/2 in. by 26	1	1 0
000010	Washer, plain, for 021086 frame stud	2	1 1/2
000003	Nut, for 021086 frame stud	2	4
018014	Plate, engine, rear	2	5 1
000278	Stud, passing through top of engine rear plates and the crankcase, 4 1/2 ins. by 7/8 in. by 26	1	7 1/2
000278	Stud, passing through bottom of engine rear plates and the crankcase, 4 1/2 ins. by 7/8 in. by 26	1	7 1/2
000011	Washer, plain, for 000278 studs	3	1 1/2
000004	Nut, for 000278 studs	3	4
000316	Stud, passing through engine rear plates, rear of crankcase, and centre of front chaincase, 7 1/2 ins. by 7/8 in. by 26. (Stud should be fitted so that the longer thread is on left-hand side of machine)	1	1 5
014084	Spacer, 1 1/2 in. long, on 000316 stud, between back of front chaincase and crankcase	1	8 1/2
021230	Wide nut spacer, on 000316 stud, inside front chaincase	1	9
000009	Washer, plain, for 000316 stud	3	1 1/2
000002	Nut, for 000316 stud	2	5
000303	Stud, passing through top of engine, rear plates, lower end of main frame seat tube and rear fork bridge, 4 3/4 ins. by 7/8 in. by 26	1	7 1/2
000003	Nut, for 000303 stud	2	4
000278	Stud, passing through rear fork bridge and back ends of engine rear plates, 4 1/2 ins. by 7/8 in. by 26	1	7 1/2
000011	Washer, plain, for 000278 stud	1	1 1/2
000004	Nut, for 000278 stud	1	4

For the bolt stud passing through the top and bottom of the gear box and the engine rear plates, see "Gear Box Fixing Bolts".  
 For the footrest rod, which passes through the bottoms of the engine rear plates and the frame rails, see "Footrests".

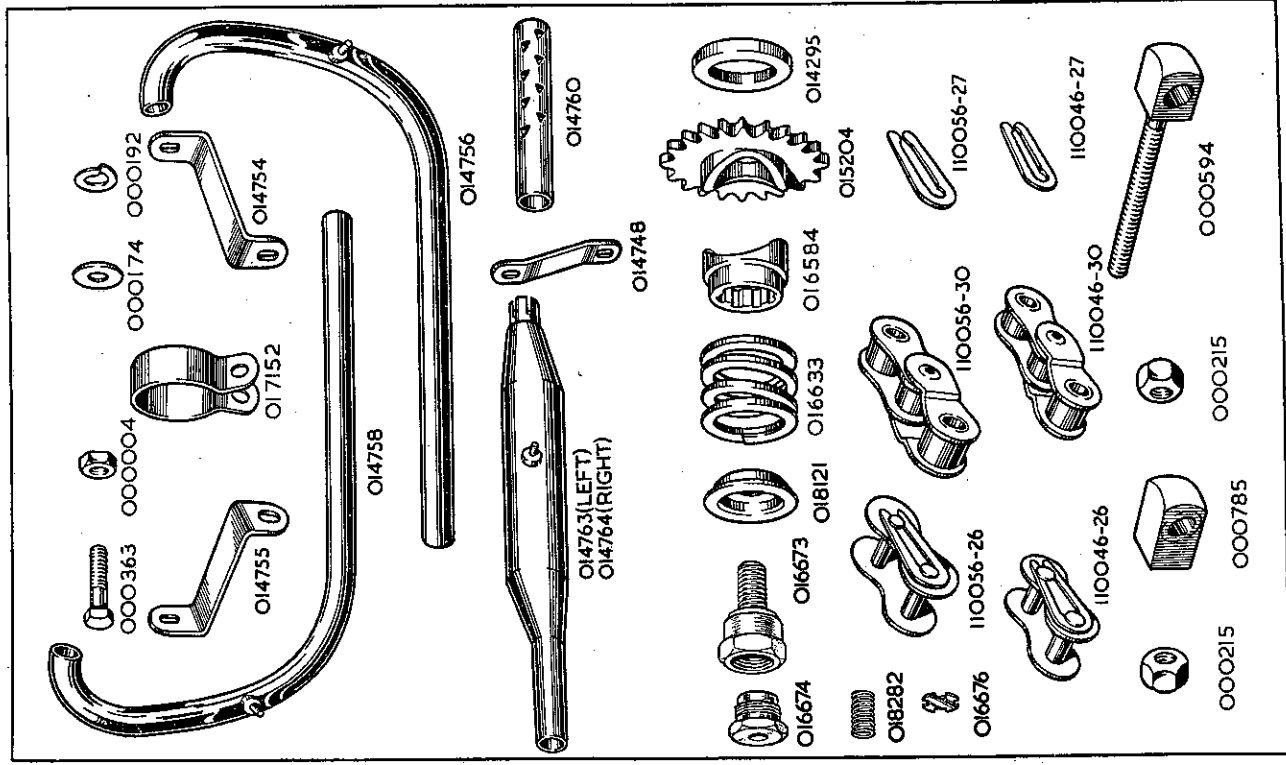

PART NUMBER	DESCRIPTION	QTY. OFF	PRICE EACH £ s. d.
-------------	-------------	----------	--------------------

**GASKETS**

We supply engine gaskets, either as separate spares, or in complete sets. Single gaskets, are listed in the groups to which they belong. Gaskets in complete sets are listed below

Complete gasket set for vertical twin engine ..... 12 4  
 Decarbonising gasket set for vertical twin engine ..... 10 5

Each complete gasket set contains—

- 1-011642 Washer, fibre, for engine filter housing cap.
- 1-011642 Washer, fibre, for oil distributor housing cap.
- 1-011642 Washer, fibre, for crankcase release valve housing cap.
- 2-000183 Washer, fibre, for bonio end of oil pipes.
- 2-011617 Washer, paper, for oil pump bodies.
- 2-011716 Washer, paper, for cylinder bases.
- 1-015034 Washer, paper, for oil filter chamber.
- 1-010339 Gasket, between magneto and crankcase.
- 2-011715 Gasket, for cylinder head.
- 2-011771 Gasket, between inlet manifold and cylinder head.
- 1-014141 Gasket, between dynamo and crankcase.
- 4-018493 Gasket, for rocker covers.
- 2-016137 Gasket, oval, behind pump carrying plate.
- 1-016138 Gasket, round, behind pump carrying plate.

Each decarbonising gasket set includes:—

- 2-011715 Gasket, for cylinder heads.
- 4-018493 Gasket, for rocker covers.
- 2-011771 Gasket, between inlet manifold and cylinder heads.
- 2-011716 Washer, paper, for cylinder bases.

**EXHAUST PIPES AND SILENCERS**

014756	Pipe, exhaust, bare, left side	1	7 8
014758	Pipe, exhaust, bare, right side	1	7 8
014760	Baffle, for exhaust pipe	2	3 11
014754	Stay, for exhaust pipe, left side	1	10
014755	Stay, for exhaust pipe, right side	1	10
000004	Nut, fixing exhaust pipe to stay	2	4
000174	Washer, plain, for exhaust pipe fixing nut	2	1 1/2
014763	Silencer, bare, left side	1	16 11
014764	Silencer, bare, right side	1	16 11
017152	Clip, clamping silencer to pipe	2	1 1/2
000363	Bolt, for silencer clip, 3/8 in. by 1/2 in. by 1/8 in.	2	5
000174	Washer, plain, for silencer clip bolt	2	4
000004	Nut, for silencer, clip bolt	2	4
014748	Stay, for silencer	2	8 1/2
000004	Nut, fixing silencer to stay	2	4
000174	Washer, plain, for silencer to stay fixing nut	2	1 1/2
000192	Washer, spring, for silencer to stay fixing nut	2	1 1/2
000004	Nut, fixing silencer stay to frame rail	2	4
000174	Washer, plain, for silencer stay to frame rail nut	2	1 1/2
000192	Washer, spring, for silencer stay to frame rail nut	2	1 1/2

**ALWAYS INCLUDE ALL THE LETTERS  
WHEN QUOTING THE ENGINE NUMBER**

PART NUMBER	DESCRIPTION	QTY. OFF	PRICE EACH £ s. d.
-------------	-------------	----------	--------------------

**ENGINE SPROCKETS (and Crankcase Release Valve)**

016665	Sprocket, engine, bare, 18 teeth (for sidcar use only)	1	4 2
015203	Sprocket, engine, bare, 19 teeth	1	7 2
015204	Sprocket, engine, bare, 20 teeth. (This is the standard sprocket)	1	7 2
014294	Sprocket, engine, bare, 21 teeth	1	4 6
014295	Spacer (collar), $\frac{3}{16}$ in. wide, for engine sprocket	1	14 5
016384	Cam, engine shock absorber	3	8 $\frac{1}{2}$
016633	Spring, engine shock absorber	3	2 $\frac{1}{2}$
018121	Cap. for engine shock absorber spring	1	2
016673	Bolt, locking shock absorber assembly, threaded $\frac{3}{8}$ in. by 20. (Also houses crankcase release valve)	1	2 $\frac{1}{2}$
016676	Diaphragm, for crankcase release valve	1	2 $\frac{1}{2}$
018282	Spring, for crankcase release valve diaphragm	1	2 $\frac{1}{2}$
016674	Plug, retaining crankcase release valve. (Screws into bolt 016673)	1	0

**CHAINS**

017298	Chain, front, 66 links, $\frac{1}{2}$ in. by .305 in.	1	1
017375	Chain, rear, 96 links, $\frac{1}{2}$ in. by .380 in.	2	5 0
110046-26	Link, connecting, for $\frac{1}{2}$ in. chains	R	8
110056-26	Link, cranked, double, for $\frac{1}{2}$ in. chains	R	11
110046-30	Link, cranked, double, for $\frac{3}{4}$ in. chains	R	12
110056-30	Link, cranked, double, for $\frac{3}{4}$ in. chains	R	17
110046-27	Clip, spring, for 110046-26 connecting links ( $\frac{1}{2}$ in.)	R	1
110056-27	Clip, spring, for 110056-26 connecting links ( $\frac{3}{4}$ in.)	R	2

The prices of front and rear chains include spring connecting links and these are also included in the number of links per chain.  
We do not sell odd lengths of chains.

**GEAR BOX**

016709	Gear, box complete, with clutch and with kick-starter and gear control levers	1	★
--------	---	---	---

★ Price on application.

**GEAR BOX FIXING PARTS**

010957	Bolt, gearbox top fixing, $5\frac{1}{4}$ ins. by $\frac{7}{16}$ in. by 26.	1	2 5
000318	Stud, gearbox bottom fixing, $4\frac{1}{2}$ ins. by $\frac{1}{4}$ in. by 26.	1	1 0
012999	Spacer, $\frac{1}{2}$ in. wide, on top bolt, outside right.	1	1 5
000002	Nut, for gearbox top fixing bolt.	1	5
000002	Nut, for gearbox bottom fixing stud.	2	5
000009	Washer, plain, for top fixing bolt, left side.	1	1 $\frac{1}{2}$
000594	Eye-bolt, for front chain adjustment.	1	4
000215	Nut, for front chain adjustment eye-bolt.	2	5
000785	Block, crosshead, for front chain adjustment eye-bolt. (This threads on the right hand end of 000278 stud that passes through the rear of the engine rear plates and the top of the rear fork bridge)	1	2 $\frac{1}{2}$

**GEAR BOX SHELL**

G-1-2	Shell, gearbox, bare (without inspection hole)	1	2 5 0
G-1-9	Shell, gearbox, bare (with inspection hole)	2	5 0
21-10-3	Inspection plug	3	0 2
12-10-5	Inspection plug washer	3	2
21-7-5	Plug, drain, for gearbox shell	1	1
12-7-6	Washer, fibre, for gearbox shell drain plug	1	1
12-7-4	Cap, in shell, covering bore for selector spindles	2	3
35-3-2	Pin, dowel, locating, kick-starter case on gearbox shell	1	4
G-2-6	Case, kick-starter	1	5 0
G-5-3	Washer, paper, between shell and kick-starter case	1	1

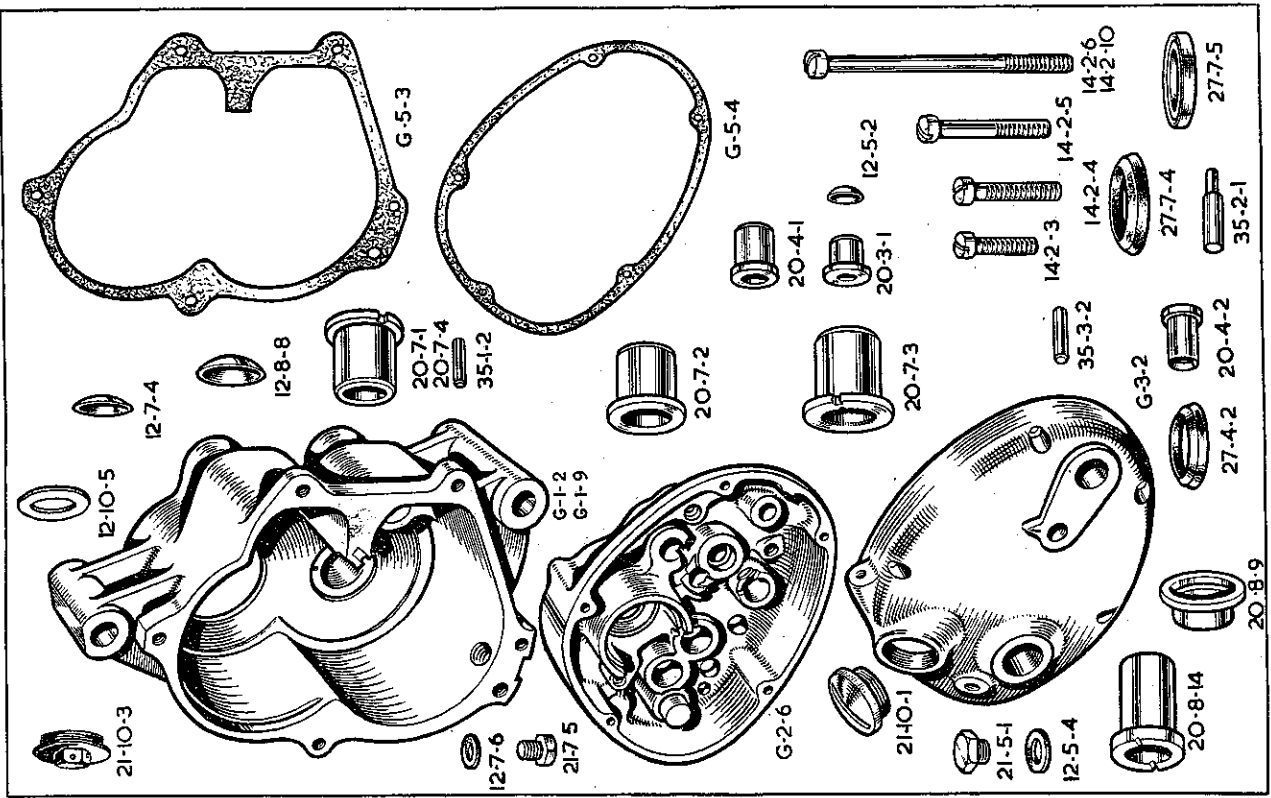



PART NUMBER	DESCRIPTION	QTY. OFF.	PRICE EACH £ s. d.
<b>GEAR OPERATING PARTS</b>			
G-30-2	Spindle, for selector forks.....	2	7 6
G-29-2	Fork, for gear selection.....	2	10 0
35-3-1	Peg, for selector spindles.....	4	6
16-1-4	Pin, center, for selector spindle pegs.....	4	1
018337	Cam, assembly.....	1	1 10 0
The cam assembly comprises:—			
1—G-27-2	Spindle.....		
1—G-28-1	Cam.....		
3—35-2-4	Pegs.....		
1—35-2-2	Locating pegs.....		
2—35-1-4	Cam stop pegs.....		
(Above parts not sold as separate spares)			
G-42-3	Plunger, locating cam assembly.....	2	0
36-2-1	Spring, for cam assembly locating plunger.....	6	6
G-25-2	Quadrant, for control spindle.....	7	6
35-2-6	Peg, quadrant drive.....	3	3
G-24-2	Spindle, for gear control.....	12	6
36-11-1	Spring, primary, for control quadrant.....	2	0
36-8-3	Spring, secondary, for control quadrant.....	6	6
G-47-1	Indicator.....	9	9
36-4-1	Spring under indicator.....	3	3
11-2-3	Nut, retaining indicator.....	3	3
G-44-7	Lever, foot, for gear control.....	1	1
G-48-1	Pad, rubber, for gear foot lever.....	1	1
35-1-6	Pin, fixing gear foot lever rubber pad.....	1	1
10-2-2	Bolt, clamping gear foot lever.....	1	10
12-2-1	Washer, spring, for gear foot lever bolt.....	1	1
11-2-1	Nut, for gear foot lever bolt.....	3	3

G-32-2	Case, for five plate clutch.....	18	0
29-2-4	Rivet, for clutch case and chainwheel.....	2	2
G-34-2	Chainwheel, 40 teeth by $\frac{1}{2}$ in. by 305 in.....	1	10
018339	Case and chainwheel, assembled (five plate).....	2	10 0
G-35-2	Sleeve, for mainshaft.....	3	0
12-10-2	Race, roller, for clutch bearing chainwheel.....	3	0
18-2-1	Rollers, for chainwheel bearing.....	1	1
12-10-3	Washer, thin, chainwheel bearing.....	1	1
12-10-4	Washer, thick, chainwheel bearing.....	1	10
G-37-3	Centre, for five plate clutch.....	1	0
12-7-5	Washer, plain, for centre retaining nut.....	9	9
12-7-7	Washer, lock, for centre retaining nut.....	9	9
12-7-5	Nut, retaining clutch centre.....	3	0
11-7-11	Plate, clutch, plain, steel.....	5	6
G-39-4	Plate, clutch, friction, with inserts.....	5	6
G-41-5	Inserts, fabric, for friction plate.....	2	6
G-39-2	Plate, clutch, spring pressure.....	1	1
25-7-3	Cup thrust, for spring pressure plate.....	1	6
11-7-8	Nut, lock, for pressure plate thrust cup.....	5	6
14-2-8	Spring, for clutch.....	5	6
36-6-1	Cup, for clutch spring.....	9	9
G-42-2	Nut, adjusting, for clutch spring.....	5	6
11-2-2			

PART NUMBER	DESCRIPTION	QTY. OFF.	PRICE EACH £ s. d.
<b>CLUTCH</b>			
G-36-3	Case, for five plate clutch.....	18	0
29-2-4	Rivet, for clutch case and chainwheel.....	2	2
G-34-2	Chainwheel, 40 teeth by $\frac{1}{2}$ in. by 305 in.....	1	10
018339	Case and chainwheel, assembled (five plate).....	2	10 0
G-35-2	Sleeve, for mainshaft.....	3	0
12-10-2	Race, roller, for clutch bearing chainwheel.....	3	0
18-2-1	Rollers, for chainwheel bearing.....	1	1
12-10-3	Washer, thin, chainwheel bearing.....	1	1
12-10-4	Washer, thick, chainwheel bearing.....	1	10
G-37-3	Centre, for five plate clutch.....	1	0
12-7-5	Washer, plain, for centre retaining nut.....	9	9
12-7-7	Washer, lock, for centre retaining nut.....	9	9
12-7-5	Nut, retaining clutch centre.....	3	0
11-7-11	Plate, clutch, plain, steel.....	5	6
G-39-4	Plate, clutch, friction, with inserts.....	5	6
G-41-5	Inserts, fabric, for friction plate.....	2	6
G-39-2	Plate, clutch, spring pressure.....	1	1
25-7-3	Cup thrust, for spring pressure plate.....	1	6
11-7-8	Nut, lock, for pressure plate thrust cup.....	5	6
14-2-8	Spring, for clutch.....	5	6
36-6-1	Cup, for clutch spring.....	9	9
G-42-2	Nut, adjusting, for clutch spring.....	5	6
11-2-2			

PART NUMBER	DESCRIPTION	QTY. OFF.	PRICE EACH £ s. d.
<b>CLUTCH OPERATING PARTS</b>			
37-3-1	Rod, thrust, 10 $\frac{1}{4}$ ins. long (five plate clutch).....	1	6
17-3-2	Ball, $\frac{1}{8}$ in., steel, for clutch thrust rod.....	1	0
G-32-2	Cam-plate, fixed, actuating clutch.....	2	0
G-33-3	Cam-plate, moving, actuating clutch.....	2	6
35-3-4	Dowel, thrust (passes through both cam-plates).....	1	1
12-2-4	Washer, plain, for cam-plate dowel.....	1	3
36-2-3	Spring, for cam-plate dowel.....	1	3
16-1-5	Pin, split, for cam-plate dowel.....	3	1
17-3-2	Ball, $\frac{1}{8}$ in., steel, for cam-plates.....	3	1

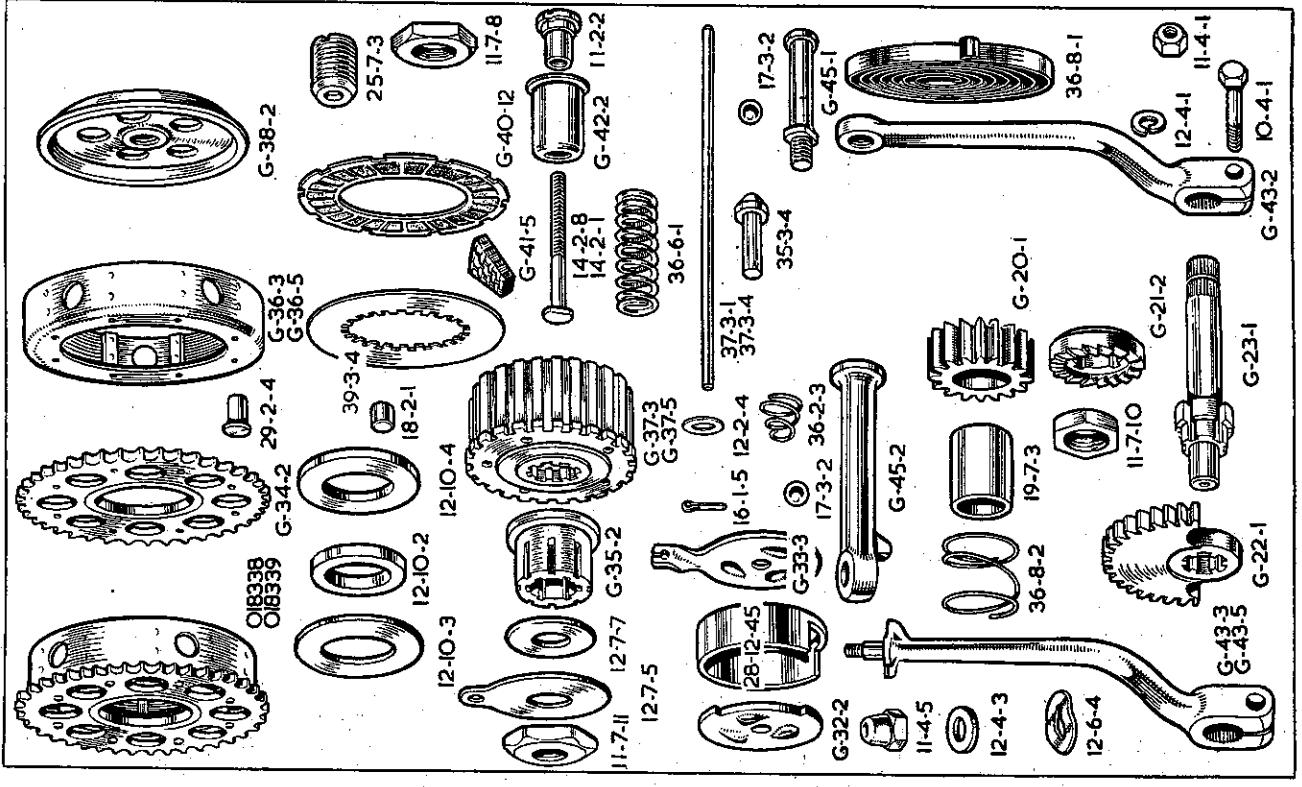

PART NUMBER	DESCRIPTION	QTY. OFF	PRICE EACH £ s. d.
<b>KICK-STARTER</b>			
G-21-2	Ratchet, driving, kick-starter.....	1	8 8
G-20-1	Pinion, ratchet, kick-starter.....	1	12 0
19-7-3	Bush, kick-starter ratchet pinion.....	3	9
36-8-2	Spring, kick-starter ratchet pinion.....	1	1 6
11-7-10	Nut, retaining ratchet driver to mainshaft.....	6	11 3
G-23-1	Spindle, for kick-starter quadrant.....	15	9
G-22-1	Quadrant, for kick-starter.....	1	7 0
O18340	Kick-starter quadrant and spindle assembled.....	4	0
36-8-1	Spring, return, for kick-starter foot lever.....	15	9
G-43-2	Lever, foot, kick-starter, bare.....	4	6
G-45-1	Pin, pedal, rigid, for kick-starter lever.....	1	1
10-4-1	Bolt, clamping, kick-starter foot lever to spindle.....	1	9
12-4-1	Washer, spring, for foot lever clamping bolt.....	1	2
11-4-1	Nut, for foot lever clamping bolt.....	1	2

PART NUMBER	DESCRIPTION	QTY. OFF	PRICE EACH £ s. d.
<b>FRONT FRAME</b>			
O21048	Frame, front portion only, bare.....	1	7 12 4
O00806	Race, ball, for frame head lug.....	2	4 7
O00072	Balls, $\frac{3}{8}$ in. diameter, for steering head, per set of.....	56	1 6
O00051	Nipples, grease, for frame head lug.....	1	1 6
O14478	Stud, for seat lug (below saddle), $4\frac{1}{2}$ ins. by $\frac{3}{8}$ in. by 26.....	1	1 1 1/2
O00008	Washer, plain, for seat lug stud.....	2	5
O00001	Nut, for seat lug stud.....	2	5
O00015	Screw, securing earth wires (screws into end of stud O14478) $\frac{3}{8}$ in. by 3 B.A.....	1	1 1/2
O00185	Washer, plain, for STD.15 earth wire screw.....	1	1 1/2
O16768	Stud, $1\frac{1}{2}$ in. by $\frac{3}{8}$ in. by 26, for oil tank, battery carrier and air cleaner retention.....	2	5
O18641	Stud, $1\frac{1}{2}$ in. by $\frac{3}{8}$ in. by 26, for oil tank, battery carrier and air cleaner retention.....	1	7 1/2
O00174	Washer, plain, for O16768 stud.....	1	1 1/2
O00004	Nut, for O16768 stud.....	3	4
O00014	Pin, split, for O18641 stud.....	1	1 1/2

PART NUMBER	DESCRIPTION	QTY. OFF	PRICE EACH £ s. d.
<b>REAR FRAME</b>			
O21094	Rail, frame, right side.....	1	2 10
O21092	Rail, frame, left side.....	1	2 11 2
O14512	Loop, rear frame.....	1	4 6 3
O00002	Stud, for rear loop at bottom, 12 ins. by $\frac{7}{8}$ in. by 26. (Also passes through rear fork bridge and both frame rails).....	1	5 2
O00009	Nut, for rear loop bottom stud.....	2	5
O18617	Washer, plain, for rear loop bottom stud.....	2	7 6
O18616	Tube, supporting rear of rear mudguard, right side.....	1	7 6
O00343	Tube, supporting rear of rear mudguard, left side.....	1	7 6
O18648	Bolt, fixing mudguard support tube to mudguard, $\frac{3}{8}$ in. by $\frac{1}{2}$ in. by 26.....	2	4
O00012	Bolt, fixing mudguard support tube to frame loop (also fixes top end of rear leg).....	2	1 7 1/2
O00191	Washer, plain, for mudguard support tube bolt.....	2	1 1/2
O00005	Nut, for mudguard support tube bolt.....	2	4
O15329	Bridges, for rear fork (includes bushes and studs for centre stand spring clip).....	1	2 12 8 1/2
O14672	Bush, for rear fork bridge.....	2	4
O00250	Stud, for rear fork bridge $\frac{3}{8}$ in. by 2 B.A.....	2	4

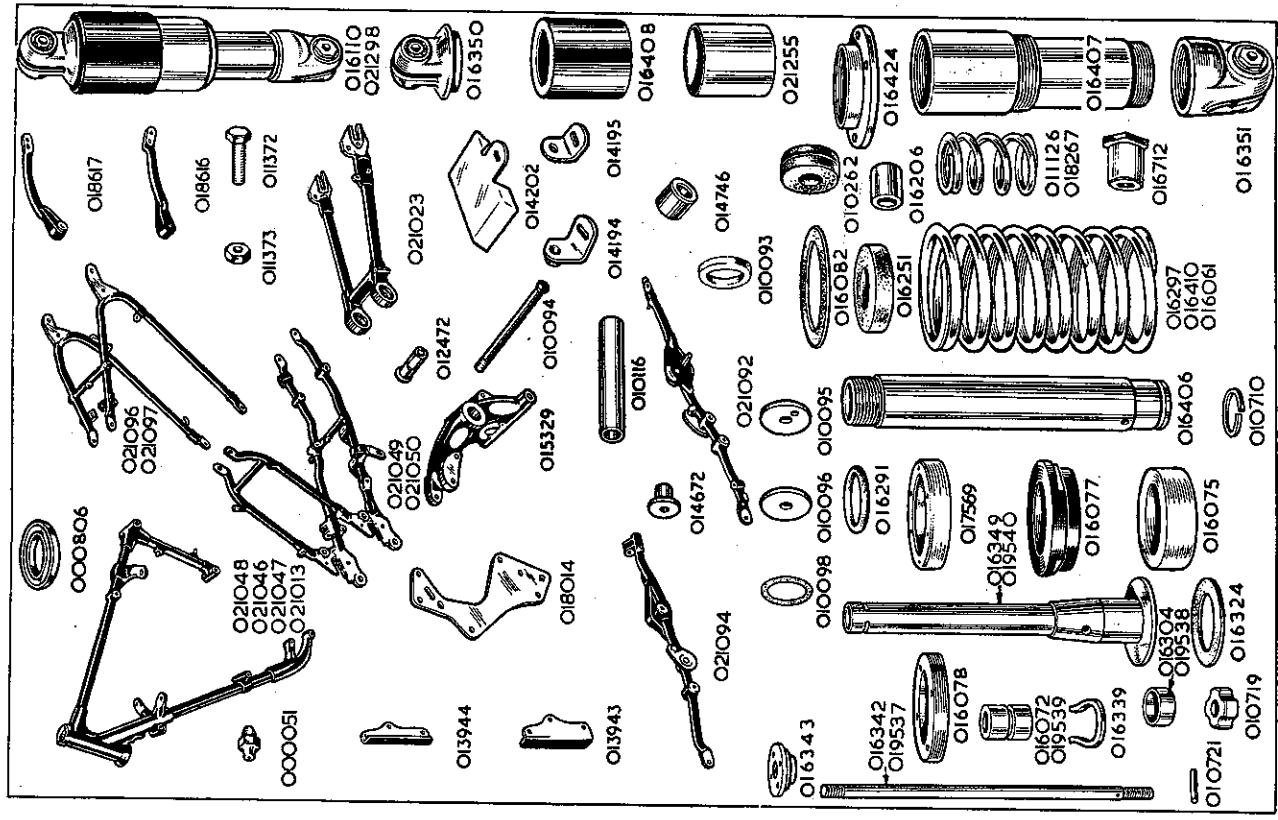

PART NUMBER	DESCRIPTION	QTY. OFF	PRICE EACH £ s. d.
021023	Fork, rear	1	4 11 3
011372	Pin, chain, adjusting, for right fork end	1	8 1/2
011373	Nut, lock, for chain adjusting pin	1	2 1/2
014746	Sleeve, assembly (bushed)	2	6 7
010116	Tube, for rear fork bearing, right side	1	6 0
010095	Cap, for rear fork bearing, left side	1	1 2 1/2
010096	Washer, felt, for rear fork bearing	1	0
010098	Gasket, for rear fork bearing caps	2	1 5
010094	Spoke, for rear fork bearing (central tie bolt)	1	5
004485	Nipple, for rear fork bearing spoke	1	5
000485	Screw, plug, for oil, in end cap, 1/2 in. by 3/8 in. by 26	1	1 1/2
000203	Washer, fibre, for oil plug screw	1	1 1/2

**REAR FORK**

PART NUMBER	DESCRIPTION	QTY. OFF	PRICE EACH £ s. d.
021445	Leg, TELEDRAULIC, rear complete assembly (no fixing bolts, washers and nuts)	2	6 14 8
016350	Pivot, top, assembled (this assembly includes the next three items)	2	18 11
016059	Pivot, top, bare	2	17 9
016262	Bush, rubber, for top pivot	4	4
016206	Spacer, for top pivot rubber bush	4	4
016351	Pivot, bottom, assembled (this assembly includes the next five items)	2	14 2
016060	Pivot, bottom, bare	2	12 7
016262	Bush, rubber, for bottom pivot	4	4
016206	Spacer, for bottom pivot rubber bush	4	4
016373	Nut, with sleeve, for bottom pivot bolt	2	7 1/2
016077	Washer, plain, for 016712 sleeve nut	2	1 1/2
016406	Tube, inner (fits in top pivot recess)	2	12 2
016291	Ring, sealing inner tube at top	1	2 1/2
016075	Bush, lower end of inner tube	3	4
010710	Circlip, retaining inner tube bush	2	1 1/2
016407	Tube, outer (screws into bottom pivot)	2	3 2
016324	Washer, sealing lower end of outer tube	4	1 1/2
016077	Bush, for outer tube	2	6 4
017569	Oil-seal, between inner and outer tubes	2	2 1/2
016078	Collar, retaining oil-seal	2	7 10
016349	Tube, for damper	2	7 1/2
016072	Sleeve, plunger, for damper rod	2	1 1/2
016339	Clip, locating plunger sleeve	2	1 1/2
016342	Rod, for damper	2	2 1/2
016343	Collar, for top end of damper rod	2	1 2 1/2
000074	Nut, locking collar top-end of damper rod	2	1 2 1/2
016304	Valve, for damper	2	4
010711	Pin, stop, for damper valve	2	4
010719	Seat, for damper valve	2	4
000005	Nut, retaining damper seat to damper rod	2	4
011126	Spring, buffer	2	1 0
016297	Spring, main (Solo)	2	6 0
016061	Washer, leather, at both ends of main spring	4	11 7
016408	Tube, outer, covering top end of main spring	2	8 8
021255	Tube, outer, covering bottom end of main spring	2	12 6
016424	Nut, retaining bottom outer cover tube	2	7 6
016251	Buffer, for TELEDRAULIC Leg	2	1 1 1/2
018448	Bolt, fixing top pivot, 3/8 in. by 3/8 in. by 26	2	1 7 1/2
014321	Bolt, fixing top pivot (replaces 018648 when carrier is fitted)	2	1 7 1/2
000010	Washer, plain, for top pivot Bolt	2	8 8
016712	Nut for top pivot Bolt	2	7 1/2
016359	Bolt, fixing bottom pivot, 2 1/4 in. by 3/8 in. by 26	2	8 8
000010	Washer, plain, for bottom pivot Bolt	2	1 1

BEFORE ORDERING  
PLEASE NOTE THE INFORMATION GIVEN ON PAGES  
TWO AND THREE

PART NUMBER	DESCRIPTION	QTY. OFF	PRICE EACH £ s. d.
021367	Fork, assembly (TELEDRAULIC Front Fork, Solo)	1	19 11 2
021368	Fork, assembly (TELEDRAULIC Front Fork, Sidecar)	1	19 14 2
021400	Front fork inner tube assembly, Solo	2	3 5 10
021401	Front fork inner tube assembly, Sidecar	2	3 7 4
018328	Front fork damper assembly	2	12 1

**FORK ASSEMBLIES**

The following fork assemblies are complete and include ball races for the fork crown and top head lug (but not the two frame ball races).

The units are listed below.

Front fork inner tube assembly, Solo

Front fork inner tube assembly, Sidecar

The above assemblies comprise—

Inner tubes with rubber buffers, bushes and circlips, top bolts with washers and sealing rings, slider extensions with oil seals, fork springs and washers.

Front fork damper assembly

Rod and two nuts, damper tube with valve, seat and pin, sleeve and clip and bottom fixing bolt with washer.

**FRONT FORK**

PART NUMBER	DESCRIPTION	QTY. OFF	PRICE EACH £ s. d.
018540	Crown, assembly, comprising crown, stem and circlip (these parts not sold separately)	1	2 4 5
000805	Race, ball, for fork crown	1	4 6
018649	Screw, pinch, for fork crown	2	1 7 1/2
018309	Lug, for handlebar and steering head	1	2 3 10
012620	Race, ball, for handlebar lug	1	4 5
000051	Nipple, grease, for handlebar lug	1	6
000236	Nut, adjusting, for fork crown stem	1	10
010712	Nut, lock (domed), for fork crown stem	1	3 5 5
016322	Tube, for fork inner	2	1 8 5
016148	Buffer, rubber, for fork inner tube	6	4 11
010692	Bush, bottom, for fork inner tube	2	2
010710	Circlip, for fork inner tube bush	2	1 1/2
016718	Bolt, top, for fork inner tube	2	2 5
014355	Ring, sealing, for fork inner tube top bolt	2	4
010709	Washer, plain, for fork inner tube top bolt	2	5
021399	Slider, fork, with cap, studs and nuts, left and right	2	2 6 6
021184	Cap, for fork slider	2	5 3
000011	Stud, securing fork slider cap, 1 1/8 in. by 1/8 in. by 26 and 22	4	5
000004	Washer, plain, for fork slider cap stud	4	1 1/2
021256	Nut, for fork slider cap stud	4	4
015286	Extension, for fork slider	2	10 11
017569	Bush, plastic, for fork inner tube	2	3 0
010718	Oil-seal, for fork inner tube (rubber)	2	6 4
014297	Oil-seal, for fork inner tube (alternative to 017569 and made of leather)	2	6 4
016526	Washer, under oil-seal (must only be used under leather oil-seal 010718)	2	2 1/2
016782	Spring, main, for front fork, solo	2	6 0
010360	Spring, main, for front fork, sidecar	2	7 6
021116	Spring, buffer, for front fork	2	1 4
010698	Washer, leather, fork spring seating, top	2	4
021294	Tube, fork cover, top, right, with lamp lug	1	10 9
021293	Tube, fork cover, top, left, with lamp lug	1	10 9
010703	Cap, for top of fork top cover tubes	2	1 5
018216	Seat (rubber), for cover tube	2	8 1/2
018215	Cap, for bottom of fork top cover tube	2	1 5
018539	Tube, fork cover, bottom	2	5 10
000485	Screw, plug, oil drain, for fork slider, 1/2 in. by 1/8 in. by 26	2	1 1/2
000203	Washer, fibre, for fork slider screw oil plug	2	1 1/2
015932	Tube, fork damper	2	6 2
010697	Bolt, fixing fork damper to slider, 3/8 in. by 1/8 in. by 26	2	1 0
010706	Washer, fibre, for damper tube bolt	2	1 1/2

1960.

22/10.

PART NUMBER	DESCRIPTION	QTY. OFF	PRICE EACH £ s. d.
-------------	-------------	----------	--------------------

**FRONT FORK—continued.**

017357	Rod, for fork damper	2	1 11
000004	Nut, lock, top end of damper rod	2	4
016072	Sleeve, plunger, for fork damper rod	2	7 1/2
016339	Clip, retaining damper rod sleeve	2	1 1/2
016304	Valve, for fork damper	2	1 2 1/2
010721	Pin, stop, for fork damper valve	2	1 1/2
010719	Seat, for fork damper valve	2	4
000005	Nut, lock, for fork damper valve seat	2	4
018691	Steering locking bar (own padlock to be used)	1	1 6

**STEERING DAMPER. (This is an optional extra)**

016405	Damper, steering, complete set of parts	1	18 0
017260	Knob, control, for steering damper	4	4
000162	Washer, ratchet, for steering damper knob	4	4
000195	Washer, spring, for steering damper knob	5	5
010808	Cap, for top of steering stem	1	7 1/2
010807	Drawbolt, for steering damper	1	5
015137	Sleeve, assembly, lower end of drawbolt	6	10
000073	Nut, locking sleeve to drawbolt	4	4
000342	Bolt, fixing sleeve assembly, 1/2 in. by 1/2 in. by 26	4	4
000191	Washer, spring, for bolt 000342	1	1 1/2
000012	Washer, plain, for bolt 000342	1	1 1/2
017008	Plate, anchor, top position	1	1 1/2
000070	Bolt, fixing top anchor plate, 1/2 in. by 1/2 in. by 26	4	4
000191	Washer, spring, for bolt 000070	1	1 1/2
000812	Washer, friction, for steering damper	2	1 0
000236	Nut, lock, for fork crown stem (this replaces the domed lock-nut 010712 when a steering damper is fitted)	1	10

**HANDLEBAR**

021257	Handlebar, bare	1	4 2
018277	Clip (half only), for handlebar lug	1	2 5
016947	Screw, for handlebar clip, 1/2 in. by 1/2 in. by 26 (socket head)	3	11

**FRONT STAND**

011286	Stand, front, bare	1	9 11
010694	Bolt, fixing iron stand to slider, 1 1/2 in. by 1 1/2 in. by 22	2	0
010724	Washer, spring, for stand to slider bolt	2	2 1/2
000014	Pin, split, for stand to slider bolt	2	4
000342	Bolt, fixing front stand to front mudguard, 1/2 in. by 1/2 in. by 26	2	1 1/2
000012	Washer, plain, for stand to mudguard bolt	2	1 1/2
000005	Nut, front stand to mudguard bolt	2	4
014278	Nut (domed), front stand to mudguard bolt	1	7 1/2

**PROP STAND**

014719	Stand, prop, bare	1	4
014713	Bolt, hinge, for prop stand, 2 1/2 ins. by 1 1/2 in. by 26	1	4
014139	Nut, for prop stand hinge bolt	1	8 1/2
000049	Pin, split, for prop stand hinge bolt	1	5
021261	Spring, return, for prop stand	1	1 1/2

**CENTRE STAND**

016438	Stand, centre, bare	1	12 8
014626	Bush, for centre stand, .7 in. long	2	10
014629	Stud, hinge, for centre stand, 8 1/2 ins. by 7/8 in. by 26	2	6
014630	Spacer, central, for centre stand hinge stud, 4 1/2 ins. long	1	1 1/2
010912	Washer, spigot, for centre stand hinge stud	2	5
000002	Nut, for centre stand hinge stud	2	3 0
014627	Spring, return, for centre stand	1	1 1/2
016399	Spring, stop, for centre stand	1	3 0
000080	Nut, for centre stand stop spring (the studs, on which these nuts fit, are listed with the "REAR FORK BRIDGE")	2	1 1/2
000039	Washer, plain, for centre stand stop spring fixing nuts	2	1 1/2

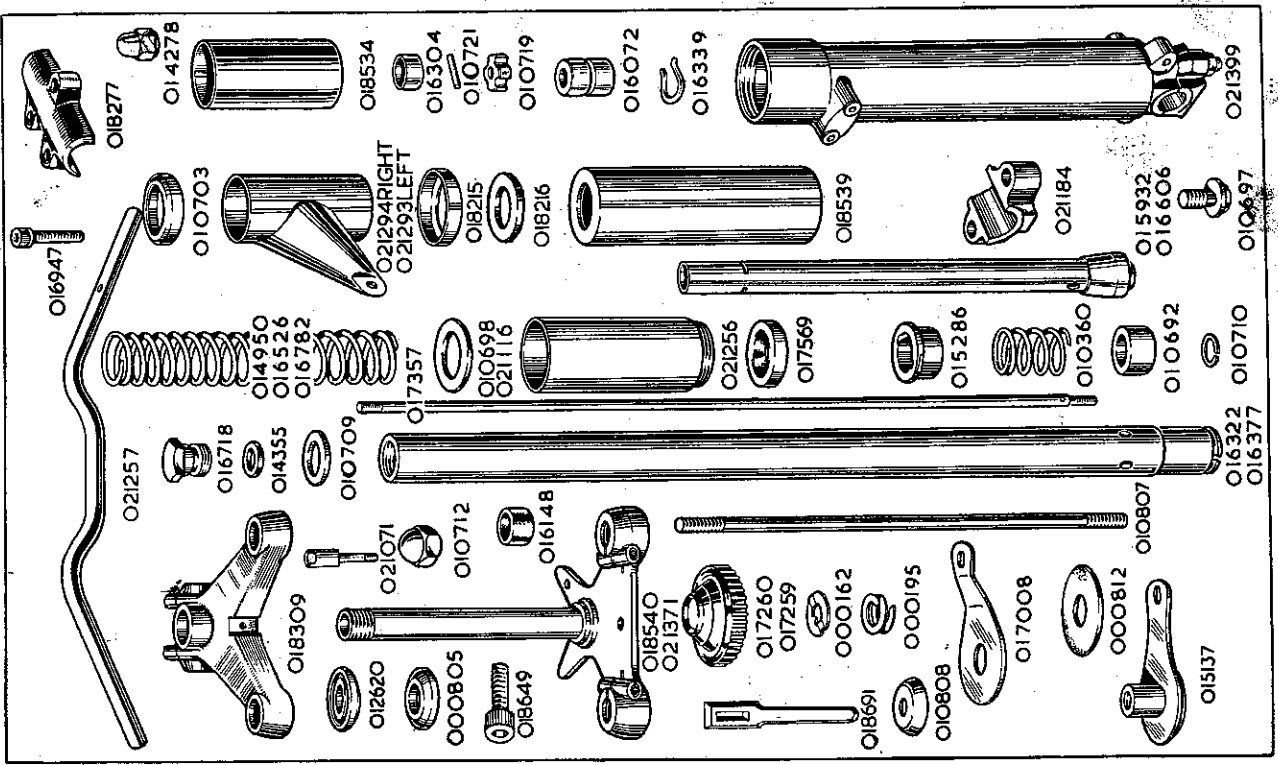

This scan is explicit for non-commercial use and is not intended for financial or material gain by anyone

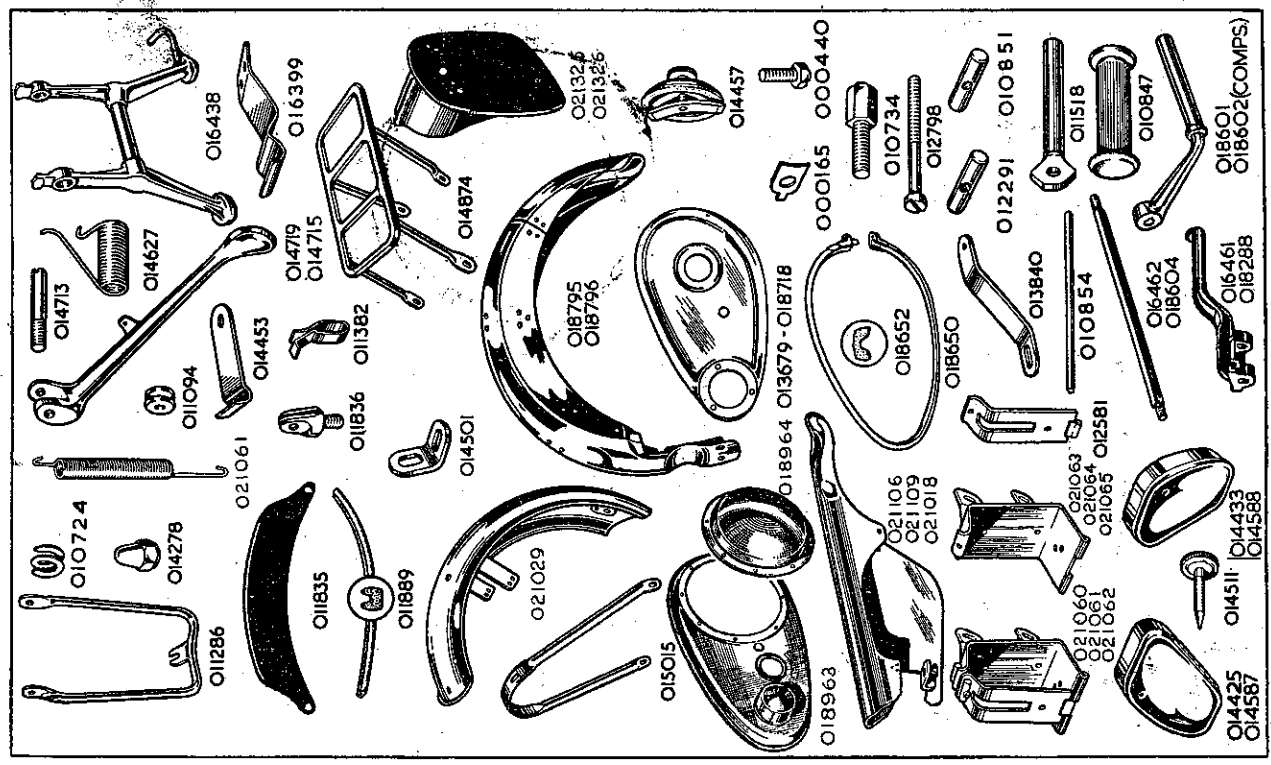

PART NUMBER	DESCRIPTION	QTY. OFF	PRICE EACH £ s. d.
<b>FRONT MUDGUARD</b>			
021029	Mudguard, front, bare	1	1 8 0
010795	Bolt, fixing mudguard bridge to right fork slider, ½ in. by ½ in. by 22	2	5 1½
000192	Washer, spring, for bridge right fixing bolt	2	...
010624	Stud, fixing mudguard bridge to left fork slider, also retains brake anchor stay and bracket for brake cable adjuster, 1½ in. by ½ in. by 26 and 22	2	5
014117	Washer, lock, for bridge left fixing stud	2	1½
000004	Nut, for bridge left fixing stud	2	4
015015	Nut, for front mudguard	2	5 1
010795	Bolt, fixing front mudguard stay to fork slider, ½ in. by ½ in. by 22	2	5
000070	Washer, spring, for stay to fork slider	2	1½
000191	Bolt, fixing stay to front mudguard, ½ in. by ½ in. by 26	2	1½
000012	Washer, spring, for stay to front mudguard bolt	2	1½
000012	Washer, plain, for stay to front mudguard bolt	2	1½
000005	Nut, for stay to front mudguard bolt	2	4

<b>REAR MUDGUARD</b>			
018796	Rear mudguard (both portions with joint bolts)	1	4 1 0
018798	Rear mudguard, forward portion only	1	2 16 2
018799	Rear mudguard, rear portion only	1	1 5
021098	Bolt, for mudguard joint	4	6
021099	Washer, for mudguard joint bolt	4	1½
014501	Bracket, for bottom of rear mudguard	2	5
000342	Bolt, fixing bracket to rear mudguard, ½ in. by ½ in. by 26	2	4
000012	Washer, plain, for bracket fixing bolt	4	1½
000005	Nut, for bracket fixing bolt	4	4
000275	Stud, fixing rear mudguard brackets to frame, 3-½ ins. by ½ in. by 26	2	4
000011	Washer, plain, for bracket fixing stud	1	5
000004	Nut, for bracket fixing stud	2	1½
000346	Bolt, fixing rear mudguard to frame loop bridge, 1-½ in. by ½ in. by 26	2	4
000191	Washer, spring, for bridge fixing bolt	1	5
000005	Nut, for bridge fixing bolt	1	1½
000342	Bolt, fixing rear mudguard to oil tank, ½ in. by ½ in. by 26	1	4
000192	Washer, spring, for mudguard to oil tank bolt	1	1½
000174	Washer, plain, for mudguard to oil tank bolt	1	1½
000004	Nut, for mudguard to oil tank bolt	1	4

<b>REAR CARRIER</b>			
014874	Carrier, rear, bare	1	1 5 2
014521	Front fixing bolt (replaces 018648 when carrier is fitted)	2	1 7½

<b>FRONT NUMBER PLATE</b>			
011835	Plate, number, front	1	3 5
011836	Stud, fixing front number plate	2	1 2½
000012	Washer, plain, front number plate stud	2	1½
000005	Nut, front number plate stud	2	4
000861	Screw, fixing front number plate to stud, ½ in. by 2 B.A.	2	1½
011889	Fillet, rubber, front number plate	1	6

<b>REAR NUMBER PLATE</b>			
021326	Plate, number, rear, 9½ in. wide	1	13 10
018737	Plate, number, rear, 8 in. wide	1	13 10
000363	Bolt, fixing rear number plate, ½ in. by ½ in. by 26	2	5
000192	Washer, spring, rear number plate bolt	2	1½

PART NUMBER	DESCRIPTION	QTY. OFF	PRICE EACH £ s. d.
-------------	-------------	----------	--------------------

### FRONT CHAINCASE

021404	Chaincase, complete (comprises both halves, metal and rubber bands, clamping screw and inspection caps—NO FIXING BOLTS, SPACERS, WASHERS AND NUTS ARE INCLUDED)	1	3 0 0
018718	Chaincase, back half, bare	1	12 6
018963	Chaincase, front half, bare	1	17 10
018650	Band, metal, for chaincase	1	7 10
000453	Screw, clamping, chaincase metal band, 1 in. by 2 B.A.	1	4
018652	Band, rubber, for chaincase	1	6 4
014457	Cap, assembly, chaincase inspection (components not sold as separate spares)	1	2 7
000580	Washer, cork, chaincase inspection cap	1	4
018964	Domed clutch cover	1	6 0
018966	Washer, cork, for clutch dome	1	1
000450	Screw, 3/8 in. by 2 B.A., round head, for clutch dome	8	2 1/2
000440	Bolt, fixing chaincase to engine, 1/2 in. by 0 B.A.	3	4 1 1/2
000165	Washer, lock, chaincase engine bolt	3	1 1/2

### REAR CHAINGUARD

021018	Chainguard, rear, bare	1	4
000350	Bolt, fixing chainguard in front, 2 1/8 ins. by 1/2 in. by 26	1	5
000012	Washer, plain, chainguard, front fixing bolt	2	1 1/2
000005	Nut, for chainguard front fixing bolt	4	4
014559	Bolt, fixing rear of chainguard, 2 1/8 ins. by 1/2 in. by 26	1	8 1/2
000011	Washer, plain, for chainguard rear fixing bolt	1	1 1/2
000192	Washer, spring, for chainguard rear fixing bolt	1	1 1/2
014560	Spacer, 1 1/8 in. long (located inside chainguard), on bolt 014559	6	6
014561	Spacer, 3/8 in. long (located between chainguard and frame on bolt 014559)	1	5
000004	Nut, for chainguard bolt 014559	1	4

### BATTERY CARRIER

021062	Carrier, battery, complete with bolts, seat and nut	1	14 9
021065	Carrier, battery, back portion only	1	10 6
017581	Carrier, battery, front portion only	1	2
010854	Pin, hinge, battery carrier front	1	4
012798	Bolt, clamping battery carrier, 1/2 in. by 1/2 in. by 26	1	7 1/2
012291	Seat, battery carrier clamping bolt	1	5
010851	Nut, battery carrier clamping bolt	1	8 1/2
000074	Nut, fixing battery carrier and oil tank to front frame	3	4
000174	Washer, plain, for battery carrier and oil tank fixing nut	3	1 1/2
013840	Sway, battery carrier to chaincase	1	1
000040	Screw, fixing stay to battery carrier, 3/8 in. by 1 B.A.	1	1 1/2
000012	Washer, plain, for 000040 bracket screw	1	1 1/2
010734	Bolt, fixing battery carrier bracket to chaincase, 3/8 in. by 1/2 in. by 26	1	5
000011	Washer, plain, for 010734 carrier-bracket bolt	1	1 1/2
000004	Nut, for 010734 carrier bracket bolt	1	4

### TOOL BOXES

014425	Box, tool, bare (with lid but no other fittings), left side	1	6
014433	Box, tool, bare (with lid but no other fittings), right side	1	1
014511	Screw, knurled, for tool box lid	2	1 1/2
000189	Washer, spring, for tool box lid screw	2	1 1/2
000005	Nut, for tool box lid screw	4	4
000342	Bolt, long, fixing tool box, 1 1/2 in. by 1/2 in. by 26	4	2 1/2
014577	Bolt, short, fixing tool box, 1 1/2 in. by 1/2 in. by 26	2	4
000639	Spacer, 3/4 in. long for tool box long fixing bolts	4	1 1/2
000012	Washer, plain, for tool box fixing bolt	12	4
000005	Nut, for tool box fixing bolts	6	1 1/2

PART NUMBER	DESCRIPTION	QTY. OFF	PRICE EACH £ s. d.
-------------	-------------	----------	--------------------

### FOOTRESTS

018601	Arm, for footrest	2	10 0
010847	Pad, rubber, for footrest arm	2	1 10
018604	Rod, for footrests, overall length 10 3/8 ins.	1	2 9
010924	Spacer, 3 1/2 ins. long, for footrest rod, between engine rear plates	1	4
013837	Spacer, 1 in. long, for footrest rod, outside right plate	1	10
010911	Spacer, 1 1/2 in. long, for footrest rod, outside left plate	1	7 1/2
010912	Washer, spigot, for footrest rod	2	4
000002	Nut, for footrest rod	2	5

### PILLION FOOTRESTS

011267	Pair of pillion footrests, complete (includes all the following items)	1	12 7
011518	Spindle, bare for pillion footrest	2	3 7 1/2
011599	Bolt, hinge, for pillion footrest spindle, 1 1/8 in. by 3/8 in. by 26	2	7 1/2
000073	Nut, for pillion footrest hinge bolt	2	4
010847	Pad, rubber, for pillion footrest spindle	2	1 10

### TWIN SEAT

021199	Seat, Twin	1	8 2 0
021208	Screw, fixing seat at rear to loop, 1/2 in. by 1/2 in.	1	10
000012	Washer, plain, for seat fixing screw	2	1 1/2
018160	Nut, for seat fixing screw	2	1 1/2
021219	Rubber Grommet, for base	2	1 1/2

### TRANSFERS

009183	Transfer, for side of oil tank (oil level indicator)	1	4
009184	Transfer, for top of oil tank (service instruction)	1	4
009186	Transfer, for front chaincase (oil level indicator)	1	4
009187	Transfer, for front chaincase (patent)	1	1 1/2
009185	Transfer, for tool box (monogram)	2	5
009194	Transfer, for rear mudguard ("A-J-S")	1	7 1/2
009192	Transfer, for front forks (patent)	1	7 1/2
009195	Transfer, for petrol tank (reserve)	1	4
009198	Transfer, for side of oil tank (oil top level indicator)	1	2 1/2
009196	Transfer, for forks ("Made in England")	1	1 1/2
009197	Transfer, for rear fork hinge (patent)	1	1 1/2
018091	Complete set of transfers	1	3 8 1/2

### DUMMY GRIP

16-069	Grip, rubber, dummy	1	1 6
--------	---------------------	---	-----

WHEN ORDERING SPARES, IF IN DOUBT REGARDING THE NAMES AND PART NUMBERS OF THE PARTS YOU REQUIRE, PLEASE SEND THE OLD PARTS TO SERVE AS PATTERNS.

PART NUMBER DESCRIPTION QTY. OFF PRICE EACH £ s. d.

**TWIST GRIP**

16-117	Twist grip, complete assembly	10	6
16-070	Grip, rubber, for twist grip	1	0
16-091	Body, twist grip (does not include rubber grip)	3	6
16-060	Body, twist grip, top (plain clip)	3	0
16-061	Body, twist grip, bottom (for friction spring)	3	0
11-013	Screw, long, clamping twist grip body	3	0
11-014	Screw, short, clamping twist grip body	3	0
16-008	Spring, friction, for twist grip	9	9
16-009	Nut, for twist grip friction spring	6	2
16-010	Screw, for twist grip friction spring screw	6	2
16-011	Stop, for twist grip (throttle) cable	6	6

**CLUTCH AND IGNITION CONTROL LEVERS**

18-640	Lever, assembly, clutch and ignition	18	9
18-528	Lever only, clutch	5	3
12-017-B	Lever only, ignition	3	9
18-241	Bracket, for clutch lever	5	3
12-008	Bracket, for ignition lever	2	9
11-013	Screw, long, clamping clutch and ignition brackets	3	3
11-014	Screw, short, clamping clutch and ignition brackets	3	3
18-087	Pin, fulcrum, for clutch lever	3	3
18-053	Nut, clutch lever fulcrum pin	3	3
12-029	Bolt, central, for ignition lever	3	3
12-031	Cap, for ignition lever	8	8
12-033	Washer, spring, for ignition lever	2	2

**BRAKE AND AIR CONTROL LEVERS**

18-641	Lever, assembly, brake and air	18	9
18-535	Lever, only, brake	5	3
12-016-B	Lever, only, air	3	9
18-240	Bracket, for brake lever	5	3
12-007	Bracket, for air lever	2	9
11-013	Screw, long, clamping brake and air brackets	3	3
11-014	Screw, short, clamping brake and air brackets	3	3
18-087	Pin, fulcrum, for brake lever	3	3
18-053	Nut, brake lever fulcrum pin	3	3
12-029	Bolt, central, for air lever	3	3
12-031	Cap, for air lever	8	8
12-033	Washer, spring, for air lever	2	2

**FRONT BRAKE CABLE**

013178	Cable, complete, assembled, front brake	6	6
000530-40 $\frac{1}{2}$	Wire, inner, front brake, 40 $\frac{1}{2}$ ins. finished length	6	6
18-689	Nipple, brake end, for brake inner wire	4	4
18-690	Nipple, handlebar end, for brake inner wire	4	4
000529-26	Nipple, roller adaptor, handlebar end for inner wire	9	9
000531	Casing, outer, front brake, 26 ins. long	10	10
011348	Ferrule, front brake outer casing	2	2
017217	Adjuster, front brake cable	1 $\frac{1}{2}$	1 $\frac{1}{2}$
017049	Nut, lock, front brake cable	2	5
000736	End, yoke, front brake cable	1	7 $\frac{1}{2}$
000014	Pin, for yoke end, front brake cable	1	7 $\frac{1}{2}$
012478	Pin, split, for front brake cable yoke and pin	1	5
	Sleeve, rubber, for front brake cable inner wire	1 $\frac{1}{2}$	6

**CLUTCH CABLE**

021405	Cable, complete, assembled, clutch, with oil nipple	6	7
000530-43 $\frac{1}{2}$	Wire, inner, clutch, 43 $\frac{1}{2}$ ins. finished length	6	6
017741	Nipple, gearbox end, clutch inner wire	1 $\frac{1}{2}$	1 $\frac{1}{2}$
18-689	Nipple, handlebar end, clutch inner wire	4	4
18-690	Nipple, roller adaptor, handlebar end for inner wire	9	9
021406	Nipple, roller adaptor, handlebar end for oil nipple	2	7
000531	Casing, outer, clutch, with adaptor for oil nipple	1 $\frac{1}{2}$	6 $\frac{1}{2}$
014225	Ferrule, clutch outer casing	2	6 $\frac{1}{2}$
011373	Adjuster, clutch cable	4	4
000051	Nut, lock, clutch cable adjuster	4	6
	Oil nipple only	1	1

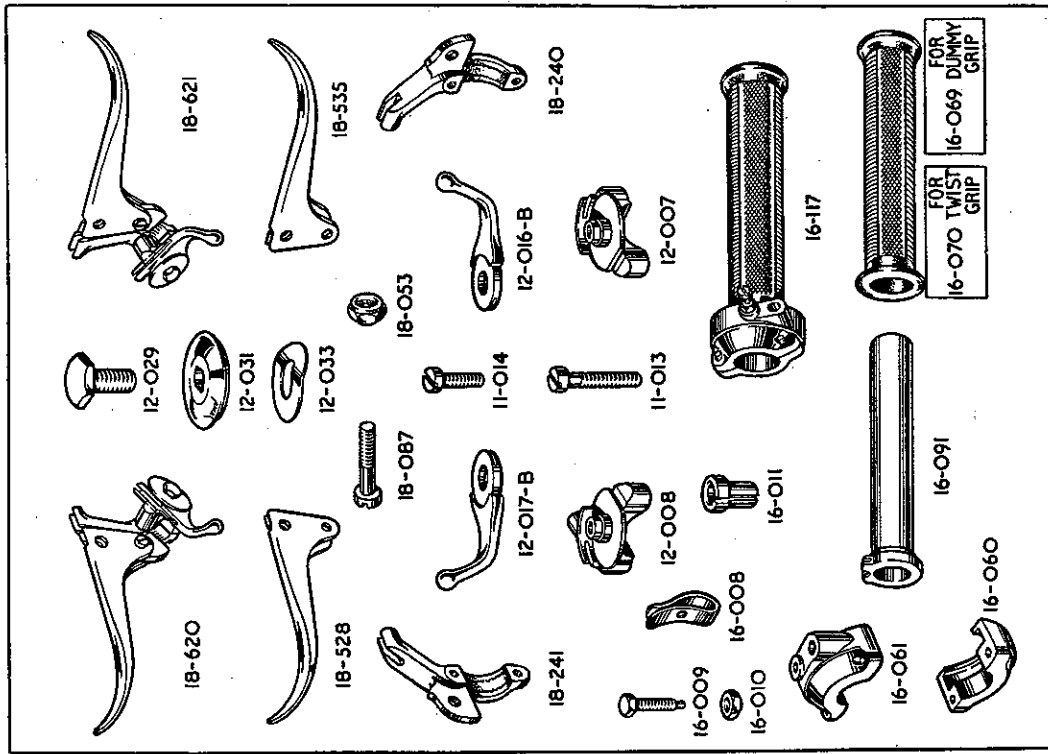

This scan is explicit for non-commercial use and is not intended for financial or material gain by anyone

PART NUMBER DESCRIPTION QTY. OFF PRICE EACH £ s. d.

**THROTTLE CONTROL CABLE**

021407	Cable, complete, assembled, throttle with oil nipple	1	5	3
000535-39½	Wire, inner, throttle, 39½ ins. finished length	1	1	4
017242	Nipple, carburettor end, throttle inner wire	1	2½	2½
017266	Nipple, handlebar end, throttle inner wire	1	2½	2½
021408	Casing, outer, throttle, with adaptor for oil nipple	1	2	5
000528	Ferrule, throttle outer casing	2	1½	1½
000051	Oil nipple only	1	6	6

**AIR CONTROL CABLE**

017263	Cable, complete, assembled, air	1	3	3
000527-32½	Wire, inner, air, 32½ ins. finished length	1	5	5
017242	Nipple, carburettor end, air inner wire	1	2½	2½
017266	Nipple, handlebar end, air inner wire	1	2½	2½
000526-28½	Casing, outer, air, 28½ ins. finished length	1	10	10
000528	Ferrule, air, outer casing	2	1½	1½

**IGNITION CONTROL CABLE**

018749	Cable, complete, assembled ignition	1	5	3
000527-37½	Wire, inner, ignition, finished length 37½ ins.	1	5	5
017379	Nipple, magneto end, ignition inner wire	1	2½	2½
017266	Nipple, handlebar end, ignition inner wire	1	9	9
000526-34½	Casing, outer, ignition, 34½ ins. long	1	1½	1½
000528	Ferrule, ignition outer casing	2	7	7
458731	Cap, rubber, cable entry to magneto	1	3	2
458727	Cap, metal, cable entry to magneto	1	1	2
163343	Washer, fibre, for cable entry metal cap	1	1	2
454969	Plunger, for ignition cable	1	1	2
458732	Spring, return, for ignition cable	1	1	3

**PETROL TANK**

021164	Tank, petrol, bare, plated, black panels	1	12	4	10
018852	Tank badge, blue and silver	2	6	3	
000153	Screw, fixing tank emblem, ½ in. by 3 B.A.	4	2½	2½	
018853	Tank badge, rubber seating	2	9	9	

**PETROL TANK FITTINGS**

013325	Cap, filler, for petrol tank	1	6	5
017050	Tap, for petrol feed, with filter	2	5	11
000200	Washer, fibre, for petrol feed tap	2	4	4
011006	Grip, knee, left hand side	1	4	11
011005	Grip, knee, right hand side	1	1	0
021169	Plate, for left hand knee grip	1	1	0
021170	Plate, for right hand knee grip	1	1	0
000348	Bolt, fixing knee grip plate, ½ in. by ½ in. by 26	4	4	4

**PETROL TANK FIXING BOLTS**

014997	Bolt, fixing tank, all positions, ½ in. by ½ in. by 26	4	10	10
014998	Sleeve, ½ in. long, for tank fixing bolts	4	2½	2½
014995	Pad, rubber, thick (⅜ in.) for tank fixing bolts in front right and both rear positions	4	5	5
014996	Pad, rubber, thin (¼ in.), for all tank fixing bolts (three used on front left bolt)	4	2½	2½
014999	Washer, metal, ½ in. diameter, plain, for tank fixing bolts	4	4	4
017051	Wire, copper, 5 feet by 20 S.W.G.	1	4	4

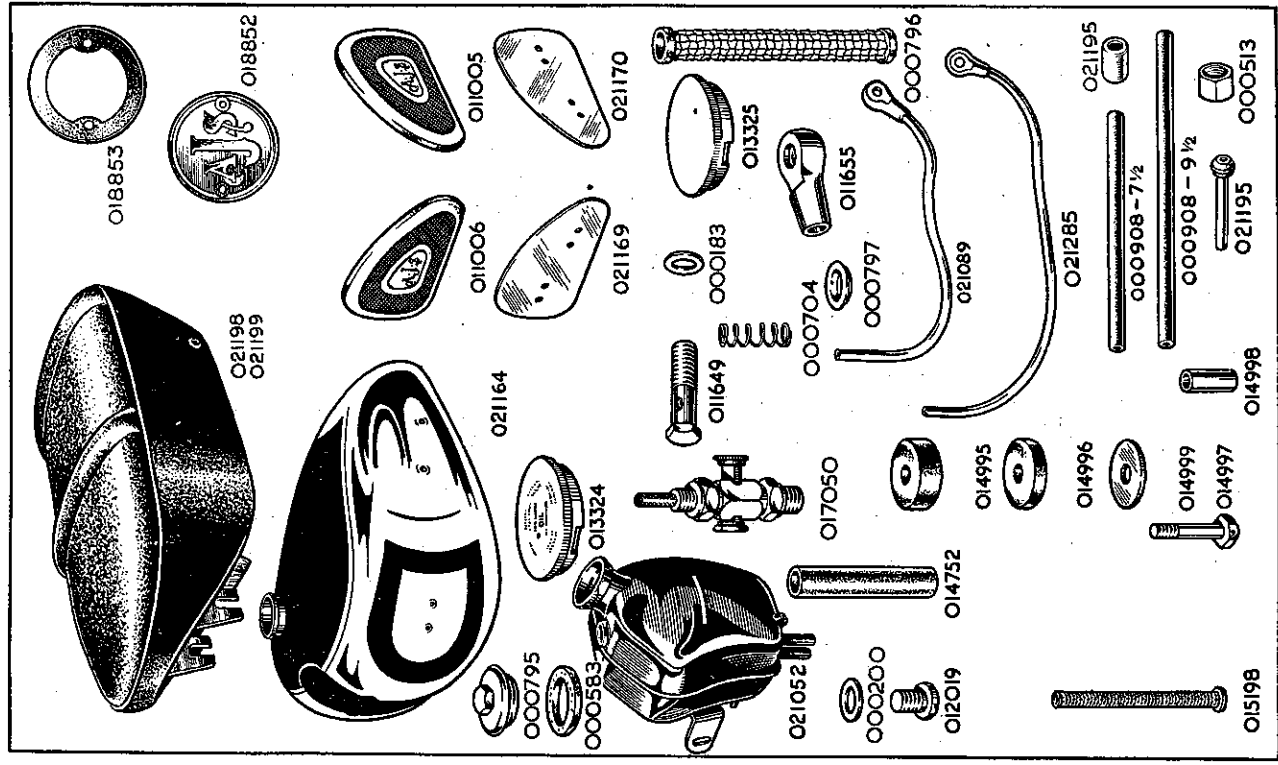

This scan is explicit for non-commercial use and is not intended for financial or material gain by anyone

PART NUMBER	DESCRIPTION	QTY. OFF	PRICE EACH £ s. d.
-------------	-------------	----------	--------------------

**OIL TANK**

021052	Tank, oil, bare	1	19 6
013324	Cap, filler, oil tank	6	6 5
012019	Plug, drain, for oil tank	5	4
000200	Washer, fibre, oil tank drain plug	4	11
000796	Filter, felt, for oil tank	7 1/2	5
000704	Spring, for oil tank felt filter	2	11
000797	Cap, metal, dished, for oil tank felt filter	2	4
000795	Cap, screwed, oil tank filter compartment	1	2 11
000583	Washer, cork, filter compartment	1	4

For the nuts and washers that retain the oil tank (and the Battery Carrier) to the main frame, see "Battery Carrier" Group.  
For the bolt, washer, and nut fixing the oil tank bracket to the rear mudguard, see "Rear Mudguard" Group.

**PETROL PIPE**

021192	Pipe, top connector	2	9
000513	Union nut for top connector	2	6
000908-9/16	Petrol flex connection, 9/16 ins. long	1	4 1/2
021195	Ferrules for connection	2	5
000908-7/8	Petrol flex connection, 7/8 ins. long	1	1

**OIL PIPES**

021285	Pipe, oil feed assembly	1	13 10
021089	Pipe, oil return	1	12 7
011655	Union, banjo, feed and return oil pipes	2	5 5
011649	Pin, banjo, retaining feed and return oil pipes to engine	2	2 4
000183	Washer, fibre, for oil pipe banjo	4	4
014752	Connection, rubber, for feed and return oil pipes	2	6
015198	Filter, metal gauze, for oil feed pipe	2	0
015138	Pipe, vent, metal	1	2 8 1/2
014936	Hose, from oil tank to metal vent pipe	1	11

**FRONT WHEEL**

The complete wheel listed below comprises:—Rim, spokes, nipples, hub, grease nipple, oil bearings, and all brake parts including cover plate and expander lever, but does not include the tyre.

The bare wheel listed below comprises:—Rim, spokes, nipples and hub.

021377	Wheel, front, with all fittings, chrome rim, black centre	1	15 12 6
021380	Wheel, front bare, chrome rim, black centre	1	7 17 4
012218	Rim, front, chrome, black centre	1	13 8
021152	Spoke, front, 3/8 ins. by 11 G.	40	2
021154	Nipple, front, .250 in. by 11 G.	40	2
021155	Hub, front wheel, shell only with brake drum	1	5 12 4
000051	Nipple, grease, for front wheel hub	1	6
011090	Tape, for 19 ins. by 2 1/2 ins. rim	1	9
021160	Hub disc, covering right side	1	7 7

**FRONT WHEEL BEARINGS**

012825	Spindle, with roller bearings, for front wheel	1	2 7
015079	Oil-seal, for front hub bearings	2	6
017219	Ring, spring, locating front hub bearings	4	4
018093	Cup, for front hub bearing oil-seal	4	4
017271	Ring, spacing, for front hub bearing oil-seal	3	7 1/2
018096	Ring, retaining front hub bearing oil-seals	1	1 1/2
021279	Nut, lock, for front hub bearing adjusting ring	1	1
017003	Ring, adjusting, for front hub bearing	3	3
017003	Nut, locating front brake cover plate	4	5
017222	Washer, locating, front brake cover plate	4	4
018071	Nut, outside, securing front brake cover plate	2	7
000001	Nut, front wheel spindle, left side	1	5
000008	Washer, plain, front wheel spindle, left side	1	1 1/2

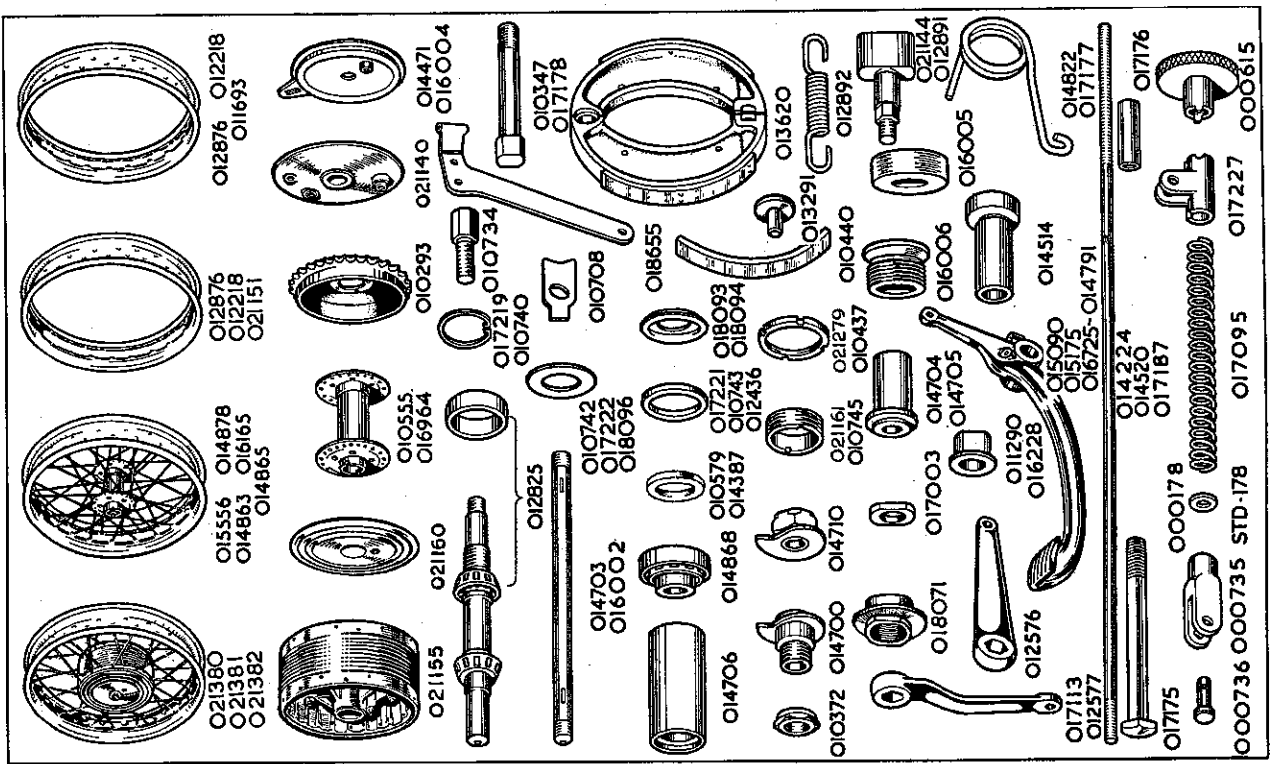

This scan is explicit for non-commercial use and is not intended for financial or material gain by anyone

PART NUMBER	DESCRIPTION	QTY. OFF	PRICE EACH £ s. d.
-------------	-------------	----------	--------------------

**REAR WHEEL**

*The complete wheel listed below comprises:—  
Rim, spokes, nipples, hub, grease nipple and all bearings assembled, but does NOT include the centre solid spindle, washers, spacers, nuts, brake parts, sprocket and brake drum, speedometer drive and tyre.*

018946	Wheel, rear, with all fittings, chrome rim, black centre	1	7 9 4
<i>The bare wheel listed below comprises:—</i>			
<i>Rim, spokes, nipples and hub.</i>			
018947	Wheel, rear, bare, chrome, black centre	1	5 6 8
012218	Rim, rear, chrome, black centre	1	1 13 8
011012	Spoke, rear, left or right, 8½ ins. by 7 G by 9 G	40	5
011013	Nipple, rear, left or right, 250 in. by 9 G	40	2 14 8
016964	Hub, rear wheel, shell only	1	6
000051	Nipple, grease, for rear wheel hub	1	1 9
011090	Tape, for 19 ins. rear rim	1	1 9

**REAR WHEEL BEARINGS**

014868	Bearings, roller, for rear hub (only sold as a complete bearing)	2	14 10
014387	Oil-seal, for rear hub bearings	2	5
010740	Ring, spring, locating rear hub bearings	1	4
018094	Cup, for rear hub bearing oil-seal	1	5
010743	Ring, spacing, for rear hub bearing oil-seal	1	1 1½
018095	Ring, retaining rear hub bearing oil-seals	3	1 1½
012436	Collar, spacing, between bearing and rear hub bearing oil-seal	2	11
014706	Spacer, 2½ ins. long between the two bearings of rear hub	3	0
010745	Ring, adjusting, for rear hub bearing	1	1 4
010437	Nut, lock, for rear hub bearing adjusting ring	1	5
014703	Spindle, centre, solid, for rear wheel	1	10 2
014705	Spacer, 1½ in. long, on rear wheel solid spindle, for speedometer gear-box	1	3 1½
010372	Nut, locking, speedometer gear-box	1	8½
014704	Sleeve, on rear wheel solid spindle, locating brake cover plate	1	3 10
014700	Cam, on rear wheel solid spindle, right side	1	7 0
014710	Cam, on rear wheel solid spindle, left side	1	5 11
000573	Key, on rear wheel solid spindle, locating cams	2	5
011290	Collar, on rear wheel solid spindle (abuts against fork end)	2	1 7½
014869	Nut, for rear wheel solid spindle	2	7½

**FRONT BRAKE**

021158	Drum, front brake (must be fitted at works)	1	8½
021162	Screw, fixing front brake drum to hub shell	5	5
019882	Lock nut for brake drum screw	5	1 8 4
021140	Plate, cover, front brake	1	14 7
018655	Stay, front brake cover plate anchor	1	1½
014807	Bolt, fixing anchor stay to front cover plate, ½ in. by ½ in. by 26	1	1
014119	Washer, special, for anchor stay bolt	1	1½
021146	Pin, fulcrum, for brake shoes	1	1
000010	Washer, plain (inner for pin)	1	1½
000011	Washer, plain (outer for pin)	1	1½
000004	Nut, for brake fulcrum pin	1	1½
013620	Shoes, pair of, for front brake, with brake linings and thrust pins (only supplied in pairs)	1	4 7
013291	Pin, thrust, brake expander adjusting	2	11
000174	Washer, plain, for thrust pin	R	1½
010440	Linings, brake, per pair of, less rivets	R	4 10
000113	Rivets, for brake linings, per set of	12	2½
012892	Spring, for brake shoes	2	4 11
021144	Expander, for brake shoes	1	3 0
012576	Lever, for front brake shoe expander	1	6
000051	Nipple, grease, for brake shoe expander	1	1½
000174	Washer, plain, for brake shoe expander	1	6
000004	Nut, for brake shoe expander	1	1½

PART NUMBER	DESCRIPTION	QTY. OFF	PRICE EACH £ s. d.
-------------	-------------	----------	--------------------

**REAR BRAKE**

010293	Sprocket and brake drum, for rear wheel, 42 teeth, five hole fixing	1	2 2 0
010734	Bolt, retaining sprocket to rear hub, ¾ in. by 1½ in. by 26	5	5
010708	Washer, lock, for rear sprocket retaining bolt	5	1½
000011	Nut, for rear sprocket retaining bolt	5	1½
000074	Nut, for rear sprocket retaining bolt	5	1½
014471	Plate, cover, rear brake	1	18 0
010347	Bolt, anchor, rear brake cover plate, 2½ ins. by ½ in. by 26, with square head	1	2 5
000003	Nut, for rear brake cover plate anchor bolt	1	4
000006	Pin, split, for rear brake anchor bolt	1	1½
013620	Shoes, pair of, for rear brake, with brake linings and thrust pins (only supplied in pairs)	1	4 7
013291	Pin, thrust, brake, expander adjusting	2	11
000174	Washer, plain, for thrust pin	R	1½
010440	Linings, brake, per pair of, less rivets	R	4 10
000113	Rivets, for brake linings	per set of 12	2½
012892	Spring, for brake shoes	2	5
012891	Expander, for brake shoes	1	4 11
017113	Lever, for rear brake shoe expander	1	3 0
000051	Nipple, grease, for brake shoe expander	1	6
000174	Washer, plain, for brake shoe expander	1	1½
000004	Nut, for brake shoe expander	1	4

**REAR BRAKE OPERATING PARTS**

014791	Pedal, foot, for rear brake	1	0 8
014514	Bush, for rear brake foot pedal	1	2½
000051	Nipple, grease, for rear brake foot pedal	1	6
014822	Spring, return, rear brake foot pedal	1	8½
000344	Bolt, adjusting, rear brake foot pedal, ¾ in. by ¾ in. by 26	4	4
000005	Nut, for rear brake, foot pedal adjusting bolt	4	4
014520	Rod, bare, rear brake	1	2 1
000735	End, yoke, for front end of brake rod	1	7½
000736	Pin, for brake rod yoke end	1	1
000014	Pin, split, for brake rod yoke end pin	1	5
017095	Spring, for brake rod	1	1½
000178	Collar, for brake rod	1	1½
017227	Clip, adjusting, for rear end of brake rod	2	11
000736	Pin, for brake rod adjusting clip	1	5
000014	Pin, split, for brake rod adjusting clip pin	1	1½
000615	Nut, adjusting, for rear brake rod	1	3 5

**VOLTAGE REGULATOR**

015087	Regulator, complete unit, type MCR2 (Lucas No. 37097-B)	1	2 4 0
000342	Bolt, fixing regulator unit, ¾ in. by ¾ in. by 26	2	4 4
000012	Washer, plain, for regulator fixing bolt	4	1½
018160	Nut, for regulator fixing bolt	2	4 4

**THE PRICES OF SPARES DO NOT INCLUDE THE COST OF CARRIAGE**

This scan is explicit for non-commercial use and is not intended for financial or material gain by anyone

PART NUMBER	DESCRIPTION	QTY. OFF.	PRICE EACH £ s. d.
<b>BATTERY</b>			
4080157	Battery, with lid, dry and uncharged. This is a battery that has NOT been filled with electrolyte (acid) and is, of course, not charged. It requires no special packing, and can safely be packed with other goods. (Lucas No. PUTE/9). (We do not supply charged batteries—for such apply to nearest Lucas Service Station)	1	2 2 6
4159062	Lid, only, with rubber pads, for battery	1	2 3
<b>HEAD LAMP</b>			
021304	Lamp, head, type SSU-700, with bulb, ammeter and switch (no cable harness) (Lucas No. 51550)	1	4 12 6
516718	Shell only, type SSU-700	1	1 5 0
553248	Rim, bare, for head lamp	1	12 6
553925	Light unit (glass and reflector)	1	14 6
555005	Adaptor (bulb holder)	1	3 9
186131	Screw, fixing panel to head lamp	3	2
See ELECTRICAL SUNDRIES for Ammeter, Switch, Cable Harness and Bulbs.			
<b>SIDE LAMP</b>			
57224	Side lamp, complete	2	12 6
516719	Rubber grommet, for side lamp	2	1 0
<b>REAR LAMP</b>			
018760	Lamp, rear, with bulb, Lucas type 525 (53269-A)	1	1 2 6
573819	Window cover, red, for rear lamp	1	7 0
573814	Rubber gasket, for window cover	1	6 4
572072	Screw, retaining lamp window cover	2	4
166014	Nut, retaining body to rear number plate	1	1 1
188330	Spring washer, under nut rear number plate	2	1 1
860428	Rear lamp wires, with contact disc, spring and paxolin washer	1	3 0 6
573825	Rubber cap, covering wire entry	1	6
<b>STOP LIGHT PARTS (Optional Extra)</b>			
018720	Stop light switch	1	4 6
018727	Pull off, spring for switch	1	11 6
018763	Bracket, for switch	1	10 0
018764	Clip, for pull off spring	1	6
000738	Screw, securing switch and spring clip	3	4
000739	Nut, for screw switch and spring clip	3	4
000039	Washer, for spring clip screw	2	1 1/2
000073	Nut, securing switch bracket	1	4
000010	Washer, for nut switch bracket	1	1 1/2
011907	Extra rubber cable clips	3	2 1/2
011908	Extra rubber cable clips	2	2 1/2
014453	Metal cable clip	1	2 1/2
011382	Metal cable clip, to side of mudguard	3	1 6
018866	Cable, 6ft (switch to lamp and battery)	1	2 1/2
900769	Snap connector	1	1 1/2
018855	Complete kit of parts for stop light conversion	1	12 0
<b>HORN</b>			
015257	Horn, type HF 1234, with bracket. Lucas replacement number is 069225, but hole in bracket must be opened out to 1/4 in. diameter	1	1 19 0
015245	Bracket, only, for horn (see note above re opening out hole)	1	3 7 1/2
000376	Horn, bolt	1	1 1/2
000192	Horn, bolt washer	1	1 1/2
000004	Horn, bolt nut	1	2 1/2
015706	Horn, rubber washer	2	7 1/2
021136	Horn, steel washer	2	4 4
021138	Horn, rubber sleeve	1	2 1/2
021137	Horn, steel sleeve	1	2 1/2

PART NUMBER	DESCRIPTION	QTY. OFF.	PRICE EACH £ s. d.
<b>ELECTRICAL SUNDRIES</b>			
36084	Ammeter, for head lamp panel	1	8 9
351551	Switch, main lighting, for head lamp panel	1	11 6
351567	Handle, with screw, for main lighting switch	1	1 6
021301	Switch, dipping, for handbrake	1	6 9
380459	Rubber packing, for dipping switch	1	3 3
021299	Screw, fixing switch, 3/8 in. by 4 BA	2	3 9
016427	Switch, horn, for handbrake (Lucas No. 76209)	1	15 0
977831	Cable harness, main lighting (no dip switch wire, no horn wire, no regulator wires)	1	4 0
858795	Cable harness, triple, for dipping switch	1	6 0
860596	Cable harness, for regulator	1	1 0
359218	Cable, for horn	1	6
016681	Sheath, for dynamo cable	1	4
016682	Sheath, for dynamo cable	1	4
000543	Cable, high tension, for sparking plug, price per foot	R	1 0
000541	Terminal, for high tension cable	2	2
900269	Connector, snap, for rear lamp cable	1	2
900260	Connector, snap, for regulator to ammeter cable	1	9
571395	Connector, screwed, for battery positive cable	1	4
011094	Bush, rubber, fits in rear mudguard, for rear lamp cable	1	5 6
312	Bulb, head lamp, main, 6 volt, 30 by 24 watts	1	1 3
988	Plus Purchase Tax	1	1 6
352	Bulb, head lamp, pilot, 6 volt, 3 watts	1	4 4
015538	Plus Purchase Tax	1	3 9
021310	Bulb, rear lamp, 6 volt, 18 and 3 watt double contact	1	10 0
015538	Plus Purchase Tax	1	5 0
021310	Plug, sparking, KLG, type FE-80	2	6 6
021310	Cover for dynamo terminals	1	6
<b>CABLE CLIPS</b>			
011907	Clip, rubber, 1 1/2 in.	4	2 1/2
011908	Clip, rubber, 3 ins.	3	2 1/2
018220	Clip, rubber, 4 1/2 ins.	3	2 1/2
014453	Clip, metal, holding rear lamp wire inside mudguard	5	4 1/2
011382	Clip, metal, holding rear lamp cable to mudguard edge	3	2 1/2
<b>SPEEDOMETER</b>			
S-480-3-L	Head, only, speedometer, trip, 120 M.P.H.	1	3 10 0
S-480-7-L	Head, only, speedometer, trip, 180 K.P.H.	1	3 10 0
54279-1	Set of bulb holding parts for head	1	5 0
53205	Bulb, 6 volts, 1.8 watts, M.B.C. for head	1	1 4
N-1253	Plus Purchase Tax	1	6
000017	Nut, fixing speedometer head to bracket	2	2
W-7216	Washer, plain, spacing, for head	2	1 1/2
53395-1-45	Washer, spring, speedometer-bracket nut	2	1
52108-1-45	Cable, speedometer drive, inner only	1	1 2 6
53398-1-45	Cable, speedometer drive, outer only	1	11 3
000450	Clip, for speedometer drive, cable	1	11 3
000190	Screw, fixing speedometer cable clip, 3/8 in. by 2 B.A.	1	1 1/2
52283-5	Washer, spring, for cable clip screw	1	1 1/2
016945	Gearbox, speedometer, complete	2	2 6
000362	Bracket, for speedometer head	1	8 1/2
000111	Bolt, fixing speedometer head to forks, 5/8 in. by 7/8 in. by 26	1	1 1/2
000192	Washer, plain, speedometer bracket bolt	1	1 1/2
000192	Washer, spring, speedometer bracket bolt	1	1 1/2
<b>VARIOUS EQUIPMENT</b>			
018691	Bar, locking, for fork crown	1	1 6
016344	Set of Panhard bags, with frames and fixing bolts, washers and nuts	1	6 6 0
011957	Plus Purchase Tax	1	17 0 0
011958	"TEKALL" "Rust preventative 1 pint	R	2 0
CM-29	Instruction Manual	R	3 0
B-A-H	Badge, monogram, A. J. S. for button hole	R	2 6
B-A-T	Badge, monogram, A. J. S. for tie	R	1 6
B-A-B	Badge, monogram, A. J. S., for brooch fixing	R	1 6

This scan is explicit for non-commercial use and is not intended for financial or material gain by anyone

PART NUMBER	DESCRIPTION	QTY. OFF	PRICE EACH		
			£	s.	d.
<b>COMPLETE TOOL KITS</b>					
018780	... Tool kit, complete, with tyre inflator.....	1	3	4	0
018781	... Tool kit, complete, less tyre inflator .....	1	2	15	0
<i>The following comprise "TOOL KIT, COMPLETE, WITH TYRE INFLATOR," and is included as part of every motor cycle.</i>					
<b>TOOLS</b>					
017253	... Bag for tools.....	1	4	11	
017256	... Screwdriver .....	1	3	4	
017248	... Pliers, side cutting .....	1	4	7	
011188	... Pliers, for gudgeon pin circlips.....	1	1	11	
017246	... Gun, grease .....	1	7	4	
017114	... Inflator, tyre.....	1	9	0	
017007	... Lever, tyre.....	2	1	3	
017052	... Spanner, double end, $\frac{7}{8}$ in. by $\frac{1}{2}$ in.....	1	2	11	
017053	... Spanner, double end, $\frac{7}{8}$ in. by $\frac{3}{8}$ in. ....	1	4	5	
018178	... Spanner, double end, 1.011 in. by 1.2 in. ....	1	1	10	
017257	... Spanner, double end, $\frac{7}{8}$ in. by .375 in. ....	1	7	$\frac{1}{2}$	
017252	... Spanner, box, with tommy, for sparking plug.....	1	1	11	
017249	... Wrench, adjustable.....	1	10	10	
015023	... Spanner, double end, with gauge, for contacts (Lucas No. 415116) .....	1	7		
015264	... Spanner, single end, for rocker clamping bolts.....	1	5		
015213	... Spanner, box, for cylinder head nuts .....	2	0		
017254	... Spanner, clutch spring adjustment.....	1	1	0	
018153	... Spanner, for petrol tap.....	1	8	$\frac{1}{2}$	
018055	... Key, for handlebar clip screws and rocker cap screws.....	1	8	$\frac{1}{2}$	
018667	... Key, for fork tube pinch screw .....	1	1	10	
<b>SPECIAL TOOLS</b>					
011381	... Holder, valve, for valve grinding .....	1	1	0	
015273	... Extractor, for timing pinion and magneto gear .....	1	5	5	
015374	... Extractor, for camshaft gears .....	1	5	5	
015955	... Disc, timing (see Instruction Manual) .....	1	4	2	
<i>The above tools are NOT INCLUDED in the equipment of a new motor cycle.</i>					

### SERVICE

The Service and Repair Department is situated in Burrage Grove, Plumstead, London, S.E.18. Burrage Grove is the first turning on the left from Burrage Road when entering Burrage Road from the Plumstead Road. (See final paragraph below.)

The nearest Railway Station is WOOLWICH ARSENAL, SOUTHERN REGION RAILWAY. This Station is five minutes' walk from our Service Depot in Burrage Grove. There is an excellent service of electric trains from Charing Cross, Waterloo, Cannon Street and London Bridge Stations, Southern Region Railway.

Bus routes 53, 54, 163, 99, 122, 122a, 177 and Trolleybus routes, 696 and 698, pass the end of Burrage Road (one minute from the Service Depot).

Bus routes 186, 75 and 161 serve Beresford Square which is three minutes' walk from the Service and Repair Department.

Visitors from the North can pass into Woolwich via the Free Ferry between North Woolwich and Woolwich. North Woolwich is a British Railways terminus and is also served by Bus and Trolleybus routes 101, 569, 669 and 685. There is also a tunnel under the River Thames at this point for foot passengers. The Free Ferry accommodates all types of motor vehicles and there is a very frequent service. The Southern landing stage is less than a mile from the Service Depot.

Visitors arriving by road, if they are strangers to the locality, should enquire for Beresford Square, Woolwich. Upon arrival there, the road skirting the Royal Arsenal should be followed in an Easterly direction for about four hundred yards, and Burrage Road is the second turning on the right after leaving the square. Burrage Grove is then the first turning on the left.