

PART NUMBER	DESCRIPTION	QTY. OFF	PRICE EACH	
			£	s. d.

CRANKCASE

022014	.. Crankcase, complete (1)	1	19	17	1
022015	.. Crankcase, driving side only (2)	1	6	5	2
022072	.. Crankcase, timing side only (3)	1	10	8	10
015670	.. Web, centre, with cap studs, washers and nuts (no bearing and thrust washers)	1	2	1	5
016867	.. Cover, for timing gear	1	2	3	0
012561	.. Badge, monogram, for driving side crankcase	1	5	1	1
011826	.. Stud, fixing centre web, $1\frac{1}{2}$ in. by $\frac{1}{2}$ in. by 26 and 20	6	4
000017	.. Washer, plain, for centre web top fixing studs	2	$1\frac{1}{2}$
000012	.. Washer, plain, for centre web centre fixing studs	2	6
000012	.. Washer, plain, for centre web bottom fixing studs	2	$1\frac{1}{2}$
011843	.. Nut, for centre web fixing studs	6	6
015667	.. Stud, for centre web bearing cap, $2\frac{1}{4}$ ins. by $\frac{3}{8}$ in. by 20 and 20	2	..	1	$1\frac{1}{2}$
000010	.. Washer, plain, for centre web bearing cap stud	2	$1\frac{1}{2}$
016845	.. Nut, for centre web bearing cap stud	2	4
011628	.. Stud, in driving side crankcase, for cylinder and head, $5\frac{7}{16}$ ins. by $\frac{1}{2}$ in. by 26 and 22	4	..	3	4
011628	.. Stud, in timing side crankcase, for cylinder and head, $5\frac{7}{16}$ ins. by $\frac{1}{2}$ in. by 26 and 22	4	..	3	4
011834	.. Stud, in timing side crankcase, for pump carrying plate, $1\frac{1}{2}$ in. by $\frac{1}{2}$ in. by 26 and 22	3	4
000272	.. Stud, in timing side crankcase, for fixing magneto, $1\frac{1}{2}$ in. by $\frac{1}{2}$ in. by 26 and 22	2	5
011803	.. Stud, in timing side crankcase, for dynamo strap, $1\frac{1}{2}$ in. by $\frac{1}{2}$ in. by 26 and 20	1	4
021508	.. Shaft, in timing side crankcase, for intermediate gear	1	..	7	11
000575	.. Plug, drain, for timing side crankcase	1	$7\frac{1}{2}$
011820	.. Screw, retaining timing gear cover	10	$7\frac{1}{2}$
011652	.. Adaptor, to accommodate oil feed and return pipe retaining banjo pins. (Screws into timing side crankcase)	2	..	2	$2\frac{1}{2}$
011657	.. Washer, fibre, for banjo pin adaptors	2	$1\frac{1}{2}$
010474	.. Bush, plain, for camshafts. (In driving side crankcase)	2	..	2	$8\frac{1}{2}$
011654	.. Bush, flanged, for camshafts. (In timing side crankcase)	4	..	3	11
016472	.. Tunnel, for camshaft chamber (fits between crankcase halves)	2	10
011648	.. Cap, in crankcase housing for inlet camshaft	1	..	2	$7\frac{1}{2}$
011642	.. Washer, fibre, for crankcase housing cap	1	$2\frac{1}{2}$

1.—Includes:—Driving crankcase. Timing crankcase, centre web with studs (no bearing and washers). Bushes for camshafts. Cylinder studs. Shaft for intermediate gear. Cam follower spindles. Studs for pump plate. Two magneto studs. Dynamo strap stud. Timing gear cover and screws. Monogram badge. Three bolts. One stud. Two nuts. Five washers.

2.—Includes:—Two camshaft bushes. Four cylinder studs. Cam follower spindles. Six studs for centre web. (No badge.)

3.—Includes:—Four camshaft bushes. Four cylinder studs. Shaft for intermediate gear. Three studs for pump plate. Two studs for magneto. One stud for dynamo strap. (No timing gear cover and screws.)

WHEN IN DOUBT REGARDING THE NAMES AND PART NUMBERS OF THE PARTS YOU REQUIRE, PLEASE SEND THE OLD PARTS TO SERVE AS PATTERNS.

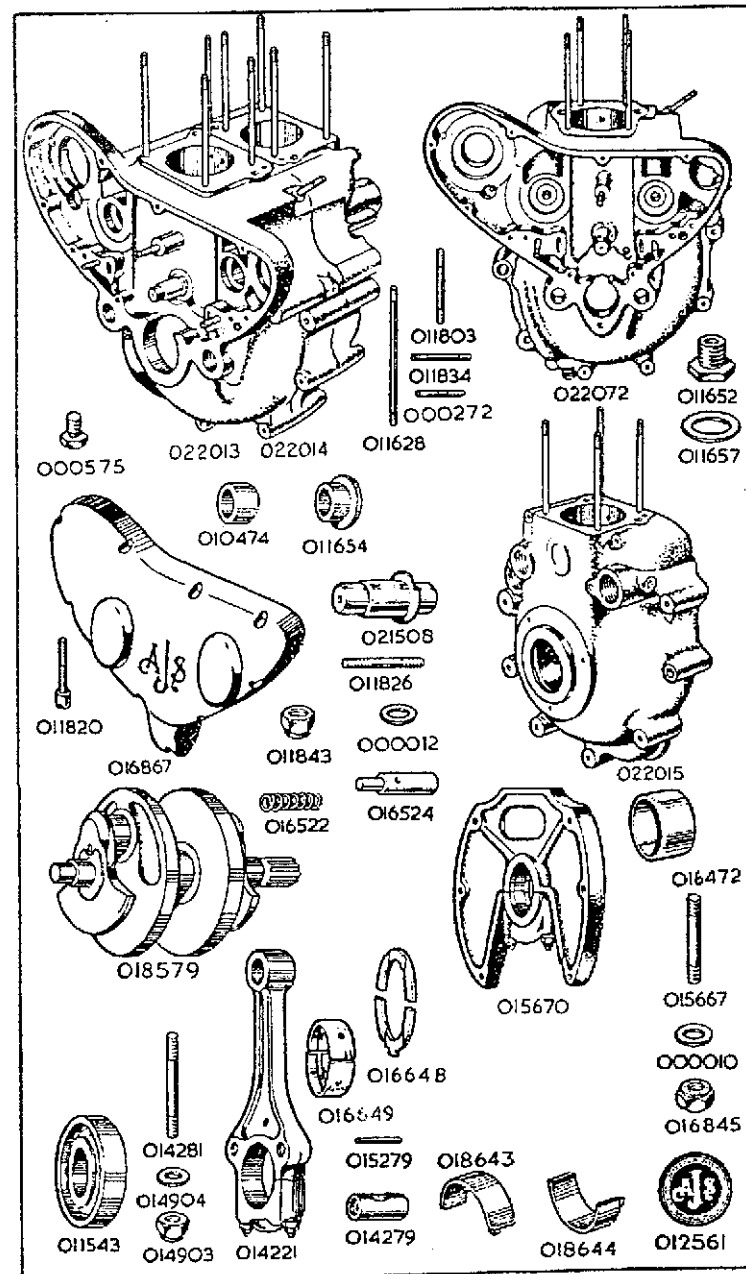

PART NUMBER	DESCRIPTION	QTY. OFF	PRICE EACH £ s. d.
-------------	-------------	----------	--------------------

CRANKSHAFT, CONNECTING RODS AND BEARINGS

018579	... Crankshaft, plugged, but bare	1	11 6 2
016649	... Bearing, plain, for centre bearing (in halves)	per pair	1 6 10
016648	... Washer, thrust, for centre bearing	2	1 0
011543	... Bearing, roller, for crankshaft. (Parts of this bearing not sold separately), 1½ in. internal, 3 ins. external, ½ in. wide. Manufacturers part number RLS-12½	2	1 14 3
014221	... Rod, connecting, assembly. (No big end bearing)	2	3 13 2
014281	... Stud, for connecting rod, 2½ ins. by ⅜ in. by 26	4	11
014279	... Trunnion, for connecting rod	4	3 9
015279	... Rivet, locating connecting rod stud	4	2½
014904	... Washer, plain, for connecting rod stud	4	1½
014903	... Nut, for connecting rod stud	4	7½
018643	... Bearing, plain, for connecting rod. (Big-end) top half	2	2 8½
018644	... Bearing, plain, for connecting rod. (Big-end) bottom half	2	6 11
The following undersize bearings (in pairs) can be supplied. It is necessary to have the journals ground to suit.			
016670	... Bearing, plain, for centre bearing, .010 in. Undersize (2 halves)	1	6 10
018671	... Bearing, plain, for connecting rod, .010 in. Undersize top half	2	4 0
018564	... Bearing, plain, for connecting rod, .010 in. Undersize bottom half	2	10 4

CYLINDERS, PISTONS, HEADS AND VALVES

011713	... Cylinder	2	3 0 0
011716	... Washer, paper, for cylinder base	2	15
015518	... Piston, bare, normal size	7-1 Comp. Ratio	1 1 0
015803	... Piston, bare, .020 in. oversize	" "	1 1 0
018024	... Piston, bare, .040 in. oversize	" "	1 1 0
015804	... Piston, complete, normal size	" "	1 14 6
015805	... Piston, complete, .020 in. oversize	" "	1 14 6
018025	... Piston, complete, .040 in. oversize	" "	1 14 6
018109	... Piston, bare, normal size	8-1 Comp. Ratio	1 1 0
018269	... Piston, bare, .020 in. oversize	" "	1 1 0
021241	... Piston, bare, .040 in. oversize	" "	1 1 0
018939	... Piston, complete, normal size	" "	1 14 6
018979	... Piston, complete, .020 in. oversize	" "	1 14 6
021242	... Piston, complete, .040 in. oversize	" "	1 14 6

The above complete pistons include:—

Piston, two compression rings (1 chrome plated), one scraper ring.
Gudgeon pin, two circlips for gudgeon pin.

018297	... Ring, compression, chrome plated, normal size	2	4 6
018298	... Ring, compression, chrome plated, .020 in. oversize	2	4 6
018299	... Ring, compression, chrome plated, .040 in. oversize	2	4 6
015531	... Ring, compression, normal size	2	1 6
015522	... Ring, compression, .020 in. oversize	2	1 6
016441	... Ring, compression, .040 in. oversize	2	1 6
010632	... Ring, scraper, normal size	2	1 11
015523	... Ring, scraper, .020 in. oversize	2	1 11
016442	... Ring, scraper, .040 in. oversize	2	1 11
011731	... Pin, gudgeon	2	5 0
014283	... Circlip, for gudgeon pin	4	4
021862	... Head, for cylinder, bare, left	1	6 2 6
021863	... Head, for cylinder, bare, right	1	6 2 6
021898	... Head, for cylinder, with valve guides, guide circlips and manifold studs, left	1	6 9 3
021899	... Head, for cylinder, with valve guides, guide circlips and manifold studs, right	1	6 9 3

NOTE—Pistons 7 to 1 C.R. are Standard Fitted

BY USING GENUINE SPARES YOU ARE ASSURED THEY WILL FIT ACCURATELY AND GIVE SATISFACTORY SERVICE

PART NUMBER	DESCRIPTION	QTY. OFF	PRICE EACH £ s. d.
-------------	-------------	----------	--------------------

CYLINDERS, PISTONS, HEADS AND VALVES—continued.

011715	... Gasket, for cylinder head	2	4 2
014163	... Valve, inlet	2	10 6
014165	... Valve, exhaust	2	19 3
011770	... Spring, inner, for valve	4	10
021769	... Spring, outer for valve	4	1 6
014169	... Seat, for valve springs	4	10
014168	... Collar, for valve springs	4	2 1½
014167	... Collet, for valve stems (in pairs)	4	1 1½
014170	... Guide, for inlet valves	2	3 0
014171	... Guide, for exhaust valves	2	3 0
011111	... Circlip, locating valve guides	4	1½
000004	... Nut, retaining cylinders and heads	8	4
011634	... Spacer, ¾ in. long for head retaining nuts	8	4
000011	... Washer, plain, for head retaining nuts	8	1½
010625	... Stud, retaining inlet manifold, 1½ in. by ½ in. by 26 and 20	4	4
014352	... Bush, for rocker spindle	4	11

RE-BORING

Cylinders may be re-bored to .020 in. or .040 in. oversize and pistons (with rings) supplied to suit. The charge is £4 19s. 9d. for the pair, with an additional 1 ls. 2d. if new gudgeon pins and circlips are also supplied. Cylinders sent for re-boring should be packed in stout cases which will be used by us for their return. Carriage is additional. If a complete machine, or engine, is sent to us for cylinder re-boring, there will be an additional charge, according to the time taken, for dismantling and assembly.

TIMING GEAR

018961	... Camshaft, inlet	1	1 17 2
018962	... Camshaft, exhaust	1	1 17 2
011620	... Gear, on camshaft, 60 teeth	2	1 1 0
000573	... Key, locating camshaft gears	2	5
011653	... Nut, retaining camshaft gears	2	11
016209	... Pinion, on crankshaft, 30 teeth	1	10 6
016210	... Spacer, ½ in. long, for crankshaft pinion	1	1 1½
000573	... Key, locating crankshaft pinion	1	5
011776	... Bolt, retaining crankshaft pinion, threaded ½ in. by 20	1	11
010589	... Washer, plain, for crankshaft pinion bolt	1	6
021506	... Gear, intermediate, with bush, 60 teeth	1	4 3
022016	... Bush, for intermediate gear	1	4 6
018576	... Follower, for camshaft	4	15 4
011626	... Spindle, for camshaft followers	2	3 0
022102	... Spacer, 1½ in. long between camshaft followers	2	1 0
018680	... Spacer, washer	4	6

ROCKERS AND PUSH RODS

022017	... Rocker, with bushes (left inlet and right exhaust)	2	1 7 4
022018	... Rocker with bushes (right inlet and left exhaust)	2	1 7 4
021868	... Spindle for rockers	4	12 6
014226	... Washer, spring, double coil, for rocker spindle	4	1½
014275	... Washer, plain, for either side of rocker spindle spring washer	8	2½
014275	... Washer, plain, for clamping end of rocker spindle	4	2½
011760	... Bolt, clamping rocker spindle. (Thread No. 2 B.A.)	4	1 5
015021	... Washer, plain, for rocker spindle clamping bolt	4	1½
011846	... Nut, for rocker spindle clamping bolt	4	4
014245	... Bush, for rockers. (Two in each rocker)	8	8½
018623	... Cover, for rockers	4	11 10
018493	... Gasket, for rocker covers	4	5
018492	... Screw, retaining rocker covers	8	1 1½
018517	... Rod, push, assembled with ends	4	7 2
018508	... Rod, push, bare	4	2 0
018518	... End, upper, for push rod	4	3 0
018519	... End, lower, for push rod	4	2 5

PART NUMBER	DESCRIPTION	QTY. OFF	PRICE EACH £ s. d.
-------------	-------------	----------	-----------------------

ENGINE STEADY STAY

018693	Plate, engine steady.....	1	0
000365	Bolt, securing rear of steady stay, 1 1/4 in. by 7/8 in. by 26	2	7 1/2
014779	Washer, lock, for steady stay frame front bolt	1	5
011842	Nut, for steady stay rear bolt.....	2	5 1/2
000366	Bolt, securing steady stay to frame, 1 1/2 in. by 7/8 in. by 26	1	7 1/2
000004	Nut, for steady stay to frame securing bolt.....	1	4
000011	Washer, plain, under heads of rear bolts	2	1 1/2
000192	Washer, spring, for rear bolts.....	3	1 1/2

OIL PUMPS

018037	Oil pumps, complete, assembled on carrying plate (4)	1	6 16 0
015017	Plate, carrying, oil pumps, bare (5)	1	16 2
014903	Nut, securing pump carrying plate to timing side crankcase	3	7 1/2
000011	Washer, plain, for pump carrying plate fixing nuts.....	3	1 1/2
000021	Ball, 1/2 in. steel, for return pump bleed valve	1	1 1/2
000701	Spring, for return pump bleed valve ball.....	1	4
015001	Screw, securing return pump bleed valve spring. (Grub screw 1/2 in. long by 7/8 in. by 22)	1	23 1/2
016137	Gasket, oval, behind pump carrying plate	2	13 1/2
016138	Gasket, round, behind pump carrying plate	1	13 1/2
015568	Body, oil feed pump, for 1/2 in. gears with 7/8 in. shaft	1	11 8
015599	Pin, dowel, for oil feed pump	2	13 8
015576	Plate, front end, for oil pump feed body	1	15 4
015573	Plate, back end, for oil pump feed body	1	15 4
011617	Washer, paper, between oil feed pump and carrying plate.....	1	1 1/2
000453	Screw, retaining oil feed pump to carrying plate. 1 in. by 2 B.A.	3	4
015579	Gear, driving, for oil feed pump, 1/2 in. wide. 7/8 in. shaft	1	11 8
015580	Gear, driven, for oil feed pump, 1/2 in. wide. 7/8 in. shaft	1	9 11
015567	Body, oil return pump, for 3/8 in. gears with 7/8 in. shaft	1	15 4
015599	Pin, dowel, for oil return pump	2	13 8
015576	Plate, front end, for oil pump return body	1	15 4
015573	Plate, back end, for oil pump return body	1	15 4
011617	Washer, paper, between oil return pump and carrying plate.....	1	1 1/2
000453	Screw, retaining oil return pump to carrying plate. 1 in. by 2 B.A.	3	4
015577	Gear, driving, for oil return pump, 3/8 in. wide. 7/8 in. shaft	1	12 0
015578	Gear, driven, for oil return pump, 3/8 in. wide. 7/8 in. shaft	1	10 6

NOTE 4.—Includes all the items listed above except the three 011842 and 000011 fixing nuts and washers.

NOTE 5.—Includes the 000021, 000701 and 015001 bleed valve ball, spring and retaining grub screw

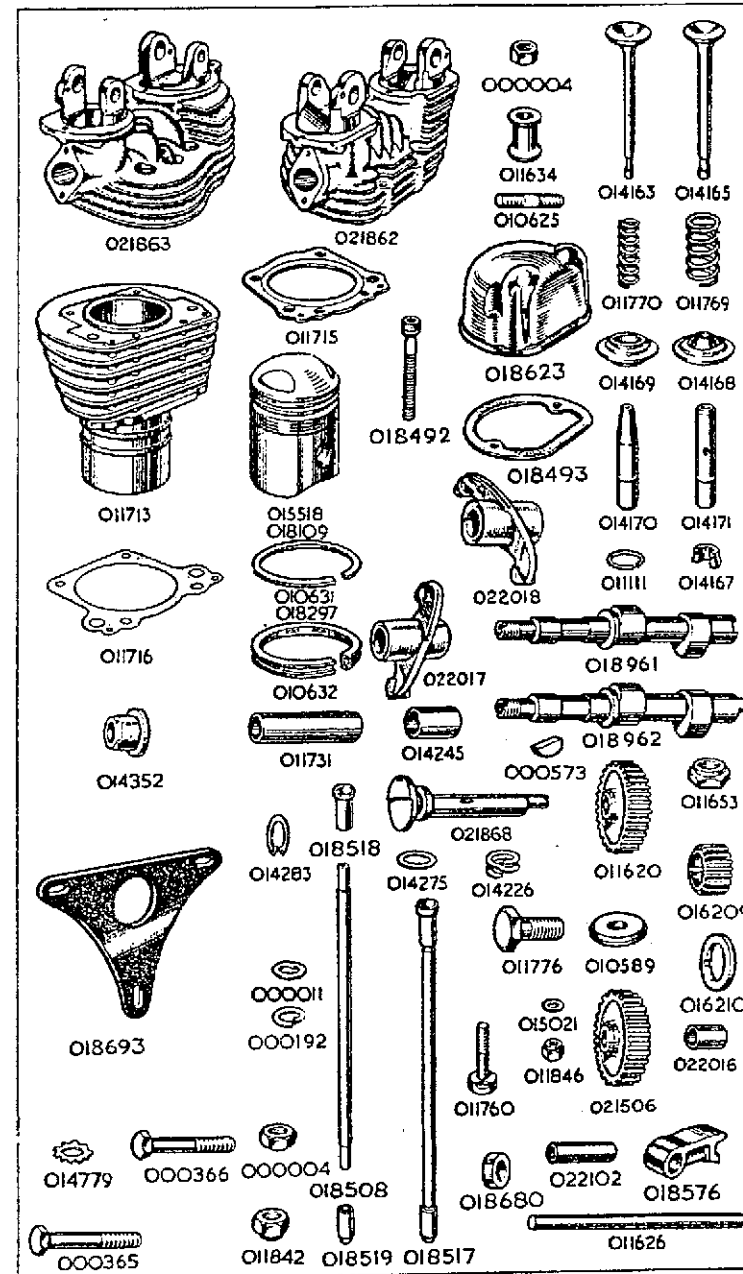

PART NUMBER	DESCRIPTION	QTY. OFF	PRICE EACH £ s. d.
OIL FELT FILTER (IN ENGINE)			
014235	... Filter, felt, for engine crankcase	1	7 2
018120	... Seat, for oil felt filter	1	5
014240	... Valve, relief, for oil felt filter	4	6
014241	... Spring, for oil felt filter relief valve	1	2½
016179	... Cap, for felt filter housing (also accommodates oil non-return valve)	8	1
012116	... Washer, fibre, for filter housing cap	1	1½
011645	... Ball, ½ in. steel, for non-return valve	1	2
013564	... Spring, for non-return valve ball	1	2½
013332	... Plug, screwed, retaining non-return valve spring	1	10
011642	... Washer, fibre, for non-return valve spring plug	1	1½
015034	... Gasket, paper, for oil filter chamber (fits between the two crankcase halves)	1	1½

OIL DISTRIBUTOR.

022101	... Distributor, oil metering jet	1	3
021944	... Cap, housing, for oil distributor	1	2
011642	... Washer, fibre, for oil distributor housing cap	1	2½

OIL RELIEF VALVE. (Located in Timing side crankcase, close to oil feed pump).

016524	... Piston, for oil relief valve	1	0
016522	... Spring, for oil relief valve piston	1	1½

GENUINE A·J·S SPARES

PURCHASED FROM

AN AUTHORISED "A·J·S" DEALER
OR FROM THE FACTORY, ARE IDENTICAL
WITH THE PARTS ORIGINALLY BUILT
INTO YOUR MOTOR CYCLE

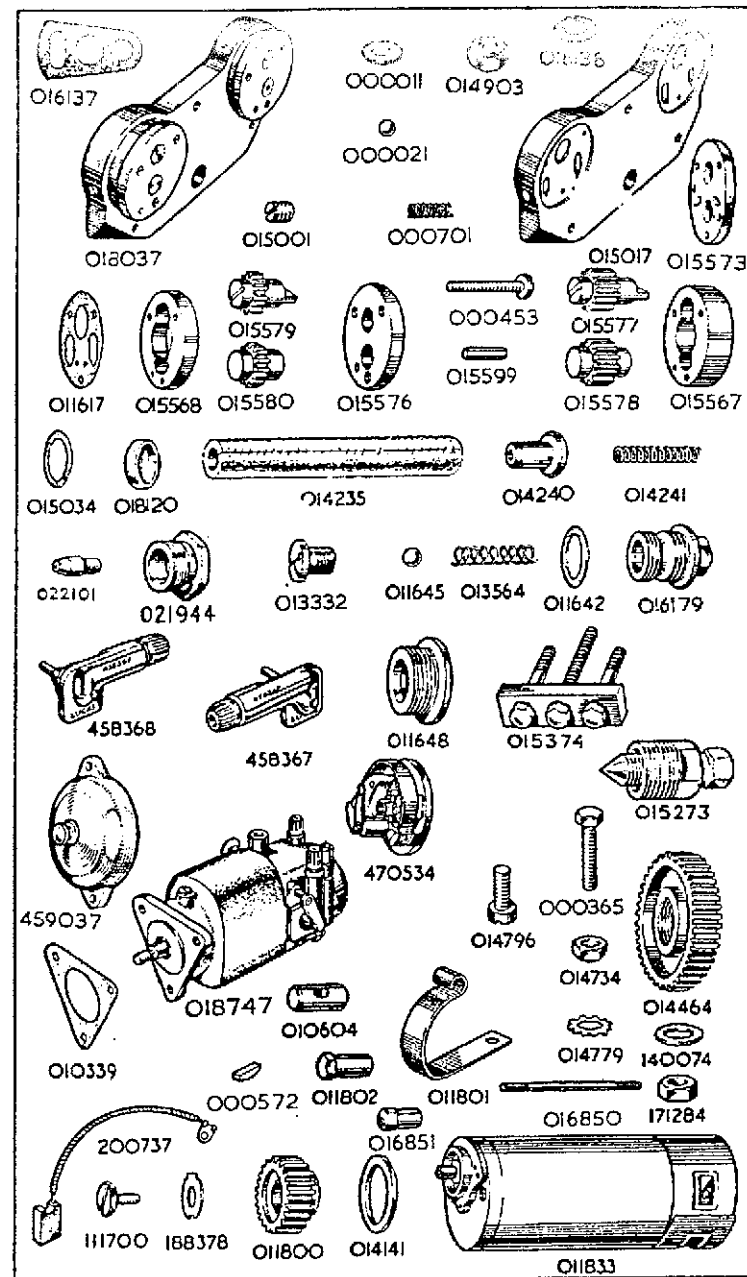

PART NUMBER	DESCRIPTION	QTY. OFF	PRICE EACH (s. d.)
CARBURETTER			
021875	Carburetter complete (less controls) Monobloc type 376/6	1	3 15 0
018554	Inlet manifold (bare) see cylinder head for fixing studs	1	16 4
020012	Washer for manifold retaining studs	4	1 1/2
090005	Nut for manifold retaining studs	4	4
011771	Gasket between manifold and cylinder head	2	1 1/2
018503	Ring, rubber between carburetter and manifold	1	1 2 1/2
016724	Bolt retaining carburetter to manifold	2	6
020011	Washer for carburetter retaining bolts	2	1 1/2
376-002	Carburetter body	1	0 0 0
376-077	Side cover	1	2 6
376-078	Side cover jointing washer	1	4
376-079	Side cover screw	3	2
376-083	Float	1	5 0
376-094	Float spindle bush	1	4
376-089	Float needle	1	1 6
376-088	Float needle seating	2	6 0
376-065	Mixing chamber cap securing ring	3	10
4-235	Mixing chamber cap securing ring spring	1	2
4-241	Screw securing cap securing ring spring	3	0 7
376-064	Mixing chamber cap	2	4 6
4-035	Control cable adjuster	1	1 3
376-062	Air valve	1	7 0
6-047	Air valve guide	1	4
376-060	Throttle valve	1	6 9
4-046	Air valve spring	1	3
376-061	Throttle valve spring	1	9
376-068	Throttle stop screw	1	9
376-069	Throttle stop screw spring	1	3
332-017	Pilot air adjusting screw	1	5
4-148	Pilot air adjusting screw spring	1	2 3
376-063	Taper jet needle	1	6
4-230	Taper jet needle clip	2	9
376-072	Needle jet	1	0 0
376-100	Main jet (specify size when ordering)	4	0 2
376-073	Main jet holder	1	2
376-074	Jet holder washer	1	0
376-075	Main jet cover	1	0
376-076	Pilot jet	1	9
376-095	Pilot jet cover nut	1	2
116-162	Pilot jet cover nut washer	10	0 6
376-056	Jet block complete	1	2
376-070	Locating peg for jet block	2	0 6
376-067	Jet block washer	2	6
376-097	Petrol pipe banjo	1	2
376-091	Petrol pipe banjo bolt	1	8
376-092	Petrol pipe banjo bolt washer	1	3
14-175	Banjo seating washer	1	2
376-093	Filter gauze	1	0 8
343-011	Tickler body	1	3
376-086	Tickler plunger	1	0
376-087	Tickler Spring	1	2
376-066	Air intake venturi	1	3 10

BY USING GENUINE SPARES YOU ARE ASSURED THEY
WILL FIT ACCURATELY AND GIVE SATISFACTORY SERVICE

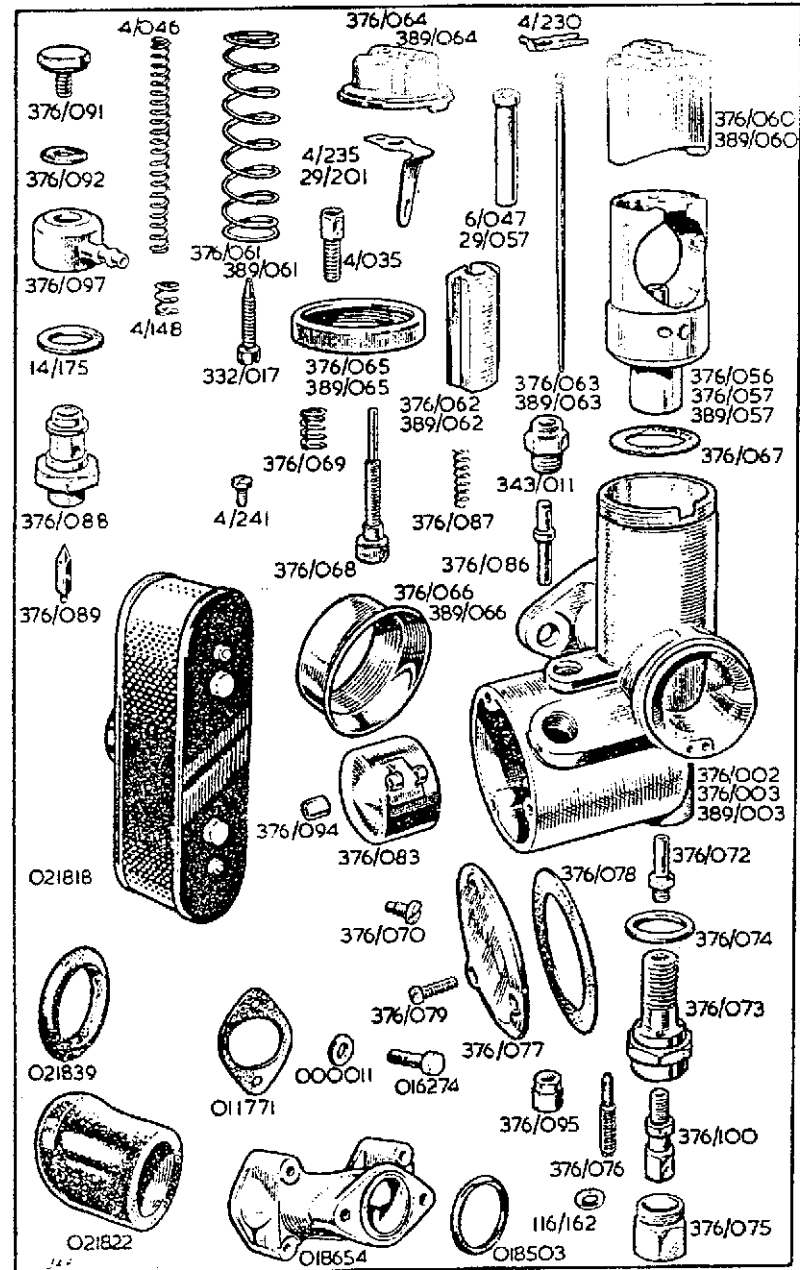

PART NUMBER	DESCRIPTION	QTY. OFF	PRICE EACH £ s. d.
-------------	-------------	----------	-----------------------

AIR CLEANER. (This is optional extra equipment)

021818	Cleaner, air	1	11 4
021822	Sleeve, rubber, connecting air cleaner to carburettor adaptor	1	2 4
016983	Set of air cleaner elements comprising filter element and two fabric end gaskets	1	8 0
021839	Sealing ring, rubber	1	9
022075	Stud, for frame $1\frac{1}{8}$ in. by $\frac{3}{8}$ in. by 26 T.P.I.	2	6

When an air cleaner is fitted it is essential to:—

Fit a smaller jet, viz., use jet 376-100 (size 230)

MAGNETO

018747	Magneto, complete, Type K2F (Lucas number 42230-A)	1	10 0 0
458367	Pick-up, with brush and spring, right	1	5 3
458368	Pick-up, with brush and spring, left	1	5 3
470534	Contact breaker, complete	1	0 0
470609	Contact set	1	8 9
459037	Cover, for contact breaker with switch	1	6 0
010339	Gasket, for magneto flange	1	1½
000365	Bolt, retaining magneto, $1\frac{1}{8}$ in. by $\frac{3}{8}$ in. by 26. For the two magneto retaining studs, see "Crankcase Group."	1	7½
014779	Washer, lock, for magneto retaining bolt and studs	3	1½
000004	Nut, for magneto retaining bolt and studs	3	4
014464	Gear, on magneto shaft	1	12 5
140074	Washer, plain, on magneto shaft	1	1
171284	Nut, on magneto shaft, retaining magneto driving gear	1	4

DYNAMO

011833	Dynamo, Type E3L-L-1-0 (Lucas Number 20009-B)	1	7 10 0
200826	Cover assembly	1	1 9
200737	Brush, for dynamo, set of two, per set	1	3 9
014141	Gasket, between dynamo and crankcase	1	1½
011801	Strap, retaining dynamo to crankcase	1	11
014796	Screw, retaining lower end of dynamo strap to crankcase, $\frac{1}{8}$ in. by $\frac{1}{2}$ in. by 20	1	2½
000012	Washer, plain, for dynamo strap retaining screw	1	1½
010604	Crosshead, in eye of dynamo retaining strap	1	7½
011802	Nut, tensioning dynamo strap. (The stud on which this nut screws, is listed with the crankcase parts)	1	5
000012	Washer, plain, for dynamo strap tensioning nut	1	1½
011800	Gear on dynamo shaft	1	10 2
000572	Key, locating dynamo shaft gear	1	4
111700	Bolt, retaining gear on dynamo shaft	1	6
188378	Washer, lock, for dynamo gear retaining bolt	1	2
016850	Stud, drawing dynamo to crankcase, and passing through timing cover, $2\frac{1}{2}$ ins. long by 2 B.A.	1	5
016851	Nut, for dynamo draw stud	1	11

PART NUMBER	DESCRIPTION	QTY. OFF	PRICE EACH £ s. d.
-------------	-------------	----------	-----------------------

CRANKCASE BOLTS, with engine plates and all bolts passing through same.

014292	Bolt, clamping crankcase throat, $3\frac{1}{4}$ ins. by $\frac{3}{8}$ in. by 22. (These bolts pass through the driving side crankcase and thread into the timing side crankcase)	3	11
000011	Washer, plain, for 014292 crankcase bolts	3	1½
013944	Plate, engine front, right side	1	2 5
013943	Plate, engine front, left side	1	2 5
000278	Stud, passing through crankcase and upper holes in engine, front plates, $4\frac{1}{8}$ ins. by $\frac{3}{8}$ in. by 26. (This stud also supports the stays for the exhaust pipes)	1	7½
000174	Washer, plain, for 000278 engine plate stud	2	1½
000192	Washer, spring, for 000278 engine plate stud	2	1½
000604	Nut, for 000278 engine plate stud	2	4
000278	Stud, passing through crankcase and lower holes in engine front plates, $4\frac{1}{8}$ ins. by $\frac{3}{8}$ in. by 26	1	7½
000011	Washer, plain, for 000278 engine plate stud	2	1½
000004	Nut, for 000278 engine plate stud	2	4
000277	Stud, passing through crankcase at bottom, $4\frac{1}{8}$ ins. by $\frac{3}{8}$ in. by 26	1	7½
000011	Washer, plain, for 000277 crankcase stud	2	1½
000004	Nut for 000277 crankcase stud	2	4
000303	Stud, passing through front of main frame and top of engine front plate, $4\frac{1}{2}$ ins. by $\frac{3}{8}$ in. by 26	1	7½
000010	Washer, plain, for 000303 frame stud	2	1½
000003	Nut, for 000303 frame stud	2	4
021086	Stud, passing through main frame front tube bottom lug, the crankcase, and the front ends of the rear frame rails, 6 ins. by $\frac{3}{8}$ in. by 26	1	1 0
000010	Washer, plain, for 021086 frame stud	2	1½
000003	Nut, for 021086 frame stud	2	4
018014	Plate, engine, rear	2	5 1
000278	Stud, passing through top of engine rear plates and the crankcase, $4\frac{1}{8}$ ins. by $\frac{3}{8}$ in. by 26	1	7½
000278	Stud, passing through bottom of engine rear plates and the crankcase, $4\frac{1}{8}$ ins. by $\frac{3}{8}$ in. by 26	1	7½
000011	Washer, plain, for 000278 studs	3	1½
000004	Nut, for 000278 studs	3	4
000316	Stud, passing through engine rear plates, rear of crankcase, and centre of front chaincase, $7\frac{1}{8}$ ins. by $\frac{3}{8}$ in. by 26. (Stud should be fitted so that the longer thread is on left-hand side of machine)	1	1 5
014084	Spacer, $1\frac{1}{2}$ in. long, on 000316 stud, between back of front chaincase and crankcase	1	8½
021230	Wide nut spacer, on 000316 stud, inside front chaincase	1	9
000009	Washer, plain, for 000316 stud	3	1½
000002	Nut, for 000316 stud	2	5
000303	Stud, passing through top of engine, rear plates, lower end of main frame seat tube and rear fork bridge, $4\frac{1}{2}$ ins. by $\frac{3}{8}$ in. by 26	1	7½
000003	Nut, for 000303 stud	2	4
000278	Stud, passing through rear fork bridge and back ends of engine rear plates, $4\frac{1}{8}$ ins. by $\frac{3}{8}$ in. by 26	1	7½
<i>(The front chain adjusting eye bolt block screws on the right-hand end of this stud.)</i>			
000011	Washer, plain, for 000278 stud	1	1½
000004	Nut, for 000278 stud	1	4

For the bolt stud passing through the top and bottom of the gear box and the engine rear plates, see "Gear Box Fixing Bolts".

For the footrest rod, which passes through the bottoms of the engine rear plates and the frame rails, see "Footrests".

PART NUMBER	DESCRIPTION	QTY. OFF	PRICE EACH £ s. d.
-------------	-------------	----------	--------------------

GASKETS

We supply engine gaskets, either as separate spares, or in complete sets. Single gaskets, are listed in the groups to which they belong. Gaskets in complete sets are listed below

018783	... Complete gasket set for vertical twin engine	1	12 4
018784	... Decarbonising gasket set for vertical twin engine	1	10 5

Each complete gasket set contains:—

- 1—011642 Washer, fibre, for engine filter housing cap.
- 1—011642 Washer, fibre, for oil distributor housing cap.
- 1—011642 Washer, fibre, for crankcase release valve housing cap.
- 2—000183 Washer, fibre, for banjo end of oil pipes.
- 2—011617 Washer, paper, for oil pump bodies.
- 2—011716 Washer, paper, for cylinder bases.
- 1—015034 Washer, paper, for oil filter chamber.
- 1—010339 Gasket, between magneto and crankcase.
- 2—011715 Gasket, for cylinder head.
- 2—011771 Gasket, between inlet manifold and cylinder head.
- 1—014141 Gasket, between dynamo and crankcase.
- 4—018493 Gasket, for rocker covers.
- 2—016137 Gasket, oval, behind pump carrying plate.
- 1—016138 Gasket, round, behind pump carrying plate.

Each decarbonising gasket set includes:—

- 2—011715 Gasket, for cylinder heads.
- 4—018493 Gasket, for rocker covers.
- 2—011771 Gasket, between inlet manifold and cylinder heads.
- 2—011716 Washer, paper, for cylinder bases.

EXHAUST PIPES AND SILENCERS

021913	... Pipe, exhaust, bare, left side	1	10 6
021914	... Pipe, exhaust, bare, right side	1	10 6
014760	... Baffle, for exhaust pipe	2	3 11
021916	... Support, for exhaust pipe, left side or right side	1	4 4
000362	... Bolt, fixing exhaust pipe to support	2	5 5
000011	... Washer, plain, for exhaust pipe fixing bolt	2	1 1/2
021885	... Silencer, bare, left side	1	2 5 2
021886	... Silencer, bare, right side	1	2 5 2
017152	... Clip, clamping silencer to pipe	2	1 11
000363	... Bolt, for silencer clip, 3/8 in. by 7/16 in. by 26	2	5 5
000174	... Washer, plain, for silencer clip bolt	2	1 1/2
000004	... Nut, for silencer clip bolt	2	4 4
000363	... Bolt, fixing silencer to frame	2	5 5
000174	... Washer, plain, for silencer stay to frame bolt	2	1 1/2
000192	... Washer, spring, for silencer stay to frame bolt	2	1 1/2

ENGINE SPROCKETS (and Crankcase Release Valve)

016665	... Sprocket, engine, bare, 18 teeth (for sidecar use only)	1	4 2
015203	... Sprocket, engine, bare, 19 teeth	1	7 2
015204	... Sprocket, engine, bare, 20 teeth. (This is the standard sprocket)	1	7 2
014294	... Sprocket, engine, bare, 21 teeth	1	7 2
014295	... Spacer (collar), 3/8 in. wide, for engine sprocket	1	4 6
016584	... Cam, engine shock absorber	1	14 5
016633	... Spring, engine shock absorber	1	3 8 1/2
018121	... Cap, for engine shock absorber-spring	1	2 1 1/2
016673	... Bolt, locking shock absorber assembly, threaded 1/4 in. by 20. (Also houses crankcase release valve)	1	2 7 1/2
016676	... Diaphragm, for crankcase release valve	1	1 1/2
018282	... Spring, for crankcase release valve diaphragm	1	2 1/2
016674	... Plug, retaining crankcase release valve. (Screws into bolt 016673)	1	1 0

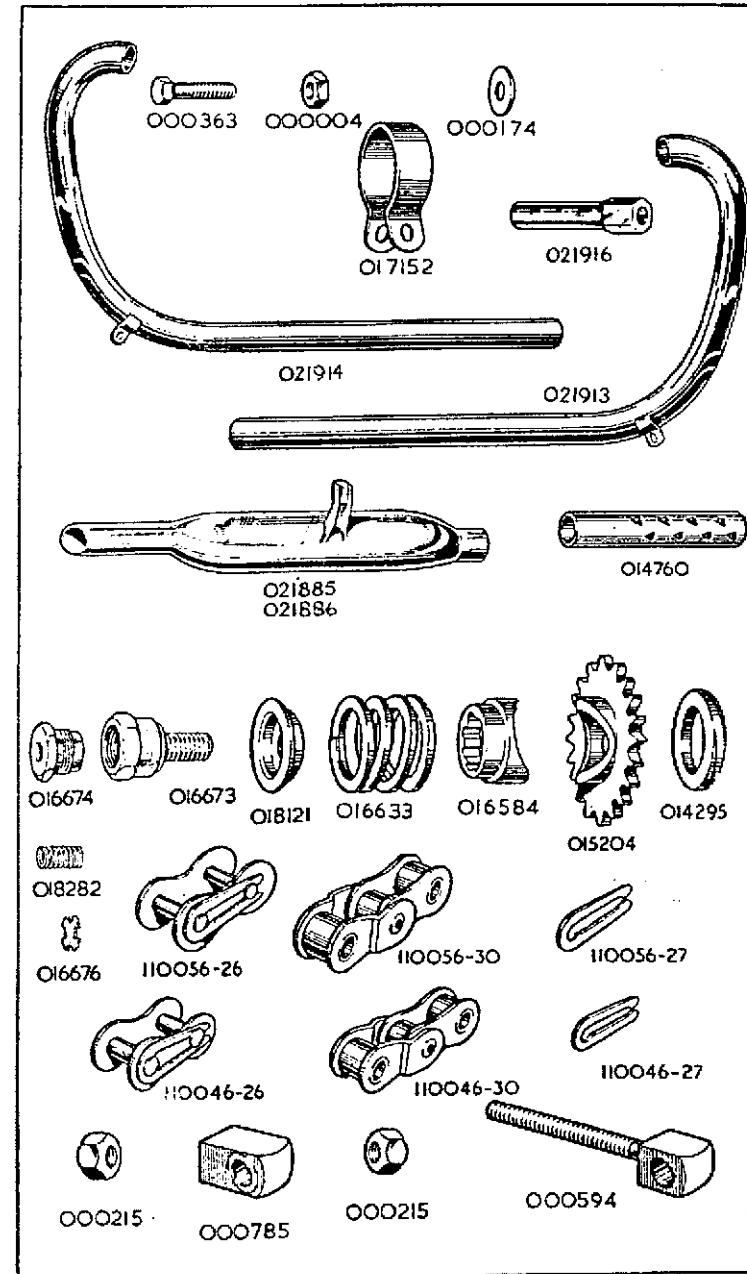

PART NUMBER	DESCRIPTION	QTY. OFF	PRICE EACH £ s. d.
CHAINS			
017298	Chain, front, 66 links, $\frac{1}{2}$ in. by .305 in.	1	1 2 6
017375	Chain, rear, 96 links, $\frac{3}{8}$ in. by .380 in.	1	2 6 8
110046-26	Link, connecting, for $\frac{1}{2}$ in. chains	R	1 0 0
110056-26	Link, connecting, for $\frac{3}{8}$ in. chains	R	1 3 0
110046-30	Link, cranked, double, for $\frac{1}{2}$ in. chains	R	1 8 0
110056-30	Link, cranked, double, for $\frac{3}{8}$ in. chains	R	1 1 5
110046-27	Clip, spring, for 110046-26 connecting links ($\frac{1}{2}$ in.)	R	2 0 0
110056-27	Clip, spring, for 110056-26 connecting links ($\frac{3}{8}$ in.)	R	2 0 0

The prices of front and rear chains include spring connecting links and these are also included in the number of links per chain.

We do not sell odd lengths of chains.

GEAR BOX

016709	Gear, box complete, with clutch and with kick-starter and gear control levers	1	★
--------	---	---	---

★ Price on application.

GEAR BOX FIXING PARTS

010957	Bolt, gearbox top fixing, $5\frac{1}{8}$ ins. by $\frac{7}{16}$ in. by 26	1	2 5 0
000318	Stud, gearbox bottom fixing, $4\frac{1}{8}$ ins. by $\frac{7}{16}$ in. by 26	1	1 0 0
012999	Spacer, $\frac{1}{2}$ in. wide, on top bolt, outside right	1	5 5 0
000002	Nut, for gearbox top fixing bolt	1	5 5 0
000002	Nut, for gearbox bottom fixing stud	2	5 5 0
000009	Washer, plain, for top fixing bolt, left side	1	1 1 5
000594	Eye-bolt, for front chain adjustment	1	4 4 0
000215	Nut, for front chain adjustment eye-bolt	2	5 5 0
000785	Block, crosshead, for front chain adjustment eye-bolt. (This threads on the right hand end of 000278 stud that passes through the rear of the engine rear plates and the top of the rear fork bridge)	1	1 2 5

GEAR BOX SHELL

G-1-9	Shell, gearbox, bare	1	2 5 0
21-10-3	Inspection plug	1	3 0 0
12-10-5	Inspection plug washer	1	2 0 0
21-7-5	Plug, drain, for gearbox shell	1	9 0 0
12-7-6	Washer, fibre, for gearbox shell drain plug	1	3 0 0
12-7-4	Cap, in shell, covering bore for selector spindles	2	3 0 0
35-3-2	Pin, dowel, locating, kick-starter case on gearbox shell	1	5 0 0
G-2-6	Case, kick-starter	1	5 0 0
G-5-3	Washer, paper, between shell and kick-starter case	1	5 0 0
G-3-2	Cover, for kick-starter case	1	5 0 0
G-5-4	Washer, paper, between kick-starter case and cover	1	1 6 0
28-12-45	Piece, locating, between kick-starter case and cover	2	3 0 0
35-1-1	Pin, dowel, locating fixed cam-plate in kick-starter case	1	3 0 0
21-10-1	Cap, filler, for kick-starter case cover	1	9 0 0
21-5-1	Plug, oil level, in kick-starter case cover	1	1 0 0
12-5-4	Washer, fibre, for oil level plug	1	6 0 0
35-2-1	Pin, anchor, in cover, for kick-starter spring	1	6 0 0
14-2-3	Screw, $\frac{1}{4}$ in. under head	1	6 0 0
14-2-4	Screw, $\frac{1}{4}$ in. under head	3	9 0 0
14-2-5	Screw, $\frac{1}{8}$ in. under head	2	9 0 0
14-2-6	Screw, $2\frac{1}{2}$ ins. under head	1	1 0 0
14-2-10	Screw, $3\frac{1}{2}$ ins. under head	1	1 0 0
12-2-5	Washer, fibre, end plate fixing screw	8	1 0 0

Above screws have cheese heads and are threaded $\frac{1}{4}$ in. Whit.

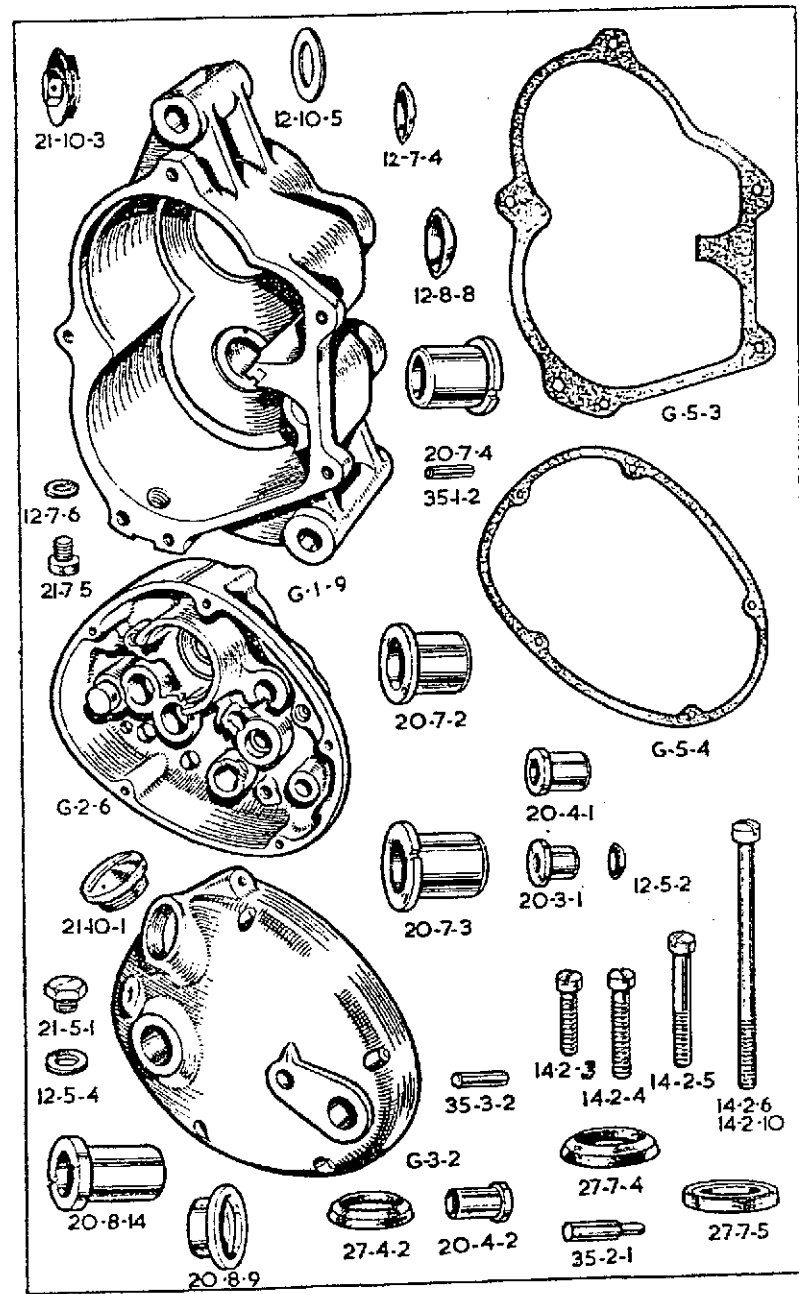

PART NUMBER	DESCRIPTION	QTY. OFF	PRICE EACH £ s. d.
SHAFTS AND GEARS			
G-18-2	Mainshaft, for gearbox	1	7 6
G-19-6	Layshaft for gearbox overall length 5½ in.	1	10 0
G-6-2	Gear, driving, mainshaft, with bushes, 28 teeth	2	8 0
G-12-2	Gear, first, mainshaft, 17 teeth	1	15 0
G-10-2	Gear, second, mainshaft, 22 teeth	1	18 6
G-8-1	Gear, third, mainshaft, 25 teeth	1	1 0
G-7-2	Pinion, on layshaft, 18 teeth	1	15 0
G-13-2	Gear, first, layshaft, with bush, 29 teeth	1	1 0
G-11-2	Gear, second, layshaft, with bush, 24 teeth	1	18 6
G-9-1	Gear, third, layshaft, 21 teeth	1	3 0
19-8-13	Bush, for mainshaft driving gear	2	5 0
19-8-15	Bush, for mainshaft third gear	1	5 0
19-8-14	Bush, for layshaft first gear	1	5 0

GEARBOX BEARINGS, CAPS AND OIL-SEALS

38-11-1	Bearing, ball, 1½ in. by 62 mm. by 16 mm. for driving gear on mainshaft	1	2 6
27-12-2	Oil-seal, for driving gear bearing	1	4 6
39-12-1	Housing, for driving gear bearing oil-seal	1	2 6
31-12-2	Ring, split, retaining driving gear bearing	1	6
38-7-1	Bearing, ball 17 mm. by 40 mm. by 12 mm. for mainshaft (kick-starter end)	1	18 9
31-11-1	Ring, split, retaining mainshaft ball bearing	1	6 0
20-7-4	Bush, for layshaft (clutch end) (.968 in. long)	1	2
35-1-2	Pin, dowel, locating layshaft bush	1	4
12-8-8	Cap, in shell, covering bore, for layshaft	1	6 0
20-7-3	Bush, for layshaft (kick-starter end) (.779 in. long)	1	2
35-1-2	Pin, dowel, locating layshaft bush	1	3 0
20-7-2	Bush, in kick-starter case, for kick-starter spindle	1	3 0
20-8-14	Bush, in cover, for kick-starter spindle	1	3 6
27-7-5	Oil-seal, in cover bush, for kick-starter spindle	1	2 6
20-4-1	Bush, in kick-starter case, for cam spindle	1	2 0
20-4-2	Bush, kick-starter case cover	1	3
27-4-2	Oil-seal, in cover bush, for cam spindle	1	1 6
20-3-1	Bush, in kick-starter case, for control quadrant spindle	1	1
12-5-2	Cap, in kick-starter case, covering bore for control quadrant spindle	1	2 6
20-8-9	Bush, in cover, for control quadrant spindle	1	4
27-7-4	Oil-seal, in cover bush, for control quadrant spindle	1	

GEARBOX SMALL SPROCKET

G-31-1	Sprocket, gearbox, 16 teeth by ½ in. by .380 in.	1	2 6
28-12-16	Collar, spacing, gearbox sprocket, .435 in. wide	1	1 6
12-11-3	Spacer, ½ in. wide, for Sprocket	2	3
12-11-1	Washer, lock, for gearbox sprocket nut	1	9
11-11-1	Nut, fixing gearbox sprocket to driving gear	1	2 7

GEAR OPERATING PARTS

G-29-4	Spindle and fork, gear selection, left	1	17 6
G-29-6	Spindle and fork, gear selection, right	1	17 6
35-3-1	Peg, for selector spindles	2	6
16-1-4	Pin, cotter, for selector spindle pegs	2	1
O18337	Cam, assembly	1	10 0

The cam assembly comprises:-

1—G-27-2 Spindle.

1—G-28-1 Cam.

3—35-2-4 Pegs.

1—35-2-2 Locating pegs.

2—35-1-4 Cam stop pegs.

(Above parts not sold as separate spares)

G-42-3	Plunger, locating cam assembly	1	2 0
36-2-1	Spring, for cam assembly locating plunger	1	6

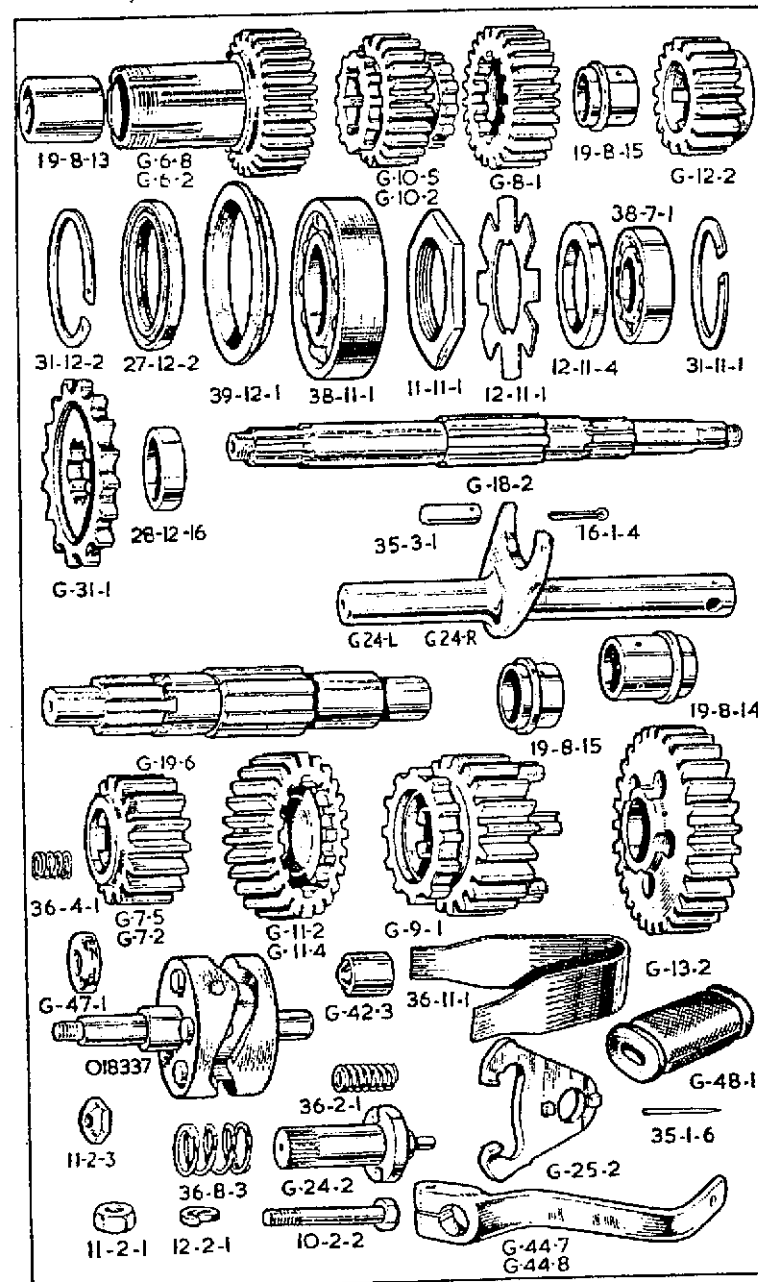

PART NUMBER	DESCRIPTION	QTY. OFF	PRICE EACH £ S. C.
-------------	-------------	----------	--------------------

GEAR OPERATING PARTS—continued.

G-25-2	Quadrant, for control spindle.....	7	6 3
35-2-6	Peg, quadrant drive.....	12	6 0
G-24-2	Spindle, for gear control quadrant.....	2	0 6
36-11-1	Spring, primary, for control quadrant.....	1	6 9
36-8-3	Spring, secondary, for control quadrant.....	1	3 3
G-47-1	Indicator.....	1	3 3
36-4-1	Spring under indicator.....	1	3 3
11-2-3	Nut, retaining indicator.....	1	1 1
G-44-7	Lever, foot, for gear control.....	11	3 1
G-48-1	Pad, rubber, for gear foot lever.....	1	1 1
35-1-6	Pin, fixing gear foot lever rubber pad.....	1	1 0
10-2-2	Bolt, clamping gear foot lever.....	1	1 3
12-2-1	Washer, spring, for gear foot lever bolt.....	1	3 3
11-2-1	Nut, for gear foot lever bolt.....	1	3 3

CLUTCH

G-36-3	Case, for five plate clutch.....	1	18 0
29-2-4	Rivet, for clutch case and chainwheel.....	8	2 2
G-34-2	Chainwheel, 40 teeth by $\frac{1}{2}$ in. by .305 in.....	1	10 0
018339	Case and chainwheel, assembled (five plate).....	2	11 0
G-35-2	Sleeve, for mainshaft.....	1	17 0
12-10-2	Race, roller, for clutch bearing chainwheel.....	1	3 0
18-2-1	Rollers, for chainwheel bearing..... price per set of 24	5	3 3
12-10-3	Washer, thin, chainwheel bearing.....	1	1 1
12-10-4	Washer, thick, chainwheel bearing.....	1	1 1
G-37-3	Centre, for five plate clutch.....	1	10 0
12-7-7	Washer, plain, for centre retaining nut.....	1	4 4
12-7-5	Washer, lock, for centre retaining nut.....	1	9 9
11-7-11	Nut, retaining clutch centre.....	1	9 9
G-39-4	Plate, clutch, plain, steel.....	5	3 0
G-40-12	Plate, clutch, friction, with inserts.....	6	12 6
G-41-5	Inserts, fabric, for friction plate..... price per dozen	120	2 6
G-38-2	Plate, clutch, spring pressure.....	1	13 6
25-7-3	Cup thrust, for spring pressure plate.....	1	0 0
11-7-8	Nut, lock, for pressure plate thrust cup.....	1	6 6
14-2-8	Scud, for clutch spring, 2 ins. long (five plate clutch).....	5	9 9
36-6-1	Spring, for clutch.....	5	9 9
G-42-2	Cup, for clutch spring.....	5	9 9
11-2-2	Nut, adjusting, for clutch spring.....	5	6 6

CLUTCH OPERATING PARTS

37-3-1	Rod, thrust, 10 $\frac{1}{2}$ ins. long (five plate clutch).....	1	6 1
17-3-2	Ball, $\frac{1}{2}$ in., steel, for clutch thrust rod.....	1	2 0
G-32-2	Cam-plate, fixed, actuating clutch.....	2	6 6
G-33-3	Cam-plate, moving, actuating clutch.....	1	6 1
35-3-4	Dowel, thrust (passes through both cam-plates).....	1	1 1
12-2-4	Washer, plain, for cam-plate dowel.....	1	3 3
36-2-3	Spring, for cam-plate dowel.....	1	1 1
16-1-5	Pin, split, for cam-plate dowel.....	3	1 1
17-3-2	Ball, $\frac{1}{2}$ in., steel, for cam-plates.....	3	1 1

KICK-STARTER

G-21-2	Ratchet, driving, kick-starter.....	1	8 8
G-20-1	Pinion, ratchet, kick-starter.....	12	0 0
19-7-3	Bush, kick-starter ratchet pinion.....	3	9 9
36-8-2	Spring, kick-starter ratchet pinion.....	1	1 1
11-7-10	Nut, retaining ratchet driver to mainshaft.....	1	6 6
G-23-1	Spindle, for kick-starter quadrant.....	11	3 3
G-22-1	Quadrant, for kick-starter.....	1	15 9
018340	Kick-starter quadrant and spindle assembled.....	7	0 0
36-8-1	Spring, return, for kick-starter foot lever.....	4	0 9
G-43-2	Lever, foot, kick-starter, bare.....	15	9 9
G-45-1	Pin, pedal, rigid, for kick-starter lever.....	4	6 6
10-4-1	Bolt, clamping, kick-starter foot lever to spindle.....	1	1 9
12-4-1	Washer, spring, for foot lever clamping bolt.....	1	2 2
11-4-1	Nut, for foot lever clamping bolt.....	1	2 2
12-7-22	Lock washer, for nut retaining ratchet driver.....	2	2 2

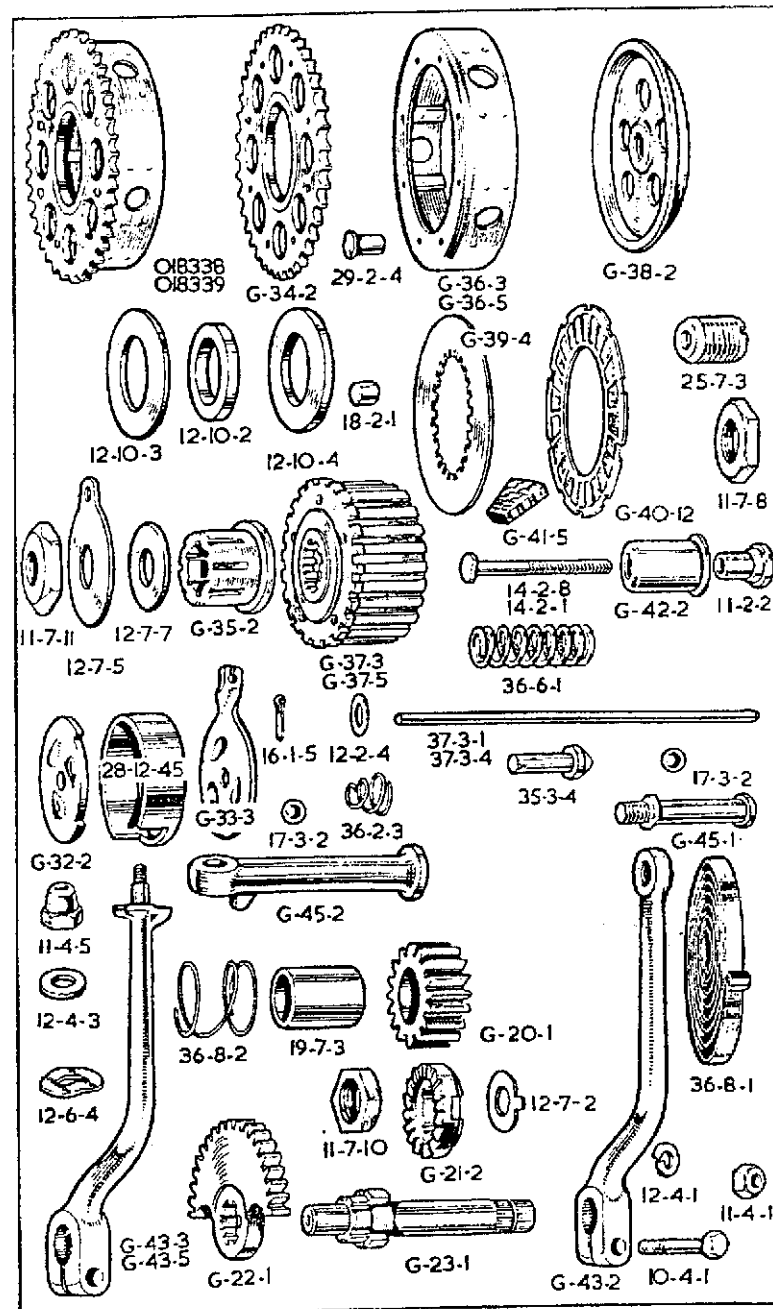

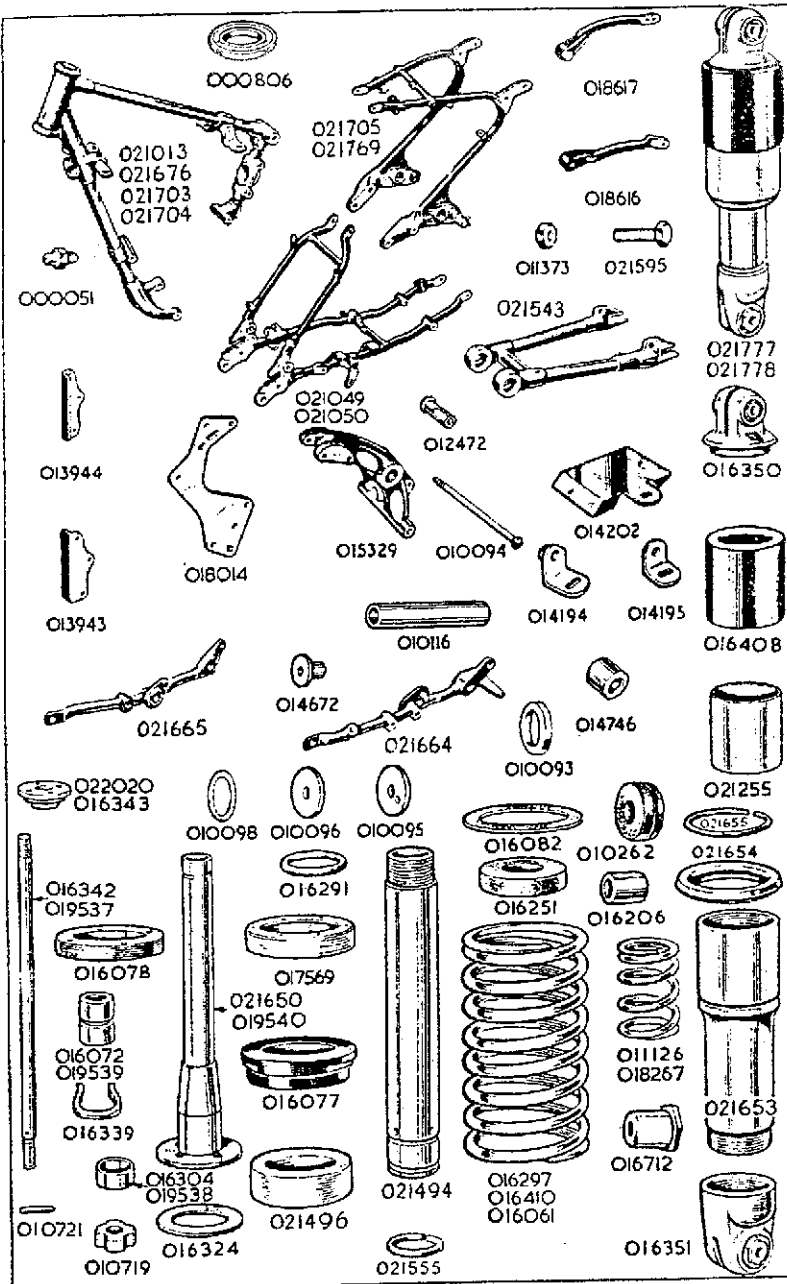

PART NUMBER	DESCRIPTION	QTY. OFF	PRICE EACH £ s. d.
-------------	-------------	----------	--------------------

FRONT FRAME

021676	... Frame, front portion only, bare	1	8 3 6
000806	... Race, ball, for frame head lug	2	4 7
000072	... Balls, $\frac{7}{16}$ in. diameter, for steering head, per set of	56	1 11
000051	... Nipple, grease, for frame head lug	1	6
021768	... Stud, for seat lug (below saddle), $4\frac{1}{4}$ ins. by $\frac{3}{8}$ in. by 26	1	1 1
000038	... Washer, plain, for seat lug stud	2	1 3
000001	... Nut, for seat lug stud	2	5

REAR FRAME

021665	... Rail, frame, right side	1	2 1 3
021664	... Rail, frame, left side	1	1 19 4
021705	... Loop, rear frame	1	6 18 0
021715	... Stud, for rear loop at bottom, 10 $\frac{1}{2}$ ins. by $\frac{1}{2}$ in. by 26. (Also passes through rear fork bridge and both frame rails)	1	4 9
000002	... Nut, for rear loop bottom stud	1	5
000009	... Washer, plain, for rear loop bottom stud	2	1 3
018617	... Tube, supporting rear of rear mudguard, right side	1	7 6
018516	... Tube, supporting rear of rear mudguard, left side	1	7 6
000343	... Bolt, fixing mudguard support tube to mudguard, $\frac{1}{2}$ in. by $\frac{3}{8}$ in. by 26	2	4
018648	... Bolt, fixing mudguard support tube to frame loop (also fixes top end of rear leg)	2	1 7 3

If a carrier is fitted the above 018648 bolts are discarded and bolt 014521 used. See Carrier page 31.

000012	... Washer, plain, for mudguard support tube bolt	2	1 3
000191	... Washer, spring, for mudguard support tube bolt	2	1 3
000005	... Nut, for mudguard support tube bolt	2	4
015329	... Bridge, for rear fork (includes bushes and studs for centre stand spring clip)	1	2 12 5
014672	... Bush, for rear fork bridge	2	8 3
000250	... Stud, for rear fork bridge $\frac{3}{8}$ in. by 2 B.A.	2	4

REAR FORK

021543	... Fork, rear	1	4 5 8
021595	... Adjuster, rear chain	1	7
011373	... Nut, lock, for chain adjuster	1	2 3
014746	... Sleeve, assembly (bushed)	2	6 7
010116	... Tube	1	6 0
010095	... Cap, for rear fork bearing, right side	1	1 2 3
010096	... Cap, for rear fork bearing, left side	1	7 3
010093	... Washer, felt, for rear fork bearing	2	1 0
010098	... Gasket, for rear fork bearing caps	2	1 3
010094	... Spoke, for rear fork bearing (central tie bolt)	1	5
012472	... Nipple, for rear fork bearing spoke	1	2 3
000485	... Screw, plug, for oil, in end cap, $\frac{1}{2}$ in. by $\frac{3}{8}$ in. by 26	1	1 3
000203	... Washer, fibre, for oil plug screw	1	1 3

PART NUMBER	DESCRIPTION	QTY. OFF	PRICE EACH £ s. d.
TELEDRAULIC REAR LEG			
021777	... Leg, TELEDRAULIC, rear complete assembly (no fixing bolts, washers and nuts)	2	6 10 10
016350	... Pivot, top, assembled (this assembly includes the next three items)	2	18 11
016059	... Pivot, top, bare	2	17 9
010262	... Bush, rubber, for top pivot	4	4
016206	... Spacer, for top pivot rubber bush	4	4
016351	... Pivot, bottom, assembled (this assembly includes the next five items)	2	14 2
016060	... Pivot, bottom, bare	2	12 7
010262	... Bush, rubber, for bottom pivot	4	4
016206	... Spacer, for bottom pivot rubber bush	2	4
016712	... Nut, with sleeve, for bottom pivot bolt	2	7 1/2
016873	... Washer, plain, for 016712 sleeve nut	2	9 8
021494	... Tube, Inner (fits in top pivot recess)	2	1 2 1/2
016291	... Ring, sealing inner tube at top	2	3 4
021496	... Bush, lower end of inner tube	2	1 1/2
021555	... Circlip, retaining inner tube bush	2	6 6
021653	... Tube, outer (screws into bottom pivot)	4	1 1/2
016324	... Washer, sealing lower end of outer tube	2	2 0
016077	... Bush, for outer tube	2	3 1
017569	... Oil-seal, between inner and outer tubes	2	2 1 1/2
016078	... Collar, retaining oil-seal	2	9 9
021650	... Tube, for damper	2	7 1/2
016072	... Sleeve, plunger, for damper rod	2	1 1/2
016339	... Clip, locating plunger sleeve	2	1 2 1/2
016342	... Rod, for damper	2	1 2 1/2
016343	... Collar, for top end of damper rod	2	4 4
000074	... Nut, locking collar top-end of damper rod	2	1 2 1/2
016304	... Valve, for damper	2	4 4
010721	... Pin, stop, for damper valve	2	4 4
010719	... Seat, for damper valve	2	4 4
000005	... Nut, retaining damper seat to damper rod	2	1 0
011126	... Spring, buffer	2	6 0
016297	... Spring, main (solo)	2	11 7
016061	... Spring, main (sidocar)	4	4 4
016082	... Washer, leather, at both ends of main spring	2	8 8
016408	... Tube, outer, covering top end of main spring	2	12 6
021255	... Tube, outer, covering bottom end of main spring	2	4 1
021654	... Collar, retaining bottom outer cover tube	2	2
021655	... Circlip, retaining collar	2	1 1 1/2
016251	... Buffer, for TELEDRAULIC Leg	2	1 7 1/2
018648	... Bolt, fixing top pivot, 3 1/2 ins. by 5/8 in. by 26	2	1 7 1/2
014521	... Bolt, fixing top pivot (replaces 018648 when carrier is fitted)	4	1 7 1/2
000010	... Washer, plain, for top pivot bolt	2	7 1/2
016712	... Nut for top pivot bolt	2	8 1/2
016359	... Bolt, fixing bottom pivot, 2 1/2 ins. by 5/8 in. by 26	2	1 1/2
000010	... Washer, plain, for bottom pivot bolt	2	

FORK ASSEMBLIES

The following fork assemblies are complete and include ball races for the fork crown and top head lug (but not the two frame ball races).

021967	... Fork, assembly (TELEDRAULIC Front Fork, Solo)	1	21 3 2
021968	... Fork, assembly (TELEDRAULIC Front Fork, Sidocar)	1	21 6 2

For ease of servicing, the inner tube unit and damper unit are listed and supplied as separate assemblies. This enables a complete assembly to be exchanged in minimum time. The units are listed below.

021971	... Front fork inner tube assembly, Solo	2	3 7 4
021972	... Front fork inner tube assembly, Sidocar	2	3 8 10

The above assemblies comprise:-
Inner tubes with rubber buffers, bushes and circlips, top bolts with washers and sealing rings, slider extensions with oil seals, fork springs and washers.

021974	... Front fork damper assembly	2	13 2
--------	--------------------------------	---	------

The above assembly comprises:-
Rod and two nuts, damper tube with valve, seat and pin, sleeve and clip and bottom fixing bolt with washer.

PART NUMBER	DESCRIPTION	QTY. OFF	PRICE EACH £ s. d.
FRONT FORK			
021927	... Crown, assembly, comprising crown, stem and circlip (these parts not sold separately)	1	2 10 7
000805	... Race, ball, for fork crown	1	4 6
021740	... Screw, pinch, for fork crown	2	1 7 1/2
021749	... Lug, for handlebar and steering head	1	2 2 11
012620	... Race, ball, for handlebar lug	1	4 5
000051	... Nipple, grease, for handlebar lug	1	6
021741	... Nut, adjusting, for fork crown stem	1	3 7
021642	... Nut, lock (domed), for fork crown stem	1	3 4
021652	... Tube, fork, inner	2	1 11 6
021911	... Buffer, rubber, for fork inner tube	6	6 6
021495	... Bush, bottom, for fork inner tube	2	4 11
021651	... Circlip, for fork inner tube bush	2	1 1/2
021830	... Bolt, top, for fork inner tube	2	2 5
018353	... Cap, fork inner tube top bolt	2	2 6
014355	... Ring, sealing, for fork inner tube top bolt	2	4
021831	... Washer, for fork inner tube top bolt	2	5
021977	... Slider, fork, with cap, studs and nuts, left	2	2 6 6
021976	... Slider, fork, with cap, studs and nuts, right	1	2 6 6
021184	... Cap, for fork slider	2	4 11
010713	... Stud, securing fork slider cap, 1 1/2 in. by 7/8 in. by 26 and 22	4	5
000011	... Washer, plain, for fork slider cap stud	4	1 1/2
000004	... Nut, for fork slider cap stud	4	4
021907	... Extension, for fork slider	2	11 8
021782	... Bush, plastic, for fork inner tube	2	3 0
021783	... Oil-seal, for fork inner tube (rubber)	2	3 1
021784	... Spring, main, for front fork, solo	2	6 0
021789	... Spring, main, for front fork, sidocar	2	7 6
022079	... Spring, buffer, for front fork	2	1 4
022021	... Collar, for buffer spring	2	6 6
021785	... Washer, leather, fork spring seating, top	2	2
021786	... Washer, leather, fork spring seating, bottom	2	4
021732	... Tube, fork cover, top, right, with lamp lug	1	13 0
021731	... Tube, fork cover, top, left, with lamp lug	1	13 0
021742	... Spigot, for top of fork top cover tubes	2	2 4
021910	... Seat (rubber), for cover tube	2	8 1/2
021912	... Housing, for fork top cover tube	2	3 3
021735	... Tube fork cover, bottom	2	6 1
000485	... Screw, plug, oil drain, for fork slider, 1/2 in. by 1/2 in. by 26	2	1 1/2
000203	... Washer, fibre, for fork slider screw oil plug	2	1 1/2
021662	... Tube, fork damper	2	7 0
010697	... Bolt, fixing fork damper to slider 7/8 in. by 7/8 in. by 26	2	1 0
010706	... Washer, fibre, for damper tube bolt	2	1 1/2
017357	... Rod, for fork damper	2	1 11
000004	... Nut, lock, top end of damper rod	2	4
016072	... Sleeve, plunger, for fork damper rod	2	7 1/2
016339	... Clip, retaining damper rod sleeve	2	1 1/2
016304	... Valve, for fork damper	2	1 1/2
010721	... Pin, stop, for fork damper valve	2	4
010719	... Seat, for fork damper valve	2	4
000005	... Nut, lock, for fork damper valve seat	2	4
018691	... Steering locking bar (own padlock to be used)	1	1 6

ALWAYS INCLUDE ALL THE LETTERS
WHEN QUOTING THE ENGINE NUMBER

PART NUMBER

DESCRIPTION

QTY
OFF L.S. G.

STEERING DAMPER. (This is an optional extra)

022059	... Damper, steering, complete set of parts	1	...	1	0	6
017260	... Knob, control, for steering damper	1	...	4	2	
000162	... Washer, ratchet, for steering damper knob	1	...	4	4	
000195	... Washer, spring, for steering damper knob	1	...	5		
010808	... Cap, for top of steering stem	1	...	7	2	
010807	... Drawbolt, for steering damper	1	...	1	5	
015137	... Sleeve, assembly, lower end of drawbolt	1	...	6	10	
000073	... Nut, locking sleeve to drawbolt	1	...	4	4	
000342	... Bolt, fixing sleeve assembly, 1 1/2 in. by 1/2 in. by 26	1	...	4	4	
000191	... Washer, spring, for bolt 000342	1	...	1	1	
000012	... Washer, plain, for bolt 000342	1	...	1	1	
017008	... Plate, anchor, top position	1	...	1	1	
000070	... Bolt, fixing top anchor plate, 3/8 in. by 1/2 in. by 26	1	...	4	4	
000191	... Washer, spring, for bolt 000070	1	...	1	1	
000812	... Washer, friction, for steering damper	2	...	1	0	
021811	... Nut, lock, for fork crown stem (this replaces the domed lock-nut 021642 when a steering damper is fitted)	1	...	3	7	

HANDLEBAR

021257	... Handlebar, bare	1	...	1	4	2
021978	... Clip (half only), for handlebar lug	1	...	4	2	
016947	... Screw, for handlebar clip, 3/8 in. by 1/2 in. by 26 (socket head)	3	...	1	1	

FRONT STAND

011286	... Stand, front, bare	1	...	9	1	
010694	... Bolt, fixing front stand to slider, 1 1/2 in. by 1/2 in. by 22	2	...	1	0	
010724	... Washer, spring, for stand to slider bolt	2	...	2	3	
000014	... Pin, split, for stand to slider bolt	2	...	1	0	
000342	... Bolt, fixing front stand to front mudguard, 1 1/2 in. by 1/2 in. by 26	1	...	4	4	
000012	... Washer, plain, for stand to mudguard bolt	2	...	1	1	
000005	... Nut, front stand to mudguard bolt	1	...	4	4	
014278	... Nut (domed), front stand to mudguard bolt	1	...	7	1	

PROP STAND

014719	... Stand, prop, bare	1	...	1	4	4
014713	... Bolt, hinge, for prop stand, 2 1/2 ins. by 1/2 in. by 26	1	...	8	2	
014139	... Nut, for prop stand hinge bolt	1	...	5	1	
000049	... Pin, split, for prop stand hinge bolt	1	...	1	1	
021261	... Spring, return, for prop stand	1	...	9		

CENTRE STAND

016438	... Stand, centre, bare	1	...	1	12	8
014626	... Bush, for centre stand, 7 in. long	2	...	2	6	
014629	... Stud, hinge, for centre stand, 8 1/2 ins. by 1/2 in. by 26	1	...	1	1	
014630	... Spacer, central, for centre stand hinge stud, 4.2 ins. long	1	...	1	1	
010912	... Washer, spigot, for centre stand hinge stud	2	...	5	5	
000602	... Nut, for centre stand hinge stud	2	...	5	5	
014627	... Spring, return, for centre stand	1	...	3	0	
016399	... Spring, stop, for centre stand	1	...	1	0	
000080	... Nut, for centre stand stop spring (the studs, on which these nuts fit, are listed with the " REAR FORK BRIDGE ")	2	...	1	1	
000039	... Washer, plain, for centre stand stop spring fixing nuts	2	...	1	1	

FRONT MUDGUARD

021716	... Mudguard, front, bare	1	...	1	12	8
010795	... Bolt, fixing mudguard bridge to right fork slider, 3/8 in. by 1/2 in. by 22	2	...	5	5	
000192	... Washer, spring, for bridge right fixing bolt	2	...	1	1	
010624	... Stud, fixing mudguard bridge to left fork slider, also retains brake anchor stay and bracket for brake cable adjuster, 1 1/2 in. by 1/2 in. by 26 and 22	2	...	5	5	
014117	... Washer, lock, for bridge left fixing stud	2	...	1	1	
000004	... Nut, for bridge left fixing stud	2	...	4	4	

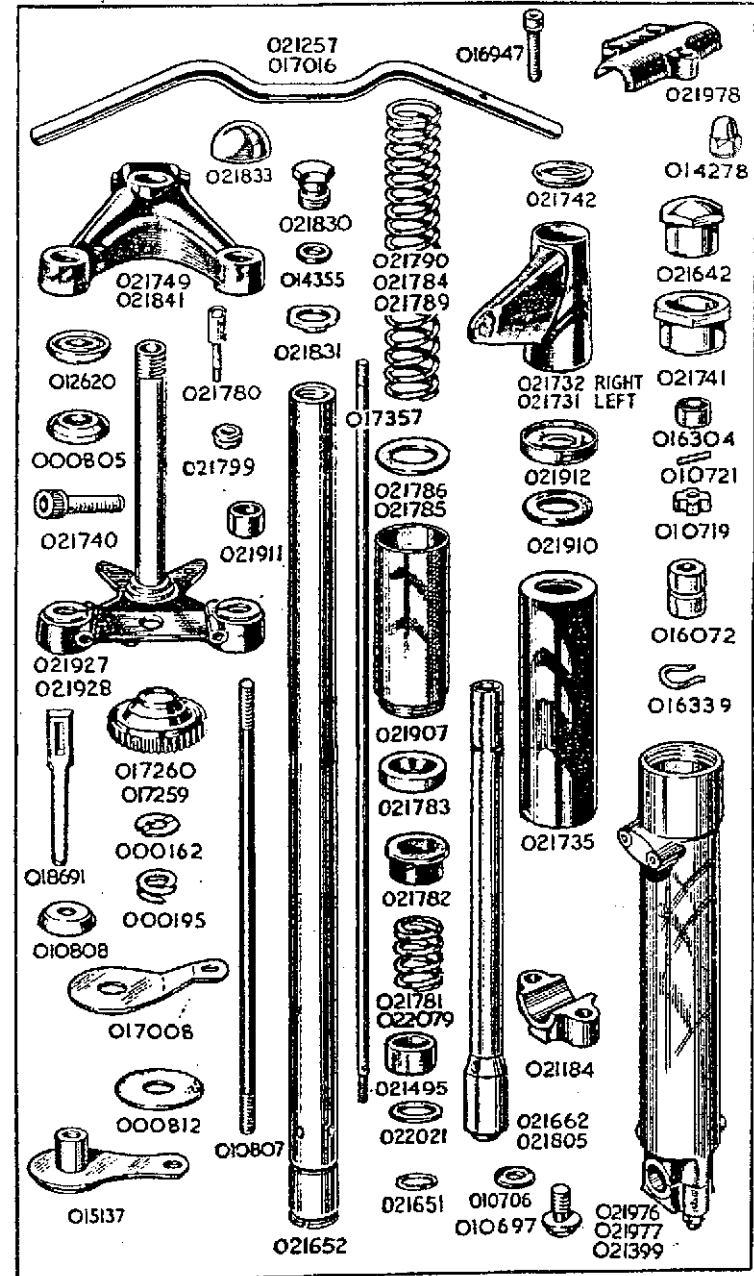

PART NUMBER	DESCRIPTION	QTY. OFF	PRICE EACH £ s. d.
REAR MUDGUARD			
021982	... Rear mudguard (both portions with joint bolts).....	1	3 16 3
021707	... Rear mudguard, forward portion only	1	2 6 10
021710	... Rear mudguard, rear portion only	1	1 7 6
021098	... Bolt, for mudguard joint.....	3	6
021099	... Washer, for mudguard joint bolt	3	1 1/2
014501	... Bracket, for bottom of rear mudguard	2	5 4
000342	... Bolt, fixing bracket to rear mudguard, 1 1/2 in. by 3/4 in. by 26.....	2	4
000012	... Washer, plain, for bracket fixing bolt.....	4	1 1/2
000005	... Nut, for bracket fixing bolt.....	2	4
000275	... Stud, fixing rear mudguard brackets to frame, 3 1/2 ins. by 3/8 in. by 26.....	1	5
000011	... Washer, plain, for bracket fixing stud.....	2	1 1/2
000004	... Nut, for bracket fixing stud	2	4
000346	... Bolt, fixing rear mudguard to frame loop bridge, 1 1/4 in. by 3/4 in. by 26	1	5
000191	... Washer, spring, for bridge fixing bolt.....	1	1 1/2
000005	... Nut, for bridge fixing bolt	1	4
000342	... Bolt, fixing mudguard to oil tank	1	4
000172	... Washer for mudguard to oil tank bolt	1	1 1/2
000005	... Nut for mudguard to oil tank bolt	1	4
REAR CARRIER			
014874	... Carrier, rear, bare	1	1 5 2
014521	... Front fixing bolt (replaces 018648 when carrier is fitted).....	2	1 7 1/2
FRONT NUMBER PLATE			
011835	... Plate, number, front	1	3 5
011836	... Stud, fixing front number plate	2	1 2 1/2
000012	... Washer, plain, front number plate stud.....	2	1 1/2
000005	... Nut, front number plate stud.....	2	4
000861	... Screw, fixing front number plate to stud, 1/2 in. by 2 B.A.....	2	1 1/2
011889	... Fillet, rubber, front number plate	1	6
REAR NUMBER PLATE			
018737	... Plate, number, rear, 8 in. wide.....	1	13 10
000363	... Bolt, fixing rear number plate, 3/4 in. by 3/8 in. by 26.....	2	5
000192	... Washer, spring, rear number plate bolt.....	2	1 1/2
FRONT CHAINCASE			
021404	... Chaincase, complete (comprises both halves, metal and rubber bands, clamping screw and inspection caps—NO FIXING BOLTS, SPACERS, WASHERS AND NUTS ARE INCLUDED).....	1	3 0 0
018718	... Chaincase, back half, bare	1	12 6
018963	... Chaincase, front half, bare	1	17 10
018650	... Band, metal, for chaincase.....	1	7 10
000453	... Screw, clamping, chaincase metal band, 1 in. by 2 B.A.....	1	4
018652	... Band, rubber, for chaincase	1	6 4
014457	... Cap, assembly, chaincase inspection (components not sold as separate spares)	1	2 7
000580	... Washer, cork, chaincase inspection cap	1	4
018964	... Domed clutch cover.....	1	6 0
018966	... Washer, cork, for clutch dome.....	1	1
000450	... Screw, 3/8 in. by 2 B.A., round head, for clutch dome.....	8	2 1/2
000440	... Bolt, fixing chaincase to engine, 3/4 in. by 0 B.A.....	3	4
000165	... Washer, lock, chaincase engine bolt.....	3	1 1/2

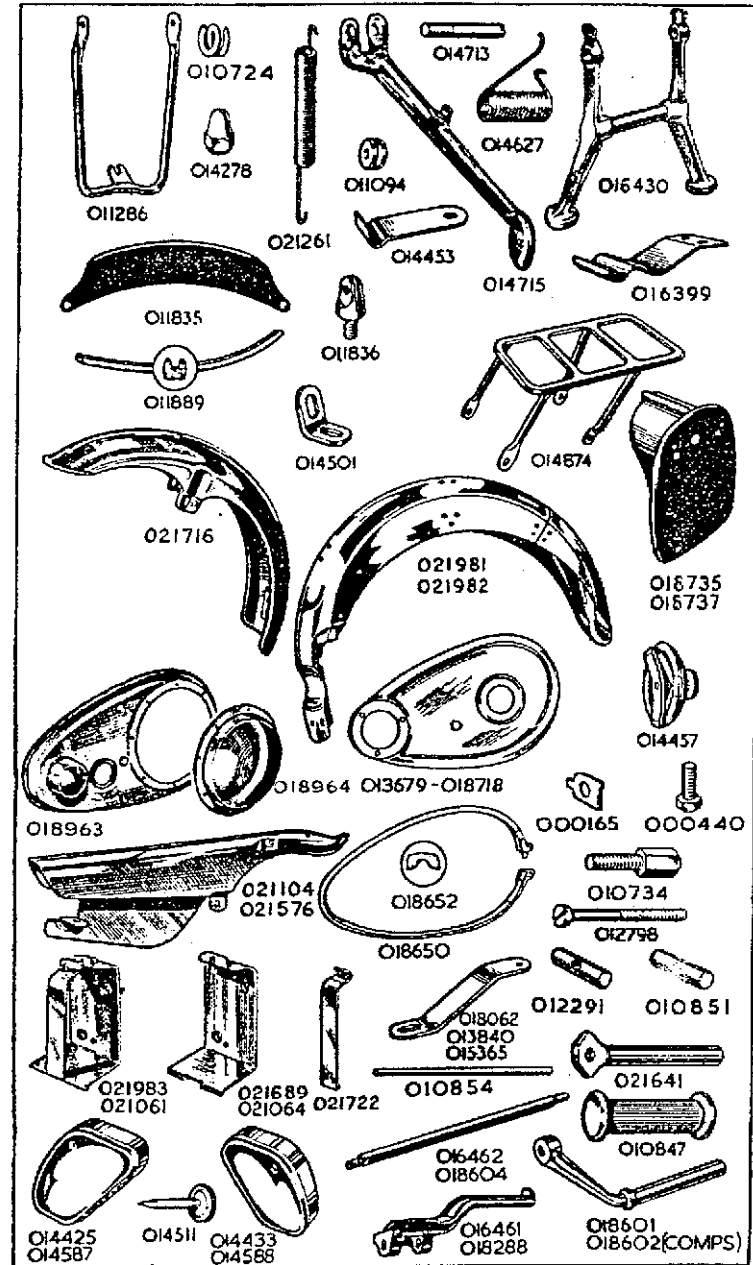

PART NUMBER	DESCRIPTION	QTY. OFF	PRICE EACH £ s. d.
REAR CHAINGUARD			
021576	... Chainguard, rear, bare	1	4 4
000350	... Bolt, fixing chainguard in front, 2 1/4 ins. by 1/2 in. by 26	1	5
000012	... Washer, plain, chainguard, front fixing bolt	2	1 1/2
000005	... Nut, for chainguard front fixing bolt	1	4
000349	... Bolt, fixing rear of chainguard, 1 1/2 ins. by 1/2 in. by 26	1	5
021579	... Washer, spring, for chainguard rear fixing bolt	1	1 1/2
021578	... Spacer, 1 1/2 in. long (located inside chainguard), on bolt 000349	1	6

BATTERY CARRIER

021983	... Carrier, battery, complete with bolt, seat and nut	1	14 10
021689	... Carrier, battery, back portion only	1	7 6
021722	... Carrier, battery, front portion only	1	5 3
010854	... Pin, hinge, battery carrier front	1	4
012798	... Bolt, clamping battery carrier, 1 1/2 in. by 1/2 in. by 26	1	7 1/2
012291	... Seat, battery carrier clamping bolt	1	5
010851	... Nut, battery carrier clamping bolt	1	8 1/2
000004	... Nut, fixing battery carrier to oil tank stud	3	4
000174	... Washer, plain, for battery carrier and oil tank fixing nut	3	1 1/2
013840	... Stay, battery carrier to chaincase	1	1 0
000040	... Screw, fixing stay to battery carrier, 1/2 in. by I.B.A.	1	1 1/2
000012	... Washer, plain, for 000040 bracket screw	1	1 1/2
010734	... Bolt, fixing battery carrier bracket to chaincase, 3/4 in. by 1/2 in. by 26	1	5
000011	... Washer, plain, for 010734 carrier bracket bolt	1	1 1/2
000004	... Nut, for 010734 carrier bracket bolt	1	4

TOOL BOXES

014425	... Box, tool, bare (with lid but no other fittings), left side	1	6 5
014433	... Box, tool, bare (with lid but no other fittings), right side	1	1 0
014511	... Screw, knurled, for tool box lid	2	1 1/2
000189	... Washer, spring, for tool box lid screw	2	1 1/2
000005	... Nut, for tool box lid screw	4	4
000342	... Bolt, long, fixing tool box, 1 1/4 in. by 1/2 in. by 26	4	4
014577	... Bolt, short, fixing tool box, 1/2 in. by 1/2 in. by 26	2	2 1/2
000639	... Spacer, 1 1/4 in. long for tool box long fixing bolts	4	4
000012	... Washer, plain, for tool box fixing bolt	12	1 1/2
000005	... Nut, for tool box fixing bolts	6	4

FOOTRESTS

018601	... Arm, for footrest	2	10 0
010847	... Pad, rubber, for footrest arm	2	1 10
018604	... Rod, for footrests, overall length 10 1/2 ins.	1	2 9
010924	... Spacer, 3 1/2 ins. long, for footrest rod, between engine rear plates	1	4
013837	... Spacer, 1 in. long, for footrest rod, outside right plate	1	10
010911	... Spacer, 1 1/2 in. long, for footrest rod, outside left plate	1	7 1/2
010912	... Washer, spigot, for footrest rod	2	4
000002	... Nut, for footrest rod	2	5

PILLION FOOTRESTS

021984	... Pair of pillion footrests, complete (includes all the following items)	1	12 7
021641	... Spindle, bare for pillion footrest	2	3 7 1/2
011599	... Bolt, hinge, for pillion footrest spindle, 1 1/2 in. by 1/2 in. by 26	2	7 1/2
000073	... Nut, for pillion footrest hinge bolt	2	4
010847	... Pad, rubber, for pillion footrest spindle	2	1 10

PART NUMBER	DESCRIPTION	QTY. OFF	PRICE EACH £ s. d.
TWIN SEAT			
021199	... Seat, Twin	1	8 2 0
021208	... Screw, fixing seat at rear to loop, 3/8 in. by 1/2 in.	2	10
000012	... Washer, plain, for seat fixing screw	2	1 1/2
018160	... Nut, for seat fixing screw	2	1 1/2
021219	... Rubber Grommet, for base	2	1 1/2

TRANSFERS

009183	... Transfer, for side of oil tank (oil level indicator)	1	4
009184	... Transfer, for top of oil tank (service instruction)	1	4
009186	... Transfer, for front chaincase (oil level indicator)	1	4
009187	... Transfer, for front chaincase (patent)	1	1 1/2
009185	... Transfer, for tool box (monogram)	2	5 5
009194	... Transfer, for rear mudguard ("A-J-5")	1	7 1/2
009199	... Transfer, for front forks (patent)	1	7 1/2
009195	... Transfer, for petrol tank (reserve)	1	4
009198	... Transfer, for side of oil tank (oil top level indicator)	1	2 1/2
009200	... Transfer, for forks ("Made In England")	1	1 1/2
009197	... Transfer, for rear fork hinge (patent)	1	1 1/2
018091	... Complete set of transfers	1	3 8 1/2

DUMMY GRIP

16-069	... Grip, rubber, dummy	1	1 6
--------	-------------------------	---	-----

TWIST GRIP

16-117	... Twist grip, complete assembly	1	11 0
16-070	... Grip, rubber, for twist grip	1	1 0
16-091	... Rotor, and sleeve, for twist grip (does not include rubber grip)	1	3 10
16-060	... Body, twist grip, top (plain clip)	1	3 4
16-061	... Body, twist grip, bottom (for friction spring)	1	3 4
11-013	... Screw, long, clamping twist grip body	1	3
11-014	... Screw, short, clamping twist grip body	1	3
16-008	... Spring, friction, for twist grip	1	10
16-009	... Screw, for twist grip friction spring	1	7
16-010	... Nut, for twist grip friction spring screw	1	2
16-011	... Stop, for twist grip (throttle) cable	1	7

CLUTCH AND IGNITION CONTROL LEVERS

18-694	... Lever, assembly, clutch and ignition	1	18 9
18-528	... Lever only, clutch	1	5 9
12-557	... Lever only, ignition	1	4 2
18-241	... Bracket, for clutch lever	1	5 9
12-008	... Bracket, for ignition lever	1	3 0
11-013	... Screw, long, clamping clutch and ignition brackets	1	3
11-014	... Screw, short, clamping clutch and ignition brackets	1	3
18-087	... Pin, fulcrum, for clutch lever	1	3
18-053	... Nut, clutch lever fulcrum pin	1	3
12-029	... Bolt, central, for ignition lever	1	3
12-031	... Cap, for ignition lever	1	1 1
12-033	... Washer, spring, for ignition lever	1	2

WHEN ORDERING SPARES, IF IN DOUBT REGARDING THE NAMES AND PART NUMBERS OF THE PARTS YOU REQUIRE, PLEASE SEND THE OLD PARTS TO SERVE AS PATTERNS.

PART NUMBER	DESCRIPTION	QTY. OFF	PRICE
			EACH £ s. d.

BRAKE AND AIR CONTROL LEVERS

18-693	Lever, assembly, brake and air	1	18 9
18-535	Lever, only, brake	1	5 9
12-556	Lever, only, air	1	4 2
18-240	Bracket, for brake lever	1	5 9
12-007	Bracket, for air lever	1	3 0
11-013	Screw, long, clamping brake and air brackets	1	3 3
11-014	Screw, short, clamping brake and air brackets	1	3 3
18-087	Pin, fulcrum, for brake lever	1	3 3
18-053	Nut, brake lever fulcrum pin	1	3 3
12-029	Bolt, central, for air lever	1	3 3
12-031	Cap, for air lever	1	1 1
12-033	Washer, spring, for air lever	1	2

FRONT BRAKE CABLE

013178	Cable, complete, assembled, front brake	1	6 6
000530-40 $\frac{1}{2}$	Wire, inner, front brake, 40 $\frac{1}{2}$ ins. finished length	1	6
18-689	Nipple, brake end, for brake inner wire	1	4
18-689	Nipple, handlebar end, for brake inner wire	1	4
18-690	Nipple, roller adaptor, handlebar end for inner wire	1	9
000529-26	Casing, outer, front brake, 26 ins. long	1	10
000531	Ferrule, front brake outer casing	2	1 $\frac{1}{2}$
011348	Adjuster, front brake cable	1	2 5
017217	Nut, lock, front brake cable adjuster	1	7 $\frac{1}{2}$
017049	End, yoke, front brake cable	1	7 $\frac{1}{2}$
000736	Pin, for yoke end, front brake cable	1	5
000014	Pin, split, for front brake cable yoke and pin	1	1 $\frac{1}{2}$
012478	Steeve, rubber, for front brake cable inner wire	1	6

CLUTCH CABLE

021405	Cable, complete, assembled, clutch, with oil nipple	1	6 7
000530-43 $\frac{1}{2}$	Wire, inner, clutch, 43 $\frac{1}{2}$ ins. finished length	1	6
017241	Nipple, gearbox end, clutch inner wire	1	1 $\frac{1}{2}$
18-689	Nipple, handlebar end, clutch inner wire	1	4
18-690	Nipple, roller adaptor, handlebar end for inner wire	1	9
021406	Casing, outer, clutch, with adaptor for oil nipple	1	2 7
000531	Ferrule, clutch outer casing	2	1 $\frac{1}{2}$
014225	Adjuster, clutch cable	1	8 $\frac{1}{2}$
011373	Nut, lock, clutch cable adjuster	1	2 $\frac{1}{2}$
000051	Oil nipple only	1	6

THROTTLE CONTROL CABLE

022019	Cable, complete, assembled, throttle with oil nipple	1	5 3
000535-40 $\frac{1}{4}$	Wire, inner, throttle, 40 $\frac{1}{4}$ ins. finished length	1	1 4
017242	Nipple, carburettor end, throttle inner wire	1	2 $\frac{1}{2}$
017266	Nipple, handlebar end, throttle inner wire	1	2 $\frac{1}{2}$
021408	Casing, outer, throttle, with adaptor for oil nipple	1	2 5
000528	Ferrule, throttle outer casing	2	1 $\frac{1}{2}$
000031	Oil nipple only	1	6

AIR CONTROL CABLE

022022	Cable, complete, assembled, air	1	3 6
000527-37 $\frac{1}{2}$	Wire, inner, air, 37 $\frac{1}{2}$ ins. finished length	1	7
017242	Nipple, carburettor end, air inner wire	1	2 $\frac{1}{2}$
017266	Nipple, handlebar end, air inner wire	1	2 $\frac{1}{2}$
000526-32 $\frac{1}{2}$	Casing, outer, air, 32 $\frac{1}{2}$ ins. finished length	1	11
000528	Ferrule, air, outer casing	2	1 $\frac{1}{2}$

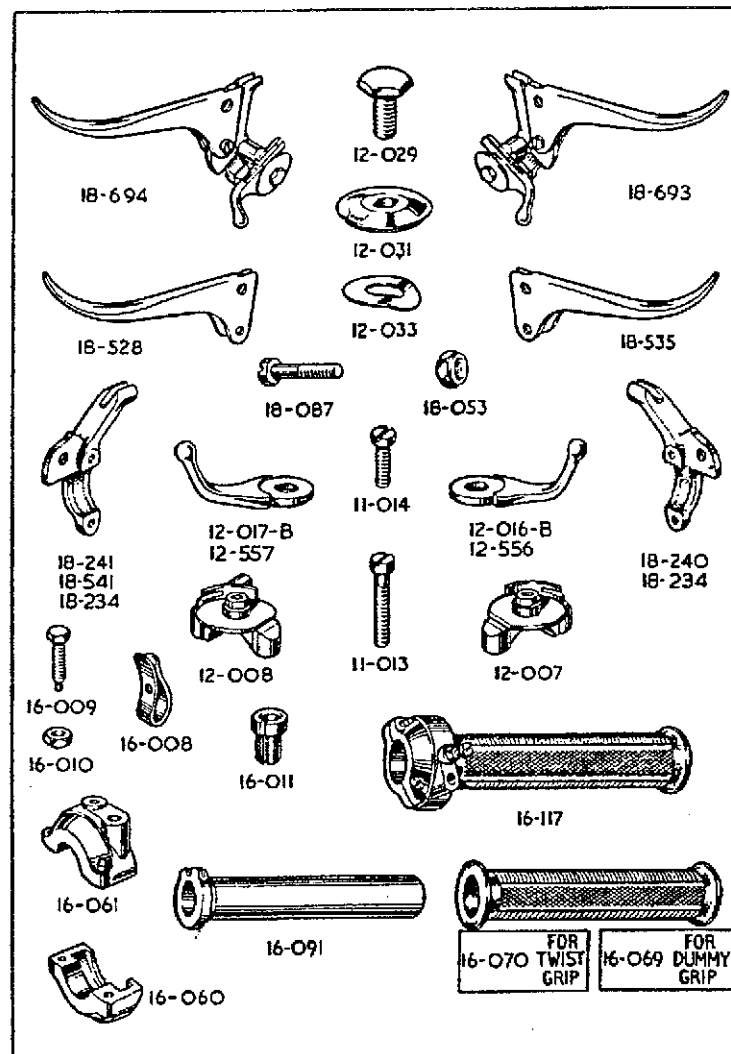

PART NUMBER	DESCRIPTION	QTY. OFF	PRICE EACH £ s. d.
IGNITION CONTROL CABLE			
018749	Cable, complete, assembled ignition	1	5 3
000527-37½	Wire, inner, ignition, finished length 37½ ins.	1	5
017379	Nipple, magneto end, ignition inner wire	1	7½
017366	Nipple, handlebar end, ignition inner wire	1	2½
000526-34½	Casing, outer, ignition, 34½ ins. long	1	9
000528	Ferrule, ignition outer casing	2	1½
458731	Cap, rubber, cable entry to magneto	1	7
458727	Cap, metal, cable entry to magneto	1	3 2
163343	Washer, fibre, for cable entry metal cap	1	1
454969	Plunger, for ignition cable	1	1 2
458732	Spring, return, for ignition cable	1	3

PETROL TANK

021164	Tank, petrol, bare, plated, black panels	1	12 4 10
018852	Tank badge, blue and silver	2	6 3
000153	Screw, fixing tank embiém, ¼ in. by 3 B.A.	4	2½
018853	Tank badge, rubber seating	2	9

PETROL TANK FITTINGS

013325	Cap, filler, for petrol tank	1	6 5
021843	Tap, for petrol feed, with filter and banjo	2	8 4
000200	Washer, fibre, for petrol feed tap	2	4
022110	Banjo, for petrol feed pipe	2	2 0
022111	Nut, dome, retaining banjo	2	1 0
022056	Washer, fibre for banjo	4	4
022112	Cork, for petrol feed tap	2	3
011006	Grip, knee, left hand side	1	4 11
011005	Grip, knee, right hand side	1	4 11
021169	Plate, for left hand knee grip	1	1 4
021170	Plate, for right hand knee grip	1	1 4
000348	Bolt, fixing knee grip plate	4	4

PETROL TANK FIXING BOLTS

014997	Bolt, fixing tank, all positions, 1½ in. by ¼ in. by 26	4	10
014998	Sleeve, ½ in. long, for tank fixing bolts	4	2½
014995	Pad, rubber, thick (⅝ in.) for tank fixing bolts in front right and both rear positions	4	5
014996	Pad, rubber, thin (¼ in.), for all tank fixing bolts (three used on front left bolt)	4	2½
014999	Washer, metal, 1½ in. diameter, plain, for tank fixing bolts	4	4
017051	Wire, copper, 5 feet by 20 S.W.G.	1	4

OIL TANK

021681	Tank, oil, bare	1	1 18 5
021698	Stud, securing oil tank	2	6
013324	Cap, filler, oil tank	1	6 5
012019	Plug, drain, for oil tank	1	5
000200	Washer, fibre, oil tank drain plug	1	4
000796	Filter, felt, for oil tank	1	4 11
000704	Spring, for oil tank felt filter	1	7½
000797	Cap, metal, dished, for oil tank felt filter	1	5
000795	Cap, screwed, oil tank filter compartment	1	2 11
000583	Washer, cork, filter compartment cap	1	4

For the nuts and washers that retain the oil tank (and the Battery Carrier) to the main frame, see "Battery Carrier" Group.

For the bolt, washer, and nut fixing the oil tank bracket to the rear mudguard, see "Rear Mudguard" Group.

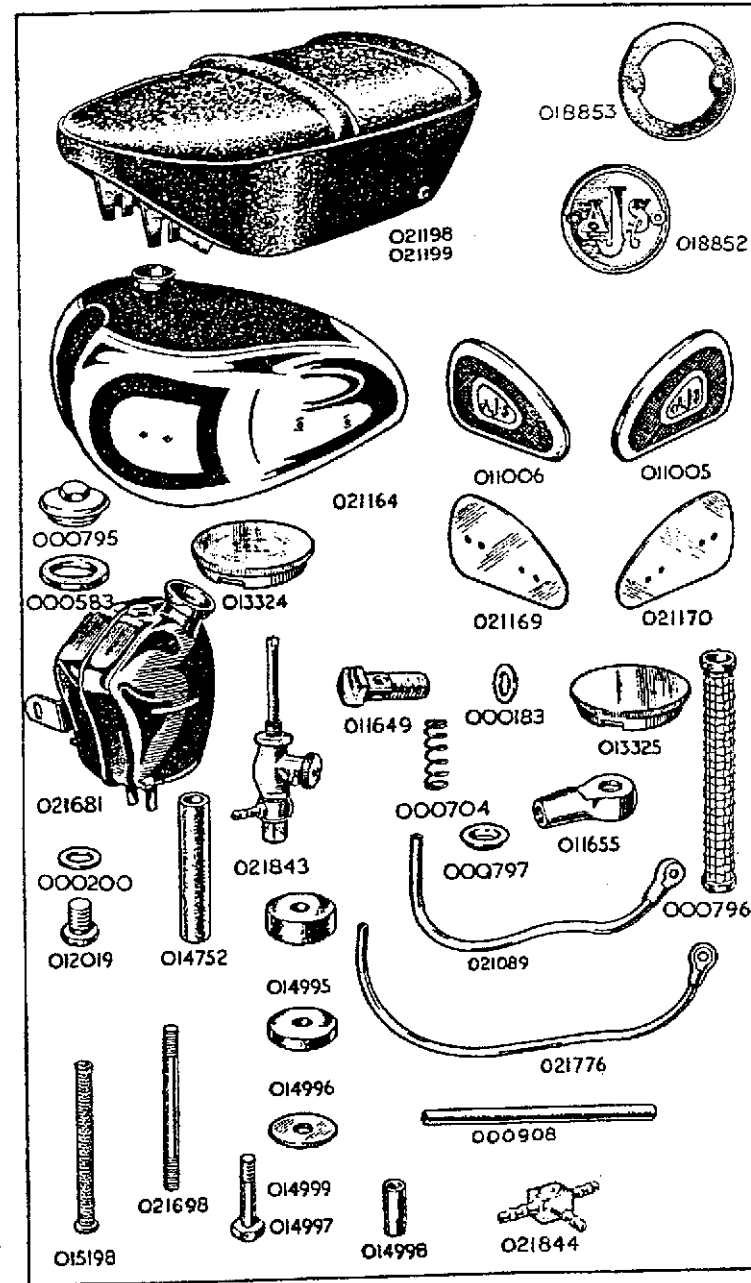

PART NUMBER	DESCRIPTION	QTY. OFF	PRICE EACH £ s. d.
-------------	-------------	----------	--------------------

PETROL PIPE

000908-2	Flexible tubing, short, 2 ins.	1	4
000908-5½	Flexible tubing, long, 5½ ins.	2	11
021844	Petrol pipe "T" piece	1	2 9

OIL PIPES

021776	Pipe, oil feed assembly	1	13 10
021089	Pipe, oil return	1	12 7
011655	Union, banjo, feed and return oil pipes	2	5 5
011649	Pin, banjo, retaining feed and return oil pipes to engine	2	2 5
000183	Washer, fibre, for oil pipe banjo	4	4
014752	Connection, rubber, for feed and return oil pipes	2	6
015198	Filter, metal gauze, for oil feed pipe	1	2 0
015138	Pipe, vent, metal	1	2 6½
014936	Hose, from oil tank to metal vent pipe	1	11

FRONT WHEEL

The complete wheel listed below comprises:—Rim, spokes, nipples, hub, grease nipple, all bearings, and all brake parts including cover plate and expander lever, but does not include the tyre.

021987	Wheel, front, with all fittings, chrome rim, black centre	1	13 17 5
--------	---	---	---------

The bare wheel listed below comprises:—Rim, spokes, nipples and hub.

021990	Wheel, front bare, chrome rim, black centre	1	7 7 6
012220	Rim, front, chrome, black centre (A.M.C. 23)	1	1 13 8
021152	Spoke, front, 5½ ins. by 11 G.	40	2
021154	Nipple, front, .250 in. by 11 G.	40	2
021461	Hub, front wheel, shell only with brake drum	1	5 0 0
000051	Nipple, grease, for front wheel hub	1	6
011090	Tape, for 19 ins. by 2½ ins. rim	1	1 9
021464	Hub disc, covering right side	1	7 7

FRONT WHEEL BEARINGS

012825	Spindle, with roller bearings, for front wheel	1	2 2 7
010579	Oil-seal, for front hub bearings	2	6
017219	Ring, spring, locating front hub bearings	1	4
018093	Cup, for front hub bearing oil-seal	2	4
018096	Ring, retaining front hub bearing oil-seals	2	1½
021279	Nut, lock, for front hub bearing adjusting ring	1	1 5
021161	Ring, adjusting, for front hub bearing	1	1 3
021931	Nut, locating front brake cover plate	1	9
017222	Washer, locating, front brake cover plate	1	4
018071	Nut, outside, securing front brake cover plate	1	2 7
000051	Nut, front wheel spindle, left side	1	5
000008	Washer, plain, front wheel spindle, left side	1	1½

REAR WHEEL

The complete wheel listed below comprises:—Rim, spokes, nipples, hub, grease nipple and all bearings assembled, but does NOT include the centre solid spindle, washers, spacers, nuts, brake parts, sprocket and brake drum, speedometer drive and tyre.

021995	Wheel, rear, with all fittings, chrome rim, black centre	1	9 5 1
--------	--	---	-------

The bare wheel listed below comprises:—

Rim, spokes, nipples and hub.			
021999	Wheel, rear, bare, chrome, black centre	1	6 17 9
021814	Rim, rear, chrome, black centre (A.M.C. 24)	1	1 14 9
021691	Spoke, rear, left or right, 8½ ins. by 7 G. by 9 G.	40	2
021693	Nipple, rear, left or right, .250 in. by 9 G.	40	2
021580	Hub, rear wheel, shell only	1	4 9 2
021582	Disc for right hand side of hub	1	6 3
000051	Nipple, grease, for rear wheel hub	1	6
011090	Tape, for 19 ins. rear rim	1	1 9

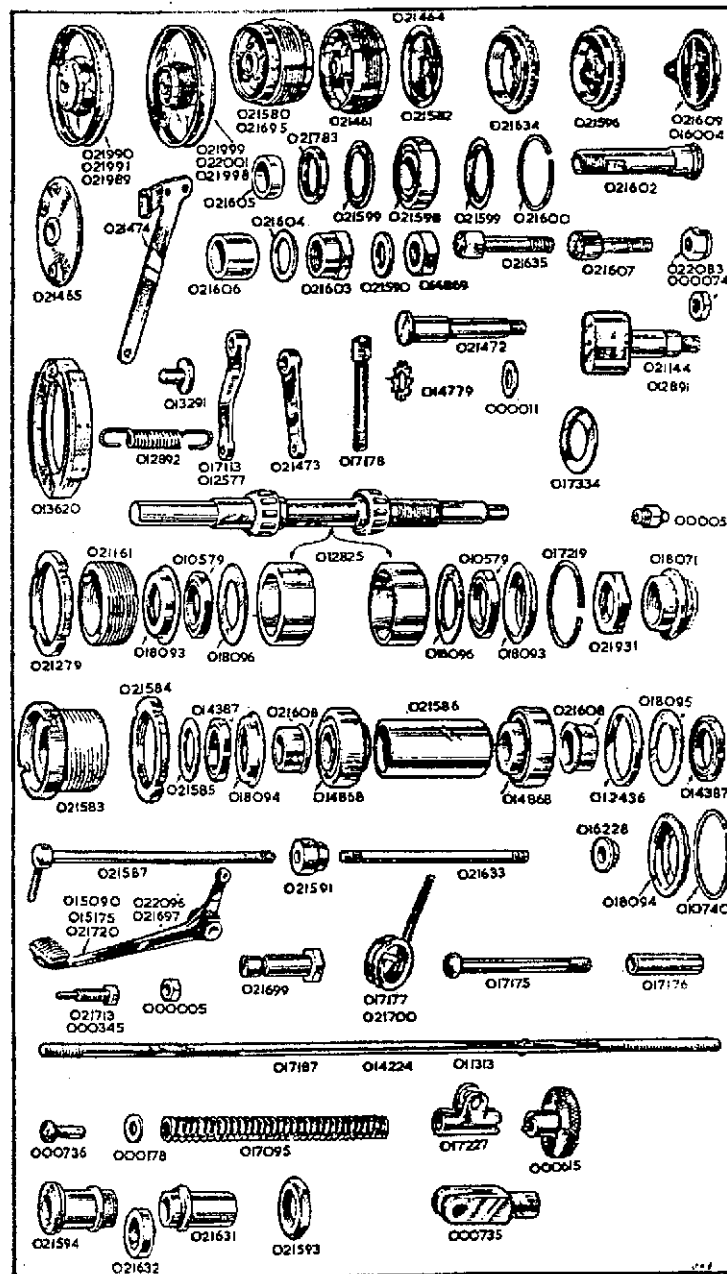

PART NUMBER	DESCRIPTION	QTY. OFF	PRICE EACH £ s. d.
REAR WHEEL BEARINGS			
014868	Bearings, roller, for rear hub (only sold as a complete bearing)	2	14 10
014387	Oil-seal, for rear hub bearings	2	5
010740	Ring, spring, locating rear hub bearings	1	4
018094	Cup, for rear hub bearing oil-seal	2	5
021585	Ring, retaining, rear hub bearing oil-seals (small)	1	1
018095	Ring, retaining, rear hub bearing oil-seals (large)	2	1 1/2
012436	Collar, spacing, between bearing and rear hub bearing oil-seal	1	11
021586	Spacer, 2 7/8 ins. long between the two bearings of rear hub	1	3 3
021583	Ring, adjusting, for rear hub bearing	1	3 9
021584	Nut, lock, for rear hub bearing adjusting ring	1	1 5
021587	Spindle, centre, solid, for rear wheel	1	18 0
021608	Spacer, on rear wheel solid spindle, for oil seals	1	1 7
021594	Spacer on rear wheel spindle for speedo gear box	1	1 3
021590	Washer, for solid spindle	1	4
021593	Nut, locking, speedometer gearbox	1	8 1/2
014704	Sleeve, on rear wheel solid spindle, locating brake cover plate	1	3 11
021591	Spacer, on rear wheel solid spindle (abuts against fork end) speedo side	1	9
014869	Nut, for rear wheel solid spindle	1	7 1/2

FRONT BRAKE

021744	Drum, front brake (must be fitted at works)	1	—
021766	Screw, fixing front brake drum to hub shell	5	1 1
011846	Lock nut for brake drum screw	5	4
021465	Plate, cover, front brake	1	8 9
021474	Stay, front brake cover plate anchor	1	14 7
014807	Bolt, fixing anchor stay to front cover plate, 5/8 in. by 3/4 in. by 26	1	4
014119	Washer, special, for anchor stay bolt	1	1 1/2
021472	Pin, fulcrum, for brake shoes	1	1 1
000010	Washer, plain (inner for pin)	1	1 1/2
000011	Washer, plain (outer for pin)	1	1 1/2
000004	Nut, for brake fulcrum pin	1	4
013620	Shoes, pair of, for front brake, with brake linings and thrust pins (only supplied in pairs)	1	4 7
013291	Pin, thrust, brake expander adjusting	2	11
000174	Washer, plain, for thrust pin	R	1 1/2
010440	Linings, brake, per pair of, less rivets	1	4 10
000113	Rivets, for brake linings, per set of	12	3
012892	Spring, for brake shoes	2	5
021144	Expander, for brake shoes	1	4 11
017334	Washer, packing, for expander bush	1	7 1/2
021473	Lever, for front brake shoe expander	1	8 6
000051	Nipple, grease, for brake shoe expander	1	6
000174	Washer, plain, for brake shoe expander	1	1 1/2
000004	Nut, for brake shoe expander	1	4

REAR BRAKE

021596	Sprocket and brake drum, for rear wheel, 42 teeth	1	2 5 0
021607	Pin, driving in hub	5	1 1
022083	Nut, for driving pin	5	4
021609	Plate, cover, rear brake	1	10 3
021606	Spacer, for brake cover plate (outer)	1	1 2
021605	Spacer, for brake cover plate (inner)	1	1 4
021598	Bearing, ball for brake drum	1	17 5
021599	Washer, for brake drum bearing	2	2
021600	Circlip, for brake drum bearing	1	3
021783	Oil seal, for brake drum bearing	1	3 1
021602	Dummy spindle, for bearing	1	5 6
021603	Nut, for dummy spindle	1	1 3
021604	Washer, for dummy spindle	1	3
013620	Shoes, pair of, for rear brake, with brake linings and thrust pins (only supplied in pairs)	1	4 7
013291	Pin, thrust, brake, expander adjusting	2	11
000174	Washer, plain, for thrust pin	R	1 1/2
010440	Linings, brake, per pair of, less rivets	1	4 10

PART NUMBER	DESCRIPTION	QTY. OFF	PRICE EACH £ s. d.
REAR BRAKE—continued.			
000113	Rivets, for brake linings	per set of 12	3
012892	Spring, for brake shoes	2	5
012891	Expander, for brake shoes	1	4 11
017113	Lever, for rear brake shoe expander	1	3 0
000051	Nipple, grease, for brake shoe expander	1	6
000174	Washer, plain, for brake shoe expander	1	1 1/2
000004	Nut, for brake shoe expander	1	4

REAR BRAKE OPERATING PARTS

021697	Pedal, foot, for rear brake	1	17 7
021699	Fulcrum, for rear brake foot pedal	1	2 1
000051	Nipple, grease, for rear brake foot pedal	1	6
021700	Spring, return, rear brake foot pedal	1	1 0
021713	Bolt, adjusting, rear brake foot pedal	1	8
000005	Nut, for rear brake, foot pedal adjusting bolt	1	4
011313	Rod, bare, rear brake	1	2 1
000735	End, yoke, for front end of brake rod	1	7 1/2
000736	Pin, for brake rod yoke end	1	5
000014	Pin, split, for brake rod yoke end pin	1	1 1/2
017095	Spring, for brake rod	1	5
000178	Collar, for brake rod, spring	1	1 1/2
017227	Clip, adjusting, for rear end of brake rod	1	2 11
000736	Pin, for brake rod adjusting clip	1	5
000014	Pin, split, for brake rod adjusting clip pin	1	1 1/2
000615	Nut, adjusting, for rear brake rod	1	3 5

VOLTAGE REGULATOR

015087	Regulator, complete unit, type MCR2 (Lucas No. 37097-B)	1	2 4 0
000342	Bolt, fixing regulator unit 1 1/4 in. by 1/2 in. by 26	2	4
000012	Washer, plain, for regulator fixing bolt	4	1 1/2
018160	Nut, for regulator fixing bolt	2	4

BATTERY

4080157	Battery, with lid, dry and uncharged. This is a battery that has NOT been filled with electrolyte (acid) and is, of course, not charged. It requires no special packing, and can safely be packed with other goods. (Lucas No. PU7E/9). (We do not supply charged batteries—for such apply to nearest Lucas Service Station)	1	2 2 6
4159062	Lid, only, with rubber pads, for battery	1	2 3

HEAD LAMP

021802	Lamp, head, type 51655A with bulb, ammeter, switch, no cable harness (not Europe)	1	5 2 6
021803	Lamp, head, type 51655A with bulb, ammeter, switch, no cable harness (Europe except France)	1	5 2 6
021804	Lamp, head, type 51655A with ammeter, switch, less bulb and cable harness (France only)	1	5 2 6
516951	Shell only, top half, for head lamp, type 51655A	1	★
516952	Shell only, bottom half, for head lamp, type 51655A	1	★
553248	Rim, bare, for head lamp	1	12 6
553925	Light unit, reflector and glass (all except Europe)	1	14 6
553948	Light unit, reflector and glass (Europe except France)	1	14 6
553940	Light unit, reflector and glass (France only)	1	14 6
555005	Adaptor (bulb holder) all except France	1	3 9

★ Price on application.

See ELECTRICAL SUNDRIES for Ammeter, Switch, Cable Harness and Bulbs.

SIDE LAMP

52224	Side lamp, complete	2	12 6
516719	Rubber grommet, for side lamp	2	1 0
573615	Lens for side lamp	2	1 6
573646	Rim and bead for side lamp	2	2 0

REAR LAMP (early models)

018760	Lamp, rear (Lucas 525 No. 53269-A)	1	2	6
573819	Window cover, red, for rear lamp	1	7	0
573814	Rubber gasket, for rear lamp	1	6	6
572072	Screw, retaining lamp window cover	2	4	4
166014	Nut, retaining body to rear number plate	2	1	1
188330	Spring washer, for body to rear number plate	2	3	0
860428	Rear lamp cables, with contact disc	1	3	0
573825	Rubber cap, covering cable entry	1	6	6

REAR LAMP WITH INTEGRAL REFLECTOR (later models)

022126	Rear lamp complete (Lucas LS64)	1	2	6
573839	Window cover, red for rear lamp	1	5	6
575200	Window cover, white for rear lamp	1	3	0
575208	Rubber gasket, for window cover	1	1	0
552928	Screw, retaining window cover	2	5	5
575207	Grommet, rubber for bulb holder	1	9	9
575209	Bulb holder	1	1	6
860428	Rear lamp wires, with Paxolin washer	1	3	0
573825	Rubber cap, covering cable entry	1	6	6
166014	Nut, retaining body to rear number plate	2	1	1
188330	Spring washer for fixing nut	2	3	0

STOP LIGHT PARTS (Optional Extra)

022031	Stop light switch	1	7	6
018727	Pull off, spring for switch	1	11	11
022032	Bracket, for switch	1	6	4
018764	Clip, for pull off spring	3	4	6
000738	Screw, securing switch and spring clip	3	4	1
000739	Nut, for screw switch and spring clip	1	4	1
000039	Washer, for spring clip screw	2	2	1
018220	Extra rubber cable clip	1	2	1
011908	Extra rubber cable clip	2	2	4
014453	Metal cable clip	1	1	9
022085	Cable (switch to lamp and battery) pair complete	1	2	1
900269	Snap connector	1	15	0
022002	Complete kit of parts for stop light conversion	1	15	0

HORN

015257	Horn, type HF 1234, with bracket. Lucas replacement number is 069225, but hole in bracket must be opened out to $\frac{1}{2}$ in. diameter	1	1	19
015245	Bracket, only, for horn (see note above re opening out hole)	1	3	3
000376	Horn, bolt	1	7	1
000192	Horn, bolt washer	1	4	4
000004	Horn, bolt nut	2	2	1
015706	Horn, rubber washer	2	7	1
021136	Horn, steel washer	2	4	4
021138	Horn, rubber sleeve	1	4	1
021137	Horn, steel sleeve	1	2	1

ELECTRICAL SUNDRIES

36084	Ammeter, for head lamp panel	1	8	9
351551	Switch, main lighting, for head lamp panel	1	11	6
351567	Handle, with screw, for main lighting switch	1	1	6
021301	Switch, dipping, for handlebar	1	6	6
380459	Rubber packing, for dipping switch	1	9	9
021299	Screw, fixing switch, $\frac{3}{8}$ in. by 4 BA	2	3	3
016427	Switch, horn, for handlebar (Lucas No. 76209)	1	3	9
997801	Cable harness, main lighting (no dip switch wire, no horn wire, no regulator wires)	1	15	0
858795	Cable harness, triple, for dipping switch	1	4	0
989981	Cable harness, for regulator	1	6	0
359218	Cable, for horn	1	1	0
016681	Sheath, for horn cable	1	6	6
016682	Sheath, for dynamo cable	1	4	4
000543	Cable, high tension, for sparking plug, price per foot	R	1	0
000541	Terminal, for high tension cable	2	4	4
900269	Connector, snap, for rear lamp cable	1	2	2
900269	Connector, snap, for regulator to ammeter cable	1	4	4
011094	Bush, rubber, fits in rear mudguard, for rear lamp cable	1	4	4
312	Bulb, head lamp, main, 6 volt, 30 by 24 watts. (not Europe)	1	5	6
	Plus Purchase Tax		1	3
988	Bulb, head lamp, pilot, 6 volt, 3 watts	2	1	6
	Plus Purchase Tax		4	4
384	Bulb, rear lamp, 6 volt, 18 and 5 watts (European models)	1	3	0
	Plus Purchase Tax		5	0
015538	Plug, sparking, KLG, type FE-80	2	5	0
021310	Cover for dynamo terminals	1	1	0

CABLE CLIPS

011907	Clip, rubber, $1\frac{1}{2}$ in.	4	2	1
011908	Clip, rubber, 3 ins.	3	2	1
018220	Clip, rubber, $4\frac{1}{2}$ ins.	5	2	1
014453	Clip, metal, holding rear lamp wire inside mudguard	1	4	4

SPEEDOMETER

022006	Speedometer complete, trip, 120 M.P.H.	1	5	0
022010	Speedometer complete, trip, 180 K.P.H.	1	5	0
021793	Head, only, speedometer, trip, 120 M.P.H.	1	3	10
021795	Head, only, speedometer, trip, 180 K.P.H.	1	3	10
022057	Bracket, retaining speedometer head	1	3	0
021798	Grommet, rubber for speedometer head in lamp	1	1	0
021799	Grommet, rubber for speedometer cable in fork crown	1	5	5
54279-1	Set of bulb holding parts for head	1	5	0
53205	Bulb, 6 volts, 1-8 watts, M.B.C. for head	1	1	6
	Plus Purchase Tax		4	4
N-1253	Nut, fixing speedometer head to lamp	2	2	1
W-7216	Washer, spring, speedometer bracket nut	2	1	1
53395-1-65	Cable, speedometer drive, complete	1	1	2
52108-1-65	Cable, speedometer drive, inner only	1	1	3
53398-1-65	Cable, speedometer drive, outer only	1	1	3
52283-5	Gearbox, speedometer, complete	1	2	2
021454	Washer, outside speedometer gear box	1	1	1

VARIOUS EQUIPMENT

018691	Bar, locking, for fork crown	1	1	6
016344	Set of Pannier bags, with frames and fixing bolts, washers and nuts	1	6	6
	Plus Purchase Tax		1	7
011957	"TEKALL" Rust preventative $\frac{3}{4}$ pint	R	2	0
011958	"TEKALL" Rust preventative 1 pint	R	3	0
	Instruction Manual	R	2	6
B-A-H	Badge, monogram, A-J-S, for button hole	R	1	6
B-A-T	Badge, monogram, A-J-S, for tie	R	1	6
B-A-B	Badge, monogram, A-J-S, for brooch fixing	R	1	6

COMPLETE TOOL KITS

022107	Tool kit, complete, with tyre inflator	1	3	3
022108	Tool kit, complete, less tyre inflator	1	2	14

The following comprise "TOOL KIT, COMPLETE, WITH TYRE INFLATOR," and is included as part of every motor cycle.

TOOLS

017253	Bag for tools	1	4	11
021625	Screwdriver	1	1	0
017248	Pliers, side cutting	1	4	7
011188	Pliers, for gudgeon pin circlips	1	1	11
017246	Gun, grease	1	7	4
017114	Inflator, tyre	1	9	0
017007	Lever, tyre	2	1	3
017052	Spanner, double end, $\frac{7}{8}$ in. by $\frac{1}{2}$ in.	1	2	11
017053	Spanner, double end, $\frac{7}{8}$ in. by $\frac{3}{4}$ in.	1	4	5
018178	Spanner, double end, 1-011 in. by 1-2 in.	1	1	10
017257	Spanner, double end, $\frac{7}{8}$ in. by $\frac{3}{4}$ in.	1	1	7
017252	Spanner, box, with tommy, for sparking plug	1	1	11
017249	Wrench, adjustable	1	10	10
015023	Spanner, double end, with gauge, for contacts (Lucas No. 415116)	1	7	7
015264	Spanner, single end, for rocker clamping bolts	1	5	5
015213	Spanner, box, for cylinder head nuts	1	2	0
017254	Spanner, clutch spring adjustment	1	1	0
018055	Key, for handlebar clip screws and rocker cap screws	1	8	1
018667	Key, for fork tube pinch screw	1	1	10
000174	Washer, for brake shoe thrust pin	B	1	1

SPECIAL TOOLS

011381	Holder, valve, for valve grinding	1	1	0
015273	Extractor, for timing pinion and magneto gear	1	5	5
015374	Extractor, for camshaft gears	1	5	5
022011	Disc, timing (see Instruction Manual)	1	4	2

The above tools are NOT INCLUDED in the equipment of a new motor cycle.