

Amalgamated Carburettors Ltd.

AMAC **1923 - 1928**

BINKS **1923 - 1928**

B & B **1923 - 1928**

AMAL **1929 - 1930**

Amac Carburetters, 1923 and 1924.

The following are the various models manufactured during the above period.

- 1—H.Y.S.P. Sporting model with tube air intake and bottom feed float chamber.
- 2—H.X.S.P. Sporting model with tube air intake and top feed float chamber.
These models were made in four different sizes or types—namely type 30, type 25, type 15, and type 10.
- 3—H.Y.D.M. Touring model with mushroom air intake and bottom feed float chamber.
(Type 30 is fitted with air cap instead of mushroom—See illustration.)
- 4—H.X.D.M. Touring model with mushroom air intake and top feed float chamber.
(Type 30 is fitted with air cap instead of mushroom—See illustration.)

These models were made in three different sizes or types—namely type 30, type 25, and type 15.

In addition to the standard model carburetters there was a special carburetter made for Douglas "CW" machines. This is known as the model "T. 30. V.D."—see illustration and specification on page 7.

To ascertain the size or type or your carburetter measure the outside diameter of your throttle valve.

Outside diameter of throttle valve	...	1"	...	type 30
"	"	1 1/8"	...	" 25
"	"	1 1/4"	...	" 15
"	"	1 1/2"	...	" 10

To ascertain the part number of the spare part required look under the spare parts list on page 4 under the column headed with the type number for which it is required.

Please note when ordering mixing chambers it is most desirable to send in to us your old chamber as pattern owing to the bore sizes varying for different makers engines.

Spare Parts for Float Chambers.

The specification for these will be found on page 6 and you will be able to ascertain the component number by referring to the column headed with the corresponding model number of your carburetter.

CONTROL LEVERS.

The standard control for 1923 was the pattern type "30 H.D." the illustration and specification for which is on page 8 and 9.

1924 standard control model "K" the illustration and specification for which is on page 9.

TWIST GRIP CONTROL.

The standard twist grip control made for 1924 is known as the 1924 T.T. model the illustration and specification for which is on page 9.

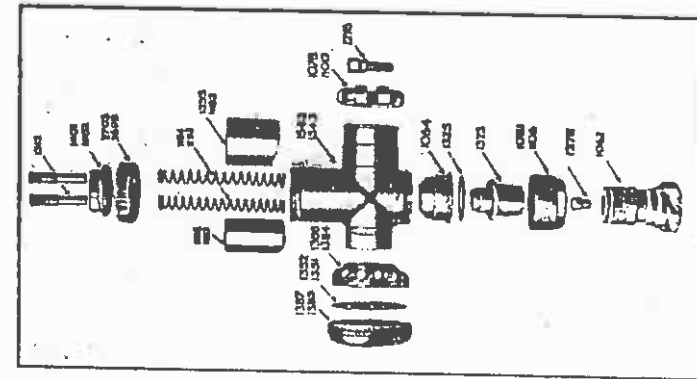

Types 1001, 1002, 1003, 1004, 1005, 1006, 1007, 1008, 1009, 1010, 1011, 1012, 1013, 1014, 1015, 1016, 1017, 1018, 1019, 1020, 1021, 1022, 1023, 1024, 1025, 1026, 1027, 1028, 1029, 1030, 1031, 1032, 1033, 1034, 1035, 1036, 1037, 1038, 1039, 1040, 1041, 1042, 1043, 1044, 1045, 1046, 1047, 1048, 1049, 1050, 1051, 1052, 1053, 1054, 1055, 1056, 1057, 1058, 1059, 1060, 1061, 1062, 1063, 1064, 1065, 1066, 1067, 1068, 1069, 1070, 1071, 1072, 1073, 1074, 1075, 1076, 1077, 1078, 1079, 1080, 1081, 1082, 1083, 1084, 1085, 1086, 1087, 1088, 1089, 1090, 1091, 1092, 1093, 1094, 1095, 1096, 1097, 1098, 1099, 1100

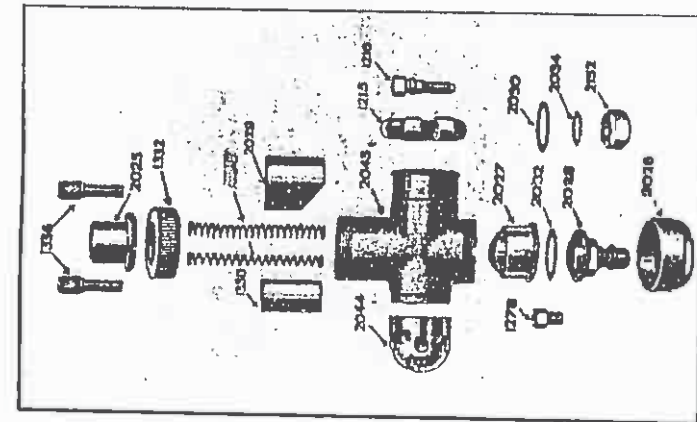

Types 2001, 2002, 2003, 2004, 2005, 2006, 2007, 2008, 2009, 2010, 2011, 2012, 2013, 2014, 2015, 2016, 2017, 2018, 2019, 2020, 2021, 2022, 2023, 2024, 2025, 2026, 2027, 2028, 2029, 2030, 2031, 2032, 2033, 2034, 2035, 2036, 2037, 2038, 2039, 2040, 2041, 2042, 2043, 2044, 2045, 2046, 2047, 2048, 2049, 2050, 2051, 2052, 2053, 2054, 2055, 2056, 2057, 2058, 2059, 2060, 2061, 2062, 2063, 2064, 2065, 2066, 2067, 2068, 2069, 2070, 2071, 2072, 2073, 2074, 2075, 2076, 2077, 2078, 2079, 2080, 2081, 2082, 2083, 2084, 2085, 2086, 2087, 2088, 2089, 2090, 2091, 2092, 2093, 2094, 2095, 2096, 2097, 2098, 2099, 2100

Amal Carburetter, 1923-4

SPECIFICATION OF MIXING CHAMBER PARTS.

COMPONENTS.	T 30	T 25	T 15	Price	T 10	Price
	HXDM. T 30 HYDM.	HXDM. T 25 HYDM.	HXDM. T 15 HYDM.		HY.SP. T 10 HX.SP.	
Mixing Chamber	2045	1543	1542	s. d. 8 8	1680	s. d. 12 6
Mixing Chamber Cap	1332	2099	2703	1 9	1719	2 2
Mixing Chamber Top	2025	1402	1401	1 9	1055	2 2
Mixing Chamber Union Nut	2020	1100	1061	1 6	1062	1 11
Mixing Chamber Key	2031	1391	1390	5	1061	2
Mixing Chamber Key Rivets	3073	3073	3073	1	3073	1
Cable Adjuster...	1330	1315	1315	4	1315	4
Sprayer Top Half	2027	1004	1064	3 0	1061	3 10
Sprayer Bottom Half	—	1323	1323	2 1	1323	2 7
Jet Holder	2028	1062	1062	1 9	1062	1 9
Jet Holder Nut	2152	—	—	3	—	—
Jet	1278	1278	1278	5	1278	5
Throttle Valve	2029	1303	1182	3 10	1663	4 3
Air Valve	1330	1102	1183	3 0	1064	3 5
Float Chamber Lug Washer	2034	—	—	2	—	2
Top Washer for Float Chamber Lug	2030	—	—	2	—	2
Valve Springs	1335	1193	1184	3	1184	3
Sprayer Washer	2032	1325	1325	2	1325	2
Peg for Sprayer	1079	1079	1079	2	1079	2
Outlet Clip	1215	1100	1070	1 9	1721	2 2
Outlet Clip Pin	1216	1216	1216	1 9	1216	1 8
Air Inlet Cap	2044	—	—	1 9	—	—
Small Copper Washer	—	2816	2816	2	2816	2
Large Copper Washer	—	2807	2867	2	2867	2
Air Intake	—	1386	1384	1 9	—	—
Air Intake Cover	—	1387	1385	1 9	—	—
Air Intake Gauze	—	1352	1351	1 10	—	—
Air Tube	1507	1507	1425	2 6	1772	3 0

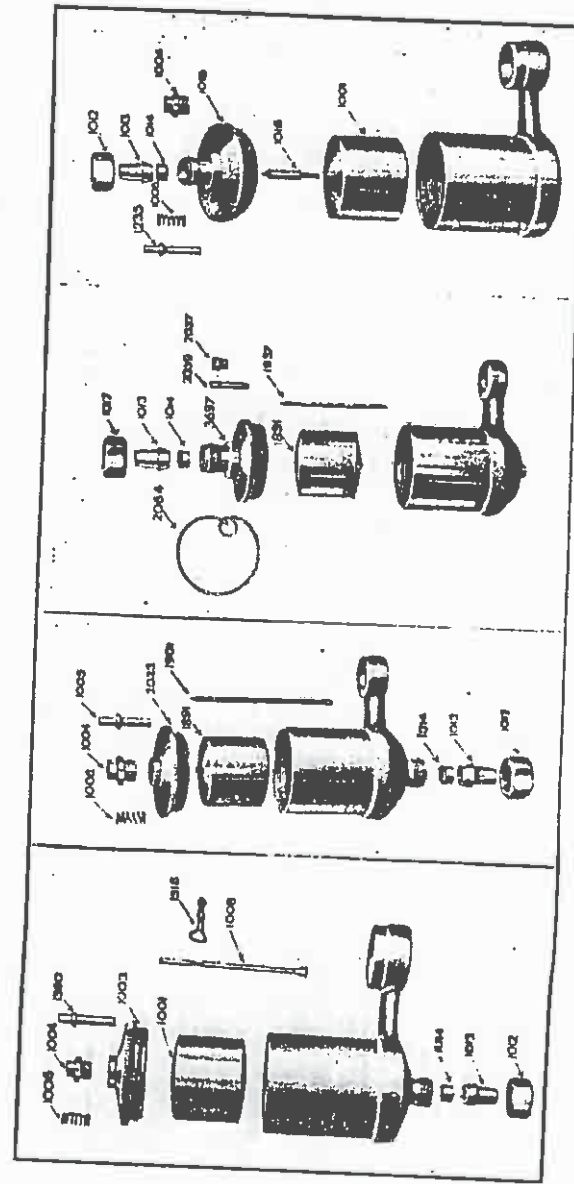

TYPES	Types	Types	Types
15HYDM, 25HYDM 15HYSP, 25HYSP	15HXDM, 25HXDM 15HXSP, 15HXSP, 10HXSP	30HXDM, 30HXSP	15PJX, 25PJX
15MYDM, 25MYDM 25MYSP, 15MYSP, 10MYSP	30HXDM, 30HXSP	30HXDM, 30HXSP	25MXDM, T15MXDM 25MXSP, 15MXSP, 10MXSP
15PJY, 25PJY	T30PJX	30PJY	15PJX, 25PJX

Amcar Carburettor

SPECIFICATION OF FLOAT CHAMBER PARTS. (1923 and 4).

COMPONENTS.	T 30	T 30	T 25	T 25	T 25	T 25	Price
	HYDM.	HXDM.	HYDM.	HXDM.	HYSP.	HXSP.	
Float Chamber Cover only ...	2033	3607	1003	1016	1003	1016	s. d. 2 11
Float Chamber Cover Complete ...	2033	3607	1003	1016	1003	1016	4 3
Float ...	1801	1891	1001	1001	1001	1001	2 6
Tickler Body ...	1004	2057	1004	1004	1004	1004	2 7
Tickler ...	1008	2050	1005	1235	1360	1235	7 7
Tickler Spring ...	1006	2084	1006	1008	1008	1008	7 2
Needle Valve ...	1901	1937	1007	1018	1008	1018	11 11
Needle Clip ...	—	—	1516	—	1516	—	3 3
Petrol Union Nut ...	1012	1012	1012	1012	1012	1012	6 6
Petrol Union Nipple ...	1013	1013	1013	1013	1013	1013	3 3
Petrol Filter ...	1014	1014	1014	1014	1014	1014	5 5
Float Chamber Body only ...	—	—	1350	1002	1350	1002	12 0
Float Chamber Body only ...	2030 2037	2058 2037	—	—	—	—	8 0 8 0

Float Chamber Complete for type 30 Carburettors 17/-. for other types 23/-
When ordering use same No. as for float chamber only state complete.

SPECIFICATION OF FLOAT CHAMBER PARTS (1925).

COMPONENTS.	T 30	T 30	T 25	T 25	T 25	T 25	Price
	HYDM.	HXDM.	MYDM.	MXDM.	MYSP.	MXSP.	
Float Chamber Cover only ...	2033	3697	1003	1016	1003	1016	s. d. 2 11
Float Chamber Cover Complete ...	2033	3697	1003	1016	1003	1016	4 3
Float ...	1891	1891	1001	1001	1001	1001	2 6
Tickler Body ...	1004	2057	1004	1004	1004	1004	2 7
Tickler ...	1008	2059	1005	1235	1360	1235	7 7
Tickler Spring ...	1006	2084	1006	1006	1008	1008	7 2
Needle Valve ...	1901	1937	1007	1018	1018	1018	11 11
Needle Clip ...	—	—	1516	—	1516	—	3 3
Petrol Union Nut ...	1012	1012	1012	1012	1012	1012	6 6
Petrol Union Nipple ...	1013	1013	1013	1013	1013	1013	3 3
Petrol Filter ...	1014	1014	1014	1014	1014	1014	5 5
Float Chamber Body only ...	—	—	1359	1002	1350	1002	12 0
Float Chamber Body only ...	2030 2037	2058 2037	L.S.M.	L.S.M.	L.S.M.	L.S.M.	8 0

Float Chamber Complete for type 30 Carburettors 17/-. for other types 23/-
When ordering use same No. as for float chamber only state complete.

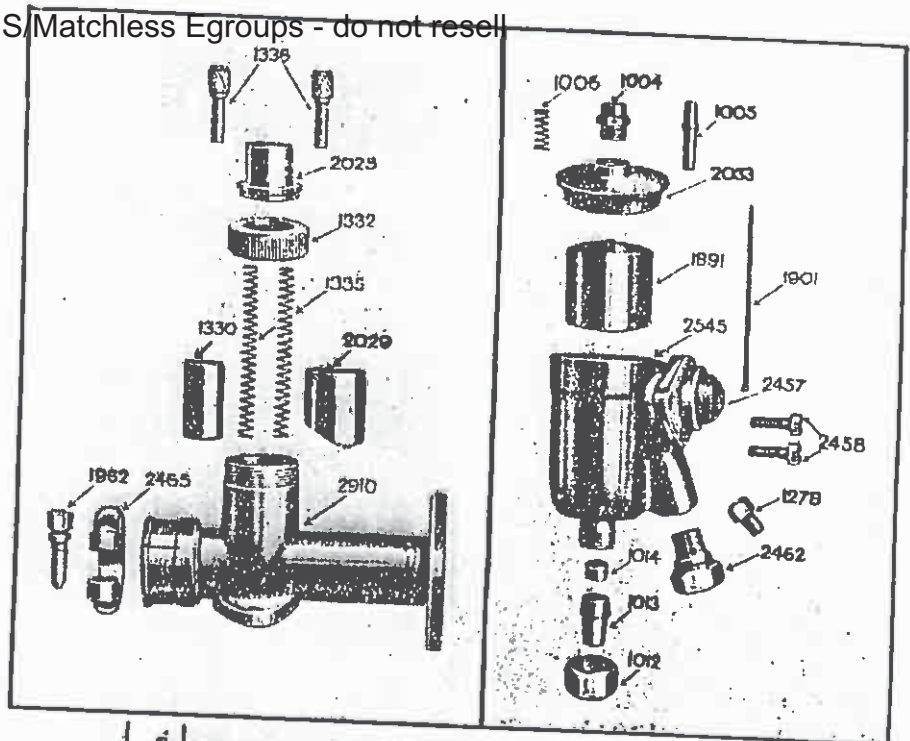

SPECIFICATION FOR T30 'VD. CARBURETTER.
(Special for Douglas "CW" Machines)

COMPONENT.	Detail No.	Price.	
		s. d.	8 6
Float Chamber only ...	2545	8	6
Float Chamber Cover Complete ...	2033 Etc.	4	2
Float ...	1891	6	3
Petrol Union Nut ...	1012	6	6
Petrol Union Nipple ...	1013	3	5
Petrol Gauze ...	1901	11	7
Needle ...	1004	7	2
Tickler Body ...	1005	8	8
Tickler Spring ...	1006	1	1
Mixing Chamber ...	2910	9	9
Mixing Chamber Cap ...	1332	0	0
Mixing Chamber Top ...	2025	3	3
Cable Adjusters ...	1336	0	0
Mixing Chamber Screws ...	2458	4	3
Mixing Chamber Fibre Washers (Flange) for ...	—	3	0
Float Chamber ...	2459	3	0
Sprayer (for illustration see Float Chamber) ...	2457	1	9
Jet Holder ...	2462	3	0
Jet ...	1278	1	5
Throttle Valve ...	2029	3	0
Air Valve ...	1330	3	0
Valve Springs ...	1336	3	3
Mixing Chamber Key ...	2031	7	3
Peg for Sprayer ...	2464	3	3
Outlet Clip ...	2465	1	8
Outlet Clip Screw ...	1982	0	0

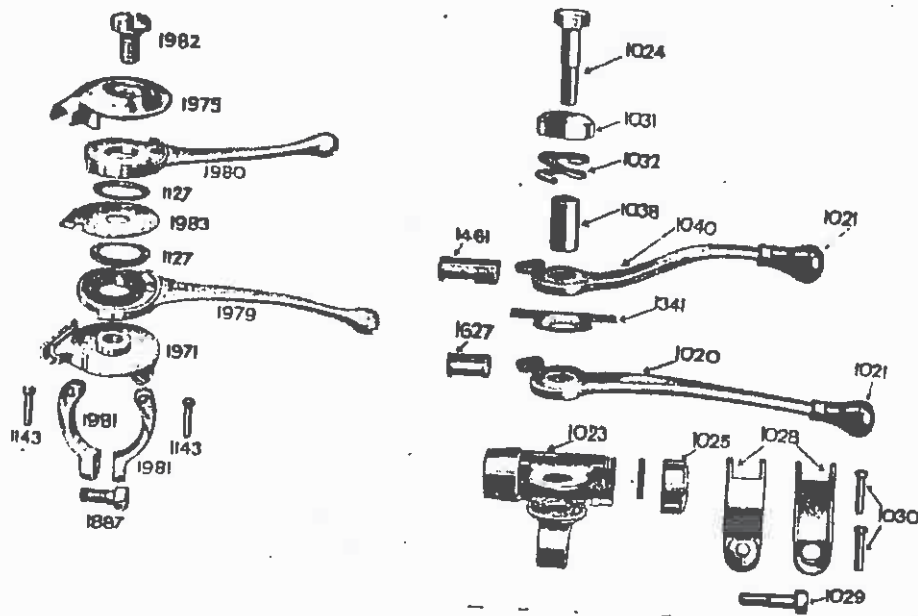

K CONTROL

T30 HD CONTROL

1923-4 "K" CONTROL.

COMPONENT.	Double Lever Open In	Double Lever Open out	Single Lever Open In	Single Lever Open out	Price.
Control Lever Throttle	1979	2200	—	—	s. d.
Control Lever Air	1980	2201	—	—	2 0
Control Cap	1975	1975	1997	1997	1 0
Control Clip Half	1981	1981	1981	1981	0
Control Bolt	1982	1982	1998	1998	3
Control Division Plate	1143	1143	1143	1143	2
Control Body only	1983	1983	—	—	5
Control Clip Screw	1971	2006	2008	2008	1 10
Cable Ferrule	1887	1887	1887	1887	3
Cable Nipple	1302	1302	1302	1302	2
Control Spring Washer	1465	1465	1465	1465	2
	1127	1127	1127	1127	

COMPONENT.	Detail No.	Price.
Bracket ...	1023	s. d.
Control Cable End	1337	3 6
Spring Washer	1032	10
Division Plate	1341	2
Throttle Lever	1020	5
Air Lever	1340	2 6
Handle Bar Clip	1028	6
Control Cap	1031	5
Control Clip Screw	1020	3
Slide for Throttle	1627	3
Slide for Air	1401	3
Slotted Cap	1026	3
Bracket Pin	1024	5
Ebonite Tip	1021	3
Control Bush	1021	5
Clip Rivet...	1035	2
	1030	2

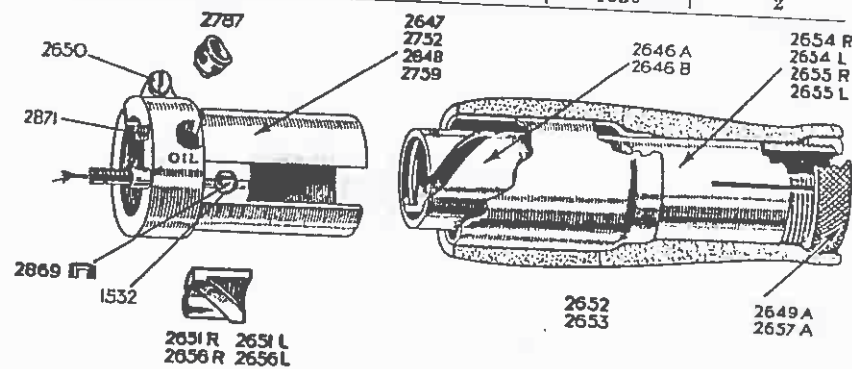

SPECIFICATION OF TWIST GRIP 1924 TT.

COMPONENT.	1" BAR		3/4" BAR.		Price
	RH.	LH.	RH.	LH.	
Slide Body	2647	2768	2648	2769	s. d.
T/Grip Cup	2646	2646	2646	2646	3 0
Slide	2651R	2651L	2650R	2650L	3
Body Clip Screw	2650	2650	2650	2650	6
Friction Nut	2649A	2649A	2657A	2657A	3
Rubber Grip	2652	2652	2653	2653	1 9
Steel Tube	2654R	2654L	2655R	2655L	1 0
Cable Nipple	1532	1532	1532	1532	1 0
Cable Nipple Cover	2869	2869	2869	2869	2
Twist Grip Stop	2787	2787	2787	2787	6
Twist Grip Stop Screw	2871	2871	2971	2871	3
Dummy Grip	2661	2661	2691	2691	2
Dummy Grip End Cap	2704	2704	2705	2705	1 6
					4

The following are the various models manufactured during the above period.

- 1 Type 30 H.Y.D.M.
 Type 30 H.X.D.M.
 Type 30 H.Y.S.P.
 Type 30 H.X.S.P.
- 2 M.Y.D.M. Touring model with mushroom air intake and bottom feed float chamber.
- 3 M.X.D.M. Touring model with mushroom air intake and top feed float chamber.
- 4 M.Y.S.P. Sporting model with tube air intake and bottom feed float chamber.
- 5 M.X.S.P. Sporting model with tube air intake and top feed float chamber.

These are exactly as supplied in 1923 and 4, for illustrations and details, etc., see page 3.

These models were made in three different sizes or types—namely type 25, type 15, and type 10.

To ascertain the type of your carburetor measure the diameter of your throttle valve.

Outside diameter of throttle valve	1"	Type	25
"	1 1/4"	"	15
"	1 1/2"	"	10

To ascertain the part number of the spare part required look under the spare parts list on page 11 under the column headed with the type number for which it is required.

For illustration of parts refer to page 3 the parts of which with the exception of the jet holder assembly are identical.

Please note when ordering mixing chambers it is most desirable to send in to us your old mixing chamber as pattern owing to the bore sizes varying for different makers' engines, if inconvenient to do this send fullest particulars possible.

SPARE PARTS FOR FLOAT CHAMBERS.

The illustrations for these will be found on page 6.

To ascertain the component number refer to page 6 and the column headed with the corresponding model number of your carburetor.

SPARE PARTS FOR CONTROL LEVERS.

The standard control for 1925 is the pattern "M" for illustration and specification refer to page 12.

SPARE PARTS FOR TWIST GRIP CONTROL.

The standard twist grip for 1925 was exactly the same as for 1924—see illustration and specification on page 9.

T.T. CARBURETTERS.

In addition to the aforementioned standard models there was a T.T. model known as the T.T. 25. Particulars for details, etc., of these refer to the Section—"AMAC T.T. CARBURETTERS."

SPECIFICATION OF MIXING CHAMBER—1925.

COMPONENT.	T 30 HXSP. T 30 HYSP. T 30 HXDM. T 30 HYDM.	T 25 MXSP. T 25 MYSP. T 25 MXDM. T 25 MYDM.	T 15 MXSP. T 15 MYSP. T 15 MXDM. T 15 MYDM.	Price	T 10 MXSP. T 10 MYSP	Price
	Mixing Chamber	2045	1543		1542	
Air Intake	—	1386	1384	1 9	—	—
Air Intake Cover	—	1387	1185	1 0	—	—
Air Intake Gauze	—	1352	1351	10	—	—
Air Valve	1330	1192	1183	3 0	1654	3 5
Throttle Valve	2029	1303	1182	3 10	1663	4 3
Valve Springs	1335	1183	1184	3	1184	3
Mixing Chamber Cap	1332	2699	2703	1 0	1655	2 2
Mixing Chamber Top	2026	2402	1401	1 0	1719	2 2
Mixing Chamber Union Nut	2026	1106	1061	1 6	1652	1 11
Cable Adjuster	1336	1316	1315	4	1315	4
Sprayer Top Half	2027	1064	1064	3 0	1661	3 10
Sprayer Washers	2032	1325	1325	2	1325	2
Sprayer Bottom Half	—	1323	1323	2 1	1323	2 7
Jet	1278	1278	1278	5	1278	5
Jet Holder	2028	2814	2814	1 9	2814	1 9
Jet Holder Nut	2152	2815	2815	3	2815	3
Outlet Clip	1215	1100	1076	1 9	1721	2 2
Outlet Clip Pin	1216	1216	1210	6	1216	6
Float Chamber Lug Washer	2034	—	—	2	—	—
Air Inlet Cap	2044	—	—	1 9	—	—
Air Tube	1507	1507	1425	2 6	1772	3 0
Peg for Sprayer	1079	1079	1079	3	1079	3
M/Chamber Key	2031	1391	1390	5	1651	5
M/Chamber Key Rivet	3973	3973	3973	1	3973	1
Top Washer for Float Lug	2030	—	—	2	—	—
Small Copper Washer	—	2816	2816	2	2816	2
Large Copper Washer	—	2867	2867	2	2867	2

Amac Carburetters, 1925

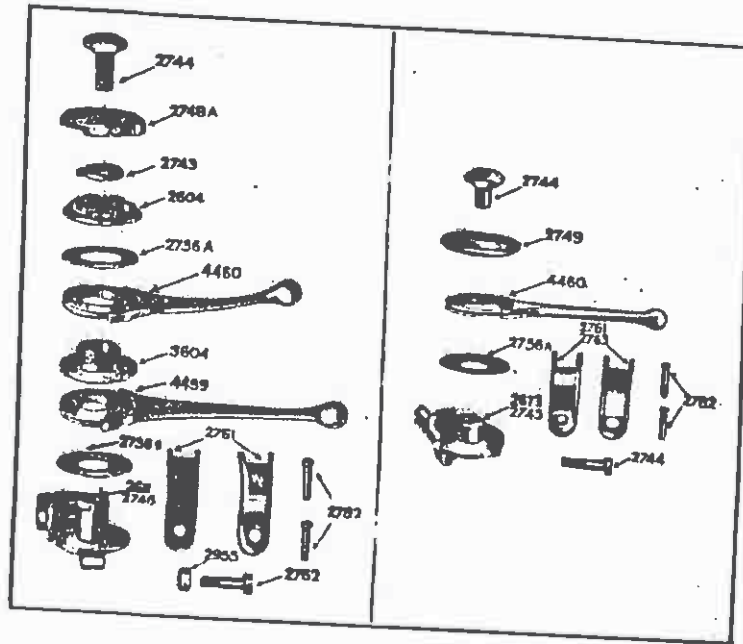

SPECIFICATION OF "M" CONTROL
1925-6-7-8.

COMPONENT.	MID.	MOD.	MIS.	MOS.	Price
Control Body	2811	2746	2745	2673	1 10
Ferrules	1246	1245	1245	1245	2
Air Lever	4480	4480	4460	4480	2 6
Throttle Lever	4450	4459	—	—	2 6
Control Cap	2748A	2748A	2740	2740	5
Control Bolt	2744	2744	2744	2744	3
Control Spring Washer	2750A	2750A	2750A	2750A	2
Control Spring Washer	2756B	2756B	—	—	2
Cable Nipple	4534	4534	4534	4534	2
Regulating Flange	3604	3004	—	—	6
Locking Washer	2743	2743	—	—	3
Handle Bar Clip 1-inch	2761	2761	2761	2761	6
Handle Bar Clip 1/2-inch	2763	2763	2763	2763	6
Handle Bar Clip Screw	2702	2762	2762	2702	3
Handle Bar Clip Rivet	2782	2782	2782	2782	2
Handle Bar Clip Nut	2055	2055	2955	2955	3

Amac Carburetters, 1926-7.

The following were manufactured during the above period in various models or types.

- MODELS.**
- T. 30 P.J.Y. } Standard touring models fitted with standard bottom feed float chambers excepting the T. 30 P.J.Y. which had fitted, with few exceptions, the T. 30 HY. float chamber.
 - T. 25 P.J.Y. }
 - T. 15 P.J.Y. }
 - T. 30 P.J.X. } Same models as above but with top feed float chambers.
 - T. 25 P.J.X. }
 - T. 15 P.J.X. }
 - T. 30 HYNP. } Carburetter adapted to two stroke engines with T. 30 HY. or T. 30 HX. float chambers fitted.
 - T. 30 MXNP. }

The type of your carburetter is stamped on the bottom of the mixing chamber, but to obtain this to save dismantling carburetter measure the diameter of your throttle valve.

Outside diameter of throttle valve

... ..	1 1/2"	... T. 30
... ..	1"	... T. 25
... ..	1 1/4"	... T. 15

MIXING CHAMBER SPARES.

To ascertain the part number of the spare part required, look under the spare parts list of mixing chambers on page 14 under the column headed with the type number for which component is required.

Please note when ordering mixing chambers it is most desirable to send in to us your old chamber as pattern owing to the bore sizes varying for different Makers engines.

FLOAT CHAMBERS SPARES FOR P.J.Y. AND P.J.X.

For illustrations refer to page 5, and specifications page 15.

FLOAT CHAMBERS PARTS FOR T. 30 H.Y.N.P. AND T. 30 H.X.N.P.

For illustrations refer to page 5 and specification page 6.

CONTROLS.

The standard control for 1926-7 was the "M" type spares for which will be found on page 12.

i.e. MID stands for double levers opening inward on Right Hand bar.

MOD. " " " " " outward. " " "

TWIST GRIPS.

Twist Grips were made in 3 lengths, i.e. 4 1/2-ins., 5 1/2-ins., 6 1/2-ins., and known as model "D" short, standard, and long also Right Hand and Left Hand when fitted on right hand bar. Spare parts will be found on page 16.

MODELS. T. 40 Y.D. Special type carburetter for ultra-lightweight machines. For spare parts for mixing chamber see page 21.

Float chamber parts same as T. 30 HY. see page 5.

TT. 25.

These were manufactured for sporting machines only, spares, etc., will be found on page 24.

T. 30 W

Special carburetter for E.W. Douglas machines for illustrations and specification of spare parts see page 15.

SPECIFICATION OF T. 30, T. 25, T. 15, P.J. MIXING CHAMBER, 1925-1928.

COMPONENT	T. 30		T. 25		T. 15		Price	
	P.J.N.	P.J.V.	P.J.N.	P.J.V.	P.J.N.	P.J.V.	H.N.N.P.	H.Y.N.P.
Mixing Chamber	2088	2057	2954	2954	3081	3081		
Mixing Chamber Top	2025	1402	1401	1401	2025	2025		
Mixing Chamber Cap	1332	2800	2703	2703	1332	1332		
Cable Adjusters	1336	1316	1315	1315	1336	1336		
Jet	1278	1278	1278	1278	1278	1278		
Throttle Valve	3020	1303	1182	1182	3020	3020		
Air Valve	1330	1102	1183	1183	1330	1330		
Valve Springs	1335	1193	1184	1184	1335	1335		
Mixing Chamber Key	2031	1301	1300	1300	2031	2031		
Mixing Chamber Key Rivet	3073	3073	3073	3073	3073	3073		
Outlet Clip	1100	1100	1076	1076	1100	1100		
Air Tube	1082	1082	1082	1082	1082	1082		
Sprayer	1507	1507	1425	1425	1507	1507		
Sprayer Washer	3086	2082	2082	2082	3154	3154		
Sprayer Screw	3088	3130	3130	3130	3088	3088		
Jet Holder	3038	3129	3120	3120	3038	3038		
Jet Holder Nut	3203	3036	3026	3026	3203	3203		
Locating Screw	3207	3037	3027	3027	3037	3037		
Pilot Needle	2631	2631	2631	2631	2631	2631		
Pilot Needle Insert	2986	2081	2081	2081	2986	2986		
Pilot Needle Spring	2080	2080	2080	2080	2080	2080		
Pilot Needle Spring Catch	2082	2082	2082	2082	2082	2082		
Small Plug Screw	2403	2403	2403	2403	2403	2403		
Washer for F/C Lug	3229	3152	3152	3152	3229	3229		
Air Intake		1386	1384	1384				
Air Intake Cover		1387	1385	1385				
Air Intake Gauze		1352	1351	1351				
Copper Washer for Jet Holder		3030	3030	3030				

All Float Chamber Parts same as T. 30 HY., T. 25 HYDM, T. 15 HYDM except Float Chamber Base.

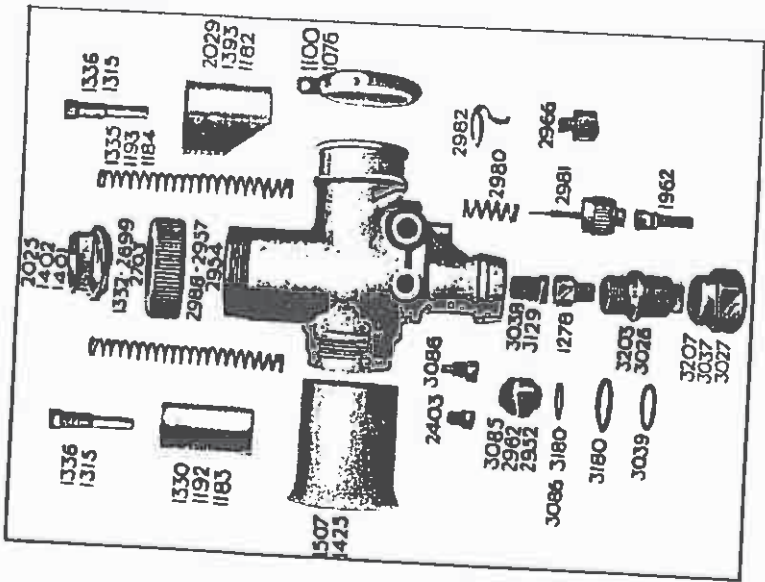

Types: 1507, 2507, 3007, 1507, 2507, 3007.

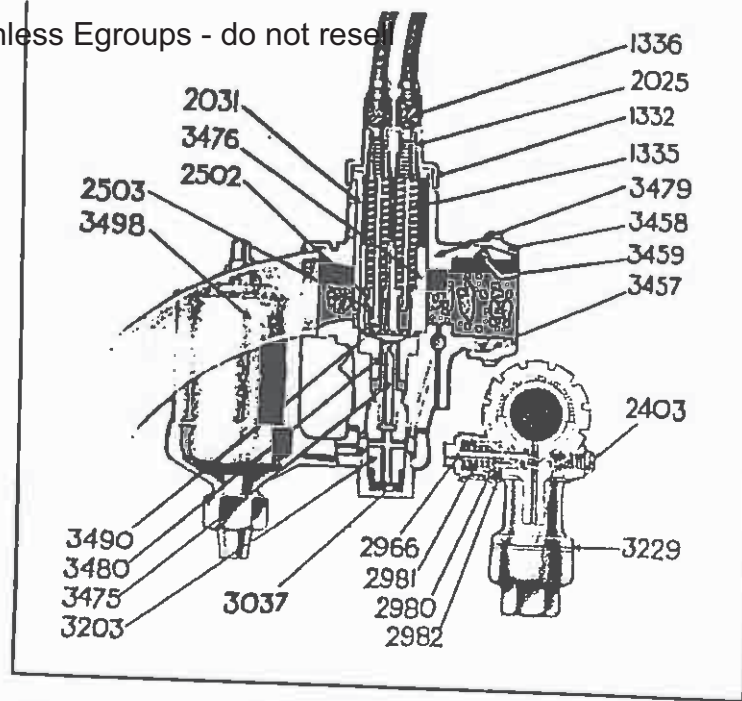

SPECIFICATION FOR SPECIAL AMAC CARBURETTER FOR E.W. DOUGLAS T. 30 W.

COMPONENT	Detail No.	Price
Mixing Chamber	3479	9. d.
Mixing Chamber Top	2025	10 0
Mixing Chamber Cap	1332	1 9
Cable Adjusters	1336	1 9
Jet	1336	4
Throttle Valve	3475	1 0
Air Valve	3476	3 10
Valve Springs	2502	3 0
Mixing Chamber Key	1335	3
Sprayer	2031	5
Jet Holder	3480	3 0
Jet Holder Nut	3203	1 9
Pilot Needle	3037	3
Pilot Needle Insert	2086	1 0
Pilot Needle Spring	2080	1 0
Pilot Needle Spring Catch	2981	2
Small Plug Screw	2982	2
Washer for F/Chamber Lug	2403	3
Sprayer Gauze	3229	2
Split Ring for Induction Joint	3490	6
Nut for Induction Joint	3457	0
Hot Air Pipe	3458	2 0
Air Valve Nipple Holder	3498	5 0
Packing Ring for Induction	2503	2
	3450	6

Float Chamber Parts as T. 30 HY. page 5

JET EQUIVALENTS LIST.

1030 AMAL and BINKS Jet Numbers—Flow In C.C.'s.
 All jets are now known by their actual flow when measured by B.E.S.A. standards, and for the sake of clearness for those who are used to think of them in sized holes, the approximate equivalent sizes are given below:

AMAL, D. & B. AMAL, BINKS, Flow In C.C.'s.	Jet Dia.	AMAL No.	OLD BINKS No.
15	—	—	0
20	.013"	—	1
25	—	10	2
30	.018"	18	3
35	—	19	4
40	.021"	20	—
45	—	21	—
50	.024"	23	5
55	—	24	—
60	.026"	25	6
65	—	26	—
70	.028"	27	7
75	—	28	—
80	.030"	29	8
85	—	—	—
90	.032"	30	9
95	—	31	—
100	.034"	32	11
110	.035"	33	13
120	.037"	35	14
130	.038"	36	15
140	.040"	38	16
150	.041"	39	17
160	.043"	40	18
170	.044"	41	19
180	.045"	43	20
200	.048"	45	21
220	.050"	47	22
240	.052"	49	23
260	.055"	51	24
280	.057"	53	25
300	.059"	55	26
32	—	57	—
34	—	59	—

NOTE.—1029 and 1030 AMAL and BINKS Jets are not interchangeable with those of other years' manufacture.

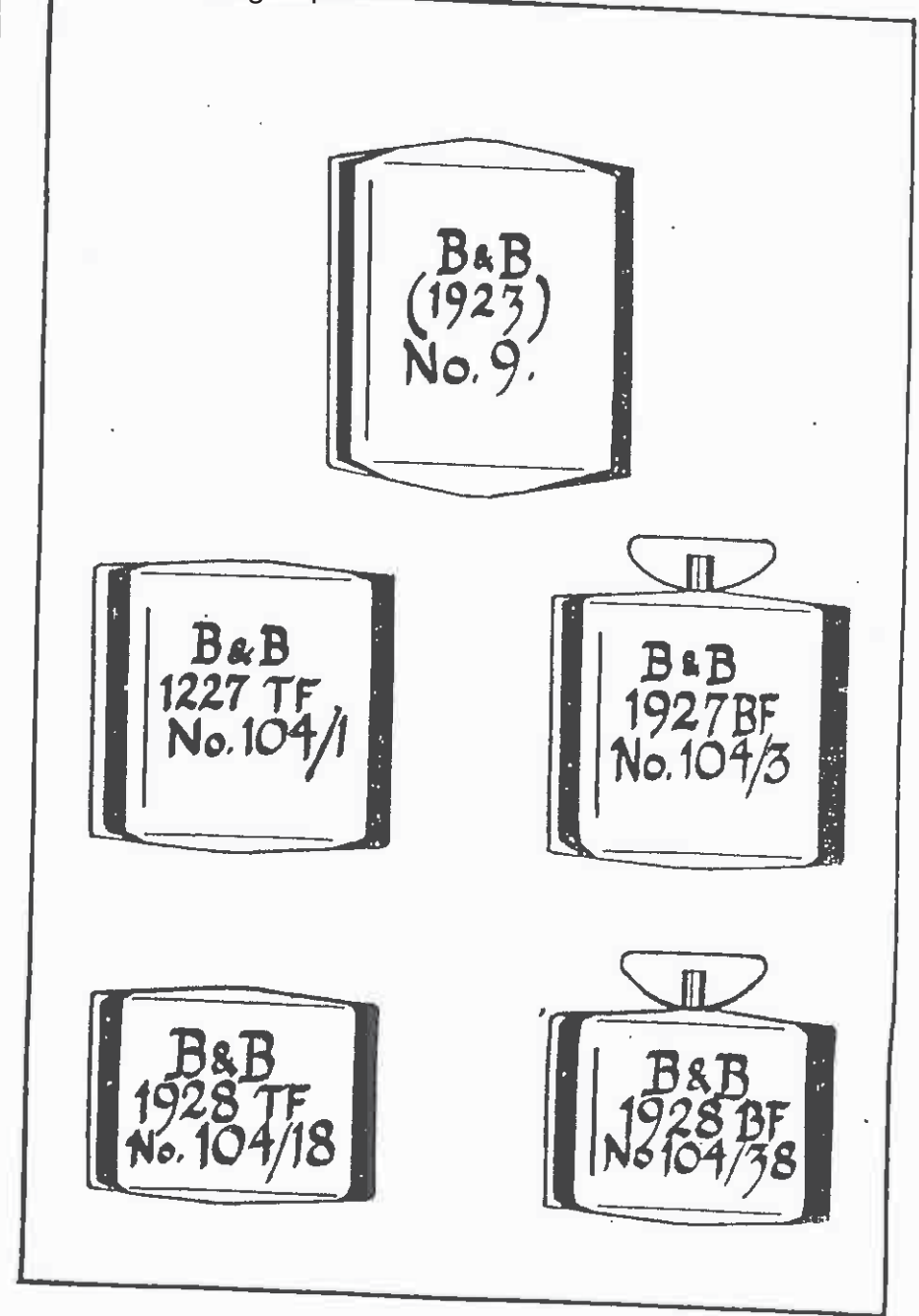

VARIOUS AMAL FLOATS. Illustrations Actual Size.

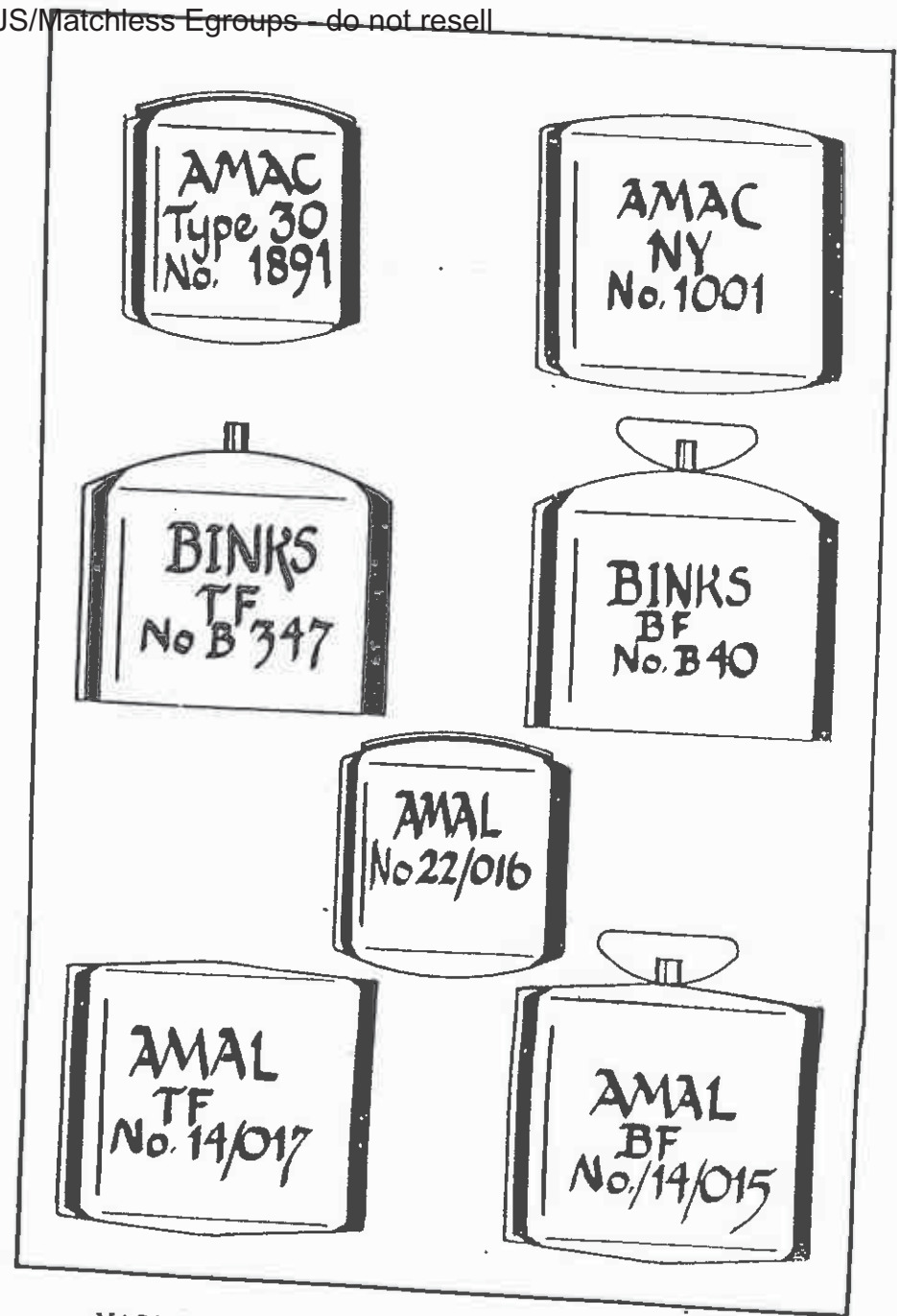

VARIOUS AMAL FLOATS. Illustrations Actual Size

Amac Carburetters, 1928,

The following are the various models manufactured in 1928.

- MODELS. T. 30 MDY.**
- T. 25 MDY.** Touring models fitted with bottom feed float chambers.
- T. 15 MDY.**
- T. 30 MDX.**
- T. 25 MDX.** Touring models fitted with top feed float chambers.
- T. 15 MDX.**
- T. 10 MDX.** Sporting models for 500cc. and over, large type carburetter, fitted, with top feed and bottom feed float chambers respectively.
- T. 10 MDY.**
- T. 40 MSX.** Single lever carburetter suitable for Ultra-light-weight machine with top feed float chamber only.

The type of your carburetter is stamped on the outlet, engine end. To ensure the correct type measure the diameter of your throttle valve.

Outside diameter of throttle valve	3"	...	T. 30
"	"	"	1"	...	T. 25
"	"	"	1 1/2"	...	T. 15
"	"	"	1 1/4"	...	T. 10

MIXING CHAMBER SPARES.

To ascertain the part number of the spare part required, look under the spare parts list of mixing chambers on page 19 under the column headed with the type number for which component is required.

Please note when ordering mixing chambers it is most desirable to send in to us your old chamber as pattern owing to the bore sizes varying for different Makers engines.

FLOAT CHAMBER SPARES.

For all models spares list will be found on page 20. Make sure before ordering whether you require top feed or bottom feed.

CONTROLS.

The standard control for 1928 is the model "M." Spares list and prices will be found on page 12.

TWIST GRIP CONTROLS.

The AMAL twist grip control, also the Binks twist grip were used in 1928. They were made in two sizes, i.e., Long and Short see pages 66 and 68

COMPONENT	T 30	T 30	T 25-15	T 25-T15	Price
	P.J.Y.	P.J.X.	P.J.Y.	P.J.X.	
Float Chamber Cover only	2033	3607	1003	1016	s. d. 2 11
Float Chamber Cover Complete	2033	3607	1003	1016	4 3
Float	Etc.	Etc.	Etc.	Etc.	2 6
Tickler Body	1801	1801	1001	1001	7 7
Tickler	1004	2057	1004	1004	7 7
Tickler Spring	1005	2050	1005	1235	2 2
Needle Valve	1006	2004	1006	1006	11 3
Needle Clip	1901	1937	1007	1018	3 3
Petrol Union Nut	—	—	1518	—	3 3
Petrol Union Nipple	1012	1012	1012	1012	3 3
Petrol Filter	1013	1013	1013	1013	5 6
	1014	1014	1014	1014	

Float Chamber Complete for type 30 Carburetters 17/-, for other types 23/-.

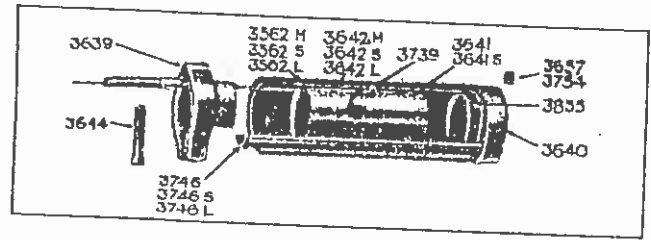

SPECIFICATION OF "D" TYPE TWIST GRIP. 1926-1927.

COMPONENT	STD.	SHORT	LONG	Price
	5 1/2" O/A.	4 1/2" O/A.	6 1/2" O/A.	
End Clip (front)	3630	3630	3630	s. d. 2 0
End Clip (rear)	3640	3640	3640	1 6
Sliding Sleeve	3641	3641S	3641	3 0
Rotating Sleeve	3642	3642S	3642L	2 0
End Clip Screw	3644	3644	3644	3 3
Friction Spring	3855	3855	3855	3 3
Rubber Grip	3502M	3562S	3562L	1 6
Grub Screw 1-in. Bar	3657	3657	3657	2 2
Grub Screw 1/2-in. Bar	3754	3754	3754	2 2
Roller	3730	3730	3730	4 4
Guide Strip	3746	3746S	3746L	1 0
Dummy Grip 1-in. Bar	3564M	3564S	3564L	1 6
Dummy Grip 1/2-in. Bar	3756M	3756S	3756L	1 6
Adhesive Tape 4-in.	—	—	—	4 4
Ferrules	1245	1245	1245	2 2
Cable Nipples (control)	1986	1986	1986	2 2
Cable Nipples (carburetter)	1483	1483	1483	2 2
Inner for 1/2-in. Bar	3755	3755S	3755L	1 6
Control Cable Length adaptor for special cables	3785	3785	3785	4 4
Twist Grip Cap	3014	3014	3014	4 4
1-in. Dummy Grip End Cap	3015	3015	3015	4 4
1/2-in. Dummy Grip End Cap	3016	3016	3016	4 4

Parts
 Above parts are for right hand twist grip opening in on R.H. bar.
 for left hand twist grip opening out please state Left Hand.
 R.H. Open in on R.H. bar or out on L.H. bar.
 L.H. " out " " in " " "

When requiring Float Chamber Body only send pattern owing to various pattern bases.
 T. 30 Float Chamber only 8/6.
 T. 25-15 Ditto, ... 12/-

Mixing Chamber and Float Chamber Parts

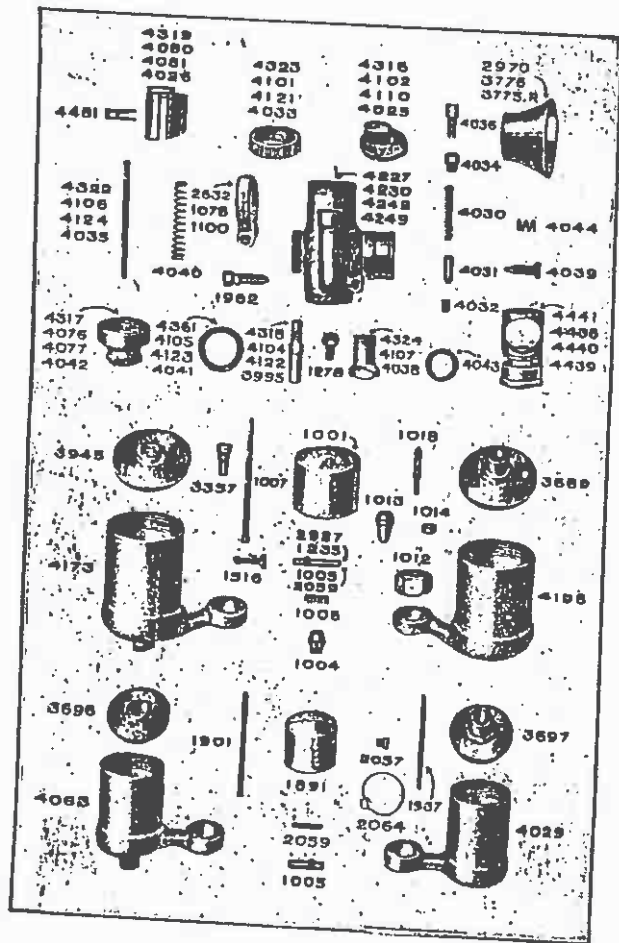
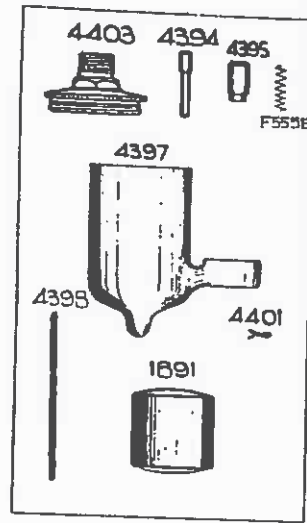

Illustration of parts for T40MSX Float Chamber on page 10

NOTE.—Throttle Valve Spring for T10 MD Is 4506*

MIXING CHAMBER PARTS.

Component	Type 10M		Type 15M		Type 25M		Type 30M		Type 15M 25M 30M		Type 40M	
	Part No.	Price	Part No.	Price	Part No.	Price	Part No.	Price	Part No.	Price	Part No.	Price
Mixing Chamber (double lever)	4227	s. d. 12 6	4230		4242		4249		s. d. 8 6		s. d.	
Mixing Chamber (single lever)	—	—	4254		4263		4266		8 6		4382	7 0
Mixing Chamber Cap ...	4323	2 2	4101		4121		4033		1 9		4387	1 8
Mixing Chamber Top ...	4316	2 2	4102		4110		4026		1 9		—	—
Cable Adjuster ...	4036	4	4036		4036		4036		4		4036	4
Jet ...	1278	5	1278		1278		1278		5		4302	5
Throttle Valves (Nos. 2, 3, 4, 5)	4310	4 3	4080		4081		4026		3 10		4399	3 0
Throttle Valves Spring ...	4506	3	4040		4040		4040		3		4040	3
Outlet Clip ...	2632	2 2	1076		1076		1100		1 9		1100	1 9
Outlet Clip Screw	1962	6	1962		1962		1962		6		1962	6
Air Funnel ...	2070	3 0	3776		3775R		3775R		2 6		—	—
Jet Block complete with choke	4441	5 0	4438		4440		4439		5 0		4400	2 0
Air Barrel Top ...	4034	7	4034		4034		4034		7		—	—
Needle Jet ...	4318	1 9	4104		4122		3995		1 9		—	—
Washer for Jet Block ...	4361	2	4105		4123		4041		2		—	—
Mixing Chamber Union Nut for large float chamber ...	4317	1 11	4076		4077		4046		1 6		—	—
Ditto, for small float chamber	—	—	—		—		4042		1 6		—	—
Washer for Float Chamber Lug	4043	2	4043		4043		4043		2		—	—
Needle for Jet ...	4322	1 3	4106		4124		4035		1 3		—	—
Spring Clip for Needle ...	4481	4	4481		4481		4481		4		—	—
Jet Plug ...	4324	1 9	4107		4038		4038		1 9		4390	1 6
Air Adjusting Screw ...	4039	6	4039		4039		4039		6		4389	6
Spring for Adjusting Screw ...	4044	2	4044		4044		4044		2		—	—
Cable Nipple ...	1482	2	1482		1482		1482		2		4404	2
Air Valve Nipple Sleeve ...	4032	2	4032		4032		4032		2		—	—
Air Valve ...	4031	1 0	4031		4031		4031		1 0		—	—
Air Valve Spring Strangler, complete (single lever only)	4030	3	4030		4030		4030		3		—	—
Jet Lock Screw	—	—	—		—		—		—		—	—
Air Cap	—	—	—		—		—		—		4391	7
Jet Washer	—	—	—		—		—		—		2044	1 9
	—	—	—		—		—		—		4405	1



. FLOAT CHAMBER PARTS.

Component	NY FLOAT CHAMBER		NX FLOAT CHAMBER		30HY FLOAT CHAMBER		30HX FLOAT CHAMBER		40MX FLOAT CHAMBER	
	s.	d.	s.	d.	s.	d.	s.	d.	s.	d.
Float Chamber only for M type Carburetters 1928	4173	12 0	4188	12 0	4063	8 6	4029	8 6	4397	8 0
Float ...	1001	2 0	1001	2 0	1801	2 6	1891	2 6	1801	2 0
Float chamber cover complete ...	3045	4 3	3089	4 3	3096	4 3	3097	4 3	4403	4 3
Float chamber cover only	3045	2 11	3089	2 11	3096	2 11	3097	2 11	4403	2 11
Needle ...	1007	11	1018	11	1801	11	1937	11	4398	11
Needle Clip	1516	3	—	—	3092	3	3092	3	3092	3
Petrol Union Nut ...	1012	6	1012	6	1012	6	1012	6	1012	6
Petrol Union Nipple ...	1013	3	1013	3	1013	3	1013	3	1013	3
Petrol Filter ...	1014	5	1014	5	1014	5	1014	5	1014	5
Locking Screw for float chamber cover ...	3357	6	—	—	—	—	—	—	—	—
Tickler Body ...	1001	7	1004	7	1004	7	2087	7	4395	7
Tickler Spring	1006	2	1006	2	1006	2	2084	2	F555B	2
Tickler ...	2927	7	1235	7	1005	7	2059	7	4394	7
Tickler Cotter Pin ...	—	—	—	—	—	—	—	—	4401	1

NY = Large bottom feed float chamber.
 NX = " top
 30HY = Small bottom " " "
 30HX = " top " " "

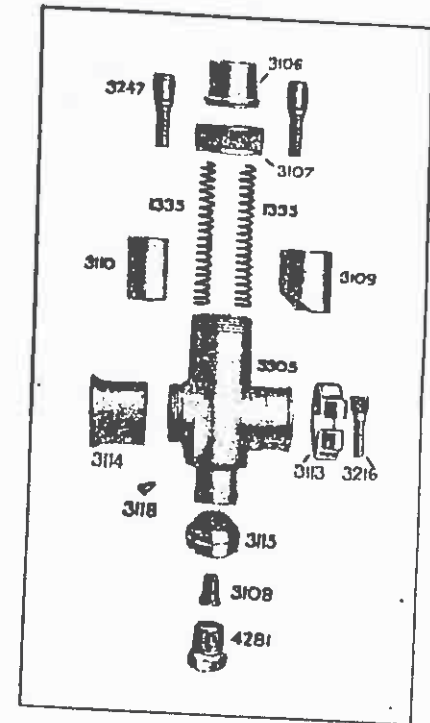

TYPE 40 YD. DOUBLE LEVER CARBURETTOR.
 1926 to 1928.

COMPONENT.	Detail No.	Price
Mixing Chamber	s. d.
Mixing Chamber Top	3305	7 0
Mixing Chamber Cap	3106	1 6
Cable Adjuster	3107	1 6
Jet ...	3247	4
Throttle Valve	3108	5
Air Valve ...	3109	3 0
Valve Springs	3110	2 6
Mixing Chamber Key	1335	3
Outlet Clip	3112	5
Outlet Clip Screw	3113	9
Air Tube ...	3216	6
Sprayer	3114	1 0
Sprayer Washer	3115	2 0
Jet Plug ...	3116	2
Sprayer Locating Screw	4281	1 6
F/Chamber Lug Washer	3118	2
	3229	2

Float Chamber same as T. 30 HY. page 5.

T. T. MODELS—1924 to 1927 Inclusive.

- T26 TT24 } This type was first used in the Isle of Man T.T. Races, 1924,
- T15 TT24 } and afterwards put into general production for Sports machines fitted with top or bottom float chambers.
- T25 TT25 } This type was first used in the Isle of Man T.T. Races, 1925,
- T15 TT25 } and afterwards put into general production for Sports machines, same being produced up till 1929 inclusive. Float chambers fitted were the bottom feed type except in a very few instances.
- T10 TT25 } These models were used in the Isle of Man T.T. Races, 1926,
- T25 TT26 } and 1927 respectively, the type denoting the year. Although they were not put into general production same were supplied for racing purposes only. Same as the TT. 25, float chambers fitted were of the bottom feed type with few exceptions.
- T15 TT26 }
- T25 TT27 }
- T15 TT27 }
- T10 TT27 }

The type of your carburetter is stamped on either the bottom of the air chamber or the outlet to engine. If you measure the diameter of your throttle valve, this will give you the type of carburetter as below :—

Outside diameter of throttle valve ...	1 1/4"	...	T. 25
" " " " " " " " " " " "	1 3/8"	...	T. 15
" " " " " " " " " " " "	1 1/2"	...	T. 10

MIXING CHAMBER SPARES.

- TT. 24. To ascertain the part number of the spare part required look under the spare parts list of mixing chambers on page 23 under the column headed with the type number for which part is required. Please note when ordering mixing chambers it is most desirable to send in to us your old chamber as pattern, owing to the bore sizes varying for different Makers engines.
- TT. 25. Same remarks apply as above with the exception that spares will be found on page 24.
- TT. 26. Same remarks as TT. 24 with the exception that spares will be found on page 26.
- TT. 27. Same remarks as TT. 24 with the exception that spares will be found on page 27.

FLOAT CHAMBER SPARES.

- TT. 24. Spares for this type are the same as HVSP. the list being on page 20.
- TT. 25. Spare parts for these types will be found on page 20.
- TT. 26. Look for the component required, and to get the correct number look under column headed with the type of Carburetter on page 28.
- TT. 27.

CONTROLS.

- TT. 24. The "K" type control was fitted to these models, spares for which will be found on page 8.
- TT. 25. The "M" type control was fitted to these models, spares for which will be found on page 12.
- TT. 26.
- TT. 27.

TWIST GRIPS.

The pattern used after 1925 was the "D" type, spares for which will be found on page 16.

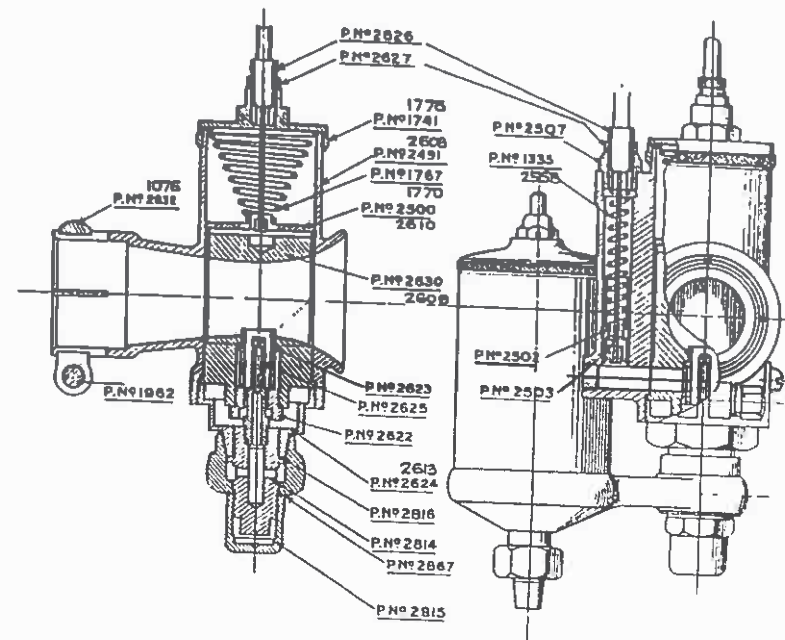

SPECIFICATION OF MIXING CHAMBER PARTS. T.T. 24.

COMPONENT.	T 25	T 15	Price s. d.
Mixing Chamber and Choke	2608	2491	12 0
Mixing Chamber Top	1770	1741	1 9
Cable Adjuster	2620	2626	1 4
Cable Adjuster Lock Nut	2027	2627	2
Mixing Chamber Union Nut	2613	2624	1 6
Jet	2625	2625	1 0
Jet Choke Plug	2622	2622	2 0
Jet Choke Tube	2623	2623	1 9
Air Valve	2502	2502	1 0
Air Valve Spring	1558	1335	3
Throttle valve	2610	2500	3 10
Throttle Valve Spring	1770	1767	3
Air Valve Nipple Holder	2603	2503	2
Air Barrel Top	2507	2507	7
Jet Holder	2814	2814	1 6
Jet Holder Nut	2815	2815	3
Jet Holder Washer (large)	2867	2867	2
Jet Holder Washer (small)	2816	2816	2
Outlet Clip	1076	2632	1 9
Outlet Clip Pin	1982	1982	6

TT28—TT27 Mixing Chamber.

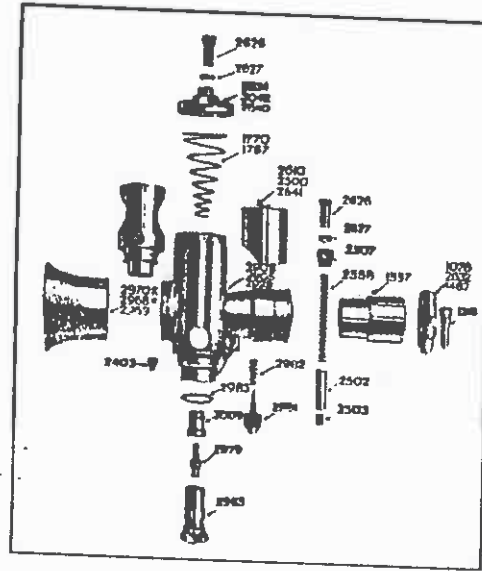

SPECIFICATION OF MIXING CHAMBER, 1925.

COMPONENT.	T 25 TT 25	T 15 TT 25	Price	T 10 T T25	Price
Mixing Chamber (with adaptor)	2008	2005	s. d.	2020	5. 0.
Air Valve	2502	2502	12 9	2502	17 0
Throttle Valve	2610	2500	1 0	2602	1 0
Mixing Chamber Top	3634	3048	3 10	2041	4 3
Cable Adjuster	2620	2626	1 9	2640	2 2
Lock Nut for Adjuster	2627	2627	4	2020	4
Jet	2070	2070	2	2627	2
Jet Holder	2005	2065	1 0	2070	1 0
Outlet Clip	1076	2632	1 0	2065	1 9
Outlet Clip Pin	1216	1216	6	2482	2 2
Pilot Needle	2081	2981	1 0	1216	6
Pilot Needle Spring	2980	2080	2	2081	1 0
Pilot Needle Insert	2966	2966	1 0	2980	2
Pilot Needle Spring Catch	2082	2082	2	2966	1 0
Float Chamber Lug Washer	3046	3046	2	2082	2
Plug Screw	2403	2403	2	3046	2
Air Tube	2970R	2088R	2 6	2403	2
Primary Choke	3000	3000	1 9	2970R	3 0
Air Valve Spring	2558	2558	3	3000	1 0
Throttle Valve Spring	1770	1770	3	2558	3
Air Barrel Top	2507	2507	7	1770	3
Air Valve Nipple	2503	2503	2	2507	7
Adaptor Location Peg	2631	2631	2	2503	2
Air Barrel Plug	3069	3069	6	2631	2
Locking Screw for Air Tube	3032	3032	2	3069	6
Outlet Liner				3032	2
				1557	9

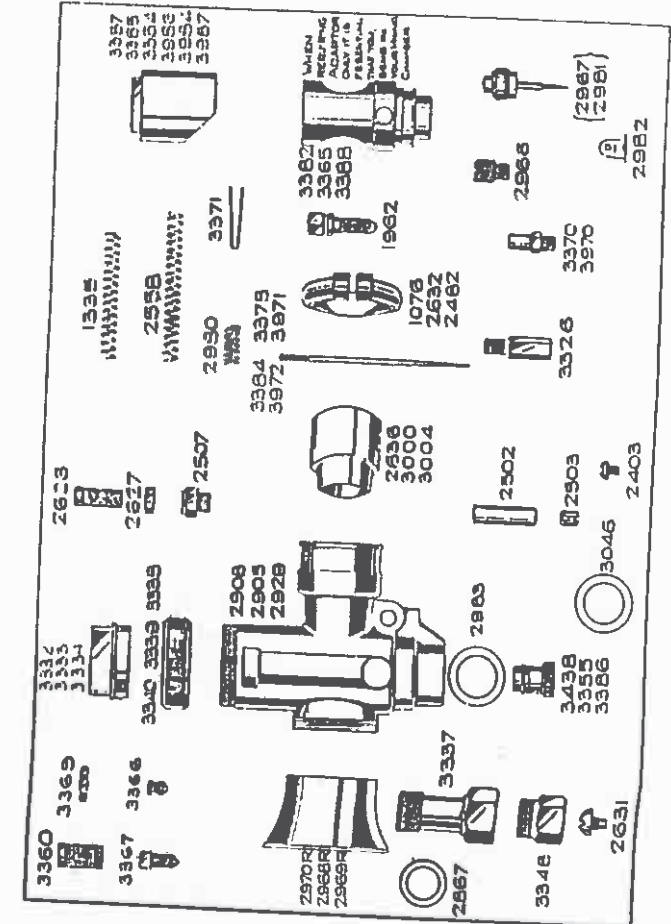

Amac T.T. Carburetters.

SPECIFICATION OF T25 TT26, T15 TT26, T10 TT26 CARBURETTERS.

COMPONENT.	T 25 TT 26	T 15 TT 26	Price	T 10 TT 26	Price
Mixing Chamber w/ Adaptor	2908	2905	12 9	2020	17 0
Mixing Chamber Top	3332	3333	1 9	3334	2 2
Air Cable Adjuster	2626	2626	4	2620	4
Jet	3326	3326	1 0	3328	1 0
Air Cable Adjuster Locknut	2627	2627	2	2627	2
Jet Choke Tube	3438	3355	1 9	3380	1 0
Air Valve	2502	2502	1 0	2502	1 0
Air Valve Spring	2558	2558	3	2558	3
Throttle Valve	3385	3384	3 10	3364	4 3
Throttle Valve Spring	1335	1335	3	1335	3
Air Barrel Top	2507	2507	7	2507	7
Carburettor Cable Nipple	2620	2620	2	2620	2
Outlet Liner	2630	3000	0	3004	2
Outlet Clip	1076	2032	1 0	2482	2 3
Outlet Clip Pin	1062	1062	6	1062	6
Adaptor Location Peg	2631	2631	3	2631	3
Air Barrel Plug	3969	3969	6	3969	6
Air Tube	2970	2968	2 6	2969	3 0
Pilot Needle	2981	2981	1 0	2981	1 0
Pilot Needle Insert	2966	2966	1 0	2966	1 0
Pilot Needle Spring	2080	2080	2	2080	2
Pilot Needle Spring Catch	2082	2082	2	2082	2
Jet Holder	3337	3337	1 0	3337	1 0
Adaptor Washer	2983	2983	2	2983	2
Mixing Chamber Cap	3340	3330	1 0	3338	2 2
Lock Plunger for M/Chamber Top	3366	3366	4	3366	4
Adjusting Screw for Lock Plunger	3367	3367	2	3367	2
Throttle Cable Adjuster	3360	3360	4	3360	4
Lock Nut for Adjuster	3369	3369	2	3369	2
Nipple Holder for Air Valve	2503	2503	2	2503	2
Jet Holder Washer	2867	2867	2	2867	2
Hair Pin for Needle	3371	3371	3	3371	3
Locking Screw for Air Tube	3932	3932	2	3932	2
Small Plug Screw	2403	2403	2	2403	2
Jet Holder Plug	3348	3348	1 9	3348	1 0
Needle for Jet	3384	3378	1 3	3378	1 3
M/Chamber Washer	3046	3046	2	3046	2
Needle Jet	3370	3370	1 0	3370	1 0

Amac T.T. Carburetters

SPECIFICATION OF T25 TT27, T15 TT27, T10 TT27 MIXING CHAMBER.

COMPONENT.	T 25	T 15	Price	T 10	Price
Mixing Chamber w/ Adaptor	2008	2005	s. d.	2020	s. d.
Mixing Chamber Top	3332	3333	12 0	3334	17 0
Mixing Chamber Cap	3340	3330	1 0	3338	2 2
Cable Adjuster (Air)	2026	2026	4	2620	2 2
Cable Adjuster Locknut	2627	2627	2	2627	4
Jet	3326	3326	1 0	3326	2
Jet Choke Tube	3438	3438	1 0	3438	1 0
Air Valve	2502	2502	1 9	2502	1 0
Air Valve Spring	2558	2558	3	2558	1 0
Throttle Valve	3084	3084	3	3084	3
Throttle Valve Spring	1335	1335	3 10	3997	4 3
Air Barrel Top	2507	2507	7	2507	3
Carburettor Cable Nipple	2620	2620	2	2620	2
Outlet Liner	2630	3000	0	3004	2
Outlet Clip	1076	2632	1 0	2482	2 2
Outlet Clip Pin	1062	1062	6	1062	6
Adaptor Location Peg	2631	2631	3	2631	3
Air Barrel Plug	3969	3969	6	3969	6
Air Tube	2970	2968	2 6	2969	3 0
Pilot Needle	2981	2981	1 0	2981	1 0
Pilot Needle Insert	2966	2966	1 0	2966	1 0
Pilot Needle Spring	2080	2080	2	2080	2
Pilot Needle Spring Catch	2082	2082	2	2082	2
Jet Holder	3337	3337	1 0	3337	1 0
Adaptor Washer	2983	2983	2	2983	2
Lock Plunger for M/C Top	3366	3366	4	3366	4
Adjusting Screw for ditto	3367	3367	2	3367	2
Throttle Cable Adjuster	3360	3360	4	3360	4
T/C Adjuster Locknut	3300	3300	4	3360	4
Needle Jet	3070	3070	2	3369	2
Nipple Holder for Air Valve	2503	2503	1 0	3970	1 0
Jet Holder Washer	2867	2867	2	2503	2
Hair Pin for Needle	3371	3371	3	2867	2
Locking Screw for Air Tube	3932	3932	2	3371	3
Small Plug Screw	2403	2403	2	3932	2
Jet Holder Plug	3406	3406	2	2403	2
M/Chamber Lug Washer	3348	3348	1 9	3406	2
Jet Holder Plug	3348	3348	1 9	3348	1 0
Needle	3972	3971	1 3	3971	1 3

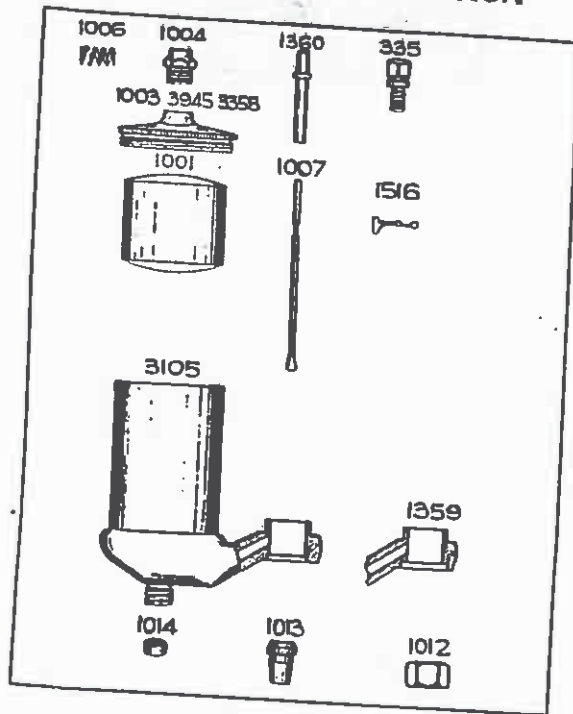

FLOAT CHAMBER PARTS FOR T.T. CARBURETTORS.

COMPONENT.	T.T. 24	T.T. 26	T.T. 28 T.T. 27	Price
Float Chamber Cover only	1003	3045	3358	s. d.
Float Chamber Cover comp.	1003 Etc.	3045 Etc.	3358 Etc.	2 11
Float	1001	1001	1001	4 3
Tickler Body	1004	1004	1004	2 0
Tickler	1360	1360	1360	7
Tickler Spring	1008	1000	1000	7
Needle Valve	1007	1007	1007	2
Needle Clip	1516	1510	1516	11
Petrol Union Nut	1012	1012	1012	3
Petrol Union Nipple	1013	1013	1013	0
Petrol Filter	1014	1013	1013	3
Float Chamber Body only	3105	3105	3105	5
Float Chamber complete	1359	3105 Etc.	1359 3200	12 0
Locking Screw for Float Chamber Cover	1359 Etc.	3105 Etc.	1359 3200	23 0
	—	3357	3357	0

Binks 3-Jet Damping Carburettors.
1923 to 1925.

This carburettor has 3 jets directly below the throttle valve and should not be confused with the later model 3-jet carburettor which has two jets directly below the throttle valve, and the third or main jet in the air intake bore at the back of the carburettor.

There are two models—namely heavyweight and lightweight. You can determine your particular model by measuring the outside diameter of the throttle valve: should this be 1 1/4-ins. your carburettor is a heavyweight model, or should it be 1-in. outside diameter the carburettor will be a lightweight model.

SPARES FOR MIXING CHAMBER.

For illustration of this refer to page 30 and for the part number of component required refer to page 31 under the column headed with your particular model, that is heavyweight or lightweight.

Note.—When ordering mixing chamber bodies it is advisable to send in your old mixing chamber as pattern.

SPARE PARTS FOR FLOAT CHAMBERS.

For illustrations refer to page 30 and for part number of component refer to page 31.

SPARE PARTS FOR CONTROL LEVERS.

For illustrations and part number of component refer to page 30.

BINKS 3-JET DAMPING CARBURETTORS.
1926 to 1928.

This carburettor has two jets immediately below the throttle valve and the main jet in the air intake bore of the mixing chamber, and should not be confused with the earlier model which has 3 jets immediately below the throttle valve.

There are two models—namely heavyweight and lightweight. You can determine your particular model by measuring the outside diameter of the throttle valve. Should this be 1 1/4-ins. your carburettor is the heavyweight model, or should it be 1-in. outside diameter the carburettor will be a lightweight model.

SPARES FOR MIXING CHAMBER.

For illustration of this refer to page 30 and for the part number of component required refer to page 32 under the column headed with your particular model, that is heavyweight or lightweight.

Note.—When ordering mixing chamber bodies it is advisable to send in your old mixing chamber as pattern.

SPARE PARTS FOR FLOAT CHAMBERS.

For illustrations refer to page 30 for part number of component refer to page 32.

SPARE PARTS FOR CONTROL LEVERS.

For illustrations and the part number of component refer to page 30.

Binks 3-Jet Carburetter

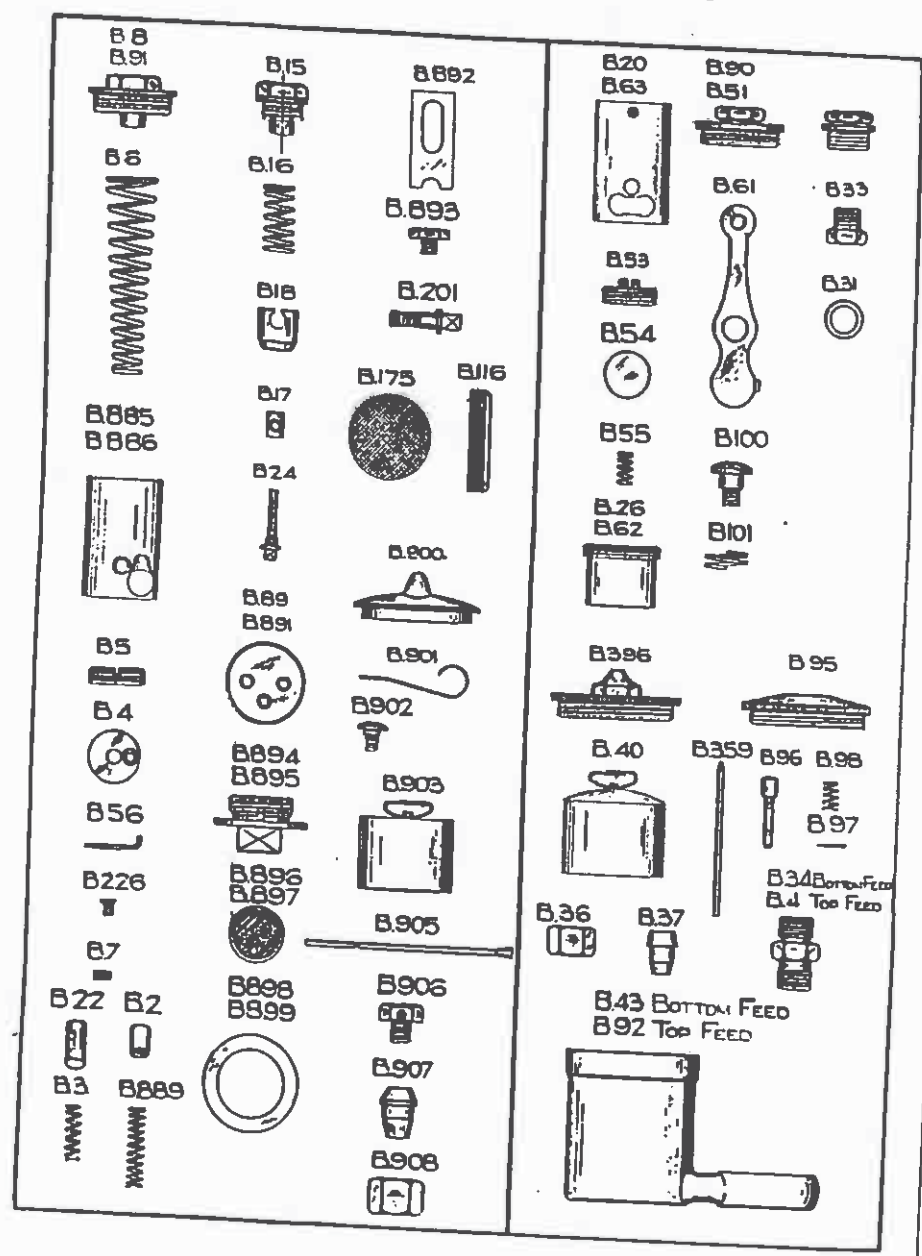

Binks Carburetter, 1923-5

BINKS 3-JET DAMPING CARBURETTER, 1923 to 1925.

MIXING CHAMBER COMPONENT.

COMPONENT.	H.W.	L.W.	Price / s. d.
Mixing Chamber Body	—	—	1 0 0
Mixing Chamber Top Cap (throttle)	8	—	2 0
Mixing Chamber Top Cap (Extension Valve)	—	91	1 6
Throttle Valve (Skeleton)	15	16	3 6
Throttle Valve (complete)	885	886	10 0
1st Pilot Damper Pad	887	888	6
2nd Pilot and Main Jet Damper	22	22	1 0
2nd Pilot Damper Spring	2	2	4
Main Jet Damper Spring	3	3	1 0
Throttle Valve Spring	880	889	4
Throttle Thimble	0	0	1 0
Throttle Plate	6	5	1 6
Throttle Plate Screw	4	—	1 0
Throttle Key Disc	226	220	2
Throttle Key Screw	—	50	1 0
Jet Size 0000	7	—	6
Jet Size 000	24	24	2 6
Jet Size (0)	24	24	2 0
Jet Size 0	24	24	1 6
Jet Size, other sizes	24	24	1 0
Jet Seat	24	24	1 0
Bottom Cap and Filter	890	891	1 0
Filter only	894	895	3 6
Washer for Bottom Cap	896	897	1 0
Extension Air Valve	898	899	2
Extension Air Valve Bar or Nipple	18	18	2 8
Extension Valve Spring	17	17	6
Pinchbolt for Engine End	10	16	9
Air Slide at side of Body	201	201	6
Screw for ditto	802	802	—
Air Intake Cap	893	803	—
Air Intake Gauze	116	116	1 6
	176	176	6

FLOAT CHAMBER COMPONENTS.

COMPONENT.	H.W.	L.W.	Price s. d.
Float Chamber Cover	—	—	2 0
Spring for ditto	900	900	1 0
Rivet for ditto	901	901	3
Float and Bow	902	902	3 6
Bow Spring only	903	903	6
Float Needle	904	904	2 6
Needle Valve Seat	905	905	1 0
Petrol Pipe Nipple	906	906	6
Petrol Pipe Nut	907	907	6
	908	908	—

Binks Carburetter. 1926-8

SPECIFICATION OF BINKS 3-JET MIXING CHAMBER PARTS 1926 to 1928 Inclusive.

COMPONENT	HW _{1/2} Diam. Throt.	LW _{1/2} Diam. Throt.	Price s. d.
Mixing Chamber Body ...			
Mixing Chamber Top Cap (Throttle Barrel) ...	30	51	20 0
Adjusting Screw 1/2-in. ...	40	40	0 0
Locknut for ditto ...	30	50	1 0
Throttle Valve (Skeleton) Throttle Complete ...	20	43	3 0
Throttle Spring ...	6	6	1 0
Throttle Key Screw ...	7	7	3 0
Throttle Key Disc ...			0 0
Throttle Plate to hold Damper Spring in ...	4	56	1 0
Throttle Plate Screw ...	28		2 0
Throttle Thimble for Wire Nipple ...	53		1 0
Throttle Plate for ditto ...	54		1 0
Spring for ditto ...	55		2 6
Skd. Throttle Thimble ...	5		0 0
1st Pilot Damper Pad ...	22		0 0
2nd Pilot Damper Complete ...	2		4 0
2nd Pilot Damper Spring ...	3		0 0
1st Pilot Jet No. 0000 ...	24	24	0 0
1st Pilot Jet No. 000 ...	24	24	0 0
1st Pilot Jet No. 00 ...	24	24	0 0
2nd Pilot Jet No. 0 ...	27	27	0 0
Main Jet (state size) ...	32	32	3 0
Main Jet Cap ...	33	33	1 0
Main Jet Washer ...	31	31	0 0
Jet Seat ...	29	62	0 0
Jet Key ...	202	202	0 0
Bottom Cup (Float Chamber Holding Screw) ...	30	30	0 0
Filter Gauge (for ditto) ...	20	20	0 0
Washer for ditto (Top of F/Chamber Arm) ...	25	25	0 0

Binks 2-Jet Carburetters.

BINKS 2-JET CARBURETTERS, 1923 to 1928 INCLUSIVE.

The following are the various models manufactured during the above period.

TWO LEVER INSTRUMENTS.

- Model "E." This is a 1/2" "D" type throttle with fixed "D" choke in mixing chamber.
- Model "F." This is a 1" "D" type throttle with fixed "D" choke in mixing chamber.
- Model "G." This is a 1 1/4" "D" type throttle with fixed "D" choke in mixing chamber.

SINGLE LEVER CARBURETTERS.

- Model "WA." 1/2" diameter "C" type throttle, 1/2" long, for carburetters with 1/8" or 1/4" choke bore.
- Model "OA." 1/2" diameter "C" type throttle, 1" long, for carburetters with 1/8", 1/4" or 3/8" choke bore.
- Model "DA." 1" diameter for throttle, for carburetters with 1/4" or 1/2" choke bore.

SPARE PARTS FOR MIXING CHAMBERS.

For illustrations refer to page 34 and for part number of component required refer to page 35 under the column headed with your particular model. Note.—When ordering mixing chamber bodies it is advisable to send in your old mixing chamber as pattern.

SPARE PARTS FOR FLOAT CHAMBERS.

For illustrations refer to page 34 and for part number of component refer to pages 35 and 36.

SPARE PARTS FOR CONTROL LEVER.

For illustrations and part number of component refer to page 39.

BINKS 2-JET CARBURETTERS, 1927 to 1928 INCLUSIVE.

The following are the various models manufactured during the above period.

TWO LEVER MODELS.

- Model "H." 1/2" diameter "C" shaped throttle.
- Model "J." 1/2" diameter "C" shaped throttle.
- Model "K." 1" diameter "C" shaped throttle.
- Model "L." 1 1/4" diameter "C" shaped throttle.

SINGLE LEVER CARBURETTERS.

- Model "HA." 1/2" diameter "C" shaped throttle.
- Model "JA." 1/2" diameter "C" shaped throttle.
- Model "KA." 1" diameter "C" shaped throttle.
- Model "LA." 1 1/4" diameter "C" shaped throttle.

SPARE PARTS FOR MIXING CHAMBERS.

For illustrations refer to page 34 and for part number of component required refer to page 35 under the column headed with your particular model.

Note.—When ordering mixing chamber bodies it is advisable to send in your old mixing chamber as pattern.

SPARE PARTS FOR FLOAT CHAMBERS.

For illustrations refer to page 34 and for part number of component refer to pages 35 and 36.

SPARE PARTS FOR CONTROL LEVER.

For illustrations and part number of component refer to page 39.

Component	HW _{1/2} LW _{1/2} Diam. Throt.		Price s. d.
	HW _{1/2} Diam. Throt.	LW _{1/2} Diam. Throt.	
Washer for ditto (Bottom of F/Chamber Arm) ...	28	28	0 0
Extra Air Valve Cap ...	13	13	1 0
Extra Air Valve ...	18	18	0 0
Extra Air Valve Bar ...	17	17	0 0
Pinch Bolt (for engine end) Locknut (for Carburetter screwed into Cylinder) 1 1/2-in. x 20 Thread Ditto (for 1 1/2-in. x 20 Thread) Air Shutter (side of body) Air Shutter Screw ...	16	21	0 0
Air Shutter Spring ...	102	102	0 0
Blow Back Cap (for Air Intake) Gauge Ring (for Air Intake) Cause (for Intake) ...	103	103	0 0
	61	61	1 0
	100	100	0 0
	101	101	0 0
	1	1	1 0
	116	116	1 0
	173	173	0 0

COMPONENT	Bottom Feed		Top Feed		Price s. d.
	Bottom Feed	Top Feed	Bottom Feed	Top Feed	
Float Chamber complete	243	243	240	240	15 0
Float Chamber Body only	43	43	102	102	0 0
Cover complete ...	306	306	205	205	0 0
Tickler ...			65	65	0 0
Split Pin ...			10	10	0 0
Float and Bow ...			40	40	0 0
Float and Needle ...			42	42	0 0
Bow Spring only ...			30	30	0 0
Needle Valve ...			34	34	0 0
Needle Valve Seat and Petrol connection ...			36	36	0 0
Union Nut ...			37	37	0 0
Union Nipple ...					0 0

Binks 2-Jet Carburetters.

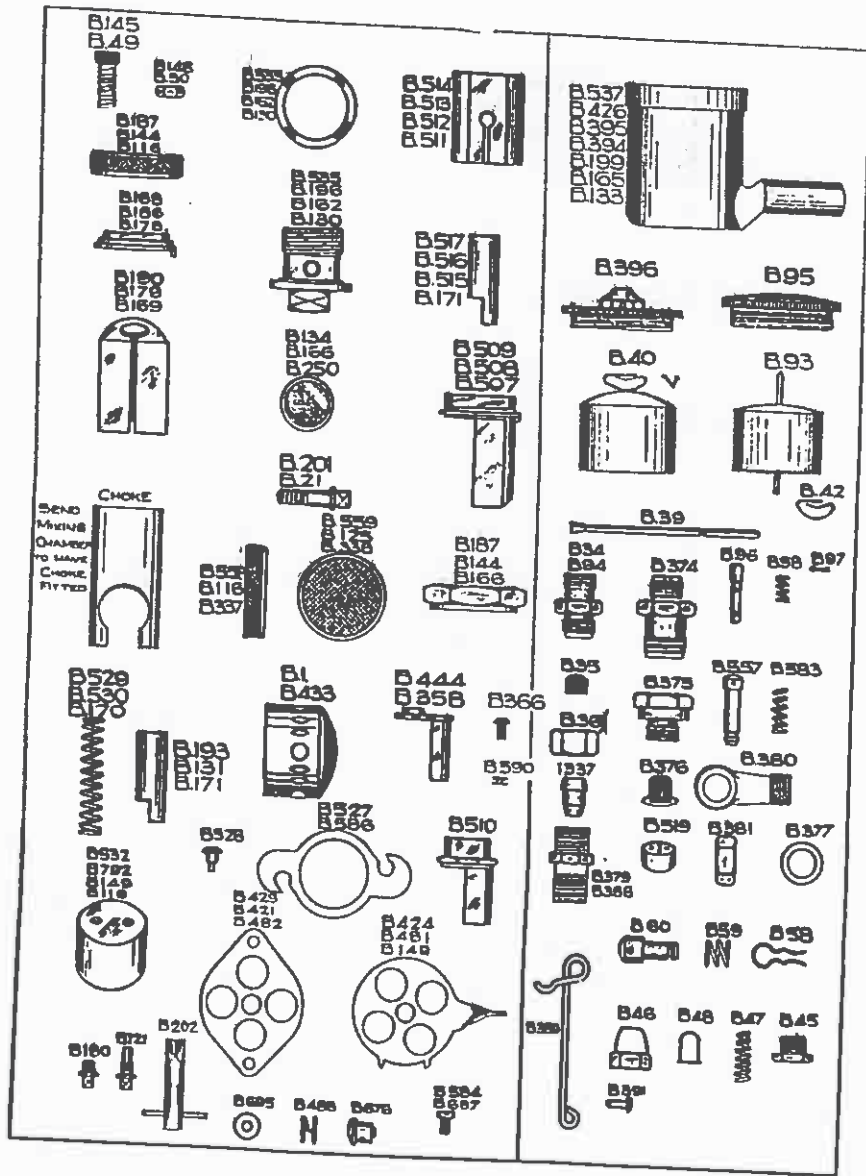

Binks 2-Jet Carburetters

BINKS CARBURETTERS, 1923 to 1926 inclusive.

MIXING CHAMBER PARTS.

COMPONENT	E.	F.	G.	W.A.	CA.	DA.	List Price
Mixing Chamber	B. 102	B. 149	B. 110	B. 102	B. 102	B. 140	20
Jet Seat	B. 185	B. 183	B. 173	B. 146	B. 146	B. 146	0
Choke	B. 190	B. 170	B. 169	B. 148	B. 148	B. 140	0
Throttle Valve	B. 193	B. 181	B. 171	B. 191	B. 101	B. 180	0
Air Valve	B. 186	B. 178	B. 168	B. 201	B. 201	B. 201	0
Top Plate	B. 187	B. 144	B. 110	B. 120	B. 120	B. 120	0
Holding Ring or Screws	B. 145	B. 145	B. 40	B. 121	B. 121	B. 121	0
Adjusting Screws	B. 146	B. 146	B. 50	B. 146	B. 146	B. 146	0
Locknut for ditto	B. 101	B. 180	B. 170	B. 191	B. 101	B. 180	0
Throttle and Air Valve Springs	B. 201	B. 21	B. 21	B. 201	B. 201	B. 201	0
Pinchoil	B. 120	B. 120	B. 120	B. 120	B. 120	B. 120	0
Pilot Jet	B. 121	B. 121	B. 121	B. 121	B. 121	B. 121	0
Main Jet	B. 433	B. 433	B. 1	B. 433	B. 433	B. 433	0
Blowback Cap	B. 558	B. 558	B. 175	B. 558	B. 558	B. 558	0
Intake Gauze	B. 202	B. 202	B. 202	B. 202	B. 202	B. 202	0
Intake Gauze Ring	B. 487	B. 457	B. 435	B. 487	B. 487	B. 457	0
Jet Key	B. 106	B. 162	B. 130	B. 106	B. 106	B. 106	0
Float Chamber	B. 413	B. 418	B. 423	B. 202	B. 202	B. 202	0
Washers for ditto	B. 426	B. 395	B. 304	B. 487	B. 487	B. 457	0
Washers for ditto	B. 396	B. 306	B. 396	B. 106	B. 106	B. 106	3

BOTTOM FEED FLOAT CHAMBER PARTS.

Float Chamber complete	B. 413	B. 418	B. 423	B. 413	B. 413	B. 418	15
Float Chamber Body	B. 426	B. 395	B. 304	B. 426	B. 426	B. 395	0
Cover	B. 396	B. 306	B. 396	B. 396	B. 396	B. 396	0
Needle Valve	B. 39	B. 39	B. 30	B. 39	B. 39	B. 39	0
Float and Bow	B. 40	B. 40	B. 40	B. 40	B. 40	B. 40	0
Bow only	B. 42	B. 42	B. 42	B. 42	B. 42	B. 42	0
Valve Seat	B. 34	B. 34	B. 34	B. 34	B. 34	B. 34	0
Union Nut	B. 36	B. 36	B. 36	B. 36	B. 36	B. 36	0
Nipple	B. 37	B. 37	B. 37	B. 37	B. 37	B. 37	0

Binks 2-Jet Carburettors

COMPONENT	E.	F.	G.	WA.	CA.	DA.	List Price
Small Filter	B. 35	B. 35	B. 35	D. 35	B. 35	B. 35	1 0
Large Valve Seat	B. 374	B. 374	B. 374	B. 374	B. 374	B. 374	1 0
Filter Union	B. 375	B. 375	B. 375	B. 375	B. 375	B. 375	1 0
Filter	B. 376	B. 376	B. 376	B. 376	B. 376	B. 376	1 0
Filter Protector	B. 519	B. 519	B. 519	B. 519	B. 519	B. 519	1 0
Horizontal Petrol Pipe Fitting	B. 380	B. 380	B. 380	B. 380	B. 380	B. 380	1 0
Needle Seat for Horizontal Fitting	B. 379	B. 379	B. 379	B. 379	B. 379	B. 379	1 0
Blind Nut for above	B. 381	B. 381	B. 381	B. 381	B. 381	B. 381	1 0
2 Washers for above	B. 377	B. 377	B. 377	B. 377	B. 377	B. 377	3d. each

COMPONENT	E.	F.	G.	HA.	JA.	KA.	LA.	List Price
Float Chamber complete	B. 210	B. 208	B. 206	B. 210	B. 210	B. 210	B. 208	15 0
Float Chamber Body	B. 199	B. 185	B. 133	B. 199	B. 199	B. 199	B. 185	5 0
Cover complete	B. 205	B. 205	B. 205	B. 205	B. 205	B. 205	B. 205	5 0
Cover only	B. 95	B. 95	B. 95	B. 95	B. 95	B. 95	B. 95	4 0
Needle Valve	B. 359	B. 359	B. 359	B. 359	B. 359	B. 359	B. 359	5 0
Float and Needle	B. 93	B. 93	B. 93	B. 93	B. 93	B. 93	B. 93	2 0
Float only	B. 347	B. 347	B. 347	B. 347	B. 347	B. 347	B. 347	2 0
Valve Seat	B. 94	B. 94	B. 94	B. 94	B. 94	B. 94	B. 94	1 0
Tickler	B. 96	B. 96	B. 96	B. 96	B. 96	B. 96	B. 96	1 0
Tickler Spring	B. 98	B. 98	B. 98	B. 98	B. 98	B. 98	B. 98	1 0
Split Pin	B. 97	B. 97	B. 97	B. 97	B. 97	B. 97	B. 97	1 0
Union Nut	B. 36	B. 36	B. 36	B. 36	B. 36	B. 36	B. 36	2 0
Nipple	B. 37	B. 37	B. 37	B. 37	B. 37	B. 37	B. 37	6 0
Small Filter	B. 35	B. 35	B. 35	B. 35	B. 35	B. 35	B. 35	1 0
Needle Valve Seat for Horizontal Petrol Pipe connection	B. 382	B. 382	B. 382	B. 382	B. 382	B. 382	B. 382	1 0
Horizontal Petrol Pipe fitting	B. 380	B. 380	B. 380	B. 380	B. 380	B. 380	B. 380	1 0
Blind Nut for above	B. 381	B. 381	B. 381	B. 381	B. 381	B. 381	B. 381	1 0
Blind nut Washers	B. 377	B. 377	B. 377	B. 377	B. 377	B. 377	B. 377	3d. each

TOP FEED FLOAT CHAMBER PARTS.

Binks 2-Jet Carburettors

**BINKS CARBURETTORS, 1927 and 1928.
MIXING CHAMBER PARTS.**

COMPONENT	H.	J.	K.	L.	HA.	JA.	KA.	LA.	List Price
Mixing Chamber	B. 140	B. 110	B. 140	B. 110	B. 532	B. 102	B. 140	B. 110	20 0
Jet Seat	B. 512	B. 512	B. 512	B. 512	B. 514	B. 513	B. 512	B. 512	1 0
Throttle Valve	B. 517	B. 517	B. 517	B. 517	B. 517	B. 517	B. 517	B. 517	2 0
Air Valve	B. 530	B. 170	B. 530	B. 170	B. 520	B. 530	B. 530	B. 170	2 0
Valve Springs	B. 509	B. 509	B. 509	B. 509	B. 510	B. 500	B. 509	B. 509	1 0
Top Plate	B. 144	B. 116	B. 144	B. 116	B. 187	B. 187	B. 144	B. 116	1 0
Hex. Nut	B. 528	B. 528	B. 528	B. 528	B. 528	B. 528	B. 528	B. 528	1 0
Flat spring	B. 308	B. 308	B. 308	B. 308	B. 308	B. 308	B. 308	B. 308	3 0
Rivets for ditto	B. 604	B. 604	B. 604	B. 604	B. 604	B. 604	B. 604	B. 604	3 0
3-B.A. screws	B. 145	B. 145	B. 145	B. 145	B. 145	B. 145	B. 145	B. 145	3 0
Spring for Screw	B. 146	B. 146	B. 146	B. 146	B. 146	B. 146	B. 146	B. 146	3 0
Cable Adjusting Screw	B. 201	B. 21	B. 201	B. 21	B. 201	B. 201	B. 201	B. 21	1 0
Locknut for ditto	B. 120	B. 120	B. 120	B. 120	B. 120	B. 120	B. 120	B. 120	6 0
Pinchbolt	B. 121	B. 121	B. 121	B. 121	B. 121	B. 121	B. 121	B. 121	6 0
Pilot Jet	B. 433	B. 1	B. 433	B. 1	B. 433	B. 433	B. 433	B. 1	1 0
Main Jet	B. 558	B. 175	B. 558	B. 175	B. 558	B. 558	B. 558	B. 175	1 0
Blowback Cap	B. 337	B. 337	B. 337	B. 337	B. 337	B. 337	B. 337	B. 337	1 0
Intake Ring	B. 482	B. 482	B. 482	B. 482	B. 482	B. 482	B. 482	B. 482	1 0
Intake Gauze	B. 481	B. 481	B. 481	B. 481	B. 481	B. 481	B. 481	B. 481	1 0
Shutter Back Plate	B. 584	B. 584	B. 584	B. 584	B. 584	B. 584	B. 584	B. 584	1 0
Shutter Plate Lever	B. 687	B. 687	B. 687	B. 687	B. 687	B. 687	B. 687	B. 687	1 0
Shutter Holding Screws 3 B.A.	B. 488	B. 488	B. 488	B. 488	B. 488	B. 488	B. 488	B. 488	1 0
Ditto 0 B.A.	B. 606	B. 606	B. 606	B. 606	B. 606	B. 606	B. 606	B. 606	1 0
Shutter Spring	B. 695	B. 695	B. 695	B. 695	B. 695	B. 695	B. 695	B. 695	1 0
Shutter Rivet	B. 106	B. 106	B. 106	B. 106	B. 106	B. 106	B. 106	B. 106	1 0
Shutter Washer	B. 487	B. 487	B. 487	B. 487	B. 487	B. 487	B. 487	B. 487	1 0
Float Chamber Washer	B. 536	B. 536	B. 536	B. 536	B. 536	B. 536	B. 536	B. 536	1 0
Float Chamber Holding Screw	B. 533	B. 487	B. 533	B. 487	B. 533	B. 533	B. 533	B. 487	3 0

COMPONENT	H.	J.	K.	L.	HA.	JA.	KA.	LA.	List Price
Float Chamber complete	B. 413	B. 413	B. 413	B. 413	B. 413	B. 413	B. 413	B. 413	4 0
Float Chamber Body	B. 426	B. 426	B. 426	B. 426	B. 426	B. 426	B. 426	B. 426	5 0
Cover	B. 306	B. 306	B. 306	B. 306	B. 306	B. 306	B. 306	B. 306	4 0
Needle Valve	B. 30	B. 30	B. 30	B. 30	B. 30	B. 30	B. 30	B. 30	2 0

BOTTOM FEED FLOAT CHAMBER PARTS.

BINKS MOUSETRAP CARBURETTERS, 1923 to 1928.

SPECIAL NOTE. The 1923 to 1925 models inclusive were 2-jet instruments having the first or pilot jet immediately below the throttle valve and the main jet in the venturi intake of the carburetter.
The 1926 to 1928 models inclusive were 3-jet instruments having the first and second pilot jet underneath the throttle valve and the main jet in the venturi intake.

Model	Throttle Diameter.	Choke Bore.	Induction Pipe Dia.
238	1 1/8"	1"	1 1/8"
250	1 1/8"	1 1/8"	1 1/8"
274	1 1/8"	1 1/8"	1 1/8"
282	1 1/8"	1 1/8"	1 1/8"
294	1 1/8"	1"	1 1/8" cranked neck.

SPARE PARTS FOR MIXING CHAMBER.

For illustrations refer below, and for the number of component required refer to page 41 under the column headed with your particular model.

Note.—When ordering mixing chamber bodies it is advisable to send in your old mixing chamber as pattern.

SPARE PARTS FOR FLOAT CHAMBERS.

For illustrations refer to page 34 and for the part number of component refer to pages 36 and 37. Column L for 238, 250 and 282 models and column K for 274 and 294 models.

SPARE PARTS FOR CONTROL LEVERS.

For illustrations and part number of component refer to page 30.

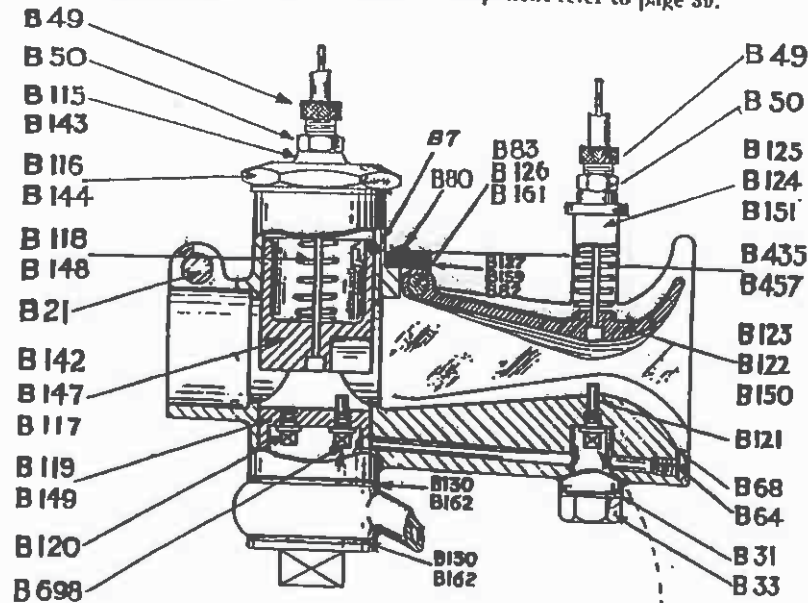

Binks Mousetrap Carburetter

SPECIFICATION FOR BINKS MOUSETRAP CARBURETTERS, 1923 to 1928.

COMPONENT	1 1/8" dia.	1 1/8" dia.	1"	1"	Price
	Throttle 1 1/8" Engine End	Throttle 1 1/8" Engine End	Throttle 1" Engine End	Throttle 1" Engine End	
Mixing Chamber ...	250	238	274	294	s. d.
Mixing Chamber Top ...	B.116	B.115	B.143	B.143	20 0
Mixing Chamber Cap ...	B.116	B.116	B.144	B.144	1 0
Cable Adjusting Screw ...	B. 40	B. 40	B. 40	B. 40	1 0
Lock nut for ditto ...	B. 60	B. 60	B. 60	B. 60	1 0
Throttle Valve ...	B.142	B.117	B.147	B.147	2 6
Throttle Key or Guide Screw ...	B. 7	B. 7	B. 7	B. 7	3
Throttle Valve Springs ...	B.118	B.118	B.148	B.148	9
Pinch Bolt ...	B. 21	B. 21	B. 21	B. 21	6
Outlet Clip ...	—	—	B.155	—	9
Outlet Clip Bolt ...	—	—	B.156	—	6
Nut for ditto ...	—	—	B.157	—	3
Pilot Jet ...	B.130	B.120	B.120	B.120	1 0
Second Pilot Jet ...	B.008	B.008	B.008	B.008	1 0
Main Jet ...	B.121	B.121	B.121	B.121	1 0
Main Jet Cap ...	B. 33	B. 33	B. 33	B. 33	2 0
Main Jet Cap Washer ...	B. 31	B. 31	B. 31	B. 31	3
Dust Screw ...	B. 04	B. 04	B.153	B.153	3
Fibre Washer for ditto ...	B. 68	B. 68	B.154	B.154	2
Jet Seat (2 jet) ...	B.119S	B.110S	B.140S	B.140S	1 6
Jet Seat (3 jet) ...	B.110	B.110	B.140	B.140	1 6
Union Nut ...	B.230	B.230	B.231	B.231	2 6
Washer for ditto ...	B.130	B.130	B.162	B.162	6
Filter Gauze for Union Nut ...	B.134	B.134	B.166	B.166	1 0
Float Chamber Holding Screw ...	B.233	B.233	B.233	B.233	2 6
Washer for ditto ...	B.234	B.234	B.234	B.234	2
Felt Plate ...	B.128	B. 81	B.160	B.160	6
Felt Plate Screws ...	B. 80	B. 80	B. 80	B. 80	3
Felt Pad ...	B.127	B. 82	B.150	B.150	6
Venturi Shutters ...	B.123	B.122	B.150	B.150	4 0
Hinge Pin for ditto ...	B.126	B. 83	B.161	B.161	0
Split Pin for ditto ...	B.120	B.120	B.120	B.120	1
Shutter Bracket ...	B.125	B.124	B.151	B.151	3 0
Screws for ditto ...	B. 80	B. 80	B. 80	B. 80	3
Spring for ditto ...	B.435	B.435	B.457	B.457	9
Float Chamber Holding Screw ...	B. 87	B. 87	B. 87	B. 87	2 6
Filter Gauze for ditto ...	B.119	B.110	B.166	B.166	1 0
Washers for F/Chamber Holding Screw ...	B.130	B.130	B.162	B.162	3
Jet Key ...	B.202	B.202	B.202	B.202	1 0

Spare for Float Chamber 1923 to 1925 see page 35—36
1926 to 1928 " 37—38
Control Lever Spares see page 39

The following are the various models manufactured during the above period.

- B.S.V.** 1 1/4" diameter Throttle Valve. Combined easy starting and Pilot Jet Device on side of Mixing Chamber.
- L.S.V.** 1 1/4" diameter Throttle Valve. Taper Needle attached to Throttle Valve. Combined easy starting and Pilot Jet Device on side of Mixing Chamber.
- B.O.D.** 1 1/4" diameter Throttle Valve. No Pilot Jet or Taper Needle.
- L.O.D.** 1 1/4" diameter Throttle Valve. No Pilot Jet or Taper Needle.
- T.O.D.** Similar to type **L.O.D.** but with a 3/4" diameter choke and fitted with a domed dust cap.
- B.A.B.** Special 1 1/4" Throttle Valve. Jets screwed in from underneath with screw-driver. Float chamber is attached to Mixing Chamber with a nut. All the above Carburettors, with the exception of **B.A.B.**, have float chambers attached to Mixing Chambers by means of a clip fitting.

SPARE PARTS FOR MIXING CHAMBERS.

The specification and illustration for these will be found on page 43 & 44. To ascertain the component number refer to page 44 under the column headed with your particular model.

FLOAT CHAMBERS.

The illustrations for these will be found on page 43. To ascertain the component number required refer to specification on page 44 under the column headed with the feed.

SPARE PARTS FOR CONTROL LEVERS.

The illustrations for these will be found on page 43 and the specification or list of parts on page 50.

SPECIFICATION OF B. AND B. 1923 DOUBLE LEVER CONTROL.

COMPONENT	Detail No.	Price
Control Lever Body R.H. (open outwards)	C.1.A.	2 0
Ditto L.H. (open inwards)	C.1.B.	2 0
Spring Washer	C.3.	5
Top Cap	C.2.	1 0
Throttle Lever R.H. (open outwards)	C.4.A.	2 6
Throttle Lever L.H. (open inwards)	C.4.B.	2 6
Air Lever R.H. (open outwards)	C.5.A.	2 6
Air Lever L.H. (open inwards)	C.5.B.	2 6
Division Plate	C.6.	4
Centre Screw	C.8.	3
Bar Clip	C.10.	1/6 per pr
Rivet (for clips)	C.11.	3 per pr
Clip Screw	C.110.	3
Liner for 3/4" Bar	C.20.	5 per pr
Liner for 1/2" Bar	C.19.	5 per pr
Lever Nipple	C.14.	2 2
Throttle Nipple	C.15.	2 2
Spring Guide	C.21.	2
Inner Wire (state length)	C.23.	2 per ft.
Outer Cable (state length)	C.22.	6 per ft.

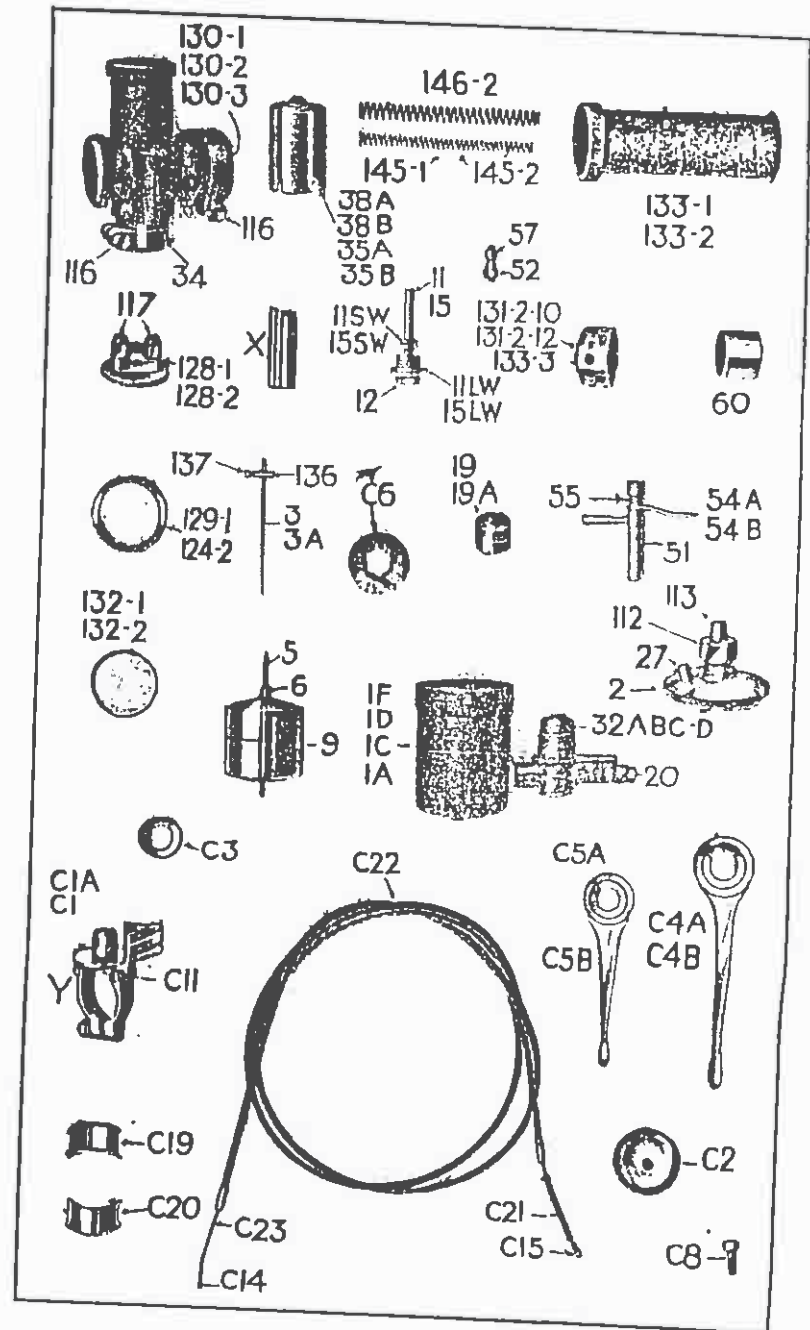

X 40A, 40B, 37A, 37B, Y C10, C116. CI should read C11.
NOTE - 130-1.2.3 should read 120-1.2.3

	BSV	LSV	100	100	100	Price
	Throttle	Throttle	Pilot	Pilot	2 Stroke	
Spraying Chamber	—	—	—	—	—	s. d.
Spraying Chamber Cap Ring ...	120/1	120/2	120/1	120/2	120/2	8 6
Spraying Chamber Cap	128/1	128/2	128/1	128/2	128/2	1 0
Cable Adjust'g Bush	117	117	117	117	117	1 8
Throttle Valve ...	38A.	38B.	35A.	36D.	35B.	4
Air Valve ...	40A.	40B.	37A.	37B.	37B.	8 9
Throttle Guide Pin	supplied in pairs only.					per pr
Vaporizing Cap	115	115	115	115	115	3
Choke ...	19	19	10A.	10A.	10A.	1 8
Taper Needle (Twin Cyl.) ...	32B.	32B.	32A.	32C.	32D.	1 8
Taper Needle (Single Cyl.) ...	3A.	3A.	—	—	—	1 0
Needle Holder ...	3	3	—	—	—	1 0
Screw for ditto ...	136	136	—	—	—	2
Jet (state size)	137	137	—	—	—	2
Stop Screw for Jet	11	11	15	15	15	1 0
Washer for ditto	12	12	114	114	114	3
Washer for Jet (small)	12N.	12N.	158/2	158/2	158/2	1
Washer for Jet (large)	11SW.	11SW.	15SW.	15SW.	15SW.	1
Outlet Clip 1 1/4"	11LW.	11LW.	15LW.	15LW.	15LW.	1
Outlet Clip 1 1/2"	130/1	130/1	130/1	130/1	130/1	1 5
Outlet Clip 1 3/4"	130/2	130/2	130/2	130/2	130/2	1 5
Outlet Clip Screw ...	130/3	130/3	130/3	130/3	130/3	1 5
1/4" Lock Ring ...	110	110	110	110	110	3
Pin for ditto ...	34	34	34	34	34	1 5
Pilot Sleeve with h'dle	110	110	110	110	110	3
Flat Spring for ditto	81	81	—	—	—	2 0
Pilot Jet ...	54A.	54B.	—	—	—	3
Pilot Adjusting Screw	52	52	—	—	—	10
Spring for ditto ...	56	56	—	—	—	5
Rubber Washer for do.	55	55	—	—	—	3
Dust Cap ...	57	57	—	—	—	1
Gauze for ditto ...	120/1	120/2	120/1	—	120/2	1 0
Back Cap with 10 holes	132/1	132/2	132/1	132/2	—	6
Ditto with 12 holes	—	—	—	—	131/2/10	1 8
Ditto Enfield T/Valve	—	—	—	—	131/2/12	1 8
Spring ...	145/1	145/2	145/1	145/2	145/2	7
A Valve Spring ...	145/2	140/2	145/2	140/2	140/2	7
Extension Pipe ...	133/1	133/2	133/1	133/2	—	2 1
Float Chamber Body (Long P.) ...	1F.	1F.	1D.	1D.	1D.	8 0
Ditto (Short P.) ...	1C.	1C.	1A.	1A.	1A.	8 0
F Chamber Cover Complete TF....	C 2	C 2	C 2	C 2	C 2	4 3
Cover only ...	2	2	2	2	2	2 11
Tickler Punger ...	27	27	27	27	27	5
Tickler Bush ...	20	20	20	20	20	7
Tickler Spring ...	20	20	20	20	20	2
Float ...	0	0	0	0	0	2 6
Needle and Collar	5 & 6	5 & 6	5 & 6	5 & 6	5 & 6	1 2
Union Nut ...	112	112	112	112	112	6
Union Nipple ...	113	113	113	113	113	3

Reducing Bush for Outlet No. 00 (state size of Engine Stubby)

B. & B. Carburetters, 1924-8

B. AND B. CARBURETTERS, 1924 to 1928 INCLUSIVE.

The following are the various models manufactured during the above period.

- Model 120** 1 1/4" diameter Throttle Valve.
Pilot Jet and Pilot Adjusting Screw on opposite sides of outlet. Supplied in Needle or Plain type.
- Model 121** 1/2" diameter Throttle Valve.
Overall length 1 3/5" approx.
Pilot Jet and Pilot Adjusting Screw on opposite sides of outlet. Supplied in Needle or Plain type.
- Model 122** 1/2" diameter Throttle Valve.
Overall length 1 1/4" approx.
No Pilot Jet.
Supplied in Plain type only with domed dust cap.
- Model 123** 1/2" diameter Throttle Valve.
Overall length 1" approx.
No Pilot Jet.
The Float Chambers for all the above models are secured to the Mixing Chambers by the Jet Bolt.
A Choke, with a gauze Cover, is fitted in bottom of Mixing Chamber.

SPARE PARTS FOR MIXING CHAMBERS.

The specification and illustration for these will be found on page 47. To ascertain the component number refer to page 48 under the column headed with your particular model.

FLOAT CHAMBERS.

The illustrations for these will be found on page 47. To ascertain the component number required refer to specification on page 49 under column headed with the feed.

SPARE PARTS FOR CONTROL LEVERS.

The illustrations for these will be found on page 47 and the specification or list of parts on page 61

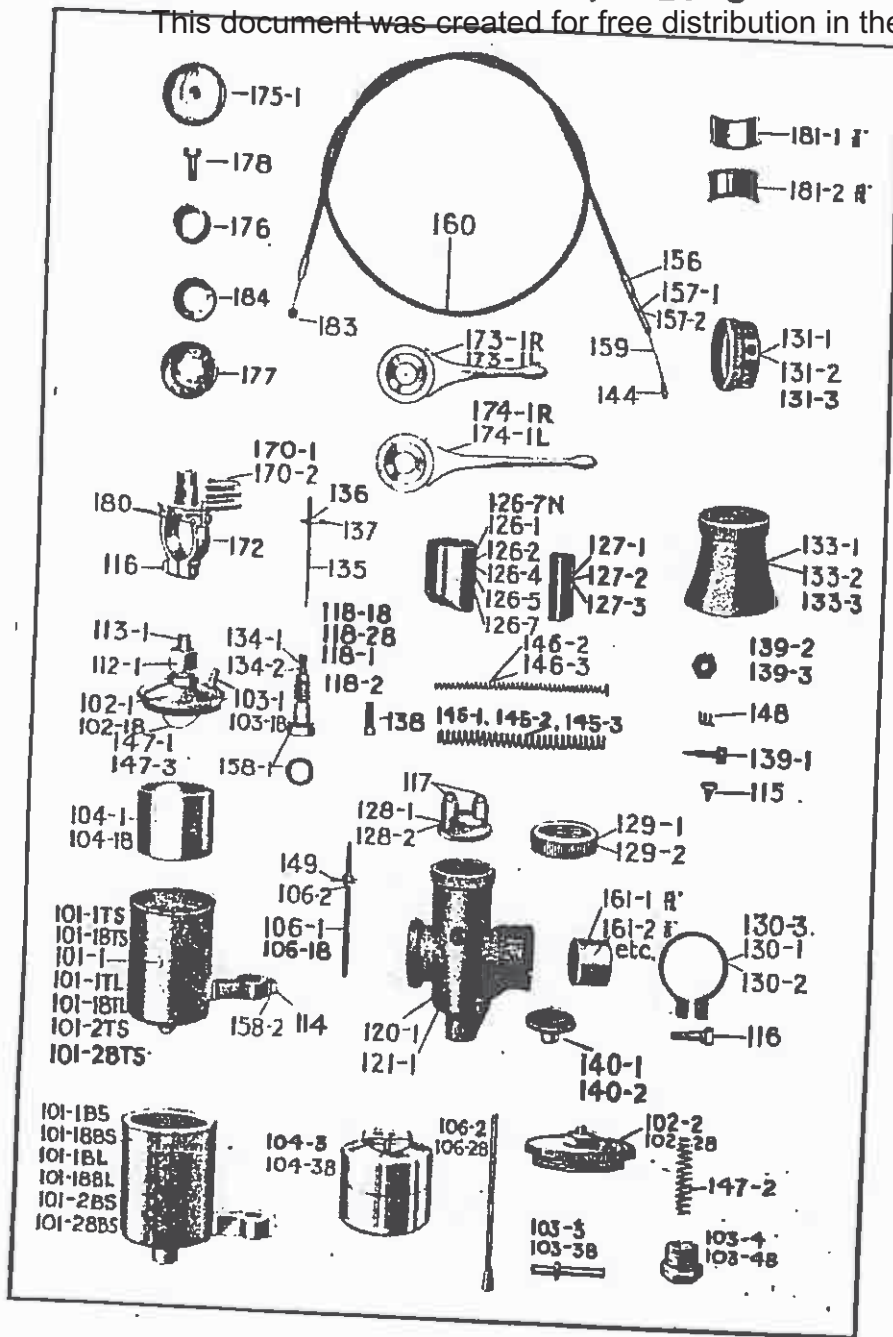

B. & B. Carburetors

SPECIFICATION OF B. AND B. MIXING CHAMBER PARTS, 1924 to 1928

COMPONENT	120 1 1/2" Thr.	121 1 1/4" long	122 1 1/8" Thr. No. Pilot 1 1/2" long	123 1 1/8" Thr. 1" long	Price
Mixing Chamber ...	—	—	—	—	s. d. 8 6
Throttle Valves (plain type) ...	120/1	120/4	120/4	120/7	Supplied
Throttle Valve (Needle type) ...	120/2	120/6	—	126/7N	in pairs only 6/9
Air Valves ...	127/1	127/2	127/2	127/3	
Throttle Valve Single Lever ...	126/3	120/6	126/6	126/8	6 9
Spraying Chamber Cap	128/1	128/2	128/2	128/2	1 8
Spraying Chamber Cap Ring ...	120/1	120/2	120/2	129/2	1 0
Outlet Clip 1 1/2" ...	130/1	130/1	130/1	130/1	1 5
Outlet Clip 1 1/4" ...	—	130/2	130/2	130/2	1 5
Outlet Lock Nut 1 1/8" x 20	130/3	—	—	—	1 5
—	130/4	130/4	(Matchless Motor Cycles)	—	1 0
Back Cap ...	131/1	131/2	131/2	131/2	1 8
Back Cap Enfield ...	—	131/3	131/3	131/3	1 8
Gauze for ditto ...	—	132/1	132/1	132/1	1 6
Extension Pipe (Bell) ...	133/1	133/2	133/2	133/2	2 1
Extension Pipe Parallel type ...	—	133/3	133/3	133/3	2 1
Std. Jet Nipple Main ...	134/1	134/1	134/1	134/1	6
Std. Jet Nipple Needle ...	134/2	134/2	—	134/2	6
Taper Needle ...	135	135	—	135	1 0
Needle Holder ...	136	136	—	136	2
Screw for ditto ...	137	137	—	137	2
Jet Pilot ...	138	138	—	138	10
Pilot Adj. Screw ...	130/1	130/1	—	130/1	5
Lock Nut for ditto ...	130/2	130/2	—	130/2	2
Lock Nut (Matchless) ...	130/3	130/3	—	130/3	2
Choke ...	140/1	140/2	140/2	140/2	1 8
Screw Driver ...	143	143	—	143	1
Cable Nipple (Carb. End) ...	144	144	144	144	2
Throttle Valve Spring ...	145/1	145/2	146/2	146/3	7
Air Valve Spring ...	145/2	146/2	146/2	146/3	7
Pilot Adj. Screw Spring ...	148	148	—	148	2
Spring Guide ...	167/1	167/1	167/1	167/1	5d. pr
Washer for Holding Bolt ...	168/1	168/1	168/1	168/1	1
Washer for Pilot Jet (not used 1928) ...	168/3	168/3	—	168/3	1
Outlet Liner 1" to 1 1/4" ...	—	161/1	161/1	161/1	3
Outlet Liner 1" to 1 1/8" ...	—	161/2	161/2	161/2	3
Outlet Liner 1 1/2" to 1 1/4" ...	161/3	—	—	—	3
Outlet Liner 1 1/4" to 1 1/8" ...	—	161/4	161/4	161/4	3
Outlet Liner 1 1/8" to 1 1/4" ...	161/5	—	—	—	3

COMPONENT	1 1/4" Thr.	1 1/2" long	1 1/2" Thr. No. Pilot 1 1/4" long	1 3/4" Thr. 1" long	Price
Outlet Liner 1 1/4" to 1"	161/6	161/6	161/6	—	5. d. 3
Stop Screw	114	114	114	—	3
Washer for ditto	158/2	158/2	158/2	158/2	1
Rivet for Throttle	115	115	115	115	3
Outlet Clip Pin	116	116	116	116	3
Cable Adjuster	117	117	117	117	4
Jet Bolt (Needle Type)	118/2	118/2	—	118/2	1 3
Jet Bolt (Plain Type)	118/1	118/1	118/1	118/1	1 3
Jet and Bolt Complete Needle Type	118/2	118/2	—	118/2	1 0
Jet Bolt Complete	134/2	134/2	—	134/2	1924 1 0
Plain Type	118/1	118/1	118/1	118/1	to
Jet Bolt Complete	134/1	134/1	134/1	134/1	1927 1 0
Needle Type	118/28	118/28	—	118/28	1 0
Jet and Bolt Complete	134/2	134/2	—	134/2	1 0
Plain Type	118/18	118/18	118/18	118/18	1 0
Jet Bolt Needle Type	134/1	134/1	134/1	134/1	1928 1 0
Jet Bolt Plain Type	118/28	118/18	—	118/28	only 1 3
Jet Bolt Plain Type	118/18	118/18	118/18	118/18	1 3

SPECIFICATION OF B. AND B. FLOAT CHAMBER.

COMPONENT	1924/7 T.F.	1924/7 B.P.	1928 T.F.	1928 B.F.	Price
Float Chamber Comp.					a. d.
Short Platform	101/1TSC	101/nsc	101/18TSC	101/nsc	17 0
Float Chamber Comp.					
Long Platform	101/1TLC	101/1nLC	101/18TLC	101/18nLC	17 0
Float Chamber Comp.					
Enfield	101/2TSC	101/2nsc	101/28TSC	101/28nsc	17 0
Float Chamber Body					
Short Platform	101/1TS	101/1ns	101/18TS	101/18ns	8 0
Float Chamber Body					
Long Platform	101/1TL	101/1nL	101/18TL	101/8DL	8 0
Float Chamber Body					
Enfield	101/2TS	101/2ns	101/28TS	101/28ns	8 0
Cover Complete Std.	102/1c	102/2c	102/18c	102/28c	4 3
Cover Comp. Enfield	102/1ce	102/2ce	102/18ce	102/28ce	4 3
Cover only	102/1	102/2	102/18	102/28	3 4
Tickler Std.	103/1	103/3	103/18	103/28	5 5
Tickler Enfield	103/2	103/3E	103/28	103/28	5 5
Tickler Spring	147/1	147/2	147/3	147/3	2 2
Tickler Bush	—	103/4	103/48	103/48	2 6
Float	104/1	104/3	104/18	104/38	4 4
Needle (Comp.)	100/1	106/2	106/18	106/28	1 2
Needle Enfield Comp.	106/3	106/4	106/38	106/48	1 2
Needle Collar	105/2	—	—	—	2 2
Stop Pin	114	114	114	114	3 3
Union Nut	112/1	112/1	112/1	112/1	6 6
Union Nipple 1/4 in. Pipe	113/1	113/1	113/1	113/1	3 3
Union Nipple 1/2 in. Pipe	113/2	113/2	113/2	113/2	3 3
Banjo (Side Feed)	108	—	108/8	—	1 6
Banjo Nut	109	—	109/8	—	6 6
Washers for ditto	1058/4	—	1058/4	—	2 2

B. & B. Carburettors, 1924 - 8.

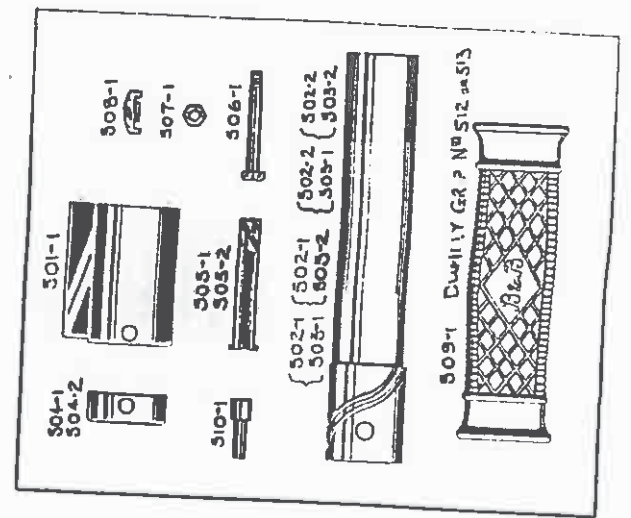
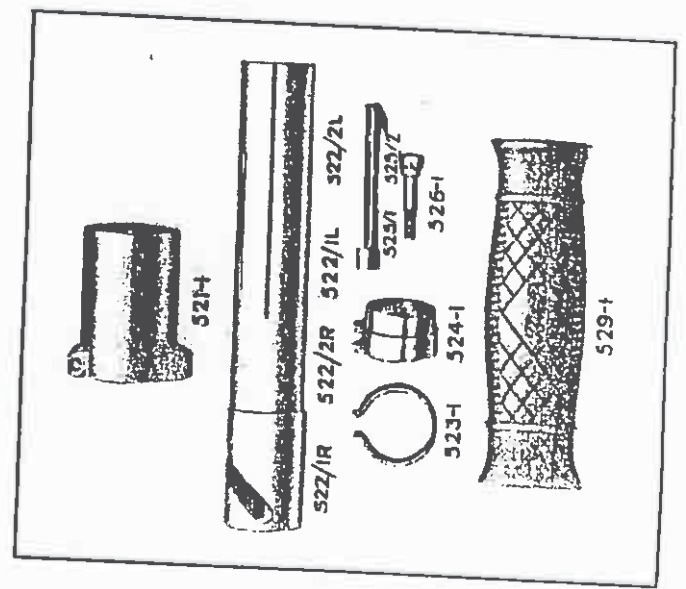

1929 Amal and Binks Carburettors.

SPECIFICATION OF 1926 B. AND B. GRIP TWIST CONTROL.

COMPONENT	Double open In L.H.	Double open out R.H.	Single open In L.H.	Single open out R.H.	Price
Control Body	170/2	170/1	171/2	171/1	s. d.
Bar Clips	172	172	172	172	1 9
Throttle Lever Long	174/1L	174/1R	—	—	1 6 pr.
Air Lever Short	173/1L	173/1R	173/1L	173/1R	2 0
Special Throttle Lever (Morgan)	—	174/2	—	—	2 6
Cap	175/1	175/1	175/1	175/1	1 0
Spring Washer	176	176	176	176	5
Division Plate	177	177	—	—	4
Centre Screw	178	178	178	178	3
Clip Screw	110	110	110	110	3
Rivets for Clip	180	180	180	180	3 pr.
Liners, 3/8-in.	181/2	181/2	181/2	181/2	5 pr.
Liners, 1/2-in.	181/1	181/1	181/1	181/1	5 pr.
Cable Nipple	183	183	183	183	3 pr.
Fibre Washer	184	184	184	184	1
Douglas Centre Stud	172/D	172/D	—	—	3
Morgan Centre Stud	172/M	172/M	—	—	3
Number Bolt	172H	172H	172H	172H	3
Washers for Douglas and Number Studs	172/W	172/W	172/W	172/W	1
Nuts for Douglas and Morgan Studs	172/N	172/N	—	—	3
Inner Cable No. 150	state length required.				8 ft.
Outer Cable No. 160	state length required.				8 ft.

The following are the various models manufactured during the above period.

- Type 4, 5 and 6.** These Models comprise the best features of both the Amal and B. and B. Carburettors, having an Adjustable Pilot and Variable Main Jet, controlled by a Taper Needle. Were supplied with Single or Double Levers, also Rod Control Single or Double. Single Lever Carburettors are usually fitted with a Plunger on top of the Mixing Chamber to regulate the Air.
- Type 7, 8 and 9.** These Models are the Improved Bink's 2-jet Carburettor 102M Model, having an improved internal construction, being supplied with either Double or Single Levers, or Rod Controls, same as Models 4, 5 and 6.
- Type 26, 27 and 28.** These Models are the Amal Track Racing Carburettors. Twin float chambers were standardized on models 27 and 28.
- Type 250, 282, 238, 274 and 294.** Binks Fast Touring and Racing Carburettors of the Mousetrap pattern. For components of mixing chamber and float chamber refer to page 41.

SPECIFICATION OF 1927-8 GRIP TWIST CONTROL B. AND B.

COMPONENT	R.H. 1"	R.H. 3/4"	L.H. 1"	L.H. 3/4"	Price
Body	501/1	501/1	501/1	501/1	s. d.
Helix	502/1	502/1	502/2	502/2	4 6
Tube	503/1	503/2	503/1	503/1	3 6
Collar	504/1	504/2	504/1	504/2	1 0
Sliding Bar	505/1	505/1	505/2	505/2	1 6
Bolt	506/1	506/1	506/1	506/1	3
Nut	507/1	507/1	507/1	507/1	3
Cable Stop Rear	508/1	508/1	508/1	508/1	0
Rubber Grip	509/1	509/1	509/1	509/1	2 0
Cable Stop Front	510/1	510/1	510/1	510/1	1 0
Spring for tube	511/1	511/2	511/1	511/2	2
Dummy Grip	512	513	512	513	2 0

MIXING CHAMBER COMPONENTS.

1.—Note the type number of the carburettor, which will be found stamped on the outlet of the Mixing Chamber, the actual type number being the figure preceding the stroke; e.g., if your mixing chamber is stamped 4/022, the type number is 4.

2.—Look on page 53 for the illustration of the part required. The part number is the number which shows the same type number as your carburettor, e.g., assuming you require a Jet Needle, this you will observe, by looking at the illustration, has 3 numbers: 4/065, 5/065 and 6/065, therefore your part number would be 4/065.

You will notice, however, that some of these components bear only one number, in which case this number is common to all types of carburettors. Also, some of these components bear only 2 numbers; therefore, should your type number not be one of these two, you should refer to the list of parts on page 54, and in the column headed with your Carburettor Type No., you will find which of these two numbers refers to your particular requirement.

3.—Refer to page No. 54, under column headed with the type number of your Carburettor for the number of the component required, and you will then be able to ascertain the correct name and price of same.

4.—There are three mixing chamber components which owing to their being manufactured in various sizes to suit particular engines, you will not be able to describe correctly by the aforementioned method; these are *Throttle Valves, Jet Block Barrels and Jets*. When ordering these, it is necessary to carry out the following instructions.

Throttle Valve. Proceed as above, in addition quote the "cut away" number which you will find stamped on the top of the Throttle Valve; this will ensure your obtaining the correct cut-away, e.g., assuming your valve is stamped 4/5, your order should read as follows:—

"One A.M.A.I. Throttle Valve No. 4/052 — 'Cut-away' No. 4/5."

Jet Block Barrel. On the top of the barrel you will find stamped a bore number. Assuming yours is stamped No. 25, you will observe by referring to the list of parts on page 54 that the part No. for that component is 4/059.

Jet. The size of this component is stamped on one flat of the hexagon.

A list showing sizes of Jets will be found on page 78. Order Jets, for example as follows:—

12 A.M.A.I. Jets 4/042, size No. 65, the price of these being ... 5d. each.

In the case of BINKS Carburettors, state whether Pilot or Main Jets, together with size required.

FLOAT CHAMBER COMPONENTS.

First of all ascertain which float chamber you possess, i.e., large or small, top or bottom feed; the large float chamber is 1 1/4-in. diameter, and the small float chamber is 1-in. diameter.

Top Feed is when your petrol pipe is connected to the float chamber cover, and the bottom feed is when the petrol pipe is connected to the bottom of the float chamber. Refer to illustrations below and on page 53, and then refer to page 56 for the name and price of the component.

CONTROL LEVER COMPONENTS.

Apart from the standard double and single levers controls fitted on above models (spares list and illustrations of which will be found on page 58) we have made other controls, i.e., Trigger lever, Tom TH lever, Inverted levers for twist grips, Straight pull Clutch lever and a double lever combined with pull up lever.

Spares and illustrations of the latter will be found on pages 57 to 65 inclusive.

TWIST GRIP COMPONENTS.

Standard Amal and Binks quick action twist grips are fitted to Amal Carburettors. Illustrations of same together with list will be found on pages 66 to 67.

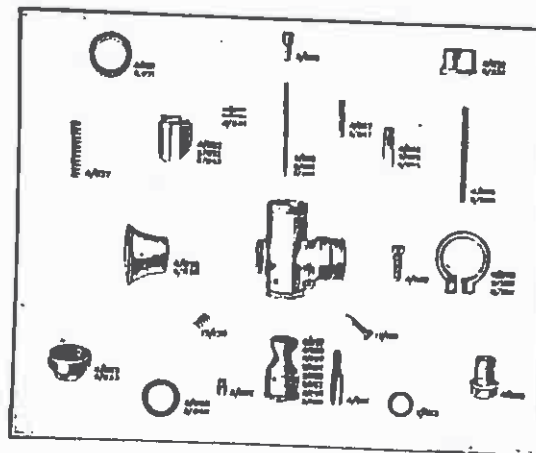

1929-30
Amal—Binks
Carburettors

Amal Mixing
Chamber Parts

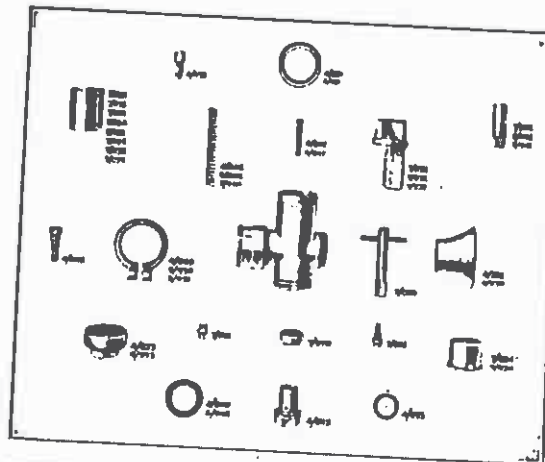

Binks Mixing
Chamber Parts

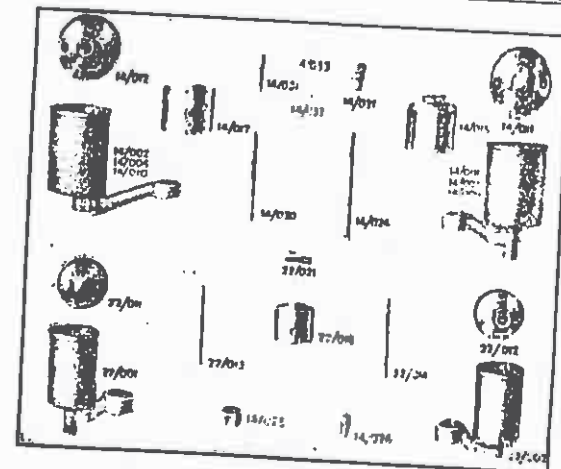

Float Chamber
Parts

MIXING CHAMBER PARTS.

Component	PART NUMBERS.						PRICE s. d.
	AMAL CARBURETTORS.			BINKS CARBURETTORS.			
	Type 4.	Type 5.	Type 6.	Type 7.	Type 8.	Type 9.	
Mixing Chamber ...	According to engine	According to engine	According to engine	According to engine	According to engine	According to engine	8 0
Mixing Chamber ...	4/057	5/057	6/057	7/034	7/034	7/034	10 0
Mixing Chamber ...	4/058	5/058	6/058	4/033	4/033	4/033	12 0
Mixing Chamber ...	4/050	5/050	6/050	4/031	4/031	4/031	0 0
Jet Block and Barrel complete, Size 17 ...	—	—	—	—	—	—	0 0
Size 21 ...	—	—	—	—	—	—	0 0
Size 25 ...	—	—	—	—	—	—	0 0
Size 28 ...	—	—	—	—	—	—	0 0
Size 33 ...	—	—	—	—	—	—	0 0
Size 30 ...	—	—	—	—	—	—	0 0
Size 45 ...	—	—	—	—	—	—	0 0
Size 51 ...	—	—	—	—	—	—	0 0
Jet Block (Binks) ...	—	—	—	—	—	—	0 0
Mixing Chamber Union Nut	4/033	4/033	4/033	7/034	7/034	7/034	5 0
Mixing Chamber Cap	4/031	4/031	4/031	4/033	4/033	4/033	1 0
Mixing Chamber Top	4/032	4/032	4/032	4/031	4/031	4/031	1 0
Cable, per length complete	—	—	—	8/032	8/032	8/032	1 0
Midway Cable Adjusters	—	—	—	—	—	—	2 3
Cable Stop (Top Hat Shape)	6/132	6/132	6/132	—	—	—	3 0
Cable Adjusters ...	4/035	4/035	4/035	6/132	6/132	6/132	1 1
Cable Nipples ...	4/034	4/034	4/034	4/035	4/035	4/035	2 4
Throttle Valve Spring	4/037	4/037	4/037	4/036	4/036	4/036	2 4
Air Funnel ...	4/038	4/038	4/038	4/037	4/037	4/037	2 4
Washer for Jet Block	4/040	4/040	4/040	4/038	4/038	4/038	2 4
Spring Clip for Needle	4/041	4/041	4/041	4/038	4/038	4/038	2 4
Holding Bolt ...	4/043	4/043	4/043	4/040	4/040	4/040	2 4
Air Valve ...	4/045	4/045	4/045	4/041	4/041	4/041	2 4
Air Valve Spring ...	4/046	4/046	4/046	4/043	4/043	4/043	2 0
Air or Throttle Valve Guide	4/047	4/047	4/047	7/045	7/045	7/045	2 0
Outlet Clip Screw ...	4/048	4/048	4/048	7/046	7/046	7/046	2 0
Outlet Clip, 1-in. ...	4/049	4/049	4/049	4/047	4/047	4/047	2 2
Outlet Clip, 1 1/4-in.	—	5/050	5/050	4/048	4/048	4/048	2 2

†

MIXING CHAMBER PARTS.

Component	PART NUMBERS.						PRICE s. d.
	AMAL CARBURETTORS.			BINKS CARBURETTORS.			
	Type 4.	Type 5.	Type 6.	Type 7.	Type 8.	Type 9.	
Outlet Clip, 1 1/4-in.	4/062	5/062	6/061	—	—	—	1 9
Throttle Valve ...	—	—	6/062	Type 25	Type 33	6/061	3 10
Throttle Valve ...	—	—	—	Type 31	Type 28	Type 51	3 10
Throttle Valve ...	4/063	4/063	—	Type 17	Type 30	Type 45	2 10
Holding Bolt Washer	4/061	4/061	4/061	4/063	4/063	4/063	2 3
Needle Jet ...	4/065	4/065	4/065	—	—	—	1 9
Needle for Jet ...	4/081	4/081	4/081	—	—	—	1 3
Air Adjusting Screw	13/129	5/065	6/065	—	—	—	6 2
Spring for Air Adjusting Screw	13/130	13/129	13/129	—	—	—	2 2
Filter ...	—	13/130	13/130	—	—	—	1 8
Jet Key ...	—	—	—	7/070	7/070	7/070	1 0
Main Jet ...	4/042	4/042	4/042	7/069	7/069	7/069	1 0
Main Jet ...	—	—	—	7/062	7/062	7/062	5 5
Pilot Jet ...	—	—	—	7/061	7/061	7/061	5 5

1929 AND 1930 FLOAT CHAMBER PARTS.

Component	PART NUMBERS				Price s. d.
	LARGE FLOAT CHAMBER		SMALL FLOAT CHAMBER		
	Bottom Feed.	Top Feed.	Bottom Feed.	Top Feed.	
Float Chamber Body (Std. Base) ...	14/001	14/002	—	—	12 0
Float Chamber Body (Long Base) ...	14/003	14/004	—	—	12 0
Float Chamber Body (Double)	14/008	14/010	—	—	20 0
Float Chamber Body (Std. Base) ...	—	—	22/001	22/002	8 0
Float Chamber Cover ...	14/011	14/012	22/011	22/012	4 3
Cover Lock Screw ...	14/015	14/017	22/010	22/010	4 0
Needle ...	14/021	—	—	—	6 1
Petrol Union Nut ...	14/024	14/030	22/013	22/011	11 0
Petrol Union Nipple ...	14/025	14/025	14/020	14/020	0 0
Tickler ...	14/026	14/026	14/020	14/020	3 7
Tickler Spring ...	14/031	14/031	22/021	22/021	2 2
Cotter for Tickler ...	14/032	14/032	14/032	14/032	1 1
Double Float Chamber complete	14/033	14/033	14/033	14/033	—
Large	—	—	—	—	33 0
Small	—	—	—	—	23 0
	—	—	—	—	17 0

SPARES LIST FOR CONCENTRIC CARBURETTOR.

MIXING CHAMBERS.		PART NO.	LIST PRICE
COMPONENT			
Mixing Chamber	7/025	8 0
Throttle Valve	25	3 10
J.A. Block	7/034	1 6
Stop Screw	0/050	6
Lock Nut for ditto	0/000	3
Mixing Chamber Union Nut	4/033	1 6
Mixing Chamber Cap	4/031	1 9
Mixing Chamber Top	30/003	1 9
Cable Adjuster	4/035	4
Cable Nipple	4/030	2
Throttle Valve Spring	4/036	3
Air Funnel with Dome	30/003	3 0
Washer for Jet Block	4/040	2
Holding Bolt	7/071	2 0
Outlet Clip	5/050	1 9
Outlet Clip Bolt	4/048	6
Throttle Valve Guide	4/047	2
Filter	7/070	1 6
Jet Key	7/000	1 0
Main Jet	7/002	6
Pilot Jet	7/001	5
Air Valve	30/092	2 6
Air Valve Operating Rod	30/008	1 3
Top for Rod	30/000	
Rod Nipple	30/061	2
Click Spring	30/004	2

FLOAT CHAMBER.

Float Chamber Complete ...	22/070	17 0
Float Chamber Cover (no Vent Hole) ...	22/011	4 3
Float Chamber Body ...	22/001	8 6
Float ...	22/016	2 6
Needle ...	22/013	11
Petrol Union Nut ...	14/025	6
Petrol Union Nipple ...	14/026	3
Tickler ...	22/023	7
Tickler Body ...	22/024	7
Tickler Spring ...	14/032	2
Cotter for Tickler ...	14/033	1

CONTROL (TOM TIT).

Control Lever ...	20/001	2 6
Control Base ...	20/010	1 0
Control Body ...	20/003	1 0
Control Bolt ...	20/011	6
Distance Piece ...	20/006	3
Control Top ...	20/007	5
Cable Stop ...	20/008	4
Spring Washer ...	20/009	3
Cable Nipple ...	12/034	2
Nut for Control Bolt ...	12/021	2

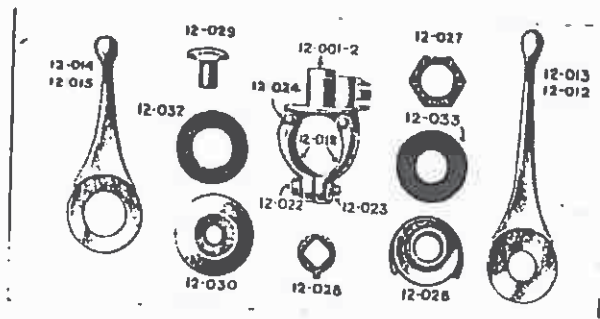

AMAL CONTROLS SPARE PARTS.

Component	AID.	AOD.	AIS.	AOS.	Price
Control Body	12/001	12/002	12/003	12/004	s. d.
Control Lever (long)	12/013	12/012	—	—	1 10
Control Lever (short)	12/014	12/015	—	—	2 0
Handlebar Clip 1-in.	12/018	12/018	12/014	12/015	2. 6
Handlebar Clip 1/2-in.	12/019	12/019	12/018	12/018	0 0
Handlebar Clip Screw	12/022	12/022	12/019	12/019	6 6
Handlebar Clip Screw Nut	12/023	12/023	12/022	12/022	3 3
Handlebar Clip Rivet	12/024	12/024	12/023	12/023	3 3
Cable Ferrules	12/025	12/025	12/024	12/024	2 2
Division Plate	12/026	12/026	12/025	12/025	2 2
Adjusting nut	12/027	12/027	—	—	5 5
Locking Washer	12/028	12/028	—	—	6 6
Control Bolt	12/029	12/029	—	—	3 3
Control Cap	12/030	12/030	12/029	12/029	3 3
Spring Washer each	12/032	12/032	12/031	12/031	5 5
Cable Nipple	12/034	12/034	12/033	12/033	2 2
Inner Wire, per foot	—	—	12/034	12/034	2 2
Outer Cable, per foot	—	—	—	—	2 2
					6 6

AID. = Double Lever Control, open in on R.H. Bar.
 AOD. = Double Lever Control, open out on R.H. Bar.
 AIS. = Single Lever Control, open in on R.H. Bar.
 AOS. = Single Lever Control, open out on R.H. Bar.

1929 and 1930 Amal Control.

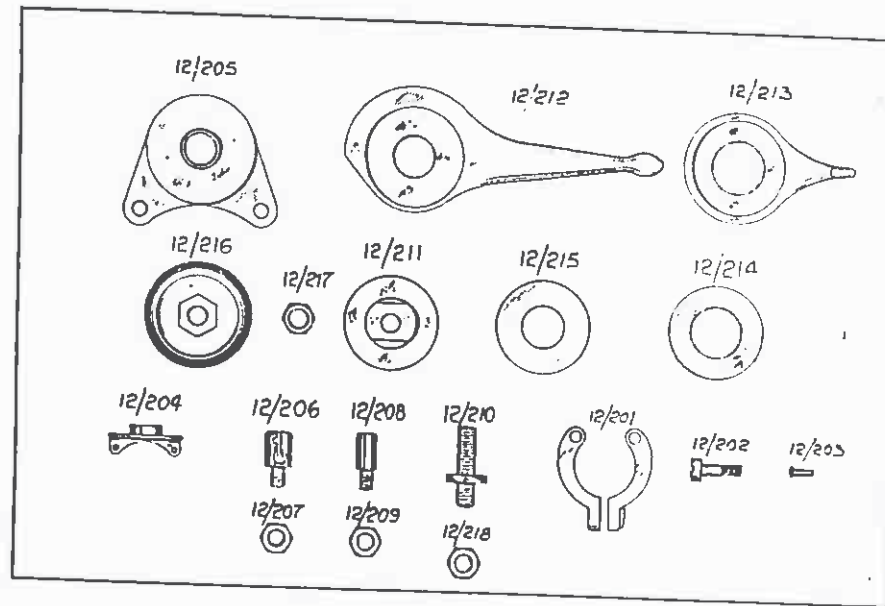

1929 AND 1930 DOUBLE LEVER RACING CONTROL SPARES.

Component	NUMBER.	PRICE
Control Clips, per pair	12/201	...
Control Clip Pin	12/202	1 6
Control Clip Rivets, per pair	12/203	6 6
Control Clip Holder	12/204	3 3
Lever Base	12/205	1 6
Cable Stop	12/206	3 6
Cable Stop Nut	12/207	9 9
Lever Stop	12/208	3 3
Lever Stop Nut...	12/209	6 6
Central Stud	12/210	3 3
Central Stud Lock Nut	12/211	9 9
Lever Bush	12/212	3 3
Long Lever	12/213	1 6
Short Lever	12/214	4 0
Friction Washers, each (12/214 large hole) (12/215 small hole)	12/215	3 0
Top Cap	12/216	4 4
Top Nut	12/217	1 9
Inner Wire	per foot	3 3
Outer Cable	per foot	2 2
		6 6

1929-30 Amal Controls.
TOM TIT CONTROL PARTS

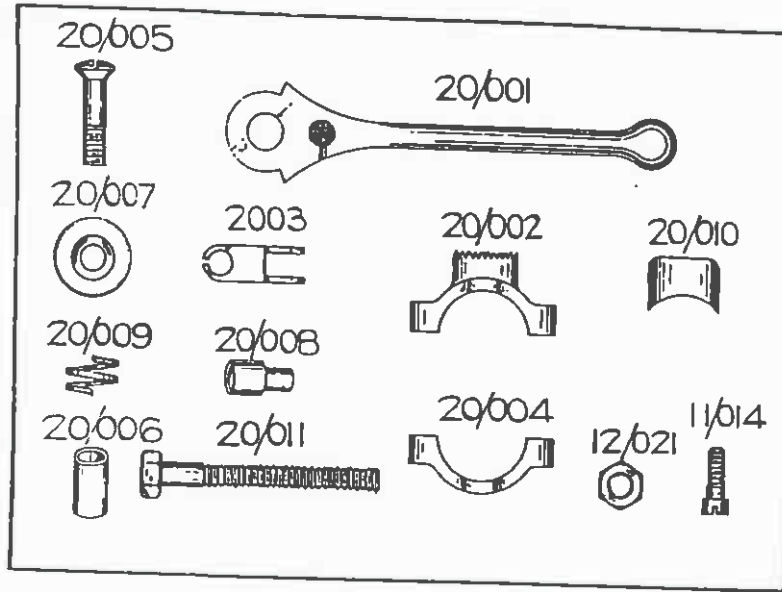

CONTROL (TOM TIT).

COMPONENT	PART No.	LIST PRICE
Control Lever	20/001	2 6
Control Base	20/010	1 0
Control Body	20/003	1 6
Control Bolt	20/011	0
Distance Piece	20/006	3
Control Top	20/007	5
Cable Stop	20/008	4
Spring Washer	20/009	3
Cable Nipple	12/034	2
Inner Wire	per foot	2
Outer Cable	per foot	0
Nut for Control Bolt	12/021	2

1929-30 Amal Controls.
Spares List of Straight Pull Lever.

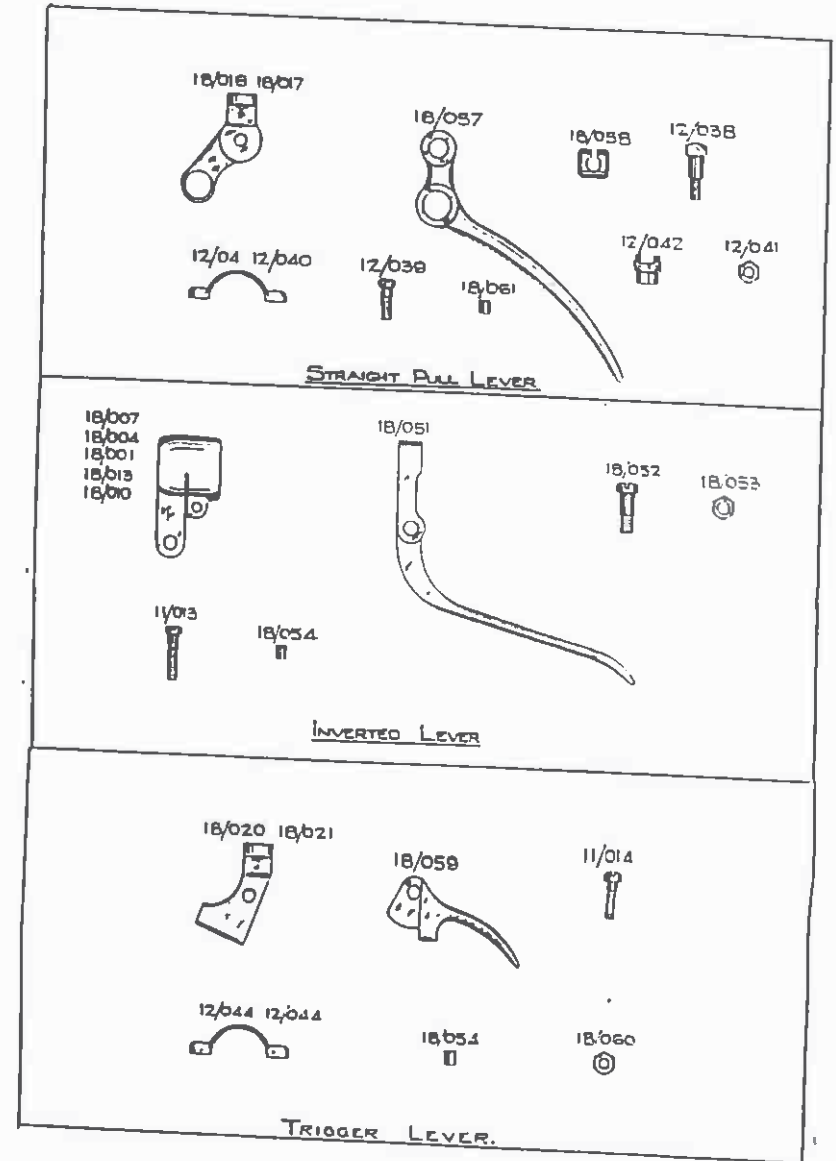

1929-30 Amal Controls.

1929-30 Amal Controls

SPARES LIST OF STRAIGHT PULL LEVER.

COMPONENT.	PART NUMBER		Price
	1" Bar.	1/2" Bar.	
Straight Pull Bracket	18/016	18/017	2 8
Straight Pull Lever	18/057	18/057	2 5
Fulcrum Pin	12/038	12/038	3
Nut for ditto	12/041	12/041	3
Adjusting Bush	12/042	12/042	10
Roller	18/058	18/058	6
Cable Nipple	18/061	18/061	6
Clamp	12/044	12/040	6
Clamp Screws	12/039	12/039	3
Inner Wire, per foot	—	—	2
Outer Cable, per foot	—	—	6

SPARES LIST OF INVERTED LEVERS.

COMPONENT	PART NUMBER					Price
	Inverted Lever 18/007 for 1/2" H' Bar.	Inverted Lever 18/004 for 1" H' Bar.	Inverted Lever 18/001 for 1/2" and 1" H' Bar.	Inverted Lever 18/013 for 1/2" D/Grip	Inverted Lever 18/010 for 1" D/Grip	
Inverted Lever Body	18/007	18/004	18/001	18/013	18/010	2 9
Inverted Lever ...	18/051	18/051	18/051	18/051	18/051	3 0
Pin for Lever ...	18/052	18/052	18/052	18/052	18/052	3
Nut for Lever ...	18/053	18/053	18/053	18/053	18/053	3
Pinch Pin for Body	11/013	11/013	11/013	11/013	11/013	3
Cable Nipple ...	18/064	18/064	18/064	18/064	18/064	2

SPARES LIST OF TRIGGER LEVERS.

COMPONENT.	PART NUMBER	Price.
Trigger Lever Body 1-in.	18/020	1 2
Trigger Lever Body 1/2-in.	18/021	1 2
Clamp 1-in.	12/044	6
Clamp 1/2-in.	12/040	6
Trigger Lever	18/050	1 6
Pin for Lever and Clamp	11/014	3
Nut for ditto	18/060	3
Cable Nipple	18/054	2

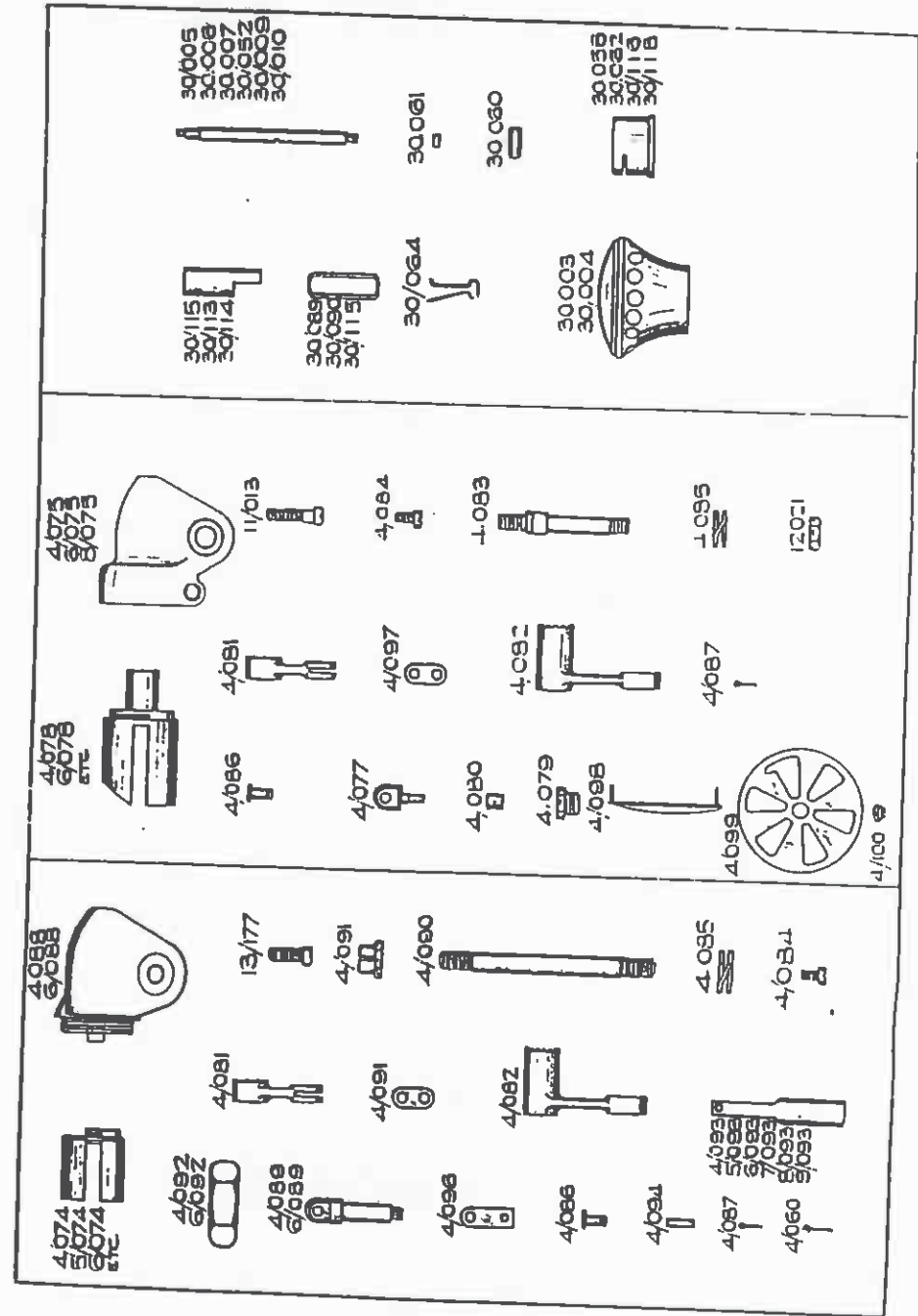

1929-30 Amal Twist Grip

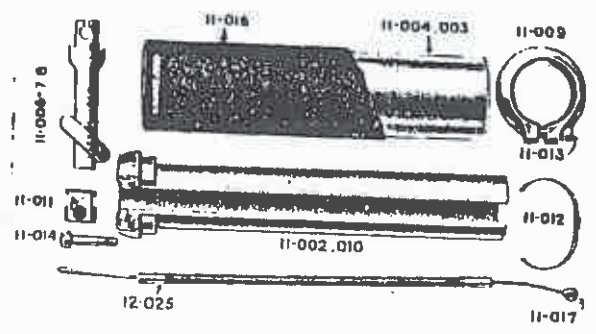

1929 AND 1930 AMAL TWIST GRIP.

AMAL TWIST GRIP PARTS. (1928 Standard Models). STRAIGHT PULL TYPE.

Component	NUMBER	Price
Inner Sleeve and Rear Clip (long 11/001 and 010) (short 11/002 and 010)	...	3 3
Outer Sleeve complete (long 11/004 and 003) (short 11/005)	...	3 3
Slide Strip, Key and Nipple Carrier R.H.	11/022R.	1 0
Slide Strip, Key and Nipple Carrier L.N.	11/033L.	1 0
Rear Clip	11/009	1 9
Cable Stop	11/011	9
Spring	11/012	4
Pin for Rear Clip	11/013	3
Pin for Front Clip	11/014	3
Rubber Grip (0 1/2-in long 11/015; 5-in short 11/016)	...	1 6
Cable Nipple	11/017	2
Liner for Twist Grip (1/2-in bar only (long 11/018) (short 11/019)	...	1 6
Dummy Grip 1/2-in. (0 1/2-in. long 11/030) 5-in. short 11/031)	...	1 6
Dummy grip 1-in. (0 1/2-in. long 11/033) (5-in. short 11/034)	...	1 6
Dummy Grip end cap 1-in. grip	11/032	4
Dummy Grip end cap 1/2-in. grip	11/035	4
Dummy Grip end cap closed end	11/030	4
Inner Wire per foot	...	2
Outer Cable per foot	...	6

* Note.—The illustration No. for this part is shown as 11/000-7-8

1929-30 Binks Twist Grip Parts,

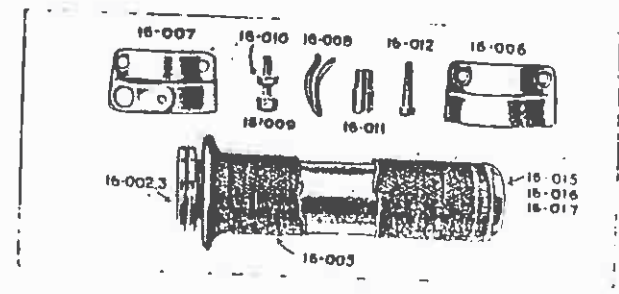

1929 AND 1930 BINKS TWIST GRIP PARTS.

Component	NUMBER	Price
Inner Sleeve and Rotor (long)	16/001-3	3 6
Inner Sleeve and Rotor (short)	16/002-3	3 6
Grip (long 16/004) (short 16/005)	...	1 6
Body (top half) R.H.	16/006	3 0
Body (bottom half) R.H.	16/007	3 0
Friction Spring	16/008	6
Screw for Friction Spring	16/009	4
Lock Nut for ditto	16/010	2
Cable Stop	16/011	4
Screw for Body (2)	16/012	3
Liner for Long Twist Grip	16/013	1 6
Liner for Short Twist Grip	16/014	1 6
End Cap (1-in. bar)	16/015	4
End Cap (1/2-in. bar)	16/016	4
End Cap with closed end	16/017	4
Inner Wire per foot	...	2
Outer Wire per foot	...	6

ADAPTORS FOR AIR FILTER.

For dimensions "A" and "B" see table on page 6.
 Fitting Air Filter to Binks' Carburettor, with Bell Mouth Air Intake.
 This can be done by means of the Adaptor No. 10/041, illustrated above.

For particulars see page 60.

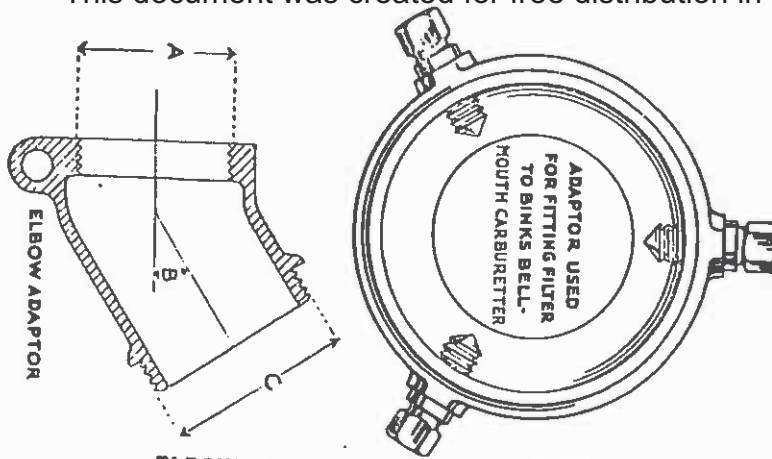

ELBOW FITTINGS FOR AIR FILTERS.

The following Elbow Adaptors can be supplied with air filters for fitting to those machines with insufficient clearance behind carburettor air intake for air filter.

Angle of Elbow "B"	Number of Elbow	Dia. of Carb. Intake "A"	Threads per in on Carb. Intake	Type of Carburettor
30°	15/007	1 1/8"	24	Amac 25M, 30M, 40M 25PJ, 30PJ
30°	15/008	1 1/8"	24	25HYDM, 30HYDM
30°	15/010	1 1/8"	24	Amac 10M, 25TT25
30°	15/016	1 1/8"	20	Amac 15M, 15PJ 15MYDM
30°	15/011	1 1/8"	20	Binks
30°	15/017	1 1/8"	28	Binks
30°	15/024	1 1/8"	28	B. and B. 123, 121, 122 B. and B. 120
60°	15/004	1 1/8"	24	Amac 25M, 30M, 40M 25PJ, 25HYDM 30HYDM, 30PJ
60°	15/003	1 1/8"	24	Amac 15M, 15PJ 15MYDM
60°	15/012	1 1/8"	20	Binks
60°	15/013	1 1/8"	28	Binks
60°	15/010	Bell Mouth	28	B. and B. 121, 122, 123
60°	15/000	1 1/8"	28	Binks
90°	15/005	1 1/8"	24	Amac 25M, 30M, 40M 25PJ, 30PJ, 25HYDM 30HYDM
90°	15/006	1 1/8"	24	Amac 15M, 15PJ 15MYDM
90°	15/014	1 1/8"	20	Binks
90°	15/015	1 1/8"	28	Binks
90°	15/060	1 1/8"	28	B. and B. 123, 121, 122 B. and B. 120

When it is known that an elbow is necessary this will always be supplied with the filter and the extra charge made.

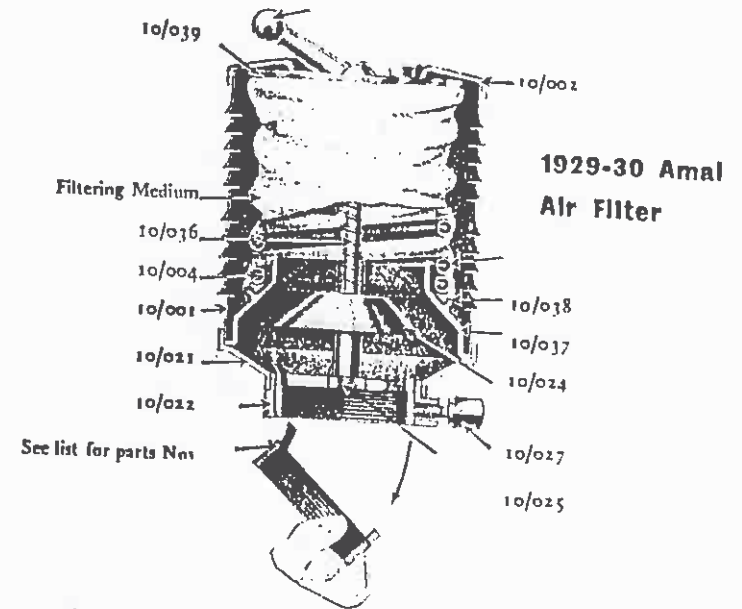

AMAL AIR FILTER SPARE PARTS LIST.

Component	Ref. Number	s. d.
Air Cleaner Case
Adaptor End Cap, Bridge piece and spindle ...	10/001	1 0
Back End Cap ...	10/021-22-25	2 0
Spring for silk bag ...	10/002	9
Back End Plate Nut ...	10/004	6
End Plate for silk bag (rear) ...	10/040	4
Lock Screw ...	10/039	6
Fabric Sleeve ...	10/027	3
Valve Seat	1 0
Valve complete ...	10/037	1 3
Front End Cap for silk bag ...	10/024	9
Valve Spring ...	10/038	10
Plas for Binks Adaptor ...	10/036	3
Valve Spring Lock Nut ...	10/043	3
Bridge Piece Adaptor ...	139/2	2
	...	1 0

The number of the bridge piece adaptor will depend on the carburettor to which the filter has to be fitted and the following is a list of the bridge piece adaptors which can be supplied.

No. of Adaptor	Dia. of Carb. Intake	Threads per in.	Carburettor	Price s. d.
10/028	1 1/8"	24	Amac	1 0
10/029	1 1/8"	28	B. and B.	1 0
10/030	1 1/8"	20	Binks	1 0
10/031	1 1/8"	24	Amac	1 0
10/032	1 1/8"	28	B. and B.	1 0
10/033	1 1/8"	20	Binks	1 0
10/035	1 1/8"	24	Amac	1 0
10/044	1 1/8"	24	Amac	1 0
10/041	Bell Mouth	—	Amac	1 0
10/045	1 1/8"	20	Binks	2 0
10/042	1 1/8"	24	Binks	1 0
			Triumph	1 0

1930 Amal and Binks Carburetter.

- Models. T. 4, T. 5, T. 6** Standard Amal Touring Carburetters with fittings the same as 1929 except for the addition of a throttle stop adjuster and nut.
- T. 46, T. 47, T. 48, T. 49.** Standard Binks Carburetters with slight modifications and replaces types 7, 8 and 9, 1929 pattern, but still retaining the Binks characteristics and fitted with the latest Throttle stop adjuster and lock nut. The T. 46 is fitted to Ultra Lightweight machines.
- T. 4. L.D. or L.S.** Carburetters fitted with rod controls either
- | | |
|-----------|--|
| 5. " " " | double Lever Type L.D. or single Lever |
| 6. " " " | Type L.S. |
| 47. " " " | |
| 48. " " " | |
| 49. " " " | |
- T. 26, T. 27, T. 28.** Track racing carburetters.
- T. 29.** Racing carburetter for machines above 500cc.
- T. 5/116/8.** Special carburetter with butterfly strangler fitted on Douglas machine 600 cc. S.V. Twin.
- T. 4/127.** Special carburetter with butterfly strangler fitted on Veloce machine model G.T.P. 250 cc. two stroke.

MIXING CHAMBER COMPONENTS.

To order, see instructions on page 51 and note the details of Rod controlled Carburetters on pages 63—64—65. and of Track Racing Carburetters on page 75.

FLOAT CHAMBER COMPONENTS.

To order see instructions page 52.

CONTROLS AND TWIST GRIPS.

To order see instructions page 52.

1930 AMAL AND BINKS MIXING CHAMBERS.

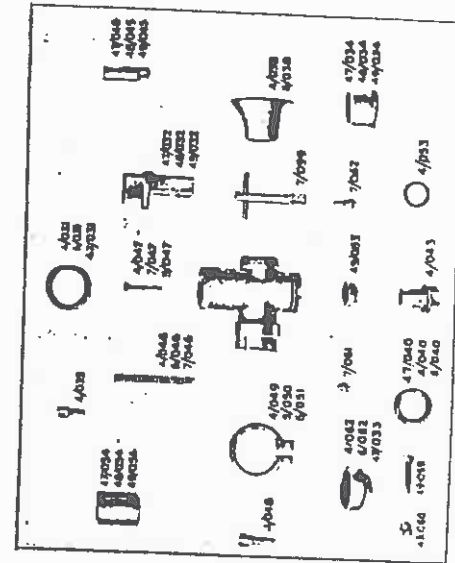

BINKS Mixing Chamber Parts.

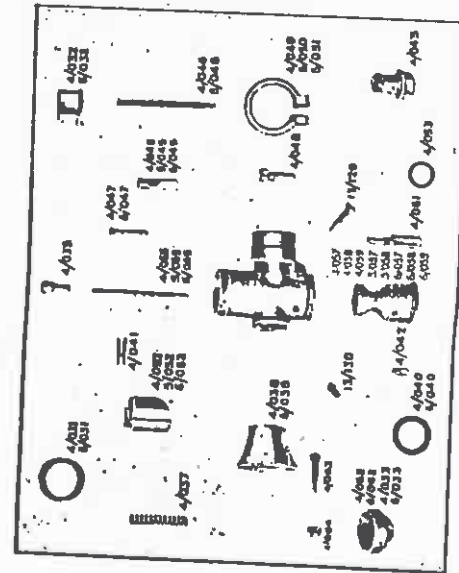

AMAL Mixing Chamber Parts.

MIXING CHAMBER PARTS FOR 1930 AMAL AND BINKS CARBURETTERS.

Component	AMAL CARBURETTERS					BINKS CARBURETTERS					Price s. d.
	Type 4	Type 5	Type 6	Type 20	Type 46	Type 47	Type 48	Type 49	Type 40		
Mixing Chamber	According to Engine	According to Engine	According to Engine	According to Engine	According to Engine	According to Engine	According to Engine	According to Engine	According to Engine	According to Engine	8 00
Ditto	4/057	5/057	6/057	29/088	47/033	47/033	47/033	47/033	47/033	47/033	10 00
Ditto	4/058	5/058	6/058	29/089	47/031	47/031	47/031	47/031	47/031	47/031	12 00
Ditto	4/059	5/059	6/059	29/070	48/031	48/032	48/032	48/032	48/032	48/032	14 00
Jet Block and Barrel complete, size 17	—	—	—	—	—	—	—	—	—	—	5 00
Ditto	—	—	—	—	—	—	—	—	—	—	5 00
Ditto	—	—	—	—	—	—	—	—	—	—	5 00
Ditto	—	—	—	—	—	—	—	—	—	—	5 00
Ditto	—	—	—	—	—	—	—	—	—	—	5 00
Ditto	—	—	—	—	—	—	—	—	—	—	5 00
Ditto	—	—	—	—	—	—	—	—	—	—	5 00
Ditto	—	—	—	—	—	—	—	—	—	—	5 00
Ditto	—	—	—	—	—	—	—	—	—	—	5 00
Mixing Chamber Union	4/062	4/062	4/062	29/072	47/082	47/082	47/082	47/082	47/082	47/082	6 00
Nut	4/031	4/031	6/031	29/041	47/031	47/031	47/031	47/031	47/031	47/031	1 11
Mixing Chamber Cap	4/032	4/032	6/032	29/042	47/032	47/032	47/032	47/032	47/032	47/032	1 11
Ditto	—	—	—	—	—	—	—	—	—	—	1 11
Ditto	—	—	—	—	—	—	—	—	—	—	1 11
Ditto	—	—	—	—	—	—	—	—	—	—	1 11
Mixing Chamber Top	—	—	—	—	—	—	—	—	—	—	1 11
Ditto	—	—	—	—	—	—	—	—	—	—	1 11
Ditto	—	—	—	—	—	—	—	—	—	—	1 11
Cable, per length com'ie.	—	—	—	—	—	—	—	—	—	—	1 11
Midway Cable Adjusters	6/132	6/132	6/132	29/047	47/132	47/132	47/132	47/132	47/132	47/132	2 23
Cable Stop, top hat shape	4/035	4/035	4/035	4/036	4/036	4/036	4/036	4/036	4/036	4/036	2 30
Cable Adjuster	4/036	4/036	4/036	4/037	4/037	4/037	4/037	4/037	4/037	4/037	2 30
Cable Nipples	4/037	4/037	4/037	4/038	4/038	4/038	4/038	4/038	4/038	4/038	2 44
Throttle Valve Spring	4/037	4/037	4/037	4/038	4/038	4/038	4/038	4/038	4/038	4/038	2 44

MIXING CHAMBER PARTS FOR 1930 AMAL AND BINKS CARBURETTERS.

Component	AMAL CARBURETTERS					BINKS CARBURETTERS					Price s. d.
	Type 4	Type 5	Type 6	Type 20	Type 46	Type 47	Type 48	Type 49	Type 40		
Air P'nnel	4/038	4/038	6/038	29/048	47/038	47/038	47/038	47/038	47/038	47/038	2 48
Ditto	—	—	—	29/050	47/040	47/040	47/040	47/040	47/040	47/040	3 00
Washer for Jet Block	4/040	4/040	4/040	4/041	47/040	47/040	47/040	47/040	47/040	47/040	3 02
Spring Clip for Needle	4/041	4/041	4/041	4/043	47/043	47/043	47/043	47/043	47/043	47/043	3 04
Holding Bolt	4/043	4/043	4/043	29/055	47/043	47/043	47/043	47/043	47/043	47/043	3 06
Air Valve	4/045	4/045	6/045	4/046	47/045	47/045	47/045	47/045	47/045	47/045	3 08
Ditto	—	—	—	—	—	—	—	—	—	—	3 10
Air Valve Spring	4/046	4/046	6/046	4/047	47/046	47/046	47/046	47/046	47/046	47/046	3 12
Air or Throttle Valve Guide	4/047	4/047	6/047	29/057	47/047	47/047	47/047	47/047	47/047	47/047	3 14
Ditto	—	—	—	4/048	47/048	47/048	47/048	47/048	47/048	47/048	3 16
Outlet Clip Screw	4/048	4/048	4/048	4/049	47/049	47/049	47/049	47/049	47/049	47/049	3 18
Outlet Clip, 1-in.	4/049	4/049	4/049	27/058	47/049	47/049	47/049	47/049	47/049	47/049	3 20
Ditto	—	—	—	6/051	47/050	47/050	47/050	47/050	47/050	47/050	3 22
Ditto	—	—	—	6/051	47/051	47/051	47/051	47/051	47/051	47/051	3 24
Ditto	—	—	—	27/059	47/051	47/051	47/051	47/051	47/051	47/051	3 26
Ditto	—	—	—	—	47/051	47/051	47/051	47/051	47/051	47/051	3 28
Ditto	—	—	—	—	47/051	47/051	47/051	47/051	47/051	47/051	3 30
Ditto	—	—	—	—	47/051	47/051	47/051	47/051	47/051	47/051	3 32
Throttle Valve	4/052	4/052	6/052	29/062	47/054	47/054	47/054	47/054	47/054	47/054	3 34
Ditto	—	—	—	—	—	—	—	—	—	—	3 36
Ditto	—	—	—	—	—	—	—	—	—	—	3 38
Ditto	—	—	—	—	—	—	—	—	—	—	3 40
Ditto	—	—	—	—	—	—	—	—	—	—	3 42
Ditto	—	—	—	—	—	—	—	—	—	—	3 44
Throttle Valve .36 bore	—	—	—	—	—	—	—	—	—	—	3 46
Ditto	—	—	—	—	—	—	—	—	—	—	3 48
Throttle Valve .41 bore	—	—	—	—	—	—	—	—	—	—	3 50
Ditto	—	—	—	—	—	—	—	—	—	—	3 52
Throttle Valve .531 bore	—	—	—	—	—	—	—	—	—	—	3 54
Ditto	—	—	—	—	—	—	—	—	—	—	3 56
Ditto	—	—	—	—	—	—	—	—	—	—	3 58
Ditto	—	—	—	—	—	—	—	—	—	—	3 60
Ditto	—	—	—	—	—	—	—	—	—	—	3 62
Ditto	—	—	—	—	—	—	—	—	—	—	3 64
Ditto	—	—	—	—	—	—	—	—	—	—	3 66
Ditto	—	—	—	—	—	—	—	—	—	—	3 68
Ditto	—	—	—	—	—	—	—	—	—	—	3 70
Ditto	—	—	—	—	—	—	—	—	—	—	3 72

MIXING CHAMBER PARTS FOR 1930 AMAL AND BINKS CARBURETTERS.

Component	AMAL CARBURETTERS			BINKS CARBURETTERS			Type 40	Price s. d.
	Type 4	Type 5	Type 6	Type 20	Type 46	Type 47		
Holding Bolt Washer	4/053	4/053	4/053	4/053	4/053	4/053	4/053	1 1
Needle Jet	4/061	4/061	4/061	29/070	4/053	4/053	4/053	1 1
Needle for Jet	4/065	6/065	6/065	13/129	4/053	4/053	4/053	1 1
Air Adjusting Screw	13/129	13/129	13/129	4/070	4/053	4/053	4/053	1 1
Spring for ditto	13/130	13/130	13/130	4/070	4/053	4/053	4/053	1 1
Filter	4/042	4/042	4/042	4/064	4/053	4/053	4/053	1 1
Filter complete	4/042	4/042	4/042	4/064	4/053	4/053	4/053	1 1
Jet Key	4/063	4/063	4/063	4/060	4/053	4/053	4/053	1 1
Main Jet	4/064	4/064	4/064	29/075	4/053	4/053	4/053	1 1
Ditto	4/063	4/063	4/063	4/060	4/053	4/053	4/053	1 1
Pilot Jet	4/064	4/064	4/064	4/060	4/053	4/053	4/053	1 1
Throttle Stop Screw	4/063	4/063	4/063	4/060	4/053	4/053	4/053	1 1
Ditto ditto Lock Nut	4/064	4/064	4/064	4/060	4/053	4/053	4/053	1 1
Split Cotter Pin for Throttle Valve	4/063	4/063	4/063	4/060	4/053	4/053	4/053	1 1
Needle	4/064	4/064	4/064	4/060	4/053	4/053	4/053	1 1
Strangler Thimble	4/063	4/063	4/063	4/060	4/053	4/053	4/053	1 1
Strangler Inner Sleeve	4/064	4/064	4/064	4/060	4/053	4/053	4/053	1 1
Strangler Lever	4/063	4/063	4/063	4/060	4/053	4/053	4/053	1 1
Valve Location Peg	4/064	4/064	4/064	4/060	4/053	4/053	4/053	1 1
Strangler Spring	4/063	4/063	4/063	4/060	4/053	4/053	4/053	1 1
Special Throttle...	4/064	4/064	4/064	4/060	4/053	4/053	4/053	1 1
Special Air Valve	4/063	4/063	4/063	4/060	4/053	4/053	4/053	1 1
Levis Throttle	4/064	4/064	4/064	4/060	4/053	4/053	4/053	1 1

Special for Two Stroke Machines

1930 Amal and Binks Carburetters

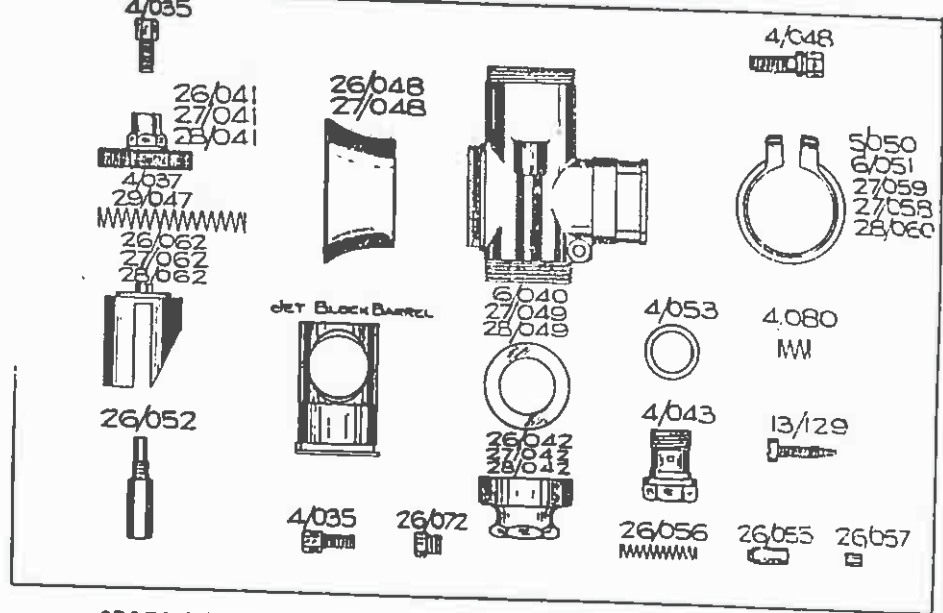

SPARE PARTS FOR 1930 AMAL TRACK RACING CARBURETTERS.

Component	Type 20		Type 27		Type 28	
	Price	s. d.	Price	s. d.	Price	s. d.
Mixing Chamber Body	According to Engine	18 0	According to Engine	20 0	According to Engine	22 0
Ditto Top	26/041	2 0	27/041	2 3	28/041	2 0
Ditto Union Nut	26/042	2 3	27/042	3 0	28/042	3 6
Cable Adjusters	4/035	4	4/035	4	4/035	4
Cable Nipples	26/046	2	26/046	2	26/046	2
Throttle Valve Spring	4/037	3	4/037	3	29/047	3
Air Funnel	26/048	2 6	27/048	3 0	27/048	3 0
Washer for Jet Block	6/040	2	27/049	2	28/040	2
Jet	26/052	1 9	20/052	1 9	26/052	1 9
Holding Bolt	4/043	2 0	4/043	2 0	4/043	2 0
Air Valve	26/055	1 0	26/055	1 0	26/055	1 0
Ditto Spring	26/050	3	20/050	3	20/050	3
Ditto Nipple Sleeves	26/057	2	28/057	2	26/057	2
Outlet Clip Screw	4/048	6	4/048	6	4/048	6
Outlet Clip, 1 1/4-in.	5/050	1 9	—	—	—	—
Ditto 1 1/4-in.	6/051	1 9	6/051	1 9	—	—
Ditto 1 1/4-in.	—	—	27/059	1 9	—	—
Ditto 1 1/4-in.	—	—	—	—	27/058	2 3
Ditto 1 1/4-in.	—	—	—	—	28/060	2 6
Throttle Valve	20/062	4 2	27/062	4 2	28/062	4 2
Holding Bolt Washer	4/053	2	4/053	2	4/053	2
Jet Block Barrel Comp.	—	8 0	—	10 0	—	12 0
(Specify Carb. type when ordering)	—	—	—	—	—	—
Air Barrel Top	20/072	7	26/072	7	26/072	7
Spring for Air Adj. Screw	4/080	2	4/080	2	4/080	2
Air Adj. Screw	13/120	6	13/120	6	13/120	6

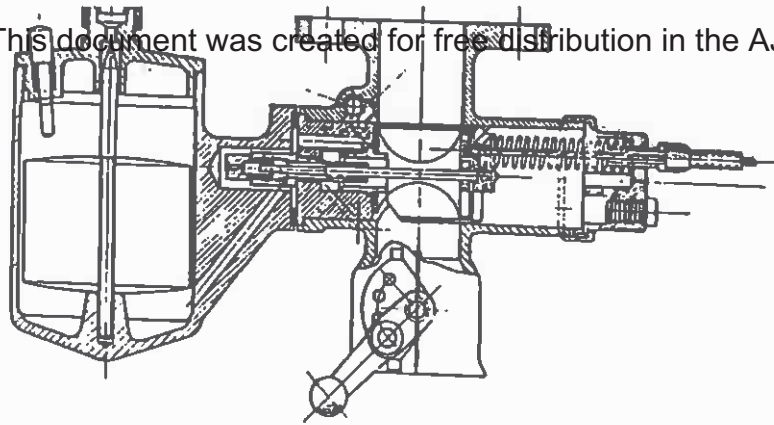

**AMAL CARBURETTER AS FITTED TO 600 cc. DOUGLAS 1930.
MIXING CHAMBER PARTS.**

COMPONENT	PART No	Price s. d.
Mixing Chamber ...	5/116/S.	15 0
Mixing Chamber Cap ...	4/031	1 9
Mixing Chamber Top ...	4/032	1 9
Jet Block and Barrel (.875) ...	5/058	5 0
Cable Adjusters ...	4/035	4
Throttle Valve Spring ...	4/037	3
Washer for Jet Block ...	4/040	2
Spring Clip for Needle ...	4/041	4
Jet ...	4/042	5
Throttle Valve ...	5/052	3 10
Split Cotter Pin for Throttle Valve ...	4/060	2
Throttle Valve Stop Screw ...	4/063	6
Lock Nut for Stop Screw... ..	4/064	2
Screws for Flange ...	5/133	4
Needle Jet ...	5/134	1 9
Jet Needle ...	5/135	1 3
Air Adjusting Screw ...	5/136	6
Plug Screw for Mixing Chamber Top ...	4/137	3
Strangler Lever ...	5/137	1 0
Strangler Spindle ...	5/138	6
Split Cotter Pin for Strangler Valve ...	13/168	1
Strangler Valve ...	13/169	1 0
Strangler Spindle Bush ...	5/139	3
Taper Pin for Strangler Spindle ...	13/165	2
Spring Plunger ...	5/140	7
Spring for ditto ...	14/032	2
Washer for Plunger ...	5/141	2
Lock Nut for Air Adjuster ...	10/010	2

FLOAT CHAMBER PARTS.

Float ...	14/017	2 0
Petrol Union Nut ...	14/025	6
Needle ...	14/030	11
Tickler ...	14/031	7
Tickler Spring ...	14/032	2
Cotter for Tickler ...	14/033	1
Float Chamber Cover ...	14/140	4 3
Short Petrol Union ...	14/141	3
Float Chamber Body ...	14/094	15 0

BOTTOM FEED NEEDLES

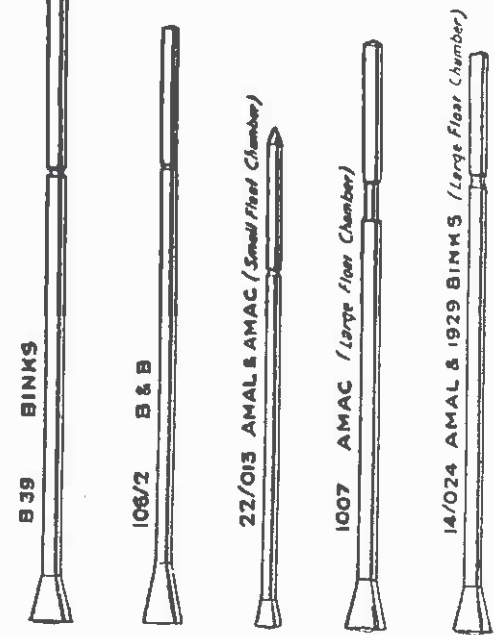

TOP FEED NEEDLES

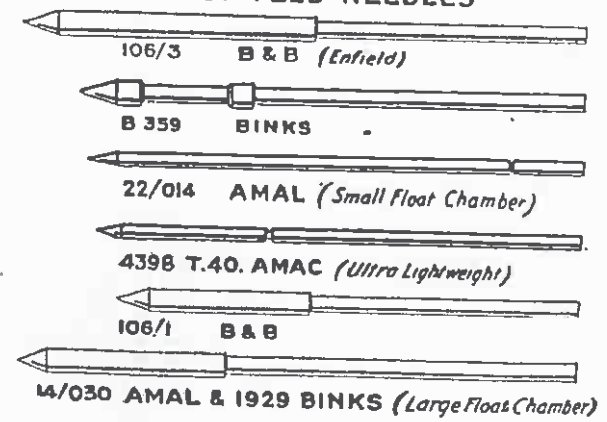

Various AMAL Float Chamber Needles.
Illustrations actual size.