

## SPARE PARTS LIST for Carburettor TYPE Nos. 223 & 523

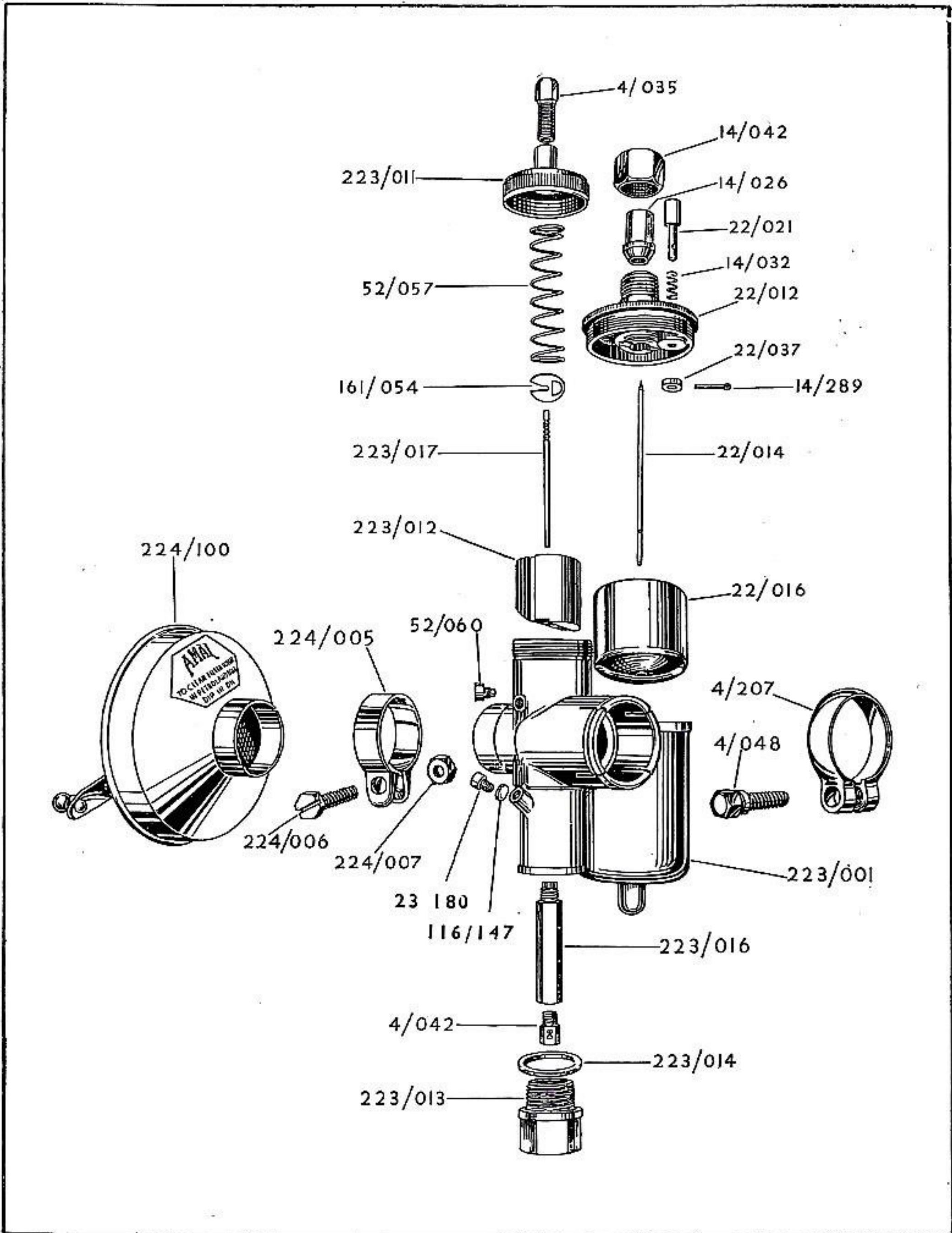

**AMAL LTD., HOLDFORD ROAD, WITTON,  
BIRMINGHAM 6, ENGLAND**

Phone: Birmingham, BIRchfields 4571.  
(P.B.X. 6 lines)

Telegrams: "AMALCARB, 'PHONE,  
BIRMINGHAM."

Component	Carb. Type 223/001C	Carb. Type 223/001D	Carb. Type 223/101	Carb. Type 223/3	Carb. Type 223/4	Carb. Type 223/5	Carb. Type 223/6
Carburettor Body only ..	223/001	223/001D	223/002	223/018	223/001	223/001D	223/023
Mixing Chamber Top ..	223/011	223/011	223/011	223/011	223/011	223/011	223/011
Cable Adjuster .. ..	4/035	4/035	4/035	4/035	4/035	4/035	4/035
Throttle Valve .. ..	223/012	223/012	223/012	223/019(5)	223/020	223/012	223/019
Cable Nipple .. ..	1482	1482	1482	1482	1482	1482	1482
Jet Plug .. ..	223/013	223/013	223/013	223/013	223/013	223/013	223/013
Jet Plug Washer .. ..	223/014	223/014	223/014	223/014	223/014	223/014	223/014
Throttle Valve Spring ..	52/057	52/057	52/057	332/021	52/057	52/057	332/021
Outlet Clip .. ..	4/207	4/207	4/207	4/207	4/207	—	—
Outlet Clip Screw .. ..	4/048	4/048	4/048	4/048	4/048	—	—
Valve Location Screw ..	52/060	52/060	52/060	52/060	52/060	52/060	52/060
Needle Jet .. ..	223/016	223/016	223/016	223/016(107)	223/016	223/016	223/106(107)
Jet Needle .. ..	223/017	223/017	159/068	223/017	223/017	223/017	223/017
Jet Needle Clip .. ..	161/054	161/054	161/054	161/054	161/054	161/054	161/054
Plug Screw .. ..	23/180	23/180	23/180	23/180	23/180	23/180	23/180
Plug Screw Washer ..	116/147	116/147	116/147	116/147	116/147	116/147	116/147
Main Jet .. ..	4/042	4/042	4/042	4/042(90)	4/042	4/042	4/042(110)
Air Filter & Strangler (com.)	224/100	224/100	224/100	224/100	224/100	224/100	224/100
Float Chamber Cover ..	22/012	22/012	22/011	22/111	22/012	22/012	22/124
Union Nut .. ..	14/042	14/042	14/042	14/042	14/042	—	14/042
Union Nipple .. ..	14/026	14/026	14/026	14/026	14/026	—	14/026
Tickler (complete) ..	22/053	22/053	22/053	22/110	22/053	22/053	22/053
Float Needle .. ..	22/014	22/014	22/013	22/014	22/014	22/014	22/014
Float .. ..	22/016	22/016	22/016	22/016	22/016	22/016	22/016

*GUARANTEE.—The Company take all possible reasonable care in the manufacture and the quality of their products. Purchasers are informed that, any part proved to be defective in manufacture or quality, and returned to the works within six months of its purchase new, will be replaced. The Company must respectfully point out however, that its responsibility and that of its agents, stockists and dealers, is limited to this Guarantee, and that they cannot, under any circumstances, be held responsible for any loss or for any contingent or resulting liability arising through any defect. These conditions of sale and use also apply when the Company's products form part of the original equipment of machines purchased new.*

Component	Carb. Type 223/7	Carb. Type 223/8	Carb. Type 523/001C	Carb. Type 523/001D	Carb. Type 523/1, 523/2	Carb. Type 523/3
Carburettor Body only ..	223/001	223/023	523/001D	523/001D	523/002D	523/002D
Mixing Chamber Top ..	223/011	223/011	223/011	223/011	223/011	223/011
Cable Adjuster .. ..	4/035	4/035	4/035	4/035	4/035	4/035
Throttle Valve .. ..	223/012	223/019	223/012	223/012	223/012	223/027
Cable Nipple .. ..	1482	1482	1482	1482	1482	1482
Jet Plug .. ..	223/013	223/013	223/013	223/013	223/013	223/103
Jet Plug Washer .. ..	223/014	223/014	223/014	223/014	223/014	223/014
Throttle Valve Spring ..	52/057	332/021	52/057	52/057	52/057	52/057
Outlet Clip .. ..	4/207	—	4/207	4/207	4/207	4/207
Outlet Clip Screw .. ..	4/048	—	4/048	4/048	4/048	4/048
Valve Location Screw ..	52/060	52/060	52/060	52/060	52/060	52/060
Needle Jet .. ..	223/016	223/016	223/016	223/016	223/016	223/016
Jet Needle .. ..	223/017	223/017	223/017	223/017	223/017	223/017
Jet Needle Clip .. ..	161/054	161/054	161/054	161/054	161/054	161/054
Plug Screw .. ..	23/180	23/180	23/180	23/180	23/180	23/180
Plug Screw Washer .. ..	116/147	116/147	116/147	116/147	116/147	116/147
Main Jet .. ..	4/042	4/042	4/042	4/042	4/042	4/042
Air Filter and Strangler (comp.)	224/100	224/100	224/100	224/100	224/100	224/100
Float Chamber Cover ..	22/012	22/124	62/220	62/220	62/217	62/217
Float Chamber Cover Screw	—	—	62/204	62/204	62/204	62/204
Union Nut .. ..	14/308	14/042	14/042	14/042	52/168	52/168
Union Nipple .. ..	14/309	14/026	14/026	14/026	14/358	14/358
Tickler (complete) .. ..	22/053	—	—	—	—	—
Tickler .. ..	—	22/021	62/207	62/207	62/207	62/207
Tickler Bush .. ..	—	—	—	—	352/204	352/204
Tickler Spring .. ..	—	—	352/208	352/208	352/208	352/208
Tickler Spring Screw ..	—	—	352/207	352/207	352/207	352/207
Float Needle .. ..	22/014	22/014	22/014	22/014	22/014	22/014
Float .. ..	22/016	22/016	22/016	22/016	22/016	22/016

# AMAL

LIST No. 605/2

ENGINE	Specific'n No.	Carb. Type No.	Internal Bore	Jet Size	Throttle Valve	Needle Position	Needle Jet Size
BROCKHOUSE. 2-stroke, Industrial ..	A3507	259/001B	.425"	60	3	2	.109
BRITISH ANZANI. 60cc., Outboard ..	A3572	259/087E	.471	60	3 Stepped	3	.106
60cc., Outboard ..	A3572	359/087E	.471	60	3 Stepped	3	.106
CORGI. 98cc., 2-stroke .. ..	A3493	259/001B	.425	55	3	2	.107
CYC-AUTO. 78cc., 2-stroke .. ..	A3476	259/001B	.425	55	3	3	.107
EXCELSIOR. 98cc. .. ..	A3449	259/001B	.425	55	3	3	.107
100cc., Minor .. ..	A3548	259/021D	.531	70	5	2	.107
G.Y.S. 50cc. .. ..	A3577	259/088	$\frac{11}{32}$ "	35	2	2	.107
LEVIS. 80cc., 2-stroke .. ..	A3578	259/001B	.425	50	3	3	.106
POWER PAK. 49cc., Power Unit ..	A3598	259/091D	.425	45	5	3	.106
49cc., Power Unit ..	A3605	359/091D	.425	45	5	3	.106
49cc., Power Unit ..	359/1	359/1	.425	45	5	3	.106
49cc., Power Unit ..	359/3	359/2	.425	45	5	3	.106
COMET. 60cc. .. ..	AF1146	359/025	.531	70	2	2	.107
GILLET. 100cc., 2-stroke ..	AF1072	259/015E	.475	55	3	3	.107
100cc., 2-stroke ..	AF1154	359/015E	.475	55	3	3	.107
100cc., 2-stroke ..	AF1145	259/005A	.425	60	2	3	.107
125cc., 2-stroke ..	AF1101	359/025E	.531	70	2	3	.107
GUDENAS. 128cc., 2-stroke ..	AF1093	259/021D	.531	50	3	3	.107
HUSQVARNA. 120cc. .. ..	AF1107	259/021D	.531	50	3	3	.107
120cc. .. ..	AF1128	359/021D	.531	55	3	5	.107

*GUARANTEE.—The Company take all possible reasonable care in the manufacture and the quality of their products. Purchasers are informed that, any part proved to be defective in manufacture or quality, and returned to the works within six months of its purchase new, will be replaced. The Company must respectfully point out however, that its responsibility and that of its agents, stockists and dealers, is limited to this Guarantee, and that they cannot, under any circumstances, be held responsible for any loss or for any contingent or resulting liability arising through any defect. These conditions of sale and use also apply when the Company's products form part of the original equipment of machines purchased new.*

1,000/10/62. W.

Printed in England.

**AMAL LTD., HOLDFORD ROAD, WITTON,  
BIRMINGHAM 6, ENGLAND**

'Phone : Birmingham, BIRchfields 4571.  
(P.B.X. 6 lines)

Telegrams : "AMALCARB, 'PHONE,  
BIRMINGHAM."