

# SPARES LIST

*for*

500 c.c. O.H.V.

## “SPRINGTWIN”

VERTICAL TWIN

(MODEL 20)



### A·J·S MOTOR CYCLES

PROPRIETORS: ASSOCIATED MOTOR CYCLES LIMITED

PLUMSTEAD - LONDON - S.E.18

★

Price:  
TWO SHILLINGS and SIXPENCE

EDITION CL-13

## ILLUSTRATIONS

	Page
CARBURETTER ... ..	13
CLUTCH AND KICK-STARTER ... ..	22
CONTROL LEVERS ... ..	32
CRANKCASE, CRANKSHAFT AND CONNECTING RODS ...	4
CYLINDERS, HEADS, PISTONS, VALVES AND TIMING GEAR	8
EXHAUST PIPES, ENGINE SHOCK-ABSORBER AND CHAINS	16
FRAME AND TELEDRRAULIC REAR LEG ... ..	25
FRONT TELEDRRAULIC FORKS AND STEERING DAMPER ...	27
GEAR OPERATING PARTS ... ..	21
GEAR BOX SHELLS, GEARS AND SHAFTS ... ..	18
OIL PUMPS, DYNAMO AND MAGNETO ... ..	11
STANDS, GUARDS, CHAINCASES AND TOOL BOXES ...	29
TANKS AND PIPES ... ..	36
WHEELS AND BRAKES ... ..	38

# SPARES LIST

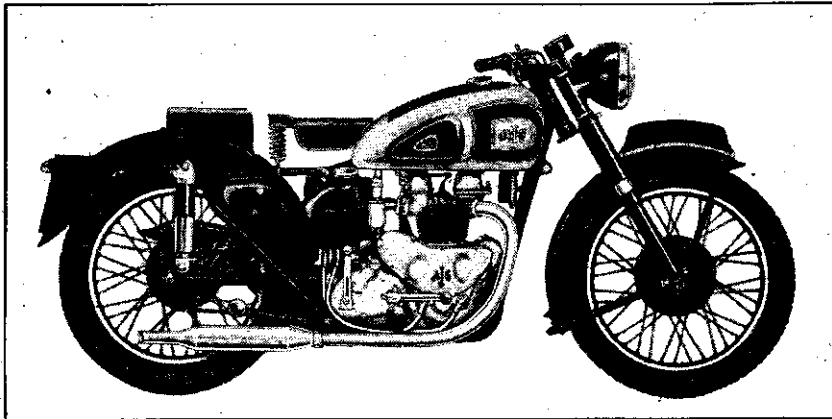

**A · J · S "SPRINGTWIN"**

**VERTICAL TWIN**

**Bore 66 m.m.**

**Stroke 72·8 m.m.**

**Capacity 498 c.c.**

**A·J·S**

Compiled and Issued by the Manufacturers:

**A·J·S MOTOR CYCLES**

(Proprietors: ASSOCIATED MOTOR CYCLES LIMITED)

Registered Offices:

**PLUMSTEAD ROAD, PLUMSTEAD  
LONDON, S.E.18 .. ENGLAND**

Nearest Station:  
**WOOLWICH ARSENAL**  
(Southern Region Railway)

Factories:  
**BURRAGE GROVE and MAXEY ROAD**  
**PLUMSTEAD, S.E.18**

Telegrams and Cables: "ICANHOPIT-WOL-LONDON"

Telephone: WOOLWICH 1223 (5 Lines)

Codes: A.B.C. 5th and 6th Edition; Bentley's; and Private Codes

All correspondence to:—

**A·J·S MOTOR CYCLES, PLUMSTEAD ROAD, LONDON, S.E.18**

**Price: TWO SHILLINGS and SIXPENCE**

**EDITION CL-13**

For the convenience of Owners, **SPARES STOCKISTS** are appointed for most districts. To save delay, and the delivery surcharge, customers are recommended to always first apply to their nearest Dealer or spares stockist.

#### (1) TERMS OF BUSINESS.

Our terms are :— CASH WITH ORDER,  
CASH AGAINST PRO-FORMA INVOICE, OR  
APPROVED LEDGER ACCOUNT.

Other than in exceptional cases we do not send goods by "CASH ON DELIVERY" (C.O.D.). Note the minimum postage fee for a C.O.D. parcel is ten pence.

Customers who wish to avoid delay can open deposit accounts and the usual deposit is £2.

Orders from abroad should be accompanied by a remittance to cover the costs of goods and postal charges, but we shall be pleased to supply by "CASH ON DELIVERY" (V.P.P.) where that system is in operation. In the latter instance, a deposit of approximately twenty-five per cent. of the value of the goods must be remitted with the order.

#### (2) PRICES AND SPECIFICATIONS.

All prices, specifications and conditions are subject to alteration without notice. The prices of spares do not include the costs of packing and carriage.

#### (3) CARRIAGE AND PACKING.

All invoices for spare parts will be SURCHARGED by FIVE PER CENT. to cover the cost of packing and postage, or carriage, and the minimum surcharge is sixpence.

A special packing case, or crate, is required for some spares to ensure freedom from damage in transit. In such circumstances a special charge for the value of the case, or crate, will be made in addition to the five per cent. surcharge but the special charge will be credited in full if the container is promptly returned to our factory carriage paid and in good condition.

#### (4) HOW TO ORDER SPARES.

STATE :— (a) The Model of the machine.  
(b) The complete engine number. (See paragraph 5.)  
(c) The frame number. (See paragraph 5.)  
(d) The part numbers of the spares required.  
(e) A description of each spare.  
(f) The quantity required of each item.  
(g) How the spares are to be sent. (Post, Parcels Post, Passenger train or Goods train.)  
(h) Your full name and address. These particulars are best written in BLOCK LETTERS.  
(i) Mention if, or not, you have an account with us.

ALSO :— Unless you have a deposit or ordinary account, enclose a remittance to cover the cost of the spares plus the five per cent. surcharge. (See paragraph 3.)  
When cash is sent any excess will be refunded without prior application.

NOTE :— When sending orders by telegram or cable do not omit your name and address from the "message."

#### (5) IDENTITY.

To ensure the supply of correct spares it is essential we can identify the machine for which they are required. The ONLY WAY to do that is for us to know the COMPLETE ENGINE and frame numbers.

The engine number is stamped on the crankcase, IN FRONT OF LEFT CYLINDER, and may have one or more letters incorporated in it. THE COMPLETE NUMBER MUST BE QUOTED.  
The frame number is stamped on the right-hand side of the frame lug that is below the saddle.

**(6) SERVICE.**

The **SERVICE AND REPAIR DEPARTMENT** is situated in **BURRAGE GROVE, PLUMSTEAD, LONDON, S.E.18**, and is open on Mondays to Fridays from 8-30 a.m. to 1 p.m.—2 p.m. to 5-30 p.m. It is closed on Saturdays, Sundays and National Holidays.

It exists for the purpose of :—

- (a) Giving technical assistance verbally or through the Post.
- (b) Supplying spare parts over the counter or through the Post.
- (c) Repairing and re-conditioning machines, or parts of machines, of our make.

If it is considered necessary to bring a machine, or parts, to the factory for an urgent repair **IT IS ESSENTIAL** you make an appointment beforehand to avoid disappointment. This can be done by letter or telephone.

**(7) REPAIRS.**

The instructions regarding repairs should be clear and definite, otherwise the cost may be greater than that expected. We shall be pleased to give estimates for repairs if parts are sent to us for that purpose. If the estimate is accepted, no charge is made for the preliminary examination, but, should it be decided not to have the work carried out, it may be necessary to make a charge to cover the cost of whatever dismantling and re-assembly may have been done to prepare the estimate.

**(8) REPAIRS TO PROPRIETARY FITTINGS.**

We do not repair carburettors, chains, electrical equipment, saddles, sparking plugs, speedometers and tyres. On page 80 of the "**MAINTENANCE MANUAL AND INSTRUCTION BOOK**" will be found the names and addresses of the manufacturers of the proprietary equipment we fit, all of whom service and repair equipment they make.

**(9) PATTERNS.**

Parts sent to us as patterns, or for repair, should have attached to them a label bearing the sender's full name and address. The instructions regarding such parts should be sent under separate cover.

**(10) GUARANTEE.**

All parts made by us, and sold as spares, are subject to the same Limited Guarantee as that issued with each new motor cycle and that guarantee is printed in full on Page 83 of the "**MAINTENANCE MANUAL AND INSTRUCTION BOOK.**"

**(11) INSTRUCTION BOOK.**

A **MAINTENANCE MANUAL AND INSTRUCTION BOOK** (Edition CM-11) has been compiled and published by us. It is only suitable for **A·J·S "SPRINGTWIN" Model 20** machines.

It is an eighty-eight page book with thirty-four illustrations and one copy is supplied free, upon application, with each new motor cycle. Replacement copies are two shillings and sixpence each.

**(12) CORRESPONDENCE.**

Our routine is organised into different departments. Therefore delay cannot be avoided if matters relating to more than one department are contained in one letter.

Consequently when communicating with more than one department it is desirable to do so on **SEPARATE SHEETS**. Each sheet should bear the sender's name and address. **IN PARTICULAR**, requests for **TECHNICAL ADVICE** should not be on the same sheets as **ORDERS FOR SPARE PARTS**.

**A·J·S MOTOR CYCLES,  
PLUMSTEAD, LONDON, S.E.18**

**NOTE**

The numbers, in brackets, that appear in the "Description" columns relate to the numbered foot notes regarding items so specially indicated.

The quantities per machine of each item are entered in the "Qty" columns. "R" indicates as may be required.

The illustrations are not to scale and are not necessarily accurate in detail.

The detailed index is on inside rear cover.

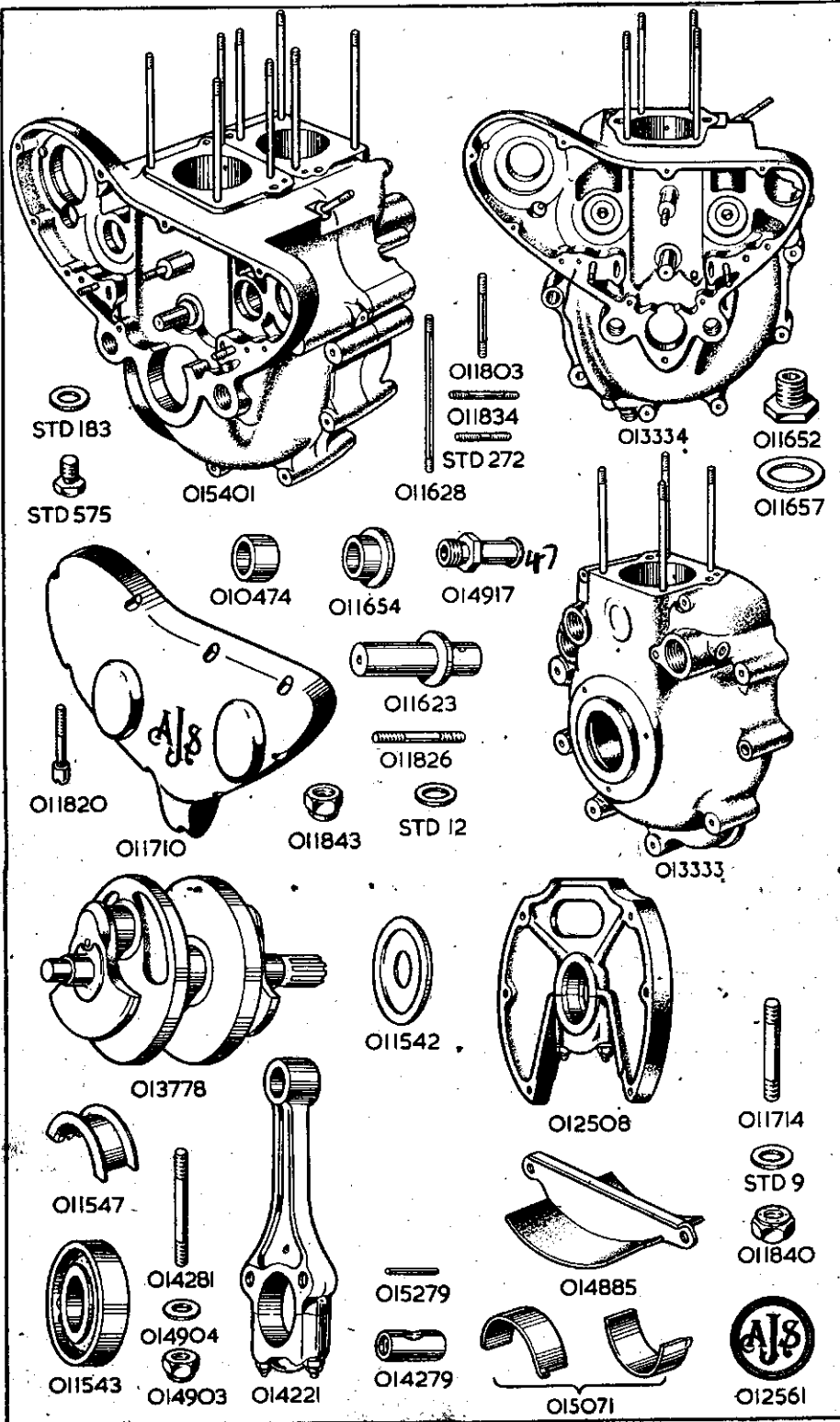

PART NUMBER.	DESCRIPTION.	QTY.	PRICE EACH £ s. d.
<b>CRANKCASE</b>			
015401	... .. Crankcase, complete (1) .....	1	16 6 11
013333	... .. Crankcase, driving side only (2).....	1	5 3 6
013334	... .. Crankcase, timing side only (3).....	1	7 6 8
012508	... .. Web, centre, with cap, studs, washers and nuts. (No bearing)	1	12 4
014885	... .. Deflector, oil, for crankcase .....	1	2 9
011710	... .. Cover, for timing gear.....	1	11 8
012561	... .. Badge, monogram, for driving side crankcase.....	1	4 3
011826	... .. Stud, fixing centre web. $1\frac{1}{2}$ in. by $\frac{1}{4}$ in. by 26 and 20 .....	6	3
STD-12	... .. Washer, plain, for centre web top fixing studs .....	2	1
STD-12	... .. Washer, plain, for centre web centre fixing studs.....	2	1
011843	... .. Nut, for centre web fixing studs .....	6	5
011714	... .. Stud, for centre web bearing cap, $2\frac{1}{16}$ in. by $\frac{7}{16}$ in. by 18 and 18	2	1 4
STD-9	... .. Washer, plain, for centre web bearing cap stud.....	2	1
011840	... .. Nut, for centre web bearing cap stud .....	2	7
011628	... .. Stud, in driving side crankcase, for cylinder and head, $5\frac{7}{16}$ in. by $\frac{5}{16}$ in. by 22 and 22 .....	4	2 9
011628	... .. Stud, in timing side crankcase, for cylinder and head, $5\frac{7}{16}$ in. by $\frac{5}{16}$ in. by 22 and 22 .....	4	2 9
011834	... .. Stud, in timing side crankcase, for pump carrying plate $1\frac{5}{8}$ in. by $\frac{5}{16}$ in. by 26 and 22.....	3	3
STD-272	... .. Stud, in timing side crankcase, for fixing magneto, $1\frac{1}{4}$ in. by $\frac{5}{16}$ in. by 26 and 22 .....	2	4
011803	... .. Stud, in timing side crankcase, for dynamo strap, $1\frac{1}{8}$ in. by $\frac{1}{4}$ in. by 26 and 20.....	1	3
011623	... .. Shaft, in timing side crankcase, for intermediate gear .....	1	5 9
STD-575	... .. Plug, drain, for timing side crankcase .....	1	6
STD-183	... .. Washer, fibre, for crankcase drain plug .....	1	3
011820	... .. Screw, retaining timing gear cover .....	10	6
011652	... .. Adaptor, to accommodate oil feed and return pipe retaining banjo pins. (Screws into timing side crankcase) .....	2	1 10
011657	... .. Washer, fibre, for banjo pin adaptors .....	2	1
014917	... .. Union, to accommodate crankcase release valve pipe. (Screws into driving side crankcase) .....	1	6
STD-183	... .. Washer, fibre, for crankcase release valve pipe union .....	1	3
010474	... .. Bush, plain, for camshafts. (In driving side crankcase) .....	2	2 3
011654	... .. Bush, flanged, for camshafts. (In timing side crankcase).....	4	3 3

**NOTE 1.—Includes :—**

Driving side crankcase. Timing side crankcase, centre web with studs (no bearing, washers and oil deflector). All bushes for camshafts. All cylinder studs. Shaft for intermediate gear. Studs for pump carrying plate. Two magneto fixing studs. Dynamo strap stud. Timing gear cover and fixing screws. Monogram badge fitted to driving side crankcase. Three bolts. One stud. Two nuts. Five washers.

**NOTE 2.—Includes :—**

Two camshaft bushes. Four cylinder studs. Six studs for centre web. (No monogram badge).

**NOTE 3.—Includes :—**

Four camshaft bushes. Four cylinder studs. Shaft for intermediate gear. Three studs for pump carrying plate. Two studs for magneto fixing. One stud for dynamo strap. (No timing gear cover and fixing screws).

PART NUMBER	DESCRIPTION.	QTY.	PRICE EACH £ s. d.
-------------	--------------	------	-----------------------

### CRANKSHAFT, BEARINGS, CONNECTING RODS AND BIG-END BEARINGS.

013778	...	...	Crankshaft, plugged, but bare	1	...	9	2	9
011542	...	...	Washer, for crankshaft	2	...		9	0
011547	...	...	Bearing, plain, for centre bearing (in halves) per pair	1	...	15	4	
011543	...	...	Bearing, roller, for crankshaft. (Parts of this bearing not sold separately) (4)	2	...	1	4	6
014221	...	...	Rod, connecting, assembly. (No Big-end bearing)	2	...	3	1	0
014281	...	...	Stud, for connecting rod, 2 $\frac{3}{32}$ in. by $\frac{5}{16}$ in. by 26	4	...			9
014279	...	...	Trunnion, for connecting rod stud	4	...		2	6
015279	...	...	Rivet, locating connecting rod stud	4	...			2
014904	...	...	Washer, plain, for connecting rod stud	4	...			1
014903	...	...	Nut, for connecting rod stud	4	...			6
015071	...	...	Bearing, plain, for connecting rod. (Big-end) in halves, per pair	2	...	13	4	

The following undersize bearings can be supplied. It is necessary to have the journals ground to suit. All are sold in pairs.

1st Undersize is .010 inch below normal.

2nd Undersize is .020 inch below normal.

3rd Undersize is .030 inch below normal.

015072	...	...	Bearing, plain, for centre bearing. 1st Undersize	1	...	15	4	
015073	...	...	Bearing, plain, for centre bearing. 2nd Undersize	1	...	15	4	
015406	...	...	Bearing, plain, for centre bearing. 3rd Undersize	1	...	15	4	
015402	...	...	Bearing, plain, for connecting rod. 1st Undersize	2	...	13	4	
015403	...	...	Bearing, plain, for connecting rod. 2nd Undersize	2	...	13	4	
015405	...	...	Bearing, plain, for connecting rod. 3rd Undersize	2	...	13	4	

NOTE 4.—Dimensions :—

Internal diameter,  $1\frac{3}{8}$  in.

External diameter, 3 in.

Width,  $\frac{1}{4}$  in.

Manufacturer's Part Number, RLS 12 $\frac{1}{2}$ .

### CYLINDERS, PISTONS, HEADS AND VALVES.

011713	...	...	Cylinder	2	...	2	10	0
011716	...	...	Washer, paper, for cylinder base	2	...			1
015518	...	...	Piston, bare, normal size	2	...	17	6	
015803	...	...	Piston, bare, .020 in. oversize (5)	2	...	17	6	
015804	...	...	Piston, complete, normal size (6)	2	...	1	6	3
015805	...	...	Piston, complete, .020 in. oversize (5) (6)	2	...	1	6	3
010631	...	...	Ring, compression, normal size	4	...		1	3
015522	...	...	Ring, compression, .020 in. oversize (5)	4	...		1	3
010632	...	...	Ring, scraper, normal size	2	...		1	7
015523	...	...	Ring, scraper, .020 in. oversize (5)	2	...		1	7
011731	...	...	Pin, gudgeon	2	...	4	2	
014283	...	...	Circlip, for gudgeon pin	4	...			3
015121	...	...	Head, for cylinder, left bare	1	...	5	2	4
015122	...	...	Head, for cylinder, right, bare	1	...	5	2	4
015526	...	...	Head, for cylinder, left, with valve guides fitted (7)	1	...	5	8	0
015527	...	...	Head, for cylinder, right, with valve guides fitted (7)	1	...	5	8	0
011715	...	...	Gasket, for cylinder head	2	...	3	6	
014163	...	...	Valve, inlet	2	...	7	6	
014165	...	...	Valve, exhaust	2	...	13	1	
011770	...	...	Spring, inner, for valve	4	...			8
011769	...	...	Spring, outer, for valve	4	...	1	3	
014169	...	...	Seat, for valve springs	4	...			8
014168	...	...	Collar, for valve springs	4	...	1	9	
014167	...	...	Collet, for valve stems	4	...			11
014170	...	...	Guide, for inlet valves	2	...	2	6	
014171	...	...	Guide, for exhaust valves	2	...	2	6	
014111	...	...	Circlip, locating valve guides	4	...			1
011635	...	...	Nut, retaining cylinders and heads	8	...			9
011634	...	...	Spacer, under head retaining nuts, $\frac{3}{32}$ in. long	8	...			3
010625	...	...	Stud, retaining inlet manifold, $1\frac{1}{16}$ in. by $\frac{1}{4}$ in. by 26 and 20	4	...			3



PART NUMBER.	DESCRIPTION.	QTY.	PRICE EACH £ s. d.
--------------	--------------	------	-----------------------

NOTE 5.—Cylinders to be ground .020 in. "oversize" to suit.

NOTE 6.—Includes :—

Piston. Two compression rings. One scraper ring. Gudgeon pin. Two circlips for gudgeon pin.

NOTE 7.—Includes :—

One inlet valve guide. One exhaust valve guide. Two circlips locating valve guides. Two studs for inlet manifold.

### RE-BORING.

Cylinders may be re-bored to .020 in. oversize and pistons (with rings) supplied to suit. The charge is £4 6s. 6d. with an additional 9s. 4d. if new gudgeon pins and circlips are also supplied.

Cylinders sent for re-boring should be packed in stout cases which will be used by us for their return. Carriage is additional. If a complete machine, or engine, is sent to us for cylinder re-boring, there will be an additional charge, according to the time taken, for dismantling and assembly.

### TIMING GEAR.

011784	...	...	Camshaft, inlet	1	...	1	11	0
011785	...	...	Camshaft, exhaust	1	...	1	11	0
011620	...	...	Gear, on camshaft, 60 teeth	2	...		17	6
STD-573	...	...	Key, locating camshaft gears	2	...			4
011653	...	...	Nut, retaining camshaft gears	2	...			7
011544	...	...	Pinion, on crankshaft, 30 teeth	1	...		10	6
STD-573	...	...	Key, locating crankshaft pinion	1	...			4
011776	...	...	Bolt, retaining crankshaft pinion, threaded $\frac{1}{2}$ in. by 20	1	...			9
010589	...	...	Washer, plain, for crankshaft pinion bolt	1	...			5
011621	...	...	Gear, intermediate, with bush, 60 teeth	1	...		18	6
015278	...	...	Bush, for intermediate gear	1	...			10
014154	...	...	Follower, for camshaft	4	...		12	9
011626	...	...	Spindle, for camshaft followers	2	...		2	6
011627	...	...	Spacer, between camshaft followers, $1\frac{3}{4}$ in. long	2	...			8

### ROCKERS AND PUSH RODS.

014284	...	...	Rocker, with bushes (left inlet and right exhaust)	2	...	1	2	9
014285	...	...	Rocker, with bushes (right inlet and left exhaust)	2	...	1	2	9
014222	...	...	Spindle, for rockers	4	...		11	3
014226	...	...	Washer, spring, double coil, for rocker spindle	4	...			1
014275	...	...	Washer, plain, for either side of rocker spindle spring washer	8	...			2
014275	...	...	Washer, plain, for clamping end of rocker spindle	4	...			2
011760	...	...	Bolt, clamping rocker spindle. (Thread No. 2 B.A.)	4	...	1		2
015021	...	...	Washer, plain, for rocker spindle clamping bolt	4	...			1
011846	...	...	Nut, for rocker spindle clamping bolt	4	...			3
014245	...	...	Bush, for rockers. (Two in each rocker)	8	...			7
014381	...	...	Cover, for rockers	4	...		10	6
014411	...	...	Gasket, for rocker covers	4	...			6
014412	...	...	Bolt, short head, retaining rocker covers, 2 B.A. by $1\frac{1}{8}$ in. under head	8	...			3
014413	...	...	Bolt, long head, retaining rocker covers, 2 B.A. by $1\frac{1}{8}$ in. under head	8	...			3
014120	...	...	Rod, push, assembled with ends	4	...		9	1
014116	...	...	Rod, push, bare	4	...		3	3
014115	...	...	End, upper, for push rod	4	...		3	3
014114	...	...	End, lower, for push rod	4	...		2	7

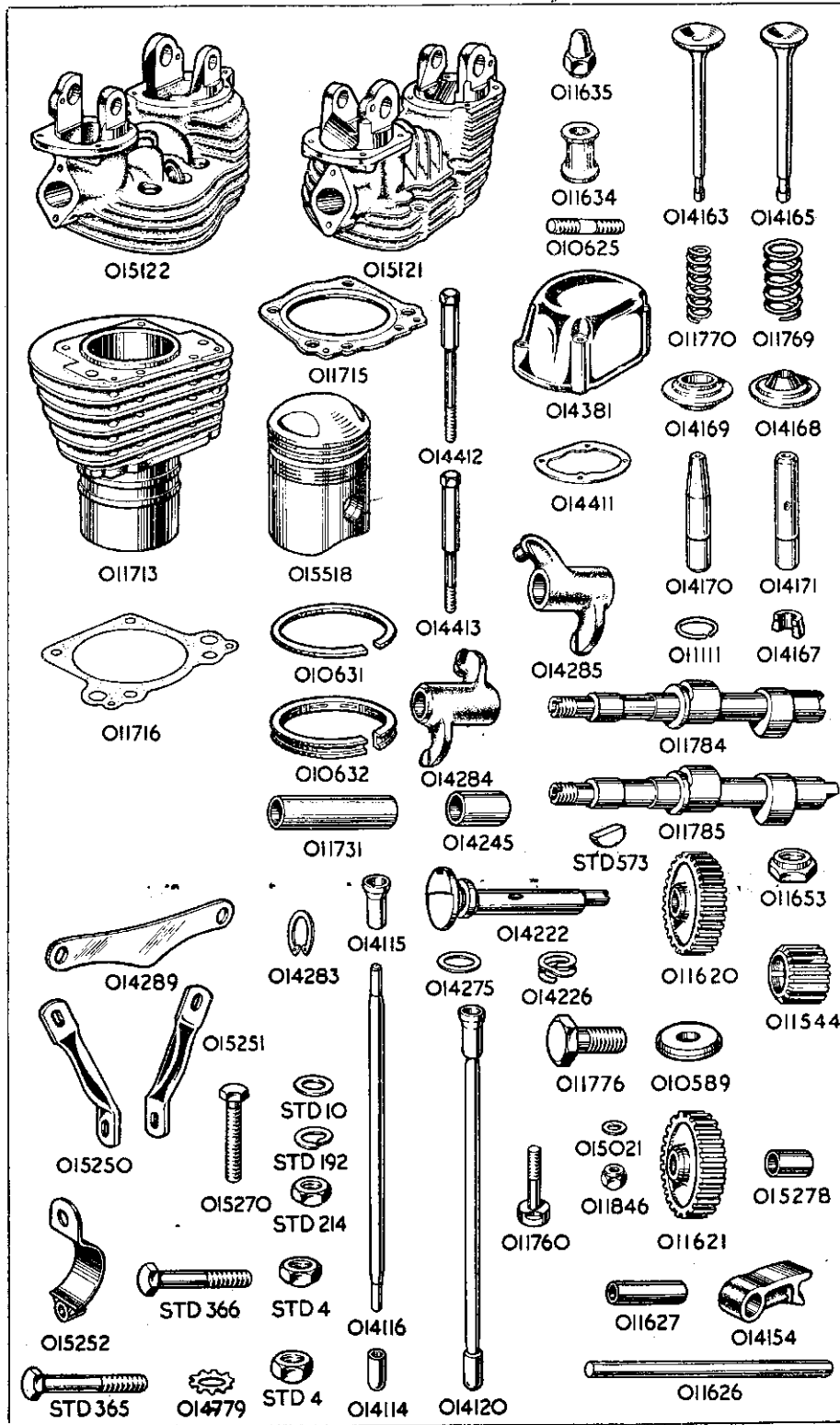

PART NUMBER.	DESCRIPTION.	QTY.	PRICE EACH £ s. d.
<b>ENGINE STEADY STAY.</b>			
015250	Stay, engine steady, right side	1	1 9
015251	Stay, engine steady, left side	1	1 9
015252	Clip, half only, on frame tube, for steady stay	2	2 10
STD-365	Bolt, securing fronts of steady stay frame clips $1\frac{1}{16}$ in. by $\frac{5}{16}$ in. by 26	1	6
014779	Washer, lock, for steady stay frame clip front bolt	1	1
STD-4	Nut, for steady stay frame clip front bolt	1	3
STD-366	Bolt, securing steady stays and frame clips, $1\frac{1}{8}$ in. by $\frac{5}{16}$ in. by 26	1	6
STD-4	Nut, for steady stays and frame clip securing bolt	1	3
014289	Plate, tie, for cylinder heads and steady stays	1	2 9
015270	Bolt, retaining steady stays and tie plate to head, $1\frac{1}{8}$ in. by $\frac{5}{16}$ in. by 22	2	4
STD-10	Washer, plain, under heads of tie plate bolts	2	1
STD-192	Washer, spring, for tie plate bolts	2	1
STD-214	Nut, for tie plate bolts	2	3

#### OIL PUMPS.

013345	Oil pumps, complete, assembled on carrying plate (8)	1	5 16 3
015017	Plate, carrying oil pumps, bare (9)	1	13 6
011842	Nut, securing pump carrying plate to timing side crankcase	3	7
STD-11	Washer, plain, for pump carrying plate fixing nuts	3	1
STD-21	Ball, $\frac{3}{16}$ in. steel, for return pump bleed valve	1	1
STD-701	Spring, for return pump bleed valve ball	1	3
015001	Screw, securing return pump bleed valve spring. (Grub screw, $\frac{1}{2}$ in. long by $\frac{5}{16}$ in. by 22)	1	2
012333	Body, oil feed pump, for $\frac{1}{4}$ in. gears	1	13 6
012336	Gear, driving, for oil feed pump, $\frac{1}{4}$ in. wide	1	10 0
012337	Gear, driven, for oil feed pump, $\frac{1}{4}$ in. wide	1	9 0
011554	Plate, end, for oil feed pump	1	12 3
011556	Pin, dowel, locating oil feed pump end plate	1	1
011617	Washer, paper, between oil feed pump and carrying plate	1	1
STD-453	Screw, retaining oil feed pump to carrying plate, 1 in. by 2 B.A.	3	3
011553	Body, oil return pump, for $\frac{3}{8}$ in. gears	1	16 5
011559	Gear, driving, for oil return pump, $\frac{3}{8}$ in. wide	1	10 0
011560	Gear, driven, for oil return pump, $\frac{3}{8}$ in. wide	1	9 0
011554	Plate, end, for oil return pump	1	12 3
011556	Pin, dowel, locating oil return pump end plate	1	1
011617	Washer, paper, between oil return pump and carrying plate	1	1
STD-453	Screw, retaining oil return pump to carrying plate, 1 in. by 2 B.A.	3	3

NOTE 8.—Includes all the items listed above except the three 011842 and STD-11 fixing nuts and washers.

NOTE 9.—Includes the STD-21, STD-701 and 015001 bleed valve ball, spring and retaining grub screw.

#### OIL FELT FILTER (IN ENGINE).

014235	Filter, felt, for engine crankcase	1	6 0
014239	Seat, for oil felt filter	1	6
014248	Valve, relief, for oil felt filter	1	3 9
014241	Spring, for oil felt filter relief valve	1	2
014238	Cap, for felt filter housing. (Also accommodates oil non-return valve)	1	5 9
011642	Washer, fibre, for filter housing cap	1	2
011645	Ball, $\frac{3}{8}$ in. steel, for non-return valve	1	2
014243	Seat, for non-return valve ball	1	1
014817	Circlip, retaining non-return valve seat	1	1
013564	Spring, for non-return valve ball	1	2
015034	Gasket, paper, for oil filter chamber. (Fits between the two crankcase halves)	1	1

#### OIL DISTRIBUTOR. (Driven by left hand end of exhaust camshaft.)

014246	Distributor, oil	1	2 8
014247	Cap, housing, for oil distributor	1	5 3
011642	Washer, fibre, for oil distributor housing cap	1	2

PART NUMBER.	DESCRIPTION.	QTY.	PRICE EACH £ s. d.
--------------	--------------	------	-----------------------

**OIL RELIEF VALVE.** (Located in Timing side crankcase, close to oil feed pump.)

011645	Ball, $\frac{3}{8}$ in. steel, for oil relief valve	1	2
011644	Spring, for oil relief valve ball	1	3
011646	Plug, retaining oil relief valve ball spring	1	4
STD-183	Washer, fibre, for oil relief valve plug	1	1

**CRANKCASE RELEASE VALVE.**

014248	Valve, crankcase release	1	3 9
011648	Cap, housing, for crankcase release valve	1	2 2
011642	Washer, fibre, for crankcase release valve housing cap	1	2

**MAGNETO.**

014573	Magneto, complete, Type K2F. (Lucas number, 42180-A)	1	8 10 0
458367	Pick-up, with brush and spring, right	1	4 0
458368	Pick-up, with brush and spring, left	1	4 0
470534	Contact breaker, complete	1	4 2
470609	Contact set	1	9 6
458619	Cover, for contact breaker	1	5 9
010339	Gasket, for magneto flange	1	1
STD-365	Bolt, retaining magneto, $1\frac{1}{8}$ in. by $\frac{5}{16}$ in. by 26	1	6

For the two magneto retaining studs, see "CRANKCASE GROUP."

014779	Washer, lock, for magneto retaining bolt and studs	3	1
014734	Nut, for magneto retaining bolt and studs	3	2
014464	Gear, on magneto shaft	1	7 0
140074	Washer, plain, on magneto shaft	1	1
171284	Nut, on magneto shaft, retaining magneto driving gear	1	3

**DYNAMO.**

011833	Dynamo, Type E3-L-LI-0. (Lucas Number 20009)	1	6 10 0
200737	Brush, for dynamo, set of two, per set	1	3 6
014141	Gasket, between dynamo and crankcase	1	1
011801	Strap, retaining dynamo to crankcase	1	9
014796	Screw, retaining lower end of dynamo strap to crankcase, $\frac{7}{16}$ in. by $\frac{1}{2}$ in. by 20	1	2
STD-12	Washer, plain, for dynamo strap retaining screw	1	1
010604	Crosshead, in eye of dynamo retaining strap	1	6
011802	Nut, tensioning dynamo strap. (The stud, on which this nut screws, is listed with the crankcase parts)	1	4
STD-12	Washer, plain, for dynamo strap tensioning nut	1	1
011800	Gear, on dynamo shaft	1	8 6
STD-572	Key, locating dynamo shaft gear	1	3
111700	Bolt, retaining gear on dynamo shaft	1	10
188378	Washer, lock, for dynamo gear retaining bolt	1	2

**CARBURETTER.**

014288	Carburetter, complete (less wires and levers). Type 76AG/IAU	1	2 19 3
011633	Manifold, inlet, bare, (no studs). (The studs are listed with cylinder heads)	1	17 0
STD-12	Washer, plain, for inlet manifold retaining studs	4	1
STD-5	Nut, for inlet manifold retaining studs	4	3
011771	Gasket, between inlet manifold and cylinder heads	2	1
010624	Stud, retaining carburetter to inlet manifold, $1\frac{1}{2}$ in. by $\frac{5}{16}$ in. by 26 and 22	2	4
STD-11	Washer, plain, for carburetter retaining studs	2	1
STD-74	Nut, retaining carburetter	2	3
STD-581	Gasket, between carburetter and inlet manifold	1	3

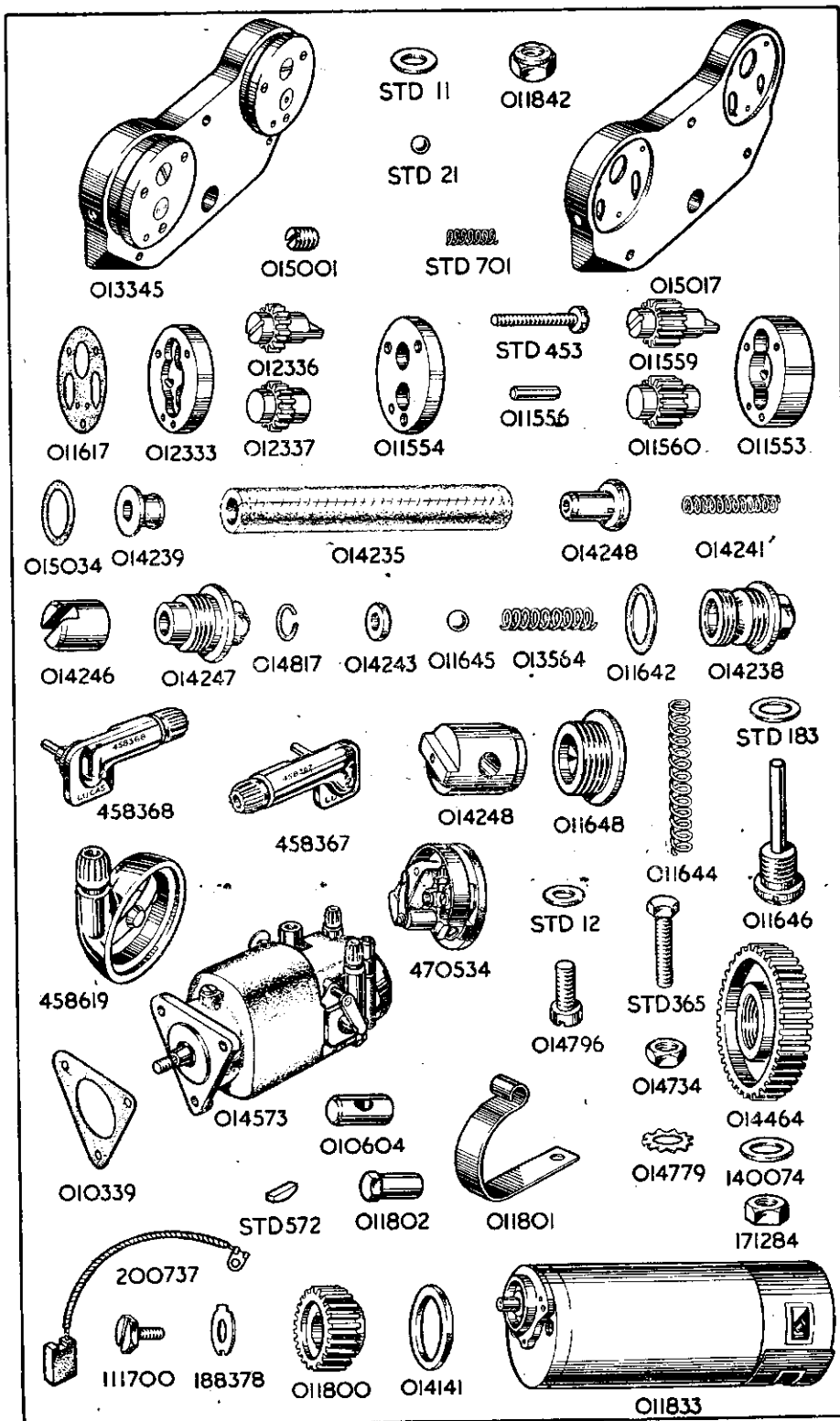

PART NUMBER	DESCRIPTION.	QTY.	PRICE EACH £ s. d.
<b>FLOAT CHAMBER.</b>			
64-192-B	Chamber, float, bare	1	14 0
13-153	Screw, plug, blocking passage in float chamber	1	3
14-039	Washer, fibre, for float chamber passage plug screw	1	1
14-208-B	Top, or cover, for float chamber	1	3 9
14-021	Screw, locking float chamber top	1	4
14-015	Float, bare	1	3 9
14-024	Needle, for float	1	1 6
14-209	Tickler, bare	1	10
14-210	Stop, for tickler	1	3
14-032	Spring, for tickler	1	2
14-289	Cotter (split pin), for tickler	1	1
14-035	Banjo, connection, for petrol pipe	1	3 0
14-175	Washer, fibre, upper, for petrol banjo connection	1	2
14-037	Washer, fibre, lower, for petrol banjo connection	1	2
14-036	Nut, retaining banjo connection to float chamber	1	9

### MIXING BODY.

76-014	Body, mixing, bare	1	14 0
6-033	Nut, union, for base of mixing body	1	2 3
6-040	Washer, fibre, for mixing body union nut	1	2
4-043	Bolt, holding float chamber to mixing body	1	3 0
4-053	Washer, fibre, for float chamber holding bolt	2	2
206-038-R	Intake, air	1	3 0
6-032-B	Top, for mixing chamber	1	2 6
6-031	Ring, fixing top to mixing chamber	1	2 6
4-235	Clip, locking mixing chamber top fixing ring	1	9
4-241	Screw, securing locking clip to mixing body top	1	2
4-035	Adjuster, for control cable, throttle or air	2	6

### CHOKE AND JETS.

6-058	Choke, or jet barrel	1	7 6
4-061	Needle jet	1	2 6
4-042-180	Jet, main, size 180	1	8
6-065	Needle, taper, for needle jet	1	2 0
4-230	Clip, for jet taper needle	1	6
4-060	Pin, split, locating taper needle clip	1	1
13-129	Screw, for pilot jet air adjustment	1	9
16-010	Nut, lock, for pilot jet air screw	1	2
The following alternative main jets can be supplied.			
4-042-170	Jet, main, size 170	1	8
4-042-190	Jet, main, size 190	1	8

### VALVES (CARBURETTER).

6-052	Valve, throttle, size 6/3	1	6 0
29-047	Spring, for throttle valve	1	4
4-063	Screw, stop, for throttle valve	1	9
16-010	Nut, lock, for throttle valve stop screw	1	2
6-045	Valve, air	1	3 9
6-047	Guide, tubular, for air valve spring	1	1 0
4-046	Spring, for air valve	1	4

WHEN IN DOUBT REGARDING THE NAMES AND PART NUMBERS OF THE PARTS YOU REQUIRE, PLEASE SEND THE OLD PARTS TO SERVE AS PATTERNS.

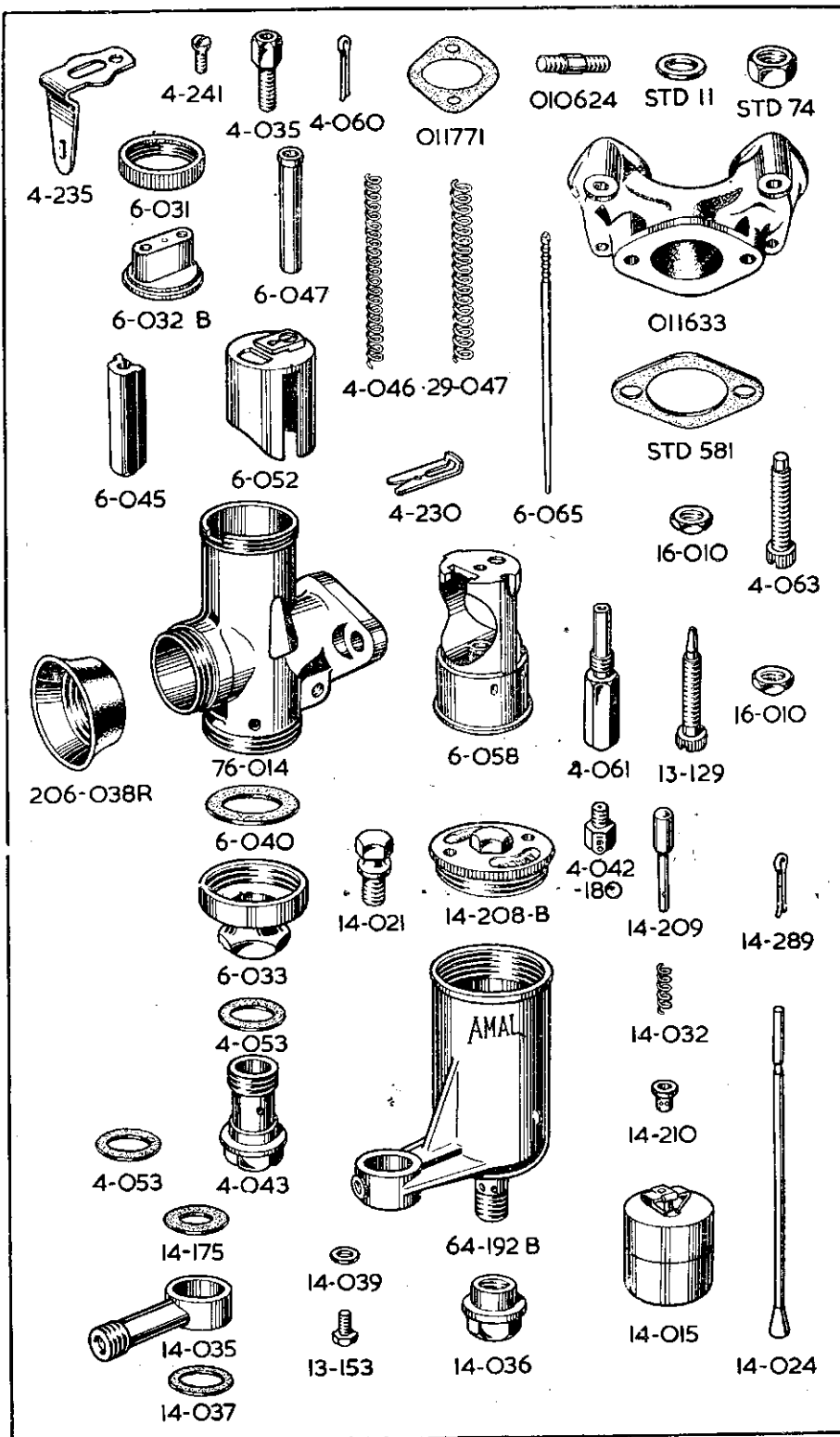

PART NUMBER.	DESCRIPTION.	QTY.	PRICE EACH £ s. d.
--------------	--------------	------	-----------------------

**CRANKCASE BOLTS, WITH ENGINE PLATES AND ALL BOLTS PASSING THROUGH SAME.**

014292	...	Bolt, clamping crankcase throat, $3\frac{1}{16}$ in. by $\frac{5}{16}$ in. by 22. (These bolts pass through the driving side crankcase and thread into the timing side crankcase)	3	9
STD-11	...	Washer, plain, for 014292 crankcase bolts	3	1
013944	...	Plate, engine, front, right side	1	2 0
013943	...	Plate, engine, front, left side	1	2 0
014736	...	Stud, passing through crankcase and upper holes in engine front plates, 5 in. by $\frac{5}{8}$ in. by 26 (This stud also supports the stays for the exhaust pipes)	1	5
STD-174	...	Washer, plain, for 014736 engine plate stud	2	1
STD-192	...	Washer, spring, for 014736 engine plate stud	2	1
STD-4	...	Nut, for 014736 engine plate stud	2	3
STD-278	...	Stud, passing through crankcase and lower holes in engine front plates, $4\frac{9}{16}$ in. by $\frac{5}{8}$ in. by 26	1	6
STD-11	...	Washer, plain, for STD-278 engine plate stud	2	1
STD-4	...	Nut, for STD-278 engine plate stud	2	3
STD-277	...	Stud, passing through crankcase at bottom, $4\frac{3}{8}$ in. by $\frac{5}{8}$ in. by 26	1	6
STD-11	...	Washer, plain, for STD-277 crankcase stud	2	1
STD-4	...	Nut, for STD-277 crankcase stud	2	3
STD-303	...	Stud, passing through front of main frame and top of engine front plates, $4\frac{1}{2}$ in. by $\frac{3}{8}$ in. by 26	1	6
STD-10	...	Washer, plain, for STD-303 frame stud	2	1
STD-3	...	Nut, for STD-303 frame stud	2	3
014911	...	Stud, passing through main frame front tube bottom lug, the crankcase, and the front ends of the rear frame rails, $5\frac{1}{8}$ in. by $\frac{5}{16}$ in. by 26	1	1 0
STD-11	...	Washer, plain, for 014911 frame stud	2	1
STD-4	...	Nut, for 014911 frame stud	2	3
013942	...	Plate, engine, rear	2	6 0
STD-278	...	Stud, passing through top of engine rear plates and the crankcase, $4\frac{9}{16}$ in. by $\frac{5}{8}$ in. by 26	1	6
STD-278	...	Stud, passing through bottom of engine rear plates and the crankcase, $4\frac{9}{16}$ in. by $\frac{5}{8}$ in. by 26	1	6
STD-11	...	Washer, plain, for STD-278 studs (two per stud)	4	1
STD-4	...	Nut, for STD-278 studs (two per stud)	4	3
STD-316	...	Stud, passing through engine rear plates, rear of crank case, and centre of front chaincase, $7\frac{7}{16}$ in. by $\frac{7}{16}$ in. by 26. (Stud should be fitted so that the longer thread is on left hand side of machine)	1	1 2
014084	...	Spacer, $1\frac{1}{2}$ in. long, on STD-316 stud, between back of front chaincase and crankcase	1	7
35-2-C29	...	Spacer, $\frac{7}{8}$ in. long, on STD-316 stud, inside front chaincase	1	4
STD-220	...	Nut, thin, on STD-316 stud, inside front chaincase	1	6
STD-9	...	Washer, plain, for STD-316 stud	2	1
STD-2	...	Nut, for STD-316 stud	2	4
STD-303	...	Stud, passing through top of engine rear plates, lower end of main frame seat tube and rear fork bridge, $4\frac{1}{2}$ in. by $\frac{3}{8}$ in. by 26	1	6
STD-3	...	Nut, for STD-303 stud	2	3
STD-278	...	Stud, passing through rear fork bridge and back ends of engine rear plates, $4\frac{9}{16}$ in. by $\frac{5}{8}$ in. by 26 (The front chain adjusting eye bolt block screws on the right hand end of this stud)	1	6
STD-11	...	Washer, plain, for STD-278 stud	1	1
STD-4	...	Nut, for STD-278 stud	1	3

For the bolt and stud passing through the top and bottom of the gear box and the engine rear plates, see "Gear Box Fixing Bolts."

For the footrest rod, which passes through the bottoms of the engine rear plates and the frame rails, see "Footrests."



PART NUMBER.	DESCRIPTION.	QTY.	PRICE EACH £ s. d.
--------------	--------------	------	-----------------------

### GASKETS.

We supply engine gaskets, either as separate spares, or in complete sets.

Single gaskets are listed in the groups to which they belong.

Gaskets in complete sets are listed below.

015870	Complete gasket set for vertical twin engine	1	11 5
015869	Decarbonising gasket set for vertical twin engine	1	9 7

Each complete gasket set contains :—

1	STD-183	Washer, fibre, for crankcase drain plug.
1	STD-183	Washer, fibre, for crankcase release valve pipe union.
1	STD-183	Washer, fibre, for oil relief valve plug.
1	011642	Washer, fibre, for engine filter housing cap.
1	011642	Washer, fibre, for oil distributor housing cap.
1	011642	Washer, fibre, for crankcase release valve housing cap.
2	011657	Washer, fibre, for banjo pin adaptors in crankcase.
1	STD-581	Gasket, between carburettor and inlet manifold.
2	011617	Washer, paper, for oil pump bodies.
2	011716	Washer, paper, for cylinder bases.
1	015034	Washer, paper, for oil filter chamber.
1	010339	Gasket, between magneto and crankcase.
2	011715	Gasket, for cylinder head.
2	011771	Gasket, between inlet manifold and cylinder head.
1	014141	Gasket, between dynamo and crankcase.
4	014411	Gasket, for rocker covers.

Each decarbonising gasket set includes :

2	011715	Gasket, for cylinder heads.
4	014411	Gasket, for rocker covers.
2	011771	Gasket, between inlet manifold and cylinder heads.
1	STD-581	Gasket, between carburettor and inlet manifold.
2	011716	Washer, paper, for cylinder bases.

### EXHAUST PIPES AND SILENCERS.

014756	Pipe, exhaust, bare, left side	1	5 10
014758	Pipe, exhaust, bare, right side	1	5 10
014760	Baffle, for exhaust pipe	2	3 3
014754	Stay, for exhaust pipe, left side	1	3 0
014755	Stay, for exhaust pipe, right side	1	3 0
STD-4	Nut, fixing exhaust pipe to stay	2	3
STD-174	Washer, plain, for exhaust pipe fixing nut	2	1
014763	Silencer, bare, left side	1	15 5
014764	Silencer, bare, right side	1	15 5
20470	Clip, clamping silencer to pipe	2	1 7
STD-363	Bolt, for silencer clip, $\frac{3}{8}$ in. by $\frac{3}{16}$ in. by 26	2	4
STD-174	Washer, plain, for silencer clip bolt	2	1
STD-4	Nut, for silencer clip bolt	2	3
014748	Stay, for Silencer	2	2 6
STD-4	Nut, fixing silencer to stay	2	3
STD-174	Washer, plain, for silencer to stay fixing nut	2	1
STD-192	Washer, spring, for silencer to stay fixing nut	2	1
STD-4	Nut, fixing silencer stay to frame rail	2	3
STD-174	Washer, plain, for silencer stay to frame rail nut	2	1

### ENGINE SPROCKETS.

015203	Sprocket, engine, bare, 19 teeth	1	19 6
015204	Sprocket, engine, bare, 20 teeth. (This is the standard sprocket)	1	10 0
014294	Sprocket, engine, bare, 21 teeth	1	10 6
014295	Spacer (collar), $\frac{3}{16}$ in. wide, for engine sprocket	1	3 9
010622	Cam, engine shock absorber	1	8 9
STD-703	Spring, engine shock absorber	1	2 5
010590	Cap, for engine shock absorber spring	1	3
011775	Bolt, locking engine shock absorber assembly, threaded $\frac{1}{2}$ in. by 20	1	9
010589	Washer, plain, for engine shock absorber locking bolt	1	5

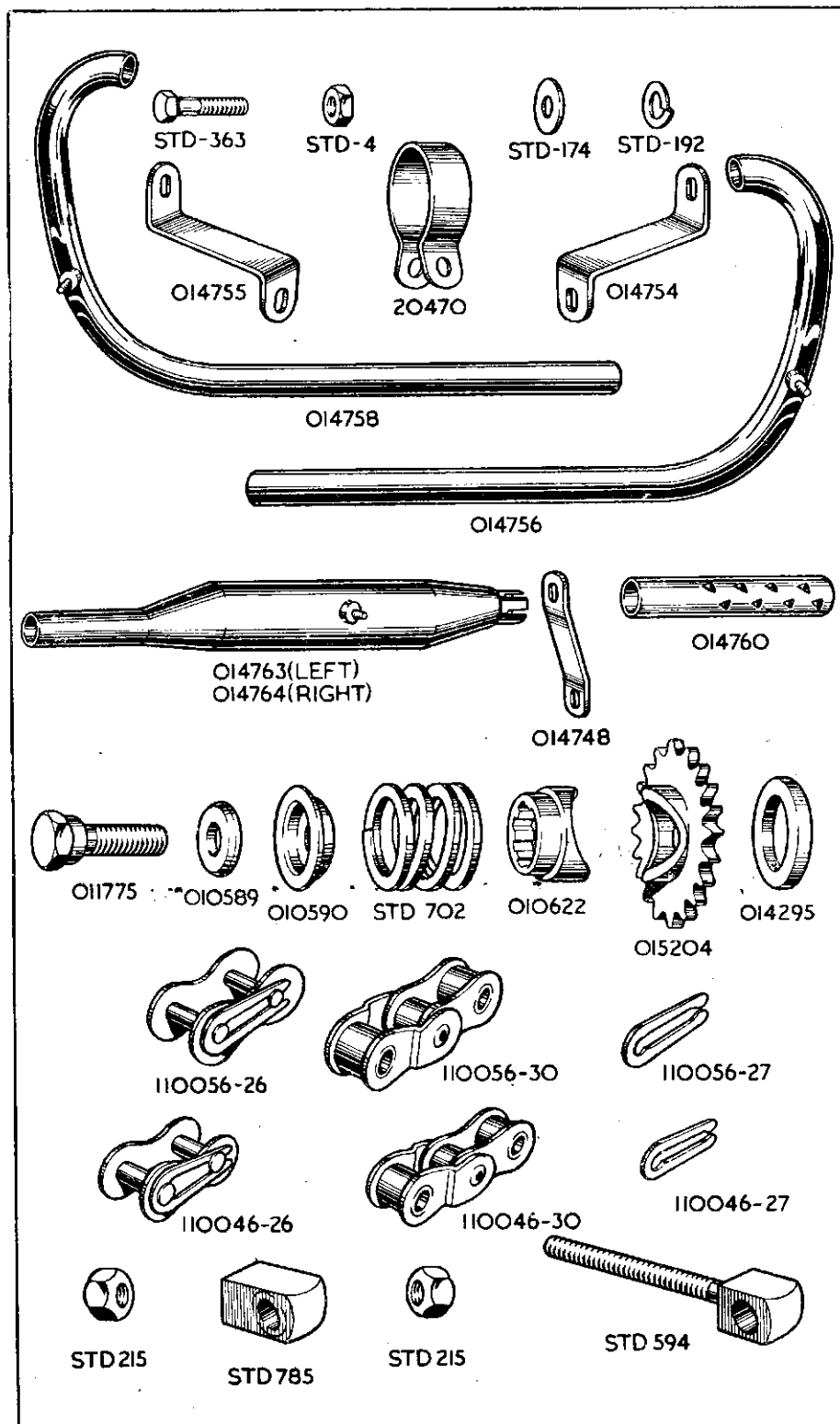

PART NUMBER	DESCRIPTION.	QTY.	PRICE EACH £ s. d.
-------------	--------------	------	-----------------------

### CHAINS.

110046-67	... Chain, front, 67 links, $\frac{1}{2}$ in. by .305 in.....	1	15 7
110056-96	... Chain, rear, 96 links, $\frac{5}{8}$ in. by .380 in. ....	1	12 11
110046-26	... Link, connecting, for $\frac{1}{2}$ in. chains .....	R	6
110056-26	... Link, connecting, for $\frac{5}{8}$ in. chains .....	R	9
110046-30	... Link, cranked, double, for $\frac{1}{2}$ in. chains.....	R	10
110056-30	... Link, cranked, double, for $\frac{5}{8}$ in. chains.....	R	1 2
110046-27	... Clip, spring, for 110046-26 connecting links, ( $\frac{1}{2}$ in.) .....	R	1
110056-27	... Clip, spring, for 110056-26 connecting links, ( $\frac{5}{8}$ in.) .....	R	1 $\frac{1}{2}$

The prices of front and rear chains include spring connecting links and these are also included in the number of links per chain.

We do not sell odd lengths of chains.

### GEAR BOX.

014556	... Gear box, complete, with clutch and with kick-starter and gear control levers .....	1	18 18 0
--------	---	---	---------

### GEAR BOX FIXING BOLTS.

010957	... Stud, fixing gear box at top, $5\frac{3}{16}$ in. by $\frac{7}{16}$ in. by 26. (This is same stud as 39-G9-G59).....	1	2 0
STD-313	... Stud, fixing gear box at bottom, $4\frac{1}{8}$ in. by $\frac{7}{16}$ in. by 26.....	1	10
012999	... Spacer, $\frac{1}{16}$ in. long, on 010957 top stud, outside right position ...	1	4
011086	... Spacer, $\frac{1}{2}$ in. long, on 010957 top stud, inside left and right positions. (This is same as 39-G9-G61) .....	2	4
011086	... Spacer, $\frac{1}{2}$ in. long, on STD-313 bottom stud, inside left and right positions. (This is same as 39-G9-G61) .....	2	4
STD-2	... Nut, on 010957 top fixing stud .....	2	4
STD-2	... Nut, on STD-313 bottom fixing stud .....	2	4
STD-9	... Washer, plain, on left side of 010957 top fixing stud.....	1	1
STD-594	... Eye-bolt, for front chain adjustment.....	1	1 3
STD-215	... Nut, front chain adjustment eye-bolt .....	2	4
STD-785	... Block, crosshead, for front chain adjustment eye-bolt. (This threads on the right hand end of STD-278 stud that passes through the rear of the engine rear plates and the top of the rear fork bridge) .....	1	1 0

### GEAR BOX SHELL.

1-CP-16	... Shell gear box, bare.....	1	2 2 0
60-X-6	... Stud, gear box shell, $1\frac{1}{16}$ in. by $\frac{5}{16}$ in. ....	2	9
60-X-9	... Stud, gear box shell, $3\frac{3}{16}$ in. by $\frac{5}{16}$ in. ....	2	9
60-X-1	... Stud, gear box shell, 1 in. by $\frac{1}{4}$ in. ....	2	9
152-X-1	... Nut, for $\frac{5}{16}$ in. gear box shell stud .....	4	4
63-X-1	... Nut, for $\frac{1}{4}$ in. gear box shell stud .....	2	3
348-X-1	... Plug, drain, for gear box shell .....	1	9
356-X-1	... Washer, drain plug .....	1	1
3-C-8	... Case, kick-starter.....	1	1 2 6
2-1C-2	... Washer, paper, for kick-starter case .....	1	1
286-X-1	... Stud, kick-starter case, $2\frac{1}{2}$ in. by $\frac{1}{4}$ in. ....	3	9
63-X-1	... Nut, for $\frac{1}{4}$ in. kick-starter case stud .....	3	3
4-C-15	... Cover for kick-starter case.....	1	1 2 6
4-1C-2	... Washer, paper, for kick-starter case cover .....	1	1
326-X-1	... Cap, filler, for kick-starter case cover .....	1	3 0
12-5-2	... Cap, in K/S case, for sector spindle bore .....	1	1
291-X	... Cap, in shell, covering bore of camshaft .....	1	3

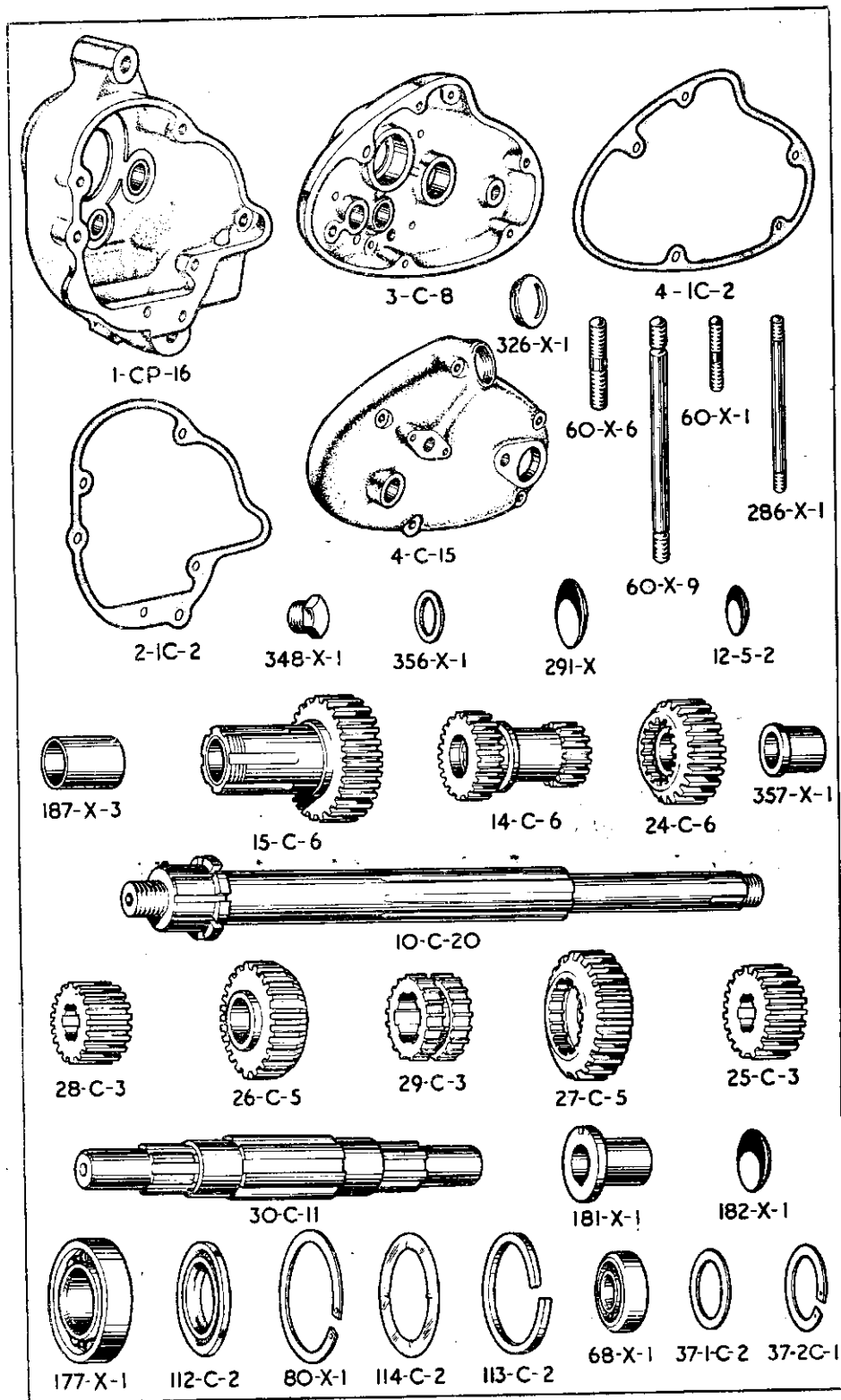

PART NUMBER	DESCRIPTION.	QTY.	PRICE EACH £ s. d.
<b>SHAFTS AND GEARS.</b>			
10-C-20	Mainshaft, gear box, 10½ in. overall length	1	18 3
15-C-6	Gear, driving, mainshaft, with bushes, 30 teeth	1	2 8 0
187-X-3	Bush, only, mainshaft driving gear	2	6 0
14-C-6	Gear, sliding, mainshaft, 18, 23 teeth	1	2 5 0
24-C-6	Gear, third, on mainshaft, 27 teeth, with bush	1	1 1 0
357-X-1	Bush, for mainshaft third gear	1	2 0
30-C-11	Layshaft, gear box, with bushes	1	13 0
28-C-3	Gear, small, on layshaft, 20 teeth	1	15 0
27-C-5	Gear, first, on layshaft, 32 teeth	1	18 9
26-C-5	Gear, second, on layshaft, 27 teeth	1	18 9
25-C-3	Gear, third, on layshaft, 23 teeth	1	15 0
29-C-3	Clutch, sliding on layshaft	1	15 0

### GEAR BOX BEARINGS.

177-X-1	Ball bearing, driving gear (10)	1	2 6
112-C-2	Oil seal, main driving gear bearing, rubber	1	3 0
80-X-1	Ring, split, retaining bearing in shell	1	6
114-C-2	Washer, outer, driving gear bearing (11)	2	4
113-C-2	Ring, split, retaining bearing outer washer	1	9
68-X-1	Ball bearing, mainshaft, K-S end (12)	1	18 9
37-1-C-2	Washer, mainshaft ball bearing K-S end (13)	1	9
37-2-C-1	Ring, split, retaining mainshaft ball bearing K-S end	1	6
181-X-1	Bush for layshaft	2	6 0
182-X-1	Cap, covering layshaft bush in gear box shell	1	3
87-X	Pin dowel, for layshaft bush	2	2

NOTE 10.—Dimensions  $1\frac{5}{8}$  in. by 62 mm. by 16 mm. (177-X-1).

NOTE 11.—Dimensions  $1\frac{1}{8}$  in. by  $2\frac{7}{8}$  in. (114-C-2).

NOTE 12.—Dimensions 12 mm. by 40 mm. by 17 mm. (68-X-1).

NOTE 13.—Dimensions  $1\frac{1}{4}$  in. by  $1\frac{7}{8}$  in. (37-1-C-2).

### GEAR OPERATING PARTS.

42-C-1	Fork operating mainshaft shding gear	1	12 0
43-C-1	Fork, operating layshaft sliding clutch	1	12 0
157-X-1	Peg, operating layshaft sliding clutch	2	9
158-X-1	Pin, split, operating fork peg	2	2
45-C-2	Camshaft, bare, for gear box	1	17 6
192-X-1	Rollers for camshaft.....per set of	12	3 0
159-X-1	Bush, for camshaft, in gear box shell	1	3 0
163-X-2	Pawl, engages in gear box camshaft	1	3 0
164-X-1	Pin, bearing, for camshaft pawl	1	1 10
95-X-1	Nut, for camshaft pawl bearing pin	1	4
193-X-1	Spring, for camshaft pawl	1	1 1
98-X-1	Plug, screwed, retaining camshaft pawl spring	1	1 6
162-X-3	Quadrant, gear selection	1	5 3
161-X-2	Sector, gear selection, engages camshaft	1	6 0
CO-51-6	Ratchet, gear selection	1	5 3
CO-51-6-A	Quadrant, sector and ratchet, assembled	1	16 9
CO-96-1	Rivet, fixing camshaft sector to quadrant	2	1
CO-96-2	Rivet, fixing camshaft ratchet to quadrant	1	1
CO-90-3	Spindle, for gear selection quadrant	1	5 3
287-X-1	Nut (inside), gear selection quadrant spindle	1	3
CO-91-1	Bush, in kick-starter case, for control spindle	1	1 6
160-X-2	Bush, in kick-starter case, for camshaft	1	3 0
CO-53-4	Quadrant, for foot gear control	1	4 6
CO-94-2	Sleeve, for foot gear control quadrant	1	11 3
CO-62-1	Peg, for gear indexing pawl	2	4
CO-53-4-A	Quadrant, assembled with sleeve and peg	1	16 1
CC-54-14	Bush, for foot control quadrant sleeve	1	7 6
CO-95-1	Bolt, fixing quadrant sleeve bush in K-S cover	1	1 10
CO-52-5	Pawl, indexing, for foot gear control	1	2 3

PART NUMBER	DESCRIPTION.	QTY.	PRICE EACH £ s. d.
-------------	--------------	------	-----------------------

### GEAR OPERATING PARTS—Continued.

CO-49-5	Box, spring, for foot gear control.....	1	7 6
CO-56-4	Plate, cover, for foot gear control spring box.....	1	1 6
CO-66-1	Spring, main, for control box (large spring) .....	2	9
CO-67-1	Spring, pawl, for control box (small spring) .....	2	9
CO-59-1	Plate, for control box main spring.....	2	3
CO-58-1	Plate, for control box pawl spring.....	2	3

### GEAR CONTROL PARTS.

CO-97-1	Indicator, gear, fixed.....	1	4
CO-97-2	Indicator, gear, moving.....	1	9
CO-105-1	Bolt, retaining moving gear indicator.....	1	3
CO-92-1	Lever, foot, gear control.....	1	11 3
CO-63-3	Bolt, clamping gear foot lever to sleeve.....	1	1 10
10-X-1	Nut, for gear foot lever clamping bolt.....	1	3
OS-52-1	Washer, foot lever clamping bolt.....	1	1
CO-82-2	Pad, rubber, foot control lever.....	1	1 1
CO-38-2	Pin fixing control lever rubber pad.....	1	1
27-7-2	Washer, felt, inserted in control spindle bush (14).....	1	4
27-8-3	Washer, felt, fits in recess in foot change lever (15).....	1	4

NOTE 14.— $\frac{17}{32}$  in. inside diameter.  
 $\frac{5}{8}$  in. outside diameter.  
 $\frac{1}{8}$  in. thick.

NOTE 15.— $\frac{13}{16}$  in. inside diameter.  
1 in. outside diameter.  
 $\frac{1}{8}$  in. thick.

### GEAR BOX SMALL SPROCKET.

179-X-7	Sprocket, gear box, 16 teeth.....	1	1 2 6
180-X-8	Collar, spacing, gear box sprocket, $\frac{7}{16}$ in. thick.....	1	1 6
176-X-1	Nut, fixing gear box sprocket to main gear.....	1	2 7
206-X-1	Collar, spacing, under gear box sprocket, $\frac{7}{16}$ in. thick.....	1	6
210-X-1	Washer, lock, gear box sprocket nut.....	1	9

### CLUTCH.

1-X-10	Case, for clutch (for five plates).....	1	18 0
OF-33-3	Rivet, for clutch case and chainwheel.....	8	2
7-X-A-5	Chainwheel and clutch case, assembled.....	1	2 9 0
7-X-28	Chainwheel, bare, 40 teeth.....	1	1 10 0
34-X-2	Race, roller, clutch sprocket bearing.....	1	3 0
35-X	Rollers, clutch sprocket bearing, per set.....	24	5 3
36-X-2	Washer, thin, clutch sprocket bearing.....	1	1 1
36-X-3	Washer, thick, clutch sprocket bearing.....	1	1 1
2-X-17	Centre for five plate clutch.....	1	1 10 0
69-X-2	Nut, retaining centre to mainshaft.....	1	1 6
349-X-3	Washer, lock, for centre retaining nut.....	1	9
71-X	Washer, plain, for centre retaining nut.....	1	4
6-X-5	Plate, clutch, plain, steel, thick.....	6	3 0
3-X-2	Plate, clutch, friction, with inserts.....	5	7 6
4-X-2	Inserts, fabric, for friction plate, per dozen.....	120	1 1
18-X-11	Plate, spring pressure, for clutch.....	1	13 6
303-X	Thrust cap, for spring plate.....	1	6
21-X-3	Spring, for clutch.....	5	9
22-X-2	Cup, for clutch spring.....	5	9
24-X-12	Stud, for clutch spring, five plate clutch.....	4	6
23-X-3	Nut, adjusting, for clutch spring.....	5	6

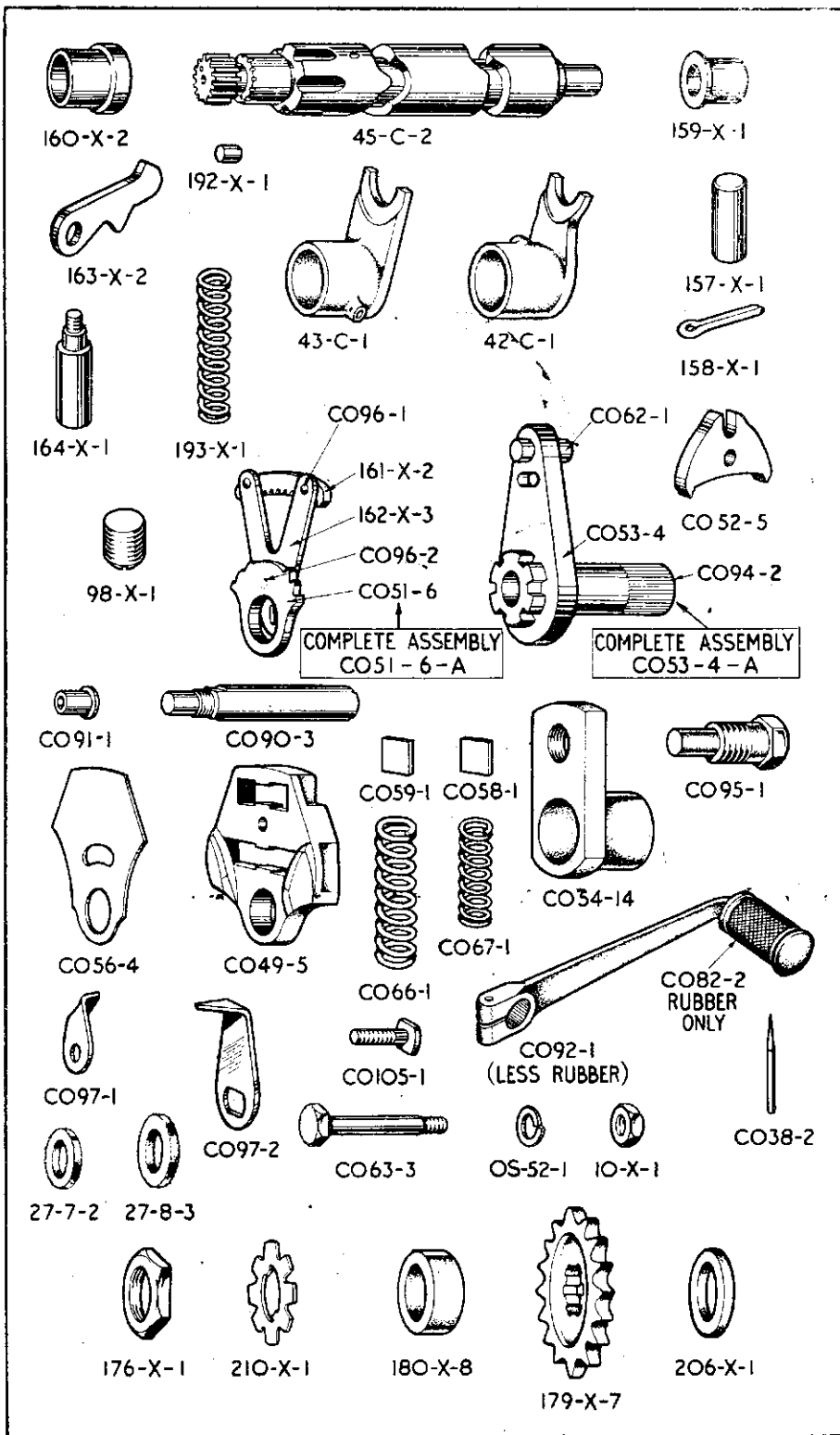

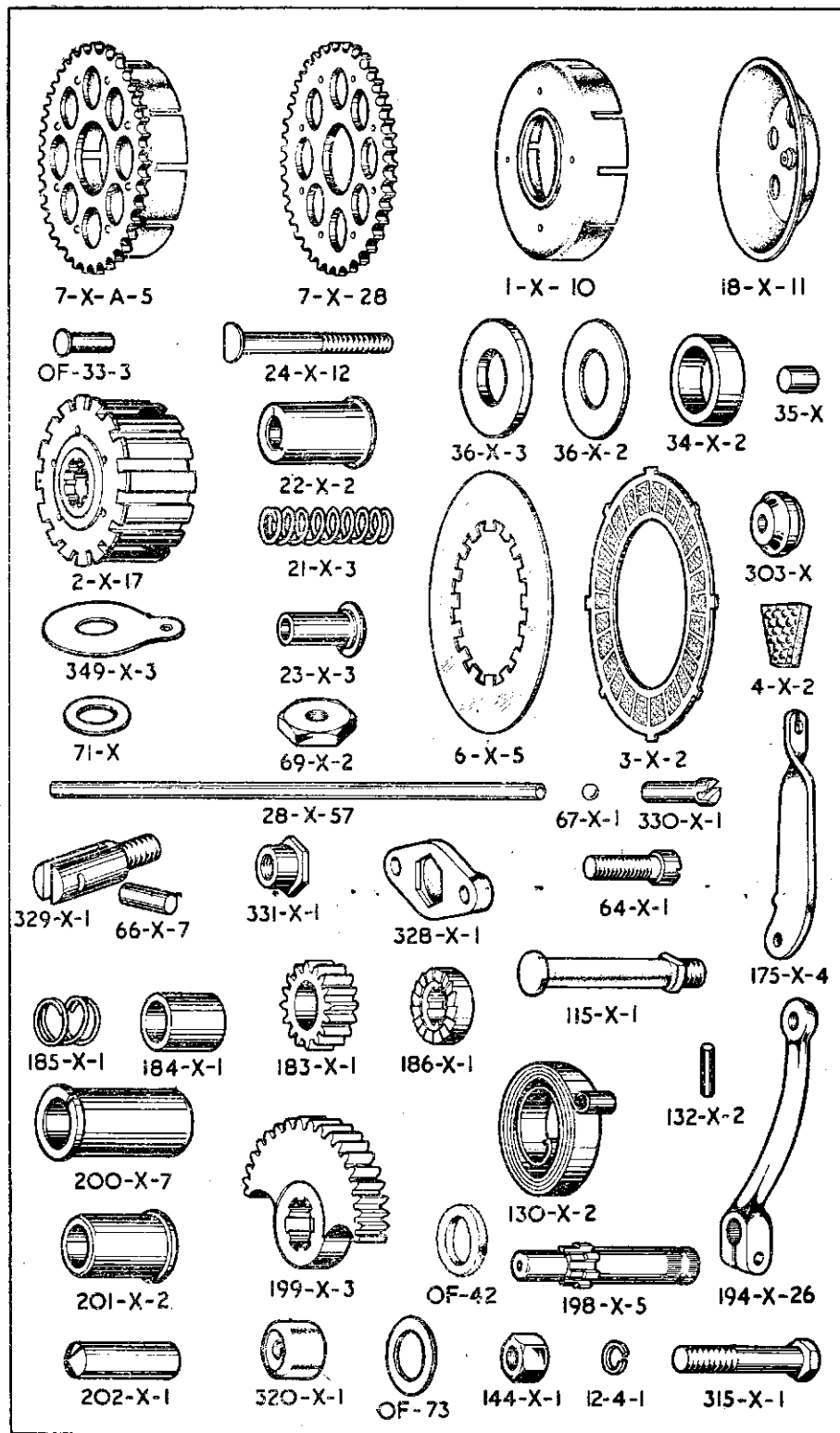



PART NUMBER	DESCRIPTION.	QTY.	PRICE EACH £ s. d.
-------------	--------------	------	-----------------------

### CLUTCH OPERATING PARTS.

28-X-57	Rod, thrust, for five plate clutch, 10 $\frac{1}{16}$ in.	1	6
330-X-1	Plunger, clutch operating	1	9
67-X-1	Ball, steel, for clutch operating plunger	1	2
175-X-4	Lever, clutch operating	3	0
66-X-7	Pin, for clutch operating lever	1	1
329-X-1	Fork, for clutch operating lever	2	3
331-X-1	Sleeve, for clutch operating lever fork	1	9
328-X-1	Cap, covering clutch operating lever fork sleeve	2	3
64-X-1	Screw, fixing sleeve cap to kick-starter case cover	2	4

### KICK-STARTER.

186-X-1	Ratchet, driving, kick-starter	1	8 7
183-X-1	Pinion, ratchet, kick-starter	12	0
184-X-1	Bush, kick-starter ratchet pinion	3	9
185-X-1	Spring, kick-starter ratchet pinion	1	1
70-X-1	Nut, retaining driving ratchet to mainshaft	1	6
198-X-5	Spindle, for kick-starter quadrant and foot lever	11	3
201-X-2	Bush, in K-S case, for K-S quadrant spindle	3	0
200-X-7	Bush, in K-S case cover, for K-S quadrant spindle	3	0
199-X-3	Quadrant, for kick-starter spindle	15	9
199-X-3-A-49	Kick-starter quadrant and spindle, assembled	1	7 0
130-X-2	Spring, return, for kick-starter foot lever	3	0
132-X-2	Pin, anchor, for kick-starter return spring	4	4
320-X-1	Stop, rubber, and sleeve, for K-S quadrant	1	9
202-X-1	Peg, for K-S stop rubber and sleeve	1	9
194-X-26	Lever, foot, kick-starter, bare	15	9
115-X-1	Pin, pedal, for kick-starter foot lever	4	9
315-X-1	Bolt, clamping K-S foot lever to spindle	1	1
144-X-1	Nut, for K-S foot lever clamping bolt	1	9
12-4-1	Washer, spring, on K-S lever bolt	1	1
OF-42	Washer, felt, on K-S spindle	1	4
OF-73	Washer, plain, retains felt washer on K-S spindle	1	4

### FRONT FRAME.

013772	Frame, front portion only, bare	1	5 7 3
STD-806	Race, ball, for frame head lug	2	3 10
STD-72	Balls, $\frac{3}{16}$ in. diameter, for steering head, per set of	56	1 7
STD-51	Nipple, grease, for frame head lug	1	3
014478	Stud, for seat lug (below saddle), 4 $\frac{7}{8}$ in. by $\frac{1}{2}$ in. by 26	1	11
STD-8	Washer, plain, for seat lug stud	2	1
STD-1	Nut, for seat lug stud	2	4
STD-15	Screw, securing earth wires (screws into end of stud 014478)	1	1
STD-185	Washer, plain, for STD-15 earth wire screw	1	1

### REAR FRAME.

014359	Rail, frame, right side	1	2 0 0
014360	Rail, frame, left side	1	2 3 4
014420	Loop, rear frame	4	1 0
014512	Stud, for rear loop at bottom, 12 in. by $\frac{1}{8}$ in. by 26 (Also passes through rear fork bridge and both frame rails)	1	4 4
STD-2	Nut, for rear loop bottom stud	2	4 4
STD-9	Washer, plain, for rear loop bottom stud	2	1
014879	Tube, supporting rear of rear mudguard, right side	1	11 3
014880	Tube, supporting rear of rear mudguard, left side	1	11 3
STD-343	Bolt, fixing mudguard support tube to frame loop, $\frac{1}{2}$ in. by $\frac{1}{4}$ in. by 26	4	3
STD-12	Washer, plain, for mudguard support tube bolt	4	1
STD-191	Washer, spring, for mudguard support tube bolt	4	1
STD-5	Nut, for mudguard support tube bolt	4	3
015329	Bridge, for rear fork (includes bushes and studs for centre stand spring clip)	1	2 3 8
014672	Bush, for rear fork bridge	2	7
STD-250	Stud, for rear fork bridge $\frac{3}{8}$ in. by 2 B.A.	2	3

PART NUMBER.	DESCRIPTION.	QTY.	PRICE EACH		
			£	s.	d.
<b>REAR FORK.</b>					
014307	Fork, rear	1	4	1	7
011372	Pin, chain adjusting, for right fork end	1			7
011373	Nut, lock, for chain adjusting pin	1			2
014746	Sleeve, assembly (bushed)	2		5	6
010116	Tube	1		5	0
010095	Cap, for rear fork bearing, right side	1		1	0
010096	Cap, for rear fork bearing, left side	1			6
010093	Washer, felt, for rear fork bearing	2			10
010098	Gasket, for rear fork bearing caps	2			1
010094	Spoke, for rear fork bearing (central tie bolt)	1			4
012472	Nipple, for rear fork bearing spoke	1			2
015189	Screw, plug, for oil, in end cap	1			5
STD-203	Washer, fibre, for oil plug screw	1			1

### TELEDRAULIC REAR LEG.

014477	Leg, TELEDRAULIC, rear, complete assembly (This assembly includes all the remaining items, except the final six, listed in this group)	2	5	1	5
015408	Pivot, top assembled (This assembly includes the next five items)	2		17	3
013872	Pivot, top, bare	2		15	0
012341	Bush, rubber, for top pivot	4			6
014912	Spacer, for top pivot rubber bush, $\frac{1}{2}$ in. long	4			3
013332	Plug, filling, for top pivot	2			8
012116	Washer, fibre, for top pivot filling plug	2			1
015409	Pivot, bottom, assembled (This assembly includes the next three items)	2		14	0
014821	Pivot, bottom, bare	2		12	6
012341	Bush, rubber, for bottom pivot	4			6
014912	Spacer, for bottom pivot rubber bush, $\frac{1}{2}$ in. long	4			3
011945	Spring, suspension, for rear leg	2		12	6
014358	Spacer, under rear leg spring	2			10
012119	Tube, cover, top, for rear leg spring	2		4	0
012120	Tube, cover, bottom, for rear leg spring	2		4	4
014609	Tube, top, for rear leg damper	2		15	3
014297	Washer, composition, for rear leg damper tube	2			2
014820	Piston, for rear leg damper	2		6	10
015306	Washer, "Fan Disc," for underside of damper piston	2			1
014669	Shuttle, for rear leg damper	2			10
015701	Bush, plastic, upper, for rear leg damper tube	2		1	6
015702	Bush, plastic, lower, for rear leg damper tube	2		1	6
015703	Ring, sealing, between damper tube plastic bushes	2			7
014313	Pin, locating damper tube shuttle	2			3
012132	Oil-seal, for rear leg damper tube	2		4	3
012131	Cap, screwed, securing rear leg damper oil-seal	2		1	1
012123	Tube, bottom, for rear leg damper	2		12	0
012124	Ring, carrier, located on bottom tube by 012125 dowel pin	2		4	0
012125	Pin, dowel, locating ring 012124	2			1
012126	Washer, fibre, under rear leg bottom damper tube	2			1
014521	Bolt, fixing top pivot, $3\frac{1}{4}$ in. by $\frac{3}{8}$ in. by 26	2		2	7
STD-10	Washer, plain, for top pivot bolt	4			1
STD-3	Nut, for top pivot bolt	2			3
STD-407	Bolt, fixing bottom pivot, $1\frac{1}{4}$ in. by $\frac{3}{8}$ in. by 26	2			7
STD-10	Washer, plain, for bottom pivot bolt	4			1
STD-73	Nut, for bottom pivot bolt	2			3

### FRONT FORKS. (Assemblies).

015865	Fork, assembly (TELEDRAULIC Front Fork)	1	16	19	5
--------	---	---	----	----	---

A "front fork assembly" comprises all the parts listed in the "FRONT FORK" group.  
For ease of servicing, the inner tube unit is listed, and supplied, as a separate assembly. This enables a complete assembly to be exchanged in minimum time. The unit is listed below.

015867	Front fork inner tube assembly	2	3	3	5
--------	--------------------------------	---	---	---	---

The above assembly comprises all those parts in the "FRONT FORK" group that are marked "A."

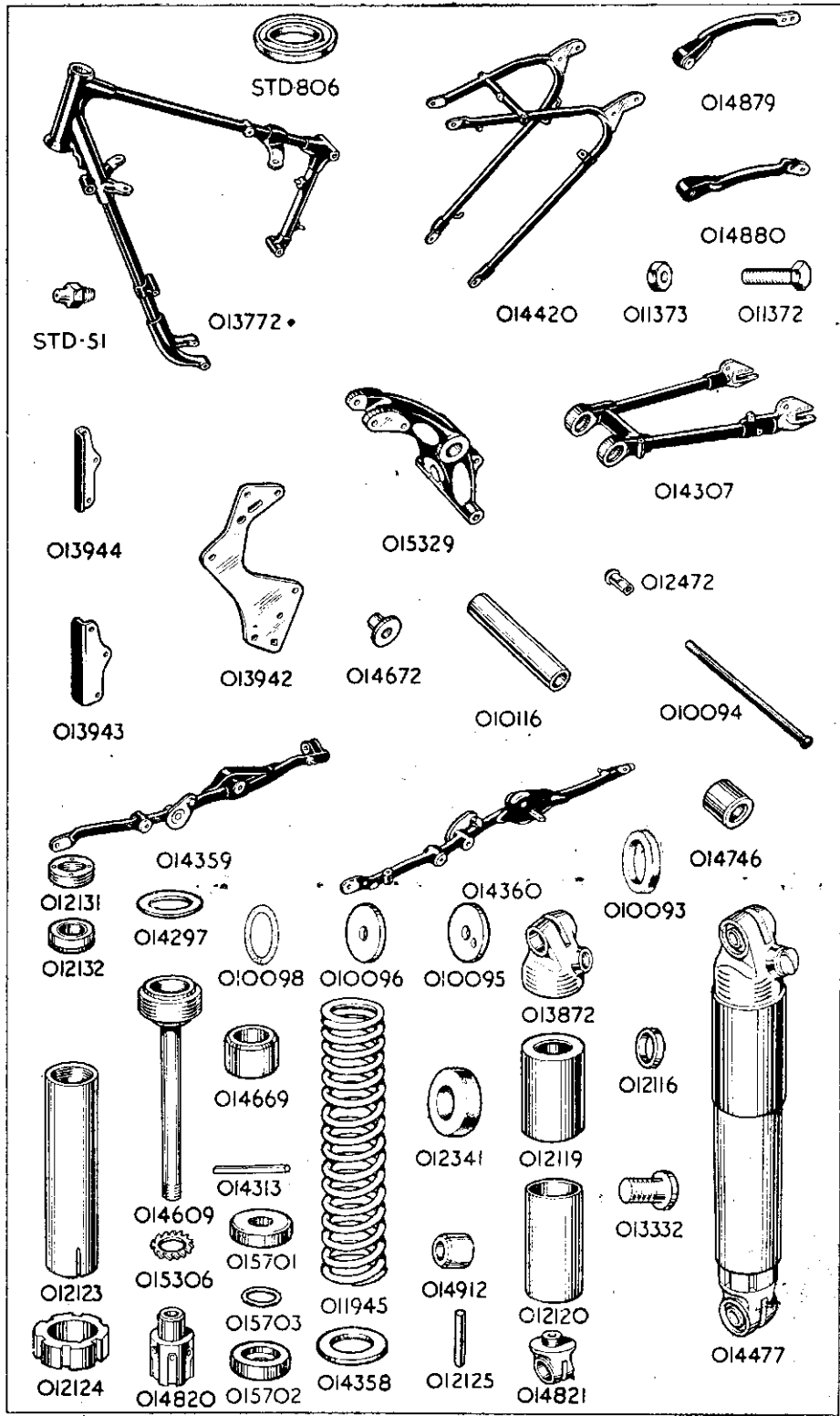

PART NUMBER.	DESCRIPTION.	QTY.	PRICE EACH £ s. d.
<b>FRONT FORK.</b>			
013861 ... ..	Crown, assembly, comprising crown, stem, circlip and two 014816 studs. (Components not sold as separate spares).....	1 ...	2 0 8
STD-805 ... ..	Race, ball, for fork crown.....	1 ...	5 2
014816 ... ..	Stud, pinch, for fork crown, $2\frac{3}{32}$ in. by $\frac{5}{16}$ in. by 26.....	2 ...	9
STD-11 ... ..	Washer, plain, for fork crown pinch stud.....	2 ...	1
011635 ... ..	Nut, for fork crown pinch stud.....	2 ...	7 0
013631 ... ..	Lug, for handlebar and steering head.....	1 ...	2 4 0
012620 ... ..	Race, ball, for handlebar lug.....	1 ...	3 10
STD-51 ... ..	Nipple, grease, for handlebar lug.....	1 ...	3
STD-236 ... ..	Nut, adjusting, for fork crown stem.....	1 ...	1 1
L4-FF46 ... ..	Nut, lock (domed), for fork crown stem.....	1 ...	2 5
013348 ... ..	Tube, fork, inner.....	A 2 ...	1 11 7
38-G4-E368 ... ..	Buffer, rubber, for fork inner tube.....	A 6 ...	6
40-G12M-FF191 ... ..	Bush, bottom, for fork inner tube.....	A 2 ...	4 1
40-G12M-FF192 ... ..	Circlip, for fork inner tube bush.....	A 2 ...	1
014354 ... ..	Bolt, top, for fork inner tube.....	A 2 ...	1 6
014355 ... ..	Ring, sealing, for fork inner tube top bolt.....	A 2 ...	3
40-G12M-FF190 ... ..	Washer, plain, for fork inner tube top bolt.....	A 2 ...	4
013632 ... ..	Slider, fork, with cap, studs and nuts, left and right.....	2 ...	1 18 0
013509 ... ..	Cap, for fork slider.....	2 ...	4 1
014341 ... ..	Extension, for fork slider.....	A 2 ...	7 5
40-G12M-FF41 ... ..	Bush, plastic, for fork inner tube.....	A 2 ...	2 2
40-G12M-FF91 ... ..	Oil-seal, for fork inner tube.....	A 2 ...	5 3
015002 ... ..	Spring, main, for front fork.....	A 2 ...	6 6
011126 ... ..	Spring, buffer, for front fork.....	A 2 ...	10
40-G12M-FF126 ... ..	Washer, leather, fork spring seating.....	A 4 ...	3
013695 ... ..	Tube, fork cover, top, left, with lamp lug.....	1 ...	8 6
013694 ... ..	Tube, fork cover, top, right, with lamp lug.....	1 ...	8 6
40-G12M-FF186 ... ..	Cap, for top of fork top cover tube.....	2 ...	1 2
012569 ... ..	Cap, for bottom of fork top cover tube.....	2 ...	9
40-G12M-FF128 ... ..	Plate, threaded, locating top cover tube.....	2 ...	6
41-G3L-FF184-B ... ..	Tube, fork cover, bottom.....	2 ...	3 3
40-G12M-FF127 ... ..	Plate, plain, locating bottom cover tube.....	2 ...	3
40-G12M-FF129 ... ..	Screw, retaining both locating plates, $1\frac{3}{8}$ in. by 3 B.A.....	6 ...	3
STD-485 ... ..	Screw, plug, oil drain, for fork slider, $\frac{1}{2}$ in. by $\frac{1}{2}$ in. by 26.....	2 ...	1
STD-203 ... ..	Washer, fibre, for fork slider screw oil plug.....	2 ...	1
013347 ... ..	Shuttle, for fork damper.....	A 2 ...	1 5
012954 ... ..	Cone, for fork damper.....	2 ...	10
40-G12M-FF94 ... ..	Bolt, fixing fork damper cone to slider.....	2 ...	7
40-G12M-FF80 ... ..	Washer, fibre, for damper cone bolt.....	2 ...	1
40-G12M-FF195 ... ..	Stud, securing fork slider cap, $1\frac{3}{8}$ in. by $\frac{5}{16}$ in. by 26 and 22 ...	4 ...	4
STD-11 ... ..	Washer, plain, for fork slider cap stud.....	4 ...	1
STD-4 ... ..	Nut, for fork slider cap stud.....	4 ...	3

## STEERING DAMPER

(This is an optional extra).

013458 ... ..	Damper, steering, complete set of parts.....	1 ...	15 0
12361 ... ..	Knob, control, for steering damper.....	1 ...	3 6
STD-162 ... ..	Washer, ratchet, for steering damper knob.....	1 ...	3
STD-195 ... ..	Washer, spring, for steering damper knob.....	1 ...	4
010808 ... ..	Cap, for top of steering stem.....	1 ...	6
010807 ... ..	Drawbolt for steering damper.....	1 ...	1 2
015137 ... ..	Sleeve, assembly, lower end of drawbolt.....	1 ...	5 4
STD-73 ... ..	Nut, locking sleeve to drawbolt.....	1 ...	3
STD-344 ... ..	Bolt, fixing sleeve assembly, $\frac{3}{8}$ in. by $\frac{1}{2}$ in. by 26.....	1 ...	3
015131 ... ..	Spacer, $\frac{1}{2}$ in. long, for bolt STD-344.....	1 ...	2
STD-191 ... ..	Washer, spring, for bolt STD-344.....	1 ...	1
STD-12 ... ..	Washer, plain, for bolt STD-344.....	1 ...	1
STD-5 ... ..	Nut, for bolt STD-344.....	1 ...	3
40-G12M-FF97 ... ..	Plate, anchor, top position.....	1 ...	9
STD-70 ... ..	Bolt, fixing top anchor plate, $\frac{9}{16}$ in. by $\frac{1}{2}$ in. by 26.....	1 ...	3
STD-191 ... ..	Washer, spring, for top anchor plate bolt.....	1 ...	1
STD-812 ... ..	Washer, fibre, friction, for steering damper.....	2 ...	4
STD-236 ... ..	Nut, lock, for fork crown stem. (This replaces the domed lock nut, L4-FF46, when a steering damper is fitted).....	1 ...	1 1

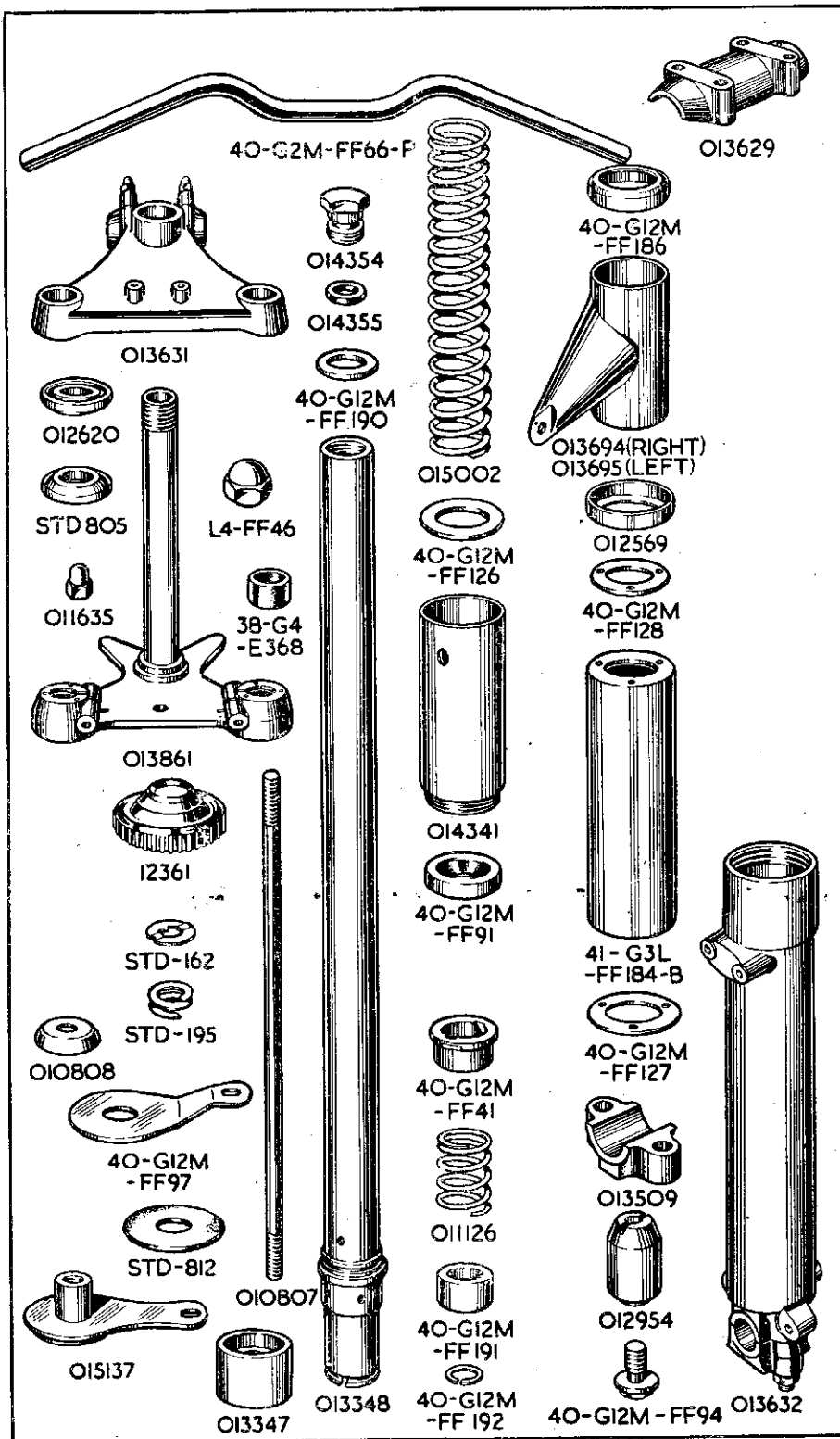

PART NUMBER.	DESCRIPTION.	QTY.	PRICE EACH £ s. d.
--------------	--------------	------	-----------------------

### HANDLEBAR.

40-G2M-FF66-P	Handlebar, bare.....	1	6 3
013629	Clip (half only), for handlebar lug.....	1	6 6
012870	Stud, for handlebar clip, $1\frac{1}{2}$ in. by $\frac{1}{4}$ in. by 26 and 20.....	4	4
STD-12	Washer, plain, for handlebar clip stud.....	4	1
014278	Nut, for handlebar clip stud.....	4	6

### FRONT STAND.

011286	Stand, front, bare.....	1	8 3
41-G3L-FF422	Bolt, fixing front stand to slider, $1\frac{3}{8}$ in. by $\frac{5}{16}$ in. by 22.....	2	10
HBD-52	Washer, spring, for stand to slider bolt.....	2	3
STD-14	Pin, split, for stand to slider bolt.....	2	1
STD-342	Bolt, fixing front stand to front mudguard, $\frac{11}{16}$ in. by $\frac{1}{2}$ in. by 26.....	1	3
STD-12	Washer, plain, for stand to mudguard bolt.....	2	1
STD-5	Nut, front stand to mudguard bolt.....	1	3
014278	Nut, (domed), front stand to mudguard bolt.....	1	6

### PROP STAND.

014719	Stand, prop, bare.....	1	0 3
014713	Bolt, hinge, for prop stand.....	1	7
STD-49	Pin, split, for prop stand hinge bolt.....	1	1
014139	Nut, for prop stand hinge bolt.....	1	4
014991	Spring, return, for prop stand.....	1	0

### CENTRE STAND.

014450	Stand, centre, bare.....	1	16 8
014626	Bush, for centre stand.....	2	8
014629	Stud, hinge, for centre stand, $8\frac{1}{8}$ in. by $\frac{7}{16}$ in. by 26.....	1	2 4
014630	Spacer, central, 4.2 in. long, for centre stand hinge stud.....	1	11
013837	Spacer, outer, right side, .993 in. long for centre stand hinge stud.....	1	10
010911	Spacer, outer, left side, .8 in. long for centre stand hinge stud.....	1	6
010912	Washer, spigot, for centre stand hinge stud.....	2	2
STD-2	Nut, for centre stand hinge stud.....	2	4
014627	Spring, return, for centre stand.....	1	2 6
014628	Spring, stop, for centre stand.....	1	0
STD-80	Nut, for centre stand stop spring (The studs on which these nuts fit, are listed with the Rear Fork bridge).....	2	1
STD-39	Washer, plain, for centre stand stop spring fixing nuts.....	2	1

### FRONT MUDGUARD.

014957	Mudguard, front, bare.....	1	0 7
41-G3L-M38	Bolt, fixing mudguard bridge to right fork slider, $\frac{1}{2}$ in. by $\frac{5}{16}$ in. by 22.....	2	4
STD-192	Washer, spring, for bridge right fixing bolt.....	2	1
015000	Stud, fixing mudguard bridge to left fork slider, also retains brake anchor stay and bracket for brake cable adjuster, 1 in. by $\frac{5}{16}$ in. by 26 and 22.....	2	4
014117	Washer, plain, for bridge left fixing stud.....	2	1
STD-4	Nut, for bridge left fixing stud.....	2	3
015015	Stay, for front mudguard.....	1	4 3
41-G3L-M38	Bolt, fixing front mudguard stay to fork slider, $\frac{1}{2}$ in. by $\frac{5}{16}$ in. by 22.....	2	4
STD-192	Washer, spring, for stay to fork slider bolt.....	2	1
STD-70	Bolt, fixing stay to front mudguard, $\frac{9}{16}$ in. by $\frac{1}{4}$ in. by 26.....	2	3
STD-191	Washer, spring, for stay to front mudguard bolt.....	2	1
STD-12	Washer, plain, for stay to front mudguard bolt.....	2	1
STD-5	Nut, for stay to front mudguard bolt.....	2	3

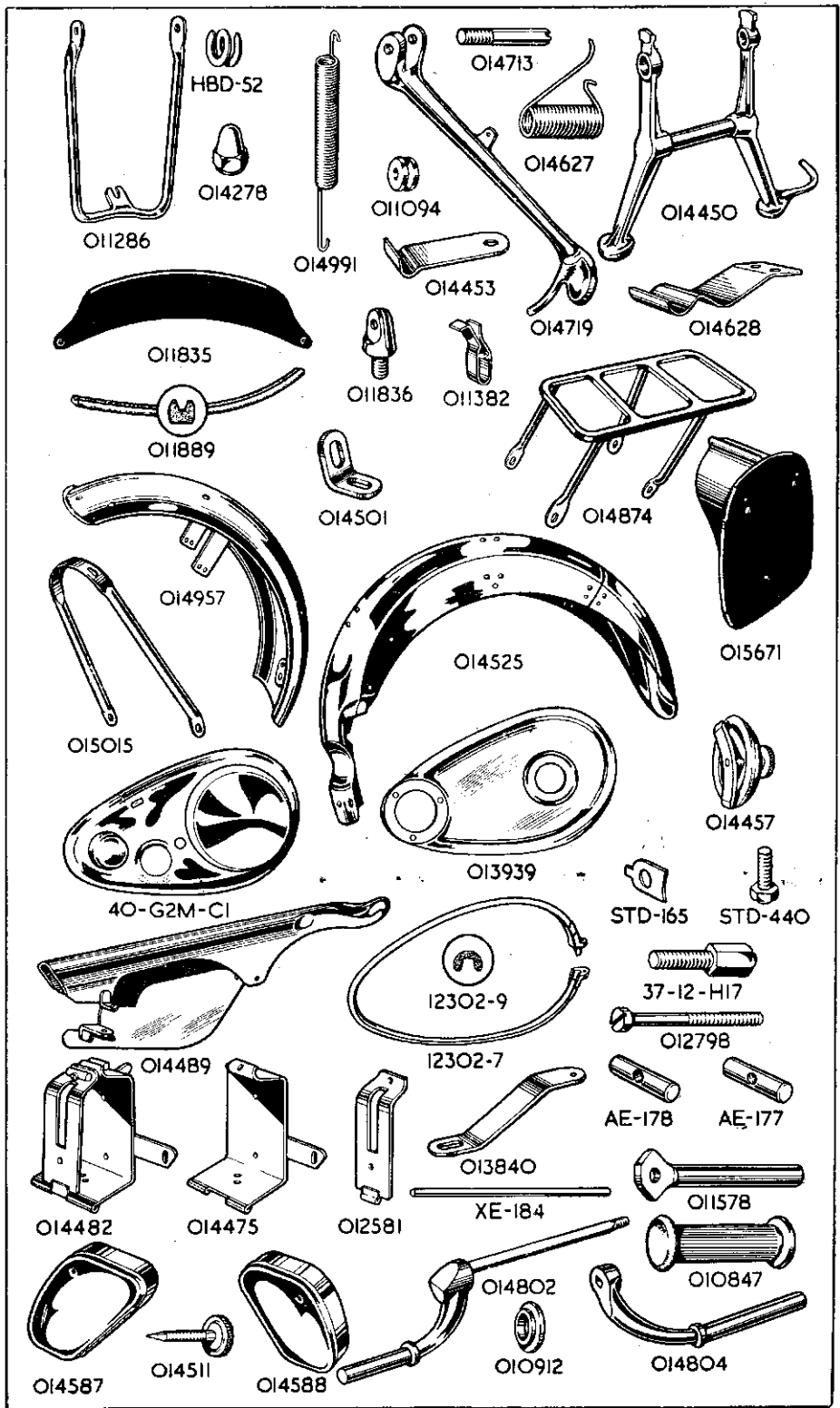

PART NUMBER	DESCRIPTION.	QTY.	PRICE EACH £ s. d.
<b>REAR MUDGUARD.</b>			
014525	Mudguard, rear, bare. (Although this is in two parts, the parts are not sold as separate spares).....	1	3 19 2
014501	Bracket, for bottom of rear mudguard.....	2	4
STD-342	Bolt, fixing bracket to rear mudguard, $\frac{1}{16}$ in. by $\frac{1}{4}$ in. by 26.....	2	3
STD-12	Washer, plain, for bracket fixing bolt.....	4	1
STD-5	Nut, for bracket fixing bolt.....	2	3
STD-271	Stud, fixing rear mudguard brackets to frame, $1\frac{3}{32}$ in. by $\frac{5}{16}$ in. by 26 and 22.....	1	4
STD-11	Washer, plain, for bracket fixing stud.....	2	1
STD-4	Nut, for bracket fixing stud.....	2	3
STD-346	Bolt, fixing rear mudguard to frame loop bridge, $1\frac{7}{16}$ in. by $\frac{1}{4}$ in. by 26.....	1	4
STD-191	Washer, spring, for bridge fixing bolt.....	1	1
STD-5	Nut, for bridge fixing bolt.....	1	3
STD-366	Bolt, fixing rear mudguard to oil tank, $1\frac{1}{2}$ in. by $\frac{5}{16}$ in. by 26.....	1	6
014515	Spacer, $\frac{3}{8}$ in. long, for mudguard to oil tank bolt.....	1	3
STD-192	Washer, spring, for mudguard to oil tank bolt.....	1	1
STD-174	Washer, plain, for mudguard to oil tank bolt.....	1	1
STD-4	Nut, for mudguard to oil tank bolt.....	1	3

#### REAR CARRIER

(This is an optional extra).

014874	Carrier, rear, bare.....	1	1 3 0
STD-342	Bolt, fixing carrier in front, $\frac{1}{4}$ in. by $\frac{1}{4}$ in. by 26.....	2	3
STD-12	Washer, plain, for carrier front fixing bolts.....	2	1
STD-191	Washer, spring, for carrier front fixing bolts.....	2	1
STD-5	Nut, for carrier front fixing bolts.....	2	3
STD-344	Bolt, fixing carrier at rear, $\frac{3}{16}$ in. by $\frac{1}{4}$ in. by 26. (These bolts displace two STD-343 bolts in the rear mudguard support tubes, the washers, nuts, etc., of which are transferred).....	2	4

#### FRONT NUMBER PLATE.

011835	Plate, number, front.....	1	2 10
011836	Stud, retaining front number plate.....	2	1 0
STD-12	Washer, plain, for number plate stud.....	2	1
STD-5	Nut, for number plate stud.....	2	3
011889	Fillet, rubber, for front number plate.....	1	5
STD-861	Screw, $\frac{5}{16}$ in. by 2 B.A. fixing number plate to stud.....	2	1

#### REAR NUMBER PLATE.

015671	Plate, number, rear.....	1	11 6
STD-363	Bolt, fixing rear number plate, $\frac{3}{4}$ in. by $\frac{5}{16}$ in. by 26.....	2	4
STD-192	Washer, spring, for rear number plate bolt.....	2	1

#### FRONT CHAINCASE.

015722	Chaincase, front, complete. (Includes the next seven items)...	1	2 5 4
013939	Chaincase, back half only, bare.....	1	7 6
40-G2M-C1	Chaincase, front half only, bare.....	1	1 6 4
12302-7	Band, metal, for front chaincase.....	1	8 3
STD-453	Screw, clamping chaincase metal band, 1 in. by 2 B.A.....	1	3
12302-9	Band, rubber, for front chaincase.....	1	10
014457	Cap, assembled, inspection, for front chaincase. (Includes cap, cork washer, central screw and back plate, parts not sold as separate spares).....	1	2 2
STD-580	Washer, cork, for chaincase inspection cap.....	1	3
STD-440	Bolt, fixing front chaincase to engine, $\frac{1}{2}$ in. by 0. B.A.....	3	3
STD-165	Washer, lock, for front chaincase to engine bolt.....	3	1

For the bolt, with washers, spacers and nuts fixing the centre of front chaincase, see "Crankcase bolts and engine plates."



PART NUMBER.	DESCRIPTION.	QTY.	PRICE EACH £ s. d.
<b>REAR CHAINGUARD.</b>			
014489 ...	Chainguard, rear, bare.....	1 ...	17 3
STD-350 ...	Bolt, fixing chainguard at front, $2\frac{1}{8}$ in. by $\frac{1}{4}$ in. by 26.....	1 ...	4
STD-12 ...	Washer, plain, for chainguard front fixing bolt.....	2 ...	1
STD-5 ...	Nut, for chainguard front fixing bolt.....	1 ...	3
014559 ...	Bolt, fixing chainguard at rear, $2\frac{7}{8}$ in. by $\frac{5}{16}$ in. by 26.....	1 ...	7
014560 ...	Spacer, $1\frac{3}{8}$ in. long (located inside chainguard) on chainguard bolt 014559.....	1 ...	5
014561 ...	Spacer, $\frac{3}{8}$ in. long (located between chainguard and frame) on chainguard bolt 014559.....	1 ...	4
STD-11 ...	Washer, plain, for chainguard rear fixing bolt.....	1 ...	1
STD-192 ...	Washer, spring, for chainguard rear fixing bolt.....	1 ...	1
STD-4 ...	Nut, for chainguard rear fixing bolt.....	1 ...	3
<b>BATTERY CARRIER.</b>			
014482 ...	Carrier, battery, complete. (Includes the next six items).....	1 ...	19 5
014475 ...	Carrier, battery, back portion only.....	1 ...	10 3
012581 ...	Carrier, battery, front portion only.....	1 ...	7 6
XE-184 ...	Pin, hinge, for battery carrier front.....	1 ...	3
012798 ...	Bolt, clamping battery in carrier, $1\frac{3}{8}$ in. by $\frac{1}{2}$ in. by 26.....	1 ...	6
AE-178 ...	Seat, for battery clamping bolt.....	1 ...	4
AE-177 ...	Nut, for battery clamping bolt.....	1 ...	7
013840 ...	Bracket, for battery carrier.....	1 ...	10
37-12-H17 ...	Bolt, fixing battery carrier bracket to chaincase, $2\frac{5}{8}$ in. by $\frac{5}{16}$ in. by 26.....	1 ...	4
STD-11 ...	Washer, plain, for battery carrier bracket to chaincase bolt.....	1 ...	1
STD-4 ...	Nut, for battery carrier bracket to chaincase bolt.....	1 ...	3
STD-40 ...	Screw, fixing battery carrier bracket to carrier, $\frac{1}{2}$ in. by I B.A.....	1 ...	1
STD-12 ...	Washer, plain, for STD-40 bracket screw.....	1 ...	1
STD-4 ...	Nut, fixing battery carrier to main frame (also secures oil tank)	2 ...	3
STD-174 ...	Washer, plain, for battery carrier fixing nuts.....	2 ...	1
<b>TOOL BOXES.</b>			
014425 ...	Box, tool, bare, left side. (Does not include any of the following items).....	1 ...	1 1 6
014433 ...	Box, tool, bare, right side (Does not include any of the following items).....	1 ...	17 3
014511 ...	Screw, knurled, for tool box lid.....	2 ...	11
STD-189 ...	Washer, spring, for tool box lid screw.....	2 ...	1
STD-5 ...	Nut, for tool box lid screw.....	4 ...	3
STD-342 ...	Bolt, long, fixing right tool box in top and bottom back locations, $\frac{1}{8}$ in. by $\frac{1}{4}$ in. by 26.....	2 ...	3
STD-342 ...	Bolt, long, fixing left tool box in top back location, $\frac{1}{16}$ in. by $\frac{1}{2}$ in. by 26.....	1 ...	3
014577 ...	Bolt, short, fixing both tool boxes at the sides, $\frac{7}{16}$ in. by $\frac{1}{4}$ in. by 26	2 ...	2
014577 ...	Bolt, short, fixing left tool box at bottom back location, $\frac{7}{16}$ in. by $\frac{1}{4}$ in. by 26.....	1 ...	2
STD-639 ...	Spacer, $\frac{1}{4}$ in. long, on 014577 tool box fixing bolts.....	3 ...	3
STD-12 ...	Washer, plain, for tool box fixing bolts.....	12 ...	1
STD-5 ...	Nut, for tool box fixing bolts.....	6 ...	3
<b>FOOTRESTS.</b>			
014802 ...	Arm, left side, for footrest (integral with rod).....	1 ...	12 0
014804 ...	Arm, right side, for footrest.....	1 ...	7 6
010847 ...	Pad, rubber, for footrest arm. (Same as 16315).....	2 ...	2 5
010924 ...	Spacer, $3\frac{1}{2}$ in. long, for footrest rod, between rear engine plates. (Same as CFR-6).....	1 ...	1 1
010912 ...	Washer, spigot, for footrest rod.....	1 ...	2
STD-2 ...	Nut, for footrest rod.....	1 ...	4

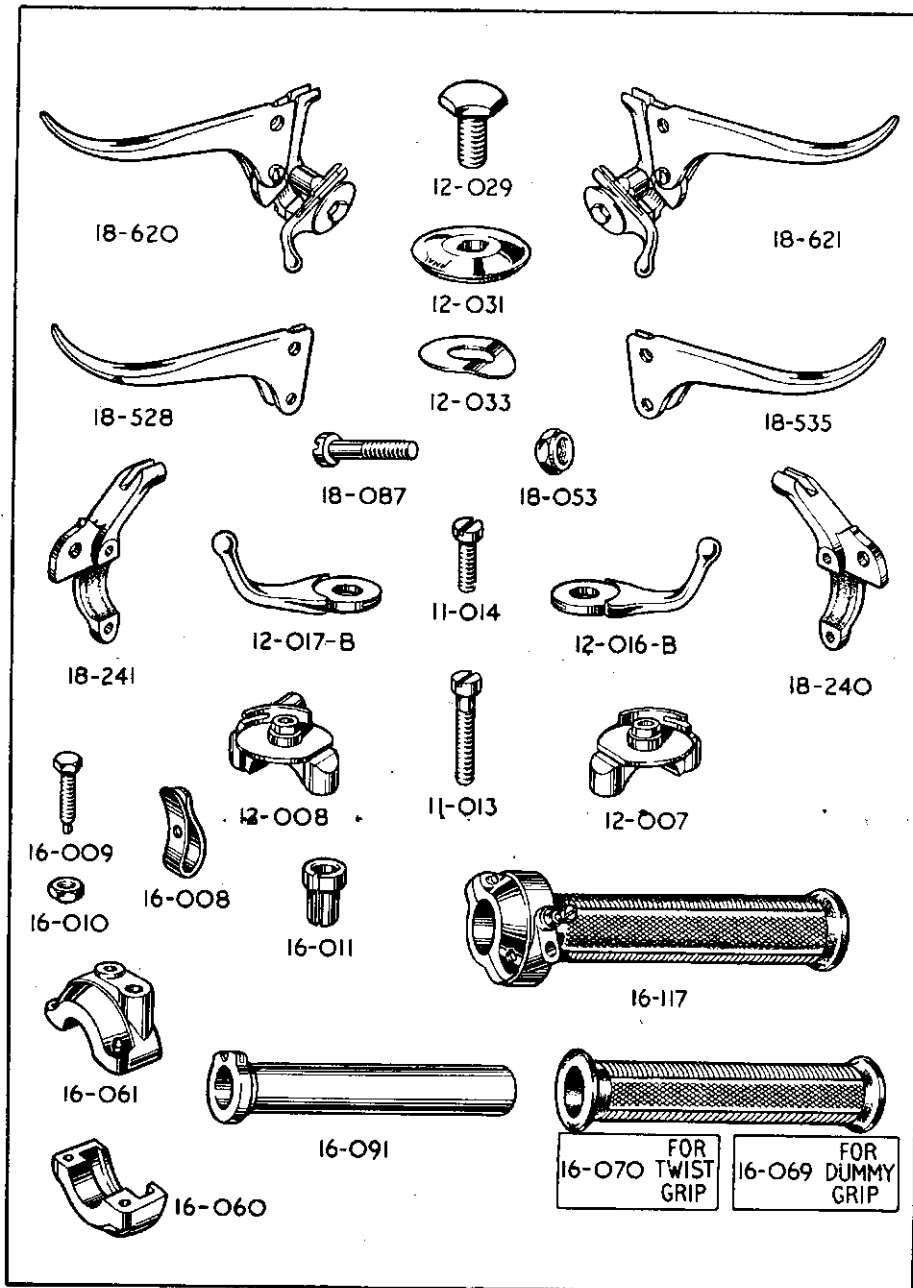

PART NUMBER	DESCRIPTION.	QTY.	PRICE EACH £ s. d.
-------------	--------------	------	-----------------------

### PILLION FOOTRESTS.

011267	... Pair of pillion footrests, complete. (Includes all the following items)	1	12 3
011518	... Spindle, bare, for pillion footrest	2	3 3
011599	... Bolt, hinge, for pillion footrest spindle, 1 $\frac{3}{8}$ in. by $\frac{3}{8}$ in. by 26	2	6
STD-73	... Nut, for pillion footrest hinge bolt	2	3
010847	... Pad, rubber, for pillion footrest spindle. (Same as 16315)	2	2 5

### SADDLE.

014429	... Saddle, complete, with rear springs	1	3 0 11
013873	... Saddle, complete, less rear springs	1	2 11 5
38-G3-F60-T	... Cover (or top), for saddle	1	19 9
014414	... Spring, rear, for saddle	2	4 9
STD-410	... Bolt, for saddle front hinge, 2 $\frac{1}{4}$ in. by $\frac{3}{8}$ in. by 26	1	7
STD-3	... Nut, for saddle front hinge bolt	1	3
012880	... Stud, supports lower end of saddle spring, 2 $\frac{1}{4}$ in. by $\frac{3}{8}$ in. by 26 the full length	2	5
STD-73	... Nut, for saddle spring stud	6	3

### TRANSFERS.

STD-9184	... Transfer, for top of oil tank (service instruction). Same as 38-G3-F391	1	3
STD-9183	... Transfer, for side of oil tank (oil level indicator). Same as 38-G3-F392	1	3
STD-9186	... Transfer, for front chaincase (oil level indicator). Same as 38-G3-F393	1	3
STD-9187	... Transfer, for front chaincase. ("PATENT")	1	1
010969	... Transfer, for rear mudguard. ("A.J.S.") Same as 38-12F383	1	6
STD-9185	... Transfer, for tool boxes (Monogram)	2	4
STD-9192	... Transfer, for front forks. ("PATENT")	1	6
012973	... Transfer, for petrol tank. ("RESERVE")	1	3
011399	... Transfer, for rear fork hinge ("PATENT")	1	1
015282	... Transfer, "Made in England"	1	1
38-12-F389	... Transfer, for petrol tank ("A.J.S.")	2	3
015906	... Set of transfers, comprising all above	1	3 5

### TWIST GRIP.

16-117	... Twist grip, complete assembly	1	10 6
16-070	... Grip, rubber, for twist grip	1	1 0
16-091	... Rotor and sleeve, for twist grip (does not include rubber grip)	1	3 6
16-060	... Body, twist grip, top (plain clip)	1	3 0
16-061	... Body, twist grip, bottom (for friction spring)	1	3 0
11-013	... Screw, long, clamping twist grip body	1	3
11-014	... Screw, short, clamping twist grip body	1	3
16-008	... Spring, friction, for twist grip	1	9
16-009	... Screw, for twist grip friction spring	1	6
16-010	... Nut, for twist grip friction spring screw	1	2
16-011	... Stop, for twist grip (throttle) cable	1	6

### DUMMY GRIP.

16-069	... Grip, rubber, dummy	1	1 6
--------	-------------------------	---	-----

PART NUMBER	DESCRIPTION.	QTY.	PRICE EACH £ s. d.
-------------	--------------	------	-----------------------

### CLUTCH AND IGNITION CONTROL LEVERS.

18-620	Lever assembly, clutch and ignition.....	1	18 9
18-528	Lever, only, clutch.....	1	5 3
12-017-B	Lever, only, ignition.....	1	3 9
18-241	Bracket, for clutch lever.....	1	5 3
12-008	Bracket, for ignition lever.....	1	2 9
11-013	Screw, long, clamping clutch and ignition brackets.....	1	3
11-014	Screw, short, clamping clutch and ignition brackets.....	1	3
18-087	Pin, fulcrum, for clutch lever.....	1	3
18-053	Nut, clutch lever fulcrum pin.....	1	3
12-029	Bolt, central, for ignition lever.....	1	3
12-031	Cap, for ignition lever.....	1	8
12-033	Washer, spring, for ignition lever.....	1	2

### BRAKE AND AIR CONTROL LEVERS.

18-621	Lever, assembly, brake and air.....	1	18 9
18-535	Lever, only, brake.....	1	5 3
12-016-B	Lever, only, air.....	1	3 9
18-240	Bracket, for brake lever.....	1	5 3
12-007	Bracket, for air lever.....	1	2 9
11-013	Screw, long, clamping brake and air brackets.....	1	3
11-014	Screw, short, clamping brake and air brackets.....	1	3
18-087	Pin, fulcrum, for brake lever.....	1	3
18-053	Nut, brake lever fulcrum pin.....	1	3
12-029	Bolt, central, for air lever.....	1	3
12-031	Cap, for air lever.....	1	8
12-033	Washer, spring, for air lever.....	1	2

### FRONT BRAKE CABLE.

013178	Cable, complete, assembled, front brake.....	1	6 3
12-44	Wire, inner, front brake.....	1	1 2
40-058	Nipple, brake end, for brake inner wire.....	1	3
18-088	Nipple, handlebar end, for brake inner wire.....	1	3
12C-26	Casing, outer, front brake.....	1	1 2
STD-531	Ferrule, front brake outer casing.....	2	1
011348	Adjuster, front brake cable.....	1	2 0
16363	Nut, lock, front brake cable adjuster.....	1	6
16482	End, yoke, front brake cable.....	1	1 4
STD-736	Pin, for yoke end, front brake cable.....	1	4
STD-14	Pin, split, for front brake cable yoke end pin.....	1	1
012478	Sleeve, rubber, for front brake cable inner wire.....	1	5

### CLUTCH CABLE.

41-C-2	Cable, complete, assembled, clutch.....	1	7 8
12-52	Wire, inner, clutch.....	1	1 2
4	Nipple, gear box end, clutch inner wire.....	1	1
18-088	Nipple, handlebar end, clutch inner wire.....	1	3
12C-47	Casing, outer, clutch.....	1	3 3
STD-531	Ferrule, clutch outer casing.....	2	1
014225	Adjuster, clutch cable.....	1	7
STD-290	Nut, lock, clutch cable adjuster.....	1	6

### THROTTLE CONTROL CABLE.

41-T-2	Cable, complete, assembled, throttle.....	1	5 3
SW2-41	Wire, inner, throttle.....	1	1 1
1482	Nipple, carburettor end, throttle inner wire.....	1	2
12-034	Nipple, handlebar end, throttle inner wire.....	1	2
11C-39	Casing, outer, throttle.....	1	2 5
STD-528	Ferrule, throttle outer casing.....	2	1

PART NUMBER.	DESCRIPTION.	QTY.	PRICE EACH	
			£	s. d.

### AIR CONTROL CABLE.

41-A-1	... Cable, complete, assembled, air.....	1	5	3
11-38	... Wire, inner, air.....	1	1	1
1482	... Nipple, carburetter end, air inner wire.....	1		2
12-034	... Nipple, handlebar end, air inner wire.....	1		2
11C-32	... Casing, outer, air.....	1	2	0
STD-528	... Ferrule, air outer casing.....	2		1

### IGNITION CONTROL CABLE.

015190	... Cable, complete, assembled, ignition.....	1	6	0
11-37½	... Wire, inner, ignition.....	1	1	1
MC-4	... Nipple, magneto end, ignition inner wire.....	1		6
12-034	... Nipple, handlebar end, ignition inner wire.....	1		2
11C-25¼	... Casing, outer, ignition, long.....	1	2	2
11C-6	... Casing, outer, ignition, short.....	1		7
014828	... Stop, adjustable, for ignition cable.....	1	3	6
STD-528	... Ferrule, ignition outer casing.....	4		1
458731	... Cap, rubber, cable entry to magneto.....	1		7
458727	... Cap, metal, cable entry to magneto.....	1	3	2
163343	... Washer, fibre, for cable entry metal cap.....	1		1
454969	... Plunger, for ignition cable.....	1	1	2
458732	... Spring, return, for ignition cable.....	1		3

### PETROL TANK.

014675	... Tank, petrol, bare.....	1	12	3	1
014827	... Deflector, for petrol tank.....	1	9	9	
014850	... Cord, rubber, for petrol tank deflector.....	1		4	
STD-150	... Screw, retaining petrol tank deflector.....	3		2	
STD-185	... Washer, plain, for petrol tank deflector screw.....	3		1	

### PETROL TANK FITTINGS..

013325	... Cap, filler, for petrol tank.....	1	6	6
41-G3L-T93	... Tap, with filter, for petrol feed.....	2	4	11
STD-200	... Washer, fibre, for petrol feed tap.....	2		3
010906	... Grip, knee, left hand side (same as 38-G3-T4-L).....	1	4	1
010907	... Grip, knee, right hand side (same as 38-G3-T4-R).....	1	4	1
010908	... Plate, for left hand knee grip (same as 38-G3-T34-L).....	1		10
010909	... Plate, for right hand knee grip (same as 38-G3-T34-R).....	1		10
STD-70	... Bolt, fixing knee grip plate, $\frac{5}{16}$ in. by $\frac{1}{4}$ in. by 26.....	4		3
STD-639	... Spacer, $\frac{1}{4}$ in. long, for knee grip plate bolts.....	4		3

### PETROL TANK FIXING BOLTS (1949).

38-G3-T15-A	... Bolt, fixing tank (front right and both rear positions), $1\frac{5}{16}$ in. by $\frac{5}{16}$ in. by 26.....	3		10
015248	... Bolt, fixing tank (front left position), $1\frac{1}{2}$ in. by $\frac{5}{16}$ in. by 26.....	1		6
015246	... Sleeve, fixing horn bracket.....	1		8
015247	... Nut, for horn bracket fixing sleeve.....	1		6
16413	... Pad, rubber, thick ( $\frac{7}{16}$ in.) for tank fixing bolt.....	3		3
16414	... Pad, rubber, thin ( $\frac{1}{8}$ in.) for tank fixing bolt.....	5		3
STD-173	... Washer, metal, $1\frac{1}{8}$ in. diameter, plain, for tank fixing bolts.....	14		3
41-G3L-T97	... Wire, copper, 5 feet by 20 S.W.G.....	1		3

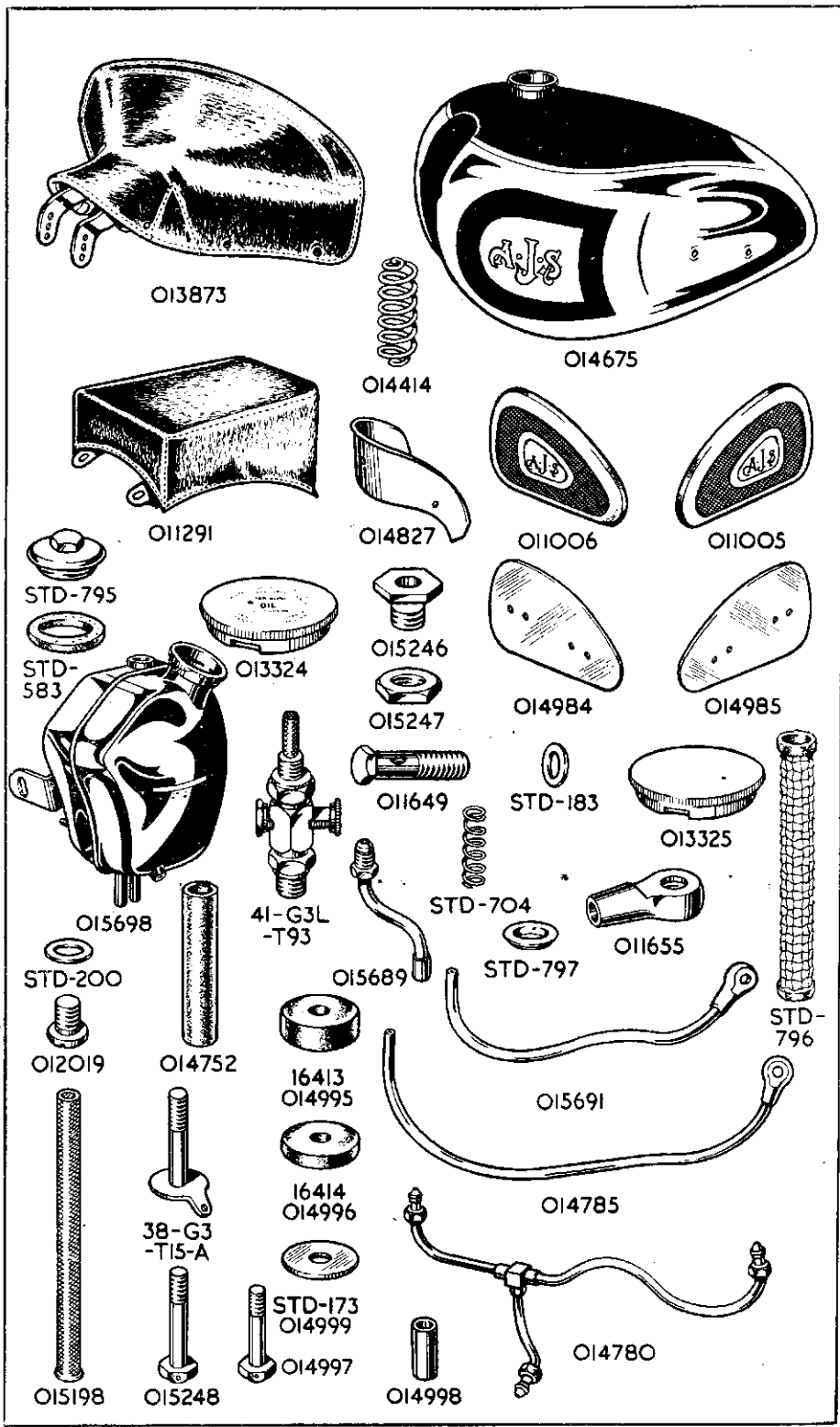

PART NUMBER.	DESCRIPTION.	QTY.	PRICE EACH	
			£	s. d.

### PETROL TANK FIXING BOLTS (1950).

014997	Bolt, fixing tank, all positions, 1 $\frac{1}{2}$ in. by $\frac{5}{16}$ in. by 26	4	...	8
014998	Sleeve, $\frac{1}{8}$ in. long, for tank fixing bolts	4	...	2
014995	Pad, rubber, thick ( $\frac{5}{8}$ in.), for tank fixing bolts in front right and both rear positions	3	...	4
014996	Pad, rubber, thin ( $\frac{3}{16}$ in.), for all tank fixing bolts (three used on front left bolt)	6	...	2
014999	Washer, metal, 1 $\frac{1}{2}$ in. diameter, plain, for tank fixing bolts	4	...	3
41-G3L-T97	Wire, copper, 5 feet by 20 S.W.G.	1	...	3

### OIL TANK.

015698	Tank, oil, bare	1	...	2 0 6
013324	Cap, filler, for oil tank	1	...	6 6
012019	Plug, drain, for oil tank	1	...	4
STD-200	Washer, fibre, for oil tank drain plug	1	...	3
STD-796	Filter, felt, for oil tank	1	...	4 1
STD-797	Cap, metal, dished, for oil tank felt filter	1	...	4
STD-704	Spring, on top of oil tank filter metal cap	1	...	6
STD-795	Cap, screwed, for oil tank filter compartment	1	...	2 5
STD-583	Washer, cork, for filter compartment cap	1	...	3

For the two nuts and washers that retain the oil tank (and the Battery Carrier) to the main frame, see "Battery Carrier" Group.

For the bolt, washer, and nut fixing the oil tank bracket to the rear mudguard, see "Rear Mudguard" Group.

### PETROL PIPE.

014780	Pipe, assembled, for petrol feed	1	...	10 6
--------	----------------------------------	---	-----	------

The "nipples" on these pipes are formed integrally with the piping. Therefore union nuts cannot be removed or re-fitted, and they are not sold as separate spares.

### OIL PIPES.

014785	Pipe, oil feed, assembly	1	...	10 6
015691	Pipe, oil return, engine end	1	...	9 6
015689	Pipe, oil return, tank end	1	...	3 6
011655	Union, banjo, for feed and engine end return oil pipes	2	...	4 6
011649	Pin, banjo, retaining feed and engine end return oil pipes	2	...	2 0
STD-183	Washer, fibre, for oil pipe banjo pins	2	...	3
014752	Connection, rubber, for feed and return oil pipes	2	...	5
015198	Filter, metal gauze, for oil feed pipe	1	...	1 8
014789	Hose, vent, from oil tank	1	...	1 5
014951	Clip, for oil tank vent pipe	1	...	4
014789	Hose, from crankcase release valve to oil tank	1	...	1 5

### FRONT WHEEL.

015555	Wheel, front, with all fittings (comprises rim, spokes, nipples, hub, all bearings, all brake parts, including cover plate and expander lever, but does not include the tyre)	1	...	9 10 1
013618	Wheel, front, less all fittings (comprises rim, spokes, nipples and hub shell assembled)	1	...	5 0 2
012217	Rim, front, 19 in. by 2 $\frac{1}{2}$ in.	1	...	1 7 3
011018	Spoke, front, left, 5 $\frac{3}{8}$ in. by 8G by 10G (same as 37-X-H51)	20	...	3
011014	Spoke, front, right, 8 $\frac{3}{8}$ in. by 9G by 11G (same as 12399)	20	...	3
011017	Nipple, front, left, .225 in. by 10G (same as 20680)	20	...	1
011016	Nipple, front, right, .225 in. by 11G (same as 20678)	20	...	1
012575	Hub, with brake drum, bare, for front wheel	1	...	2 11 0
STD-51	Nipple, grease, for front wheel hub	1	...	3

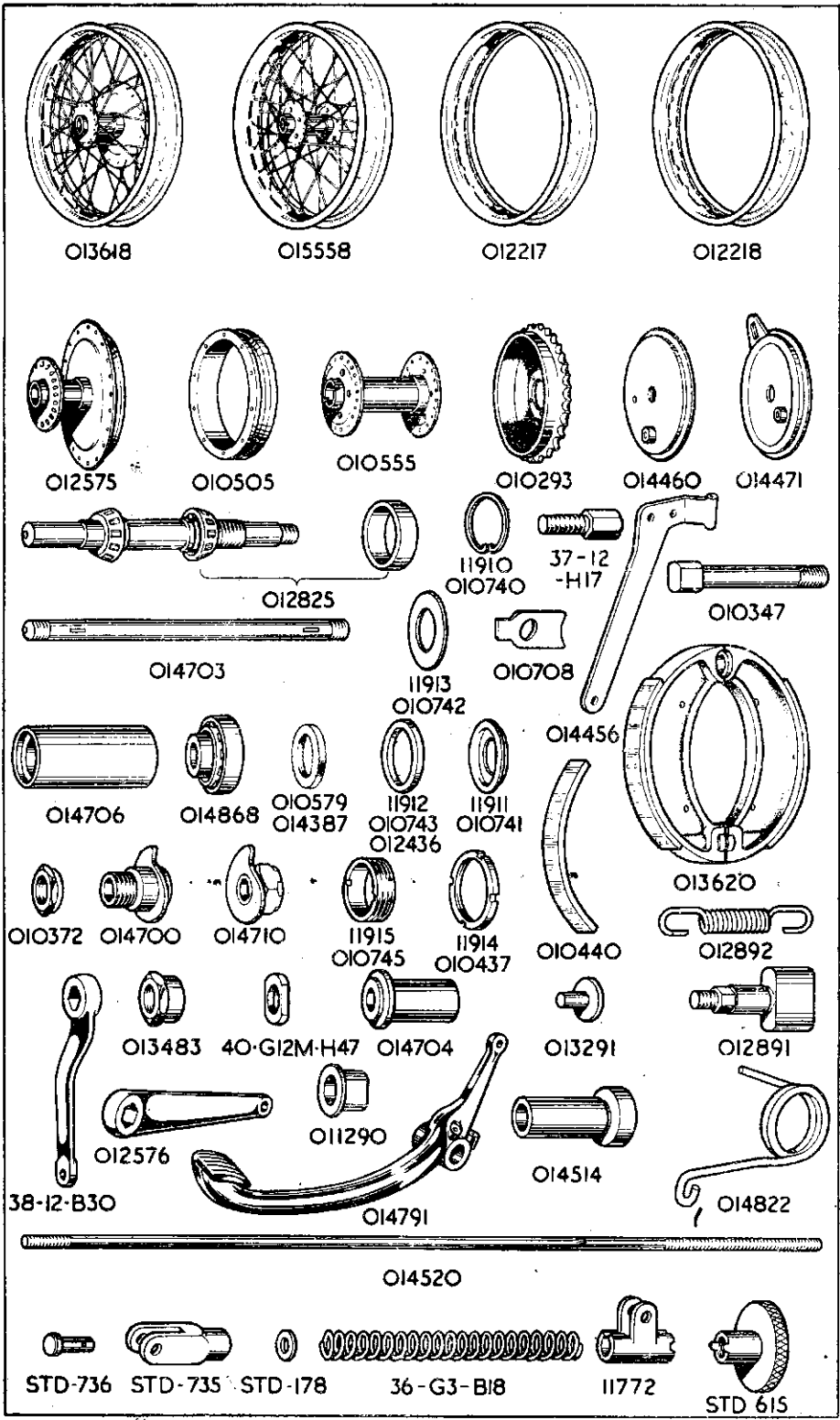



PART NUMBER	DESCRIPTION.	QTY.	PRICE EACH £ s. d.
<b>FRONT WHEEL BEARINGS.</b>			
012825	Spindle, with roller bearings, for front wheel (same as 40-G12M-H10)	1	15 6
010579	Oil-seal, for front hub bearings	2	5
11910	Ring, spring, locating front hub bearings	1	3
11911	Cup, for front hub bearing oil-seal	1	4
11912	Ring, spacing, for front hub bearing oil-seal	1	6
11913	Ring, retaining front hub bearing oil-seals	3	3
11914	Nut, lock, for front hub bearing adjusting ring	1	2 0
11915	Ring, adjusting, for front hub bearing	1	2 5
40-G12M-H47	Nut, locating front brake cover plate	1	4
11913	Washer, locating front brake cover plate	1	3
013483	Nut, outside, securing front brake cover plate	1	8
STD-1	Nut, front wheel spindle, left side	1	4
STD-8	Washer, plain, front wheel spindle, left side	1	1

### REAR WHEEL.

015566	Wheel, rear, with all fittings (comprises rim, spokes, nipples, hub, all bearings, but does not include the centre solid spindles, washers, spacers, cams, nuts, brake parts, sprocket, speedometer drive and tyre)	1	6 10 11
015558	Wheel, rear, less all fittings (comprises rim, spokes, nipples and hub shell assembled)	1	4 14 9
012218	Rim, rear, 19 in. by 2½ in.	1	1 7 3
011012	Spoke, rear wheel, left and right, 8⅜ in. by 6G by 9G (same as 39-8-H54)	40	3
011013	Nipple, left and right, .250 in. by 9G (same as 12344)	40	1
010555	Hub, rear wheel, shell only	1	2 5 7
STD-51	Nipple, grease, for rear wheel hub	1	3

### REAR WHEEL BEARINGS.

014868	Bearing, roller, for rear hub (only sold as a complete bearing)	2	12 4
014387	Oil-seal, for rear hub bearings	2	4
010740	Ring, spring, locating rear hub bearings	1	3
010741	Cup, for rear hub bearing oil-seal	1	3
010743	Ring, spacing, for rear hub bearing oil-seal	1	11
010742	Ring, retaining rear hub bearing oil-seals	3	3
012436	Collar, spacing, between taper bearing and rear hub bearing oil-seal	2	9
014706	Spacer, 2⅞ in. long, between the two bearings of rear hub	1	2 6
010745	Ring, adjusting, for rear hub bearing	1	2 5
010437	Nut, lock, for rear hub bearing adjusting ring	1	2 0
014703	Spindle, centre, solid, for rear wheel	1	8 6
014705	Spacer, 1⅞ in. long, on rear wheel solid spindle, for speedometer gear box	1	2 7
010372	Nut, locking, speedometer gear box	1	7
014704	Sleeve, on rear wheel solid spindle, locating cover plate	1	3 3
014700	Cam, on rear wheel solid spindle, right side	1	5 10
014710	Cam, on rear wheel solid spindle, left side	1	4 11
STD-573	Key, on rear wheel solid spindle locating cams	2	4
011290	Collar, on rear wheel solid spindle (abuts against fork end)	2	1 4
014869	Nut, on rear wheel solid spindle	2	6

### FRONT BRAKE.

010505	Drum, front brake	1	17 11
STD-140	Screw, fixing front brake drum to hub shell, ⅝ in. by 1 B.A.	10	3
014460	Plate, cover, front brake	1	17 3
014456	Stay, front brake cover plate anchor	1	15 3
014807	Bolt, fixing anchor stay to front cover plate, ⅝ in. by ⅝ in. by 26	1	3
014119	Washer, plain, for anchor stay bolt	1	1
013620	Shoes, pair of, for front brake, with brake linings and thrust pins. Only supplied in pairs (same as 39-8-B71-A) per pair	1	1 0 6

PART NUMBER	DESCRIPTION.	QTY.	PRICE EACH £ s d.
<b>FRONT BRAKE—Continued,</b>			
013291	Pin, thrust, brake expander adjusting.....	2	9
STD-174	Washer, plain, for thrust pin.....	R	1
000440	Linings, brake, per pair of, less rivets (same as 3836-2).....	1	4 0
STD-113	Rivets, for brake linings, per set of.....	12	2
012892	Spring, for brake shoes (same as 16485).....	2	4
012891	Expander, for brake shoes (same as 36-8-B51).....	1	4 1
012576	Lever, for front brake shoe expander.....	1	2 6
STD-51	Nipple, grease, for brake shoe expander.....	1	3
STD-174	Washer, plain, for brake shoe expander.....	1	1
STD-4	Nut, for brake shoe expander.....	1	3

### REAR BRAKE.

010293	Sprocket and brake drum, for rear wheel, 42-teeth.....	1	15 0
37-12-H17	Bolt, retaining sprocket to rear hub, $\frac{3}{8}$ in. by $\frac{5}{16}$ in. by 26.....	5	4
010708	Washer, lock, for rear sprocket retaining bolt.....	5	1
STD-11	Washer, plain, for rear sprocket retaining bolt.....	5	1
STD-74	Nut, for rear sprocket retaining bolt.....	5	3
014471	Plate, cover, rear brake.....	1	15 0
010347	Bolt, anchor, rear brake cover plate, $2\frac{1}{4}$ in. by $\frac{3}{8}$ in. by 26, with square head.....	1	2 0
STD-3	Nut, for rear brake cover plate anchor bolt.....	1	3
STD-6	Pin, split, for rear brake anchor bolt.....	1	1
013620	Shoes, pair of, for rear brake, with brake linings and thrust pins. Only supplied in pairs (same as 39-8-B71-A) per pair.....	1	0 6
013291	Pin, thrust, brake expander adjusting.....	2	9
STD-174	Washer, plain, for thrust pin.....	R	1
010440	Linings, brake, per pair of, less rivets (same as 3836-2).....	1	4 0
STD-113	Rivets, for brake linings, per set of.....	12	2
012892	Spring, for brake shoes (same as 16485).....	2	4
012891	Expander, for brake shoes (same as 36-8-B51).....	1	4 1
38-12-B30	Lever, for rear brake shoe expander.....	1	2 6
STD-51	Nipple, grease, for brake shoe expander.....	1	3
STD-174	Washer, plain, for brake shoe expander.....	1	1
STD-4	Nut, for brake shoe expander.....	1	3

### REAR BRAKE OPERATING PARTS.

014791	Pedal, foot, for rear brake.....	1	17 3
014514	Bush, for rear brake foot pedal.....	1	1 0
STD-51	Nipple, grease, for rear brake foot pedal.....	1	3
STD-344	Bolt, adjusting rear brake foot pedal, $\frac{3}{8}$ in. by $\frac{1}{4}$ in. by 26.....	1	6
STD-5	Nut, for rear brake foot pedal adjusting bolt.....	1	3
014822	Spring, return, rear brake foot pedal.....	1	7
014520	Rod, bare, rear brake.....	1	1 9
STD-735	End, yoke, for front end of brake rod.....	1	1 4
STD-736	Pin, for brake rod yoke end.....	1	4
STD-14	Pin, split, for brake rod yoke end pin.....	1	1
36-G3-B18	Spring, for brake rod.....	1	4
STD-178	Collar, for brake rod spring.....	1	1
11772	Clip, adjusting, for rear end of brake rod.....	1	2 5
STD-736	Pin, for brake rod adjusting clip.....	1	4
STD-14	Pin, split, for brake rod adjusting clip pin.....	1	1
STD-615	Nut, adjusting, for rear brake rod.....	1	2 10

### VOLTAGE REGULATOR.

015087	Regulator, with cut-out, complete unit, type MCR-2. Lucas replacement number 37097.....	1	17 5
014929	Strip, fixing regulator to battery carrier.....	1	8
STD-70	Bolt, fixing regulator to fixing strip, $\frac{5}{16}$ in. by $\frac{1}{2}$ in. by 26.....	2	3
STD-347	Bolt, securing fixing strip to battery carrier, $1\frac{5}{8}$ in. by $\frac{1}{4}$ in. by 26.....	1	3
STD-12	Washer, plain, for regulator fixing bolts.....	5	1
STD-5	Nut, for regulator fixing bolts.....	3	3

PART NUMBER	DESCRIPTION.	QTY.	PRICE EACH £ s. d.
<b>BATTERY.</b>			
PUW-7E-4	Battery, with lid, dry and uncharged. This is a battery that has NOT been filled with electrolyte (acid) and is, of course, not charged. It requires no special packing and can safely be packed with other goods.....	1	16 9
PUW-7E-4-C	Battery, with lid, filled and charged. This is a battery filled with electrolyte and charged, ready for use. It is only supplied to callers who have previously arranged for it to be prepared. IN NO CIRCUMSTANCES do we pack and despatch this battery .....	1	19 0
S-2171	Lid, only, with rubber pads, for battery.....	1	2 0
<b>HEAD LAMP.</b>			
50788-B	Lamp, head, Type SSU-700-P, with bulbs, ammeter and switch (no cable harness).....	1	4 2 6
553248	Rim, bare, for head lamp.....	1	12 1
516364	Reflector with front glass (parts not sold separately).....	1	14 5
516368	Holder, for bulbs .....	1	8 8
106779	Screw, fixing panel to head lamp.....	3	4
185026	Washer, spring, for panel fixing screw.....	3	1
516183	Fillet, rubber, for head lamp panel.....	1	3
112201	Bolt, fixing head lamp to bracket.....	2	7
137141	Washer, plain, for head lamp fixing bolts.....	2	5
<b>REAR LAMP.</b>			
53139-A	Lamp, rear, complete with bulb. Lucas replacement number for early models "467-1," for later models "467-2" (see items seven and eight below).....	1	1 6
572611	Glass, red, for rear lamp.....	1	6 11
572595	Gasket, rubber, for base of rear lamp.....	1	1 2
572039	Grummet, rubber, for rear lamp wire.....	1	10
572040	Plug, rubber, for base of rear lamp.....	1	11
572609	Frame, over rear lamp red glass.....	1	11 6
572055	Screw, fixing glass frame on rear lamps marked "467-1," (see item one above).....	1	5
572614	Nut, sleeve, fixing glass frame on rear lamps marked "467-2" (see item one above).....	1	5
161385	Washer, rubber, for screw, or sleeve nut, fixing glass frame on rear lamps.....	1	1
188818	Terminal sleeve, for rear lamp wire.....	2	2
165310	Nut, rear lamp fixing screw.....	2	2
185036	Washer, spring, for rear lamp fixing screw.....	2	2
<b>HORN.</b>			
015257	Horn, type HF 1234, with bracket. Lucas replacement number is 069225, but hole in bracket must be opened out to $\frac{31}{32}$ in. diameter.....	1	15 0
015245	Bracket, only, for horn (see note above re opening out hole).....	1	3 2

For the convenience of Owners, **SPARES STOCKISTS** are appointed for most districts. To save delay, and the delivery surcharge customers are recommended to always first apply to their nearest Agent or spares stockist.

PART  
NUMBER.

**ELECTRICAL SUNDRIES.**

36084	...	...	Ammeter, for head lamp panel.....	1	...	8	8
351551	...	...	Switch, main lighting, for head lamp panel.....	1	...	9	10
380521	...	...	Switch, dipping, for handlebar.....	1	...	6	4
762664	...	...	Switch, horn, for handlebar.....	1	...	5	2
762664	...	...	Switch, magneto cut-out, for handlebar.....	1	...	5	2
351567	...	...	Handle, with screw, for main lighting switch.....	1	...	1	9
994001	...	...	Cable harness, main lighting and horn, but does not include the triple wire from head lamp to handlebar dipping switch and the wires from regulator.....	1	...	13	7
858795	...	...	Cable harness, triple, for dipping switch.....	1	...	4	0
989981	...	...	Cable harness, for regulator.....	1	...	4	0
STD-543	...	...	Cable, high tension, for sparking plugs (28½ ins. required for left cylinder and 28½ ins. for right cylinder) price per foot.....	R	...	10	
STD-541	...	...	Terminal, for high tension cable.....	2	...	3	
STD-540	...	...	Terminal, for earth cables.....	2	...	2	
900269	...	...	Connector, snap, for rear lamp cable.....	1	...	1	2
900269	...	...	Connector, snap, for regulator to ammeter cable.....	1	...	1	2
571395	...	...	Connector, screwed, for battery positive cable.....	1	...	1	9
168	...	...	Bulb, head lamp, main, 6 volt, 24 by 24 watts.....	1	...	3	6
			Plus Purchase Tax.....	-	...		9
988	...	...	Bulb, head lamp, pilot, 6 volt, 3 watts.....	1	...	1	6
			Plus Purchase Tax.....	-	...		4
988	...	...	Bulb, rear lamp, 6 volt, 3 watts.....	1	...	1	6
			Plus Purchase Tax.....	-	...		4
014296	...	...	Plug, sparking, LODGE, Type HL-14-S (used as standard on 1949 machines).....	2	...	6	0
015547	...	...	Plug, sparking, K-L-G, Type FE-80 (used as standard on 1950 machines).....	2	...	5	0

**CABLE CLIPS.**

011907	...	...	Clip, rubber, 1½ in.....	6	...	2	
011908	...	...	Clip, rubber, 3 in.....	5	...	2	
011909	...	...	Clip, rubber, 4½ in.....	4	...	2	
014453	...	...	Clip, metal, holding cable behind rear lamp.....	1	...	3	
011382	...	...	Clip, metal, holding rear lamp cable to mudguard edge.....	3	...	2	
011094	...	...	Bush, rubber, fits in rear mudguard, for rear lamp cable (same as 39-G3-EQ-13).....	1	...	4	

**SPEEDOMETER.**

015561	...	...	Speedometer, trip, 120 M-P-H, complete.....	1	...	4	0	0
015562	...	...	Speedometer, trip, 180 K-P-H, complete.....	1	...	4	0	0
S-480-3-L	...	...	Head, only, speedometer, trip, 120 M-P-H.....	1	...	2	10	0
S-480-7-L	...	...	Head, only, speedometer, trip, 180 K-P-H.....	1	...	2	10	0
53279-1	...	...	Set of bulb holding parts for speedometer head.....	1	...	3	11	
53205	...	...	Bulb, for speedometer head, M-B-C, 6 volts, 1.8 watts.....	1	...	1	6	
			Plus Purchase Tax.....	-	...		4	
40-G12M-FF78	...	...	Bracket for speedometer head.....	1	...	10		
STD-341	...	...	Bolt, fixing speedometer bracket to forks, ⅝ in. by ¼ in. by 20... ..	2	...	3		
STD-12	...	...	Washer, plain, for speedometer bracket bolts.....	2	...	1		
STD-12	...	...	Washer, plain, spacing, for speedometer head.....	2	...	1		
W-7216	...	...	Washer, spring, for speedometer head fixing nut.....	2	...	1		
N-1253	...	...	Nut, fixing speedometer head to bracket.....	2	...	2		
53395-1-65	...	...	Cable, speedometer drive, complete.....	1	...	1	0	0
52108-1-65	...	...	Cable, speedometer drive, inner only.....	1	...	10	0	
53398-1-65	...	...	Cable, speedometer drive, outer only.....	1	...	10	0	
41-G3L-F311	...	...	Clip, for speedometer drive cable.....	1	...	3		
STD-450	...	...	Screw, fixing speedometer cable clip, ⅜ in. by 2 B.A.....	1	...	1		
STD-190	...	...	Washer, spring, for cable clip screw.....	1	...	1		
52283-5	...	...	Gearbox, speedometer, complete.....	1	...	12	6	

**COMPLETE TOOL KITS.**

015899	...	...	Tool kit, complete, with tyre inflator.....	1	...	2	17	8
015900	...	...	Tool kit, complete, less tyre inflator.....	1	...	2	10	2

**PART  
NUMBER**

**TOOLS.**

The following comprise "TOOL KIT, COMPLETE, WITH TYRE INFLATOR," and is included as part of every motor cycle.

17520	...	...	Bag, for tools.....	1	...	4	1
L-TK13	...	...	Screwdriver .....	1	...	2	9
L-TK15	...	...	Pliers, side cutting.....	1	...	3	10
11024	...	...	Pliers, for gudgeon pin circlips.....	1	...	1	7
L-TK20	...	...	Gun, grease .....	1	...	6	7
38-G3-EQ2	...	...	Inflator, tyre.....	1	...	7	6
40-G3-TK29	...	...	Lever, tyre.....	2	...	1	7
015264	...	...	Spanner, single end, for rocker clamping bolts.....	1	...	1	4
41-G3L-TK1	...	...	Spanner, double end, $\frac{3}{16}$ in. by $\frac{1}{4}$ in.....	2	...	2	5
41-G3L-TK2	...	...	Spanner, double end, $\frac{5}{16}$ in. by $\frac{3}{8}$ in.....	1	...	3	8
3263	...	...	Spanner, double end, $\frac{3}{16}$ in. by .375 in., clutch cable adjustment	1	...	1	4
015023	...	...	Spanner, double end, with gauge, for contacts (Lucas number, 415116) .....	1	...	7	
R-TK3	...	...	Spanner, triple end, .80 in. by 1.011 in. by 1.2 in.....	1	...	1	7
17634	...	...	Spanner, box, with tommy, for sparking plug.....	1	...	1	7
015213	...	...	Spanner, box, for cylinder head nuts.....	1	...	1	8
014540	...	...	Spanner, box, with tommy, for rocker box, cover bolts.....	1	...	1	5
11914-S	...	...	Spanner, hook, for front hub bearing lock nut.....	1	...	1	1
010438	...	...	Spanner, hook, for rear hub bearing lock nut.....	1	...	1	1
L-TK12	...	...	Wrench, adjustable.....	1	...	9	0

**SPECIAL TOOLS.**

36-G8-E384	...	...	Holder, valve, for valve grinding.....	1	...	10	
015273	...	...	Extractor, for timing pinion and magneto gear.....	1	...	2	8
015374	...	...	Extractor, for camshaft gears.....	1	...	4	6
014598	...	...	Disc, timing (see Instruction Manual).....	1	...	3	6

The above tools are NOT INCLUDED in the equipment of a new motor cycle.

**VARIOUS.**

011957	...	...	"Tekall," rust preventative, $\frac{1}{2}$ pint tin.....	R	...	2	0
011958	...	...	"Tekall," rust preventative, 1 pint tin.....	R	...	2	6
CM-10	...	...	Instruction Manual .....	R	...	2	6
BAH	...	...	Badge, Monogram, A.J.S., for button hole.....	R	...	1	6
BAT	...	...	Badge, Monogram, A.J.S., for tie.....	R	...	1	6
BAB	...	...	Badge, Monogram, A.J.S., for brooch fixing.....	R	...	1	6

**SERVICE**

The Service and repair department is situated in **Burrage Grove, Plumstead, London, S.E.18**, **Burrage Grove** is the first turning on the left from Burrage Road when entering Burrage Road from the Plumstead Road. (See final paragraph below.)

The nearest Railway Station is **WOOLWICH ARSENAL, SOUTHERN REGION RAILWAY**. This Station is five minutes walk from our Service Depot in Burrage Grove. There is an excellent service of electric trains from Charing Cross, Waterloo, Cannon Street and London Bridge Stations, Southern Region Railway.

Bus routes 53, 53a, 54, 99 and 122. Trolleybus routes, 696 and 698, and Tram routes 36, 38 and 40, pass the end of Burrage Road (one minute from the Service Depot).

Bus routes 21a, 75 and 161 and Tram routes 44, 46 and 72 serve **Beresford Square** which is three minutes walk from the **Service and Repair Department**.

Visitors from the North can pass into Woolwich via the Free Ferry between North Woolwich and Woolwich. North Woolwich is a British Railways terminus and is also served by Bus and Trolleybus routes 101, 569, 669 and 685. There is also a tunnel under the River Thames at this point for foot passengers. The Free Ferry accommodates all types of motor vehicles and there is a very frequent service. The Southern landing stage is less than a mile from the Service Depot.

Visitors arriving by road, if they are strangers to the locality, should enquire for **Beresford Square, Woolwich**. Upon arrival there, the road skirting the Royal Arsenal should be followed in an Easterly direction for about four hundred yards, and Burrage Road is the second turning on the right after leaving the square. Burrage Grove is then the first turning on the left.

# DETAILED INDEX

	Page		Page
<b>BRAKES</b>		<b>ENGINE PLATES</b>	
Front ... ..	39	Plates ... ..	14
Rear ... ..	40	Crankcase bolts ... ..	14
Rear, operating parts ... ..	40		
<b>CARBURETTER</b>		<b>FOOTRESTS</b>	
Choke ... ..	12	Pillion ... ..	33
Complete ... ..	10	Rider's ... ..	31
Float Chamber ... ..	12		
Jets ... ..	12	<b>FRAME</b>	
Mixing body ... ..	12	Front Frame ... ..	23
Valves ... ..	12	Rear Frame ... ..	23
		Rear Fork ... ..	24
		Rear Carrier ... ..	30
		Teledraulic rear leg ... ..	24
<b>CABLES</b>			
Air ... ..	35	<b>FRONT FORKS</b>	
Brake ... ..	34	Assembly ... ..	24
Clutch ... ..	34	Handlebar ... ..	28
Ignition ... ..	35	Parts ... ..	26
Throttle ... ..	34	Steering damper ... ..	26
<b>ELECTRICAL</b>		<b>GRIPS</b>	
Battery ... ..	41	Dummy ... ..	33
Battery carrier ... ..	31	Twist ... ..	33
Cable clips ... ..	42		
Dynamo ... ..	10	<b>GUARDS</b>	
Horn ... ..	41	Chaincase (front) ... ..	30
Lamp, Head ... ..	41	Chainguard (rear) ... ..	31
Lamp, Rear ... ..	41	Mudguard, front ... ..	28
Magneto ... ..	10	Mudguard, rear ... ..	30
Sundries ... ..	42	Number plate, front ... ..	30
Voltage Regulator ... ..	40	Number plate, rear ... ..	30
<b>ENGINE</b>		<b>LEVERS</b>	
Big-end bearings ... ..	6	Air ... ..	34
Connecting rods ... ..	6	Brake ... ..	34
Crankcase ... ..	5	Clutch ... ..	34
Crankshaft ... ..	6	Ignition ... ..	34
Cylinders ... ..	6		
Cylinder heads ... ..	6	<b>LUBRICATION</b>	
Gaskets ... ..	15	Distributor—oil ... ..	9
Pistons ... ..	6	Filter—oil ... ..	9
Push rods ... ..	7	Pumps—oil ... ..	9
Re-boring ... ..	7	Valve—oil relief ... ..	10
Rockers ... ..	7	Valve—oil release ... ..	10
Steady stay ... ..	9		
Timing ... ..	7		
Valves ... ..	6		