



# SPARES LIST

*for*

**1951**

*500 c.c. O.H.V.*

## **MATCHLESS** **"SUPER CLUBMAN"**

VERTICAL TWIN  
(MODEL G8)



**MATCHLESS**  
**MOTOR CYCLES**

PROPRIETORS: ASSOCIATED MOTOR CYCLES LIMITED  
PLUMSTEAD - LONDON - S.E.18



Price:  
TWO SHILLINGS and SIXPENCE

EDITION CL.19

## ILLUSTRATIONS

	Page
CARBURETTER ... ..	13
CLUTCH AND KICK-STARTER ... ..	23
CONTROL LEVERS ... ..	34
CRANKCASE, CRANKSHAFT AND CONNECTING RODS ... ..	4
CYLINDERS, HEADS, PISTONS, VALVES AND TIMING GEAR ... ..	8
EXHAUST PIPES, SHOCK ABSORBER AND CHAINS ... ..	16
FRAME AND TELEDRALIC REAR LEG ... ..	25
FRONT TELEDRALIC FORKS AND STEERING DAMPER ... ..	28
GEAR OPERATING PARTS ... ..	21
GEAR BOX SHELLS, GEARS AND SHAFTS ... ..	18
OIL PUMPS, DYNAMO AND MAGNETO ... ..	11
STANDS, GUARDS, CHAINCASES AND TOOL BOXES ... ..	30
TANKS AND PIPES ... ..	36
WHEELS AND BRAKES... ..	38

## ALWAYS QUOTE THE COMPLETE ENGINE NUMBER

*(Including all the Letters in it)*

THIS ENABLES US TO IDENTIFY THE MACHINE

---

EACH SERIES OF FRAMES IS NUMBERED FROM ZERO  
UPWARDS. THEREFORE THE QUOTATION OF A  
FRAME NUMBER ONLY DOES NOT PERMIT A MACHINE  
TO BE IDENTIFIED.

# SPARES LIST

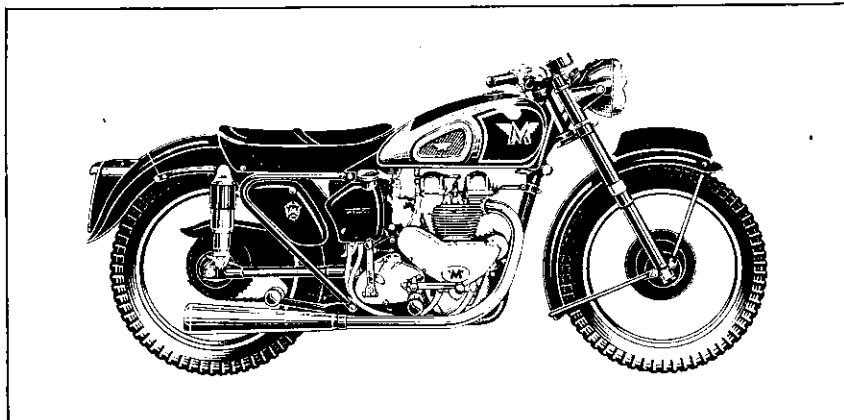

## MATCHLESS "SUPER CLUBMAN"

### VERTICAL TWIN

Bore 66 m.m.

Stroke 72.8 m.m.

Capacity 498 c.c.



Compiled and Issued by the Manufacturers :

## MATCHLESS MOTOR CYCLES

(Proprietors : ASSOCIATED MOTOR CYCLES LIMITED)

Registered Offices :

PLUMSTEAD ROAD, PLUMSTEAD  
LONDON, S.E.18 . ENGLAND

Nearest Station :  
WOOLWICH ARSENAL  
(Southern Region Railway)

Factories :  
BURRAGE GROVE and MAXEY ROAD  
PLUMSTEAD, S.E.18

Telegrams and Cables : " MATCHLESS, WOL-LONDON "

Telephone : WOOLWICH 1 2 2 3 (5 Lines)

Codes : A.B.C. 5th and 6th Edition ; Bentley's ; and Private Codes

All correspondence to :—  
MATCHLESS MOTOR CYCLES, PLUMSTEAD ROAD, LONDON, S.E.18

**Price : TWO SHILLINGS and SIXPENCE**

EDITION CL-19

**(1) TERMS OF BUSINESS.**

**Our terms are :—** CASH WITH ORDER,  
CASH AGAINST PRO-FORMA INVOICE, OR  
APPROVED LEDGER ACCOUNT.

Customers who wish to avoid delay can open deposit accounts and the usual deposit is £5.

Orders from abroad should be accompanied by a remittance to cover the costs of goods and postal charges.

We do not send goods by "CASH ON DELIVERY" (C.O.D.).

**(2) PRICES AND SPECIFICATIONS.**

All prices, specifications and conditions are subject to alteration without notice. The prices of spares do not include the costs of packing and carriage.

**(3) CARRIAGE AND PACKING.**

All invoices for spare parts will be SURCHARGED by FIVE PER CENT. to cover the cost of packing and postage, or carriage, and the minimum surcharge is sixpence. (Home orders only.)

A special packing case, or crate, is required for some spares to ensure freedom from damage in transit. In such circumstances a special charge for the value of the case, or crate, will be made in addition to the five per cent. surcharge but the special charge will be credited in full if the container is promptly returned to our factory carriage paid and in good condition.

**(4) HOW TO ORDER SPARES.**

**STATE :—** (a) The Model of the machine.  
(b) The complete engine number. (See paragraph 5.)  
(c) The frame number. (See paragraph 5.)  
(d) The part numbers of the spares required.  
(e) A description of each spare.  
(f) The quantity required of each item.  
(g) How the spares are to be sent. (Post, Parcels Post, Passenger train or Goods train.)  
(h) Your full name and address. These particulars are best written in BLOCK LETTERS.  
(i) Mention if, or not, you have an account with us.

**ALSO :—** Unless you have a deposit or ordinary account, enclose a remittance to cover the cost of the spares plus the five per cent. surcharge. (See paragraph 3.)

When cash is sent any excess will be refunded without prior application.

**NOTE :—** When sending orders by telegram or cable do not omit your name and address from the message.

**(5) IDENTITY.**

To ensure the supply of correct spares it is essential we can identify the machine for which they are required. The ONLY WAY to do that is for us to know the COMPLETE ENGINE and frame numbers.

The engine number is stamped on the crankcase, IN FRONT OF LEFT CYLINDER, and may have one or more letters incorporated in it. THE COMPLETE NUMBER MUST BE QUOTED.

The frame number is stamped on the right-hand side of the frame lug that is below the saddle.

**(6) SERVICE.**

The **SERVICE AND REPAIR DEPARTMENT** is situated in **BURRAGE GROVE, PLUMSTEAD, LONDON, S.E.18**, and is open on Mondays to Fridays from 8.30 a.m. to 12.55 p.m.—2 p.m. to 5.30 p.m. It is closed on Saturdays, Sundays and National Holidays.

It exists for the purpose of :—

- (a) Giving technical assistance verbally or through the Post.
- (b) Supplying spare parts over the counter or through the Post.
- (c) Repairing and re-conditioning machines, or parts of machines, of our make.

If it is considered necessary to bring a machine, or parts, to the factory for an urgent repair IT IS ESSENTIAL you make an appointment beforehand to avoid disappointment. This can be done by letter or telephone.

**(7) REPAIRS.**

The instructions regarding repairs should be clear and definite, otherwise the cost may be greater than that expected. We shall be pleased to give estimates for repairs if parts are sent to us for that purpose. If the estimate is accepted, no charge is made for the preliminary examination, but, should it be decided not to have the work carried out, it may be necessary to make a charge to cover the cost of whatever dismantling and re-assembly may have been done to prepare the estimate.

**(8) REPAIRS TO PROPRIETARY FITTINGS.**

We do not repair carburetters, chains, electrical equipment, saddles, sparking plugs, speedometers and tyres. On page 82 of the "**MAINTENANCE MANUAL AND INSTRUCTION BOOK**" will be found the names and addresses of the manufacturers of the proprietary equipment we fit, all of whom service and repair equipment they make.

**(9) PATTERNS.**

Parts sent to us as patterns, or for repair, should have attached to them a label bearing the sender's full name and address. The instructions regarding such parts should be sent under separate cover.

**(10) GUARANTEE.**

All parts made by us, and sold as spares, are subject to the same Limited Guarantee as that issued with each new motor cycle and that guarantee is printed in full on Page 85 of the "**MAINTENANCE MANUAL AND INSTRUCTION BOOK.**"

**(11) INSTRUCTION BOOK.**

A "**MAINTENANCE MANUAL AND INSTRUCTION BOOK**" (Edition CM-16) has been compiled and published by us.

It is an eighty-eight page book with thirty-five illustrations and one copy is supplied free, upon application with each new motor cycle. Replacement copies are two shillings and sixpence each.

**(12) CORRESPONDENCE.**

Our routine is organised into different departments. Therefore delay cannot be avoided if matters relating to more than one department are contained in one letter.

Consequently when communicating with more than one department it is desirable to do so on SEPARATE SHEETS. Each sheet should bear the sender's name and address. **IN PARTICULAR,** requests for TECHNICAL ADVICE should not be on the same sheets as ORDERS FOR SPARE PARTS.

MATCHLESS MOTOR CYCLES,  
PLUMSTEAD, LONDON, S.E.18.

---

**NOTE**

The numbers, in brackets, that appear in the "Description" columns relate to the numbered foot notes regarding items so specially indicated.

The quantities per machine of each item are entered in the "Qty." columns. "R" indicates as may be required.

The illustrations are not to scale and are not necessarily accurate in detail.

Some items are not illustrated.

WHEN IN DOUBT REGARDING THE NAMES AND PART  
NUMBERS OF THE PARTS YOU REQUIRE, PLEASE SEND  
THE OLD PARTS TO SERVE AS PATTERNS.

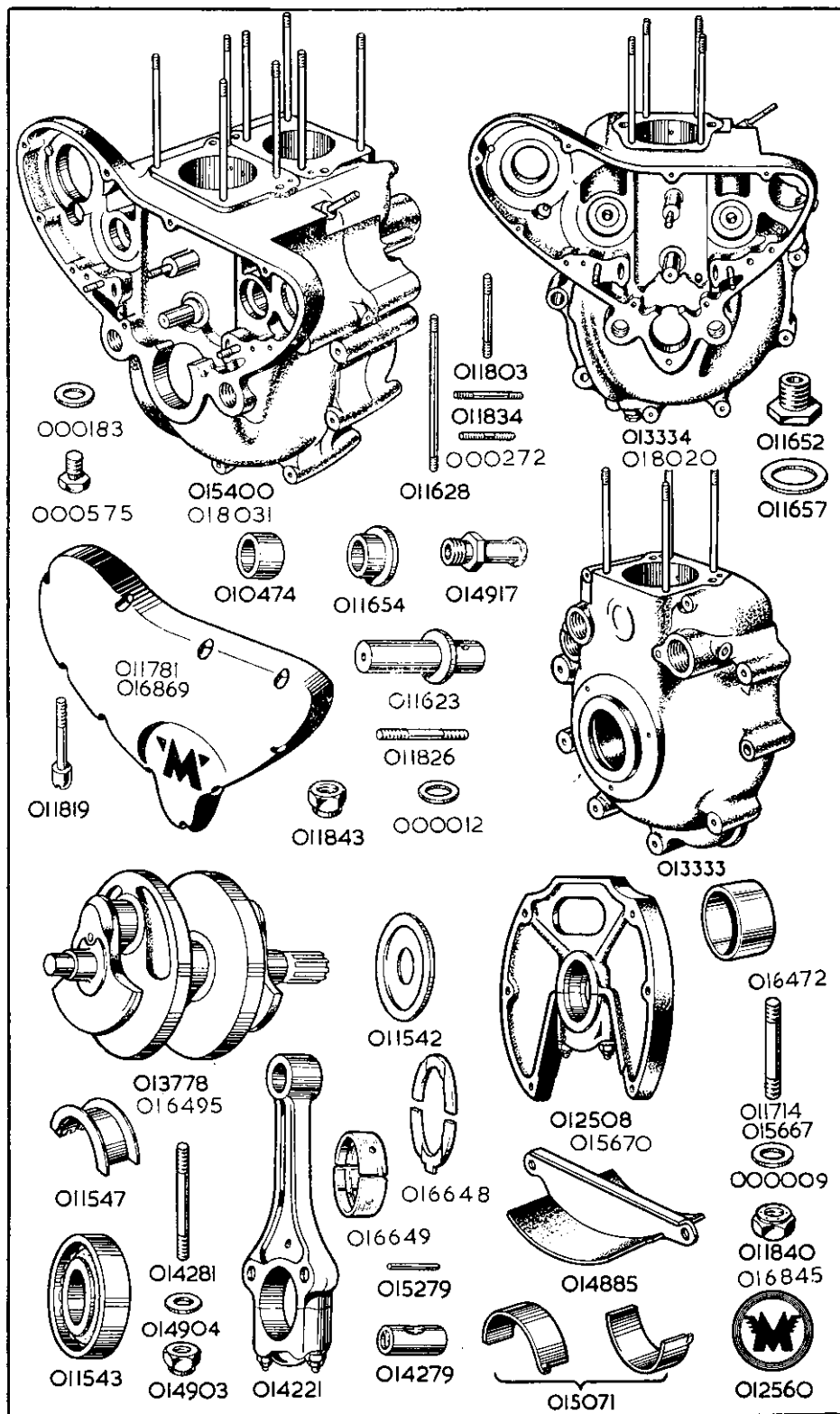

PART NUMBER	DESCRIPTION	QTY. OFF	PRICE EACH £ s. d.
<b>CRANKCASE</b>			
015400	... Crankcase, complete (1). Used on engines up to 5966	1	...
018031	... Crankcase, complete (1). Used on engines after 5966	1	...
013333	... Crankcase, driving side only (2)	1	...
013334	... Crankcase, timing side only (3). Used on engines up to 5966	1	...
018020	... Crankcase, timing side only (3). Used on engines after 5966	1	...
012508	... Web, centre, with cap, studs, washers and nuts (no bearing). Used on engines up to 5966	1	...
015670	... Web, centre, with cap, studs, washers and nuts (no bearing and thrust washers). Used on engines after 5966	1	...
014885	... Deflector, oil, for crankcase. Used on engines up to 5966	1	...
011781	... Cover, for timing gear. Used on engines up to 5966	1	...
016869	... Cover, for timing gear. Used on engines after 5966	1	...
012560	... Badge, monogram, for driving side crankcase	1	...
011826	... Stud, fixing centre web, $1\frac{1}{2}$ in. by $\frac{1}{4}$ in. by 26 and 20	6	...
000012	... Washer, plain, for centre web top fixing studs (same as STD.12)	2	...
000012	... Washer, plain, for centre web centre fixing studs (same as STD.12)	2	...
000012	... Washer, plain, for centre web bottom fixing studs (same as STD.12). Used on engines after 5966	2	...
011843	... Nut, for centre web fixing studs	6	...
011714	... Stud, for centre web bearing cap, $2\frac{1}{16}$ ins. by $\frac{7}{16}$ in. by 18 and 18. Used on engines up to 5966	2	...
015667	... Stud, for centre web bearing cap, $2\frac{1}{16}$ ins. by $\frac{3}{8}$ in. by 20 and 20. Used on engines after 5966	2	...
000009	... Washer, plain, for centre web bearing cap stud (same as STD.9). Used on engines up to 5966	2	...
000010	... Washer, plain, for centre web bearing cap stud (same as STD.10). Used on engines after 5966	2	...
011840	... Nut, for centre web bearing cap stud. Used on engines up to 5966	2	...
016845	... Nut, for centre web bearing cap stud. Used on engines after 5966	2	...
011628	... Stud, in driving side crankcase, for cylinder and head, $5\frac{7}{16}$ ins. by $\frac{5}{16}$ in. by 26 and 22	4	...
011628	... Stud, in timing side crankcase, for cylinder and head, $5\frac{7}{16}$ ins. by $\frac{5}{16}$ in. by 26 and 22	4	...
011834	... Stud, in timing side crankcase, for pump carrying plate, $1\frac{1}{8}$ in. by $\frac{5}{16}$ in. by 26 and 22	3	...
000272	... Stud, in timing side crankcase, for fixing magneto, $1\frac{1}{2}$ in. by $\frac{5}{16}$ in. by 26 and 22 (same as STD.272)	2	...
011803	... Stud, in timing side crankcase, for dynamo strap, $1\frac{1}{8}$ in. by $\frac{1}{4}$ in. by 26 and 20	1	...
011623	... Shaft, in timing side crankcase, for intermediate gear	1	...
000575	... Plug, drain, for timing side crankcase (same as STD.575)	1	...
000183	... Washer, fibre, for crankcase drain plug (same as STD.183)	1	...
011819	... Screw, retaining timing gear cover	10	...
011652	... Adaptor, to accommodate oil feed and return pipe retaining banjo pins. (Screws into timing side crankcase)	2	...
011657	... Washer, fibre, for banjo pin adaptors	2	...
014917	... Union, to accommodate crankcase release valve pipe. (Screws into driving side crankcase)	1	...
000183	... Washer, fibre, for crankcase release valve pipe union (same as STD.183)	1	...
010474	... Bush, plain, for camshafts. (In driving side crankcase)	2	...
011654	... Bush, flanged, for camshafts. (In timing side crankcase)	4	...
016472	... Tunnel, for camshaft chamber (fits between crankcase halves)	2	...

1.—Includes:—Driving crankcase. Timing crankcase, centre web with studs (no bearing, washers and oil deflector). Bushes for camshafts. Cylinder studs. Shaft for intermediate gear. Studs for pump plate. Two magneto studs. Dynamo strap stud. Timing gear cover and screws. Monogram badge. Three bolts. One stud. Two nuts. Five washers.

2.—Includes:—Two camshaft bushes. Four cylinder studs. Six studs for centre web. (No badge.)

3.—Includes:—Four camshaft bushes. Four cylinder studs. Shaft for intermediate gear. Three studs for pump plate. Two studs for magneto. One stud for dynamo strap. (No timing gear cover and screws.)

PART NUMBER	DESCRIPTION	QTY. OFF	PRICE EACH £ s. d.
----------------	-------------	-------------	--------------------------

### CRANKSHAFT, CONNECTING RODS AND BEARINGS

013778	... Crankshaft, plugged, but bare. Used on engines up to 5966	1	...
016495	... Crankshaft, plugged, but bare. Used on engines after 5966	1	...
011542	... Washer, for crankshaft	2	...
011547	... Bearing, plain, for centre bearing (in halves). Used on engines up to 5966	per pair	1
016649	... Bearing, plain, for centre bearing (in halves). Used on engines after 5966	per pair	1
016648	... Washer, thrust, for centre bearing. Used on engines after 5966	2	...
011543	... Bearing, roller, for crankshaft. (Parts of this bearing not sold separately), $1\frac{3}{4}$ in. internal, 3 ins. external, $\frac{1}{16}$ in. wide. Manufacturers part number RLS-12 $\frac{1}{2}$	2	...
014221	... Rod, connecting, assembly. (No big end bearing)	2	...
014281	... Stud, for connecting rod, $2\frac{3}{4}$ ins. by $\frac{5}{16}$ in. by 26	4	...
014279	... Trunnion, for connecting rod	4	...
015279	... Rivet, locating connecting rod stud	4	...
014904	... Washer, plain, for connecting rod stud	4	...
014903	... Nut, for connecting rod stud	4	...
015071	... Bearing, plain, for connecting rod. (Big-end) in halves	per pair	2

*The following undersize bearings (in pairs) can be supplied. It is necessary to have the journals ground to suit.*

015072	... Bearing, plain, for centre bearing, .010 in. Undersize	1	...
	<i>Only used on engines up to 5966.</i>		
016670	... Bearing, plain, for centre bearing, .010 in. Undersize	1	...
	<i>Only used on engines after 5966.</i>		
015402	... Bearing, plain, for connecting rod, .010 in. Undersize	2	...

### CYLINDERS, PISTONS, HEADS AND VALVES

011713	... Cylinder	2	...
011716	... Washer, paper, for cylinder base	2	...
015518	... Piston, bare, normal size	2	...
015803	... Piston, bare, .020 in. oversize	2	...
018024	... Piston, bare, .040 in. oversize	2	...
015804	... Piston, complete, normal size	2	...
015805	... Piston, complete, .020 in. oversize	2	...
018025	... Piston, complete, .040 in. oversize	2	...

*The above complete pistons include:—*

*Piston, two compression rings, one scraper ring.*

*Gudgeon pin, two circlips for gudgeon pin.*

010631	... Ring, compression, normal size	4	...
015522	... Ring, compression, .020 in. oversize	4	...
016441	... Ring, compression, .040 in. oversize	4	...
010632	... Ring, scraper, normal size	2	...
015523	... Ring, scraper, .020 in. oversize	2	...
016442	... Ring, scraper, .040 in. oversize	2	...
011731	... Pin, gudgeon	2	...
014283	... Circlip, for gudgeon pin	4	...
015121	... Head, for cylinder, bare, left	1	...
015122	... Head, for cylinder, bare, right	1	...
015526	... Head, for cylinder, with valve guides, guide circlips and manifold studs, left	1	...
015527	... Head, for cylinder, with valve guides, guide circlips and manifold studs, right	1	...
	<i>The above heads are only used on engines up to 5966.</i>		
016592	... Head, for cylinder, bare, left	1	...
016593	... Head, for cylinder, bare, right	1	...
018035	... Head, for cylinder, with valve guides, guide circlips and manifold studs, left	1	...
018036	... Head, for cylinder, with valve guides, guide circlips and manifold studs, right	1	...
	<i>The above heads are only used on engines after 5966.</i>		

PART NUMBER	DESCRIPTION	QTY. OFF	PRICE EACH £ s. d.
----------------	-------------	-------------	--------------------------

### CYLINDERS, PISTONS, HEADS AND VALVES—continued.

011715	... Gasket, for cylinder head .....	2	...
014163	... Valve, inlet .....	2	...
014165	... Valve, exhaust .....	2	...
011770	... Spring, inner, for valve .....	4	...
011769	... Spring, outer for valve .....	4	...
014169	... Seat, for valve springs.....	4	...
014168	... Collar, for valve springs .....	4	...
014167	... Collet, for valve stems (in pairs) .....	4	...
014170	... Guide, for inlet valves .....	2	...
014171	... Guide, for exhaust valves .....	2	...
011111	... Circlip, locating valve guides.....	4	...
011635	... Nut, retaining cylinders and heads .....	8	...
011634	... Spacer, $\frac{3}{8}$ in. long for head retaining nuts.....	8	...
000011	... Washer, plain, for head retaining nuts (same as STD.11) .....	8	...
010625	... Stud, retaining inlet manifold, $1\frac{1}{16}$ in. by $\frac{1}{4}$ in. by 26 and 20 .....	4	...

### RE-BORING

Cylinders may be re-bored to .020 in. or .040 in. oversize and pistons (with rings) supplied to suit. The charge is for the pair, with an additional if new gudgeon pins and circlips are also supplied. Cylinders sent for re-boring should be packed in stout cases which will be used by us for their return. Carriage is additional.

If a complete machine, or engine, is sent to us for cylinder re-boring, there will be an additional charge, according to the time taken, for dismantling and assembly.

### TIMING GEAR

011784	... Camshaft, inlet.....	1	...
011785	... Camshaft, exhaust .....	1	...
011620	... Gear, on camshaft, 60 teeth .....	2	...
000573	... Key, locating camshaft gears (same as STD.573) .....	2	...
011653	... Nut, retaining camshaft gears .....	2	...
016209	... Pinion, on crankshaft, 30 teeth .....	1	...
016210	... Spacer, $\frac{7}{8}$ in. long, for crankshaft pinion .....	1	...
000573	... Key, locating crankshaft pinion (same as STD.573) .....	1	...
011776	... Bolt, retaining crankshaft pinion, threaded $\frac{1}{2}$ in. by 20 .....	1	...
010589	... Washer, plain, for crankshaft pinion bolt .....	1	...
011621	... Gear, intermediate, with bush, 60 teeth .....	1	...
015278	... Bush, for intermediate gear .....	1	...
014154	... Follower, for camshaft .....	4	...
011626	... Spindle, for camshaft followers .....	2	...
011627	... Spacer, $1\frac{3}{4}$ in. long between camshaft followers .....	2	...

### ROCKERS AND PUSH RODS

014284	... Rocker, with bushes (left inlet and right exhaust) .....	2	...
014285	... Rocker with bushes (right inlet and left exhaust) .....	2	...
014222	... Spindle for rockers .....	4	...
014226	... Washer, spring, double coil, for rocker spindle .....	4	...
014275	... Washer, plain, for either side of rocker spindle spring washer ...	8	...
014275	... Washer, plain, for clamping end of rocker spindle .....	4	...
011760	... Bolt, clamping rocker spindle. (Thread No. 2 B.A.) .....	4	...
015021	... Washer, plain, for rocker spindle clamping bolt .....	4	...
011846	... Nut, for rocker spindle clamping bolt .....	4	...
014245	... Bush, for rockers. (Two in each rocker) .....	8	...
014381	... Cover, for rockers .....	4	...
014411	... Gasket, for rocker covers .....	4	...
014412	... Bolt, short head, retaining rocker covers, 2 B.A. by $1\frac{1}{8}$ in. under head .....	8	...
014413	... Bolt, long head, retaining rocker covers, 2 B.A. by $1\frac{1}{8}$ in. under head .....	8	...
014120	... Rod, push, assembled with ends .....	4	...
014116	... Rod, push, bare .....	4	...
014115	... End, upper, for push rod .....	4	...
014114	... End, lower, for push rod .....	4	...

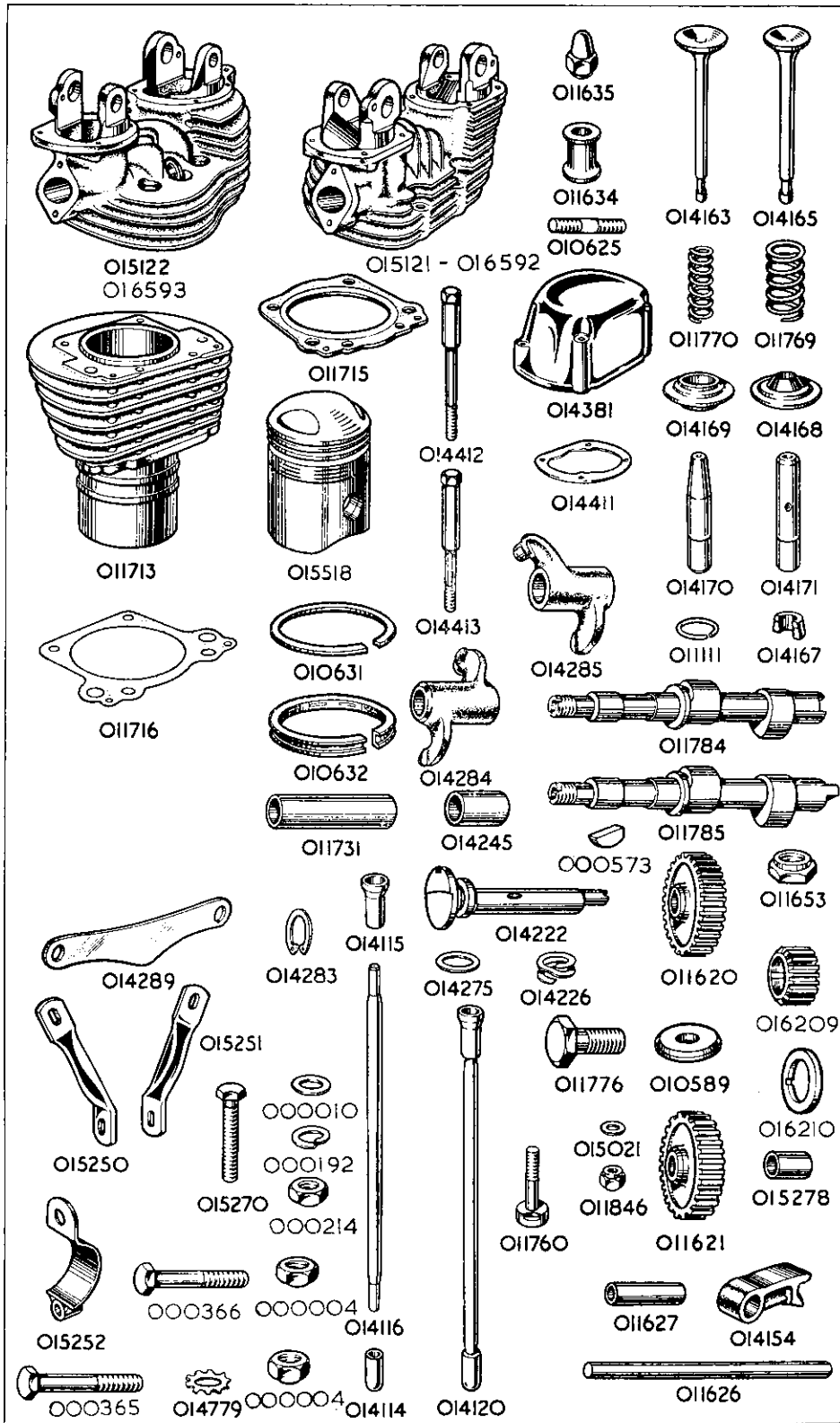

PART NUMBER	DESCRIPTION	QTY. OFF	PRICE EACH £ s. d.
----------------	-------------	-------------	--------------------------

### ENGINE STEADY STAY

015250	... Stay, engine steady, right side .....	1	...
015251	... Stay, engine steady, left side .....	1	...
015252	... Clip, half, only, on frame tube, for steady stay .....	2	...
000365	... Bolt, securing fronts of steady stay frame clips $1\frac{1}{8}$ in. by $\frac{5}{16}$ in. by 26 (same as STD.365) .....	1	...
014779	... Washer, lock, for steady stay frame clip front bolt .....	1	...
000004	... Nut, for steady stay frame clip front bolt (same as STD.4) .....	1	...
000366	... Bolt, securing steady stays and frame clips, $1\frac{1}{4}$ in. by $\frac{5}{16}$ in. by 26 (same as STD.366) .....	1	...
000004	... Nut, for steady stays and frame clip securing bolt (same as STD.4) ...	1	...
014289	... Plate, tie, for cylinder heads and steady stays .....	1	...
015270	... Bolt, retaining steady stays and tie plate to head, $1\frac{1}{4}$ in. by $\frac{5}{16}$ in. by 22	2	...
000010	... Washer, plain, under heads of tie plate bolts (same as STD.10) ...	2	...
000192	... Washer, spring, for tie plate bolts (same as STD.192) .....	2	...
000214	... Nut, for tie plate bolts (same as STD.214) .....	2	...

### OIL PUMPS

*The following parts are only used on engines up to 5966*

013345	... Oil pumps complete, assembled on carrying plate (4) .....	1	...
015017	... Plate, carrying oil pumps, bare (5) .....	1	...
011842	... Nut, securing pump carrying plate, to timing side crankcase .....	3	...
000011	... Washer, plain, for pump carrying plate fixing nuts (same as STD.11) ...	3	...
000021	... Ball, $\frac{3}{8}$ in. steel, for return pump bleed valve (same as STD.21) .....	1	...
000701	... Spring, for return pump bleed valve ball (same as STD.701) .....	1	...
015001	... Screw, securing return pump bleed valve spring. (Grub screw, $\frac{1}{4}$ in. long by $\frac{5}{16}$ in. by 22) .....	1	...
012333	... Body, oil feed pump, for $\frac{1}{4}$ in. gears .....	1	...
012336	... Gear, driving, for oil feed pump, $\frac{1}{4}$ in. wide .....	1	...
012337	... Gear, driven, for oil feed pump, $\frac{1}{4}$ in. wide .....	1	...
011554	... Plate, end, for oil feed pump .....	1	...
011556	... Pin, dowel, locating oil feed pump end plate .....	1	...
011617	... Washer, paper, between oil feed pump and carrying plate .....	1	...
000453	... Screw, retaining oil feed pump to carrying plate, 1 in. by 2 B.A. (same as STD.453) .....	3	...
011553	... Body, oil return pump, for $\frac{3}{8}$ in. gears .....	1	...
011559	... Gear, driving, for oil return pump, $\frac{3}{8}$ in. wide .....	1	...
011560	... Gear, driven, for oil return pump, $\frac{3}{8}$ in. wide .....	1	...
011554	... Plate, end, for oil return pump .....	1	...
011556	... Pin, dowel, locating oil return pump end plate .....	1	...
011617	... Washer, paper, between oil return pump and carrying plate .....	1	...
000453	... Screw, retaining oil return pump to carrying plate, 1 in. by 2 B.A. (same as STD.453) .....	3	...

NOTE 4.—Includes all the items listed above except the three 011842 and 000011 fixing nuts and washers.

NOTE 5.—Includes the 000021, 000701 and 015001 bleed valve ball, spring and retaining grub screw.

### OIL PUMPS

*The following parts are only used on engines after 5966.*

018037	... Oil pumps, complete, assembled on carrying plate (6) .....	1	...
015017	... Plate, carrying, oil pumps, bare (7) .....	1	...
011842	... Nut, securing pump carrying plate to timing side crankcase .....	3	...
000011	... Washer, plain, for pump carrying plate fixing nuts (same as STD.11) ...	3	...
000021	... Ball, $\frac{3}{8}$ in. steel, for return pump bleed valve (same as STD.21) .....	1	...
000701	... Spring, for return pump bleed valve ball (same as STD.701) .....	1	...
015001	... Screw, securing return pump bleed valve spring. (Grub screw $\frac{1}{4}$ in. long by $\frac{5}{16}$ in. by 22) .....	1	...
016137	... Gasket, oval, behind pump carrying plate .....	2	...
016138	... Gasket, round, behind pump carrying plate .....	1	...
015568	... Body, oil feed pump, for $\frac{1}{4}$ in. gears with $\frac{7}{16}$ in. shaft .....	1	...
015599	... Pin, dowel, for oil feed pump .....	2	...

PART NUMBER	DESCRIPTION	QTY. OFF	PRICE EACH £ s. d.
----------------	-------------	-------------	--------------------------

#### **OIL PUMPS—continued.**

015576	... Plate, front end, for oil pump feed body .....	1	...
015573	... Plate, back end, for oil pump feed body .....	1	...
011617	... Washer, paper, between oil feed pump and carrying plate.....	1	...
000453	... Screw, retaining oil feed pump to carrying plate. 1 in. by 2 B.A. (same as STD.453) .....	3	...
015579	... Gear, driving, for oil feed pump, $\frac{1}{4}$ in. wide. $\frac{7}{16}$ in. shaft .....	1	...
015580	... Gear, driven, for oil feed pump, $\frac{1}{4}$ in. wide. $\frac{7}{16}$ in. shaft .....	1	...
015567	... Body, oil return pump, for $\frac{3}{8}$ in. gears with $\frac{7}{16}$ in. shaft .....	1	...
015599	... Pin, dowel, for oil return pump .....	2	...
015576	... Plate, front end, for oil pump return body .....	1	...
015573	... Plate, back end, for oil pump return body .....	1	...
011617	... Washer, paper, between oil return pump and carrying plate .....	1	...
000453	... Screw, retaining oil return pump to carrying plate. 1 in. by 2 B.A. (same as STD.453) .....	3	...
015577	... Gear, driving, for oil return pump, $\frac{3}{8}$ in. wide. $\frac{7}{16}$ in. shaft .....	1	...
015578	... Gear, driven, for oil return pump, $\frac{3}{8}$ in. wide. $\frac{7}{16}$ in. shaft .....	1	...

NOTE 6.—Includes all the items listed above except the three 011842 and 000011 fixing nuts and washers.

NOTE 7.—Includes the 000021, 000701 and 015001 bleed valve ball, spring and retaining grub screw.

#### **OIL FELT FILTER (IN ENGINE)**

014235	... Filter, felt, for engine crankcase .....	1	...
014239	... Seat, for oil felt filter .....	1	...
014240	... Valve, relief, for oil felt filter .....	1	...
014241	... Spring, for oil felt filter relief valve .....	1	...
016179	... Cap, for felt filter housing (also accommodates oil non-return valve) .....	1	...
012116	... Washer, fibre, for filter housing cap .....	1	...
011645	... Ball, $\frac{3}{8}$ in. steel, for non-return valve .....	1	...
013564	... Spring, for non-return valve ball .....	1	...
013332	... Plug, screwed, retaining non-return valve spring .....	1	...
000183	... Washer, fibre, for non-return valve spring plug (same as STD.183) .....	1	...
015034	... Gasket, paper, for oil filter chamber (fits between the two crank- case halves) .....	1	...

#### **OIL DISTRIBUTOR. (Driven by the left hand end of exhaust camshaft)**

014246	... Distributor, oil .....	1	...
014247	... Cap, housing, for oil distributor .....	1	...
011642	... Washer, fibre, for oil distributor housing cap .....	1	...

#### **OIL RELIEF VALVE. (Located in Timing side crankcase, close to oil feed pump)**

016056	... Body, for oil relief valve .....	1	...
000183	... Washer, fibre, for relief valve body (same as STD.183) .....	1	...
016057	... Piston, for oil relief valve body .....	1	...
016058	... Spring, for oil relief valve piston .....	1	...
012019	... Plug, retaining relief valve spring.....	1	...
000200	... Washer, fibre, for relief valve plug (same as STD.200) .....	1	...
016176	... Seal, rubber, for oil relief valve .....	1	...
016177	... Tube, metal centre, for relief valve rubber seal .....	1	...

#### **CRANKCASE RELEASE VALVE**

014248	... Valve, crankcase release .....	1	...
011648	... Cap, housing, for crankcase release valve .....	1	...
011642	... Washer, fibre, for crankcase release valve housing cap .....	1	...

**MAINTENANCE MANUAL** EDITION CM-16 PRICE **2/6**  
IS THE APPROPRIATE MANUAL FOR THIS SPARES LIST

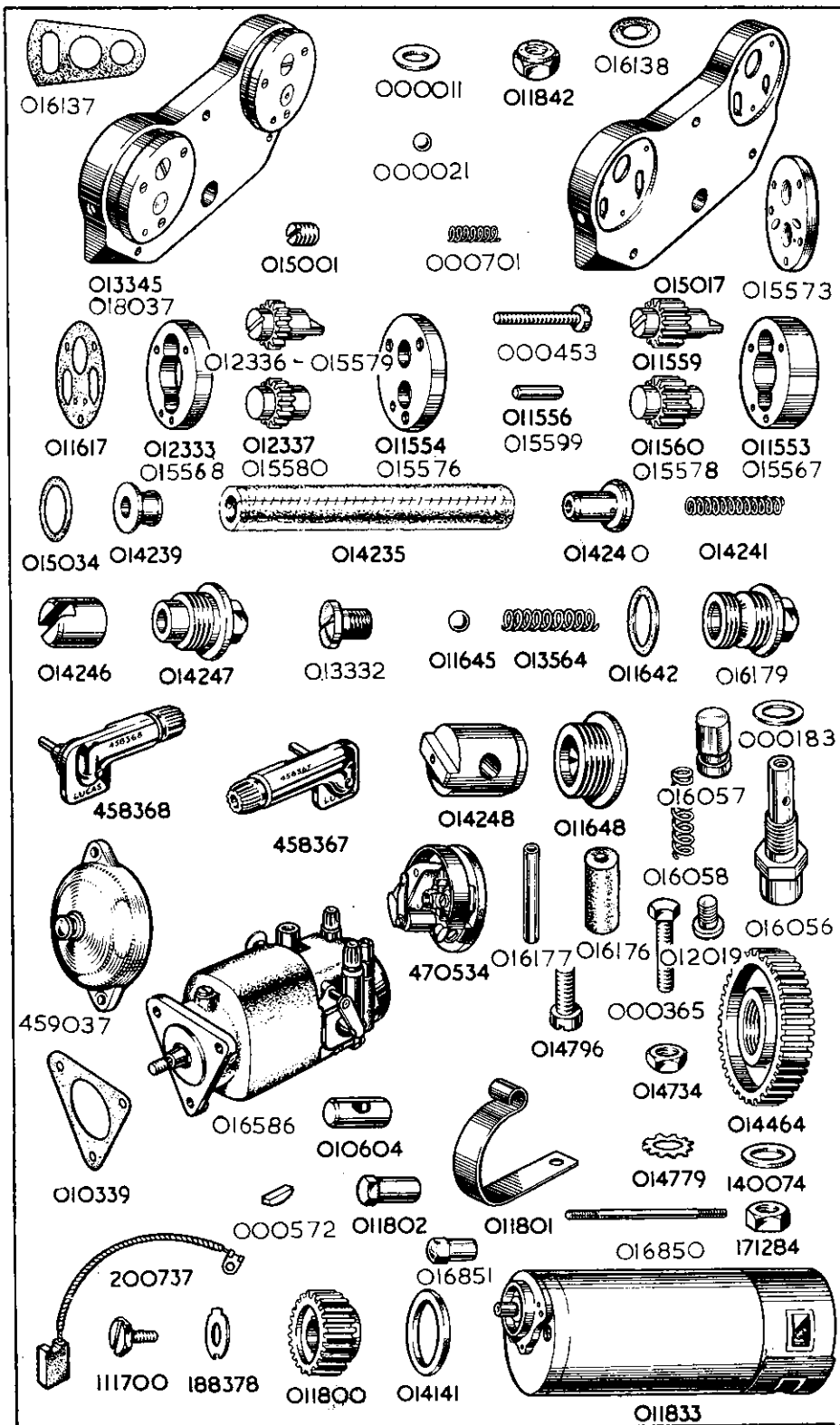

PART NUMBER	DESCRIPTION	QTY. OFF	PRICE EACH £ s. d.
----------------	-------------	-------------	--------------------------

### CARBURETTER

014288	... Carburetter, complete (less wires and levers) Type 76AG/1AU	1	...
011633	... Manifold, inlet, bare (no studs). (The studs are listed with cylinder heads).....	1	...
000012	... Washer, plain, for inlet manifold retaining studs (same as STD.12).....	4	...
000005	... Nut, for inlet manifold retaining studs (same as STD.5) .....	4	...
011771	... Gasket, between inlet manifold and cylinder heads .....	2	...
016724	... Bolt, retaining carburettor to inlet manifold, $4\frac{7}{8}$ ins. by $\frac{5}{8}$ in. by 22	2	...
000011	... Washer, plain, for carburetter retaining bolts (same as STD.11) ...	2	...
000581	... Gasket, between carburetter and inlet manifold .....	1	...

### FLOAT CHAMBER

64-192-B	... Chamber, float, bare .....	1	...
13-153	... Screw, plug, blocking passage in float chamber .....	1	...
14-039	... Washer, fibre, for float chamber passage plug screw .....	1	...
14-208	... Top, or cover, for float chamber (same as 14-208-B) .....	1	...
14-021	... Screw, locking float chamber top.....	1	...
14-015	... Float, bare.....	1	...
14-024	... Needle, for float .....	1	...
14-209	... Tickler, bare.....	1	...
14-210	... Stop, for tickler .....	1	...
14-032	... Spring, for tickler .....	1	...
14-289	... Cotter (split pin), for tickler .....	1	...
14-035	... Banjo, connection, for petrol pipe .....	1	...
14-175	... Washer, fibre, upper, for petrol banjo connection .....	1	...
14-037	... Washer, fibre, lower, for petrol banjo connection .....	1	...
14-036	... Nut, retaining banjo connection to float chamber .....	1	...

### MIXING BODY

76-014	... Body, mixing, bare .....	1	...
6-033	... Nut, union, for base of mixing body .....	1	...
6-040	... Washer, fibre, for mixing body union nut .....	1	...
4-043	... Bolt holding float chamber to mixing body .....	1	...
4-053	... Washer, fibre, for float chamber holding bolt .....	2	...
6-038	... Intake, air (same as 206-038-R) .....	1	...
6-032	... Top, for mixing chamber (same as 6-032-B) .....	1	...
6-031	... Ring, fixing top to mixing chamber.....	1	...
4-235	... Clip, locking mixing chamber top fixing ring .....	1	...
4-241	... Screw, securing locking clip to mixing body top .....	1	...
4-035	... Adjuster, for control cable, throttle or air .....	2	...

### CHOKE AND JETS

6-058	... Choke, or jet barrel .....	1	...
4-061	... Needle jet.....	1	...
4-042-180	... Jet, main, size 180 .....	1	...
6-065	... Needle, taper, for needle jet.....	1	...
4-230	... Clip, for jet taper needle .....	1	...
4-060	... Pin, split, locating taper needle clip.....	1	...
13-129	... Screw, for pilot jet air adjustment .....	1	...
4-206	... Nut, lock, for pilot jet air screw (same as 16-010) .....	1	...
The following alternative main jets can be supplied.			
4-042-160	... Jet, main, size 160 .....	1	...
4-042-170	... Jet, main, size 170 .....	1	...
4-042-190	... Jet, main, size 190 .....	1	...

BY USING GENUINE SPARES YOU ARE ASSURED THEY  
WILL FIT ACCURATELY AND GIVE SATISFACTORY SERVICE

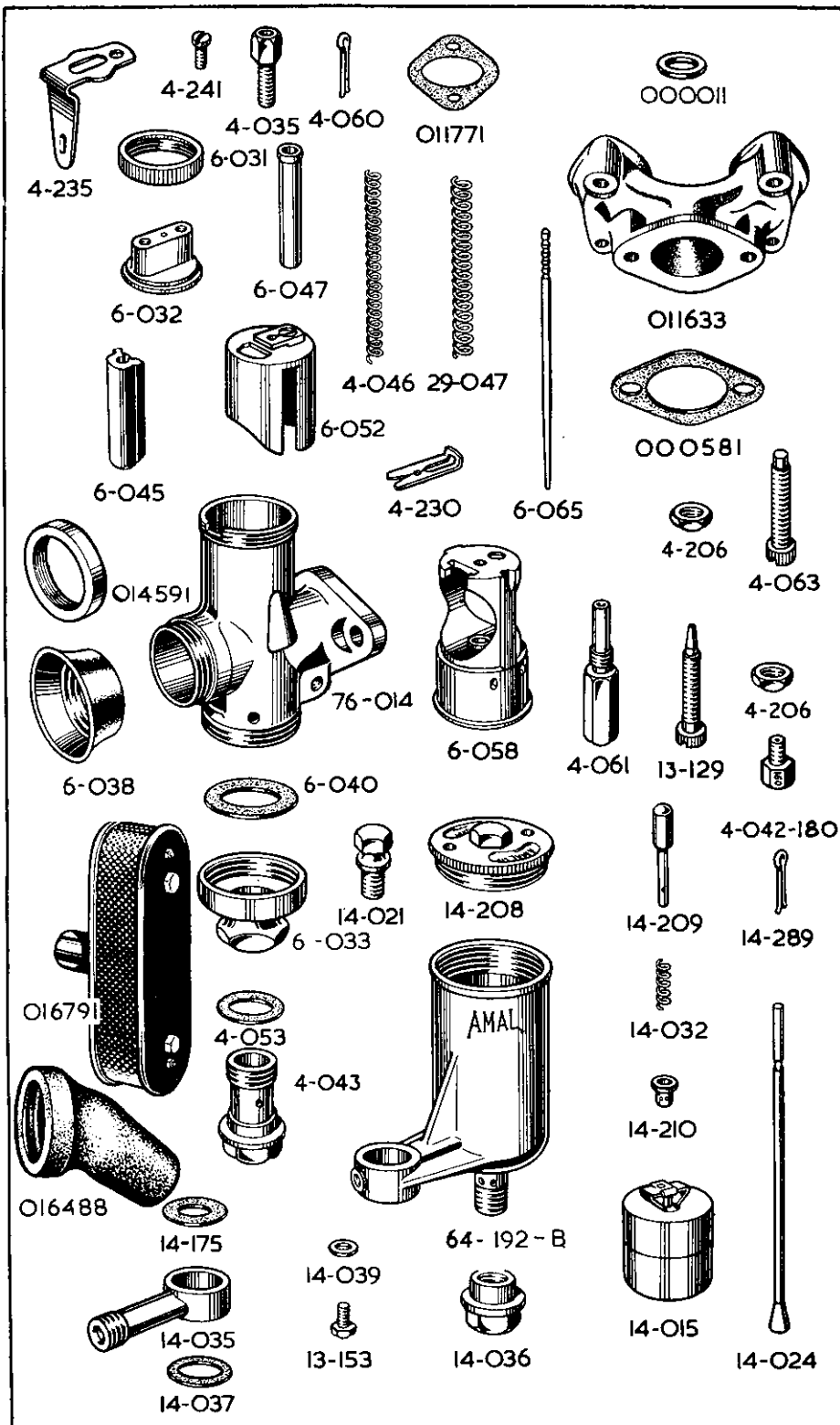

PART NUMBER	DESCRIPTION	QTY. OFF	PRICE EACH £ s. d.
----------------	-------------	-------------	--------------------------

### VALVES (CARBURETTER)

6-052	... Valve, throttle, size 6/3 .....	1	...
29-047	... Spring, for throttle valve .....	1	...
4-063	... Screw, stop, for throttle valve .....	1	...
4-206	... Nut, lock, for throttle valve stop screw (same as 16-010) .....	1	...
6-045	... Valve, air .....	1	...
6-047	... Guide, tubular, for air valve spring .....	1	...
4-046	... Spring, for air valve .....	1	...

### AIR CLEANER. (This is optional extra equipment)

016791	... Cleaner, air .....	1	...
014591	... Adaptor, for air cleaner (screws on carburetter) .....	1	...
016488	... Sleeve, rubber, connecting air cleaner to carburetter adaptor .....	1	...
016983	... Set of air cleaner elements comprising filter element and two fabric end gaskets .....	1	...

When an air cleaner is fitted it is essential to:—

(a) Use an adaptor and connector in order to fit the cleaner to carburetter intake. (016791 does not include these.)

(b) Fit a smaller jet, viz., use jet 4-042-160 (size 160), price

### MAGNETO

016586	... Magneto, complete, Type K2F (Lucas number 42230-A) .....	1	...
458367	... Pick-up, with brush and spring, right .....	1	...
458368	... Pick-up, with brush and spring, left .....	1	...
470534	... Contact breaker, complete .....	1	...
470609	... Contact set .....	1	...
459037	... Cover, for contact breaker with switch .....	1	...
010339	... Gasket, for magneto flange .....	1	...
000365	... Bolt, retaining magneto, $1\frac{1}{8}$ in. by $\frac{5}{16}$ in. by 26 (same as STD.365) .....	1	...
For the two magneto retaining studs, see "Crankcase Group."			
014779	... Washer, lock, for magneto retaining bolt and studs .....	3	...
014734	... Nut, for magneto retaining bolt and studs .....	3	...
014464	... Gear, on magneto shaft .....	1	...
140074	... Washer, plain, on magneto shaft .....	1	...
171284	... Nut, on magneto shaft, retaining magneto driving gear .....	1	...

### DYNAMO

011833	... Dynamo, Type E3-L-LI-0 (Lucas Number 20009) .....	1	...
200737	... Brush, for dynamo, set of two, per set .....	1	...
014141	... Gasket, between dynamo and crankcase .....	1	...
011801	... Strap, retaining dynamo to crankcase .....	1	...
014796	... Screw, retaining lower end of dynamo strap to crankcase, $\frac{7}{16}$ in. by $\frac{1}{4}$ in. by 20 .....	1	...
000012	... Washer, plain, for dynamo strap retaining screw (same as STD.12) .....	1	...
010604	... Crosshead, in eye of dynamo retaining strap .....	1	...
011802	... Nut, tensioning dynamo strap. (The stud on which this nut screws, is listed with the crankcase parts) .....	1	...
000012	... Washer, plain, for dynamo strap tensioning nut (same as STD.12) .....	1	...
011800	... Gear on Dynamo shaft .....	1	...
000572	... Key, locating dynamo shaft gear (same as STD.572) .....	1	...
111700	... Bolt, retaining gear on dynamo shaft .....	1	...
188378	... Washer, lock, for dynamo gear retaining bolt .....	1	...
000251	... Stud, drawing dynamo to crankcase, $1\frac{1}{8}$ in. long by 2 B.A. (same as STD.251). Only used on engines up to 5966 .....	1	...
011846	... Nut, for dynamo draw stud. Only used on engines up to 5966 .....	1	...
016850	... Stud, drawing dynamo to crankcase, and passing through timing cover, $2\frac{1}{2}$ ins. long by 2 B.A. Only used on engines after 5966 .....	1	...
016851	... Nut, for dynamo draw stud, only used on engines after 5966 .....	1	...

PART NUMBER	DESCRIPTION	QTY. OFF	PRICE EACH £ s. d.
<b>CRANKCASE BOLTS, with engine plates and all bolts passing through same.</b>			
014292	... Bolt, clamping crankcase throat, $3\frac{1}{8}$ ins. by $\frac{5}{16}$ in. by 22. (These bolts pass through the driving side crankcase and thread into the timing side crankcase) .....	3	...
000011	... Washer, plain, for 014292 crankcase bolts (same as STD.11) .....	3	...
013944	... Plate, engine front, right side .....	1	...
013943	... Plate, engine front, left side .....	1	...
014736	... Stud, passing through crankcase and upper holes in engine, front plates, 5 ins. by $\frac{5}{16}$ in. by 26. (This stud also supports the stays for the exhaust pipes) .....	1	...
000174	... Washer, plain, for 014736 engine plate stud (same as STD.174).....	2	...
000192	... Washer, spring, for 014736 engine plate stud (same as STD.192) ...	2	...
000004	... Nut, for 014736 engine plate stud (same as STD.4) .....	2	...
000278	... Stud, passing through crankcase and lower holes in engine front plates, $4\frac{3}{8}$ ins. by $\frac{5}{16}$ in. by 26 (same as STD.278) .....	1	...
000011	... Washer, plain, for 000278 engine plate stud (same as STD.11) .....	2	...
000004	... Nut, for 000278 engine plate stud (same as STD.278) .....	2	...
000277	... Stud, passing through crankcase at bottom, $4\frac{3}{8}$ ins. by $\frac{5}{16}$ in. by 26 (same as STD.277) .....	1	...
000011	... Washer, plain, for 000277 crankcase stud (same as STD.11) .....	2	...
000004	... Nut for 000277 crankcase stud (same as STD.4) .....	2	...
000303	... Stud, passing through front of main frame and top of engine front plate, $4\frac{1}{2}$ ins. by $\frac{3}{8}$ in. by 26 (same as STD.303) .....	1	...
000010	... Washer, plain, for 000303 frame stud (same as STD.10) .....	2	...
000003	... Nut, for 000303 frame stud (same as STD.3) .....	2	...
014911	... Stud, passing through main frame front tube bottom lug, the crankcase, and the front ends of the rear frame rails, $5\frac{1}{8}$ ins. by $\frac{5}{16}$ in. by 26 .....	1	...
000011	... Washer, plain, for 014911 frame stud (same as STD.11) .....	2	...
000004	... Nut, for 014911 frame stud (same as STD.4) .....	2	...
013942	... Plate, engine, rear .....	2	...
000278	... Stud, passing through top of engine rear plates and the crankcase, $4\frac{3}{8}$ ins. by $\frac{5}{16}$ in. by 26 (same as STD.278).....	1	...
000278	... Stud, passing through bottom of engine rear plates and the crankcase, $4\frac{3}{8}$ ins. by $\frac{5}{16}$ in. by 26 (same as STD.278) .....	1	...
000011	... Washer, plain, for 000278 studs (two per stud) (same as STD.11)...	4	...
000004	... Nut, for 000278 studs (two per stud) (same as STD.4) .....	4	...
000316	... Stud, passing through engine rear plates, rear of crankcase, and centre of front chaincase, $7\frac{7}{8}$ ins. by $\frac{7}{8}$ in. by 26. (Stud should be fitted so that the longer thread is on left-hand side of machine) (same as STD.316) .....	1	...
014084	... Spacer, $1\frac{1}{2}$ in. long, on 000316 stud, between back of front chaincase and crankcase .....	1	...
017142	... Spacer, $\frac{3}{8}$ in. long, on 000316 stud, inside front chaincase (same as 35-2-C29) .....	1	...
000220	... Nut, thin, on 000316 stud, inside front chaincase (same as STD.220) .....	1	...
000009	... Washer, plain, for 000316 stud (same as STD.9) .....	2	...
000166	... Washer, plain, thin, on 000316 stud .....	1	...
000002	... Nut, for 000316 stud (same as STD.2).....	2	...
000303	... Stud, passing through top of engine, rear plates, lower end of main frame seat tube and rear fork bridge, $4\frac{1}{2}$ ins. by $\frac{3}{8}$ in. by 26 (same as STD.303) .....	1	...
000003	... Nut, for 000303 stud (same as STD.3).....	2	...
000278	... Stud, passing through rear fork bridge and back ends of engine rear plates, $4\frac{3}{8}$ ins. by $\frac{5}{16}$ in. by 26 (same as STD.278) .....	1	...
	(The front chain adjusting eye bolt block screws on the right-hand end of this stud.)		
000011	... Washer, plain, for 000278 stud (same as STD.11) .....	1	...
000004	... Nut, for 000278 stud (same as STD.4).....	1	...

For the bolt stud passing through the top and bottom of the gear box and the engine rear plates, see " Gear Box Fixing Bolts ".

For the footrest rod, which passes through the bottoms of the engine rear plates and the frame rails, see " Footrests ".

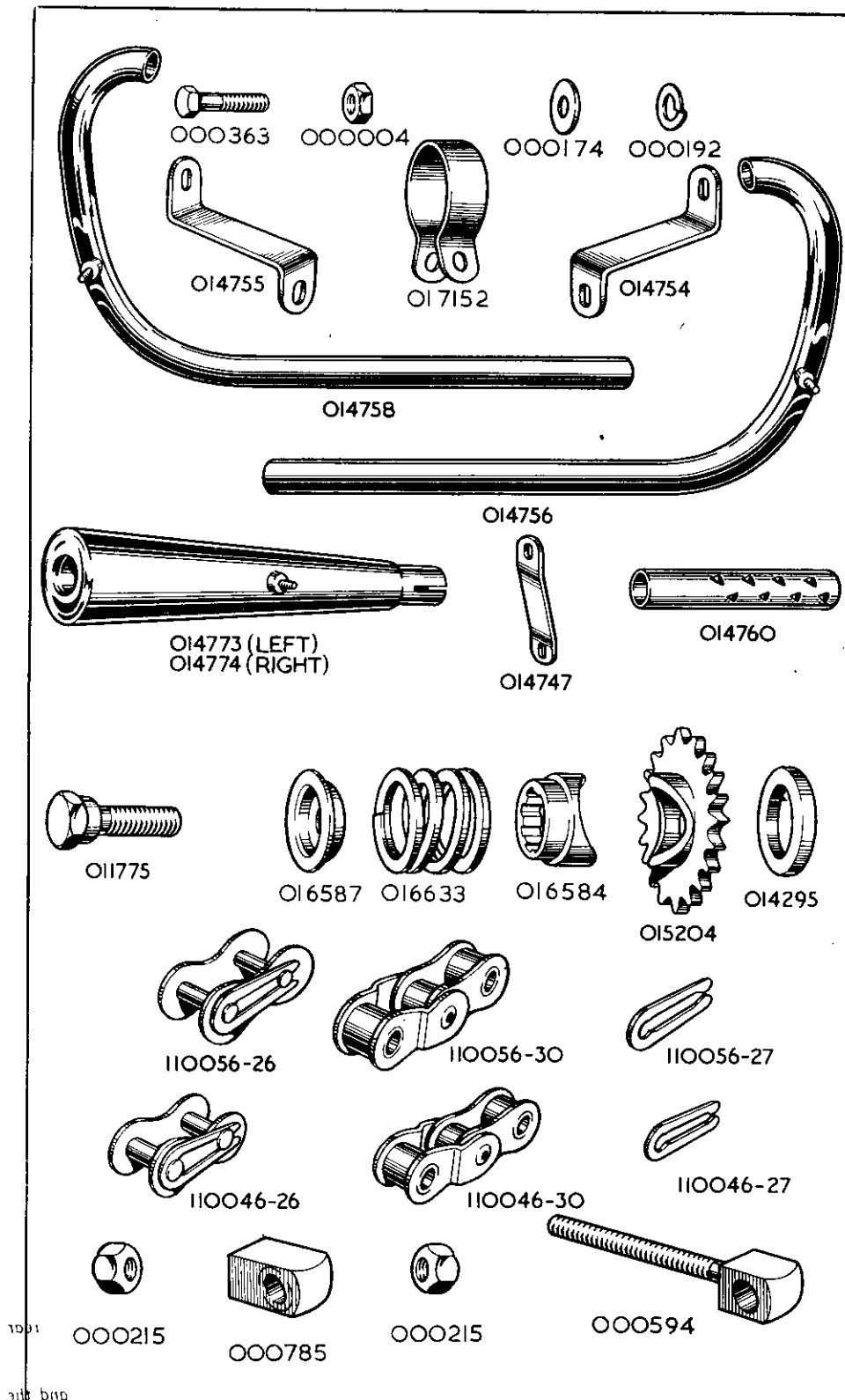

PART NUMBER	DESCRIPTION	QTY. OFF	PRICE EACH £ s. d.
----------------	-------------	-------------	--------------------------

## GASKETS

We supply engine gaskets, either as separate spares, or in complete sets.

Single gaskets, are listed in the groups to which they belong.

Gaskets in complete sets are listed below

015870	... Complete gasket set for vertical twin engine .....	1	...
015869	... Decarbonising gasket set for vertical twin engine .....	1	...

Each complete gasket set contains:—

- 1—000183 Washer, fibre, for crankcase, drain plug (same as STD.183)
- 1—000183 Washer, fibre, for crankcase, release valve pipe union (same as STD.183)
- 1—000183 Washer, fibre, for oil relief, valve plug (same as STD.183)
- 1—011642 Washer, fibre, for engine filter housing cap.
- 1—011642 Washer, fibre, for oil distributor housing cap.
- 1—011642 Washer, fibre, for crankcase release valve housing cap.
- 2—011657 Washer, fibre, for banjo pin adaptors in crankcase
- 1—000581 Gasket, between carburettor and inlet manifold (same as STD.581).
- 2—011617 Washer, paper, for oil pump bodies.
- 2—011716 Washer, paper, for cylinder bases.
- 1—015034 Washer, paper, for oil filter chamber.
- 1—010339 Gasket, between magneto and crankcase.
- 2—011715 Gasket, for cylinder head.
- 2—011771 Gasket, between inlet manifold and cylinder head.
- 1—014141 Gasket, between dynamo and crankcase.
- 4—014411 Gasket, for rocker covers.

Each decarbonising gasket set includes:—

- 2—011715 Gasket, for cylinder heads.
- 4—014411 Gasket, for rocker covers.
- 2—011771 Gasket, between inlet manifold and cylinder heads.
- 1—000581 Gasket, between carburettor and inlet manifold (same as STD.581).
- 2—011716 Washer, paper, for cylinder bases.

## EXHAUST PIPES AND SILENCERS

014756	... Pipe, exhaust, bare, left side .....	1	...
014758	... Pipe, exhaust, bare, right side .....	1	...
014760	... Baffle, for exhaust pipe .....	2	...
014754	... Stay, for exhaust pipe, left side .....	1	...
014755	... Stay, for exhaust pipe, right side .....	1	...
000004	... Nut, fixing exhaust pipe to stay (same as STD.4) .....	2	...
000174	... Washer, plain, for exhaust pipe fixing nut (same as STD.174) .....	2	...
014773	... Silencer, bare, left side .....	1	...
014774	... Silencer, bare, right side .....	1	...
017152	... Clip, clamping silencer to pipe (same as 20470) .....	2	...
000363	... Bolt, for silencer clip, $\frac{3}{8}$ in. by $\frac{5}{16}$ in. by 26 (same as STD.363) .....	2	...
000174	... Washer, plain, for silencer clip bolt (same as STD. 174) .....	2	...
000004	... Nut, for silencer, clip bolt (same as STD. 4) .....	2	...
014747	... Stay, for silencer .....	2	...
000004	... Nut, fixing silencer to stay (same as STD. 4).....	2	...
000174	... Washer, plain, for silencer to stay fixing nut (same as STD. 174) ...	2	...
000192	... Washer, spring, for silencer to stay fixing nut (same as STD. 192) ...	2	...
000004	... Nut, fixing silencer stay to frame rail (same as STD. 4) .....	2	...
000174	... Washer, plain, for silencer stay to frame rail nut (same as STD.174) ...	2	...

ALWAYS INCLUDE ALL THE LETTERS  
WHEN QUOTING THE ENGINE NUMBER

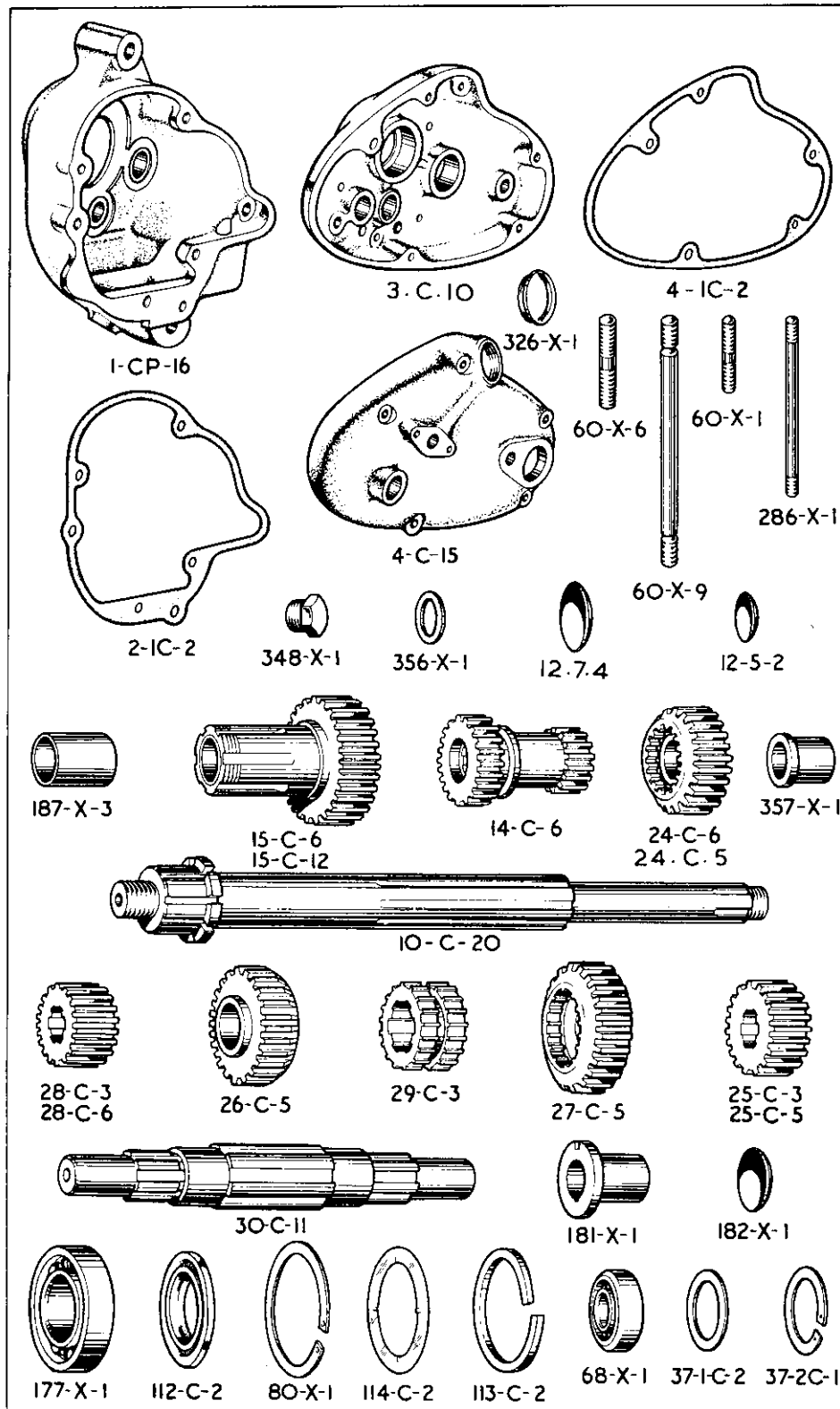

PART NUMBER	DESCRIPTION	QTY. OFF	PRICE EACH		
			£	s.	d.

## ENGINE SPROCKETS

015203	... Sprocket engine, bare, 19 teeth	1	...		
015204	... Sprocket, engine, bare, 20 teeth. (This is the standard sprocket)	1	...		
014294	... Sprocket, engine, bare, 21 teeth	1	...		
014295	... Spacer (collar), $\frac{9}{32}$ in. wide, for engine sprocket	1	...		
016584	... Cam, engine shock absorber	1	...		
016633	... Spring, engine shock absorber	1	...		
016587	... Cap, for engine shock absorber spring	1	...		
011775	... Bolt, locking engine shock absorber assembly, threaded $\frac{1}{2}$ in. by 20	1	...		

## CHAINS

017299	... Chain, front, 67 links, $\frac{1}{2}$ in. by .305 in. (same as 110046-67)	1	...		
017375	... Chain, rear, 96 links, $\frac{5}{8}$ in. by .380 in. (same as 110056-96)	1	...		
110046-26	... Link, connecting, for $\frac{1}{2}$ in. chains	R	...		
110056-26	... Link, connecting, for $\frac{5}{8}$ in. chains	R	...		
110046-30	... Link, cranked, double, for $\frac{1}{2}$ in. chains	R	...		
110056-30	... Link, cranked, double, for $\frac{5}{8}$ in. chains	R	...		
110046-27	... Clip, spring, for 110046-26 connecting links ( $\frac{1}{2}$ in.)	R	...		
110056-27	... Clip, spring, for 110056-26 connecting links ( $\frac{5}{8}$ in.)	R	...		

The prices of front and rear chains include spring connecting links and these are also included in the number of links per chain.

We do not sell odd lengths of chains.

## GEAR BOX

016582	... Gear, box complete, with clutch and with kick-starter and gear control levers	1	...		
--------	---	---	-----	--	--

## SHAFTS AND GEARS

10-C-20	... Mainshaft gearbox	1	...		
15-C-6	... Gear, driving, mainshaft, with bushes, 30 teeth	1	...		
187-X-3	... Bush, only, for mainshaft driving gear	2	...		
14-C-6	... Gear, sliding, mainshaft, 18/23 teeth	1	...		
24-C-6	... Gear, third on mainshaft, 27 teeth, with bush	1	...		
357-X-1	... Bush, for 24-C-6 and 24-C-5 gears, on mainshaft	1	...		
30-C-11	... Layshaft, gearbox, with bushes	1	...		
28-C-3	... Gear, small, on layshaft, 20 teeth	1	...		
27-C-5	... Gear, first, on layshaft, 32 teeth	1	...		
26-C-5	... Gear, second, on layshaft, 27 teeth	1	...		
25-C-3	... Gear, third, on layshaft, 23 teeth	1	...		
29-C-3	... Clutch, sliding, on layshaft	1	...		

## GEAR BOX BEARINGS

177-X-1	... Ball, bearing, driving gear, $1\frac{9}{32}$ in. by 62 mm. by 16 mm.	1	...		
112-C-2	... Oil-seal, main driving gear bearing, rubber	1	...		
80-X-1	... Ring, split, retaining bearing in shell	1	...		
114-C-2	... Washer, outer, driving gear bearing $1\frac{1}{8}$ in. by $2\frac{7}{8}$ ins.	2	...		
113-C-2	... Ring, split, retaining bearing outer washer	1	...		
68-X-1	... Ball bearing, mainshaft, kick-starter end, 12 mm. by 40 mm. by 17 mm.	1	...		
37-1C-2	... Washer, mainshaft ball bearing, kick-starter end, $1\frac{1}{4}$ in. by $1\frac{7}{8}$ in.	1	...		
37-2C-1	... Ring, split, retaining mainshaft ball bearing, kick-starter end	1	...		
181-X-1	... Bush, for layshaft	2	...		
35-1-2	... Pin, dowel, for layshaft bush (same as 87-X-1)	2	...		
182-X-1	... Cap, covering layshaft bush in gearbox shell	1	...		

PART NUMBER	DESCRIPTION	QTY. OFF	PRICE EACH £ s. d.
----------------	-------------	-------------	--------------------------

### GEAR BOX FIXING BOLTS

010957	... Bolt, fixing gear box at top, $5\frac{3}{8}$ ins. by $\frac{7}{16}$ in. by 26 (same as 39-G9-G59) .....	1	...
000313	... Stud, fixing gear box at bottom, $4\frac{1}{4}$ ins. by $\frac{7}{16}$ in. by 26 (same as STD.313) .....	1	...
012999	... Spacer, $\frac{5}{8}$ in. long, on 010957 top stud, outside right position .....	1	...
011086	... Spacer, $\frac{1}{2}$ in. long, on 010957 top stud, inside left and right posi- tions (same as 39-G9-G61) .....	2	...
011086	... Spacer, $\frac{1}{2}$ in. long on STD.313 bottom stud, inside left and right positions (same as 39-G9-G61) .....	2	...
000002	... Nut, on 010957 top fixing stud (same as STD.2) .....	1	...
000002	... Nut, on 000313 bottom fixing stud (same as STD.2) .....	2	...
000009	... Washer, plain, on left side of 010957 top fixing stud (same as STD.9) .....	1	...
000594	... Eye-bolt, for front chain adjustment (same as STD.594) .....	1	...
000215	... Nut, front chain adjustment eye-bolt (same as STD.215) .....	2	...
000785	... Block, crosshead, for front chain adjustment eye-bolt. (This threads on the right hand end of 000278 stud that passes through the rear of the engine rear plates and the top of the rear fork bridge), (same as STD.785) .....	1	...

### GEAR BOX SHELL

1-CP-16	... Shell, gearbox, bare .....	1	...
60-X-1	... Stud, gearbox shell, 1 in. by $\frac{1}{4}$ in. ....	2	...
60-X-6	... Stud, gearbox shell, $1\frac{1}{8}$ in. by $\frac{5}{16}$ in. ....	2	...
60-X-9	... Stud, gearbox shell, $3\frac{3}{8}$ ins. by $\frac{5}{16}$ in. ....	2	...
63-X-1	... Nut, for $\frac{1}{4}$ in. gearbox stud .....	2	...
152-X-1	... Nut, for $\frac{5}{16}$ in. gearbox stud .....	4	...
348-X-1	... Plug, drain, for gearbox shell .....	1	...
356-X-1	... Washer, drain plug .....	1	...
3-C-10	... Case, kick-starter .....	1	...
2-1C-2	... Washer, paper, for kick-starter case .....	1	...
286-X-1	... Stud, kick-starter case, $2\frac{1}{4}$ ins. by $\frac{1}{4}$ in. ....	3	...
63-X-1	... Nut, for $\frac{1}{4}$ in. kick-starter case stud .....	3	...
4-C-15	... Cover, for kick-starter case .....	1	...
4-1C-2	... Washer, paper, for kick-starter case cover .....	1	...
326-X-1	... Cap, filler, for kick-starter case cover .....	1	...
12-7-4	... Cap, in shell, covering bore of camshaft (same as 291-X-1) .....	1	...
12-5-2	... Cap, in K-S case, for sector spindle bore .....	1	...

### GEAR OPERATING PARTS

42-C-1	... Fork, operating mainshaft sliding gear .....	1	...
43-C-1	... Fork, operating layshaft sliding clutch .....	1	...
157-X-1	... Peg, for operating forks .....	2	...
158-X-1	... Pin, split, for fork operating pegs .....	2	...
45-C-2	... Camshaft, bare, for gearbox .....	1	...
192-X-1	... Rollers, for camshaft, per set of .....	12	...
159-X-1	... Bush, for camshaft, in gearbox shell .....	1	...
163-X-2	... Pawl, engages in gearbox camshaft .....	1	...
164-X-1	... Pin, bearing, for camshaft pawl .....	1	...
11-1-1	... Nut, for camshaft pawl bearing pin (same as 95-X-1) .....	1	...
193-X-1	... Spring, for camshaft pawl .....	1	...
21-6-1	... Plug, screwed, retaining camshaft pawl spring (same as 98-X-1) ...	1	...
162-X-3	... Quadrant, gear selection .....	1	...
161-X-2	... Sector, gear selection, engages camshaft .....	1	...
CO-51-6	... Ratchet, gear selection .....	1	...
CO-51-6-A	... Quadrant sector and ratchet (gear selection), assembled .....	1	...
CO-96-1	... Rivet, $\frac{3}{8}$ in. fixing camshaft sector to quadrant .....	1	...
CO-96-2	... Rivet, $\frac{1}{2}$ in. fixing camshaft ratchet to quadrant .....	1	...
CO-90-3	... Spindle, for gear selection, quadrant .....	1	...
287-X-1	... Nut (inside), $\frac{3}{8}$ in. by 26, gear selection quadrant spindle .....	1	...
CO-91-1	... Bush in kick-starter case, for control spindle .....	1	...
160-X-2	... Bush, in kick-starter case for camshaft .....	1	...
CO-53-4	... Quadrant, for foot control spindle .....	1	...
CO-94-2	... Sleeve, for foot gear control quadrant .....	1	...
35-3-2	... Peg, for gear indexing pawl (same as CO-62-1) .....	2	...
CO-53-4-A-49	... Quadrant, assembled with sleeve and peg .....	1	...

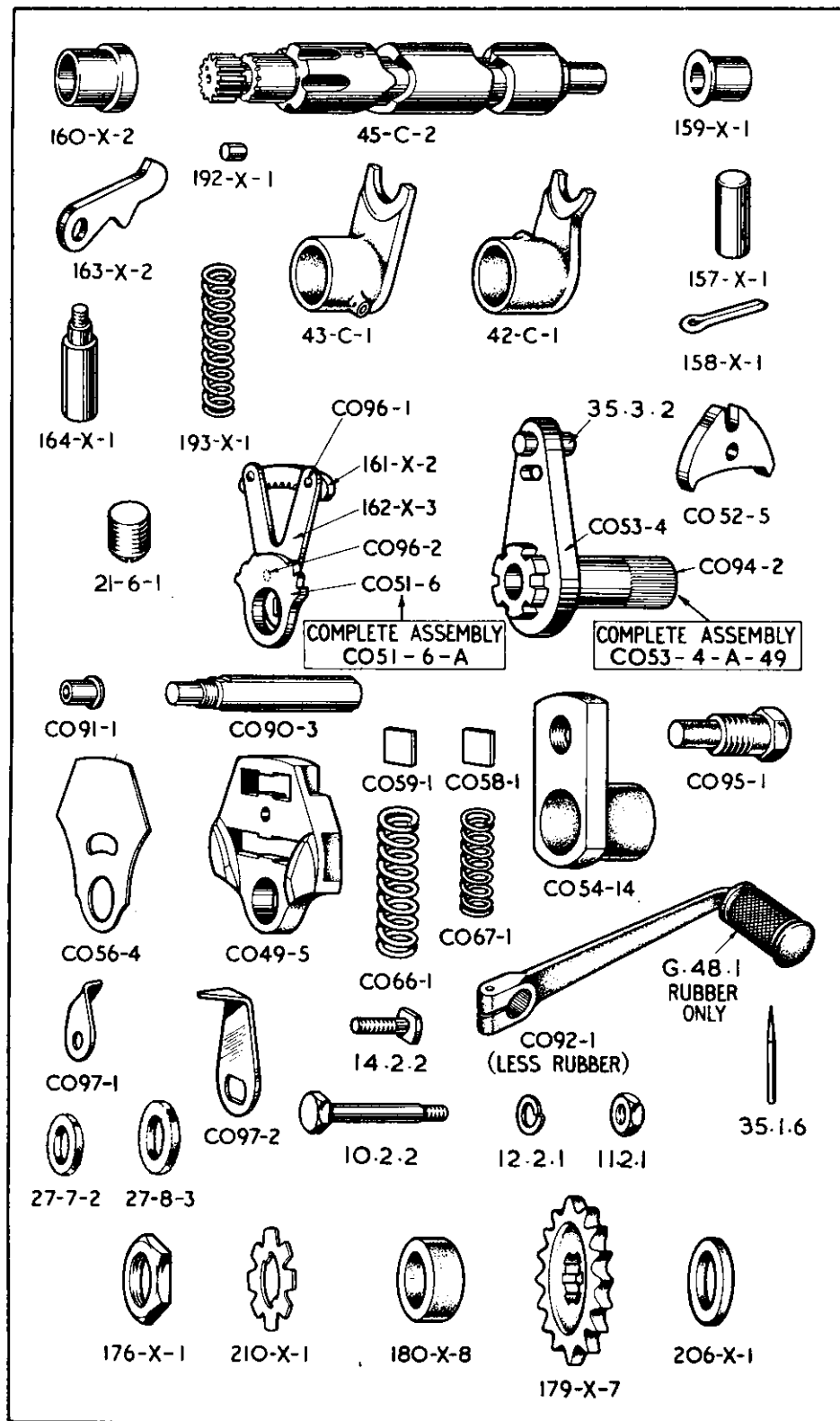

PART NUMBER	DESCRIPTION	QTY. OFF	PRICE EACH £ s. d.
----------------	-------------	-------------	--------------------------

#### GEAR OPERATING PARTS—continued.

CO-54-14	... Bush, for foot control quadrant sleeve	1	...
CO-95-1	... Bolt, fixing quadrant sleeve bush in kick-starter cover	1	...
CO-52-5	... Pawl, indexing, for foot gear control	1	...
CO-49-5	... Box, spring, for foot gear control	1	...
CO-56-4	... Plate, cover, for foot gear control spring box	1	...
CO-66-1	... Spring, main, for control box (large spring)	2	...
CO-67-1	... Spring, pawl, for control box (small spring)	2	...
CO-59-1	... Plate, for control box main spring	2	...
CO-58-1	... Plate, for control box pawl spring	2	...

#### GEAR CONTROL PARTS

CO-97-1	... Indicator, gear, fixed	1	...
CO-97-2	... Indicator, gear, moving	1	...
14-2-2	... Bolt, retaining moving gear indicator (same as CO-105-1)	1	...
CO-92-1	... Lever, foot, gear control	1	...
10-2-2	... Bolt, clamping gear foot lever to sleeve (same as CO-63-3)	1	...
11-2-1	... Nut, for gear foot lever clamping bolt (same as 10-X-1)	1	...
12-2-1	... Washer, foot lever, clamping bolt (same as OF-52-1)	1	...
G-48-1	... Pad, rubber, foot control lever (same as CO-82-2)	1	...
35-1-6	... Pin, fixing control lever rubber pad (same as CO-38-2)	1	...
27-7-2	... Washer, felt (inner), inserted in control spindle bush, $\frac{1}{32}$ in. inside diameter, $\frac{5}{8}$ in. outside diameter, $\frac{1}{8}$ in. thick	1	...
27-8-3	... Washer, felt (outer), fits in recess in foot change lever, $\frac{1}{16}$ in. inside diameter, 1 in. outside diameter, $\frac{1}{8}$ in. thick	1	...

#### GEAR BOX SMALL SPROCKET

179-X-7	... Sprocket, gearbox, 16 teeth by $\frac{5}{8}$ in. by .380 in.	1	...
180-X-8	... Collar, spacing, gearbox sprocket, $\frac{1}{16}$ in. thick	1	...
176-X-1	... Nut, fixing gearbox sprocket to main gear	1	...
206-X-1	... Collar, spacing, under gearbox sprocket, $\frac{3}{16}$ in. thick	1	...
210-X-1	... Washer, lock, gearbox sprocket nut	1	...

#### CLUTCH

G-36-3	... Case for clutch	1	...
29-2-4	... Rivet, for clutch case and chainwheel (same as OF-33-3)	8	...
016903	... Chainwheel and clutch case, assembled	1	...
G-34-2	... Chainwheel, bare, 40 teeth by $\frac{1}{2}$ in. by .305 in.	1	...
12-10-2	... Race, roller, clutch sprocket bearing (same as 34-X-2)	1	...
18-2-1	... Rollers, clutch sprocket bearings, per set (same as 35-X)	24	...
12-10-3	... Washer, thin, clutch sprocket bearing (same as 36X2)	1	...
12-10-4	... Washer, thick, clutch sprocket bearing (same as 36X3)	1	...
G-37-3	... Centre, for five plate clutch (same as 2-X-17)	1	...
11-7-11	... Nut, retaining clutch centre to mainshaft	1	...
71-X	... Washer, plain, for centre retaining nut	1	...
12-7-5	... Washer, lock, for centre retaining nut (same as 349-X-3)	1	...
G-39-4	... Plate, clutch, plain, steel, thin (same as 6-X-5)	6	...
G-40-6	... Plate, clutch, friction with inserts	5	...
18-X-11	... Plate, spring, pressure, for clutch	1	...
G-41-1	... Inserts, fabric, for friction plate (same as 4-X-2) price per dozen	120	...
303-X-1	... Cap, thrust for spring pressure plate	1	...
36-6-1	... Spring, for clutch (same as 21-X-3)	5	...
G-42-2	... Cup, for clutch spring (same as 22-X-2)	5	...
14-2-8	... Stud, for clutch spring, five plate clutch (same as 24-X-12)	5	...
11-2-2	... Nut, adjusting, for clutch spring (same as 23-X-3)	5	...

#### CLUTCH OPERATING PARTS

28-X-57	... Rod, thrust, for five plate clutch, 10 $\frac{1}{8}$ in. long	1	...
330-X-1	... Plunger, clutch operating	1	...
67-X-1	... Ball, steel, for clutch operating plunger	1	...
175-X-4	... Lever, clutch operating	1	...
66-X-7	... Pin, for clutch operating lever	1	...
329-X-1	... Fork, for clutch operating lever	1	...
331-X-1	... Sleeve, for clutch operating lever fork	1	...
328-X-1	... Cap, covering clutch operating lever fork sleeve	1	...
64-X-1	... Screw, fixing sleeve cap to kick-starter case cover	2	...

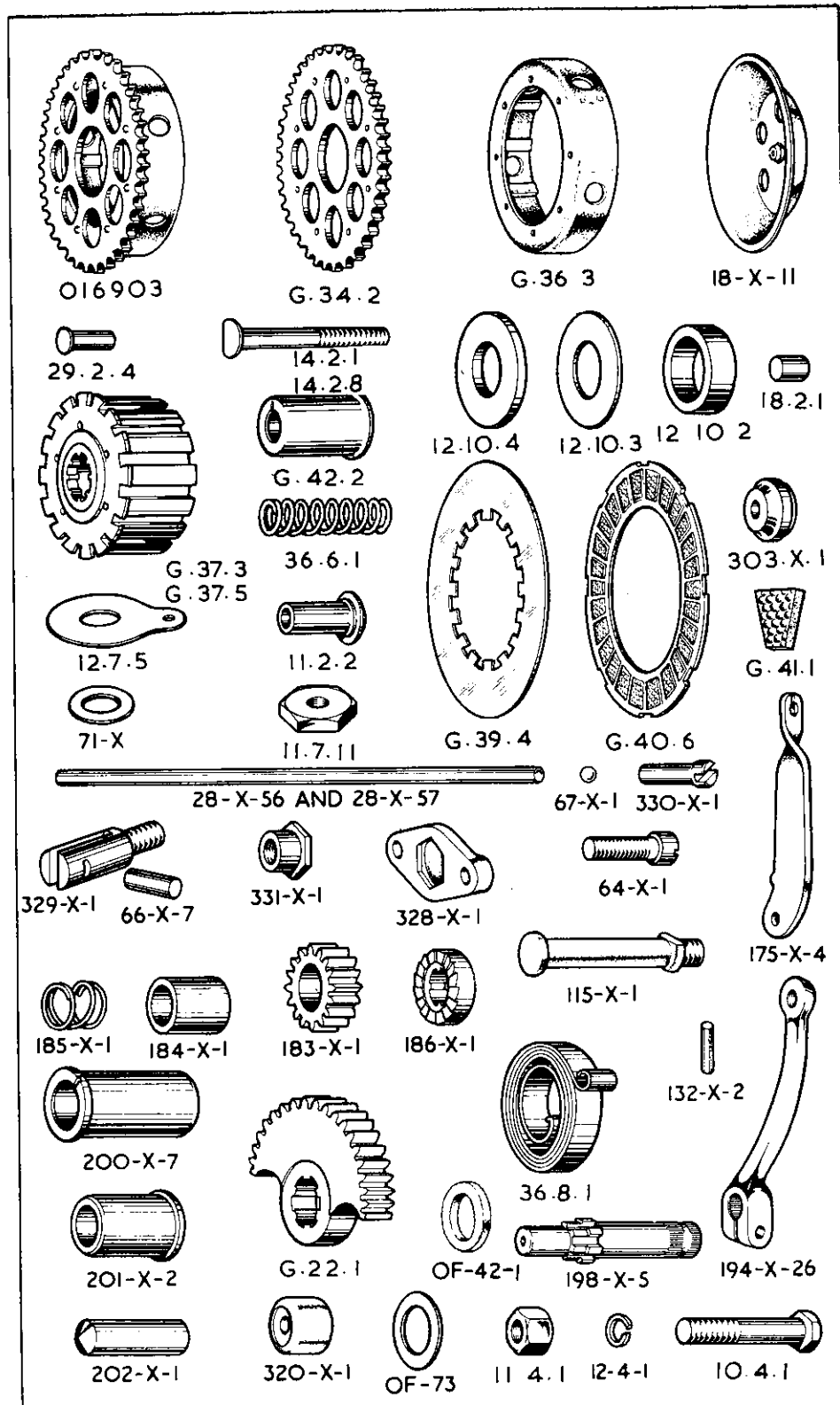

PART NUMBER	DESCRIPTION	QTY. OFF	PRICE EACH £ s. d.
----------------	-------------	-------------	--------------------------

## KICK-STARTER

186-X-1	... Ratchet, driving, kick-starter	1	...
183-X-1	... Pinion, ratchet, kick-starter	1	...
184-X-1	... Bush, kick-starter ratchet pinion	1	...
185-X-1	... Spring, kick-starter ratchet pinion	1	...
70-X-1	... Nut, retaining, driving ratchet to mainshaft	1	...
198-X-5	... Spindle, for kick-starter quadrant and foot lever	1	...
201-X-2	... Bush, in kick-starter case, for kick-starter quadrant spindle	1	...
200-X-7	... Bush, in kick-starter case cover, for kick-starter quadrant spindle	1	...
G-22-1	... Quadrant, for kick-starter spindle (same as 199-X-3)	1	...
016904	... Kick-starter quadrant and spindle assembled (same as 199-X-A-49)	1	...
36-8-1	... Spring, return, for kick-starter foot lever (same as 130-X-2)	1	...
132-X-2	... Pin, anchor, for kick-starter return spring	1	...
320-X-1	... Stop, rubber and sleeve, for kick-starter quadrant	1	...
202-X-1	... Peg, for kick-starter stop rubber and sleeve	1	...
194-X-26	... Lever, foot, kick-starter, bare	1	...
115-X-1	... Pin, pedal, for kick-starter foot lever	1	...
10-4-1	... Bolt, clamping kick-starter foot lever to spindle (same as 315-X-1)	1	...
11-4-1	... Nut, for kick-starter foot lever clamping bolt (same as 144-X-1)	1	...
12-4-1	... Washer, spring, on kick-starter lever bolt (same as 109-X-1)	1	...
OF-42-1	... Washer, felt, on kick-starter spindle	1	...
OF-73	... Washer, plain, retains felt washer on kick-starter spindle	1	...

## FRONT FRAME

016489	... Frame, front portion only, bare	1	...
000806	... Race, ball, for frame head lug (same as STD. 806)	2	...
000072	... Balls, $\frac{3}{8}$ in. diameter, for steering head, per set of (same as STD.72)	56	...
000051	... Nipple, grease, for frame head lug (same as STD.51)	1	...
014478	... Stud, for seat lug (below saddle), $4\frac{1}{16}$ ins. by $\frac{1}{2}$ in. by 26	1	...
000008	... Washer, plain, for seat lug stud (same as STD.8)	2	...
000001	... Nut, for seat lug stud (same as STD.1)	2	...
000015	... Screw, securing earth wires (screws into end of stud 014478) $\frac{3}{8}$ in. by 3 B.A. (same as STD.15)	1	...
000185	... Washer, plain, for STD.15 earth wire screw (same as STD.185)	1	...

## REAR FRAME

014359	... Rail, frame, right side	1	...
014360	... Rail, frame, left side	1	...
014420	... Loop, rear frame	1	...
014512	... Stud, for rear loop at bottom, 12 ins. by $\frac{7}{16}$ in. by 26. (Also passes through rear fork bridge and both frame rails)	1	...
000002	... Nut, for rear loop bottom stud (same as STD.2)	2	...
000009	... Washer, plain, for rear loop bottom stud (same as STD.9)	2	...
016190	... Tube, supporting rear of rear mudguard, right side	1	...
016191	... Tube, supporting rear of rear mudguard, left side	1	...
000343	... Bolt, fixing mudguard support tube to frame loop, $\frac{1}{2}$ in. by $\frac{1}{2}$ in. by 26 (same as STD.343)	4	...
000012	... Washer, plain, for mudguard support tube bolt (same as STD.12)	4	...
000191	... Washer, spring, for mudguard support tube bolt (same as STD. 191)	4	...
000005	... Nut, for mudguard support tube bolt (same as STD. 5)	4	...
015329	... Bridge, for rear fork (includes bushes and studs for centre stand spring clip)	1	...
014672	... Bush, for rear fork bridge	2	...
000250	... Stud, for rear fork bridge $\frac{3}{8}$ in. by 2 B.A. (same as STD. 250)	2	...
016768	... Stud, $1\frac{1}{8}$ in. by $\frac{5}{16}$ in. by 26 by 26, for oil tank, battery carrier and air cleaner retention	3	...
000174	... Washer, plain, for 016768 stud	3	...
000004	... Nut, for 016768 stud	3	...

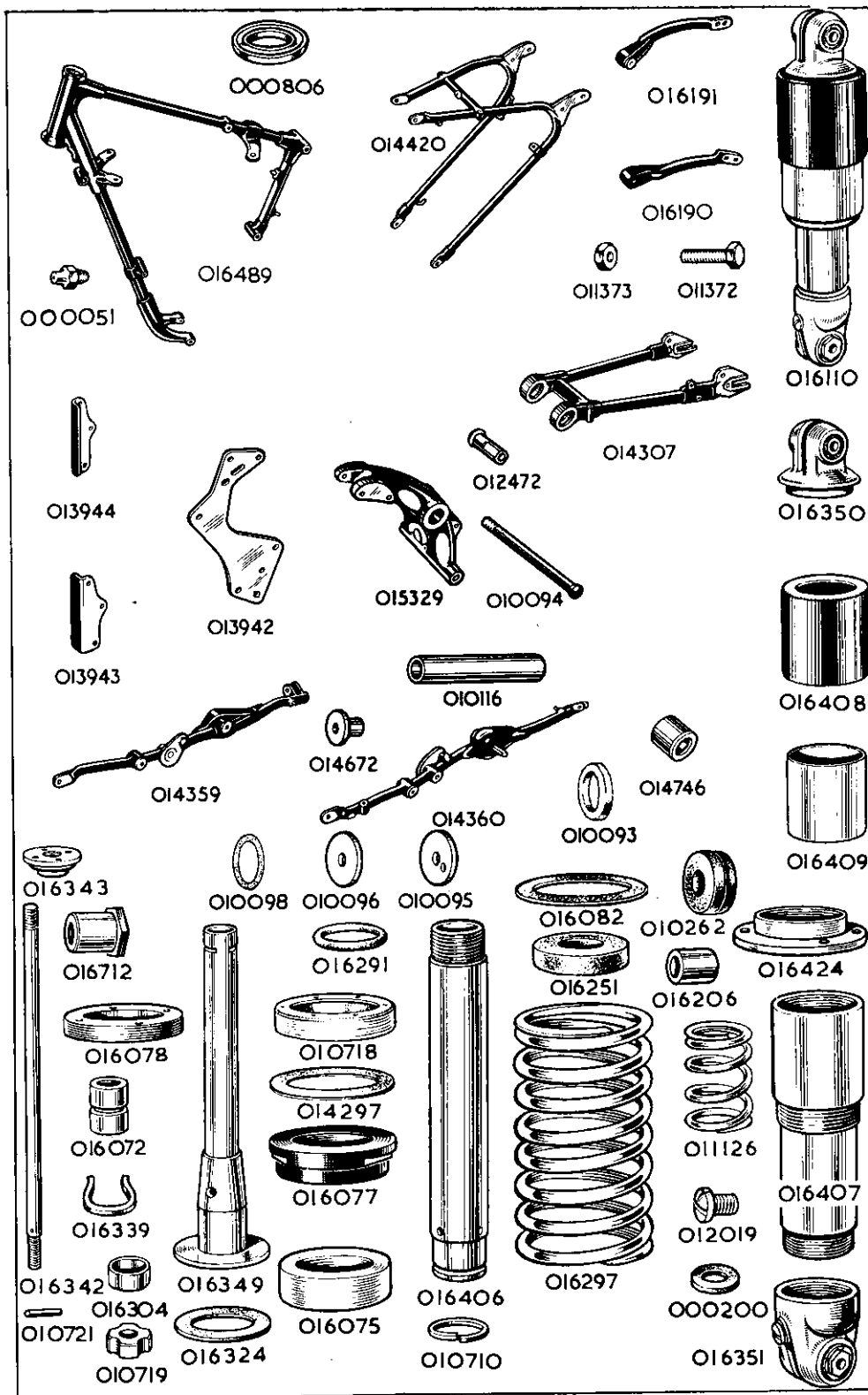

PART NUMBER	DESCRIPTION	QTY. OFF	PRICE EACH £ s. d.
----------------	-------------	-------------	--------------------------

## REAR FORK

014307	... Fork, rear .....	1	...
011372	... Pin, chain, adjusting, for right fork end .....	1	...
011373	... Nut, lock, for chain adjusting pin.....	1	...
014746	... Sleeve, assembly (bushed) .....	2	...
010116	... Tube .....	1	...
010095	... Cap, for rear fork bearing, right side .....	1	...
010096	... Cap, for rear fork bearing, left side.....	1	...
010093	... Washer, felt, for rear fork bearing .....	2	...
010098	... Gasket, for rear fork bearing caps .....	2	...
010094	... Spoke, for rear fork bearing (central tie bolt) .....	1	...
012472	... Nipple, for rear fork bearing spoke .....	1	...
000485	... Screw, plug, for oil, in end cap, $\frac{1}{4}$ in. by $\frac{1}{4}$ in. by 26 (same as STD.485) .....	1	...
000203	... Washer, fibre, for oil plug screw (same as STD.203) .....	1	...

## TELEDRAULIC REAR LEG

016110	... Leg, TELEDRAULIC, rear complete assembly (no fixing bolts, washers and nuts) .....	2	...
016350	... Pivot, top, assembled (this assembly includes the next three items) .....	2	...
016059	... Pivot, top, bare .....	2	...
010262	... Bush, rubber, for top pivot .....	4	...
016206	... Spacer, for top pivot rubber bush .....	4	...
016351	... Pivot, bottom, assembled (this assembly includes the next five items) .....	2	...
016060	... Pivot, bottom, bare .....	2	...
010262	... Bush, rubber, for bottom pivot .....	4	...
016206	... Spacer, for bottom pivot rubber bush .....	2	...
016712	... Nut, with sleeve, for bottom pivot bolt.....	2	...
016873	... Washer, plain, for 016712 sleeve nut .....	2	...
012019	... Plug, drain, for bottom pivot (only on early machines) .....	2	...
000200	... Washer, fibre, for bottom pivot drain plug (same as STD.200) (only on early machines) .....	2	...
016406	... Tube, inner (fits in top pivot recess) .....	2	...
016291	... Ring, sealing inner tube at top .....	2	...
016075	... Bush, lower end of inner tube .....	2	...
010710	... Circlip, retaining inner tube bush (same as 40-G12M-FF192) .....	2	...
016407	... Tube, outer (screws into bottom pivot).....	2	...
016324	... Washer, sealing lower end of outer tube .....	4	...
016077	... Bush, for outer tube .....	2	...
010718	... Oil-seal, between inner and outer tubes (same as 40-G12M-FF91) .....	2	...
014297	... Washer, under oil-seal .....	2	...
016078	... Collar, retaining oil-seal.....	2	...
016349	... Tube, for damper .....	2	...
016072	... Sleeve, plunger, for damper rod .....	2	...
016339	... Clip, locating plunger sleeve .....	2	...
016342	... Rod, for damper .....	2	...
016343	... Collar, for top end of damper rod .....	2	...
000074	... Nut, locking collar top-end of damper rod (same as STD.74) .....	2	...
016304	... Valve, for damper .....	2	...
010721	... Pin, stop, for damper valve (same as 40-18-FF59) .....	2	...
010719	... Seat, for damper valve (same as 40-18-FF57) .....	2	...
000005	... Nut, retaining damper seat to damper rod (same as STD.5) .....	2	...
011126	... Spring buffer .....	2	...
016297	... Spring, main .....	2	...
016082	... Washer, leather, at both ends of main spring .....	4	...
016408	... Tube, outer, covering top end of main spring .....	2	...
016409	... Tube, outer, covering bottom end of main spring .....	2	...
016424	... Nut, retaining bottom outer cover tube .....	2	...
016251	... Buffer, for TELEDRAULIC Leg .....	2	...
016205	... Bolt, fixing top pivot, $3\frac{7}{16}$ ins. by $\frac{3}{8}$ in. by 26.....	2	...
000010	... Washer, plain, for top pivot bolt (same as STD.10) .....	4	...
000003	... Nut for top pivot bolt (same as STD.3) .....	3	...
016359	... Bolt, fixing bottom pivot, $2\frac{1}{2}$ ins. by $\frac{3}{8}$ in. by 26 .....	2	...
000010	... Washer, plain, for bottom pivot bolt (same as STD.10) .....	4	...

PART NUMBER	DESCRIPTION	QTY. OFF	PRICE EACH
			£ s. d.

## FORK ASSEMBLIES

<i>The following fork assemblies are complete and include ball races for the fork crown and top head lug (but not the two frame ball races).</i>			
016891	... Fork, assembly (TELEDRAULIC Front Fork, Solo) .....	1	...
016892	... Fork, assembly (TELEDRAULIC Front Fork, Sidecar) .....	1	...

<i>For ease of servicing, the inner tube unit is listed as supplied as a separate assembly. This enables a complete assembly to be exchanged in minimum time. The units are listed below.</i>			
016895	... Front Fork inner tube assembly, Solo .....	2	...
016896	... Front Fork inner tube assembly, Sidecar .....	2	...

*The above assemblies comprise:—*

*Inner tubes with rubber buffers. Bushes and circlips. Top bolts with washers and sealing rings. Slider extensions with oil seals. Fork springs and washers.*

## FRONT FORK

013861	... Crown, assembly, comprising crown, stem and circlip (these parts not sold separately), and two 016320 studs .....	1	...
000805	... Race, ball, for fork crown (same as STD.805) .....	1	...
016320	... Stud, pinch, for fork crown, 2 ins. by $\frac{7}{16}$ in. by 26 .....	2	...
000011	... Washer, plain, for fork crown pinch stud (same as STD.11) .....	2	...
011635	... Nut, for fork crown pinch stud .....	2	...
013631	... Lug, for handlebar and steering head .....	1	...
012620	... Race, ball, for handlebar lug .....	1	...
000051	... Nipple, grease, for handlebar lug (same as STD.51) .....	1	...
000236	... Nut, adjusting, for fork crown stem (same as STD.236) .....	1	...
010712	... Nut, lock (domed), for fork crown stem (same as L4-FF46) .....	1	...
016322	... Tube, fork, inner .....	2	...
016148	... Buffer, rubber, for fork inner tube .....	6	...
010692	... Bush, bottom, for fork inner tube (same as 40-G12M-FF191) .....	2	...
010710	... Circlip, for fork inner tube bush (same as 40-G12M-FF192) .....	2	...
016718	... Bolt, top, for fork inner tube .....	2	...
014355	... Ring, sealing, for fork inner tube top bolt .....	2	...
010709	... Washer, plain, for fork inner tube top bolt (same as 40-G12M-FF190) .....	2	...
013632	... Slider, fork, with cap, studs and nuts, left and right .....	2	...
013509	... Cap, for fork slider .....	2	...
010713	... Stud, securing fork slider cap, $1\frac{3}{8}$ in. by $\frac{5}{16}$ in. by 26 and 22 (same as 40-G12M-FF195) .....	4	...
000011	... Washer, plain, for fork slider cap stud (same as STD. 11) .....	4	...
000004	... Nut, for fork slider cap stud (same as STD.4) .....	4	...
018161	... Extension, for fork slider .....	2	...
015286	... Bush, plastic, for fork inner tube .....	2	...
010718	... Oil-seal, for fork inner tube (same as 40-G12M-FF91) .....	2	...
014297	... Washer, under oil-seal .....	2	...
016526	... Spring, main, for front fork, solo .....	2	...
016782	... Spring, main, for front fork, sidecar .....	2	...
010360	... Spring, buffer, for front fork .....	2	...
010698	... Washer, leather, fork spring seating (same as 40-G12M-FF126) .....	4	...
013694	... Tube, fork cover, top, right, with lamp lug .....	1	...
013695	... Tube, fork cover, top, left, with lamp lug .....	1	...
010703	... Cap, for top of fork top cover tubes (same as 40-G12M-FF186) .....	2	...
012569	... Cap, for bottom of fork top cover tube .....	2	...
010701	... Plate, threaded, locating top cover tube (same as 40-G12M-FF128) .....	2	...
017036	... Tube fork cover, bottom (same as 41-G3L-FF184-B) .....	2	...
010702	... Plate, plain, locating bottom cover tube (same as 40-G12M-FF127) .....	2	...
010716	... Screw, retaining both locating plates, $1\frac{3}{8}$ in. by 3 B.A. (same as 40-G12M-FF129) .....	6	...
000485	... Screw, plug, oil drain, for fork slider, $\frac{1}{4}$ in. by $\frac{1}{4}$ in. by 26 (same as STD.485) .....	2	...
000203	... Washer, fibre, for fork slider screw oil plug (same as STD.203) .....	2	...
015932	... Tube, fork damper .....	2	...
010697	... Bolt, fixing fork damper to slider $\frac{7}{16}$ in. by $\frac{5}{16}$ in. by 26 (same as 40-G12M-FF94) .....	2	...
010706	... Washer, fibre, for damper tube bolt (same as 40-G12M-FF80) .....	2	...
017357	... Rod, for fork damper (same as 41-G3L-FF55) .....	2	...
000004	... Nut, lock, top end of damper rod (same as STD.4) .....	2	...
016072	... Sleeve, plunger, for fork damper rod .....	2	...
016339	... Clip, retaining damper rod sleeve .....	2	...
016304	... Valve, for fork damper .....	2	...
010721	... Pin, stop, for fork damper valve (same as 40-18-FF59) .....	2	...
010719	... Seat, for fork damper valve (same as 40-18-FF57) .....	2	...
000005	... Nut, lock, for fork damper valve seat (same as STD.5) .....	2	...

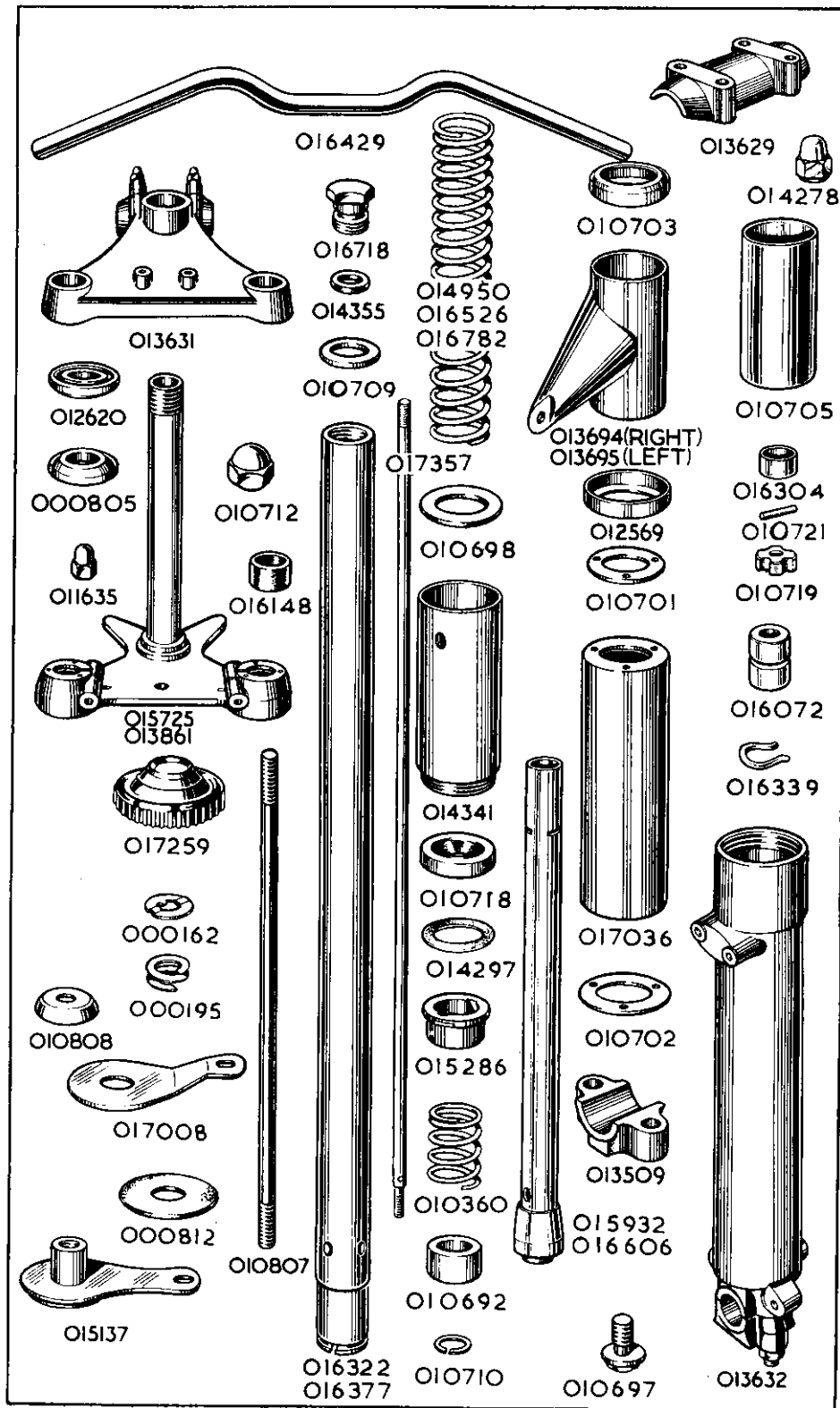

PART NUMBER	DESCRIPTION	QTY. OFF	PRICE EACH		
			£	s.	d.

### STEERING DAMPER. (This is an optional extra)

016404	... Damper, steering, complete set of parts.....	1	...		
017259	... Knob, control, for steering damper (same as TFF-101-S).....	1	...		
000162	... Washer, ratchet, for steering damper knob (same as STD.162) ...	1	...		
000195	... Washer, spring, for steering damper knob (same as STD.195) .....	1	...		
010808	... Cap, for top of steering stem .....	1	...		
010807	... Drawbolt, for steering damper.....	1	...		
015137	... Sleeve, assembly, lower end of drawbolt .....	1	...		
000073	... Nut, locking sleeve to drawbolt (same as STD.73) .....	1	...		
000342	... Bolt, fixing sleeve assembly, $\frac{1}{4}$ in. by $\frac{1}{2}$ in. by 26 (same as STD.342) .....	1	...		
000191	... Washer, spring, for bolt 000342 (same as STD.191) .....	1	...		
000012	... Washer, plain, for bolt 000342 (same as STD.12) .....	1	...		
000005	... Nut, for bolt 000342 (same as STD.5).....	1	...		
017008	... Plate, anchor, top position (same as 40-G12M-FF97) .....	1	...		
000070	... Bolt, fixing top anchor plate, $\frac{7}{8}$ in. by $\frac{1}{2}$ in. by 26 (same as STD.70) .....	1	...		
000191	... Washer, spring, for bolt 000070 (same as STD.191) .....	1	...		
000812	... Washer, fibre, friction, for steering damper (same as STD.812) ...	2	...		
000236	... Nut, lock, for fork crown stem (this replaces the domed lock-nut 010712 when a steering damper is fitted) (same as STD.236).....	1	...		

### HANDLEBAR

016429	... Handlebar, bare .....	1	...		
013629	... Clip (half only) for handlebar lug.....	1	...		
012870	... Stud, for handlebar clip, $1\frac{1}{2}$ in. by $\frac{1}{2}$ in. by 26 and 20.....	4	...		
000012	... Washer, plain, for handlebar clip stud (same as STD.12).....	4	...		
014278	... Nut, for handlebar clip stud .....	4	...		

### FRONT STAND

011286	... Stand, front, bare .....	1	...		
010694	... Bolt, fixing front stand to slider, $1\frac{5}{8}$ in. by $\frac{5}{8}$ in. by 22 (same as 41-G3L-FF422) .....	2	...		
010724	... Washer, spring, for stand to slider bolt (same as HBD-52).....	2	...		
000014	... Pin, split, for stand to slider bolt (same as STD.14).....	2	...		
000342	... Bolt, fixing front stand to front mudguard, $\frac{1}{4}$ in. by $\frac{1}{2}$ in. by 26 (same as STD.342) .....	1	...		
000012	... Washer, plain, for stand to mudguard bolt (same as STD.12) .....	2	...		
000005	... Nut, front stand to mudguard bolt (same as STD.5) .....	1	...		
014278	... Nut (domed), front stand to mudguard bolt.....	1	...		

### PROP STAND

014719	... Stand, prop, bare.....	1	...		
014713	... Bolt, hinge, for prop stand, $2\frac{1}{8}$ ins. by $\frac{7}{8}$ in. by 26.....	1	...		
014139	... Nut, for prop stand hinge bolt.....	1	...		
000049	... Pin, split, for prop stand hinge bolt (same as STD.49).....	1	...		
010843	... Spring, return, for prop stand .....	1	...		

### CENTRE STAND

016438	... Stand, centre, bare .....	1	...		
014626	... Bush, for centre stand, .7 in. long .....	2	...		
014629	... Stud, hinge, for centre stand, $8\frac{1}{8}$ ins. by $\frac{7}{8}$ in. by 26 .....	1	...		
014630	... Spacer, central, for centre stand hinge stud, 4.2 ins. long .....	1	...		
010912	... Washer, spigot, for centre stand hinge stud .....	2	...		
000002	... Nut, for centre stand hinge stud (same as STD.2) .....	2	...		
014627	... Spring, return, for centre stand .....	1	...		
016399	... Spring, stop, for centre stand .....	1	...		
000080	... Nut, for centre stand stop spring (the studs, on which these nuts fit, are listed with the " REAR FORK BRIDGE ") (same as STD.80).....	2	...		
000039	... Washer, plain, for centre stand stop spring fixing nuts (same as STD.39).....	2	...		

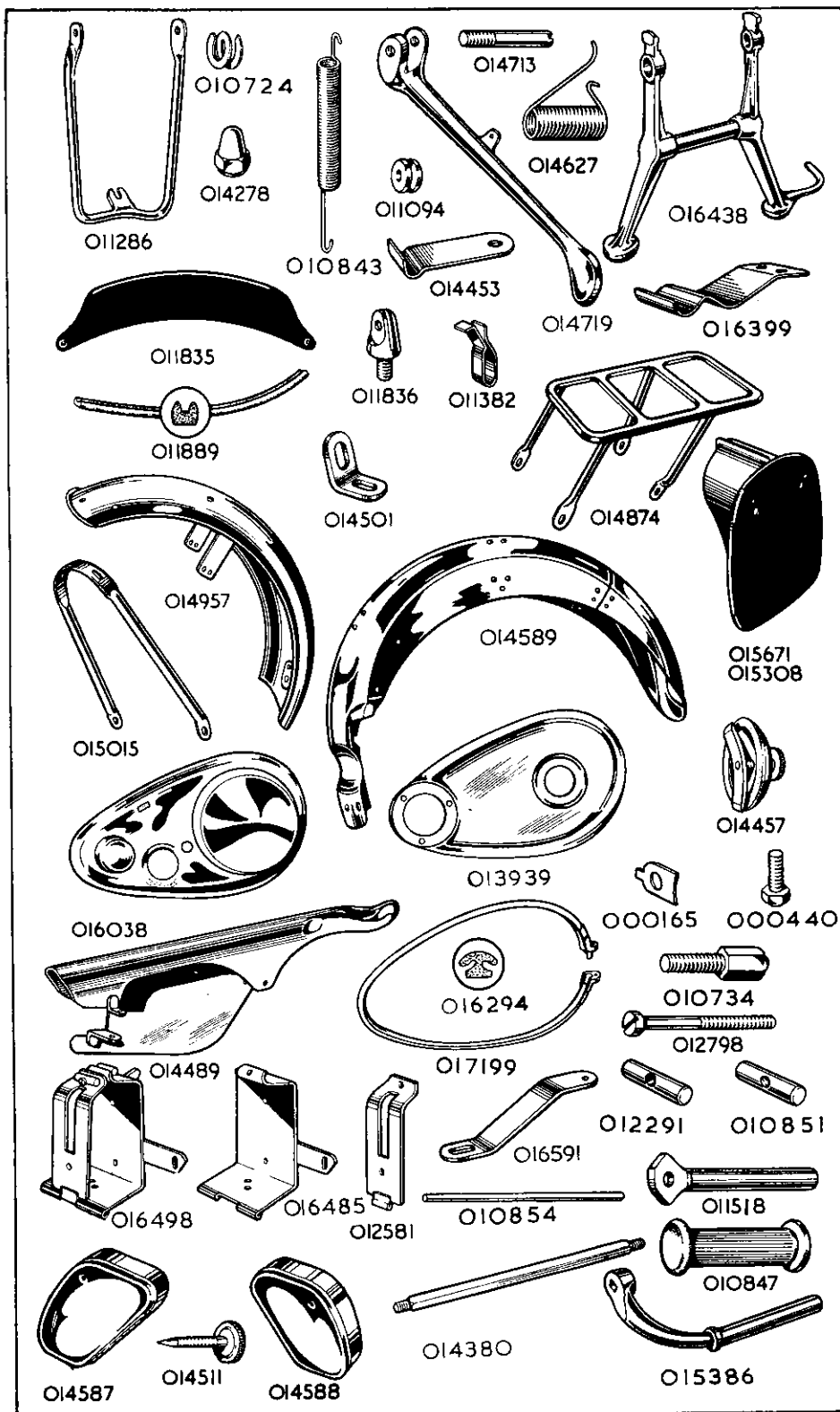

PART NUMBER	DESCRIPTION	QTY. OFF	PRICE EACH
			£ s. d.

### FRONT MUDGUARD

014957	... Mudguard, front, bare .....	1	...
010795	... Bolt, fixing mudguard bridge to right fork slider, $\frac{1}{2}$ in. by $\frac{5}{16}$ in. by 22 (same as 41-G3L-M38) .....	2	...
000192	... Washer, spring, for bridge right fixing bolt (same as STD.192).....	2	...
010624	... Stud, fixing mudguard bridge to left fork slider, also retains brake anchor stay and bracket for brake cable adjuster, $1\frac{1}{32}$ in. by $\frac{5}{16}$ in. by 26 and 22.....	2	...
014117	... Washer, lock, for bridge left fixing stud.....	2	...
000004	... Nut, for bridge left fixing stud (same as STD.4) .....	2	...
015015	... Stay, for front mudguard .....	1	...
010795	... Bolt, fixing front mudguard stay to fork slider, $\frac{1}{2}$ in. by $\frac{5}{16}$ in. by 22 (same as 41-G3L-M38) .....	2	...
000192	... Washer, spring, for stay to fork slider bolt (same as STD.192) .....	2	...
000070	... Bolt, fixing stay to front mudguard, $\frac{9}{16}$ in. by $\frac{1}{4}$ in. by 26 (same as STD.70).....	2	...
000191	... Washer, spring, for stay to front mudguard bolt (same as STD.191) .....	2	...
000012	... Washer, plain, for stay to front mudguard bolt (same as STD.12) .....	2	...
000005	... Nut, for stay to front mudguard bolt (same as STD.5) .....	2	...

### REAR MUDGUARD

014589	... Mudguard, rear, bare (altogether this is in two parts, the parts are not sold as separate spares) .....	1	...
014501	... Bracket, for bottom of rear mudguard .....	2	...
000342	... Bolt, fixing bracket to rear mudguard, $\frac{1}{8}$ in. by $\frac{1}{4}$ in. by 26 (same as STD.342) .....	2	...
000012	... Washer, plain, for bracket fixing bolt (same as STD.12).....	4	...
000005	... Nut, for bracket fixing bolt (same as STD.5).....	2	...
000275	... Stud, fixing rear mudguard brackets to frame, $3\frac{9}{16}$ ins. by $\frac{5}{16}$ in. by 26 (same as STD.275) .....	1	...
000011	... Washer, plain, for bracket fixing stud (same as STD.11).....	2	...
000004	... Nut, for bracket fixing stud (same as STD.4) .....	2	...
000346	... Bolt, fixing rear mudguard to frame loop bridge, $1\frac{7}{8}$ in. by $\frac{1}{4}$ in. by 26 (same as STD.346) .....	1	...
000191	... Washer, spring, for bridge fixing bolt (same as STD.191) .....	1	...
000005	... Nut, for bridge fixing bolt (same as STD. 5).....	1	...
000362	... Bolt, fixing rear mudguard to oil tank, $\frac{5}{8}$ in. by $\frac{5}{16}$ in. by 26 (same as STD.362) .....	1	...
000192	... Washer, spring, for mudguard to oil tank bolt (same as STD.192)...	1	...
000174	... Washer, plain, for mudguard to oil tank bolt (same as STD.174) .....	1	...
000004	... Nut, for mudguard to oil tank bolt (same as STD.4) .....	1	...

### REAR CARRIER

014874	... Carrier, rear, bare .....	1	...
<i>Existing bolts are used to attach the above carrier, plain and/or spring washers being discarded, as may be necessary, to allow for the thickness of the carrier legs.</i>			

### FRONT NUMBER PLATE

011835	... Plate, number, front .....	1	...
011836	... Stud, fixing front number plate .....	2	...
000012	... Washer, plain, front number plate stud (same as STD.12) .....	2	...
000005	... Nut, front number plate stud (same as STD.5).....	2	...
000861	... Screw, fixing front number plate to stud, $\frac{5}{16}$ in. by 2 B.A. (same as STD.861) .....	2	...
011889	... Fillet, rubber, front number plate .....	1	...

### REAR NUMBER PLATE

015671	... Plate, number, rear.....	1	...
000363	... Bolt, fixing rear number plate, $\frac{3}{4}$ in. by $\frac{5}{16}$ in. by 26 (same as STD.363) .....	2	...
000192	... Washer, spring, rear number plate bolt (same as STD.192) .....	2	...

PART NUMBER	DESCRIPTION	QTY. OFF	PRICE EACH £ s. d.
----------------	-------------	-------------	--------------------------

### FRONT CHAINCASE

018034	... Chaincase, complete (comprises both halves, metal and rubber bands, clamping screw and inspection cap—NO FIXING BOLTS, SPACERS, WASHERS AND NUTS ARE INCLUDED) .....	1	...
013939	... Chaincase, back half, bare .....	1	...
016038	... Chaincase, front half, bare .....	1	...
017199	... Band, metal, for chaincase (same as 12302-7) .....	1	...
000453	... Screw, clamping, chaincase metal band, 1 in. by 2 B.A. (same as STD.453) .....	1	...
016294	... Band, rubber, for chaincase .....	1	...
014457	... Cap, assembly, chaincase inspection (components not sold as separate spares) .....	1	...
000580	... Washer, cork, chaincase inspection cap (same as STD.580) .....	1	...
000440	... Bolt, fixing chaincase to engine, $\frac{1}{2}$ in. by 0 B.A. (same as STD.440) .....	3	...
000165	... Washer, lock, chaincase engine bolt (same as STD.165) .....	3	...

### REAR CHAINGUARD

014489	... Chainguard, rear, bare .....	1	...
000350	... Bolt, fixing chainguard in front, $2\frac{1}{8}$ ins. by $\frac{1}{4}$ in. by 26 (same as STD.350) .....	1	...
000012	... Washer, plain, chainguard, front fixing bolt (same as STD.12) .....	2	...
000005	... Nut, for chainguard front fixing bolt (same as STD.5) .....	1	...
014559	... Bolt, fixing rear of chainguard, $2\frac{7}{8}$ ins. by $\frac{5}{8}$ in. by 26 .....	1	...
000011	... Washer, plain, for chainguard rear fixing bolt (same as STD.11) .....	1	...
000192	... Washer, spring, for chainguard rear fixing bolt (same as STD.192) .....	1	...
014560	... Spacer, $1\frac{5}{8}$ in. long (located inside chainguard), on bolt 014559 .....	1	...
014561	... Spacer, $\frac{3}{8}$ in. long (located between chainguard and frame on bolt 014559) .....	1	...
000004	... Nut, for chainguard bolt 014559 (same as STD.4) .....	1	...

### BATTERY CARRIER

016498	... Carrier, battery, complete with bolt, seat and nut .....	1	...
016485	... Carrier, battery, back portion only .....	1	...
012581	... Carrier, battery, front portion only .....	1	...
010854	... Pin, hinge, battery carrier front (same as X-E184) .....	1	...
012798	... Bolt, clamping battery carrier, $1\frac{3}{8}$ in. by $\frac{1}{4}$ in. by 26 .....	1	...
012291	... Seat, battery carrier clamping bolt (same as A-E178) .....	1	...
010851	... Nut, battery carrier clamping bolt (same as A-E177) .....	1	...
000004	... Nut, fixing battery carrier and oil tank to front frame (same as STD.4) .....	3	...
000174	... Washer, plain, for battery carrier and oil tank fixing nut (same as STD.174) .....	3	...
016591	... Stay, battery carrier to chaincase .....	1	...
000040	... Screw, fixing stay to battery carrier, $\frac{1}{2}$ in. by 1 B.A. (same as STD.40) .....	1	...
000012	... Washer, plain, for 000040 bracket screw (same as STD.12) .....	1	...
010734	... Bolt, fixing battery carrier bracket to chaincase, $\frac{3}{8}$ in. by $\frac{5}{8}$ in. by 26 (same as 37-12-H17) .....	1	...
000011	... Washer, plain, for 010734 carrier bracket bolt (same as STD.11) .....	1	...
000004	... Nut, for 010734 carrier bracket bolt (same as STD.4) .....	1	...

### TOOL BOXES

014587	... Box, tool, bare (with lid but no other fittings), left side .....	1	...
014588	... Box, tool, bare (with lid but no other fittings), right side .....	1	...
014511	... Screw, knurled, for tool box lid .....	2	...
000189	... Washer, spring, for tool box lid screw (same as STD.189) .....	2	...
000005	... Nut, for tool box lid screw (same as STD.5) .....	4	...
000342	... Bolt, long, fixing tool box, $1\frac{1}{8}$ in. by $\frac{1}{4}$ in. by 26 (same as STD.342) .....	4	...
014577	... Bolt, short, fixing tool box, $\frac{7}{8}$ in. by $\frac{1}{4}$ in. by 26 .....	2	...
000639	... Spacer, $\frac{1}{4}$ in. long for tool box long fixing bolts (same as STD.639) .....	4	...
000012	... Washer, plain, for tool box fixing bolt (same as STD.12) .....	12	...
000005	... Nut, for tool box fixing bolts (same as STD.5) .....	6	...

PART NUMBER	DESCRIPTION	QTY. OFF	PRICE EACH
			£ s. d.

### FOOTRESTS

015386	... Arm, for footrest.....	2	...
010847	... Pad, rubber, for footrest arm (same as 16315) .....	2	...
014380	... Rod, for footrests, overall length 9 ins. ....	1	...
010924	... Spacer, 3½ ins. long, for footrest rod, between engine rear plates (same as CFR-6) .....	1	...
014484	... Spacer, ¾ in. long, for footrest rod, outside right plate.....	1	...
000009	... Washer, plain, for footrest rod (same as STD.9) .....	2	...
000002	... Nut, for footrest rod (same as STD.2) .....	2	...

### PILLION FOOTRESTS

011267	... Pair of pillion footrests, complete (includes all the following items) .....	1	...
011518	... Spindle, bare for pillion footrest .....	2	...
011599	... Bolt, hinge, for pillion footrest spindle, 1⅜ in. by ⅜ in. by 26.....	2	...
000073	... Nut, for pillion footrest hinge bolt (same as STD.73) .....	2	...
010847	... Pad, rubber, for pillion footrest spindle (same as 16315) .....	2	...

### TWIN SEAT

014293	... Seat, Twin.....	1	...
014919	... Screw, fixing seat at rear to loop, ¾ in. by 2 B.A.....	2	...
000039	... Washer, plain, for seat fixing screw (same as STD.39).....	2	...
000080	... Nut, for seat fixing screw (same as STD.80) .....	2	...
000011	... Washer, plain, for nut fixing seat in centre (same as STD.11) .....	2	...
000004	... Nut, fixing seat in centre (same as STD.4).....	2	...

### TRANSFERS

009183	... Transfer, for side of oil tank (oil level indicator) (same as 38-G3-F392 and STD.9183) .....	1	...
009184	... Transfer, for top of oil tank (service instruction) (same as 38-G3-F391 and STD.9184) .....	1	...
009186	... Transfer, for front chaincase (oil level indicator) (same as 38-G3-F393 and STD. 9186) .....	1	...
009187	... Transfer, for front chaincase (patent) (same as STD.9187) .....	1	...
009188	... Transfer, for tool box (monogram) (same as 38-G3-F385 and STD.9188) .....	2	...
009189	... Transfer, for rear mudguard ("MATCHLESS") (same as 38-G3-F383 and STD.9189) .....	1	...
009192	... Transfer, for front forks (patent) (same as STD.9192) .....	1	...
009195	... Transfer, for petrol tank (reserve) (same as 012973) .....	1	...
009198	... Transfer, for side of oil tank (oil top level indicator) .....	1	...
015282	... Transfer, for forks ("Made in England") .....	1	...
011399	... Transfer, for rear fork hinge (patent) .....	1	...
018090	... Complete set of transfers .....	1	...

### TWIST GRIP

16-117	... Twist grip, complete assembly .....	1	...
16-070	... Grip, rubber, for twist grip .....	1	...
16-091	... Rotor, and sleeve, for twist grip (does not include rubber grip) ...	1	...
16-060	... Body, twist grip, top (plain clip) .....	1	...
16-061	... Body, twist grip, bottom (for friction spring) .....	1	...
11-013	... Screw, long, clamping twist grip body .....	1	...
11-014	... Screw, short, clamping twist grip body .....	1	...
16-008	... Spring, friction, for twist grip .....	1	...
16-009	... Screw, for twist grip friction spring .....	1	...
16-010	... Nut, for twist grip friction spring screw .....	1	...
16-011	... Stop, for twist grip (throttle) cable .....	1	...

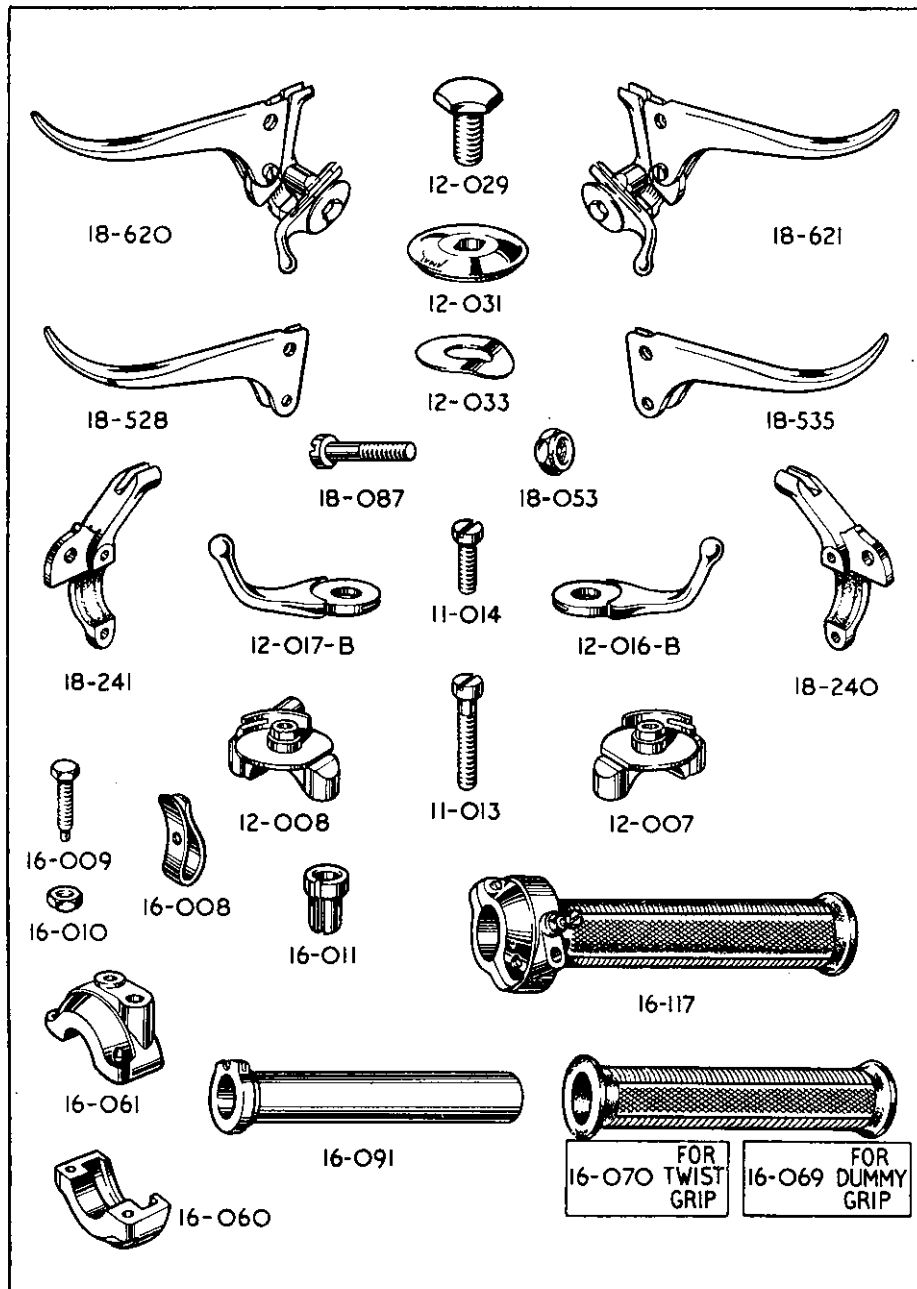

PART NUMBER	DESCRIPTION	QTY. OFF	PRICE EACH
			£ s. d.

### DUMMY GRIP

16-069	Grip, rubber, dummy.....	1	...
--------	--------------------------	---	-----

### CLUTCH AND IGNITION CONTROL LEVERS

18-620	Lever, assembly, clutch and ignition .....	1	...
18-528	Lever only, clutch .....	1	...
12-017-B	Lever only, ignition .....	1	...
18-241	Bracket, for clutch lever .....	1	...
12-008	Bracket, for ignition lever .....	1	...
11-013	Screw, long, clamping clutch and ignition brackets .....	1	...
11-014	Screw, short, clamping clutch and ignition brackets .....	1	...
18-087	Pin, fulcrum, for clutch lever .....	1	...
18-053	Nut, clutch lever fulcrum pin .....	1	...
12-029	Bolt, central, for ignition lever.....	1	...
12-031	Cap, for ignition lever .....	1	...
12-033	Washer, spring, for ignition lever .....	1	...

### BRAKE AND AIR CONTROL LEVERS

18-621	Lever, assembly, brake and air .....	1	...
18-535	Lever, only, brake .....	1	...
12-016-B	Lever, only, air .....	1	...
18-240	Bracket, for brake lever.....	1	...
12-007	Bracket, for air lever .....	1	...
11-013	Screw, long, clamping brake and air brackets .....	1	...
11-014	Screw, short, clamping brake and air brackets .....	1	...
18-087	Pin, fulcrum, for brake lever.....	1	...
18-053	Nut, brake lever fulcrum pin .....	1	...
12-029	Bolt, central, for air lever .....	1	...
12-031	Cap, for air lever.....	1	...
12-033	Washer, spring, for air lever.....	1	...

### FRONT BRAKE CABLE

013178	Cable, complete, assembled, front brake .....	1	...
000530-44	Wire, inner, front brake, 40 $\frac{1}{8}$ ins. finished length (same as 12-44) .....	1	...
017240	Nipple, brake end, for brake inner wire (same as 40-058) .....	1	...
017238	Nipple, handlebar end, for brake inner wire (same as 18-088) .....	1	...
000529-26	Casing, outer, front brake, 26 ins. long (same as 12C-26) .....	1	...
000531	Ferrule, front brake outer casing (same as STD.531) .....	2	...
011348	Adjuster, front brake cable .....	1	...
017217	Nut, lock, front brake cable adjuster (same as 16363).....	1	...
017049	End, yoke, front brake cable (same as 16482) .....	1	...
000736	Pin, for yoke end, front brake cable (same as STD.736) .....	1	...
000014	Pin, split, for front brake cable yoke and pin (same as STD.14).....	1	...
012478	Sleeve, rubber, for front brake cable inner wire .....	1	...

### CLUTCH CABLE

017126	Cable, complete, assembled, clutch .....	1	...
000530-55	Wire, inner, clutch, 54 $\frac{1}{8}$ ins. finished length (same as 12-55) .....	1	...
017241	Nipple, gearbox end, clutch inner wire (same as 4).....	1	...
017238	Nipple, handlebar end, clutch inner wire (same as 18-088) .....	1	...
000529-50 $\frac{3}{8}$	Casing, outer, clutch, 50 $\frac{3}{8}$ ins. long (same as 12C-50 $\frac{3}{8}$ ).....	1	...
000531	Ferrule, clutch outer casing (same as STD.531).....	2	...
014225	Adjuster, clutch cable.....	1	...
000290	Nut, lock, clutch cable adjuster (same as STD.290) .....	1	...

WHEN IN DOUBT REGARDING THE NAMES AND PART  
NUMBERS OF THE PARTS YOU REQUIRE, PLEASE SEND  
THE OLD PARTS TO SERVE AS PATTERNS.

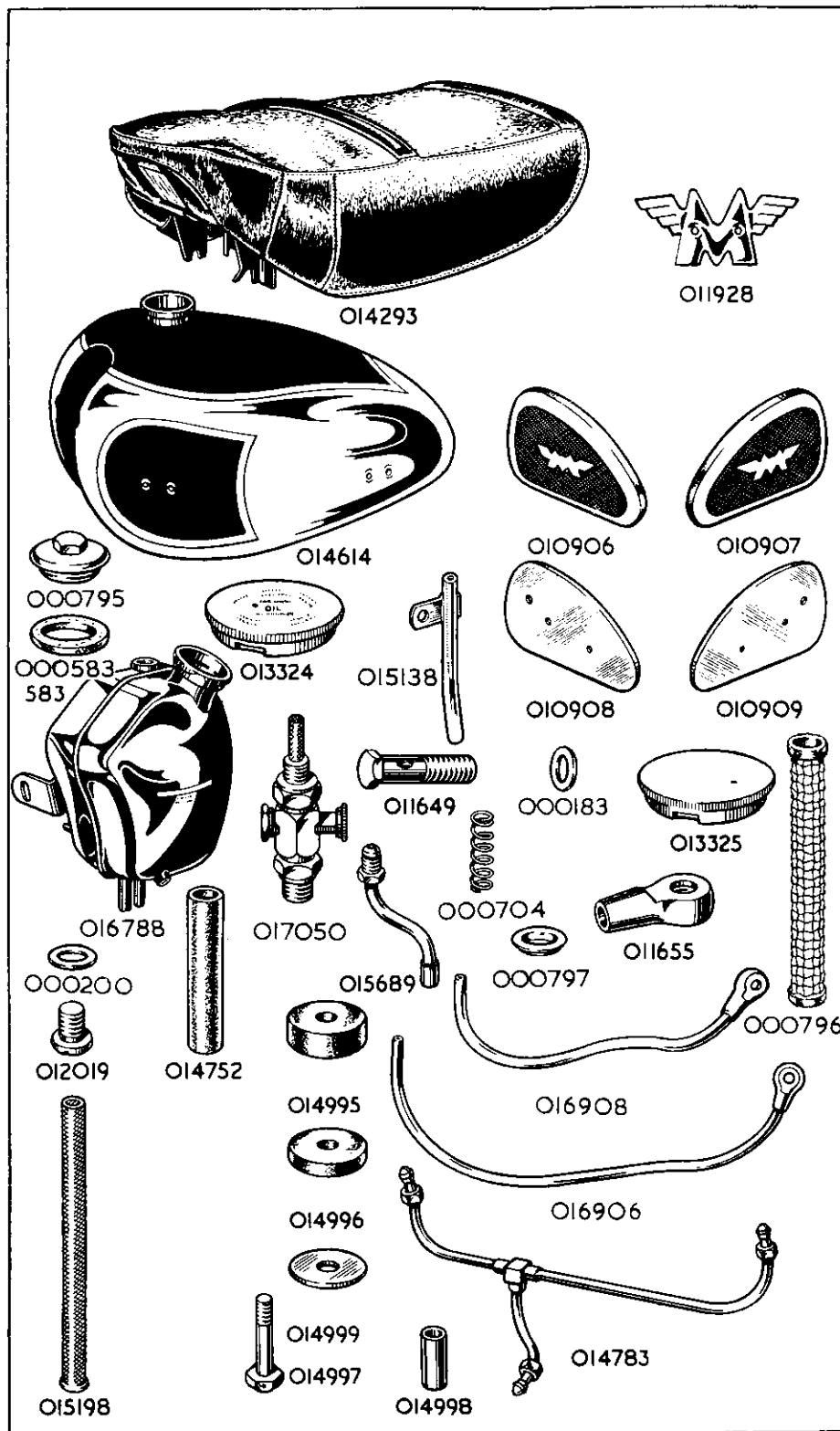

PART NUMBER	DESCRIPTION	QTY. OFF	PRICE EACH		
			£	s.	d.

### THROTTLE CONTROL CABLE

017262	... Cable, complete, assembled, throttle (same as 41-T-2)	1	...		
000535-41	... Wire, inner, throttle, $39\frac{1}{8}$ ins. finished length (same as SW2-41)	1	...		
017242	... Nipple, carburetter end, throttle inner wire (same as 1482)	1	...		
017266	... Nipple, handlebar end, throttle inner wire (same as 12-034)	1	...		
000526-37	... Casing, outer, throttle, $36\frac{1}{2}$ ins. finished length (same as 11C-36 $\frac{1}{2}$ )	1	...		
000528	... Ferrule, throttle outer casing	2	...		

### AIR CONTROL CABLE

017263	... Cable, complete, assembled, air (same as 41-A-1)	1	...		
000527-36	... Wire, inner, air, $35\frac{7}{8}$ ins. finished length (same as 11-36)	1	...		
017242	... Nipple, carburetter end, air inner wire (same as 1482)	1	...		
017266	... Nipple, handlebar end, air inner wire (same as 12-034)	1	...		
000526-32	... Casing, outer, air, $31\frac{3}{4}$ ins. finished length (same as 11C-32)	1	...		
000528	... Ferrule, air, outer casing (same as STD.528)	2	...		

### IGNITION CONTROL CABLE

015190	... Cable, complete, assembled ignition	1	...		
000527-38	... Wire, inner, ignition, finished length $37\frac{1}{2}$ ins. (same as 11-37 $\frac{1}{2}$ )	1	...		
017379	... Nipple, magneto end, ignition inner wire (same as MC-4)	1	...		
017266	... Nipple, handlebar end, ignition inner wire (same as 12-034)	1	...		
000526-25 $\frac{1}{2}$	... Casing, outer, ignition, $25\frac{1}{2}$ ins. long (same as 11C-25 $\frac{1}{2}$ )	1	...		
000526-6	... Casing, outer, ignition, 6 ins. long (same as 11C-6)	1	...		
014828	... Stop, adjustable, for ignition cable	1	...		
000928	... Ferrule, ignition outer casing (same as STD.528)	4	...		
458731	... Cap, rubber, cable entry to magneto	1	...		
458727	... Cap, metal, cable entry to magneto	1	...		
163343	... Washer, fibre, for cable entry metal cap	1	...		
454969	... Plunger, for ignition cable	1	...		
458732	... Spring, return, for ignition cable	1	...		

### PETROL TANK

014614	... Tank, petrol, bare	1	...		
011928	... Letter M and wing emblem	2	...		
000150	... Screw, fixing wing emblem, $\frac{1}{8}$ in. by 3 B.A. (same as STD.150)	4	...		

### PETROL TANK FITTINGS

013325	... Cap, filler, for petrol tank	1	...		
017050	... Tap, for petrol feed, with filter (same as 41-G3L-T93)	2	...		
000200	... Washer, fibre, for petrol feed tap (same as STD.200)	2	...		
010906	... Grip, knee, left hand side (same as 38-G3-T4-L)	1	...		
010907	... Grip, knee, right hand side (same as 38-G3-T4-R)	1	...		
010908	... Plate, for left hand knee grip (same as 38-G3-T34-L)	1	...		
010909	... Plate, for right hand knee grip (same as 38-G3-T34-R)	1	...		
000070	... Bolt, fixing knee grip plate, $\frac{7}{8}$ in. by $\frac{1}{2}$ in. by 26 (same as STD.70)	4	...		
000639	... Spacer, $\frac{11}{16}$ in. long, for knee grip plate bolts (same as STD.639)	4	...		

### PETROL TANK FIXING BOLTS

014997	... Bolt, fixing tank, all positions, $1\frac{1}{4}$ in. by $\frac{5}{8}$ in. by 26	4	...		
014998	... Sleeve, $\frac{1}{8}$ in. long, for tank fixing bolts	4	...		
014995	... Pad, rubber, thick ( $\frac{3}{8}$ in.) for tank fixing bolts in front right and both rear positions	3	...		
014996	... Pad, rubber, thin ( $\frac{1}{8}$ in.), for all tank fixing bolts (three used on front left bolt)	6	...		
014999	... Washer, metal, $1\frac{1}{2}$ in. diameter, plain, for tank fixing bolts	4	...		
017051	... Wire, copper, 5 feet by 20 S.W.G. (same as 41-G3L-T97)	1	...		

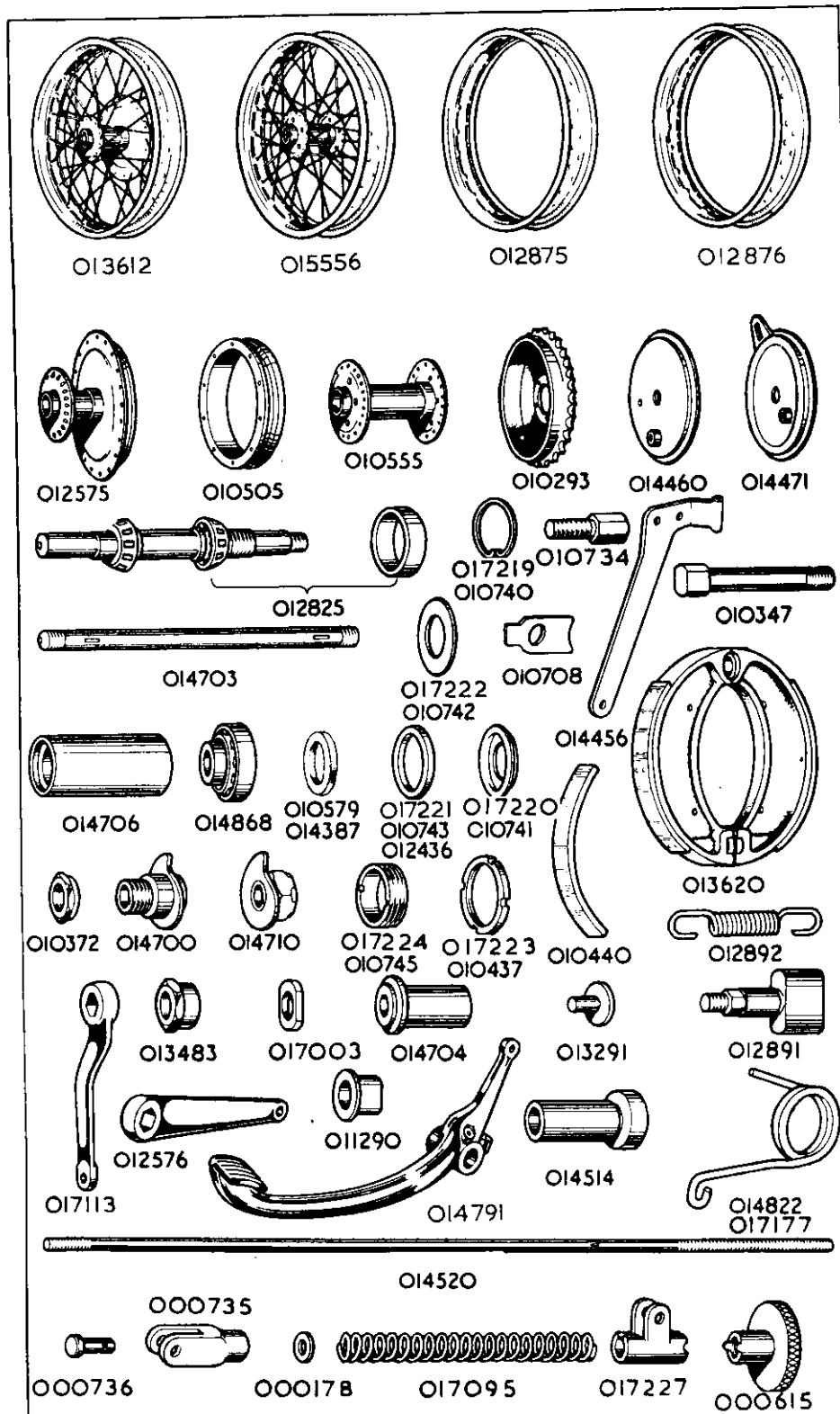

PART NUMBER	DESCRIPTION	QTY. OFF	PRICE EACH £ s. d.
----------------	-------------	-------------	--------------------------

### OIL TANK

016788	... Tank, oil, bare .....	1	...
013324	... Cap, filler, oil tank .....	1	...
012019	... Plug, drain, for oil tank .....	1	...
000200	... Washer, fibre, oil tank drain plug (same as STD.200) .....	1	...
000796	... Filter, felt, for oil tank (same as STD.796) .....	1	...
000704	... Spring, for oil tank felt filter (same as STD.704) .....	1	...
000797	... Cap, metal, dished, for oil tank felt filter (same as STD.797) .....	1	...
000795	... Cap, screwed, oil tank filter compartment (same as STD.795) .....	1	...
000583	... Washer, cork, filter compartment cap (same as STD.583) .....	1	...
<i>For the nuts and washers that retain the oil tank (and the Battery Carrier) to the main frame, see "Battery Carrier" Group.</i>			
<i>For the bolt, washer, and nut fixing the oil tank bracket to the rear mudguard, see "Rear Mudguard" Group.</i>			

### PETROL PIPE

014783	... Pipe, assembled, for petrol feed .....	1	...
<i>The "nipples" on these pipes are formed integrally with the piping. Therefore union nuts cannot be re-moved or re-fitted, and they are not sold as separate spares.</i>			

### OIL PIPES

016906	... Pipe, oil feed assembly .....	1	...
016908	... Pipe, oil return, engine end (long) .....	1	...
015689	... Pipe, oil, return .....	1	...
011655	... Union, banjo, feed and return oil pipes .....	2	...
011649	... Pin, banjo, retaining feed and return oil pipes to engine .....	2	...
000183	... Washer, fibre, for oil pipe banjo pins (same as STD.183) .....	4	...
014752	... Connection, rubber, for feed and return oil pipes .....	2	...
015198	... Filter, metal gauze, for oil feed pipe .....	1	...
014789	... Hose, from crankcase release valve to oil tank .....	1	...
015138	... Pipe, vent, metal .....	1	...
014936	... Hose, from oil tank to metal vent pipe .....	1	...

### FRONT WHEEL

*The complete wheel listed below comprises:—*

*Rim, spokes, nipples, hub, grease nipple, all bearings, and all brake parts including cover plate and expander lever, but does not include the tyre.*

015553	... Wheel, front, complete with all fittings, chrome and red centre .....	1	...
<i>The bare wheel listed below comprises:—</i>			
<i>Rim, spokes, nipples and hub.</i>			
013612	... Wheel, front, bare, less all fittings .....	1	...
012875	... Rim, front, 19 ins. by 2½ ins. ....	1	...
011018	... Spoke, front left, 5½ ins. by 8 G by 10 G (same as 37-X-H51) .....	20	...
011014	... Spoke, front, right, 8½ ins. by 9 G by 11 G (same as 12399) .....	20	...
011017	... Nipple, front, left, .225 in. by 10 G (same as 20680) .....	20	...
011016	... Nipple, front, right, .225 in. by 11 G (same as 20678) .....	20	...
012575	... Hub, front wheel, shell only with brake drum .....	1	...
000051	... Nipple, grease, for front wheel hub (same as STD.51) .....	1	...
011090	... Tape, for 19 ins. by 2½ ins. rim .....	1	...

### FRONT WHEEL BEARINGS

012825	... Spindle, with roller bearings, for front wheel (same as 40-G12M-H10) .....	1	...
010579	... Oil-seal, for front hub bearings .....	2	...
017219	... Ring, spring, locating front hub bearings (same as 11910) .....	1	...
017220	... Cup, for front hub bearing oil-seal (same as 11911) .....	1	...
017221	... Ring, spacing, for front hub bearing oil-seal (same as 11912) .....	1	...
017222	... Ring, retaining front hub bearing oil-seals (same as 11913) .....	3	...
017223	... Nut, lock, for front hub bearing adjusting ring (same as 11914) .....	1	...
017224	... Ring, adjusting, for front hub bearing (same as 11915) .....	1	...
017003	... Nut, locating front brake cover plate (same as 40-G12M-H47) .....	1	...
017222	... Washer, locating, front brake cover plate (same as 11913) .....	1	...
013483	... Nut, outside, securing front brake cover plate .....	1	...
000001	... Nut, front wheel spindle, left side (same as STD.1) .....	1	...
000008	... Washer, plain, front wheel spindle, left side (same as STD.8) .....	1	...

PART NUMBER	DESCRIPTION	QTY. OFF	PRICE EACH £ s. d.
----------------	-------------	-------------	--------------------------

## REAR WHEEL

*The complete wheel listed below comprises:—*

*Rim, spokes, nipples, hub, grease nipple and all bearings assembled, but does NOT include the centre solid spindle, washers, spacers, nuts, brake parts, sprocket and brake drum, speedometer drive and tyre.*

015565 ... Wheel, rear, complete, with all fittings, chrome and red centre ... 1 ...

*The bare wheel listed below comprises:—*

*Rim, spokes, nipples and hub.*

015556 ... Wheel, rear, bare, less all fittings, chrome and red centre..... 1 ...  
012876 ... Rim, rear, 19 ins. by 2½ ins. .... 1 ...  
011012 ... Spoke, rear, left or right, 8½ ins. by 7 G by 9 G  
(same as 39-8-H54) ..... 40 ...  
011013 ... Nipple, rear, left or right, .250 in. by 9 G (same as 12344) ..... 40 ...  
010555 ... Hub, rear wheel, shell only ..... 1 ...  
000051 ... Nipple, grease, for rear wheel hub (same as STD.51) ..... 1 ...  
011090 ... Tape, for 19 ins. rear rim ..... 1 ...

## REAR WHEEL BEARINGS

014868 ... Bearings, roller, for rear hub (only sold as a complete bearing) ... 2 ...  
014387 ... Oil-seal, for rear hub bearings ..... 2 ...  
010740 ... Ring, spring, locating rear hub bearings ..... 1 ...  
010741 ... Cup, for rear hub bearing oil-seal ..... 1 ...  
010743 ... Ring, spacing, for rear hub bearing oil-seal ..... 1 ...  
010742 ... Ring, retaining rear hub bearing oil-seals ..... 3 ...  
012436 ... Collar, spacing, between bearing and rear hub bearing oil-seal ... 2 ...  
014706 ... Spacer, 2⅞ ins. long between the two bearings of rear hub ..... 1 ...  
010745 ... Ring, adjusting, for rear hub bearing ..... 1 ...  
010437 ... Nut, lock, for rear hub bearing adjusting ring ..... 1 ...  
014703 ... Spindle, centre, solid, for rear wheel ..... 1 ...  
014705 ... Spacer, 1⅞ in. long, on rear wheel solid spindle, for speedometer  
gearbox ..... 1 ...  
010372 ... Nut, locking, speedometer gearbox ..... 1 ...  
014704 ... Sleeve, on rear wheel solid spindle, locating brake cover plate..... 1 ...  
014700 ... Cam, on rear wheel solid spindle, right side ..... 1 ...  
014710 ... Cam, on rear wheel solid spindle, left side ..... 1 ...  
000573 ... Key, on rear wheel solid spindle, locating cams (same as STD.573) 2 ...  
011290 ... Collar, on rear wheel solid spindle (abuts against fork end) ..... 2 ...  
014869 ... Nut, for rear wheel solid spindle..... 2 ...

## FRONT BRAKE

010505 ... Drum, front brake ..... 1 ...  
000140 ... Screw, fixing front brake drum to hub shell, ⅜ in. by 1 B.A.  
(same as STD.140) ..... 10 ...  
014460 ... Plate, cover, front brake ..... 1 ...  
014456 ... Stay, front brake cover plate anchor ..... 1 ...  
014807 ... Bolt, fixing anchor stay to front cover plate, ⅝ in. by ⅝ in. by 26..... 1 ...  
014119 ... Washer, special, for anchor stay bolt ..... 1 ...  
013620 ... Shoes, pair of, for front brake, with brake linings and thrust pins  
(only supplied in pairs) (same as 39-8-B71-A) per pair ..... 1 ...  
013291 ... Pin, thrust, brake expander adjusting ..... 2 ...  
000174 ... Washer, plain, for thrust pin (same as STD.174) ..... R ...  
010440 ... Linings, brake, per pair of, less rivets (same as 3836-2) ..... 1 ...  
000113 ... Rivets, for brake linings (same as STD.113), per set of ..... 12 ...  
012892 ... Spring, for brake shoes (same as 16485) ..... 2 ...  
012891 ... Expander, for brake shoes (same as 36-8-B51) ..... 1 ...  
012576 ... Lever, for front brake shoe expander ..... 1 ...  
000051 ... Nipple, grease, for brake shoe expander (same as STD.51) ..... 1 ...  
000174 ... Washer, plain, for brake shoe expander (same as STD.174) ..... 1 ...  
000004 ... Nut, for brake shoe expander (same as STD.4) ..... 1 ...

PART NUMBER	DESCRIPTION	QTY. OFF	PRICE
			EACH £ s. d.

### REAR BRAKE

010293	... Sprocket and brake drum, for rear wheel, 42 teeth, five hole fixing	1	...
010734	... Bolt, retaining sprocket to rear hub, $\frac{3}{8}$ in. by $\frac{5}{16}$ in. by 26 (same as 37-12-H17)	5	...
010708	... Washer, lock, for rear sprocket retaining bolt	5	...
000011	... Washer, plain, for rear sprocket retaining bolt (same as STD.11)	5	...
000074	... Nut, for rear sprocket retaining bolt	5	...
014471	... Plate, cover, rear brake	1	...
010347	... Bolt, anchor, rear brake cover plate, $2\frac{1}{4}$ ins. by $\frac{3}{8}$ in. by 26, with square head	1	...
000003	... Nut, for rear brake cover plate anchor bolt (same as STD.3)	1	...
000006	... Pin, split, for rear brake anchor bolt (same as STD.6)	1	...
013620	... Shoes, pair of, for rear brake, with brake linings and thrust pins (only supplied in pairs) (same as 39-8-B71-A)	1	per pair
013291	... Pin, thrust, brake, expander adjusting	2	...
000174	... Washer, plain, for thrust pin (same as STD.174)	R	...
010440	... Linings, brake, per pair of, less rivets (same as 3836-2)	1	...
000113	... Rivets, for brake linings (same as STD.113)	per set of	12
012892	... Spring, for brake shoes (same as 16485)	2	...
012891	... Expander, for brake shoes (same as 36-8-B-51)	1	...
017113	... Lever, for rear brake shoe expander (same as 38-12-B30)	1	...
000051	... Nipple, grease, for brake shoe expander (same as STD.51)	1	...
000174	... Washer, plain, for brake shoe expander (same as STD.174)	1	...
000004	... Nut, for brake shoe expander (same as STD.4)	1	...

### REAR BRAKE OPERATING PARTS

014791	... Pedal, foot, for rear brake	1	...
014514	... Bush, for rear brake foot pedal	1	...
000051	... Nipple, grease, for rear brake foot pedal (same as STD.51)	1	...
014822	... Spring, return, rear brake foot pedal	1	...
000344	... Bolt, adjusting, rear brake foot pedal, $\frac{3}{8}$ in. by $\frac{1}{4}$ in. by 26 (same as STD.344)	1	...
000005	... Nut, for rear brake, foot pedal adjusting bolt (same as STD.5)	1	...
014520	... Rod, bare, rear brake	1	...
000735	... End, yoke, for front end of brake rod (same as STD.735)	1	...
000736	... Pin, for brake rod yoke end (same as STD. 736)	1	...
000014	... Pin, split, for brake rod yoke end pin (same as STD.14)	1	...
017095	... Spring, for brake rod (same as 36-G3-B18)	1	...
000178	... Collar, for brake rod, spring (same as STD.178)	1	...
017227	... Clip, adjusting, for rear end of brake rod (same as 11772)	1	...
000736	... Pin, for brake rod adjusting clip (same as STD.736)	1	...
000014	... Pin, split, for brake rod adjusting clip pin (same as STD.14)	1	...
000615	... Nut, adjusting, for rear brake rod (same as STD. 615)	1	...

### VOLTAGE REGULATOR

015070	... Regulator, complete unit, type MCR2 (Lucas No. 37144-A)	1	...
000070	... Bolt, fixing regulator unit $\frac{5}{16}$ in. by $\frac{1}{4}$ in. by 26 (same as STD.70)	2	...
000012	... Washer, plain, for regulator fixing bolt (same as STD.12)	2	...
000005	... Nut, for regulator fixing bolt (same as STD.5)	2	...
016519	... Strap, fixing regulator to battery carrier	1	...
000347	... Bolt, securing fixing strap to battery carrier, $1\frac{1}{8}$ in. by $\frac{1}{4}$ in. by 26 (same as STD.347)	1	...
000012	... Washer, plain, for strap fixing bolt (same as STD.12)	3	...
000005	... Nut, for strap fixing bolt (same as STD.5)	1	...

THE PRICES OF SPARES DO NOT  
INCLUDE THE COST OF CARRIAGE

PART NUMBER	DESCRIPTION	QTY. OFF	PRICE EACH £ s. d.
----------------	-------------	-------------	--------------------------

### BATTERY

011255	... Battery, with lid, dry and uncharged. This is a battery that has NOT been filled with electrolyte (acid) and is, of course, not charged. It requires no special packing, and can safely be packed with other goods. (Lucas No. PUW-7E-4). (We do not supply charged batteries—for such apply to nearest Lucas Service Station)	1	...
S-2171	... Lid, only, with rubber pads, for battery	1	...

### HEAD LAMP

50945-A	... Lamp, head, type SSU-700-P, with bulbs, ammeter and switch (no cable harness)	1	...
553248	... Rim, bare, for head lamp	1	...
553268	... Light unit (glass and reflector)	1	...
858542	... Adaptor (bulb holder)	1	...
130251	... Screw, fixing panel to head lamp	3	...
185026	... Washer, spring, for panel fixing screw	3	...
516183	... Fillet, rubber, for head lamp panel	1	...
112201	... Bolt, fixing head lamp to bracket	2	...
137141	... Washer, plain, for head lamp fixing bolts	2	...

See ELECTRICAL SUNDRIES for Ammeter, Switch, Cable Harness and Bulbs.

### REAR LAMP

014674	... Lamp, rear, complete with bulb (Lucas No. 53139-A)	1	...
572595	... Gasket, rubber, for base of rear lamp	1	...
572039	... Grummet, rubber, for rear lamp wire	1	...
572040	... Plug, rubber, for base of rear lamp	1	...
572611	... Glass, red, for rear lamp	1	...
572604	... Frame, over rear lamp, red glass	1	...
572614	... Nut, sleeve, fixing glass frame	1	...
161385	... Washer, rubber, for sleeve nut fixing glass frame on rear lamp	1	...
188818	... Terminal sleeve, for rear lamp wire	2	...
165310	... Nut, rear lamp fixing screw	2	...
185036	... Washer, spring, for rear lamp, fixing screw	2	...

### HORN

015257	... Horn, type HF 1234, with bracket. Lucas replacement number is 069225, but hole in bracket must be opened out to $\frac{11}{16}$ in. diameter	1	...
015245	... Bracket, only, for horn (see note above re opening out hole)	1	...

### ELECTRICAL SUNDRIES

36084	... Ammeter, for head lamp panel	1	...
351551	... Switch, main lighting, for head lamp panel	1	...
351567	... Handle, with screw, for main lighting switch	1	...
380521	... Switch, dipping, for handlebar	1	...
016427	... Switch, horn, for handlebar (Lucas No. 76209)	1	...
994001	... Cable harness, main lighting (no dip switch wire, no horn wire, no regulator wires)	1	...
858795	... Cable harness, triple, for dipping switch	1	...
989981	... Cable harness, for regulator	1	...
359218	... Cable, for horn	1	...
016681	... Sheath, for horn cable	1	...
016682	... Sheath, for dynamo cable	1	...
000543	... Cable, high tension, for sparking plug, price per foot (same as STD.543)	R	...
000541	... Terminal, for high tension cable (same as STD.541)	2	...
000540	... Terminal, for earth cables (same as STD.540)	2	...
900260	... Connector, snap, for rear lamp cable	1	...
900260	... Connector, snap, for regulator to ammeter cable	1	...
571395	... Connector, screwed, for battery positive cable	1	...

PART NUMBER	DESCRIPTION	QTY. OFF	PRICE EACH		
			£	s.	d.

### ELECTRICAL SUNDRIES—continued.

011094	... Bush, rubber, fits in rear mudguard, for rear lamp cable (same as 39-G3-E13)	1	...		
312	... Bulb, head lamp, main, 6 volt, 30 by 24 watts.	1	...		
	Plus Purchase Tax	—	...		
988	... Bulb, head lamp, pilot, 6 volt, 3 watts.	1	...		
	Plus Purchase Tax	—	...		
988	... Bulb, rear lamp, 6 volt, 3 watts., M.B.C., single contact	1	...		
	Plus Purchase Tax	—	...		
015538	... Plug, sparking, KLG, type FE-80	2	...		

### CABLE CLIPS

011907	... Clip, rubber, 1½ in.	6	...		
011908	... Clip, rubber, 3 ins.	4	...		
011909	... Clip, rubber, 4½ ins.	4	...		
018012	... Clip, rubber, 5 ins.	1	...		
014453	... Clip, metal, holding rear lamp wire inside mudguard	1	...		
011382	... Clip, metal, holding rear lamp cable to mudguard edge	3	...		
011094	... Bush, rubber, fits in rear mudguard for rear lamp cable (same as 39-G3-EQ13)	1	...		

### SPEEDOMETER

S-480-3-L	... Head, only, speedometer, trip, 120 M.P.H.	1	...		
S-480-7-L	... Head, only, speedometer, trip, 180 K.P.H.	1	...		
54279-1	... Set of bulb holding parts for head	1	...		
53205	... Bulb, 6 volts, 1.8 watts, M.B.C. for head	1	...		
	Plus Purchase Tax	—	...		
N-1253	... Nut, fixing speedometer head to bracket	2	...		
000012	... Washer, plain, spacing, for head (same as STD.12)	2	...		
W-7216	... Washer, spring, speedometer bracket nut	2	...		
53395-1-65	... Cable, speedometer drive, complete	1	...		
52108-1-65	... Cable, speedometer drive, inner only	1	...		
53398-1-65	... Cable, speedometer drive, outer only	1	...		
011392	... Clip, for speedometer drive, cable (same as 41-G3L-F311)	1	...		
000450	... Screw, fixing speedometer cable clip, ⅜ in. by 2 B.A. (same as STD.450)	1	...		
000190	... Washer, spring, for cable clip screw (same as STD.190)	1	...		
52283-5	... Gearbox, speedometer, complete	1	...		
010696	... Bracket, for speedometer head (same as 40-G12M-FF78)	1	...		
000341	... Bolt, fixing speedometer head to forks, ⅝ in. by ¼ in. by 20 (same as STD.341)	2	...		
000012	... Washer, plain, speedometer bracket bolt (same as STD.12)*	2	...		

### VARIOUS EQUIPMENT

016344	... Set of Pannier bags, with frames and fixing bolts, washers and nuts	1	...		
	Plus Purchase Tax	—	...		
011957	... "TEKALL" Rust preventative ½ pint	R	...		
011958	... "TEKALL" Rust preventative 1 pint	R	...		
CM-16	... Instruction Manual	R	...		
B-M-H	... Badge, monogram, MATCHLESS, for button hole	R	...		
B-M-T	... Badge, monogram, MATCHLESS, for tie	R	...		
B-M-B	... Badge, monogram, MATCHLESS, for brooch fixing	R	...		

PART NUMBER	DESCRIPTION	QTY. OFF	PRICE EACH £ s. d.
----------------	-------------	-------------	--------------------------

### COMPLETE TOOL KITS

015899	... Tool kit, complete, with tyre inflator .....		...
015900	... Tool kit, complete, less tyre inflator .....		...

*The following comprise "TOOL KIT, COMPLETE, WITH TYRE INFLATOR," and is included as part of every motor cycle.*

### TOOLS

017253	... Bag for tools (same as 17520) .....		...
017256	... Screwdriver (same as L-TK-13) .....		...
017248	... Pliers, side cutting (same as L-TK-15) .....		...
011188	... Pliers, for gudgeon pin circlips (same as 11024) .....		...
017246	... Gun, grease (same as L-TK-20) .....		...
017114	... Inflator, tyre (same as 38-G3-EQ2) .....		...
017007	... Lever, tyre (same as 40-G3-TK29) .....		...
017052	... Spanner, double end, $\frac{3}{8}$ in. by $\frac{1}{2}$ in. (same as 41-G3L-TK1) .....		...
017053	... Spanner, double end, $\frac{5}{8}$ in. by $\frac{3}{4}$ in. (same as 41-G3L-TK2) .....		...
017255	... Spanner, triple end, .820 in. by 1.011 in. by 1.2 in. (same as R-TK-3) .....		...
017257	... Spanner, double end, $\frac{3}{4}$ in. by .375 in. (same as 3263) .....		...
017252	... Spanner, box, with tommy, for sparking plug (same as 17634) .....		...
017250	... Spanner, hook, for front hub bearings (same as 11914-5) .....		...
010438	... Spanner, hook, for rear hub bearings .....		...
017249	... Wrench, adjustable (same as L-TK12) .....		...
015023	... Spanner, double end, with gauge, for contacts (Lucas No. 415116) .....		...
015264	... Spanner, single end, for rocker clamping bolts .....		...
015213	... Spanner, box, for cylinder head nuts .....		...
014540	... Spanner, box, with tommy, for rocker box cover nuts .....		...

### SPECIAL TOOLS

011381	... Holder, valve, for valve grinding (same as 36-G8-E384) .....		...
015273	... Extractor, for timing pinion and magneto gear .....		...
015374	... Extractor, for camshaft gears .....		...
015955	... Disc, timing (see Instruction Manual) .....		...

*The above tools are NOT INCLUDED in the equipment of a new motor cycle.*

## SERVICE

The **Service and Repair Department** is situated in **Burrage Grove, Plumstead, London, S.E.18.** **Burrage Grove** is the first turning on the left from Burrage Road when entering Burrage Road from the Plumstead Road. (See final paragraph below.)

The nearest Railway Station is **WOOLWICH ARSENAL, SOUTHERN REGION RAILWAY.** This Station is five minutes' walk from our Service Depot in Burrage Grove. There is an excellent service of electric trains from Charing Cross, Waterloo, Cannon Street and London Bridge Stations, Southern Region Railway.

Bus routes 53, 53a, 54, 99 and 122. Trolleybus routes, 696 and 698, and Tram routes 36, 38 and 40, pass the end of Burrage Road (one minute from the Service Depot).

Bus routes 21a, 75 and 161 and Tram routes 44, 46 and 72 serve **Beresford Square** which is three minutes' walk from the **Service and Repair Department.**

Visitors from the North can pass into Woolwich via the Free Ferry between North Woolwich and Woolwich. North Woolwich is a British Railways terminus and is also served by Bus and Trolleybus routes 101, 569, 669 and 685. There is also a tunnel under the River Thames at this point for foot passengers. The Free Ferry accommodates all types of motor vehicles and there is a very frequent service. The Southern landing stage is less than a mile from the Service Depot.

Visitors arriving by road, if they are strangers to the locality, should enquire for **Beresford Square, Woolwich.** Upon arrival there, the road skirting the Royal Arsenal should be followed in an Easterly direction for about four hundred yards, and Burrage Road is the second turning on the right after leaving the square. Burrage Grove is then the first turning on the left.

## DETAILED INDEX

<b>BRAKES</b> ... ..	Page 40-41	<b>HANDLEBAR</b> ... ..	Page 29
<b>CARBURETTER</b> ... ..	12-14	<b>LEVERS (Control)</b> ... ..	33-35
<b>CABLES (Control)</b> ... ..	35-37	<b>OFFICE INFORMATION</b>	
<b>CARRIER</b> ... ..	31	Guarantee ... ..	3
<b>ELECTRICAL</b>		How to order spares ... ..	2
Battery ... ..	42	Instruction Book ... ..	3
Battery carrier ... ..	32	Repairs ... ..	3
Cable clips ... ..	43	Service ... ..	2
Dynamo ... ..	14	Terms of Business ... ..	2
Horn ... ..	42	<b>PIPES</b>	
Lamp, Head ... ..	42	Exhaust ... ..	17
Lamp, Rear ... ..	42	Oil ... ..	39
Magneto ... ..	14	Petrol ... ..	39
Sundries ... ..	42	<b>SEATS</b> ... ..	33
Voltage Regulator ... ..	41	<b>SERVICE</b>	
<b>ENGINE</b> ... ..	5 to 10	How to reach Factory ... ..	44
<b>ENGINE PLATES</b> ... ..	15	<b>SILENCERS</b> ... ..	17
<b>FOOTRESTS</b> ... ..	33	<b>SPEEDOMETER</b> ... ..	43
<b>FORKS (Front)</b> ... ..	27	<b>STANDS</b> ... ..	29
<b>FORKS (Rear)</b> ... ..	26	<b>TANKS</b> ... ..	37-39
<b>FRAME</b> ... ..	24-26	<b>TELEDRULIC LEG</b> ... ..	26
<b>GASKETS</b> ... ..	17	<b>TOOLS</b> ... ..	43-44
<b>GRIPS</b> ... ..	33-35	<b>TOOL BOXES</b> ... ..	32
<b>GUARDS</b>		<b>TRANSFERS</b> ... ..	33
Chaincase, front ... ..	32	<b>TRANSMISSION</b> ... ..	19 to 24
Chainguard rear ... ..	32	<b>VARIOUS</b> ... ..	43
Mudguard, front ... ..	31	<b>WHEELS</b> ... ..	39-40
Mudguard, rear ... ..	31		
Number plate, front ... ..	31		
Number plate, rear ... ..	31		

PRINTED IN ENGLAND

---

CHAS. F. THORN & SON, LTD  
58-64, Wellington Street  
WOOLWICH, S.E.18

---

2,000-4-51