

SPARES LIST

MATCHLESS

1960, 1961

- 350 MODEL G3 TOURING SINGLE
- 350 MODEL G3C TRIALS SINGLE
- 500 MODEL G80 TOURING SINGLE
- 500 MODEL G80CS MOTO-CROSS SINGLE
- 500 MODEL G9 TOURING TWIN, A-C GENERATOR
- 650 MODEL G12 TOURING TWIN, A-C GENERATOR
- 650 MODEL G12 DELUXE TOURING TWIN, MAGNETO
- 650 MODEL G12CS MOTO-CROSS TWIN
- 650 MODEL G12CSR SPORTS TWIN

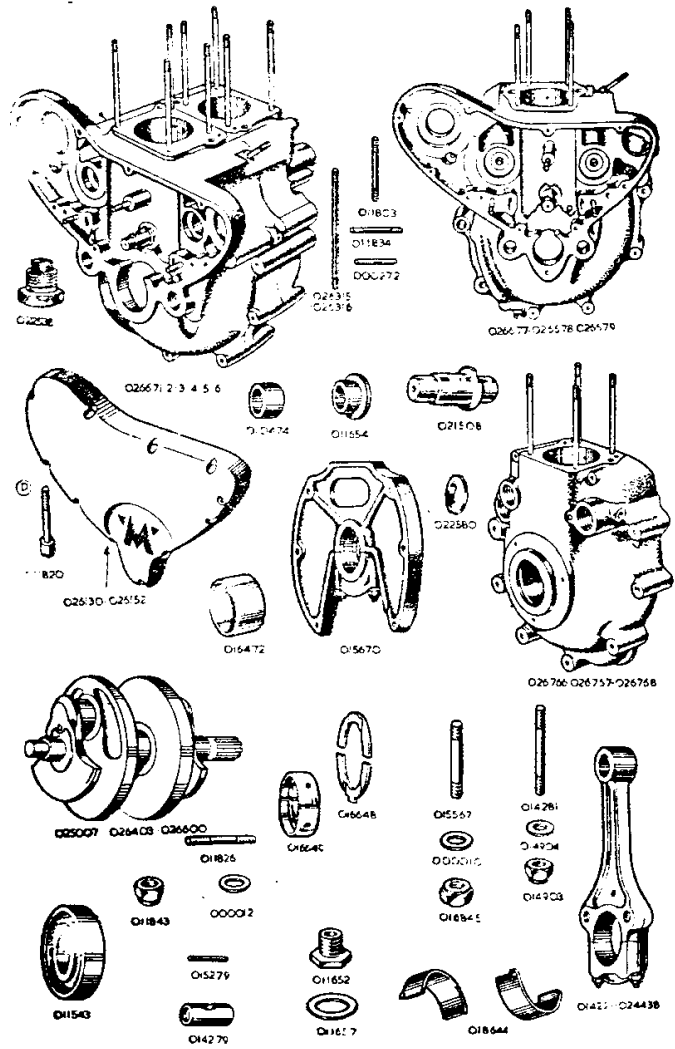

ENGINE SECTION — TWINS

CRANKCASE

026671	...	Crankcase, complete (1)	...	1	G9	26	5	2
026673	...	Crankcase, complete (1)	...	1	G2	27	7	2
026675	...	Crankcase, complete (1)	...	1	G12DL G12CS G12CSR	27	15	6
026766	...	Crankcase, driving side only (2)	...	1	G9	11	0	10
026767	...	Crankcase, driving side only (2)	...	1	G12	11	9	0
026768	...	Crankcase, driving side only (2)	...	1	G12DL G12CS G12CSR	11	2	11
026677	...	Crankcase, timing side only (3)	...	1	G9	13	19	0
026678	...	Crankcase, timing side only (3)	...	1	G12	14	3	2
026679	...	Crankcase, timing side only (3)	...	1	G12DL G12CS G12CSR	15	3	4
015670	...	Web, centre, with cap. studs, nuts and washers	...	1	All	2	5	7
026130	...	Cover, timing gear	...	1	G9, G12	2	6	0
026152	...	Cover, timing gear	...	1	G12DL G12CS G12CSR	2	6	0
011820	...	Screw, timing centre web	...	10	All	10
011826	...	Stud, fixing centre web	...	6	All	4
000012	...	Washer, centre web fixing stud	...	6	All	1
011843	...	Nut, centre web fixing stud	...	6	All	4
015667	...	Stud, centre web cap	...	2	All	1
000010	...	Washer, centre web cap stud	...	2	All	4
016845	...	Nut, centre web cap stud	...	2	All	1
026316	...	Stud in crankcase for cylinder head	...	8	G9	8
026315	...	Stud in crankcase for cylinder head	...	8	G12 G12DL G12CS G12CSR	9
011834	...	Stud, in crankcase, for pump carrying plate	...	3	All	4
000272	...	Stud, in crankcase, for distributor or magneto	...	2	All	5
011803	...	Stud, in crankcase for dynamo strap	...	1	G12DL G12CS G12CSR	4
021508	...	Shaft, in crankcase, for intermediate gear	...	1	All	11
011652	...	Adaptor, for oil feed and return banjo	...	2	All	9
011657	...	Washer, fibre, oil feed and return banjo adaptor	...	2	All	9
010474	...	Bush, plain, for camshafts (in driving side crankcase)	...	2	All	1
011654	...	Bush, flanged, for camshafts (in timing side crankcase)	...	4	All	3
016472	...	Turner, for camshaft chambers (between crankcase halves)	...	2	All	5
011648	...	Cap, inlet camshaft housing	...	1	All	1
023106	...	Washer, copper, camshaft housing cap	...	1	All	3
000340	...	Plug, for dynamo strap stud hole	...	1	G12CS	6
000012	...	Washer, dynamo strap stud hole plug	...	1	G12CS	4

1.—Includes —Driving crankcase. Timing crankcase, centre web with studs (no bearing and washers). Bushes for camshaft. Cylinder studs. Shaft for intermediate gear. Cam follower spindles. Studs for pump plate. Two magneto studs. Dynamo strap stud. Timing gear cover and screws. Three bolts. One stud. Two nuts. Five washers.

2.—Includes —Two camshaft bushes. Four cylinder studs. Cam follower spindles. Six studs for centre web.

3.—Includes —Four camshaft bushes. Four cylinder studs. Shaft for intermediate gear. Three studs for pump plate. Two studs for magneto. One stud for dynamo strap. (No timing gear cover and screws.)

CYLINDERS, PISTONS, HEADS AND VALVES

026037	...	Barrel, cylinder, only	...	2	G9	3	15	0
026038	...	Barrel, cylinder, only	...	2	G12 G12DL G12CS G12CSR	3	15	0
022233	...	Washer, paper, for cylinder base	...	2	All	1
026323	...	Piston, bare, normal size, 8-0 to 1, C.R.	...	2	G9	7
026324	...	Piston, bare, normal size, 7-5 to 1, C.R.	...	2	G12 G12DL	6
026325	...	Piston, bare, normal size, 8-5 to 1, C.R.	...	2	G12CS G12CSR	6
026559	...	Piston, bare, .020 in. oversize, 8-0 to 1, C.R.	...	2	G9	9
026635	...	Piston, bare, .020 in. oversize, 7-5 to 1, C.R.	...	2	G12 G12DL	6
026640	...	Piston, bare, .020 in. oversize, 8-5 to 1, C.R.	...	2	G12CS G12CSR	6
026561	...	Piston, bare, .040 in. oversize, 8-0 to 1, C.R.	...	2	G9	9
026637	...	Piston, bare, .040 in. oversize, 7-5 to 1, C.R.	...	2	G12 G12DL	6
026642	...	Piston, bare, .040 in. oversize, 8-5 to 1, C.R.	...	2	G12CS G12CSR	6
026558	...	Piston, complete, normal size, 8-0 to 1, C.R.	...	2	G9	5
026634	...	Piston, complete, normal size, 7-5 to 1, C.R.	...	2	G12 G12DL	5
026639	...	Piston, complete, normal size, 8-5 to 1, C.R.	...	2	G12CS G12CSR	5
026560	...	Piston, complete, .020 in. oversize, 8-0 to 1, C.R.	...	2	G9	5
026636	...	Piston, complete, .020 in. oversize, 7-5 to 1, C.R.	...	2	G12 G12DL	5
026641	...	Piston, complete, .020 in. oversize, 8-5 to 1, C.R.	...	2	G12CS G12CSR	5
026562	...	Piston, complete, .040 in. oversize, 8-0 to 1, C.R.	...	2	G9	5
026638	...	Piston, complete, .040 in. oversize, 7-5 to 1, C.R.	...	2	G12 G12DL	5

026643	Piston, complete, -040 in. oversize, 8-5 to 1, C.R.	2	G12CS, G12CSR	...	2	13	5
The above complete pistons include:—							
Piston, two compression rings (1 chrome plated), one scraper ring, gudgeon pin, two gudgeon pin circlips.							
018297	Ring, compression, chrome plated, normal size	2	G9	...	5	8	
024239	Ring, compression, chrome plated, normal size	2	G12, G12DL, G12CS, G12CSR	...	5	8	
018298	Ring, compression, chrome plated, -020 in. oversize	2	G9	...	5	8	
024479	Ring, compression, chrome plated, -020 in. oversize	2	G12, G12DL, G12CS, G12CSR	...	5	8	
018299	Ring, compression, chrome plated, -040 in. oversize	2	G9	...	5	8	
024480	Ring, compression, chrome plated, -040 in. oversize	2	G12, G12DL, G12CS, G12CSR	...	5	8	
010631	Ring, compression, plain, normal size	2	G9	...	1	11	

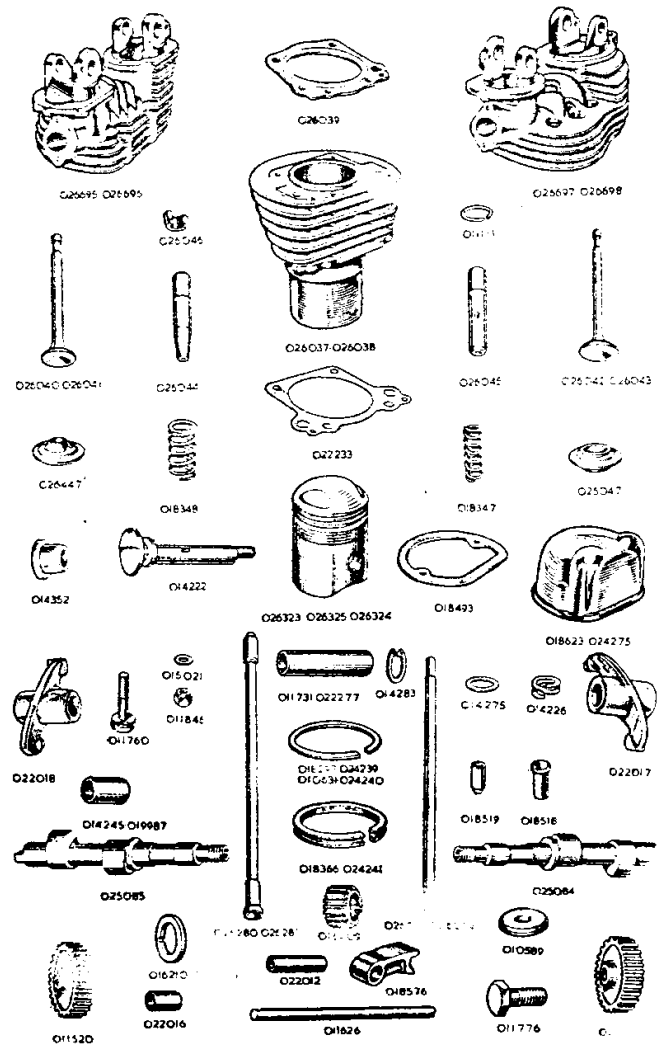

024240	Ring, compression, plain, normal size	2	G12, G12DL, G12CS, G12CSR	...	2	3	
015522	Ring, compression, plain, -020 in. oversize	2	G9	...	1	11	
024481	Ring, compression, plain, -020 in. oversize	2	G12, G12DL, G12CS, G12CSR	...	2	3	
016441	Ring, compression, plain, -040 in. oversize	2	G9	...	1	11	
024482	Ring, compression, plain, -040 in. oversize	2	G12, G12DL, G12CS, G12CSR	...	2	3	
018366	Ring, scraper, normal size	2	G9	...	4	1	
024241	Ring, scraper, normal size	2	G12, G12DL, G12CS, G12CSR	...	7	0	
022677	Ring, scraper, -020 in. oversize	2	G9	...	4	1	
024483	Ring, scraper, -020 in. oversize	2	G12, G12DL, G12CS, G12CSR	...	7	0	
022679	Ring, scraper, -040 in. oversize	2	G9	...	4	1	
024484	Ring, scraper, -040 in. oversize	2	G12, G12DL, G12CS, G12CSR	...	7	0	
011731	Ptn. Gudgeon	2	G9	...	6	4	
022277	Pin, Gudgeon	2	G12, G12DL, G12CS, G12CSR	...	6	4	
014283	Circlip, gudgeon pin	4	All	...	6	4	
026695	Head, cylinder, with valve guides, and Manifold studs, left	1	G9	...	9	5	4
026696	Head, cylinder, with valve guides, and manifold studs, left	1	G12, G12DL, G12CS, G12CSR	...	9	5	4
026697	Head, cylinder, with valve guides, and manifold studs, right	1	G9	...	9	5	4
026698	Head, cylinder, with valve guides, and manifold studs, right	1	G12, G12DL, G12CS, G12CSR	...	9	5	4
026039	Gasket, cylinder head to barrel	2	All	...	3	8	
026040	Valve, inlet	2	G9	...	14	9	
026041	Valve, inlet	2	G12, G12DL, G12CS, G12CSR	...	14	9	
026042	Valve, exhaust	2	G9	...	1	0	3
026043	Valve, exhaust	2	G12, G12DL, G12CS, G12CSR	...	1	0	3
026044	Guide, inlet valve	2	All	...	4	6	
026045	Guide, exhaust valve	2	All	...	4	6	
011111	Circlip, valve guide	4	All	...	1	3	
018347	Spring, for valve, inner	4	All	...	1	9	
018348	Spring, for valve, outer	4	All	...	1	5	
026047	Seat, for valve spring	4	All	...	6	9	
026477	Collar, for valve spring	4	All	...	1	9	
026046	Collar, for valve stem (each in two pieces)	4	All	...	1	9	
000004	Nut, retaining, cylinder and head	8	All	...	4		
000011	Washer, plain, cylinder retaining nut	8	All	...	1		
026058	Stud, inlet manifold, long	2	All	...	4		
010625	Stud, inlet manifold, short	2	All	...	4		
014352	Bush, in head, for rocker spindle	4	All	...	1	2	

RE-BORING

Cylinders may be re-bored to -020 in. or to -040 in. oversize and normal compression pistons (with rings) (one chrome plated) supplied to suit.

... Per pair £6 4 10 (new gudgeon pins and circlips 14s. Od. extra)

... G12 deuxe ... Per pair £6 18 10 (new gudgeon pins and circlips 14s. Od. extra)

... G12CS, G12CSR ... Per pair £6 18 10 (new gudgeon pins and circlips 14s. Od. extra)

Cylinders sent for re-boring should be packed in stout cases which will be used by us for their return. Carriage is additional. If a complete machine, or engine, is sent to us for cylinder re-boring, there will be an additional charge, according to the time taken, for dismantling and assembly.

CRANKSHAFT, CONNECTING RODS AND BEARINGS

025007	Crankshaft, plugged, but bare	1	G9	...	17	6	6
026403	Crankshaft, plugged, but bare	1	G12	...	17	6	6
026600	Crankshaft, plugged, but bare	1	G12DL, G12CS, G12CSR	...	17	6	6
016677	Bearing, plain, for centre web	Pair	All	...	8	7	
016644	Washer, thrust, centre web bearing	2	All	...	1	3	
011543	Bearing, roller, for crankshaft, timing and driving side	2	All	...	2	2	3
024438	rod, connecting, with cap, studs and nuts (no bearings)	2	All	...	4	12	10
018644	Bearing, plain, for connecting rod, each half	4	All	...	7	11	
014281	Stud, for connecting rod	4	All	...	1	2	
014279	Trunnion, for connecting rod	4	All	...	3	10	
015279	Rivet, connecting rod stud	4	All	...	2		
014904	Washer, plain, connecting rod stud	4	All	...	1		
014903	Nut, connecting rod stud	4	All	...	10		

The following undersize bearings can be supplied: It is necessary to have the journals ground to suit.

016670	Bearing, plain, for centre bearing -010 in. undersize (2 halves)	1	All	...	8	7	
016671	Bearing, plain, for centre bearing -020 in. undersize (2 halves)	1	All	...	8	7	
016672	Bearing, plain, for centre bearing -030 in. undersize (2 halves)	1	All	...	8	7	
018564	Bearing, plain, for connecting rod, -010 in. undersize	4	All	...	8	5	
018565	Bearing, plain, for connecting rod, -020 in. undersize	4	All	...	8	5	
018566	Bearing, plain, for connecting rod, -030 in. undersize	4	All	...	8	5	

TIMING GEAR

025064	...	Camshaft, inlet	...	1	All	...	2	10	0
025085	...	Camshaft, exhaust	...	1	All	...	2	10	0
011630	...	Gear, camshaft, 60 teeth	...	2	All	...	1	6	6
000573	...	Key, locating camshaft gear	...	2	All	5
011653	...	Nut, retaining camshaft gear	...	2	All	11
016209	...	Pinion, on crankshaft, 30 teeth	...	1	All	13	3
016210	...	Spacer, $\frac{1}{2}$ in., for crankshaft pinion	...	1	All	1	5
000573	...	Key, locating crankshaft pinion	...	1	All	5
011776	...	Bolt, retaining crankshaft pinion	...	1	All	1	2
010589	...	Washer, plain, crankshaft pinion bolt	...	1	All	7
021506	...	Gear, intermediate, with bush, 60 teeth	...	1	All	...	1	10	8
022016	...	Bush, for intermediate gear	...	1	All	5
018576	...	Follower, for camshaft	...	4	All	19	4
011626	...	Spindle, for camshaft followers	...	2	All	3	10
022102	...	Spacer, $1\frac{1}{2}$ in., between camshaft follower	...	2	All	1	3

ROCKERS AND PUSH RODS

022017	...	Rocker, with bushes (left inlet and right exhaust)	...	2	All	...	1	14	7
022018	...	Rocker, with bushes (right inlet and left exhaust)	...	2	All	...	1	14	7
014245	...	Bush, for rocker (one in each rocker)	...	4	All	3	2
019987	...	Bush, for rocker (one in each rocker)	...	4	All	17	1
014222	...	Spindle for rocker	...	4	All	1
014226	...	Washer, double spring for rocker spindle	...	4	All	2
014275	...	Washer, plain, for rocker spindle	...	12	All	1	10
011760	...	Bolt, clamping rocker spindle	...	4	All	1
015021	...	Washer, plain, rocker spindle clamping bolt	...	4	All	1
011846	...	Nut, rocker spindle clamping bolt	...	4	All	12	0
024275	...	Cover, for rockers	...	4	All	14	11
018623	...	Cover, for rockers	...	4	All	5
018453	...	Gasket, for rocker cover	...	4	All	5
018492	...	Screw, retaining rocker cover	...	8	All	1	5
026280	...	Rod, push, assembled, with ends	...	4	All	7	0
026281	...	Rod, push, assembled, with ends	...	4	All	7	0
026051	...	Rod, push, bare	...	4	All	2	1
026052	...	Rod, push, bare	...	4	All	2	1
018518	...	End, upper, for push rod	...	4	All	3	10
018519	...	End, lower, for push rod	...	4	All	3	1

ENGINE STEADY STAY

026459	...	Stay, engine steady	...	1	All	3	5
000364	...	Bolt, steady stay to frame	...	1	G9	10	5
000362	...	Bolt, steady stay to frame	...	1	G12, G12DL, G12CS, G12CSR	5	5
000011	...	Washer, steady stay/frame bolt	...	1	All	1
025054	...	Spacer, steady stay/frame bolt	...	1	G9	4	4
011484	...	Bolt, steady stay to cylinder head	...	2	All	1	0
022083	...	Nut, steady stay/cylinder head bolt	...	2	All	5	5
000011	...	Washer, plain, steady stay/cylinder head bolt	...	2	All	1
020192	...	Washer, spring, steady stay/cylinder head bolt	...	2	All	1

OIL PUMPS

018037	...	Oil pumps, complete, on carrying plate	...	1	All	8	12	8
019887	...	Oil pump, feed only, assembled	...	1	All	4	0	0
019888	...	Oil pump, return only, assembled	...	1	All	4	5	0
015017	...	Plate, carrying oil pumps, bare (1)	...	1	All	1	0	5
014903	...	Nut, securing pump carrying plate to timing side crankcase	...	3	All	10
000021	...	Washer, plain, for pump carrying plate fixing nut	...	3	All	1
000021	...	Ball $\frac{1}{2}$ in., steel for return pump bleed valve	...	1	All	1
000701	...	Spring, for return pump bleed valve	...	1	All	4
015001	...	Screw, securing return valve spring	...	1	All	2
016137	...	Washer, paper, oval, behind pump carrying plate	...	2	All	1
016138	...	Washer, paper, round, behind pump carrying plate	...	1	All	1
015568	...	Body, oil feed pump, $\frac{1}{2}$ in. gear, $\frac{1}{2}$ in. shaft	...	1	All	14	9	1
015599	...	Pin, dowel, for oil feed pump	...	2	All	17
015576	...	Plate, front, oil feed body	...	1	All	15
015573	...	Plate, back, oil feed body	...	1	All	4
011617	...	Washer, paper, between oil feed pump and carrying plate	...	1	All	1
000453	...	Screw, retaining oil return pump to carrying plate	...	2	All	4
015579	...	Gear, driving, oil return pump, $\frac{1}{2}$ in. wide, $\frac{1}{2}$ in. shaft	...	1	All	14	9	9
015580	...	Gear, driven, for oil return pump, $\frac{1}{2}$ in. wide, $\frac{1}{2}$ in. shaft	...	1	All	12	7	4
015567	...	Body, oil return pump, $\frac{1}{2}$ in. gear, $\frac{1}{2}$ in. shaft	...	1	All	19	4	1
015599	...	Pin, dowel, oil return pump	...	2	All	17
015576	...	Plate, front, oil return body	...	1	All	19
015573	...	Plate, back, oil return body	...	1	All	4

011617	...	Washer, paper, between oil return pump and carrying plate	...	1	All	1
000453	...	Screw, retaining oil return pump to carrying plate	...	3	All	4
015577	...	Gear, driving, oil return pump, $\frac{1}{2}$ in. wide, $\frac{1}{2}$ in. shaft	...	1	All	15
015578	...	Gear, driven, oil return pump, $\frac{1}{2}$ in. wide, $\frac{1}{2}$ in. shaft	...	1	All	13

NOTE 1 Includes the 000021, 000701 and 015001 bleed valve ball, spring and grub screw.

OIL DISTRIBUTOR

022385	...	Distributor, oil	...	1	All	5	8
014247	...	Cap, housing, for oil distributor	...	1	All	4	0

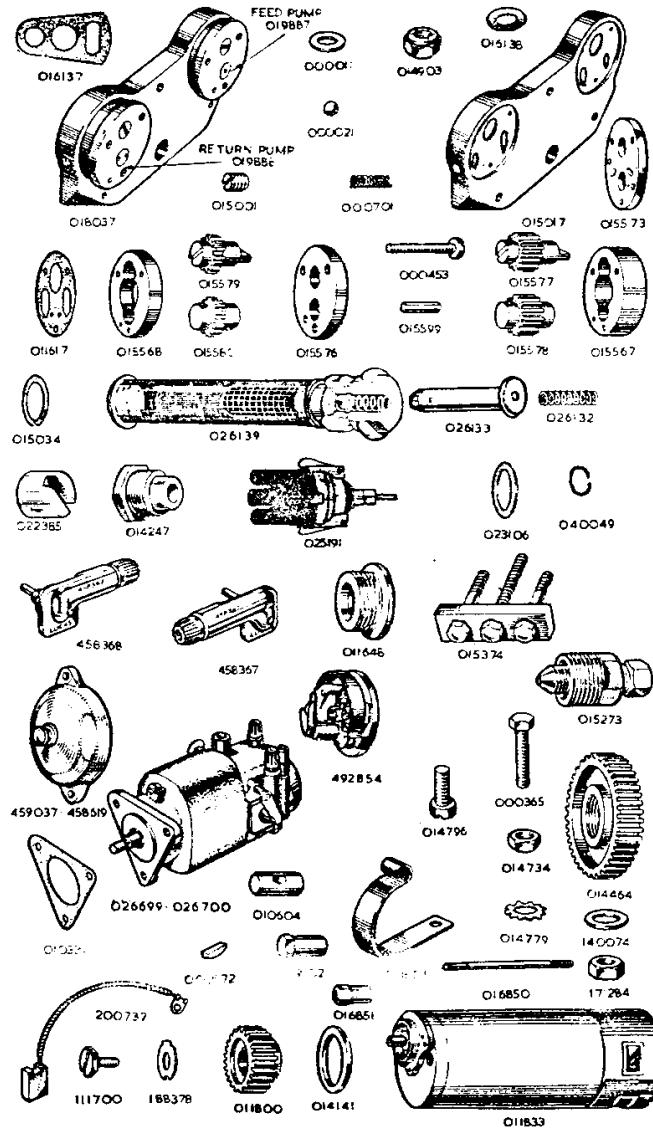

023106	Washer, copper, distributor housing cap	1	All	6
022580	Washer, sealing, crankcase bolt	1	All	11

OIL FELT FILTER AND RELIEF VALVE

026139	Filter, felt, assembled	1	All	1 5 6
023106	Washer, copper, oil filter housing	1	All	6
013034	Gasket, oil filter compartment	1	All	1
026133	Piston, oil pressure relief valve	1	All	2 0
026132	Spring, oil pressure relief valve	1	All	2
026134	Washer, oil pressure relief valve	1	All	3
040049	Circlip, oil pressure relief valve	1	All	1

MAGNETO

026699	Magneto, complete	1	G12DL	1
026700	Magneto, complete	1	G12CS, G12CSR	1
458367	Pick-up, with brush and spring, right	1	G12DL, G12CS, G12CSR	6 6
458368	Pick-up, with brush and spring, left	1	G12DL, G12CS, G12CSR	6 6
452854	Contact breaker, complete	1	G12DL, G12CS, G12CSR	16 0
54440886	Contact set	1	G12DL, G12CS, G12CSR	7 6
459037	Cover, for contact breaker	1	G12DL	7 6
458619	Cover, for contact breaker	1	G12CS, G12CSR	8 9
010339	Gasket, for magneto or distributor flange	1	All	1
000365	Bolt, fixing magneto or distributor	1	All	10
000004	Nut, fixing magneto or distributor	3	All	4
D14779	Washer, spring, for magneto or distributor studs or bolt	3	All	1
014464	Gear, only, magneto	1	G12DL, G12CS, G12CSR	2 1 0
025031	Gear, only, for distributor	1	G9, G12	15 0
143074	Washer, plain on magneto shaft	1	G12DL, G12CS, G12CSR	1
171284	Nut, on magneto shaft, retaining magneto gear	1	G12DL, G12CS, G12CSR	6

DYNAMO

011833	Dynamo, type E3L-L-1-0 (Lucas 2009B)	1	G12DL, G12CS, G12CSR	1
200826	Cover, end assembly	1	G12DL, G12CS, G12CSR	2 3
200737	Brush, set, for dynamo	1	G12DL, G12CS, G12CSR	3 0
014141	Gasket between dynamo and crankcase	1	G12DL, G12CS, G12CSR	2
011801	Strap, retaining dynamo to crankcase	1	G12DL, G12CS, G12CSR	1 2
014796	Screw, lower end of dynamo strap to crankcase	1	G12DL, G12CS, G12CSR	3
000012	Washer, Dynamo strap lower screw	1	G12DL, G12CS, G12CSR	1
010604	Crosshead, dynamo retaining screw	1	G12DL, G12CS, G12CSR	10
011802	Nut, tensioning, dynamo strap (the stud for this nut is listed under crankcase)	1	G12DL, G12CS, G12CSR	5
000012	Washer, for dynamo strap tensioning nut	1	G12DL, G12CS, G12CSR	1
011800	Gear, on dynamo shaft	1	G12DL, G12CS, G12CSR	12 10
000572	Key, for dynamo gear	1	G12DL, G12CS, G12CSR	4
F11700	Bolt, retaining gear on dynamo shaft	1	G12DL, G12CS, G12CSR	6
18E37B	Washer, lock, dynamo gear retaining bolt	1	G12DL, G12CS, G12CSR	2
016850	Stud, drawing dynamo to crankcase	1	G12DL, G12CS, G12CSR	5
016851	Nut, dynamo draw stud	1	G12DL, G12CS, G12CSR	1 2

*Price on application

ENGINE SPROCKETS (SOLO)

023266	Sprocket, engine, only, 21 teeth	1	G9, G12CS	1 9 0
023474	Sprocket, engine, only, 23 teeth	1	G12, G12DL, G12CSR	1 9 4
023163	Spacer (collar), engine sprocket	1	All	13 3
025034	Spacer, Generator rotor	1	G9, G12	1 6
025267	Washer, lock, generator rotor	1	G9, G12	3
023268	Washer, tab, engine sprocket	1	G12DL, G12CS, G12CSR	7
025298	Valve, release, assembled	1	G9, G12	5 9
025526	Valve, release, assembled	1	G12DL, G12CS, G12CSR	8 0

The following alternative engine sprockets can be supplied:—

023261	Sprocket, engine, only, 18 teeth	1	All	1 8 5
023264	Sprocket, engine, only, 19 teeth (1)	1	All	1 8 5
023265	Sprocket, engine, only, 20 teeth	1	All	1 8 9
023266	Sprocket, engine, only, 21 teeth (2)	1	All	1 9 0
023267	Sprocket, engine, only, 22 teeth	1	All	1 9 4

(1) For sidecar on Model G9.
(2) For sidecar on Models G12, G12 deluxe, G12CSR.

GASKETS

Engine gaskets are supplied as separate spares and in complete sets. Single gaskets are listed in the groups to which they belong. Gaskets in sets are listed on pages 65 and 66.

ENGINE PLATES AND CRANKCASE BOLTS

014292	Bolt, clamping crankcase throat	3	All	1 2
000011	Washer, plain, for 014292 bolt	2	All	1
000277	Stud, for crankcase bottom, front	1	All	10
000004	Nut, for crankcase bottom front stud	2	All	4
000011	Washer, plain, for crankcase bottom front stud	2	All	1

PART NUMBER	DESCRIPTION	QTY.	USED ON	PRICE EACH £ s. d.
026127	Plate, engine, front	1	All	6 3
021086	Stud, front engine plate to frame	1	All	1 1
000003	Nut, front engine plate to frame stud	2	All	4
000010	Washer, front engine plate to frame stud	2	All	1
026213	Spacer, front engine plate	1	All	4 3
026229	Spacer, front engine plate lug	1	All	5
000278	Stud, front engine plate to crankcase, top and bottom	2	All	10
000004	Nut, front engine plate to crankcase stud	4	All	4
000011	Washer, plain, front engine plate to crankcase stud	4	All	1
022291	Plate, engine, rear, left	1	G9, G12, G12DL	7 9
023643	Plate, engine, rear, left	1	G12CS, G12CSR	9 0
022292	Plate, engine, rear, right	1	G9, G12, G12DL	7 11
023644	Plate, engine, rear, right	1	G12CS, G12CSR	10 3
000278	Stud, rear engine plate, through crankcase, top and bottom	2	All	10
000004	Nut, rear engine plate, through crankcase stud	4	All	4
000011	Washer, plain, rear engine plate, through crankcase stud	4	All	1
024276	Stud, through centre of engine plates and chaincase	1	All	11
000002	Nut, engine plate and chaincase stud	2	All	5

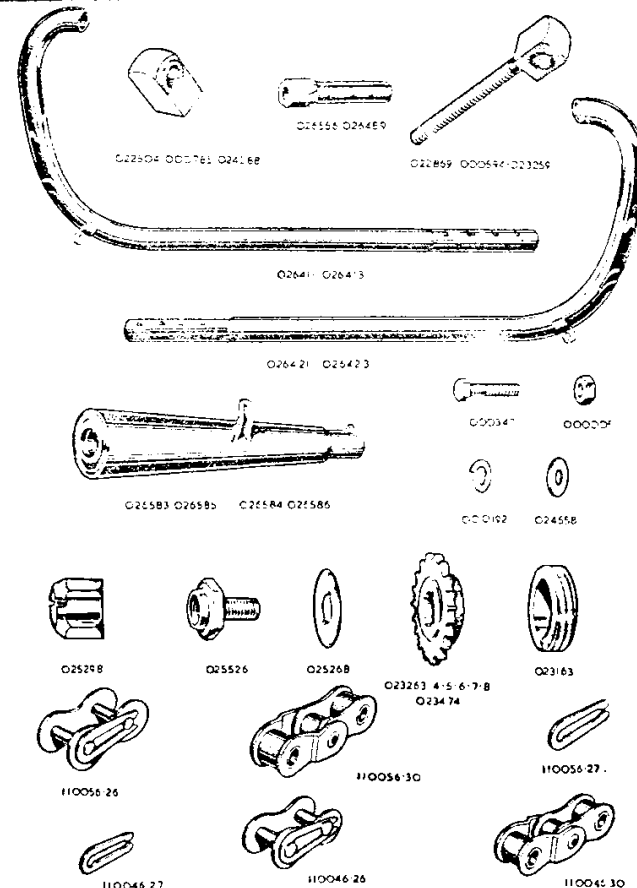

000009	Washer, plain, engine plate and chaincase stud	2	All	2
00	Stud, rear engine plate and frame lug	2	All	10
000053	Nut, rear engine plate and frame lug stud	4	All	4
025317	Cover, rear engine plates	1	G9, G12	13 6
022422	Cover, rear engine plates	1	G12DL, G12CS, G12CSR	3 3
026334	Shield, crankcase	1	G12CS	13 3

EXHAUST PIPES AND SILENCERS

026411	Pipe, exhaust, bare, left side	1	G9	1 18 6
026413	Pipe, exhaust, bare, left side	1	G12, G12DL	1 18 6
026415	Pipe, exhaust, bare, left side	1	G12CS, G12CSR	1 8 3
026421	Pipe, exhaust, bare, right side	1	G9	1 18 6
026423	Pipe, exhaust, bare, right side	1	G12, G12DL	1 18 6
026425	Pipe, exhaust, bare, right side	1	G12CS, G12CSR	1 19 10
026556	Support, exhaust pipe, left side	1	G9, G12, G12DL	3 8
026489	Support, exhaust pipe, right side	1	G9, G12, G12DL	3 6
025252	Support, exhaust pipe	1	G12CS, G12CSR	5 6
000362	Bolt, exhaust pipe support	2	G9, G12, G12DL	5 5
000511	Washer, plain, exhaust pipe support bolt	2	All	1 1
000192	Washer, spring, exhaust pipe support bolt	2	G9, G12, G12DL	1 1
000004	Nut, exhaust pipe support	1	G12CS, G12CSR	4 4
000347	Bolt, exhaust pipe clamping lug	1	G12CS, G12CSR	5 4
000005	Nut, exhaust pipe clamping lug bolt	1	G12CS, G12CSR	4 4
024558	Washer, exhaust pipe clamping lug bolt	2	G12CS, G12CSR	2 7 9
026583	Silencer, only, bare, left side	1	G9	2 7 9
026585	Silencer, only, bare, left side	1	G12, G12DL	2 7 9
026584	Silencer, only, bare, right side	1	G9	2 7 9
026586	Silencer, only, bare, right side	1	G12, G12DL	2 7 9
026590	Silencer, only, bare, right side	1	G12CS, G12CSR	3 19 2
000347	Bolt, clamping silencer to exhaust pipe	2	G9, G12, G12DL	5 5
000005	Nut, silencer clamping bolt	2	G12CS, G12CSR	4 4
000005	Nut, silencer clamping bolt	1	G12CS, G12CSR	4 4
024558	Washer, silencer clamping bolt	4	G9, G12, G12DL	1 1
024558	Washer, silencer clamping bolt	2	G12CS, G12CSR	1 1
024176	Bolt, silencer stay, to frame	1	G12CS	9 9
000008	Washer, large, silencer stay to frame bolt	1	G12CS	2 2
000010	Washer, small, silencer stay to frame bolt	1	G12CS	1 1
000003	Nut, silencer stay to frame bolt	1	G12CS	4 4
016768	Stud, silencer	2	G9, G12, G12DL	5 4
000004	Nut, silencer fixing stud	2	G9, G12, G12DL	1 1
000011	Washer, plain, silencer fixing stud	2	G9, G12, G12DL	1 1
000192	Washer, spring, silencer fixing stud	2	G9, G12, G12DL	1 1
000192	Washer, spring, silencer fixing stud	1	G12CS, G12CSR	1 1

ENGINE SECTION — SINGLES

CYLINDER BARREL

024000	Barrel, cylinder	1	G3	3 16 4
024207	Barrel, cylinder	1	G80	4 3 6
022649	Barrel, cylinder	1	G3C	8 16 10
022298	Barrel, cylinder	1	G80CS	9 12 3
023285	Plate, compression $\frac{1}{16}$ in. thick (not standard fitting)	R	G3	4 4
023286	Plate, compression $\frac{1}{8}$ in. thick (not standard fitting)	R	G80	4 4
023027	Washer, paper, cylinder base	1	G3, G80	1 1
015381	Washer, paper, cylinder base	1	G80CS	1 1
022515	Washer, paper, cylinder base	1	G80CS	2 2
000217	Nut, retaining cylinder to crankcase	4	G3, G80	11 11
015351	Nut, sleeve, retaining cylinder head	4	G3C, G80CS	4 2
000008	Washer, plain, cylinder retaining sleeve nut,	4	G3C, G80CS	2 2

CYLINDER HEAD

022711	Head, cylinder, with valve guides	1	G3	8 15 11
022769	Head, cylinder, with valve guides	1	G3C	9 2 1
026701	Head, cylinder, with valve guides	1	G80	10 12 0
026702	Head, cylinder, with valve guides	1	G80CS	10 17 4
010643	Screw, hex, adjusting, inlet valve oil feed	1	All	11 11
011373	Nut, lock, hex, adjusting screw	1	All	2 2
010932	Bolt, securing head to barrel $3\frac{3}{8}$ in. by $\frac{3}{8}$ in. by 26 x 22 T.P.I.	4	G3, G80	2 1
000010	Washer, plain, cylinder head bolt	4	G3, G80	1 1
013793	Gasket, cylinder head	1	G3, G80	2 1
080291	Stud, fixing carburettor	2	G3, G3C, G80	5 5
023653	Screw, Allen, carburettor manifold	2	G3, G3C	1 5
000004	Nut, carburettor fixing stud	2	G3, G3C, G80	4 4

ENGINE VALVES

013985	Valve, inlet	1	G3, G3C	13 11
026028	Valve, inlet	1	G80, G80CS	16 3
013986	Valve, exhaust	1	G3	13 11
018103	Valve, exhaust	1	G3C	1 2 1

026029	Valve, exhaust	1	G80, G80CS	1 6
016962	Spring, valve, inlet	2	G3, G3C, G80	9 10
026861	Spring, valve, inlet	2	G80CS	12 8
016963	Spring, valve, inlet prong	2	G3, G3C, G80	9 10
026862	Spring, valve, inlet prong	2	G80CS	12 8
013990	Collar, valve spring, inlet and exhaust	2	G3, G3C, G80	6 5
014044	Collar, valve spring, inlet and exhaust	2	G80CS	11 5
000686	Collar, for valve spring, inlet and exhaust (each in two pieces)	2	G3, G3C	1 10
014042	Collar, for valve spring, inlet and exhaust (each in two pieces)	2	G80, G80CS	11 3
023355	Seat, for valve spring	2	All	6 3
017019	Guide, inlet valve	1	G3, G3C	6 3
016030	Guide, inlet valve	1	G80, G80CS	5 0
022208	Guide, exhaust valve	1	G3, G3C	6 3
024519	Guide, exhaust valve	1	G80, G80CS	9 0
011111	Circlip, exhaust valve guide	1	All except G80CS	1 1
011111	Circlip, valve guides	2	G80CS	1 1

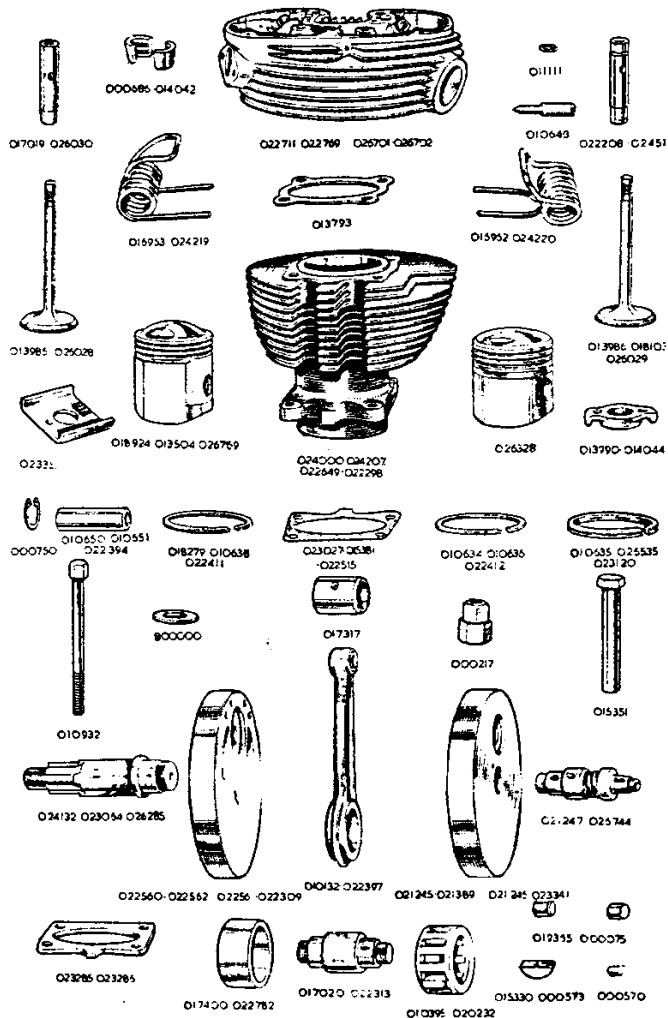

PART NUMBER	DESCRIPTION	QTY.	USED ON	PRICE EACH
-------------	-------------	------	---------	------------

PISTONS

018925	Piston, complete	1	G3	2 10 0
018301	Piston, complete	1	G3C	2 8 0
026790	Piston, complete	1	G80	2 19 0
026645	Piston, complete	1	G80CS	3 5 5
018924	Piston, bare	1	G3	1 9 7
013504	Piston, bare	1	G3C	1 9 11
026769	Piston, bare	1	G80	1 16 1
026328	Piston, bare	1	G80CS	1 17 6
018279	Ring, compression, chrome plated	1	G3, G3C	6 5
010638	Ring, compression, chrome plated	1	G80	6 5
022411	Ring, compression, chrome plated	1	G80CS	6 5
010634	Ring, compression, plain	1	G3, G3C	2 3
010636	Ring, compression, plain	1	G80	2 3
022412	Ring, compression, plain	1	G80CS	2 3
010635	Ring, scraper	1	G3, G3C	3 5
026535	Ring, scraper	1	G80	4 2
023120	Ring, scraper	1	G80CS	4 2
010650	Pin, gudgeon	1	G3, G3C	8 11
010651	Pin, gudgeon	1	G80	6
022394	Pin, gudgeon	1	G80CS	8 3
006750	Circlip, gudgeon pin	2	All	10

"Piston, complete" includes—Piston, one ordinary compression ring, one chrome plated compression ring, one scraper ring, one gudgeon pin and circlips

The following oversize parts can be supplied:—

018948	Piston, complete, -020 in. oversize	1	G3	2 10 0
018949	Piston, complete, -040 in. oversize	1	G3	2 10 0
018302	Piston, complete, -020 in. oversize	1	G3C	2 8 0
018303	Piston, complete, -040 in. oversize	1	G3C	2 8 0
026772	Piston, complete, -020 in. oversize	1	G80	2 19 0
026774	Piston, complete, -040 in. oversize	1	G80	2 19 0
026667	Piston, complete, -020 in. oversize	1	G80CS	3 5 5
026669	Piston, complete, -040 in. oversize	1	G80CS	3 5 5
018929	Piston, bare, -020 in. oversize	1	G3	1 9 7
018930	Piston, bare, -040 in. oversize	1	G3	1 9 7
013621	Piston, bare, -020 in. oversize	1	G3C	1 9 11
014723	Piston, bare, -040 in. oversize	1	G3C	1 9 11
026771	Piston, bare, -020 in. oversize	1	G80	1 16 1
026773	Piston, bare, -040 in. oversize	1	G80	1 16 1
026666	Piston, bare, -020 in. oversize	1	G80CS	1 17 6
026668	Piston, bare, -040 in. oversize	1	G80CS	1 17 6
018280	Ring, compression, -020 in. oversize, chrome plated	1	G3, G3C	5 8
018281	Ring, compression, -040 in. oversize, chrome plated	1	G3, G3C	5 8
016449	Ring, compression, -020 in. oversize, chrome plated	1	G80	6 5
016450	Ring, compression, -040 in. oversize, chrome plated	1	G80	6 5
022813	Ring, compression, -020 in. oversize, chrome plated	1	G80CS	6 5
022814	Ring, compression, -040 in. oversize, chrome plated	1	G80CS	6 5
016443	Ring, compression, -020 in. oversize, plain	1	G3, G3C	2 3
016444	Ring, compression, -040 in. oversize, plain	1	G3, G3C	2 3
013661	Ring, compression, -020 in. oversize, plain	1	G80	2 8
016447	Ring, compression, -040 in. oversize, plain	1	G80	2 8
022815	Ring, compression, -020 in. oversize, plain	1	G80CS	2 8
022816	Ring, compression, -040 in. oversize, plain	1	G80CS	2 8
016445	Ring, scraper, -020 in. oversize	1	G3, G3C	3 5
016446	Ring, scraper, -040 in. oversize	1	G3, G3C	3 5
026713	Ring, scraper, -020 in. oversize	1	G80	4 2
026714	Ring, scraper, -040 in. oversize	1	G80	4 2
023558	Ring, scraper, -020 in. oversize	1	G80CS	8 11
023559	Ring, scraper, -040 in. oversize	1	G80CS	8 11

RE-BORING

Cylinders may be re-bored to -020 in. or to -040 in. oversize and normal compression pistons (with rings) (one chrome plated) supplied to suit.

G3	£3 3 11 (new gudgeon pin and circlips 9s. 2d. extra)
G3C	£3 4 3 (new gudgeon pin and circlips 9s. 2d. extra)
G80	£3 12 4 (new gudgeon pin and circlips 9s. 8d. extra)
G80CS	£3 18 6 (new gudgeon pin and circlips 9s. 11d. extra)

FLYWHEELS

022560	Flywheel, bare, driving side	1	G3	1 13 11
022562	Flywheel, bare, driving side	1	G3C	1 16 4

022561	Flywheel, bare, driving side	1	G80	1 13 11
022309	Flywheel, bare, driving side	1	G80CS	6 6 4
021245	Flywheel, bare, timing side	1	G3	1 17 7
021389	Flywheel, bare, timing side	1	G3C	1 17 7
021246	Flywheel, bare, timing side	1	G80	1 17 7
023341	Flywheel, bare, timing side	1	G80CS	6 14 6
021247	Axle, timing side flywheel	1	G3, G3C, G80	1 5 3
026744	Axle, timing side flywheel	1	G80CS	1 12 2
024132	Axle, driving side flywheel	1	G3, G80	1 10 0
023064	Axle, driving side flywheel	1	G3C	1 19 1
026285	Axle, driving side flywheel	1	G80CS	1 19 1
000573	Key, driving side axle	2	All	5
021249	Nut, timing side axle	1	G3, G3C, G80	11
000234	Nut, driving side axle	1	G3, G3C, G80	1 11
000573	Key, timing side axle	1	G80CS	5

CONNECTING ROD

010312	Rod, connecting, with liner and bush	1	G3, G3C, G80	2 19 0
022397	Rod, connecting, with liner and bush	1	G80CS	2 19 0
017400	Liner, for big end bearing	1	G3, G3C, G80	11 4
022782	Liner, for big end bearing	1	G80CS	11 4
017317	Bush, gudgeon pin	1	All	6 6
017020	Crankpin, only	1	G3, G3C, G80	1 6 4
022313	Crankpin, only	1	G80CS	1 16 3
000075	Roller, for crankpin, 1/2 in. by 1/2 in.	30	G3, G3C, G80	4
019365	Roller, for crankpin, 1/2 in. by 1/2 in.	14	G80CS	10
010395	Cage, for crankpin roller	1	G3, G3C, G80	18 9
020232	Cage, for crankpin roller	1	G80CS	18 8
000233	Nut, for crankpin	2	G3, G3C, G80	2 1
023345	Nut, for crankpin	2	G80CS	5 2
022401	Washer, for crankpin	2	G80CS	4 4
000573	Key, for crankpin	1	G80CS	5

CRANKCASE

026715	Crankcase, complete (1)	1	G3, G80	11 13 0
023534	Crankcase, complete (2)	1	G3C	13 16 6
026716	Crankcase, complete (3)	1	G80CS	14 1 8
026717	Crankcase, driving side only (4) (6)	1	G3, G80	3 6 11
023537	Crankcase, driving side only (4) (6)	1	G3C	4 9 5
026718	Crankcase, driving side only (4) (6)	1	G80CS	4 1 3
026618	Crankcase, timing side only (5) (6)	1	G3, G80	8 6 1
026619	Crankcase, timing side only (5) (6)	1	G3C	9 7 1
026620	Crankcase, timing side only (5) (6)	1	G80CS	10 0 5
022538	Filter, magnetic	1	All	8 2
009182	Washer, magnetic filter	1	All	1
000485	Screw, plug, crankcase oil holes	3	All	1
000203	Washer, fibre, for oil hole screw	3	All	1
000300	Stud, cylinder base	4	G3, G80	5
015350	Stud, cylinder	4	G3C	7 2
022516	Stud, cylinder	4	G80CS	7 4
000577	Dowel, locating timing gear cover	2	All	1
024016	Case, timing	1	G3, G80	1 5 10
018306	Cover, timing gear, with bushes	1	G3C, G80CS	2 0 5
017182	Washer, paper, timing case or timing gear cover	1	All	4
000482	Screw, for timing case or timing gear cover	5	All	4
000765	Cap, in timing case or timing gear cover for cam bush	1	All	5
024018	Cover, timing case	1	G3, G80	15 6
016864	Cover, magneto chain	1	G3C, G80CS	3 5
000453	Screw, timing case cover	2	G3, G80	4
000455	Screw, magneto chain cover	8	G3C, G80CS	4
024159	Grommet, timing case cover	1	G3, G80	2
000486	Plug, oil return	1	All	4

NOTE 1 Comprises 026717 and 026618.

NOTE 2 Comprises 023537 and 026619.

NOTE 3 Comprises 026718 and 026620.

NOTE 4 Comprises crankcase half and two cylinder studs.

NOTE 5 Comprises crankcase half, bush for timing side flywheel axle, two camshaft bushes, two cylinder studs and two dowel pins for timing gear cover.

NOTE 6 Values of crankcases must be "matched" in the factory, therefore it is necessary to send the sound half of the crankcase when ordering a new half.

CRANKCASE BEARINGS

021962	Bush, timing side flywheel axle	1	G3, G3C, G80	14 2
023346	Bush, timing side flywheel axle	1	G80CS	12 11
022351	Race, outer, with rollers, timing side axle	1	G80CS	1 8 10
022352	Race, inner, timing side axle	1	G80CS	6 8
012233	Peg, securing, timing side axle bush	1	All	1
021872	Bearing, ball, inner, for driving side axle, 1 in. by 2 1/2 in. by 1/2 in.	1	All	1 5 11
026762	Bearing, ball, outer, for driving side axle, 1 in. by 2 1/2 in. by 1/2 in.	1	All	1 2 0

021859	Washer, spacing between bearings	1	All	2
000651	Bush, for exhaust camshaft in crankcase	1	All	4 4
000651	Bush, for inlet camshaft in crankcase	1	All	4 4
000651	Bush, for exhaust camshaft in timing case	1	G3, G80	4 4
000652	Bush, for exhaust camshaft in timing gear cover	1	G3C, G80CS	4 4
024329	Bush, for inlet camshaft in timing case	1	G3, G80	4 4
000651	Bush, for inlet camshaft in timing gear cover	1	G3C, G80CS	4 4
024287	Seal, oil, inlet cam	1	G3, G80	1 9

CRANKCASE BOLTS, ENGINE PLATES

000277	Stud, crankcase, bottom, front	1	All	10
000288	Stud, crankcase, bottom, rear	1	All	10
000004	Nut, crankcase, bottom front and rear stud	4	All	4
000011	Washer, plain, crankcase, bottom front and rear stud	4	All	1
024208	Plate, engine, front	1	G3, G80	5 0
010819	Plate, engine front	2	G3C, G80CS	5 0
021086	Stud, front engine plate to frame	1	G3, G80	1 3
010823	Stud, front engine plate to frame	1	G3C	1 3
023348	Stud, front engine plate to frame	1	G80CS	1 2
000003	Nut, front engine plate to frame stud	2	All	4

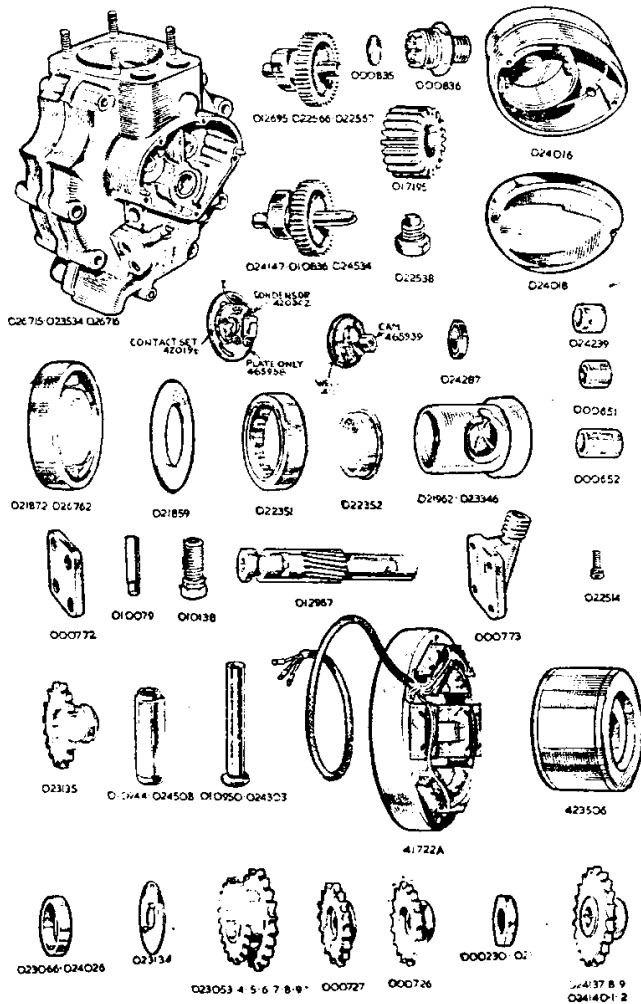

000010	Washer, plain, front engine plate to frame stud	2	All	1
000276	Stud, front engine plate to crankcase, top	1	G3, G80	10
010824	Stud, front engine plate to crankcase, top	1	G3C, G80CS	1 1
000278	Stud, front engine plate to crankcase, bottom	1	All	10
000004	Nut, front engine plate to crankcase stud	4	All	4
000011	Washer, plain, front engine plate to crankcase stud	4	All	1
024019	Plate, engine, rear	2	G3, G80	11 0
025157	Plate, engine, rear	2	G3C	1 6 1
026293	Plate, engine, rear	2	G80CS	1 16 11
026213	Spacer, front engine plate	1	G3, G80, G80CS	4 3
026229	Spacer, front engine plate lug	1	G3, G80	5
000278	Stud, rear engine plate to crankcase, top	1	All	10
014147	Bolt, rear engine plate to crankcase, bottom	1	All	10
000004	Nut, rear engine plate to crankcase, stud and bolt	3	All	4
000011	Washer, plain, rear engine plate to crankcase stud and bolt	3	All	1
024276	Stud, through centre of engine plates and chaincase	1	G3, G80, G80CS	11
000316	Stud, through centre of engine plates and chaincase	1	G3C	1 10
000002	Nut, engine plate and chaincase stud	2	All	5
000009	Washer, plain, engine plate and chaincase stud	2	All	2
000303	Stud, rear engine lug, bottom	1	G3, G3C, G80	10
000306	Stud, rear engine lug, bottom	1	G80CS	1 3
000303	Stud, rear engine lug, top	1	G3, G80	10
000303	Stud, rear engine lug, top	1	G3C, G80CS	1 3
000303	Nut, rear engine lug, stud	4	All	4
000010	Washer, plain, rear engine lug stud	2	G80CS	1
024252	Cover, rear engine plates	1	G3, G80	10 6
025144	Cover, rear engine plates	1	G3C, G80CS	5 7
025771	Shield, crankcase	1	G3C	9 6
026334	Shield, crankcase	1	G80CS	13 3

OIL PUMP

012967	Plunger, oil pump	1	All	17 3
010138	Screw, guide, oil pump plunger	1	All	1 11
010079	Pin, oil pump plunger guide screw	1	All	1 1
000773	Cap, front end, oil pump	1	All	3 7
000772	Cap, rear end, oil pump	1	All	1 3
000582	Washer, paper, oil pump end cap	2	All	1
000015	Screw, oil pump front end cap	4	All	1
000591	Bolt, oil pump rear end cap	4	All	4

RELEASE VALVE

000836	Body, release valve	1	All	2 6
000835	Diaphragm, for release valve	1	All	4

TIMING GEAR

012695	Camshaft, exhaust	1	G3, G80	10 11
022566	Camshaft, exhaust	1	G3C	1 8 11
022567	Camshaft, exhaust	1	G80CS	1 8 11
024147	Camshaft, inlet	1	G3, G80	1 12 6
010836	Camshaft, inlet	1	G3C	1 9 3
024534	Camshaft, inlet	1	G80CS	1 17 11
016847	Washer, shim, .005 in, thick	R	All	2
016848	Washer, shim, .010 in, thick	R	All	2
017195	Pinion, timing, on flywheel axle	1	All	11 6
000570	Key, for timing pinion	1	All	1
000221	Nut, retaining timing pinion to axle (left hand thread)	1	G3, G3C, G80	5
02454e	Nut, retaining timing pinion to axle (right hand thread)	1	G80CS	5
026738	Washer, tab, for timing pinion nut	1	G80CS	3

TAPPETS

010950	Tappet, bare	2	G3, G3C, G80	8 2
024303	Tappet, bare	2	G80CS	10 0
010944	Guide, for tappet	2	G3, G3C, G80	6 3
024508	Guide, for tappet	2	G80CS	9 0
022514	Screw, for tappet guide	2	G80CS	1 10

PUSH RODS

018314	Rod, long, push, complete (l)	2	G3, G3C, G80	9 6
018315	Rod, long, push, complete (l)	2	G80CS	9 8
018168	Rod, long, push, bare	2	G3, G3C, G80	2 4
015511	Rod, long, push, bare	2	G80CS	2 7
000721	End, ball, push rod, bottom	2	All	2 4
018266	End, sleeve, push rod, top	2	All	1 4
000592	Screw, adjusting, push rod, top	2	All	2 4
000216	Nut, push rod adjusting screw	2	All	10
022288	Cover, tube, long push rod	2	G3, G3C, G80	7 2
010672	Gasket, rubber, top of cover tube	2	G3, G3C, G80	10

016944	Washer, metal, $\frac{3}{8}$ in. thick (located below 010672)	2	G3, G80	5
000691	Gland, rubber, bottom of cover tube	2	All	1
022518	Seal, oil, push rod tunnel, top	2	G80CS	2
011087	Washer, metal, $\frac{3}{8}$ in. thick (located above 010672)	2	G3, G3C, G80	5
011087	Washer, metal, $\frac{3}{8}$ in. thick (located above 010672 when compression plate is fitted)	4	G3	5
014603	Washer, metal, $\frac{1}{2}$ in. thick (located above 010672 when compression plate is fitted)	2	G80	5

NOTE 1 "Rod, long, push, complete" comprises one long push rod, with sleeve end bottom ball end adjusting screw and lock nut

ROCKER BOX

022142	Rocker box, assembled (1)	1	G3, G80	7 13 11
022143	Rocker box, assembled (1)	1	G3C	7 15 2
026719	Rocker box, assembled (1)	1	G80CS	7 15 2
014364	Rocker box, with bushes (2)	1	G3, G80	3 5 8
015458	Rocker box, with bushes (2)	1	G3C, G80CS	3 5 8
013958	Rocker box, bare	1	G3, G80	2 10 2
015422	Rocker box, bare	1	G3C, G80CS	2 10 2
013980	Cover, side, for rocker box	1	G3, G80	8 9

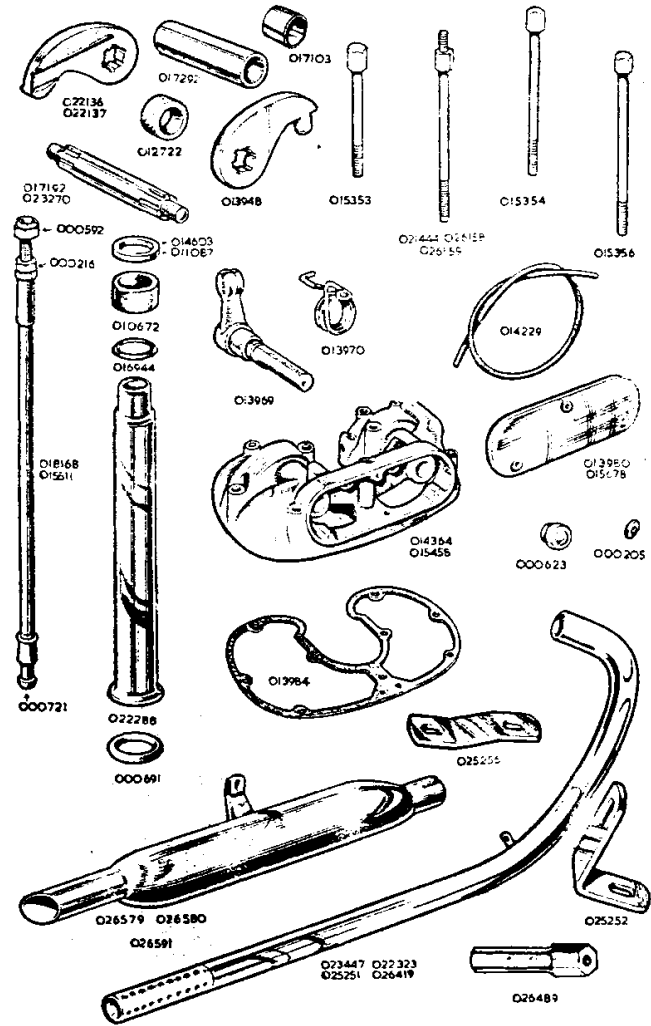

015678	Cover, side, for rocker box	1	G3C, G80CS	9 10
013984	Gasket, for rocker box	1	All	1 3
017103	Bush, for rocker box	4	All	3 8
018890	Plugs, metering	3	All	1
014229	Filllet, rubber, rocker box side cover	1	All	5
000251	Stud, rocker box side cover	3	All	4
000623	Nut, rocker box side cover	3	All	11
000205	Washer, fibre, rocker box, side cover nut	3	All	1
000508	Union, oil, in rocker box	3	All	10
015353	Bolt, fixing rocker box, $1\frac{1}{2}$ in. by $\frac{7}{8}$ in. by 22 T.P.I.	4	All	7
015354	Bolt, fixing rocker box, $2\frac{1}{2}$ in. by $\frac{7}{8}$ in. by 22 T.P.I.	2	All	10
015356	Bolt, fixing rocker box, $3\frac{1}{8}$ in. by $\frac{7}{8}$ in. by 22 T.P.I.	1	All	11
021444	Bolt, fixing rocker box, with extension for stay	2	G3C	2 3
026158	Bolt, fixing rocker box, with extension for stay, long	1	G3, G80, G80CS	2 3
026159	Bolt, fixing rocker box, with extension for stay, short	1	G3, G80, G80CS	2 0
000011	Washer, plain, rocker box fixing bolt	9	All	1

NOTE 1 Includes all parts listed in this paragraph (except gasket, fixing bolts and washers), and all those listed under "OVERHEAD ROCKERS" and "EXHAUST VALVE LIFTER".

NOTE 2 This is a bare rocker box to which is fitted four 017103 bushes, two 012722 felt rings and oil metering plugs 018890.

OVERHEAD ROCKERS

017152	Axle, rocker	2	G3, G3C, G80	8 9
023270	Axle, rocker	2	G80CS	8 9
017292	Sleeve, for rocker axle	2	All	7 7
022136	Arm, rocker, valve end, inlet	1	All	8 9
022137	Arm, rocker, valve end, exhaust	1	All	8 9
013946	Arm, rocker, tappet end, inlet and exhaust	2	All	5 7
0000	Washer, plain, rocker axle	4	All	1
000003	Nut, rocker axle	4	All	4
012722	Ring, felt, rocker axle sleeve	2	All	4

EXHAUST VALVE LIFTER

013969	Lever, with shaft exhaust valve lifter	1	All	14 0
014523	Ring, rubber, sealing, valve lifter shaft	1	All	5
013970	Spring, return, valve lifter shaft	1	All	5
000451	Screw, anchor valve lifter return spring	1	All	4
000039	Washer, plain, valve lifter return spring anchor screw	1	All	1

ROCKER BOX STAY

026155	Stay, for rocker box	1	G3, G80, G80CS	4 6
014373	Stay, for rocker box	1	G3C	1 11
026156	Sleeve, rocker box stay bolt	1	G3, G80, G80CS	1 0
000011	Washer, plain rocker box bolt extension	2	G3C	1
000009	Washer, rocker box stay bolt sleeve	1	G3, G80, G80CS	2
026157	Nut, rocker box stay bolt sleeve	1	G3, G80, G80CS	3
000004	Nut, rocker box bolt extension	2	G3C	4
026873	Bolt, rocker box stay to frame	1	G3, G80, G80CS	5
000011	Washer, plain, rocker box stay/frame bolt	1	G3, G80, G80CS	1
022083	Nut, rocker box stay/frame bolt	1	G3, G80, G80CS	5
021365	Clip, on frame for rocker box stay	1	G3C	1 0
000364	Bolt, rocker box stay clip	1	G3C	10
000011	Washer, plain rocker box stay clip bolt	2	G3C	1
000011	Washer, spacing, rocker box stay clip bolt	3	G3C	1
000004	Nut, rocker box stay clip bolt	1	G3C	4

GASKETS

Engine gaskets are supplied as separate spares and in complete sets. Single gaskets are listed in the groups to which they belong.

MAGNETO

015487	Magneto, type NR1 (Lucas 42179E)	1	G3C, G80CS	6 4
000727	Sprocket, on engine camshaft for magneto	1	G3C, G80CS	4
000004	Nut, engine camshaft magneto sprocket	1	G3C, G80CS	4
000011	Washer, plain, engine camshaft magneto sprocket	1	G3C, G80CS	1
000726	Sprocket, on magneto armature shaft	1	G3C, G80CS	6 4
022178	Seal, rubber, between magneto and chaincase	1	G3C, G80CS	1
021194	Pipe, vent, metal	1	G3C, G80CS	4
015488	Hose, rubber, vent pipe	1	G3C, G80CS	0
010820	Platform, magneto	1	G3C, G80CS	11 4
000340	Bolt, fixing magneto to platform	4	G3C, G80CS	1
000012	Washer, plain, magneto fixing bolt	4	G3C, G80CS	4
010821	Spacer, magneto platform, front	1	G3C	5
010822	Spacer, magneto platform, rear	1	G3C, G80CS	5
026214	Spacer, magneto platform, front	1	G80CS	5

376-098	Banjo, for petrol feed	1	All twins	...	3	6
376-091	Bolt, petrol feed banjo	1	All except G80CS	...	2	2
376-092	Washer, petrol feed banjo bolt	1	All except G80CS	...	2	2
14-175	Washer, seating petrol feed banjo bolt	1	All except G80CS	...	2	2
376-093	Gauze, filter	1	All except G80CS	...	1	0
343-011	Body, tickler	1	All except G80CS	...	1	0
376-086	Plunger, tickler	1	All except G80CS	...	1	3
376-087	Spring, tickler	1	All except G80CS	...	1	2
376-066	Venturi, air intake	1	G3, G3C, G9	...	4	9
389-066	Venturi, air intake	1	G80	...	4	9
01121	Extension, air tube	1	G12, G12DL, G12CS, G12CSR	...	7	6
316-352	Body, mixing chamber	1	G80CS	...	10	0
316-049	Top, mixing chamber	1	G80CS	...	9	6
316-488	Bush, mixing chamber top	1	G80CS	...	1	0
316-050	Cap, mixing chamber top	1	G80CS	...	9	6
316-048	Spring, lock, mixing chamber cap	1	G80CS	...	2	9
316-159	Adjuster, throttle cable	1	G80CS	...	1	3
3369	Nut, lock, throttle cable adjuster	1	G80CS	...	1	3
316-083	Sheath, throttle cable adjuster	1	G80CS	...	1	0
316-020	Valve, throttle, size 6	1	G80CS	...	1	0
5-204	Nipple, screwed, throttle valve	1	G80CS	...	1	3
175-309	Spring, throttle valve	1	G80CS	...	1	3
316-146	Jet needle	1	G80CS	...	6	7
316-021	Clip, jet needle	1	G80CS	...	1	7
316-015	Screw, jet needle clip	1	G80CS	...	1	3

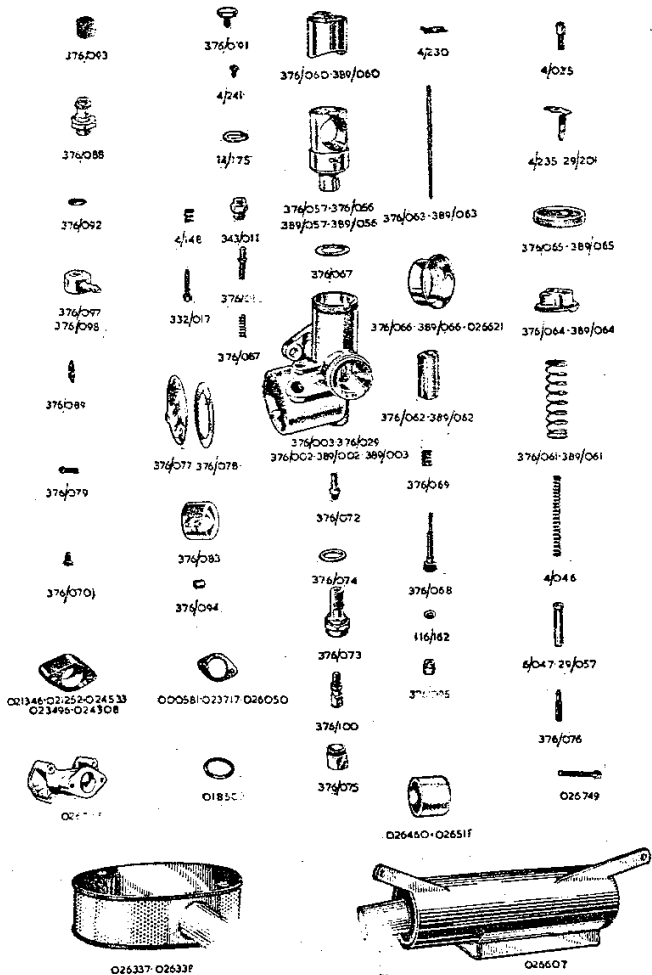

316-025	Washer, choke adaptor	1	G80CS	...	2	3
316-006	Screw, securing choke adaptor	2	G80CS	...	2	0
316-144	Tube, spray	1	G80CS	...	5	6
175-371	Ring, lock, air tube	1	G80CS	...	6	0
3326	Jet, main, size 290	1	G80CS	...	6	0
316-027	Holder, main jet	1	G80CS	...	2	6
316-028	Screw, jet holder plug	1	G80CS	...	6	0
316-065	Needle, jet, size -109	1	G80CS	...	3	3
2626	Adjuster, air valve cable	1	G80CS	...	9	3
2627	Nut, lock air valve adjuster	1	G80CS	...	1	9
2507	Top, air barrel	1	G80CS	...	1	6
2502	Valve, air	1	G80CS	...	2	0
2558	Spring, air valve	1	G80CS	...	2	0
2503	Holder, air valve nipple	1	G80CS	...	4	3
2629	Nipple, air valve	1	G80CS	...	3	3
316-052	Jet, air, size -125	1	G80CS	...	2	0
316-066	Screw, air jet plug	1	G80CS	...	1	6
13-163	Washer, air jet plug screw	1	G80CS	...	1	2
316-283	Adjuster and needle, pilot	1	G80CS	...	3	3
2980	Spring, pilot adjuster and needle	1	G80CS	...	3	4
2982	Spring, click, pilot adjuster and needle	1	G80CS	...	3	3
2966	Insert, pilot adjuster and needle	1	G80CS	...	2	0
2403	Plug, pilot adjuster and needle	1	G80CS	...	4	4
14-218	Connection, banjo for float chamber	1	G80CS	...	3	3
36-006	Washer, banjo connection	1	G80CS	...	2	6
316-421	Clip, outlet	1	G80CS	...	7	2
316-422	Screw, outlet clip	1	G80CS	...	1	6
302-001	Chamber, float, bare, 3"	1	G80CS	...	2	0
302-002	Cover, float chamber, with baffle	1	G80CS	...	1	5
302-009	Screws, fixing float chamber cover	2	G80CS	...	5	5
302-010	Tickler	1	G80CS	...	1	0
14-032	Spring, for tickler	1	G80CS	...	1	2
14-033	Pin, cotter for tickler	1	G80CS	...	1	1
14-189	Washer, for tickler	1	G80CS	...	2	0
302-042	Float, only	1	G80CS	...	6	6
302-044	Needle, float	1	G80CS	...	2	9
302-045/6	Plug and guide, base	1	G80CS	...	4	0
14-252	Washer, base plug	1	G80CS	...	2	0
14-250	Banjo, twin, 90°	1	G80CS	...	10	0
14-255	Nut, banjo	1	G80CS	...	2	0
14-275	Washer, banjo	2	G80CS	...	2	0
14-232	Screw, plug	1	G80CS	...	8	8
14-241	Washer, plug screw	1	G80CS	...	2	2
14-360	Nuts, petrol pipe union	2	G80CS	...	1	0
376-105	Nipple, petrol pipe union	2	G80CS	...	8	8

CHAINS

017299	Chain, front 67 link, 1/2 in. by .305 in.	1	G3, G80CS, G9, G12CS	...	1	8	5
017298	Chain, front, 66 link, 1/2 in. by .305 in.	1	G3C	...	1	7	11
025389	Chain, front, 69 link, 1/2 in. by .305 in.	1	G80	...	1	9	3
022870	Chain, front, 68 link, 1/2 in. by .305 in.	1	G12, G12DL, G12CSR	...	1	8	10
017376	Chain, rear, 98 link, 1/2 in. by .380 in.	1	G3, G80, G80CS, G12CSR	...	3	0	10
017301	Chain, rear, 94 link, 1/2 in. by .380 in.	1	G3C	...	2	18	4
022876	Chain, rear, 97 link, 1/2 in. by .380 in.	1	G9, G12, G12DL, G12CS	...	3	0	2
017294	Chain, magneto, 46 link, 1/2 in. by .225 in.	1	G3C, G80CS	...	9	8	7
023459	Chain, dynamo, 50 link, 1/2 in. by .225 in.	1	G3C	...	10	7	8
110046-26	Link, connecting, for 1/2 in. chain	1	All	...	1	9	1
110056-26	Link, connecting, for 1/2 in. chain	1	All	...	1	1	1
110046-30	Link, cranked, double, for 1/2 in. chain	1	All	...	1	5	5
110056-30	Link, cranked, double, for 1/2 in. chain	1	All	...	1	1	1
110046-27	Clip, spring, for 110046-26 connecting link	1	All	...	1	1	1
110056-27	Clip, spring, for 110056-26 connecting link	1	All	...	1	1	1

GEAR BOX FIXING PARTS

022509	Bolt, gear box top fixing	1	G3, G3C, G80, and all twins	...	2	7
024228	Bolt, gear box top fixing	1	G80CS	...	4	3
000318	Stud, gear box bottom pivot	1	All	...	1	3
000002	Nut, gear box fixing stud and bolt	3	All	...	5	5
000177	Washer, plain, gear box top fixing bolt	2	G3, G3C, G80, and all twins	...	1	2
000009	Washer, plain, gear box top fixing bolt	2	G80CS	...	2	0
012999	Spacer, gear box top fixing bolt	2	G80CS	...	5	5
022869	Bolt, gear box adjusting	1	G3, G3C, G80	...	1	5
000594	Bolt, gear box adjusting	2	G80CS	...	1	11
023259	Bolt, gear box adjusting	1	All twins	...	1	5
000004	Nut, gear box adjusting bolt	1	G3, G3C, G80, and all twins	...	4	4
000215	Nut, gear box adjusting bolt	4	G80CS	...	5	5
022504	Crosshead, gear box adjuster	1	G3, G3C, G80, G9, G12, G12DL	...	1	10
000785	Crosshead, gear box adjuster	2	G80CS	...	1	6
024288	Crosshead, gear box adjuster	1	G12CS, G12CSR	...	4	3
000402	Bolt, gear box adjuster crosshead	1	G3, G3C, G80, G9, G12, G12DL	...	10	10
000361	Bolt, gear box adjuster crosshead	2	G80CS	...	4	4
000402	Bolt, gear box adjuster crosshead	2	G12CS, G12CSR	...	10	10
000010	Washer, gear box adjuster crosshead	1	G3C	...	1	1
000011	Washer, gear box adjuster crosshead	2	G80CS	...	1	1
000010	Washer, gear box adjuster crosshead bolt	1	G3, G80, G9, G12, G12DL	...	1	1
000010	Washer, gear box adjuster crosshead bolt	2	G12CS, G12CSR	...	1	1

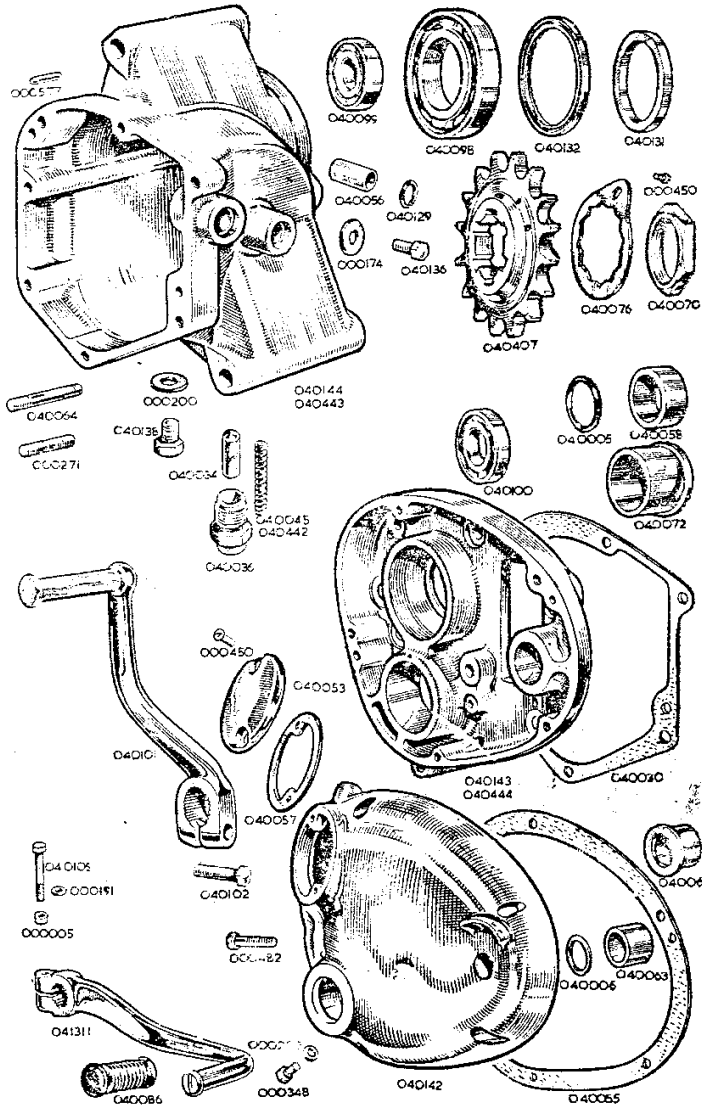

PART NUMBER	DESCRIPTION	QTY.	USED ON	PRICE EACH £ s. d.
GEAR BOX SHELL				
040141	Shell, gear box, with two bushes	1	All except G80CS...	5 15 6
040443	Shell, gear box, with two bushes	1	G80CS	5 15 6
040143	Case, inner, for kickstart	1	All except G3C, G80CS	3 9 3
040444	Case, inner, for kickstart	1	G3C, G80CS	3 9 3
040142	Case, outer, for kickstart	1	All	2 17 9
040030	Gasket, for inner kickstart case	1	All	2 17 9
040055	Gasket, for outer kick start cover	1	All	8
040138	Plug, drain, for shell	1	All	4
000200	Washer, fibre, for drain plug	1	All	5
000348	Plug, oil level	1	All	1
000203	Washer, fibre, oil level plug	1	All	1

040053	Cover, inspection	1	All	3
040057	Gasket, inspection cover	1	All	2
000450	Screw, for inspection cover	2	All	2
000577	Pin, dowel, locating kickstart case	2	All	1 8
040064	Stud, in shell, for kickstart case	2	All	8
000271	Stud, in shell, for kickstart case	5	All	5
000004	Nut, for kickstart case stud	7	All	4
000577	Pin, dowel, locating kickstart cover	2	All	1
000482	Screw, securing kickstart cover	5	All	4
SHAFTS AND GEARS				
040001	Mainshaft, gearbox	1	All	2 6 2
040025	Layshaft, gearbox	1	All	1 14 6
040422	Gear, driving, main, with bushes, 23 teeth	1	All except G3C	2 17 9
040251	Gear, driving, main, with bushes, 25 teeth	1	G3C...	2 17 9
040026	Gear, first mainshaft, 14 teeth	1	All	14 4
040418	Gear, second mainshaft, 18 teeth	1	All except G3C	1 11 7
040254	Gear, second mainshaft, 16 teeth	1	G3C...	1 11 7
040012	Gear, third mainshaft, 21 teeth	1	All	1 17 4
040115	Gear, first layshaft, 28 teeth	1	All except G3C	2 0 3

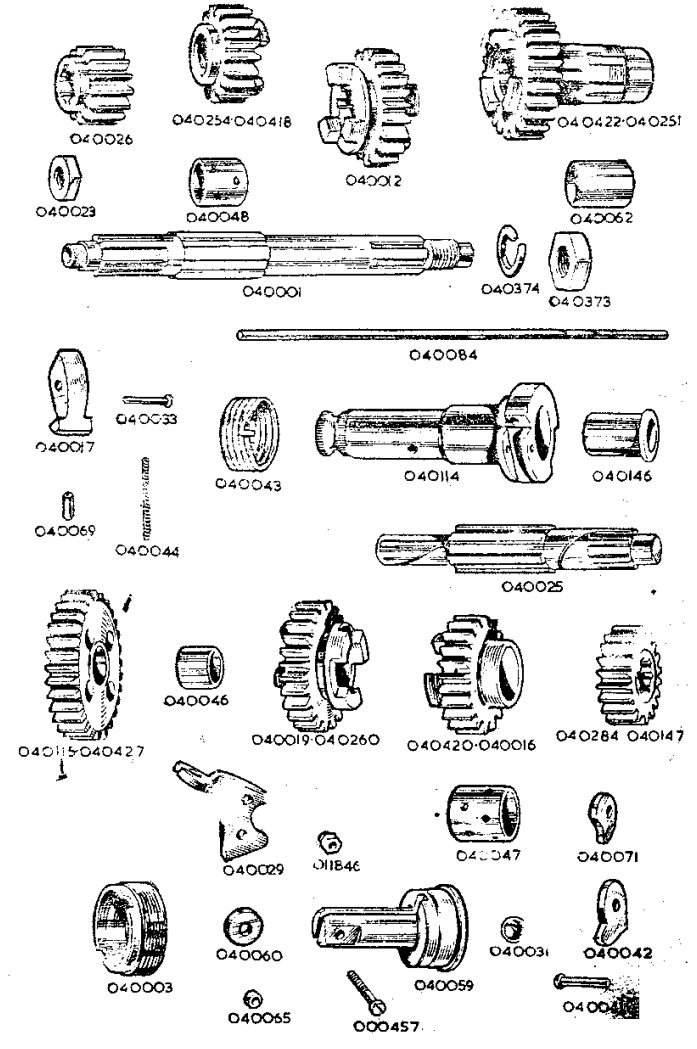

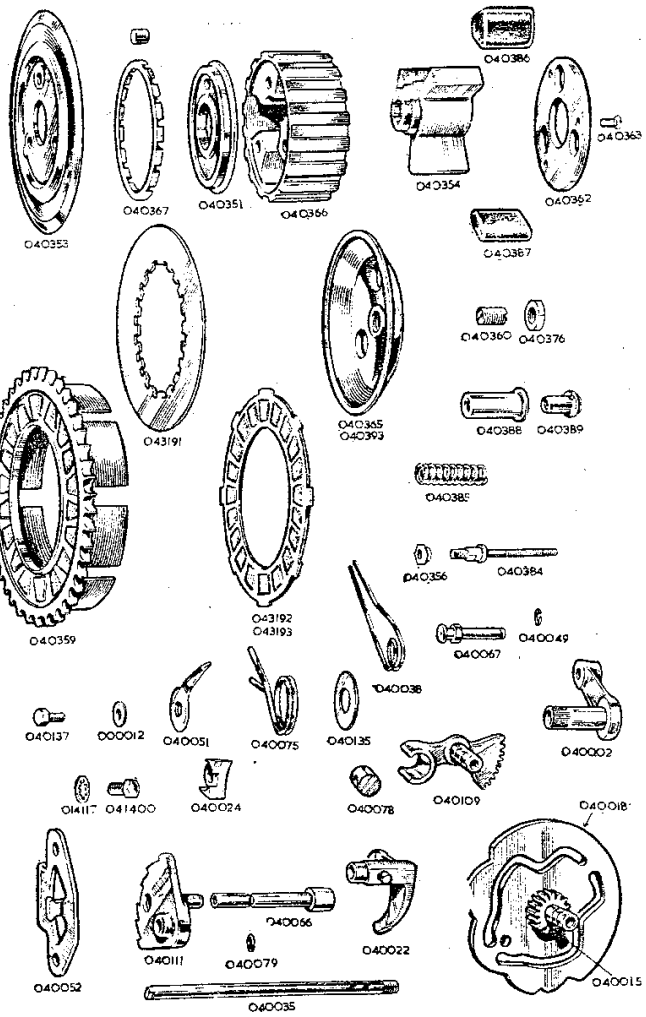

040427	...	Gear, first layshaft, 29 teeth...	...	G3C...	...	2	0	3
040019	...	Gear, second layshaft, 24 teeth	...	All except G3C	...	1	14	6
040425	...	Gear, second layshaft, 25 teeth	...	G3C...	...	1	14	5
040420	...	Gear, third layshaft, 20 teeth	...	All except G3C	...	1	7	4
040016	...	Gear, third layshaft, 21 teeth	...	G3C...	...	1	12	9
040284	...	Gear, pinion, top layshaft, 18 teeth	...	All except G3C	...	1	18	5
040147	...	Gear, pinion, top layshaft, 16 teeth	...	G3C...	...	1	18	5
040062	...	Bush, main driving gear	...	All	...	2	2	10
040048	...	Bush, mainshaft, second gear	...	All	...	1	7	6
040047	...	Bush, layshaft, third gear	...	All	...	1	9	9
040046	...	Bush, layshaft, first gear	...	All	...	1	5	9

GEAR BOX BEARINGS AND OIL SEALS

040098	...	Bearing, ball, for main driving gear...	...	All	...	1	9	3
040099	...	Bearing, ball, for mainshaft, in kickstart case	...	All	...	1	17	9
040100	...	Bearing, ball, for layshaft, in shell	...	All	...	1	16	11
040056	...	Bush, in shell, for camplate spindle and quadrant spindle	...	All	...	2	5	5
040132	...	Oil seal, main gear bearing	...	All	...	1	5	2
040129	...	Oil seal, "O" ring, for quadrant assembly...	...	All	...	1	1	2
040072	...	Bush, in kickstart case, for kickstart spindle	...	All	...	1	7	6
040061	...	Bush, in kickstart case, for footchange spindle	...	All	...	1	1	5

040058	...	Bush, in kickstart case cover, for kickstart spindle	...	All	...	1	6	4
040063	...	Bush, in kickstart case cover, for footchange spindle	...	All	...	1	1	2
040079	...	Oil seal, "O" ring, for ratchet spindle	...	All	...	1	7	7
040006	...	Oil seal, "O" ring, for footchange spindle	...	All	...	1	1	2
040005	...	Oil seal, "O" ring, for kickstart	...	All	...	1	1	2
040036	...	Bush, camplate plunger	...	All	...	1	1	1

GEAR BOX SMALL SPROCKET

040451	...	Sprocket, gear box, 17 teeth, 1/8 in. by .380 in.	...	G12CSR	...	1	8	9
040407	...	Sprocket, gear box, 16 teeth, 1/8 in. by .380 in.	...	All except G12CSR	...	1	8	9
040070	...	Nut, fixing gear box sprocket	...	All	...	1	1	5
040076	...	Plate, locking gear box sprocket nut	...	All	...	1	7	7
000450	...	Screw, for sprocket nut locking plate	...	All	...	1	2	2
040131	...	Spacer, gear box sprocket	...	All	...	1	5	9

GEAR OPERATING PARTS

040018	...	Camplate, only	...	All	...	1	9	11
040015	...	Spindle, only, for camplate	...	All	...	1	8	7
040109	...	Quadrant, assembly, with spindle	...	All	...	1	3	0
000174	...	Washer, plain, for camplate or quadrant	...	All	...	1	2	7
040136	...	Screw, for camplate or quadrant spindle	...	All	...	1	13	4
040022	...	Fork, selector	...	All	...	1	6	1
040035	...	Shaft, for selector fork	...	All	...	1	6	4
040111	...	Gear, ratchet assembly	...	All	...	1	13	1
040078	...	Roller, for knuckle pin	...	All	...	1	4	7
040038	...	Spring, pawl, for gear change	...	All	...	1	4	4
040110	...	Carrier, pawl, assembly	...	All	...	1	7	7
040002	...	Carrier, pawl, only	...	All	...	1	6	2
040067	...	Pin, for pawl carrier	...	All	...	1	1	9
040024	...	Pawl, footchange	...	All	...	1	6	4
040049	...	Circlip, footchange pawl	...	All	...	1	1	1
040066	...	Spindle, for ratchet	...	All	...	1	6	4
040075	...	Spring, return, gear change	...	All	...	1	7	7
040135	...	Washer, footchange return spring	...	All	...	1	2	10
040052	...	Plate, stop, gear change	...	All	...	1	7	7
041400	...	Screw, gear change stop plate	...	All	...	2	1	6
014117	...	Washer, shakeproof, stop plate screw	...	All	...	2	1	1
041311	...	Pedal, footchange	...	All except G3C	...	1	0	6
020195	...	Pedal, footchange	...	G3C	...	1	4	9
040086	...	Rubber, footchange pedal	...	All	...	1	1	2
040105	...	Bolt, footchange pedal	...	All	...	1	1	1
000012	...	Washer, plain, footchange pedal bolt	...	All	...	1	1	1
000005	...	Nut, footchange pedal bolt	...	All	...	1	1	4
040051	...	Indicator, gear	...	All	...	1	1	9
040137	...	Screw, gear indicator	...	All	...	1	1	7
000012	...	Washer, plain, gear indicator screw	...	All	...	1	1	1
040034	...	Plunger, camplate	...	All	...	1	3	1
040442	...	Spring, camplate plunger	...	All except G80CS	...	1	3	3
040045	...	Spring, camplate plunger	...	G80CS	...	1	3	3

CLUTCH

040366	...	Centre, clutch	...	All	...	1	2	0
040584	...	Plate, back, for clutch	...	All	...	1	15	0
040351	...	Plate, race	...	All	...	1	13	6
040367	...	Cage, roller	...	All	...	1	3	5
000075	...	Roller, for clutch	...	All	...	15	1	4
040359	...	Sprocket, only, for clutch, bonded	...	All	...	1	3	0
040354	...	Centre, shock absorber	...	All	...	1	13	10
040386	...	Rubber, large, shock absorber	...	All	...	3	1	8

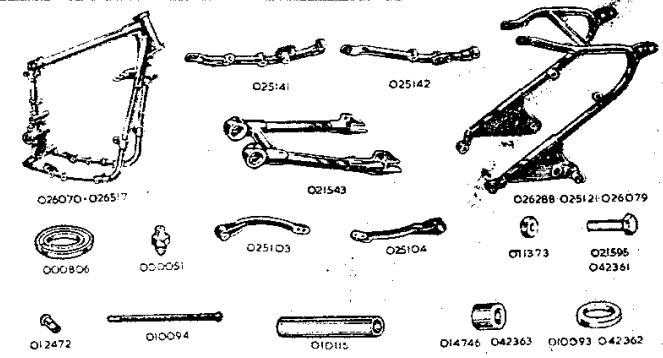

000051	Nipple, grease, frame head lug	1	All	7
023250	Stud, for seat lug (below saddle)	1	G3, G80, G9, G12, G12DL	2 5
000312	Stud, for seat lug (below saddle)	1	G3C	1 3
026282	Stud, for seat lug (below saddle)	1	G80CS, G12CS, G12CSR	3 3
000292	Nut, for seat lug stud	2	All except G3C	1 2
000002	Nut, for seat lug stud	2	G3C	1 5
000176	Washer, plain, for seat lug stud	2	All except G3C	2
000009	Washer, plain, for seat lug stud	2	G3C	1
021917	Stud, uniting front frame and rails	1	G3C	2 9
000003	Nut, frame and rail uniting stud	2	G3C	4
000010	Washer, plain, frame and rail uniting stud	2	G3C	1
026161	Stud, frame rail junction	1	All except G3C	2 6
000003	Nut, frame rail junction stud	1	All except G3C	4
000010	Washer, plain, frame rail junction stud	2	All except G3C	1
025178	Stud, frame rail and brake pedal	1	G3C	3 6
017678	Nut, lock, frame rail and brake pedal stud	1	G3C	9

REAR FRAME

026288	Loop, rear, frame	1	G3, G80, G9, G12, G12DL	12 19 0
025121	Loop, rear frame	1	G3C	8 14 4
026079	Loop, rear frame	1	G80CS, G12CS, G12CSR	8 9 5
025141	Rail, frame, left side	1	G3C	2 5 5
025142	Rail, frame, right side	1	G3C	1 19 0
022248	Stud, for rear loop at bottom	1	All except G3C	5 8
000002	Nut, frame loop bottom stud	1	All except G3C, G80CS	2
000009	Washer, plain, frame loop bottom stud	1	All except G3C, G80CS	2
026582	Nut, sleeve, frame loop bottom stud	1	G80CS	8
026399	Cover, rear frame	1	G3, G80	8 6
026400	Cover, rear frame	1	G9, G12, G12DL, G12CS, G12CSR	8 0
022541	Beading, plastic, rear frame cover 20 ins.	1	All except G3C, G80CS	6
014357	Screw, knurled, rear frame cover	2	All except G3C, G80CS	1 2
000191	Washer, spring, rear frame cover knurled screw	2	All except G3C, G80CS	1

CHAINSTAY (REAR FORK)

021543	Fork, rear	1	All except G3C	5 8 9
025145	Chainstay, left assembled	1	G3C	3 3 9
026512	Chainstay, right assembled	1	G3C	3 1 6
000051	Nipple, grease	1	All except G3C	1
000485	Screw, plug, for oil, in end cap	1	All except G3C	1
000203	Washer, fibre, oil plug screw	1	All except G3C	10
010096	Cap, rear fork bearing, left side	1	All except G3C	1 6
010095	Cap, rear fork bearing, right side	1	All except G3C	1
010098	Gasket, rear fork bearing caps	2	All except G3C	5
010094	Spoke, rear fork bearing (central tie bolt)	1	All except G3C	3
012472	Nipple, rear fork bearing spoke	1	All except G3C	1 3
010093	Washer, felt, chainstay bearing spindle	1	All except G3C	7 7
010116	Tube, rear fork bearing	1	All except G3C	8 4
014746	Sleeve, assembly (bushed)	2	G3C	7 3
042363	Bush, chainstay bearing spindle	2	G3C	1
042362	Washer, felt, chainstay bearing spindle	2	All except G3C	11
022879	Pin, cotter, for bearing tube	2	G3C	11
042360	Pin, cotter, for bearing tube	2	All except G3C	4
000004	Nut, bearing tube, cotter pin	2	G3C	7
023281	Nut, bearing tube cotter pin	2	All except G3C	1
014117	Washer, shakeproof, bearing tube cotter pin	2	G3C	1
000010	Washer, plain, bearing tube cotter pin	2	All except G3C	10
021595	Adjuster, rear chain	2	All except G3C	9
042361	Adjuster, rear chain	2	G3C	2
026856	Nut, lock, rear chain adjuster	2	All	2

REAR SUSPENSION UNIT

024180	Unit, complete, rear suspension (solo)	2	Touring	2 17 0
024506	Unit, complete, rear suspension (sidecar)	2	Touring	2 17 0
042370	Unit, complete, rear suspension	2	G3C	2 17 0
024181	Unit, complete, rear suspension	2	CS and CSR	2 17 0
024481	Unit, damper, inner assembly	2	Touring	1 14 6
045311	Unit, damper, inner assembly	2	G3C	1 14 6
024439	Unit, damper, inner assembly	2	CS and CSR	1 14 6
023480	Shield, dust, top	2	Touring	8 6
023485	Shield, dust, top	2	C, CS, and CSR	7 0
024465	Shield, dust, top, chrome	2	CS and CSR	18 0
023481	Shield, dust, bottom	2	All	8 6
023479	Clip, top dust shield	4	All	3 1
023473	Spring, main (solo)	2	Touring	7 9
023372	Spring, main (sidecar)	2	Touring	7 9
045312	Spring, main	2	G3C	8 0
024483	Spring, main	2	CS and CSR	8 0
023599	Sleeve assembly, with rubber bush, top pivot	2	All except G3C	2 2
043313	Sleeve assembly, with rubber bush, top or bottom pivot	4	G3C	2 2
023485	Rubber, bottom pivot	2	All except G3C	6
023600	Bush, bottom pivot rubber	2	All except G3C	1 2
018648	Bolt, top pivot	2	All touring	2 1
023318	Bolt, top pivot	2	G3C	1 5
023269	Bolt, top pivot	2	CS and CSR	2 10
016712	Nut, top pivot bolt	2	Touring	10

000003	Nut, top pivot bolt	2	C, CS and CSR	4
016359	Bolt, bottom pivot	2	All except G3C	11
042678	Bolt, bottom pivot	2	G3C	3 0
000010	Washer, top and bottom pivot bolt	6	All except G3C	1
000010	Washer, top and bottom pivot bolt	6	G3C	1
023601	Nut, bottom pivot bolt	2	All except G3C	7
000174	Washer, large, bottom pivot bolt	2	G3C	2
022083	Nut, bottom pivot bolt	2	G3C	5

FRONT FORK

The following fork assemblies are complete and include ball races for fork crown and top head lug (but not the two frame ball races).

026720	Fork, complete assembly, solo	1	G3, G80, G9, G12, G12DL	27 4 0
026721	Fork, complete assembly, sidecar	1	G3, G80, G9, G12, G12DL	27 7 10
025418	Fork, complete assembly	1	G3C	26 7 9
026722	Fork, complete assembly	1	G80CS, G12CS	28 1 3
026723	Fork, complete assembly	1	G12CSR	28 3 4

For ease of servicing, the inner tube unit and damper unit are listed and supplied as separate assemblies. This enables a complete assembly to be exchanged in minimum time.

The units are listed below.

023523	Inner tube assembly, front fork, solo	2	G3, G80, G9, G12, G12DL	4 6 8
023524	Inner tube assembly, front fork, sidecar	2	G3, G80, G9, G12, G12DL	4 6 7
021402	Inner tube assembly, front fork	2	G3C	5 1 0
023542	Inner tube assembly, front fork	2	G80CS, G12CS, G12CSR	4 8 7

The above assemblies comprise—

Inner tubes with rubber buffers, bushes, circlips, top bolts with washers and sealing rings, slider extensions with oil seals, fork springs and washers.

021974	Damper assembly, inner	2	G3, G80, G9, G12, G12DL	16 8
018328	Damper assembly, inner	2	G3C	15 3
023544	Damper assembly, inner	2	G80CS, G12CS, G12CSR	1 0 2

The above assemblies comprise—

Rod and two nuts, damper tube with valves, seat and pin, sleeve and clip, and bottom fixing bolt with washer.

026724	Crown, assembly, comprising: crown, stem and circlip (these parts not sold separately)	1	G3, G80, G9, G12, G12DL, G12CSR	3 4 2
026725	Crown, assembly, comprising: crown, stem and circlip (these parts not sold separately)	1	G3C	2 16 4
026725	Crown, assembly, comprising: crown, stem and circlip (these parts not sold separately)	1	G80CS, G12CS	3 5 6
021740	Screw, pinch, for fork crown	2	G3, G80, G9, G12, G12DL, G12CSR	2 1
021071	Stop, fork (acts also as pinch bolt)	2	G3C	2 6
026529	Stop, fork (acts also as pinch bolt)	2	G80CS, G12CS	2 6
000003	Nut, fork stop	2	G3C, G80CS, G12CS	4
000193	Washer, spring, fork stop	2	G3C, G80CS, G12CS	1
000011	Washer, packing fork stop	2	G3C	1
000805	Race, ball, fork crown	1	All	5 8
026726	Lug, for handlebar and steering head	1	G3, G80, G9, G12, G12DL, G12CSR	2 14 5
013631	Lug, for handlebar and steering head	1	G3C	2 15 8
026727	Lug, for handlebar and steering head	1	G80CS, G12CS	2 17 1
012620	Race, ball, for handlebar lug	1	All	5 7
000051	Nipple, grease for handlebar lug	1	All	7
021741	Nut, adjusting fork stem	1	All except G3C	4 6
000236	Nut, adjusting fork stem	1	G3C	1 1
021642	Nut, lock, (domed) fork stem	1	All except G3C	4 2
010712	Nut, lock, (domed) fork stem	1	G3C	4 4
022823	Tube, fork, inner	2	All except G3C	2 0 3
016377	Tube, fork, inner	2	G3C	2 11 3
021911	Bush, rubber, fork inner tube	6	All except G3C	7
016148	Bush, rubber, fork inner tube	6	G3C	7
021495	Bush, bottom, fork inner tube	2	All except G3C	6 3
010692	Bush, bottom, fork inner tube	2	G3C	6 3
021651	Circlip, fork inner tube bottom bush	4	All except G3C	1
010710	Circlip, fork inner tube bottom bush	2	G3C	1
022215	Bolt, top, fork inner tube	2	All except G3C	5 1
016718	Bolt, top, fork inner tube	2	G3C	3 1
014355	Ring, sealing, inner tube top bolt	2	All	2
022216	Grommet, fork inner tube top bolt	2	All except G3C	4
010709	Washer, fork inner tube top bolt	2	G3C	5
022213	Adapter, fork damper rod	2	All except G3C	7
022795	Slider, fork, with cap, studs and nuts, left	1	G3, G80, G9, G12, G12DL	2 19 0
025425	Slider, fork, with cap, studs and nuts, left	1	G3C	2 19 0
022794	Slider, fork, with cap, studs and nuts, left and right	2	G80CS, G12CS, G12CSR	2 19 0
022793	Slider, fork, with cap, studs and nuts, right	1	G3, G80, G9, G12, G12DL	2 19 0
025421	Slider, fork, with cap, studs and nuts, right	1	G3C	2 19 0
022799	Cap, fork slider	2	All except G3C	6 1
013589	Cap, fork slider	2	G3C	6 1
010713	Stud, slider end cap	4	All	5
000011	Washer, plain, slider end cap stud	4	All	1
000004	Nut, slider end cap stud	4	All	4
021907	Extension, fork slider	2	All except G3C	14 9
021256	Extension, fork slider	2	G3C	13 9

Table listing parts for 'STEERING DAMPER (OPTIONAL EXTRA)'. Columns include part number, description, quantity, and code.

Table listing parts for 'STEERING DAMPER (OPTIONAL EXTRA)'. Columns include part number, description, quantity, and code.

Table listing parts for 'STEERING DAMPER (OPTIONAL EXTRA)'. Columns include part number, description, quantity, and code.

Table listing parts for 'STEERING DAMPER (OPTIONAL EXTRA)'. Columns include part number, description, quantity, and code.

Table listing parts for 'HANDLEBAR'. Columns include part number, description, quantity, and code.

Table listing parts for 'CENTRE STAND'. Columns include part number, description, quantity, and code.

Table listing parts for 'CENTRE STAND'. Columns include part number, description, quantity, and code.

Table listing parts for 'PROP STAND'. Columns include part number, description, quantity, and code.

Table listing parts for 'FRONT MUDGUARD'. Columns include part number, description, quantity, and code.

Table listing parts for 'FRONT MUDGUARD'. Columns include part number, description, quantity, and code.

Table listing parts for 'REAR MUDGUARD (G3, G80, G9, G12, G12DL)'. Columns include part number, description, quantity, and code.

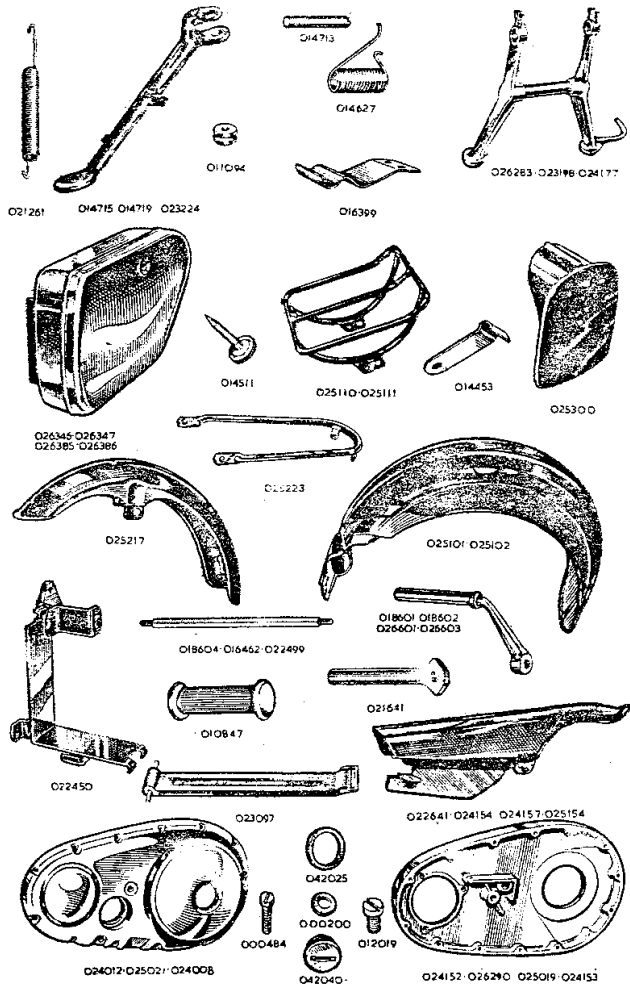

PART NUMBER	DESCRIPTION	QTY.	USED ON	PRICE EACH £ s. d.
REAR MUDGUARD (G3, G80, G9, G12, G12DL)—continued				
000004	Nut, mudguard bracket stud	2	All	4
000346	Bolt, rear mudguard bridge	1	All	5
000012	Washer, small mudguard bridge bolt	1	All	1
000172	Washer, large, mudguard bridge bolt	1	All	2
000191	Washer, spring, mudguard bridge bolt	1	All	1
000005	Nut, mudguard bridge bolt	1	All	4
REAR MUDGUARD (G3C, G80CS, G12CS, G12CSR)				
025168	Mudguard, rear, bare	1	G3C...	3 2 6
026225	Mudguard, rear, bare...	1	CS and CSR	3 2 6
026277	Tube, support, rear mudguard	1	G3C...	1 13 6
026219	Tube, support, rear mudguard	1	CS and CSR	1 17 6
026221	Bridge, support tube	1	CS and CSR	1 8 4
024236	Washer, alloy, fixing rear mudguard 2BA	3	G3C...	3
024236	Washer, alloy, fixing rear mudguard 2BA	5	CS and CSR	3

024237	Washer, alloy, fixing rear mudguard, 1/4 in.	3	All	3
024238	Washer, alloy, fixing rear mudguard, 1/4 in.	3	G3C...	3
000012	Washer, steel, fixing rear mudguard, 1/4 in.	3	CS and CSR	1
000361	Bolt, rear mudguard, bottom front	1	G3C...	1
000368	Bolt, support tube, front	1	CS and CSR	5
000004	Nut, support tube front bolt	1	CS and CSR	4
000011	Washer, plain, support tube-front bolt	1	CS and CSR	1
000074	Nut, support tube, rear	2	G3C...	4
000011	Washer, steel, support tube rear nut	2	G3C...	1
026227	Bracket, bottom, rear mudguard	1	CS and CSR	1 9
014577	Bolt, bottom bracket	1	CS and CSR	3
000005	Nut, bottom bracket bolt	1	CS and CSR	4
000012	Washer, small, bottom bracket bolt	1	CS and CSR	1
024237	Washer, alloy, bottom bracket bolt	1	CS and CSR	3
012565	Bolt, support tube bridge bracket	2	G3C...	4
012565	Bolt, support tube bridge bracket	7	CS and CSR	2
000080	Nut, support tube bridge bracket bolt	2	G3C...	2
000080	Nut, support tube bridge bracket bolt	7	CS and CSR	2
000039	Washer, plain, support tube bridge bracket bolt	2	G3C...	1
000039	Washer, plain, support tube bridge bracket bolt	7	CS and CSR	1
000190	Washer, spring, support tube bridge bracket bolt	2	G3C...	1
000190	Washer, spring, support tube bridge bracket bolt	7	CS and CSR	1
000346	Bolt, rear mudguard bridge	1	All	5
000005	Nut, rear mudguard bridge bolt	1	All	4
000012	Washer, small, rear mudguard bridge bolt	1	All	1
000172	Washer, large, rear mudguard bridge bolt	1	All	2
000191	Washer, spring, rear mudguard bridge bolt	1	All	1

FRONT NUMBER PLATE

011698	Plate, number, front	1	G3C, G12CS, G12CSR	4 0
011836	Stud, fixing front number plate	2	G3C, G12CS, G12CSR	1 7
000012	Washer, plain, front number plate fixing stud	2	G3C, G12CS, G12CSR	1
000005	Nut, front number plate fixing stud	2	G3C, G12CS, G12CSR	4
000861	Screw, fixing number plate to stud	2	G3C, G12CS, G12CSR	1

REAR NUMBER PLATE

025300	Plate, number, rear black	1	All touring	17 6
025376	Plate, number, rear off white	1	All touring	17 6
021881	Plate, number, rear	1	G3C...	5 4
025318	Plate, number, rear	1	G12CS, G12CSR	6 3
000363	Bolt, fixing rear number plate	2	All touring	5
000070	Bolt, fixing rear number plate	2	G3C, G12CS, G12CSR	4
000012	Washer, plain, rear number plate fixing bolt	2	G3C, G12CS, G12CSR	1
000192	Washer, spring, rear number plate fixing bolt	2	All touring	1
000639	Spacer, rear number plate fixing bolt	1	G3C, G12CS, G12CSR	4
000012	Washer, spacing, rear number plate fixing bolt	1	G3C, G12CS, G12CSR	1
000005	Nut, rear number plate fixing bolt	2	G3C, G12CS, G12CSR	4
025173	Bracket, rear number plate	1	G3C...	1 9
000343	Bolt, rear number plate bracket, top	1	G3C...	4
000070	Bolt, rear number plate bracket, bottom	1	G3C...	4
000012	Washer, plain, rear number plate bracket bolt	2	G3C...	1
000005	Nut, rear number plate bracket bolt	2	G3C...	4
024237	Washer, alloy, rear number plate bracket bolt	2	G3C...	3
025392	Beading, plastic, rear mudguard/number plate, 22 ins.	1	All touring	6

REAR CARRIER

026751	Carrier, rear (inclined)	1	All touring	3 6 11
000344	Bolt, fixing rear carrier, front	2	All touring	10
000364	Bolt, fixing rear carrier, rear	2	All touring	10
014278	Nut, domed, rear carrier fixing bolt, front	2	All touring	10
025115	Nut, domed, rear carrier fixing bolt, rear	2	All touring	10
021099	Washer, chrome, rear carrier fixing bolt	2	All touring	1 5

FRONT CHAINCASE

024152	Chaincase, back half, assembled	1	G3, G80	2 17 9
023150	Chaincase, back half, only	1	G3C...	19 3
026290	Chaincase, back half, assembled	1	G80CS	3 8 10
025019	Chaincase, back half, assembled	1	G9, G12	3 0 0
024153	Chaincase, back half, assembled	1	G12DL, G12CS, G12CSR	2 12 6
024012	Chaincase, front half, only	1	G3, G80, G80CS	2 13 7
023149	Chaincase, front half, only	1	G3C...	1 4 5
025021	Chaincase, front half only	1	G9, G12	3 0 0
024008	Chaincase, front half only	1	G12DL, G12CS, G12CSR	2 2 9
018650	Band, metal, for chaincase	1	G3C...	9 10

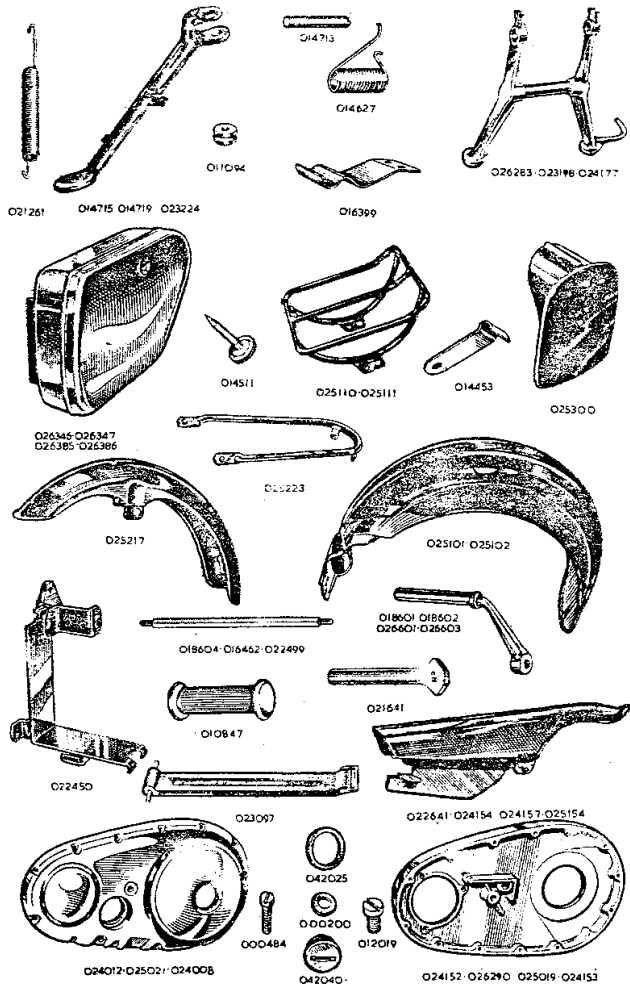

PART NUMBER	DESCRIPTION	QTY.	USED ON	PRICE EACH £ s. d.
REAR MUDGUARD (G3, G80, G9, G12, G12DL)—continued				
000004	Nut, mudguard bracket stud	2	All	4
000346	Bolt, rear mudguard bridge	1	All	5
000012	Washer, small mudguard bridge bolt	1	All	1
000172	Washer, large, mudguard bridge bolt	1	All	2
000191	Washer, spring, mudguard bridge bolt	1	All	1
000005	Nut, mudguard bridge bolt	1	All	4
REAR MUDGUARD (G3C, G80CS, G12CS, G12CSR)				
025168	Mudguard, rear, bare	1	G3C...	3 2 6
026225	Mudguard, rear, bare...	1	CS and CSR	3 2 6
026277	Tube, support, rear mudguard	1	G3C...	1 13 6
026219	Tube, support, rear mudguard	1	CS and CSR	1 17 6
026221	Bridge, support tube	1	CS and CSR	1 8 4
024236	Washer, alloy, fixing rear mudguard 2BA	3	G3C...	3
024236	Washer, alloy, fixing rear mudguard 2BA	5	CS and CSR	3

024237	Washer, alloy, fixing rear mudguard, 1/4 in.	3	All	3
024238	Washer, alloy, fixing rear mudguard, 1/4 in.	3	G3C...	3
000012	Washer, steel, fixing rear mudguard, 1/4 in.	3	CS and CSR	1
000361	Bolt, rear mudguard, bottom front	1	G3C...	1
000368	Bolt, support tube, front	1	CS and CSR	5
000004	Nut, support tube front bolt	1	CS and CSR	4
000011	Washer, plain, support tube-front bolt	1	CS and CSR	1
000074	Nut, support tube, rear	2	G3C...	4
000011	Washer, steel, support tube rear nut	2	G3C...	1
026227	Bracket, bottom, rear mudguard	1	CS and CSR	1 9
014577	Bolt, bottom bracket	1	CS and CSR	3
000005	Nut, bottom bracket bolt	1	CS and CSR	4
000012	Washer, small, bottom bracket bolt	1	CS and CSR	1
024237	Washer, alloy, bottom bracket bolt	1	CS and CSR	3
012565	Bolt, support tube bridge bracket	2	G3C...	4
012565	Bolt, support tube bridge bracket	7	CS and CSR	2
000080	Nut, support tube bridge bracket bolt	2	G3C...	2
000080	Nut, support tube bridge bracket bolt	7	CS and CSR	2
000039	Washer, plain, support tube bridge bracket bolt	2	G3C...	1
000039	Washer, plain, support tube bridge bracket bolt	7	CS and CSR	1
000190	Washer, spring, support tube bridge bracket bolt	2	G3C...	1
000190	Washer, spring, support tube bridge bracket bolt	7	CS and CSR	1
000346	Bolt, rear mudguard bridge	1	All	5
000005	Nut, rear mudguard bridge bolt	1	All	4
000012	Washer, small, rear mudguard bridge bolt	1	All	1
000172	Washer, large, rear mudguard bridge bolt	1	All	2
000191	Washer, spring, rear mudguard bridge bolt	1	All	1

FRONT NUMBER PLATE

011698	Plate, number, front	1	G3C, G12CS, G12CSR	4 0
011836	Stud, fixing front number plate	2	G3C, G12CS, G12CSR	1 7
000012	Washer, plain, front number plate fixing stud	2	G3C, G12CS, G12CSR	1
000005	Nut, front number plate fixing stud	2	G3C, G12CS, G12CSR	4
000861	Screw, fixing number plate to stud	2	G3C, G12CS, G12CSR	1

REAR NUMBER PLATE

025300	Plate, number, rear black	1	All touring	17 6
025376	Plate, number, rear off white	1	All touring	17 6
021881	Plate, number, rear	1	G3C...	5 4
025318	Plate, number, rear	1	G12CS, G12CSR	6 3
000363	Bolt, fixing rear number plate	2	All touring	5
000070	Bolt, fixing rear number plate	2	G3C, G12CS, G12CSR	4
000012	Washer, plain, rear number plate fixing bolt	2	G3C, G12CS, G12CSR	1
000192	Washer, spring, rear number plate fixing bolt	2	All touring	1
000639	Spacer, rear number plate fixing bolt	1	G3C, G12CS, G12CSR	4
000012	Washer, spacing, rear number plate fixing bolt	1	G3C, G12CS, G12CSR	1
000005	Nut, rear number plate fixing bolt	2	G3C, G12CS, G12CSR	4
025173	Bracket, rear number plate	1	G3C...	1 9
000343	Bolt, rear number plate bracket, top	1	G3C...	4
000070	Bolt, rear number plate bracket, bottom	1	G3C...	4
000012	Washer, plain, rear number plate bracket bolt	2	G3C...	1
000005	Nut, rear number plate bracket bolt	2	G3C...	4
024237	Washer, alloy, rear number plate bracket bolt	2	G3C...	3
025392	Beading, plastic, rear mudguard/number plate, 22 ins.	1	All touring	6

REAR CARRIER

026751	Carrier, rear (inclined)	1	All touring	3 6 11
000344	Bolt, fixing rear carrier, front	2	All touring	10
000364	Bolt, fixing rear carrier, rear	2	All touring	10
014278	Nut, domed, rear carrier fixing bolt, front	2	All touring	10
025115	Nut, domed, rear carrier fixing bolt, rear	2	All touring	10
021099	Washer, chrome, rear carrier fixing bolt	2	All touring	1 5

FRONT CHAINCASE

024152	Chaincase, back half, assembled	1	G3, G80	2 17 9
023150	Chaincase, back half, only	1	G3C...	19 3
026290	Chaincase, back half, assembled	1	G80CS	3 8 10
025019	Chaincase, back half, assembled	1	G9, G12	3 0 0
024153	Chaincase, back half, assembled	1	G12DL, G12CS, G12CSR	2 12 6
024012	Chaincase, front half, only	1	G3, G80, G80CS	2 13 7
023149	Chaincase, front half, only	1	G3C...	1 4 5
025021	Chaincase, front half only	1	G9, G12	3 0 0
024008	Chaincase, front half only	1	G12DL, G12CS, G12CSR	2 2 9
018650	Band, metal, for chaincase	1	G3C...	9 10

000453	Screw, clamping metal band	1	G3C	4
024020	Gasket, joint, chaincase halves	1	G3, G80, G80CS	9
018652	Band, rubber, chaincase halves	1	G3C	8 0
025037	Gasket, joint, chaincase halves	1	G9, G12	9
024021	Gasket, joint, chaincase halves	1	G12DL, G12CS, G12CSR	9
000484	Screw, joining chaincase halves	14	All except G3C	7 7
018964	Clutch, cover, domed	1	G3C	4
018966	Gasket, cork, clutch cover	1	G3C	1 4
000450	Screw, clutch cover	8	G3C	4 2
042040	Cap, inspection	2	All except G3C	4 0
014457	Cap, inspection, assembled	1	G3C	3 3
042025	Gasket, inspection cap	2	All except G3C	4
000580	Gasket, inspection cap	1	G3C	4
012019	Plug, drain, chaincase	1	All except G3C	5
000200	Washer, fibre, chaincase drain plug	1	All except G3C	4
024023	Gasket, chaincase to crankcase	1	G3, G80, G80CS	2
023104	Gasket, chaincase to crankcase	1	G3C	3
025035	Gasket, chaincase to crankcase	1	G9, G12	2
024022	Gasket, chaincase to crankcase	1	G12DL, G12CS, G12CSR	2
024024	Gasket, chaincase centre stud	1	All except G3C	1
024148	Screw, fixing chaincase to crankcase	3	All except G3C	3
000440	Bolt, fixing chaincase to crankcase	3	G3C	4
022131	Washer, lock, chaincase fixing screw	3	All except G3C	2
023107	Washer, lock, chaincase fixing bolt	3	G3C	2
012912	Bolt, chaincase centre	1	G3, G80, G80CS	10
023429	Stud, chaincase centre	1	G9, G12	6
024285	Stud, chaincase centre	1	G12DL, G12CS, G12CSR	6
000004	Nut, chaincase centre stud	1	G9, G12	4
021230	Nut, spacing, inside chaincase halves	1	G3C	5
024286	Nut, chaincase centre stud	1	G12DL, G12CS, G12CSR	1 0
000011	Washer, plain chaincase centre bolt	1	G3, G80, G80CS	1
014117	Washer, shakeproof, chaincase centre stud	1	G9, G12	1
023117	Spacer, behind chaincase	1	G3C	11
REAR CHAINGUARD				
024157	Chainguard, rear, only	1	G3, G80	9 10
025154	Chainguard, rear, only	1	G3C	0 0
022461	Chainguard, rear, only	1	G80CS	9 10
024154	Chainguard, rear, only	1	All twins	9 10
024449	Bolt, fixing chainguard, front	1	All except G3C	11
024218	Bolt, fixing chainguard, rear	1	All except G3C	6
000346	Bolt, fixing chainguard, front and rear	2	G3C	5
023146	Nut, chainguard front fixing bolt	1	All except G3C	3
023509	Washer, tab, chainguard front fixing bolt	1	All except G3C	3
021578	Spacer, chainguard rear fixing bolt	1	All except G3C	7
021579	Washer, chainguard rear fixing bolt	1	All except G3C	1
000011	Washer, plain chainguard rear fixing bolt	1	All except G3C	1
000012	Washer, plain, chainguard rear fixing bolt	2	G3C	1
BATTERY CARRIER				
C...-49	Carrier, battery, assembled	1	G3C	15 10
022450	Carrier, battery, back portion only	1	G3C	6 6
023097	Strap, retaining battery	1	All except G3C, G80CS	2 8
021722	Strap, retaining battery	1	G3C	6 7
010854	Pin, hinge, battery strap	1	G3C	4
012798	Bolt, battery strap	1	G3C	10
012291	Seat, battery strap bolt	1	G3C	5
010851	Nut, battery strap bolt	1	G3C	11
026359	Rubber, battery support	1	All except G3C, G80CS	6
026360	Rubber, battery steady	4	All except G3C, G80CS	3
026361	Rubber, battery steady, rear	4	All except G3C, G80CS	3
014577	Bolt, battery, earthing	1	All except G80CS	3
000012	Washer, battery, earthing bolt	1	All except G80CS	1
FOOTREST				
018621	Arm, footrest	2	G3, G80, G9, G12, G12DL	12 8
018632	Arm, footrest	2	G3C	15 10
026601	Arm, footrest, left	1	G80CS, G12CS	1 9 3
026603	Arm, footrest, left	1	G12CSR	2 0 0
023430	Arm, footrest, right	1	G80CS, G12CS	1 13 0
024462	Arm, footrest, right	1	G12CSR	1 13 0
010847	Rubber, pad, footrest arm	2	All except C and CS	2 3
018604	Rod, footrest arm	1	All except G3C, G80CS, G12CS, G12CSR	3 5
022499	Rod, footrest arm (also serves as centre stand stud)	1	G3C	5 8
016462	Rod, footrest arm	1	G80CS, G12CS, G12CSR	3 6
026604	Spacer, footrest arm	1	G80CS, G12CS, G12CSR	11
010911	Spacer, footrest rod, outside, left	1	G3, G80, G9, G12, G12DL	10
013837	Spacer, footrest rod, outside, right	1	G3, G80, G9, G12, G12DL	1 9
022636	Spacer, footrest rod, outside, right	1	G3C	4
C...484	Spacer, footrest rod	1	G80CS, G12CS, G12CSR	1 1
010924	Spacer, footrest rod (between engine plates)	1	All except G3C	1 9
PILLION FOOTRESTS				
021641	Spindle, only, pillion footrests	2	All touring and G12CSR	4 7
010847	Pad, rubber, pillion footrest spindle	2	All touring and G12CSR	2 3

011599	Bolt, hinge, pillion footrest spindle	2	All touring and G12CSR	10
000073	Nut, pillion, footrest spindle hinge bolt	2	All touring and G12CSR	4
G...174	Yoke, pillion footrest spindle, left	1	G12CSR	5 0
C...75	Yoke, pillion footrest spindle, right	1	G12CSR	5 0
024175	Yoke, pillion footrest spindle, left (dual exhaust)	1	G12CSR	5 0
000003	Nut, pillion footrest spindle, yoke	2	G12CSR	4
000010	Washer, plain, pillion footrest spindle yoke	2	G12CSR	1
014119	Washer, shakeproof, pillion footrest spindle yoke	1	G12CSR	1

TWIN SEAT AND SADDLE

026223	Twinsat, only	1	All touring	7 15 0
026096	Twinsat, only	1	G80CS, G12CS, G12CSR	6 12 6
023251	Screw, fixing twinsat at rear	2	All touring	1 5
022083	Nut, twinsat rear fixing screw	2	All touring	5
000011	Washer, plain, twinsat rear fixing screw	2	All touring	1
000342	Bolt, fixing, twin seat at rear	2	G80CS, G12CS, G12CSR	4
000172	Washer, plain, twinsat rear fixing bolt	2	G80CS, G12CS, G12CSR	2
026536	Nut fixing twinsat at front	2	G80CS, G12CS, G12CSR	1
000176	Washer, plain, twinsat fixing nut at front	2	G80CS, G12CS, G12CSR	2
023086	Saddle, complete, with springs	1	G3C	2 12 5
018998	Saddle, less springs	1	G3C	2 0 2
025203	Spring, for saddle	2	G3C	6 0
012880	Stud, for saddle spring	2	G3C	7
000073	Nut, for saddle spring stud	6	G3C	4
000376	Bolt, saddle, front hinge	1	G3C	1 0
000004	Nut, saddle, front hinge bolt	1	G3C	4
000011	Washer, plain, saddle front hinge bolt	1	G3C	1
021217	Bush, saddle, front hinge bolt	1	G3C	4

TOOL BOX

026346	Tool box, with lid, bare, black	1	G3, G80, G9, G12	2 8 2
026389	Tool box, with lid, bare, off white	1	G3, G80, G9, G12	2 7 1
025183	Tool box, with cap, bare, black	1	G3C, G80CS	1 17 8
025479	Tool box, with cap, bare, off white	1	G3C, G80CS	1 17 8
026385	Tool box, with lid, bare, black	1	G12DL, G12CS	2 7 4
026390	Tool box, with lid, bare, off white	1	G12DL, G12CS, G12CSR	2 9 1
026387	Tool box, with lid, bare, red	1	G12DL, G12CS, G12CSR	2 11 0
014033	Cap, for tool box	1	G3C, G80CS	18 4
013936	Pin, split, tool box cap	1	G3C, G80CS	1
014511	Screw, knurled, for tool box lid	1	All except G3C, G80CS	1 5
000005	Nut, tool box lid knurled screw	2	All except G3C, G80CS	4
000189	Washer, spring, tool box lid knurled screw	1	All except G3C, G80CS	1
000070	Bolt, fixing tool box, top and rear	2	All except G3C, G80CS	4
000005	Nut, tool box fixing bolt	2	All except G3C, G80CS	4
000012	Washer, plain, tool box fixing bolt	4	All except G3C, G80CS	1
026353	Bracket, tool box fixing	1	All except G3C, G80CS	3 0
000362	Bolt, tool box fixing bracket	1	All except G80CS	5
000094	Nut, tool box fixing bracket	1	All except G80CS	4
000011	Washer, plain, tool box fixing bracket bolt	2	All except G3C, G80CS	1
000288	Stud, rear engine plate (tool box)	1	G80CS	10
017198	Spacer, rear engine plate (tool box) stud	1	G80CS	1 3
000004	Nut, rear engine plate (tool box) stud	2	G80CS	1
000011	Washer, plain, rear engine plate (tool box) stud	2	G80CS	4
000174	Washer, plain, large, tool box fixing bolt	2	G3C	2

PETROL TANK (STANDARD FINISH)

026142	Tank, petrol, bare, black, lined	1	G3, G80	8 1 0
024065	Tank, petrol, bare, black, lined, alloy, 2 gallon	1	G3C	12 13 7
026110	Tank, petrol, bare, lined	1	G80CS	8 9 9
026645	Tank, petrol, bare, black, lined	1	G9, G12	8 13 6
026647	Tank, petrol, bare, black (for chrome panels)	1	G12DL	7 13 4
026115	Tank, petrol, bare, red, lined	1	G12CS	7 1 0
026652	Tank, petrol, bare, red (for chrome panels)	1	G12CSR	8 17 8
026606	Bead, centre, top of petrol tank	1	All except G3C, G80CS, G12CS...	11 6
023359	Panel, side of petrol tank, left, chrome	1	G12DL, G12CSR	1 14 6
023358	Panel, side of petrol tank, right, chrome	1	G12DL, G12CSR	1 14 6
023360	Bead, petrol tank side panel, red	2	G12DL, G12CSR	1 3
018896	Seating, rubber, petrol tank motif	2	All except G3C, G80CS, G12CS...	1 2
000153	Screw, petrol tank motif	4	G3, G80, G9, G12	3
023371	Screw, petrol tank motif	4	G12DL, G12CSR	3
018891	Motif, for petrol tank	2	All except G3C, G80CS, G12CS...	8 6
023085	Grip, knee, rubber, for petrol tank, left	1	All except G3C, G80CS, G12CS...	4 7
023086	Grip, knee, rubber, for petrol tank, right	1	All except G3C, G80CS, G12CS...	4 7
023282	Plate, knee grip rubber, left	1	All except G3C, G80CS, G12CS...	2 7
023283	Plate, knee grip rubber, right	1	All except G3C, G80CS, G12CS...	2 7
000070	Bolt, knee grip plate	4	G3, G80, G9, G12	4
000343	Bolt, knee grip plate	4	G12DL, G12CSR	4
000178	Spacer, knee grip plate bolt	4	G3, G80, G9, G12	1
000172	Washer, knee grip plate bolt	4	G12DL, G12CSR	1
042423	Spacer, knee grip plate bolt	4	G12DL, G12CSR	3
013325	Cap, filler, petrol tank	1	All except G3C, G80CS, G12CS...	8 2
014034	Cap, filler, petrol tank	1	G3C, G80CS, G12CS	12 7

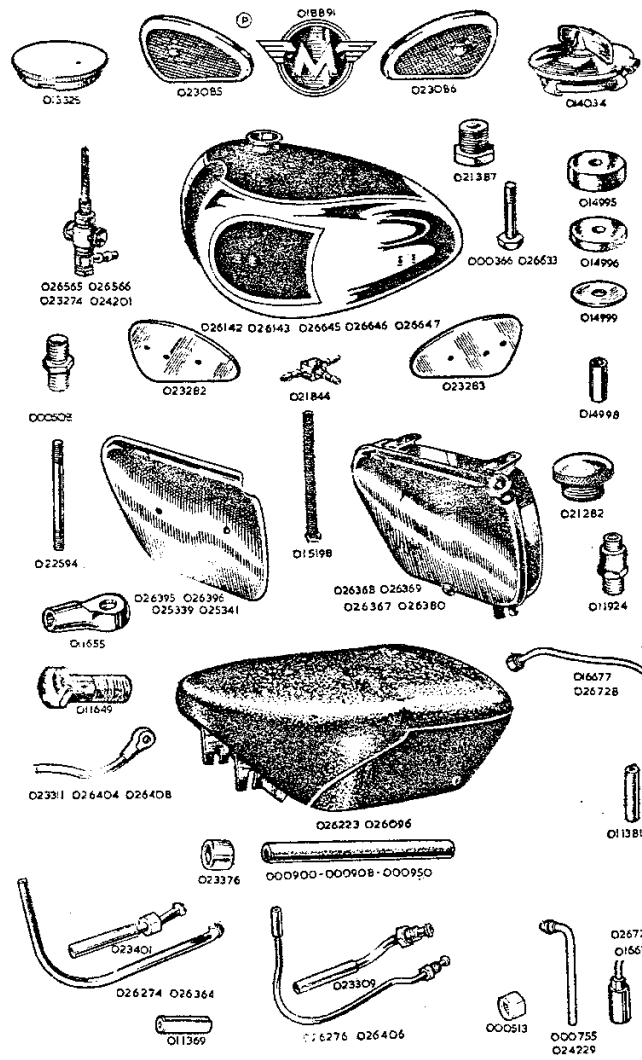

013936	Pin, split, petrol tank filler cap	1	G3C, G80CS, G12CS	1
026565	Tap, petrol, main supply	1	G3, G80, G9, G12, G12DL	9 3
026566	Tap, petrol, main supply	1	G3C, G80CS, G12CS, G12CSR	9 3
023274	Tap, petrol, "reserve"	1	G3, G80, G9, G12, G12DL	10 3
024201	Tap, petrol, "reserve"	1	G3C, G80CS, G12CS, G12CSR	8 3
000183	Washer, fibre, petrol tap	2	G3C, G80CS, G12CS	1 4
021387	Adaptor, petrol tap, short	1	G3C, G80CS, G12CS	2 5
000908	Pipe, plastic, for petrol feed, 12 1/2 ins.	1	G3, G80	1 8
000908	Pipe, plastic, for petrol feed, 8 1/2 ins.	1	G3C...	2 7
000908	Pipe, plastic, for petrol feed, 20 1/2 ins.	1	G80CS	2 8
000908	Pipe, plastic, for petrol feed, 14 ins.	1	All twins	3 5
021844	"T" piece, union for petrol feed pipe	1	G80CS	1 3
023756	Banjo, for petrol tap	2	G3, G80, G9, G12, G12DL	1 3
023757	Bolt, for petrol tap banjo	2	G3, G80, G9, G12, G12DL	1 10
000366	Bolt, petrol tank, front	2	G3, G80	2 3
021175	Bolt, petrol tank, front	2	G3C, G80CS, G12CS	4 0
026633	Bolt, petrol tank, front	2	G9, G12, G12DL, G12CSR	4 3
014998	Sleeve, petrol tank front bolt	2	G3, G80	4 4
014999	Washer, petrol tank front bolt	2	All except G3C, G80CS, G12CS...	2
000009	Washer, inner, petrol tank front bolt	2	G9, G12, G12DL, G12CSR	2

021453	Washer, petrol tank front bolt	2	G3C, G80CS, G12CS	2
000177	Washer, petrol tank front bolt	2	G80CS, G12CS	1
014995	Rubber, thick, petrol tank front bolt	2	G3, G80, G80CS, G12CS	5
014996	Rubber, thin, petrol tank front bolt	2	G3, G80	3
021174	Rubber, petrol tank front bolt	2	G3C, G80CS, G12CS	1 7
014995	Rubber, petrol tank front bolt	4	G9, G12, G12DL, G12CSR	5
016845	Nut, petrol tank front bolt	2	G3C, G80CS, G12CS	4
022083	Nut, petrol tank front bolt	2	G9, G12, G12DL, G12CSR	5
026626	Clip, petrol tank, rear, bottom	1	G9, G12, G12DL, G12CSR	11 9
026630	Rubber, mounting, petrol tank, rear	2	G9, G12, G12DL, G12CSR	6
026834	Stud, petrol tank rear clip	2	G9, G12, G12DL, G12CSR	5
000011	Washer, plain, petrol tank rear clip stud	2	G9, G12, G12DL, G12CSR	1
000004	Nut, petrol tank rear clip stud	2	G9, G12, G12DL, G12CSR	4
042269	Bolt, petrol tank, rear	1	G3, G80, G80CS, G12CS	9
014996	Rubber, petrol tank rear bolt	2	G3, G80, G80CS, G12CS	3
014999	Washer, petrol tank rear bolt	1	G3, G80, G80CS, G12CS	4
024074	Stud, petrol tank, rear	1	G3C...	4
024361	Rubber, petrol tank, rear stud	2	G3C...	11
024073	Spacer, petrol tank rear stud	1	G3C...	7
024072	Sleeve, petrol tank rear stud	1	G3C...	6
000174	Washer, petrol tank rear stud	2	G3C...	2
022083	Nut, petrol tank rear stud	2	G3C...	5

PETROL TANK (ALTERNATIVE FINISH)

026144	Tank, petrol, bare, black (for chrome panels)	1	G3, G80	7 1 0
026145	Tank, petrol, bare, off-white/red	1	G3, G80	9 1 8
026147	Tank, petrol, bare, off-white	1	G3, G80	8 1 8
026149	Tank, petrol, bare, red (for chrome panels)	1	G3, G80	8 5 3
025505	Tank, petrol, bare, red, lined, alloy, 2 gallon	1	G3C...	12 18 0
025502	Tank, petrol, bare, red, lined, steel, 2 1/2 gallon	1	G3C...	11 0 0
025511	Tank, petrol, bare, black, lined, steel, 2 1/2 gallon	1	G3C...	11 0 0
025321	Tank, petrol, bare, red, lined, steel, 3 gallon	1	G3C...	11 18 0
025548	Tank, petrol, bare, red and chrome, 3 gallon	1	G3C...	11 18 0
025397	Tank, petrol, bare, black, lined, alloy, 3 gallon	1	G3C...	12 18 0
026115	Tank, petrol, bare, red, lined	1	G80CS, G12CS	7 1 0
026121	Tank, petrol, bare, red, lined, steel, 3 gallon	1	G80CS, G12CS	11 6 8
026123	Tank, petrol, bare, red and chrome, 3 gallon	1	G80CS, G12CS	14 11 0
026647	Tank, petrol, bare, black (for chrome panels)	1	G9, G12	7 13 4
026648	Tank, petrol, bare, off-white/red	1	G9, G12, G12DL, G12CSR	9 10 5
026650	Tank, petrol, bare, off-white	1	G9, G12, G12DL, G12CSR	8 14 2
026652	Tank, petrol, bare, red (for chrome panels)	1	G9, G12, G12DL	8 17 8
026539	Embellisher, for two-tone tank, left	1	G3, G80, G9, G12, G12DL, G12CSR	12 9
026540	Embellisher, for two-tone tank, right	1	G3, G80, G9, G12, G12DL, G12CSR	12 9
014577	Bolt, knee grip plate, two-tone tank	4	G3, G80, G9, G12, G12DL, G12CSR	3
023359	Panel, side for petrol tank, chrome, left	1	G3, G80, G9, G12...	14 6
023358	Panel, side for petrol tank, chrome, right	1	G3, G80, G9, G12...	14 6
023360	Bead, for petrol tank side panel, red	2	G3, G80, G9, G12...	4 11
023371	Screw, petrol tank motif (chrome panels)	4	G3, G80, G9, G12...	3
000343	Bolt, knee grip plate (chrome panels)	4	G3, G80, G9, G12...	4
000172	Washer, knee grip plate (chrome panels)	4	G3, G80, G9, G12...	2
042423	Spacer, knee grip plate (chrome panels)	4	G3, G80, G9, G12...	3

OIL TANK

026368	Tank, oil, bare, black	1	G3, G80	4 5 3
026478	Tank, oil, bare, off-white	1	G3, G80	4 7 0
026479	Tank, oil, bare, red	1	G3, G80	4 13 9
025160	Tank, oil, bare, black	1	G3C...	3 6 10
025451	Tank, oil, bare, off-white	1	G3C...	3 12 0
026376	Tank, oil, bare	1	G80CS	5 14 0
026369	Tank, oil, bare, black	1	G9, G12, G12DL	3 19 10
026481	Tank, oil, bare, off-white	1	G9, G12, G12DL	3 19 10
026380	Tank, oil, bare, black	1	G12CS, G12CSR	3 19 7
026483	Tank, oil, bare, off-white	1	G12CS, G12CSR	4 2 9
026541	Tank, oil, bare, red	1	G12CS, G12CSR	4 7 6
026395	Cover, only, oil tank, black	1	G9, G12, G12DL	1 5 9
026485	Cover, only, oil tank, off-white	1	G9, G12, G12DL	1 10 5
026486	Cover, only, oil tank, red	1	G9, G12, G12DL	1 10 5
025339	Cover, only, oil tank, black	1	G12CS, G12CSR	1 4 3
025534	Cover, only, oil tank, off-white	1	G12CS, G12CSR	1 4 3
025340	Cover, only, oil tank, red	1	G12CS, G12CSR	1 8 6
022632	Screw, oil tank cover	2	All twins	11
000203	Washer, fibre, oil tank cover screw	2	All twins	1
000012	Washer, plain, oil tank cover screw	2	All twins	1
025352	Cap, filter, oil tank	1	All except G3C	6 0
021282	Cap, filter, oil tank	1	G3C...	10
021329	Washer, oil tank filler cap	1	G3C...	2
012019	Plug, oil drain	1	All	5
000200	Washer, fibre, oil tank drain plug	1	All	4
000361	Bolt, top, front, oil tank	1	All except G3C, G80CS	5
000362	Bolt, top, front, oil tank	1	G80CS	4
000011	Washer, top, front, oil tank bolt	1	All except G3C, G80CS	1
014999	Washer, top, front, oil tank bolt	6	G80CS	4
026538	Bolt, oil tank bracket, bottom	1	G80CS	2 3

014996	... Rubber, plain, oil tank bracket	... 1	G80CS	3
016025	... Rubber, spigot, oil tank bracket	... 1	G80CS	6
042425	... Sleeve, oil tank, bracket bottom bolt	... 1	G80CS	3
000005	... Nut, oil tank bracket bottom bolt	... 1	G80CS	4
000012	... Washer, plain, oil tank bracket bottom bolt	... 1	G80CS	1
000004	... Nut, oil tank bracket...	... 1	G80CS	4
000347	... Bolt, oil tank to mudguard bracket	... 1	G3C...	5
000005	... Nut, oil tank to mudguard bracket bolt	... 1	G3C...	4
000012	... Washer, small, oil tank to mudguard bolt...	... 1	G3C...	1
000172	... Washer, large, oil tank to mudguard bolt...	... 1	G3C...	2
022594	... Stud, oil tank	... 2	G3C...	3
000004	... Nut, oil tank stud	... 2	G3C...	4
000011	... Washer, plain, oil tank stud	... 2	G3C...	3
000370	... Bolt, oil tank to mudguard support	... 1	G80CS	6
000369	... Bolt, oil tank to mudguard support	... 1	G12CS, G12CSR	5
000004	... Nut, oil tank to mudguard support bolt	... 1	G80CS, G12CS, G12CSR	4
000011	... Washer, plain, oil tank to mudguard support bolt	... 1	G80CS, G12CS, G12CSR	1

OIL PIPE

023401	... Pipe, oil feed	... 1	G3, G80	8 7
026274	... Pipe, oil feed	... 1	G3C...	9 9
026364	... Pipe, oil feed	... 1	G80CS	12 0
023311	... Pipe, oil feed and return	... 2	G9, G12, G12DL	15 3
026404	... Pipe, oil feed	... 1	G12CS, G12CSR	1 2 3
000950	... Hose, rubber, oil feed and return pipe, 18 ins.	... 2	G3, G80	2 10
011369	... Hose, rubber, connection, oil feed and return pipe	... 2	G3C...	10
000950	... Hose, rubber, oil feed pipe 12½ ins.	... 1	G80CS	1 11
000950	... Hose, rubber, oil return pipe, 14½ ins.	... 1	G80CS	2 2
014752	... Hose, rubber, connection, oil feed and return pipe	... 2	G12CS, G12CSR	7
000950	... Hose, rubber, oil feed pipe, 22 ins.	... 1	G9, G12, G12DL	3 6
000950	... Hose, rubber, oil return pipe, 18 ins.	... 1	G9, G12, G12DL	2 10
015198	... Filter, metal gauze, oil feed pipe	... 1	All	2 6
011924	... Union, oil feed pipe	... 1	All singles	1 6
023376	... Ferrule, oil feed and return pipe hose	... 4	All except G3C, G12CS, G12CSR	3
023309	... Pipe, oil return	... 1	G3, G80	6 11
026276	... Pipe, oil return	... 1	G3C...	15 0
026406	... Pipe, oil return	... 1	G80CS	15 6
026408	... Pipe, oil return	... 1	G12CS, G12CSR	19 0
000951	... Sheath, plastic for oil pipes, 5 ins.	... 1	All except C, CS and CSR	6
011649	... Pin, banjo, retaining oil pipes to engine	... 2	All twins	3 1
000183	... Washer, fibre, oil pipe banjo pin	... 4	All twins	4
026363	... Pipe, vent (chain oiler)	... 1	All except G3C, G80CS	6 0
022570	... Pipe, vent (chain oiler)	... 1	G3C...	6 4
026453	... Pipe, vent (chain oiler)	... 1	G80CS	5 3
000900	... Hose vent pipe, 7½ ins.	... 1	All except G3C	1 5
000900	... Hose vent pipe, 5 ins.	... 1	G3C...	1 0
026278	... Pipe, rocker box oil feed, top portion	... 1	G3, G80, G80CS	3 8
016677	... Pipe, rocker box oil feed, top portion	... 1	G3C...	3 5
026729	... Pipe, rocker box oil feed, bottom portion	... 1	G3, G80, G80CS	10 1
016678	... Pipe, rocker box oil feed, bottom portion	... 1	G3C...	9 5
011361	... Connection, rubber, rocker box feed pipe	... 1	All singles	1 3
000513	... Nut, union, rocker box feed pipe, top	... 1	All singles	7
017180	... Nut, union, rocker box feed pipe, bottom	... 1	All singles	2 4
000755	... Pipe, oil discharge, for release valve	... 1	G3, G80	3 5
024229	... Pipe, oil discharge, for release valve	... 1	G3C, G80CS	4 9

TWIST GRIP

023739	... Grip, twist, complete	... 1	G3, G3C, G80, G9, G12, G12DL	9 0
020024	... Grip, twist, complete	... 1	G80CS	5 0
016658	... Grip, twist, complete	... 1	G12CS, G12CSR	11 0
366-001	... Body, twist grip, top half	... 1	G3, G3C, G80, G9, G12, G12DL	3 0
364-002	... Body, twist grip, top half	... 1	G80CS	6 6
16-060	... Body, twist grip, top half	... 1	G12CS, G12CSR	3 0
366-002	... Body, twist grip, bottom half	... 1	G3, G3C, G80, G9, G12, G12DL	3 8
364-001	... Body, twist grip, bottom half	... 1	G80CS	8 8
16-061	... Body, twist grip, bottom half	... 1	G12CS, G12CSR	2 6
366-004	... Rotor, twist grip	... 1	G3, G3C, G80, G9, G12, G12DL	6 6
364-008	... Rotor, twist grip	... 1	G80CS	6 3
16-091	... Rotor, twist grip	... 1	G12CS, G12CSR	4 3
16-070	... Grip, rubber, twist grip rotor	... 1	All	1 0
376-079	... Screw, clamping twist grip halves	... 2	G3, G3C, G80, G9, G12, G12DL	2
376-079	... Screw, clamping twist grip halves	... 2	G80CS	2
11-013	... Screw, clamping twist grip halves, long	... 1	G12CS, G12CSR	4
11-014	... Screw, clamping twist grip halves, short	... 1	G12CS, G12CSR	4
366-007	... Spring, friction, twist grip	... 1	G3, G3C, G80, G80CS, G9, G12, G12DL	10
16-008	... Spring, friction, twist grip	... 1	G12CS, G12CSR	7
366-008	... Screw, for friction spring	... 1	G3, G3C, G80, G80CS, G9, G12, G12DL	6
16-009	... Screw, for friction spring	... 1	G12CS, G12CSR	2
16-010	... Nut, lock, friction spring screw	... 1	G80CS, G12CS, G12CSR	8
023443	... Stop, slotted, for cable	... 1	G3, G3C, G80, G9, G12, G12DL	8
023446	... Stop, slotted, for cable	... 1	G12CS, G12CSR	6

DUMMY GRIP

16-069	... Grip, dummy, for left side of handlebar	... 1	All	1 6
--------	---	-------	-----	--------	-----

BRAKE AND AIR CONTROL LEVERS

026238	... Lever, assembly, front brake and air	... 1	G3, G80, G9, G12, G12DL, G12CSR	1 0 7
026233	... Lever, assembly, front brake	... 1	G3C...	11 6
026259	... Lever, assembly, front brake	... 1	G80CS	11 6
026320	... Lever, assembly, front brake and air	... 1	G12CS	1 0 7
023737	... Lever, assembly, air, only	... 1	G3C, G80CS	9 11
023707	... Trunnion, brake lever	... 1	All	3
18-535	... Lever, only, front brake	... 1	G3, G3C, G80, G9, G12, G12DL, G12CSR	6 5
022715	... Lever, only, front brake	... 1	G80CS, G12CS	6 8
18-816	... Body, only, front brake lever	... 1	G3, G80, G9, G12, G12DL, G12CS, G12CSR	6 5
18-812	... Body, only, front brake lever	... 1	G3C, G80CS	6 5
18-087	... Screw, pivot, front brake lever	... 1	All	3
18-053	... Nut, lock front brake lever pivot pin	... 1	All	3
12-595	... Clamp, front brake lever body	... 1	G3C, G80CS	11
11-014	... Screw, front brake lever body clamp	... 2	G3C, G80CS	4
12-556	... Lever, only, air	... 1	All	4 7
12-594	... Body, only, air lever	... 1	All	3 4
12-607	... Bolt, central, air control lever	... 1	All	8
12-606	... Cap, air control lever	... 1	All	1 2
12-033	... Washer, spring, air control lever	... 1	All	2
11-013	... Screw, clamping lever body	... 1	G3, G80, G9, G12, G12DL, G12CS, G12CSR	4
11-014	... Screw, clamping lever body	... 1	G3, G80, G9, G12, G12DL, G12CS, G12CSR	4
12-595	... Clamp, air control lever body	... 1	G3C, G80CS	11
11-014	... Screw, air control lever body clamp	... 2	G3C, G80CS	4

CLUTCH AND IGNITION CONTROL LEVERS

026232	... Lever, assembly, clutch	... 1	G3, G3C, G80, G9, G12	11 6
026258	... Lever, assembly, clutch	... 1	G80CS	11 6
026255	... Lever, assembly, clutch and ignition	... 1	G12DL, G12CSR	1 0 7
026321	... Lever, assembly, clutch and ignition	... 1	G12CS	1 0 7
023735	... Lever, assembly, ignition	... 1	G3C, G80CS	9 11
023707	... Trunnion, clutch lever	... 1	All	3
18-528	... Lever, only, clutch	... 1	G3, G3C, G80, G9, G12, G12DL, G12CSR	6 5
022714	... Lever, only, clutch	... 1	G80CS, G12CS	6 8
18-814	... Body, only, clutch lever	... 1	G3, G3C, G80, G80CS, G9, G12	6 5
18-818	... Body, only, clutch lever	... 1	G12DL, G12CS, G12CSR	6 5
18-087	... Screw, pivot, clutch lever	... 1	All	3
18-053	... Nut, lock, clutch lever pivot screw	... 1	All	3
12-595	... Clamp, clutch lever body	... 1	G3, G3C, G80, G80CS, G9, G12	11
11-014	... Screw, clutch lever body clamp	... 2	G3, G3C, G80, G80CS, G9, G12	4
12-557	... Lever, only, ignition	... 1	G3C, G80CS, G12DL, G12CS, G12CSR	4 7
12-596	... Body, only, ignition lever	... 1	G3C, G80CS, G12DL, G12CS, G12CSR	3 4
12-607	... Bolt, central, ignition lever	... 1	G3C, G80CS, G12DL, G12CS, G12CSR	8
12-606	... Cap, ignition lever	... 1	G3C, G80CS, G12DL, G12CS, G12CSR	1 2
12-033	... Washer, spring, ignition lever	... 1	G3C, G80CS, G12DL, G12CS, G12CSR	2
11-013	... Screw, clamping lever body, long	... 1	G12DL, G12CS, G12CSR	4
11-014	... Screw, clamping lever body, short	... 1	G12DL, G12CS, G12CSR	4
12-595	... Clamp, ignition lever body	... 1	G3C, G80CS	11
11-014	... Screw, ignition lever body clamp	... 2	G3C, G80CS	4

VALVE LIFTER LEVER

026239	... Lever assembly, valve lifter	... 1	G3, G3C, G80, G80CS	7 9
18-877	... Body only, valve lifter lever	... 1	G3, G3C, G80, G80CS	3 4
18-871	... Lever only, valve lifter	... 1	G3, G3C, G80, G80CS	3 0
11-014	... Screw, pivot, valve lifter lever	... 1	G3, G3C, G80, G80CS	4
18-060	... Nut, lock valve lifter lever pivot screw	... 1	G3, G3C, G80, G80CS	3
76-016	... Washer, shakeproof, valve lifter pivot screw	... 1	G3, G3C, G80, G80CS	1
12-604	... Clamp valve lifter lever body	... 1	G3, G3C, G80, G80CS	11
376079	... Screw, valve lifter lever body clamp	... 2	G3, G3C, G80, G80CS	2

FRONT BRAKE CABLE

022874	... Cable, assembled, front brake	... 1	G3, G80, G9, G12, G12DL, G12CSR	8 7
026253	... Cable, assembled, front brake	... 1	G3C...	7 9
026807	... Cable, assembled, front brake	... 1	G80CS, G12CS	7 6
025583	... Adjuster, front brake cable	... 1	All except G3C	2 0
025597	... Adjuster, front brake cable	... 1	G3C...	2 0
025584	... Nut, lock, front brake cable adjuster	... 1	All	1 0
042764	... Sleeve, plastic, front brake cable, 7½ ins.	... 1	All except G3C	1

CLUTCH CABLE

026250	... Cable, assembled, clutch	G3, G80, G9, G12, G12DL, G12CSR	7	3
026251	... Cable, assembled, clutch	G3C	7	0
026806	... Cable, assembled, clutch	G80CS, G12CS	7	3
014225	... Adjuster, clutch cable	All		11
011373	... Nut, lock clutch cable adjuster	All		2

VALVE LIFTER CABLE

026244	... Cable, assembled, valve lifter	G3, G80	6	3
026254	... Cable, assembled, valve lifter	G3C	6	6
026810	... Cable, assembled, valve lifter	G80CS	6	6
014225	... Adjuster, valve lifter cable	G3, G3C, G80, G80CS		11
011373	... Nut, lock, valve lifter cable adjuster	G3, G3C, G80, G80CS		2

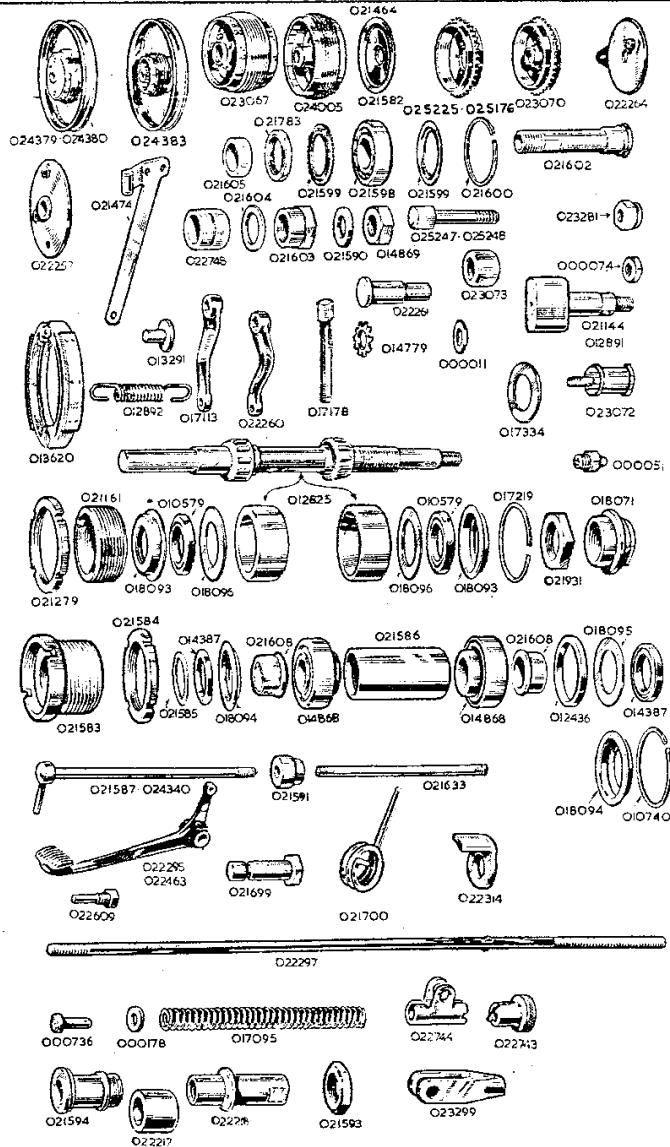

THROTTLE CABLE

042871	... Cable, assembled, throttle	G3, G9	4	3
024172	... Cable, assembled, throttle	G3C	3	0
026804	... Cable, assembled, throttle	G80	4	3
026260	... Cable, assembled, throttle	G80CS	5	0
026805	... Cable, assembled, throttle	G12, G12DL	5	0
026809	... Cable, assembled, throttle	G12CS	5	0
026745	... Cable, assembled, throttle	G12CSR	5	0

AIR CABLE

023696	... Cable, assembled, air	G3, G3C	1	9
023695	... Cable, assembled, air	G80	1	9
026317	... Cable, assembled, air	G80CS	4	3
026802	... Cable, assembled, air	G9	4	3
026803	... Cable, assembled, air	G12, G12DL, G12CSR	4	3
026808	... Cable, assembled, air	G12CS	4	2

IGNITION CABLES

023702	... Cable, assembled, ignition	G3C, G80CS	10	0
018749	... Cable, assembled, ignition	G12DL, G12CSR	10	0
025311	... Cable, assembled, ignition	G12CS	10	0
022133	... Set of parts ignition cable	G3C, G80CS, G12DL, G12CS, G12CSR	10	0

CONTROL CABLE SLEEVES

022728	... Sleeve, rubber, for control cables	G3, G80, G9, G12, G12DL	2	3
022728	... Sleeve, rubber, for control cables	G12CS, G12CSR	4	3
022728	... Sleeve, rubber, for control cables	G3C, G80CS	5	3

FRONT WHEEL

THE COMPLETE WHEELS LISTED BELOW COMPRISE:—

Rim, spokes, nipples, hub, hubdisc, grease nipple, all bearings, and all brake parts including cover plate and expanding lever, but does not include the tyre.

024379	... Wheel, front, complete, with all fittings	G3, G80, G9, G12, G12DL, G12CSR	17	8	6
025422	... Wheel, front, complete, with fittings	G3C	13	3	3
024380	... Wheel, front, complete, with fittings	G80CS, G12CS	17	12	9
024381	... Wheel, front, bare, less fittings	G3, G80, G9, G12, G12DL, G12CSR	9	1	10
025423	... Wheel, front, bare, less fittings	G3C	6	12	6
024382	... Wheel, front, bare, less fittings	G80CS, G12CS	9	4	2
024348	... Rim, front wheel, 19 in. by 2 1/2 in, chrome	G3, G80, G9, G12, G12DL, G12CSR	2	4	0
021151	... Rim, front wheel, 21 in. by 2 1/2 in, chrome	G3C, G80CS, G12CS	2	4	11
021152	... Spoke, front wheel	G3, G80, G9, G12, G12DL, G12CSR	40		3
021153	... Spoke, front wheel	G80CS, G12CS	40		3
021111	... Spoke, front wheel, right side	G3C	20		2
021154	... Spoke, front, wheel, left side	G3C	20		2
021154	... Nipple, front wheel, spoke	All except G3C	40		2
021154	... Nipple, front wheel, spoke, left side	G3C	20		2
021693	... Nipple, front wheel, spoke, right side	G3C	20		7
000039	... Washer, for spoke, on hub flange	G3C	40		1
024005	... Hub, front, wheel, shell only, with liner	All except G3C	6	0	0
017365	... Hub, front, wheel, shell only, with brake drum	G3C	3	15	4
011090	... Tape, rim, for 19 in. by 2 1/2 in, rim	G9, G80, G9, G12, G12DL, G12CSR	2		3
013693	... Tape, rim, for 21 in. by 2 1/2 in, rim	G3, G80CS, G12CS	2		3
021464	... Disc, for right side of hub	All except G3C	9		7
000051	... Nipple, grease for hub	All	7		7
011708	... Bolt, security, for tyre	G3C, G80CS, G12CS	6		1
021550	... Grommet, rubber, for hub disc	G80CS, G12CS	7		7

FRONT WHEEL BEARINGS

012825	... Spindle, with roller bearings, front wheel	All	2	14	0
010579	... Seal, oil, front hub bearing	All	2		7
017219	... Ring, spring, locating, front hub bearing	All	1		4
018093	... Cup, front hub bearing oil seal	All	2		4
018096	... Ring, retaining, front hub bearing oil seal	All	2		1
017221	... Ring, spacing, front hub bearing oil seal	G3C	2		10
021161	... Ring, adjusting, front hub bearing	All except G3C	1		7
017224	... Ring, adjusting, front hub bearing	G3C	1		8
021279	... Nut, lock, front hub bearing adjusting ring	All except G3C	1		10
017223	... Nut, lock, front hub bearing adjusting ring	G3C	3		1
021931	... Nut, locating, front cover plate	All except G3C	1		0
017003	... Nut, locating, front cover plate	G3C	1		5
018071	... Nut, outside, securing cover plate	All except G3C	3		4
017486	... Nut, outside, securing cover plate	G3C	1		10
000009	... Washer, plain, front wheel spindle, left side	All	1		2
000001	... Nut, front wheel spindle, left side	All	1		5

REAR WHEEL

THE COMPLETE WHEELS LISTED BELOW COMPRISE:—

Rim, spokes, hub, grease nipple and all bearings assembled, but does NOT include centre solid spindle, washers, spacers, nuts, sprocket and brake parts or speedometer drive and tyre.

024383	Wheel, rear, complete, with all fittings	1	G3, G80, G9, G12, G12DL, G12CSR	12 17 10
025426	Wheel, rear, complete, with all fittings	1	G3C...	5 14 0
026798	Wheel, rear, complete, with all fittings	1	G80CS, G12CS	12 18 8
024384	Wheel, rear, bare, less fittings	1	G3, G80, G9, G12, G12DL, G12CSR	9 2 9
025427	Wheel, rear, bare, less fittings	1	G3C...	6 19 4
026797	Wheel, rear, bare, less fittings	1	G80CS, G12CS	9 3 7
024249	Rim, rear, wheel, 19 in. by 2 1/2 in., chrome	1	G3, G80, G9, G12, G12DL, G12CSR	2 4 0
011693	Rim, rear, wheel, 19 in. by 3 in., chrome	1	G3C...	2 4 11
021817	Rim, rear, wheel, 19 in. by 3 in., chrome	1	G80CS, G12CS	2 4 10
021691	Spoke, rear wheel	40	G3, G80, G9, G12, G12DL, G12CSR	3
017097	Spoke, rear wheel	40	G3C...	5
021692	Spoke, rear wheel	40	G80CS, G12CS	3
021693	Nipple, rear wheel spoke	40	G3, G80, G9, G12, G12DL, G12CSR	2
012472	Nipple, rear wheel spoke	40	G3C...	3
021694	Nipple, rear wheel spoke	40	G80CS, G12CS	2
023067	Hub, shell only, rear wheel	1	G3, G80, G9, G12, G12DL, G12CSR	6 14 6
016964	Hub, shell only, rear wheel	1	G3C...	3 9 5
023068	Hub, shell only, rear wheel	1	G80CS, G12CS	6 14 7
000051	Nipple, grease, rear hub shell	1	All	2 3
011090	Tape, rim, rear rim	1	All	6 1
011707	Bolt, security, rear tyre	2	G3C, G80CS, G12CS	7 10
021582	Disc, for right side of rear hub	1	All except G3C	7 10
021550	Grommet, rubber, rear hub disc	1	G3C, G80CS, G12CS	7

REAR WHEEL BEARINGS

014868	Bearing, roller, for rear hub (only sold complete)	2	All	18 2
014387	Seal, oil, rear hub bearing	2	All	5
018094	Cup, rear hub bearing oil seal	2	All except G3C	5
018094	Cup, rear hub bearing oil seal	1	G3C...	5
010740	Ring, spring, locating rear hub bearing	1	All	4
021585	Ring, retaining, rear hub bearing, small	1	All except G3C	2
018095	Ring, retaining, rear hub bearing, large	1	All except G3C	2
018095	Ring, retaining, rear hub bearing	3	G3C...	2
021436	Collar, spacing, between bearing and oil seal	1	All except G3C	1 2
021436	Collar, spacing, between bearing and oil seal	2	G3C...	1 2
021586	Spacer, between bearings	1	All except G3C	3 10
014706	Spacer, between bearings	1	G3C...	3 10
021608	Spacer, on spindle, for oil seals	2	All except G3C	2 0
014704	Spacer, on spindle, for oil seal	1	G3C...	5 0
010743	Spacer, on spindle, for oil seal	1	G3C...	1 5
021583	Ring, adjusting, rear hub bearing	1	All except G3C	4 8
010745	Ring, adjusting, rear hub bearing	1	G3C...	1 9
021584	Nut, lock, rear hub bearing adjusting ring	1	All except G3C	1 10
010437	Nut, lock, rear hub bearing adjusting ring	1	G3C...	1 10
021587	Spindle, centre solid, rear wheel	1	G3, G80, G9, G12, G12DL, G12CSR	2 8
021633	Spindle, centre solid, rear wheel	1	G3C...	9 6
024340	Spindle, centre solid, rear wheel	1	G80CS, G12CS	1 6 6
021594	Spacer, on solid spindle, for speedometer gear box (carries nut)	1	All except G3C	1 7
025180	Spacer, on solid spindle, for speedometer gear box (carries nut)	1	G3C...	6 9
021593	Nut, locking speedometer gear box	1	All	11
021454	Washer, outside speedometer gear box	1	All	2
021591	Spacer, on solid spindle (abuts against fork end speedometer side)	1	All except G3C	1 0
025182	Spacer, on solid spindle	2	G3C...	2 0
021590	Washer, solid spindle nut	1	All except G3C	4
021590	Washer, solid spindle nut	2	G3C...	4
014869	Nut, solid spindle	1	All except G3C	10
025181	Nut, solid spindle	2	G3C...	1 6

FRONT BRAKE

017335	Drum, ring, front brake	1	G3C...	1 7 1
000140	Screw, brake drum ring to hub flange	8	G3C...	4
022257	Plate, cover, front brake	1	All except G3C	1 16 4
017326	Plate, cover, front brake	1	G3C...	1 9 11
017334	Washer, locating cover plate	1	G3C...	5
021474	Stay, anchor, stay to cover plate	1	All except G3C	18 5
014807	Bolt, anchor, stay to cover plate	1	All except G3C	3 4
017522	Bolt, anchor, cover plate to slider	1	G3C...	3 1
014119	Washer, anchor stay bolt	1	All except G3C	1
000011	Washer, anchor bolt	1	G3C...	1
000004	Nut, anchor bolt	1	G3C...	4
000049	Pin, split, anchor bolt	1	G3C...	1
022261	Pin, fulcrum, brake shoes	1	All except G3C	1 9
021563	Screw, brake shoe fulcrum pin	1	All except G3C	1 8
000009	Washer, inner, brake shoe fulcrum pin	1	All except G3C	2
013620	Shoes, pair of, for front brake, with linings and rivets and thrust pins (only supplied in pairs)	Pair	All except G3C	1 11 5
017605	Shoes, pair of, for front brake, with linings and rivets and thrust pins (only supplied in pairs)	Pair	G3C...	1 3 3

013291	Pin, thrust, adjusting brake shoes	2	All except G3C	1 2
017606	Pin, thrust, adjusting brake shoes	2	G3C...	1 2
000174	Washer, plain, adjusting thrust pin	R	All except G3C	2
017670	Washer, plain, adjusting thrust pin	R	G3C...	2
010440	Linings, brake, per pair of, less rivets	Pair	All except G3C	6 1
010441	Linings, brake, per pair of, less rivets	Pair	G3C...	5 7
000113	Rivets, for brake linings	14	All except G3C	Doz. 3
000113	Rivets, for brake linings	16	G3C...	Doz. 3
012892	Spring, for brake shoes	2	All except G3C	5
017488	Spring, for brake shoes	2	G3C...	4
021144	Expander, for brake shoes	1	All except G3C	6 3
017487	Expander, for brake shoes	1	G3C...	6 3
017334	Washer, packing, expander bush	1	All except G3C	5
022600	Lever, brake shoe expander	1	All except G3C	12 5
017327	Lever, brake shoe expander	1	G3C...	8 0
000051	Nipple, grease, brake shoe expander	1	All	7
000004	Nut, expander lever	1	All	4
000174	Washer, expander lever	1	All	2

REAR BRAKE

025225	Sprocket, and brake drum, rear wheel	1	All except G3C, G12DL	2 14 5
025176	Sprocket, and brake drum, rear wheel	1	G3C...	2 4 9
023070	Sprocket, and brake drum, rear wheel	1	G12DL	2 17 1
025247	Bolt, retaining sprocket to rear hub	5	All except G3C, G12DL	1 9
042728	Bolt, retaining sprocket to rear hub	5	G3C...	5
023072	Pin, driving, in sprocket and rear hub	5	G12DL	1 9
023073	Rubber, sprocket driving pin	5	G12DL	11
023281	Nut, rear wheel sprocket bolt or driving pin	5	All except G3C	7
000074	Nut, rear wheel sprocket bolt	5	G3C...	4
016213	Washer, rear wheel sprocket bolt	5	All except G3C, G12DL	5
010708	Washer, tab, rear wheel sprocket nut	5	G3C...	1
022264	Plate, cover, rear brake	1	All except G3C	1 6 2
025186	Plate, cover, rear brake	1	G3C...	18 0
022910	Spacer, spindle nut	1	G3, G80, G9, G12, G12CSR	1 3
022217	Spacer, spindle nut	1	G80CS, G12CS	1 2
022218	Spacer, for cover plate, inner	1	G3, G80, G80CS, G9, G12, G12CS, G12CSR	5 10
022748	Spacer, for cover plate, outer	1	All except G3C	1 1
021605	Spacer, for cover plate, inner	1	G12DL	1 8
021602	Spindle, dummy, for brake drum	1	G12DL	6 11
021603	Nut, brake drum dummy spindle	1	G12DL	1 7
021598	Bearing, ball, brake drum	1	G12DL	1 2
021599	Washer, brake drum bearing	2	G12DL	2
021600	Circlip, brake drum bearing	1	G12DL	3
021783	Seal, oil, brake drum bearing	1	G12DL	3 10
013620	Shoes, pair of, for rear brake, with linings and thrust pins (only supplied in pairs)	Pair	All except G3C	1 11 0
017605	Shoes, pair of, for rear brake, with linings and thrust pins (only supplied in pairs)	Pair	G3C...	1 3 3
013291	Pin, thrust, adjusting brake shoes	2	All except G3C	1 2
017606	Pin, thrust, adjusting brake shoes	2	G3C...	1 2
000174	Washer, plain, adjusting thrust pin	R	All except G3C	2
017670	Washer, plain, adjusting thrust pin	R	G3C...	1
010440	Linings, brake, per pair of, less rivets	Pair	All except G3C	6 1
010441	Linings, brake, per pair of, less rivets	Pair	G3C...	5 7
000113	Rivets, for brake linings	14	All except G3C	Doz. 3
000113	Rivets, for brake linings	16	G3C...	Doz. 3
012892	Spring, for brake shoes	2	All except G3C	5
017488	Spring, for brake shoes	2	G3C...	4
012891	Expander, brake shoes	1	All except G3C	6 3
017487	Expander, brake shoes	1	G3C...	6 3
017113	Lever, brake shoe expander	1	All except G9, G12, G12DL	3 10
021473	Lever, brake shoe expander	1	G9, G12, G12DL	10 9
000051	Nipple, grease, brake shoe expander	1	All	7
000174	Washer, plain, brake shoe expander lever	1	All	2
000004	Nut, brake shoe expander lever	1	All	4
042879	Bolt, anchor, rear brake cover plate to frame	1	G3C...	7 9
000010	Washer, rear brake anchor bolt	1	G3C...	1
000003	Nut, rear brake anchor bolt	1	G3C...	4
000006	Pin, split, rear brake anchor bolt	1	G3C...	1

REAR BRAKE OPERATING PARTS

022295	Pedal, foot, for rear brake	1	G3, G80, G9, G12, G12DL	1 3 11
015175	Pedal, foot, for rear brake	1	G3C...	1 3
022463	Pedal, foot, for rear brake	1	G80CS, G12CS, G12CSR	1 3 10
022609	Bolt, foot brake pedal	1	All except G3C	4
021699	Fulcrum, foot brake pedal	1	All except G3C	2 7
000051	Nipple, grease, foot brake pedal	1	All	7
021700	Spring, return, foot brake pedal	1	All except G3C	1 3
017177	Spring, return, foot brake pedal	1	G3C...	1 3
022314	Stop, foot brake pedal	1	All except G3C	5
025177	Stop, foot brake pedal	1	G3C...	1 0
025179	Sleeve, foot brake pedal	1	G3C...	3 9
022297	Rod, rear brake, only	1	All except G3C	2 10
017187	Rod, rear brake, only	1	G3C...	2 10
017095	Spring, rear brake rod	1	All	5

000178	Washer, stop, rear brake rod spring	All	1
022744	Clip, adjusting, for front end of brake rod	All	3 0
000736	Pin, clevis, for adjusting clip...	All	5
000014	Pin, split, for clevis pin	All	1
023299	Yoke, end, for brake rod	All	5 5
000736	Pin, clevis, for brake rod yoke end	All	5
000014	Pin, split, for yoke end clevis pin	All	1
022743	Nut, adjusting, rear brake rod	All	2 6

HEADLAMPS (ALL EXCEPT G80CS)

58409A	Headlamp, with bulbs, ammeter and switches, less cable harness (home and export, except Europe)	G3, G80	6 5 0
58514A	Headlamp, with bulbs, ammeter and switches, less cable harness (Europe, except France)	G3, G80	6 5 0
58515A	Headlamp, with ammeter and switches, less cable harness and bulbs (France only)	G3, G80	6 5 0
58432A	Headlamp, with bulbs, ammeter and switches, less cable harness (home and export, except Europe)	G9, G12	6 5 0
58516A	Headlamp, with bulbs, ammeter and switches, less cable harness (Europe, except France)	G9, G12	6 5 0
58517A	Headlamp, with ammeter and switches, less bulbs and cable harness (France only)	G9, G12	6 5 0
58477A	Headlamp, with bulbs, ammeter and switches, less cable harness (home and export, except Europe)	G12DL, G12CSR	5 15 0
58518A	Headlamp, with bulbs, ammeter and switches, less cable harness (Europe, except France)	G12DL, G12CSR	5 15 0
58519A	Headlamp, with ammeter and switches, less bulbs and cable harness (France only)	G12DL, G12CSR	6 5 0
58224A	Headlamp, with bulbs, ammeter and switch less cable harness	G3C...	5 5 0
58208A	Headlamp, with bulbs, ammeter and switch less cable harness	G12CS	5 5 0
54520510	Shell, only, headlamp	G3, G80, G9, G12	2 0 0
54520009	Shell, only, headlamp	G3C, G12CS	2 5 0
54520728	Shell, only, headlamp	G12DL, G12CSR	2 0 0
553248	Rim, only, headlamp	All	15 6
516798	Light unit, reflector and glass (home and export, except Europe)	All	16 0
555275	Light unit, reflector and glass (Europe, except France)	All	18 6
516802	Light unit, reflector and glass (France only)	All	18 6
144921	Screw, fixing headlamp rim	All	4 9
554602	Holder, for bulb (All except France)	All	12 6
552943	Back shell and bulb holder (France only)	All	2 9
112201	Bolt, fixing headlamp to fork covers	All	1 0
025114	Washer, headlamp fixing bolts	All	1 0
54942783	Grommet, in shell for cable harness	All except G3C	1 0

REAR LAMP

022126	Lamp, rear, complete (Lucas L564)	G3, G80, G9, G12, G12DL	1 2 6
023287	Lamp, rear, complete (Lucas L53429A)	G3C, G12CS, G12CSR	15 0
021880	Support, rear lamp	G3C...	3 4
000738	Screw, rear lamp support	G3C...	2
000739	Nut, rear lamp support screw	G3C...	2
011094	Grommet, rubber, rear lamp cable...	G3, G80, G9, G12, G12DL	5
573839	Window, cover, red, for rear lamp...	G3, G80, G9, G12, G12DL	4 6
526404	Window, cover, red, for rear lamp...	G3C, G12CS, G12CSR	3 3
575200	Window, cover, white, for rear lamp...	G3, G80, G9, G12, G12DL	2 3
526406	Window, cover, white, for rear lamp...	G3C, G12CS, G12CSR	1 3
525208	Gasket, rubber, for window cover	G3, G80, G9, G12, G12DL	1 3
526415	Seat, rubber for rear lamp	G3C, G12CS, G12CSR	2 0
552928	Screw, retaining window cover	G3, G80, G9, G12, G12DL	7
133551	Screw, retaining window cover	G3C, G12CS, G12CSR	5
575207	Grommet, rubber, for bulb holder	G3, G80, G9, G12, G12DL	9
575209	Holder, for bulb	G3, G80, G9, G12, G12DL	2 0
860428	Wires, rear lamp, with paxolin washer	G3, G80, G9, G12, G12DL	1 0
526418	Holder, bulb, with cable	G3C, G12CS, G12CSR	3 0
573825	Cap, rubber, covering cable entry	G3, G80, G9, G12, G12DL	9
526410	Screw, fixing lamp to number plate	G3C, G12CS, G12CSR	1 0
166014	Nut, fixing lamp to number plate	G3, G80, G9, G12, G12DL	2
166103	Nut, rear lamp fixing screw	G3C, G12CS, G12CSR	2
188330	Washer, rear lamp fixing nut	G3, G80, G9, G12, G12DL	1
188412	Washer, rear lamp fixing screw	G3C, G12CS, G12CSR	1

VOLTAGE REGULATOR

015070	Regulator, complete unit (Lucas 37232)	G3C...	2 11 6
024187	Regulator, complete unit (Lucas 37252)	G12DL, G12CS, G12CSR...	2 11 6
025440	Bracket, regulator unit	G3C...	1 9
000343	Bolt, fixing regulator unit	G3C...	4

000005	Nut, regulator fixing bolt	G3C...	2
000012	Washer, plain, regulator fixing bolt	G3C...	4
011094	Grommet, rubber, regulator cable	G12DL, G12CS, G12CSR...	1
024204	Rubber, shrouding, regulator unit	G12DL, G12CS, G12CSR...	2 6
022720	Rubber, regulator/tool box lid	G12DL, G12CS, G12CSR...	3
024205	Rubber, regulator unit base	G12DL, G12CS, G12CSR...	6

BATTERY

026366	Battery, with lid (charged, but dry) (MLZ9E)	All except G3C	2 17 6
022345	Battery, with lid (charged, but dry) (PUZ.7E.11)	G3C...	2 6 6

HORN

022529	Horn, electric	All except G3C	1 15 0
015257	Horn, electric	G3C...	2 2 6
012565	Bolt, fixing horn	All except G3C, G80CS	4
000080	Nut, horn fixing bolt	All except G3C, G80CS	2
000039	Washer, plain, horn fixing bolt	All except G3C, G80CS	1
021453	Washer, horn fixing bolt	G3C...	2
026410	Bracket, for horn	All except G3C, G80CS	1 9
000368	Bolt, horn bracket	All except G3C, G80CS	5
000004	Nut, horn bracket bolt	All except G3C, G80CS	4
000011	Washer, plain, horn bracket bolt	All except G3C, G80CS	1
015705	Nut, sleeve horn bracket	G3C...	1 2
015707	Washer, horn bracket sleeve nut	G3C...	1
015706	Rubber, horn bracket sleeve nut	G3C...	3

CABLE CLIPS

011907	Clip, rubber, 1 1/4 ins.	G3, G80	3
011907	Clip, rubber, 1 1/4 ins.	G3C, G12CS, G12CSR	3
011907	Clip, rubber, 1 1/4 ins.	G9, G12, G12DL	3
011908	Clip, rubber, 3/4 ins.	All except G3C, G80CS	3
011908	Clip, rubber, 3/4 ins.	G3C, G80CS	3
018220	Clip, rubber, 4/8 ins.	G3, G80, G12CS, G12CSR	3
018220	Clip, rubber, 4/8 ins.	G3C...	3
018220	Clip, rubber, 4/8 ins.	G9, G12, G12DL	3
014453	Clip, metal, rear lamp cable to mudguard	G3, G80, G9, G12, G12DL	4

STOPLIGHT

026622	Kit, complete set of parts	G3C...	14 0
022031	Switch, only, stop light	All except G80CS, G12CS	8 0
022032	Bracket, stop light switch	All except G3C, G80CS, G12CS	1 3
026612	Bracket, stop light switch	G3C...	2 6
018721	Spring, pull off, for switch	All except G80CS, G12CS	1 0
018764	Clip (on brake rod), for pull off spring	All except G80CS, G12CS	7
000738	Screw, for switch and pull off spring	All except G80CS, G12CS	2
000739	Nut, for switch and pull off spring screw	All except G80CS, G12CS	2
000039	Washer, for switch and pull off spring screw	All except G80CS, G12CS	1
024376	Cable, switch to lamp and battery	All	2 3
000269	Connection, snap, for cable	All except G80CS, G12CS	7
014453	Clip, metal, cable to mudguard	G3, G80, G9, G12, G12DL, G12CSR	4
011908	Clip, rubber, for cable, 3/4 ins.	G3, G80, G9, G12, G12DL, G12CSR	3
011908	Clip, rubber, for cable, 3/4 ins.	G3C...	3
018220	Clip, rubber, for cable, 4/8 ins.	G3, G80, G9, G12, G12DL, G12CSR	3
011907	Clip, rubber, for cable, 1 1/4 ins.	G12CSR	3

ALTERNATOR, ETC.

47122A	Stator, generator	G3, G80, G80CS, G9, G12	3 15 0
024150	Stud, in chaincase, for generator stator	G3, G80, G80CS, G9, G12	4
011843	Nut, for generator stator stud	G3, G80, G80CS, G9, G12	4
000012	Washer, plain, for generator stator stud	G3, G80, G80CS, G9, G12	1
041065	Grommet, rubber, for stator cable	G3, G80, G80CS, G9, G12	3
022216	Plug, alternator cable hole	G80CS	2
423506	Rotor, generator	G3, G80, G80CS, G9, G12	4 7 6
026286	Spacer, in lieu of rotor	G80CS	2 3
024026	Spacer, generator rotor	G3, G80, G80CS	1 6
023034	Spacer, generator rotor	G9, G12	1 6
042195	Key, Woodruff, generator rotor	G3, G80, G80CS, G9, G12	6
000230	Nut, generator rotor	G3, G80	11
000176	Washer, generator rotor nut	G3, G80, G80CS	1
025267	Washer, lock, generator rotor	G9, G12	3
024183	Contact breaker, complete (Lucas 47578)	G3	2 5 0
024273	Contact breaker, complete (Lucas 47579)	G80	2 5 0
465958	Plate, contact breaker	G3, G80	2 9
420196	Points, contact breaker	G3, G80	5 9
420302	Condenser, contact breaker plate	G3, G80	6 3
000451	Screw, fixing contact breaker plate to timing case	G3, G80	4
000039	Washer, plain, contact breaker plate fixing screw	G3, G80	1
515729	Weight, assembly	G3, G80	2 9
424201	Spring set, auto advance	G3	1 3
416136	Spring set, auto advance	G80	1 3
465939	Cam, contact breaker	G3, G80	7 0
024310	Bolt, for contact breaker cam	G3, G80	3
024326	Washer, plain, contact breaker cam bolt	G3, G80	1

024327	Washer, shakeproof, contact breaker cam bolt	G3, G80	1	1
024159	Grommet, rubber, contact breaker cable	G3, G80	1	2
024251	Rectifier, with bolt and nut (Lucas 47111)	G3, G80, G80CS, G9, G12	1	2 6
000214	Nut, fixing rectifier	G3, G80, G80CS, G9, G12	1	5
014779	Washer, shakeproof, rectifier fixing nut	G3, G80, G80CS, G9, G12	1	1
024404	Screw, for rectifier leads	G3, G80, G80CS, G9, G12	3	3
024405	Nut, for rectifier lead screw	G3, G80, G80CS, G9, G12	3	3
024406	Washer, for rectifier lead screw	G3, G80, G80CS, G9, G12	3	3
024210	Coil assembly (Lucas 45077)	G3, G80, G9, G12	1	11 6
026314	Strap, assembly, for coil	G3, G80, G9, G12	1	2 6
024213	Screw, for coil strap	G3, G80, G9, G12	2	3
024214	Seat "D" for coil strap	G3, G80, G9, G12	4	3
024215	Nut, square, for coil strap	G3, G80, G9, G12	2	1 9
025268	Distributor and gear assembled	G9, G12	3	2 6 9
025191	Distributor, only	G9, G12	1	16 6
025029	Adaptor, for distributor	G9, G12	1	3
025032	Pin, driving, for distributor adaptor	G9, G12	1	7
012920	Circlip, for distributor adaptor	G9, G12	1	4
000341	Bolt, locking distributor	G9, G12	1	2 2
000012	Washer, distributor locking bolt	G9, G12	1	6 6
000543	Cable, distributor and coil, 21 ins.	G9, G12	1	6
425049	Cap, assembly, distributor	G9, G12	1	1 9
404435	Brush and spring, carbon, for distributor cap	G9, G12	1	6
188639	Ring, rubber, for distributor cap	G9, G12	1	6
424158	Clip, spring, retaining distributor cap	G9, G12	2	4
421863	Clip, H.T. lead contact	G9, G12	4	2 6
423486	Arm, rotor	G9, G12	1	4
421554	Cover, rubber, H.T. lead	G9, G12	3	6 3
425219	Contact breaker set	G9, G12	1	7 6
54410769	Condenser, assembly	G9, G12	1	10 0

ELECTRICAL SUNDRIES (ALL EXCEPT G80CS)

36084	Ammeter, for headlamp	All	1	10 0
54033109	Switch, for lighting	G3, G80	1	0 0
31754	Switch, for lighting	G3C, G12CS	1	13 6
54033028	Switch, for lighting	G9, G12, G12DL, G12CSR	1	0 0
54033027	Switch, for ignition	G3, G80	1	19 6
54033056	Switch, for ignition	G9, G12	1	0 0
54330934	Knob and screw, for lighting switch	G3, G80, G9, G12, G12DL, G12CSR	1	1 9
351815	Knob and screw, for lighting switch	G3C, G12CS	1	2 6
54332498	Knob and screw, for ignition switch	G3, G80, G9, G12	1	2 3
022548	Switch dipping and horn combined	G3, G80, G9, G12, G12DL, G12CSR	1	10 6
360521	Switch, dipping	G3C, G12CS	1	7 0
380459	Packing, rubber, for dipping and horn switch	G3, G80, G9, G12, G12DL, G12CSR	1	9
021299	Screw, fixing dipping switch	G3, G80, G9, G12, G12DL, G12CSR	2	3
021637	Switch, for horn	G3C, G12CS	1	7 3
021637	Switch, for magneto cut out	G3C, G12CS	1	7 3
54944148	Harness, main lighting	G3, G80	1	17 0
54941907	Harness, main lighting	G3C	1	10 6
54944147	Harness, main lighting	G9, G12	1	15 0
54944350	Harness, main lighting	G12DL, G12CSR	1	5 0
54945365	Harness, main lighting	G12CS	1	11 6
54941009	Harness, dipping switch	G3, G80, G9, G12, G12DL, G12CSR	1	2 0
54941013	Harness, dipping switch	G3C, G12CS	1	1 6
54941908	Harness, regulator	G3C	1	3 0
8652178	Cable, for horn	G12DL, G12CS, G12CSR	1	5 0
369218	Cable, for magneto cut out	All	1	1 0
369218	Plug, headlamp cable harness	G12CS	1	1 0
54941768	Socket, dynamo terminals	G3C, G12CS	1	3 6
809795	Cover, dynamo terminals	G3C, G12CS	1	3 9
000543	Terminal, high tension, for sparking plugs	G3C, G12DL, G12CS, G12CSR	1	1 0
000541	Terminal, high tension cable	All	1	Per foot
000269	Connector, snap, with sleeve, rear lamp cable	All	1	4
011094	Plug, spark, K.L.G. F.E.80	All	1	7
015547	Plug, spark, K.L.G. F.E.80	All	1	5
015538	Plug, spark, K.L.G. F.E.80	G3, G80, G9, G12, G12DL	1	5 0
025529	Plug, spark, K.L.G. F.E. 220	G3C	1	5 0
025529	Plug, spark, K.L.G. F.E. 200	G80CS	1	7 6
015399	Cover, for sparking plug	G12CS, G12CSR	1	7 6
018995	Interference suppressor (home market only)	G3C, G80CS	1	2 3
373	Bulb, headlamp, main 6 volt 30 X 24 watt (home and export except Europe)	All	1	9
403	Bulb, headlamp, main, 6 volt 35 X 35 watt (Europe, except France)	All	1	5 6
988	Bulb, headlamp, pilot, 6 volt X 3 watt	All	1	6 6
384	Bulb, rear lamp, stop, tail, 6 volt X 18 X 6 watt	All	1	1 3

SPEEDOMETER

025499	Head, only, speedometer, with nuts and washers, 120 m.p.h.	G3, G80, G9, G12, G12DL, G12CSR	1	4 10 0
021422	Head, only, speedometer, with nuts and washers, 120 m.p.h.	G3C, G80CS, G12CS	1	4 10 0

025498	Head, only, speedometer, with nuts and washers, 180 k.p.h.	G3, G80, G9, G12, G12DL, G12CSR	1	4 10 0
021423	Head, only, speedometer, with nuts and washers, 180 k.p.h.	G3C, G80CS, G12CS	1	4 10 0
53279-1	Set, of bulb holding parts for speedometer head	All	1	5 0
53205	Bulb, only, 6 volt X 1.8 watt M.C.B.	All	1	1 6
022057	Bracket, retaining speedometer head in headlamp shell	G3, G80, G9, G12, G12DL, G12CSR	1	3 10
010696	Bracket, for speedometer head	G3C	1	1 3
023626	Bracket, for speedometer head	G80CS, G12CS	1	5 5
N.1253	Nut, fixing speedometer head to bracket	All	2	2
W.7216	Washer, spring, speedometer head fixing nut	All	2	1
000341	Bolt, fixing bracket to handlebar lug	G3C	2	4
000362	Bolt, fixing bracket to handlebar lug	G80CS, G12CS	2	5
000012	Washer, plain, bracket fixing bolt	G3C	2	1
000192	Washer, spring, bracket fixing bolt	G80CS, G12CS	2	1
000012	Washer, packing, for speedometer head	G80CS, G12CS	1	1
53395-1-65	Cable, speedometer drive, complete	All except G3C	1	2 6
53395-1-62	Cable, speedometer drive, complete	G3C	1	2 6
52108-1-65	Cable, speedometer drive, inner only	All except G3C	1	11 3
52108-1-62	Cable, speedometer drive, inner only	G3C	1	11 3
53398-1-65	Cable, speedometer drive, outer only	All except G3C	1	11 3
53398-1-62	Cable, speedometer drive, outer only	G3C	1	11 3
024448	Gearbox, speedometer drive complete	All	1	17 6
021799	Grommet, speedometer cable in fork crown	G80CS, G12CS	1	6
021798	Grommet, speedometer head in headlamp	All touring and CSR	1	1 3

TOOLKIT

024385	Tool kit, with inflater	G3, G80	1	3 19 8
024387	Tool kit, with inflater	G3C, G80CS	1	3 19 9
025430	Tool kit, with inflater	G9, G12	1	3 18 11
024386	Tool kit, with inflater	G12DL, G12CSR	1	3 19 0
025432	Tool kit, with inflater	G12CS	1	3 16 9
024388	Tool kit, less inflater	G3, G80	1	3 8 3
024390	Tool kit, less inflater	G3C, G80CS	1	3 9 4
025431	Tool kit, less inflater	G9, G12	1	3 8 6
024389	Tool kit, less inflater	G12DL, G12CSR	1	3 8 7
025433	Tool kit, less inflater	G12CS	1	3 6 4

TOOLS

017253	Bag, for tools	All	1	6 3
021625	Screwdriver	All	1	1 3
017248	Pliers, sidecutting	All	1	5 9
011168	Pliers, for gudgeon pin circlips	All	1	2 5
017246	Gun, grease	All	1	9 3
017053	Spanner, double end, 1/2 ins. by 3/8 ins.	All	1	5 7
017007	Lever, tyre	All	2	1 7
018178	Spanner, double end 1-010 ins. by 1-2 ins.	All	1	2 3
017257	Spanner, double end, 3/4 ins. by 3/8 ins.	All	1	2 1
023284	Spanner, for frame stay unit.	All	1	1 5
017252	Spanner, box, with Tommy bar, for sparking plug	All	1	2 4
018055	Key, Allen, for handlebar clip screw	All except G3C	1	11
017249	Wrench, adjustable	All	1	13 8
017254	Spanner, for dynamo and clutch	All	1	1 3
017052	Spanner, double end, 3/8 ins. by 1/2 ins.	All singles	2	3 8
017052	Spanner, double end, 3/8 ins. by 1/2 ins.	All twins	1	3 8
024365	Screwdriver and gauge, for contact breaker	G3, G80, G9, G12	1	9
015023	Spanner and gauge, for contact points	G3C, G80CS, G12DL, G12CS, G12CSR	1	10
018667	Key, Allen, for fork crown pinch screw	G3, G80, G9, G12, G12DL, G12CSR	1	2 3
015264	Spanner, for rocker spindle lock nut	All twins	1	5
015213	Spanner, box, 3/8 ins. hexagon	All twins	1	2 6
000174	Washer, brake shoe adjustment	All except G3C	8	2
017670	Washer, brake shoe adjustment	G3C	8	1
017114	Infлятор, tyre	All	1	10 5

SPECIAL TOOLS AND SUNDRIES

017482	Holder, valve for grinding	All singles	1	2 4
011381	Holder, valve for grinding	All twins	1	1 3
018276	Compressor, valve spring	All singles	1	5 3
022011	Disc, timing (see instruction book)	All	1	5 3
015273	Extractor, for timing pinion and magnet gear	All twins	1	6 10
015374	Extractor, for camshaft gears	All twins	1	6 10
024328	Bolt, extractor, for contact breaker	G3, G80	1	2 0
040449	Tool extracting clutch	All	1	8 6
B.M.H.	Badge, monogram. Matchless, for button-hole	All	1	1 6
B.M.B.	Badge, monogram. Matchless, Brooch	R All	1	1 6
011957	"Tekall" rust preventative, 1/2 pint	All	1	2 0
011958	"Tekall" rust preventative, 1 pint	R All	1	3 6
026730	Enamel, off-white, 1/2 pint tin	R All	1	2 6

000073	Nut, pillion footrest spindle hinge bolt	2	G80CS, G12CS	4
024174	Yoke, pillion footrest spindle, left	1	G80CS, G12CS	5 0
024175	Yoke, pillion footrest spindle, right	1	G80CS, G12CS	5 0
000003	Nut, pillion footrest spindle yoke	2	G80CS, G12CS	4
000010	Washer, plain pillion footrest spindle yoke	2	G80CS, G12CS	1
014119	Washer, spring, pillion footrest spindle yoke	2	G80CS, G12CS	1

G80CS WITH LIGHTING EQUIPMENT

ALTERNATOR, BATTERY AND RECTIFIER—AS TOURING

FRONT AND REAR JUMBER PLATES, HORN AND BRACKET, AND REAR LAMP—AS G12CS

BATTERY CARRIER

026466	Carrier, battery, less strap	1	G80CS	3 8
023797	Strap, battery carrier	1	G80CS	2 8
023359	Rubber, battery carrier support	1	G80CS	6
026361	Rubber, battery steady, rear	4	G80CS	1
026360	Rubber, battery steady, side	4	G80CS	3
000347	Bolt, battery carrier, top	1	G80CS	5
000005	Nut, battery carrier top bolt	1	G80CS	4
000012	Washer, battery carrier top bolt	1	G80CS	1
026779	Cover, assembled, for battery	1	G80CS	9 9
011094	Grommet, rubber, for cable	2	G80CS	5

SILENCER, ETC.

023623	Baffle, exhaust pipe	1	G80CS	8 9
026592	Silencer, only	1	G80CS	4 0 0
000347	Bolt, clamping silencer to exhaust pipe	1	G80CS	5
024558	Washer, plain, silencer clamping bolt	1	G80CS	1
000005	Nut, silencer clamping bolt	1	G80CS	4
024281	Stay, silencer	1	G80CS	3 8
024176	Bolt, silencer stay to frame	1	G80CS	9
000010	Washer, small, silencer stay to frame bolt	1	G80CS	1
000008	Washer, large, silencer stay to frame bolt	1	G80CS	2
000003	Nut, silencer stay to frame bolt	1	G80CS	4
000363	Bolt, silencer to stay	1	G80CS	5
000004	Nut, silencer to stay bolt	1	G80CS	4
000011	Washer, plain, silencer to stay bolt	1	G80CS	1
000192	Washer, spring, silencer to stay bolt	1	G80CS	1

HEADLAMP, ETC.

58586A	Lamp, head, with bulb, ammeter and switch, less cable harness	1	G80CS	5 13 0
54520852	Shell, only, headlamp	1	G80CS	1 10 0
553248	Rim, only, headlamp	1	G80CS	15 6
516798	Light unit, reflector and glass	1	G80CS	16 0
144921	Screw, fixing headlamp rim	1	G80CS	6
554602	Holder, for bulb	1	G80CS	4 9
112201	Bolt, fixing headlamp to fork covers	2	G80CS	2 9
021099	Washer, headlamp fixing bolts	2	G80CS	1 5
36084	Ammeter only	1	G80CS	10 0
31784	Switch, lighting	1	G80CS	1 2 6
026354	Bracket, headlamp lighting switch	1	G80CS	2 6
351815	Knob and screw, for lighting switch	1	G80CS	2 6
31620	Switch, dipping	1	G80CS	7 9
76204	Switch, horn	1	G80CS	7 3
54945334	Harness, main lighting	1	G80CS	17 0
54946012	Plug, headlamp cable harness	1	G80CS	5 6
000543	Cable, high tension for sparking plug	R	G80CS	Per foot 1 3
000541	Terminal for high tension cable	R	G80CS	4
000269	Connector, snap, with sleeve, rear lamp cable	R	G80CS	7
011094	Bush, rubber, rear lamp cables	1	G80CS	5
025529	Plug, sparking K.L.G. 220	R	G80CS	7 6
015399	Cover, for sparking plug	R	G80CS	2 3
018995	Interference suppressor	1	G80CS	1 9
373	Bulb, headlamp, main, 6 volt, 30 watt	R	G80CS	5 6
966	Bulb, headlamp, pilot, 6 volt, 3 watt	R	G80CS	1 1
				Purchase Tax 1 1
				1 5

REVOLUTION COUNTER G12CSR

022127	Head, only, revolution counter	1	G12CSR	4 0 0
024488	Bracket, revolution counter and speedometer head	1	G12CSR	17 9
013351	Nut, sleeve revolution counter head bracket	4	G12CSR	1 3
013353	Rubber, revolution counter head bracket	8	G12CSR	3
013352	Washer, metal, revolution counter head bracket	8	G12CSR	1
018162	Gearbox, revolution counter drive	1	G12CSR	2 7 6
000451	Screw, revolution counter gear box	2	G12CSR	4
000190	Washer, spring, revolution counter gear box screw	2	G12CSR	1
018980	Flange, revolution counter gear box	1	G12CSR	7 7
024490	Distributor, oil	1	G12CSR	10 2

018959	Cap, housing, oil distributor	1	G12CSR	7 3
023106	Washer, copper oil distributor housing cap	1	G12CSR	6
018958	Seal, oil distributor housing cap	1	G12CSR	5 8
000750	Circlip, oil distributor housing cap	1	G12CSR	10
023603	Cable, drive revolution counter	1	G12CSR	17 6
021422	Head, speedometer only, 120 m.p.h.	1	G12CSR	4 10 0
014963	Lamp head, with ammeter switch and bulbs, less cable harness	1	G12CSR	4 7 6
021731	Cover tube, top, front fork, left	1	G12CSR	16 5
021732	Cover tube, top, front fork, right	1	G12CSR	16 5

G80CS WITH 1 1/8 ins. MONOBLOC CARBURETTOR

022652	Carburettor, complete, less controls	1	G80CS	5 0 0
021002	Spacer, for carburettor	1	G80CS	3 8
000581	Gasket, for carburettor spacer	1	G80CS	4
000291	Stud, fixing carburettor	2	G80CS	5
000004	Nut, carburettor fixing stud	2	G80CS	4
026492	Hose, for air cleaner	1	G80CS	6 0
026493	Liner, for air cleaner hose	1	G80CS	3 3
022565	Camshaft, inlet	1	G80CS	1 9 3
012695	Camshaft, exhaust	1	G80CS	1 10 1

PISTONS (OPTIONAL COMPRESSION RATIO)

G80CS (HIGH COMPRESSION)

026811	Piston, bare, standard size, 12 to 1 C.R.	1	G80CS	3 12 4
026813	Piston, bare, -020 ins. oversize, 12 to 1 C.R.	1	G80CS	3 12 4
026815	Piston, bare, +020 ins. oversize, 12 to 1 C.R.	1	G80CS	3 12 4
026812	Piston, complete, standard size, 12 to 1 C.R.	1	G80CS	5 0 0
026814	Piston, complete, -020 ins. oversize, 12 to 1 C.R.	1	G80CS	5 0 0
026816	Piston, complete, +040 ins. oversize, 12 to 1 C.R.	1	G80CS	5 0 0

TWINS (LOW COMPRESSION, EXPORT)

026848	Piston, bare, standard size, 6-75 to 1 C.R.	2	G12, G12DL, G12CS, G12CSR	1 11 6
026850	Piston, bare, -020 ins. oversize, 6-75 to 1 C.R.	2	G12, G12DL, G12CS, G12CSR	1 11 6
026852	Piston, bare, +040 ins. oversize, 6-75 to 1 C.R.	2	G12, G12DL, G12CS, G12CSR	1 11 6
026849	Piston, complete, standard size, 6-75 to 1 C.R.	2	G12, G12DL, G12CS, G12CSR	1 11 6
026851	Piston, complete, -020 ins. oversize, 6-75 to 1 C.R.	2	G12, G12DL, G12CS, G12CSR	2 13 5
026853	Piston, complete, +040 ins. oversize, 6-75 to 1 C.R.	2	G12, G12DL, G12CS, G12CSR	2 13 5

PISTON RINGS, GUDGEON PIN AND CIRCLIPS ARE AS STANDARD RATIO PISTONS

AIR CLEANER

026338	Cleaner, air, only	1	G3, G80	2 14 0
022128	Cleaner, air, only	1	G3C...	1 5 0
026607	Cleaner, air, only	1	G80CS	4 19 6
026337	Cleaner, air, only	1	All twins	2 18 0
022129	Adaptor, for air cleaner	1	G3, G3C, G9	1 11
022130	Adaptor, for air cleaner	1	G80, G12, G12DL, G12CS, G12CSR	1 11
026460	Hose, connecting air cleaner	1	G3, G80, G80CS, G9	9
026511	Hose, connecting air cleaner	1	G12, G12DL, G12CS, G12CSR	8
024218	Bolt, fixing air cleaner, top	1	All except G3C, G80CS	6
011373	Nut, air cleaner top fixing bolt	1	All except G3C, G80CS	2
000012	Washer, plain, air cleaner top fixing bolt	1	All except G3C, G80CS	1
000191	Washer, spring, air cleaner top fixing bolt	1	All except G3C, G80CS	1 3
026456	Bolt, fixing air cleaner, bottom	1	All except G3C, G80CS	3
023146	Nut, air cleaner bottom fixing bolt	1	All except G3C, G80CS	1
000012	Washer, plain, air cleaner bottom fixing bolt	1	All except G3C, G80CS	3
000191	Washer, spring, air cleaner bottom fixing bolt	1	All except G3C, G80CS	1
026458	Bracket, fixing air cleaner	1	All except G3C, G80CS	2 0
000362	Bolt, fixing air cleaner	1	G80CS	5
000011	Washer, plain, air cleaner fixing bolt	1	G80CS	1

When fitting an air cleaner the following main jets should be used:—

For G3 and G3C	use jet 376-100, size 200	1	6
For G80	use jet 376-100, size 300	1	6
For G80CS	use jet 3326, size 290	1	2 0
For G9	use jet 376-100, size 210	1	6
For G12 and G12DL	use jet 376-100, size 340	1	6
For G12CS, and G12CSR	use jet 376-100, size 390	1	6